

Wall hung smart toilet USER MANUAL

Model No: D18G/D19G

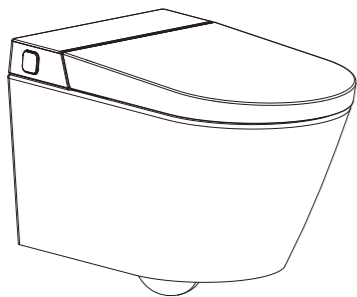

Edition: V 2024.05.04

B05232162

• Before beginning installation, read all instructions first. Save these instructions for future use.

Product functions

Heated Seat, Soft Night Light, Energy Saving, Warm Air Drying, Rear Wash, Front Wash, Moving Cleanse, One Touch, Nozzle Cleaning, Nozzle Self-clean, Foot Induction Flush, Remote Control Flush, Adjustable Water Temperature, Adjustable Seat Temperature, Adjustable Air Temperature, Adjustable Water Pressure, Tube Adjustment.

Using guide

Please follow up the process below before product operation.

1. Open the valve, keep the water flow unobstructed.
2. Plug the power cord into electrical inlet.

Stand by mode

stop current washing or drying function; Long press: in off seat mode, long press to exit or enter standby mode.

Rear Wash

Quickly press: start rear wash ; Subsequently press (in rear wash mode) stop or start oscillating washing.

Front Wash

Quickly press: start front wash ; Subsequently press (in front wash mode) stop or start oscillating washing.

Dryer

Quickly press: start /stop warm air drying.

Packing list

No.	Name	Quantity	No.	Name	Quantity
1	Wall hung smart toilet	1	8	Gasket	1
2	User Manual	1	9	Straight stainless steel braided tube	1
3	Remote Controller	1	10	Seat cover decorate accessories	2
4	Remote Expansion Nut	2	11	Power cord	1
5	AAA Battery	2	12	M4 screws	2
6	Remote Control User Manual	1	13	power cord lock fitting a	1
7	Ball valve	1	14	power cord lock fitting b	1

Product size

Unit: mm

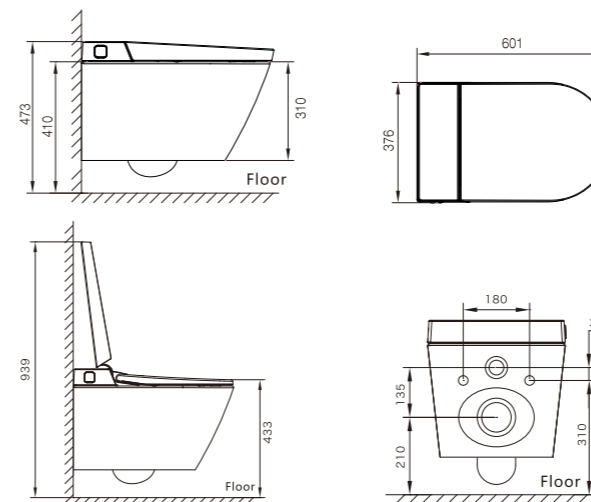

Reserve position before installation

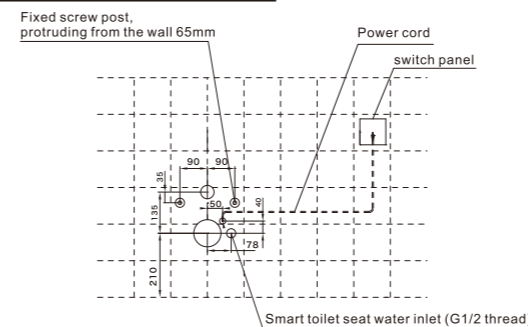

Precautions for use

Attention	It may cause minor injury or damage, be sure to always pay attention.
Forbiddance	Do not operate forbidden content.
Enforcement	Must comply with the enforcing content.
Ground	Connect the ground properly

Warning	
Do not disassemble	It is absolutely forbidden to disassemble, repair and transform this product by yourself. It may cause fire, electric shock and other accidents.
No watering	Do not pour water or detergent on the power plug. It may cause fire, electric shock and other accidents.
Forbiddance of fire	Do not bring lit cigarettes or burning species close to the product. It may cause a fire.
Forbiddance	Please do not continue to use the product when the product fails. Please contact the after-sales service staff for maintenance. When the following situation occurs, please remove the power plug and close the inlet angle valve. 1. Leakage from the inside of the product line; 2. The product is unusually hot; 3. The product makes an abnormal sound and smell; 4. The product is burnt. If the product is still used in the event of malfunction, it may cause problems such as fire, electric shock, water inflow in the room. (The normal life of this product is six years, the continued use beyond the service life may lead to accidents.)
Forbiddance	Only tap water can be used. Otherwise may cause infectious dermatitis and other diseases. Do not use loose power outlet. It may cause a fire or electric shock. Please use the power outlet within the specified conditions (110-120V~, 13A, 60Hz socket). Do only use 110-120V~ power supply. Using power beyond the socket regulations may cause the socket to heat up and cause a fire. Do not damage the power cord and seat wire. 1. Do not damage, do not process, do not heat; 2. Do not force bending, do not curly tied, do not pull; 3. Do not put heavy objects on the power cord and the seat lid connection, ignoring product damage and continuing to use may result in fire, electric shorts and other conditions.
Enforcement	1. This product belongs to the electrical products, do not put it in places where there is water or the places of high humidity. When used in the bathroom, please install ventilation fan or ventilation port to keep the bathroom in good air circulation. Otherwise, it may cause a fire or electric shock. 2. If the power cord is damaged, do not disassemble it yourself and must be replaced by the manufacturer or its service department or relative department.
Grounding	Please check if grounding is done. A product that is not grounded may cause an electric shock in the event of a malfunction or leakage.

Attention	
Forbiddance	Forbiddance sitting on the seat for a long time, the seat temperature should be adjusted in low-grade, please note that low-temperature burns. The following personnel should set the seat temperature at low-grade when using the toilet. 1. Children and elderly people who cannot adjust the temperature to the right degree. 2. Patients, persons with disabilities and other people who can not move freely. 3. Lethargic crowd because of taking hypnotics (Such as sleeping pills, cold medicine, etc.) deep drinking and over fatigue.
Forbiddance	Do not forcibly stretch the connecting pipe of the water supply pipe. Otherwise it may cause water leakage. Do not rely on the seat cover or forcibly press the control panel. Otherwise it may result in malfunction or breakage. Forced application of force may cause seat cover and control panel damage, resulting in personal injury. Do not place containers containing liquid such as vials, cups, cosmetics, pharmaceuticals, etc. or small metal objects on top of the product. Inadvertent entry into the product may result in fire or electric shock. Do not place the product in direct sunlight, otherwise the appearance of products may be aging deformation.

Forbiddance	People with disabilities, mental retardation, etc. (including children) need to use this toilet under supervision, do not let children play with this toilet. Do not use the toilet to flush expect shit, urinate and toilet paper, or it may cause toilet jam, sewage overflow. Please do not hit the ceramic to prevent damages that result in leakage. Please do not use in the environment below 3°C. When installing the inlet angle valve, please tighten firmly. Otherwise it will lead to water leakage. Prevent damage caused by freezing. Freezing can cause damage to the water hose and product interiors and cause water leakage. When traveling for long periods of time or when not in use, please unplug the power plug from the outlet. Unplug the power plug when lightning occurs.
Enforcement	This product is only for bathroom, and should not be used for any purposes other than the ones described in this manual. Otherwise maybe cause to fire, electric shock, personal injury or malfunction. Do not allow urine and other contaminants to touch the smart toilet. Doing so may cause odor or cause malfunction. Do not forcibly close the seat and seat cover. It is necessary to avoid the collision of the seat lid and the seat cover when turning them. Otherwise maybe cause malfunction. For external maintenance, unplug the power plug from the socket for safety reasons. Otherwise maybe get an electric shock.

Technical data

Rated voltage	110-120V~	
Rated frequency	60Hz	
Rated power	1100W (15°C±1°C inlet water temperature)	
Length of wire	1.5m	
Water supply mode	Directly connected to the channel	
Ambient temperature	About 3°C to 40°C	
Water supply temperature	About 3°C to 35°C	
Water pressure range	0.12MPa-0.8MPa	
Safety devices	Seated sensor	
Decontaminating apparatus	Heating method	Instant heating
	Warm water temperature	Four grades (Room temperature to 40°C)
	Spray volume	Buttock cleaning About 0.5 to 0.8L/min Women-only About 0.5 to 0.8L/min
	Warm water heater	1100W
Drying device	Safety appliance	Temperature sensor, temperature fuse, temperature jumper, flowmeter
	Wind speed	>4m/s
	Air temperature	Four grades (Room temperature to 50°C)
Thermal seat	Drying heater	200W
	Safety devices	Double-sheet-metal switch, temperature fuse
	Seat temperature	Four grades (Room temperature to 40°C)
	Seat heater	45W
Safety devices	Temperature sensor, temperature fuse	
Switch structure	Damping slowdown	

Rated power: at room temperature 20±5°C, inlet water static pressure is 0.18±0.02MPa. The average power of turning on the cleaning function and working steadily for one cleaning cycle at the inlet temperature of 15±1°C.

1-5.Remove redundant pipes.

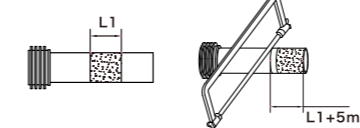

1-6.Remove redundant pipes

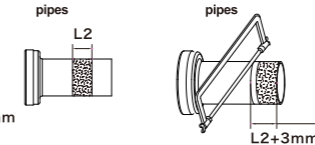

1-7.Remove redundant pipes

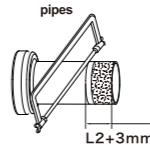

1-8.Sand the sawn-off nozzle to remove burrs.



1-9.After sanding apply silicone oil



1-10.Put in gasket

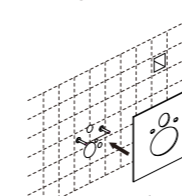

1-11.Install the water inlet braided pipe, power cord, flushing pipe in the wall of the circuit breaker, and apply silicone oil to the nozzle of the sewage pipe.

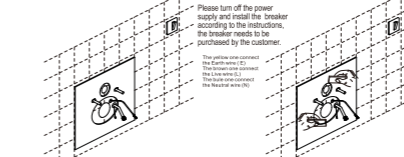

1-12.Insert the outlet and inlet water pipe individually into the wall.

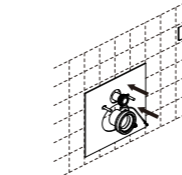

1-13.Apply silicone oil.

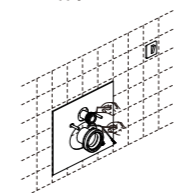

1-14.Cut off excess foam.

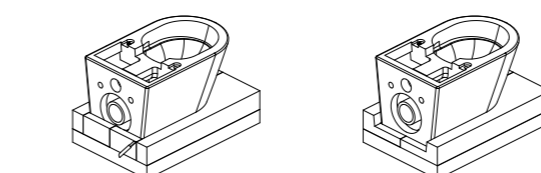

Installation step

1-1.Unpack and confirm accessories

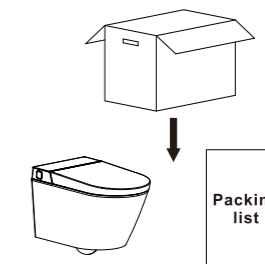

1-2.Open the seat cover and lid, take out the screw and Gasket

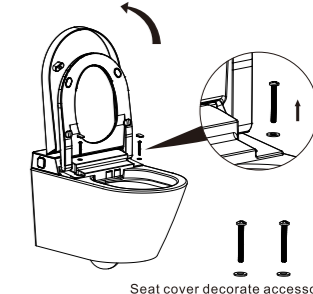

1-3.Close the cover and separate from ceramic, and be careful not to scratch the cover seat.

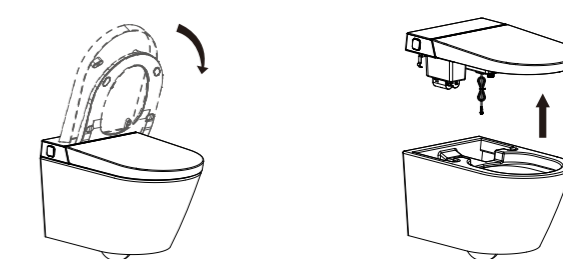

1-4.Confirm the length of the inlet and outlet water pipes.

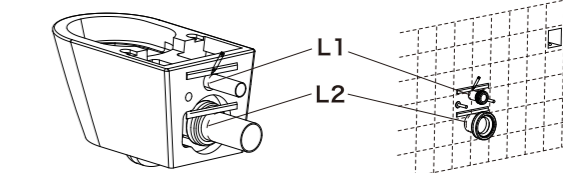

1-15.Align the toilet with the water pipe, and thread the water inlet pipe, connecting wire and power cord to one end of the toilet.

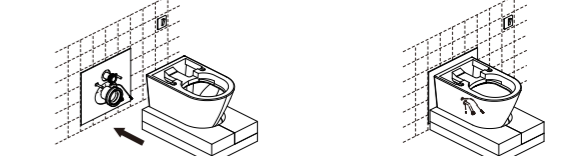

1-16. Check if installed in the same horizontal position.



1-17. Screw on the gasket and nut.

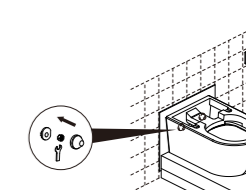

1-18. Cut off excess gasket.

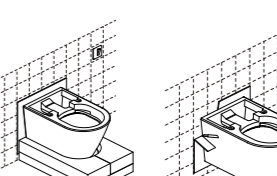

1-19. Glass glue applied around the toilet.

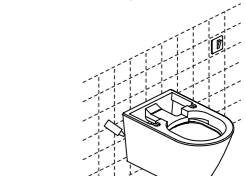

1-20. Tighten the cover plate and the coupler at one end of the toilet; The cover plate is connected with the water inlet hose at one end of the toilet through a ball valve; Make the new hose assembly included with the product, the old hose cannot be reused.

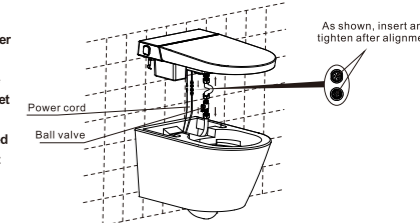

2

3

6

7

1-21. Install the smart toilet cover back on the toilet.

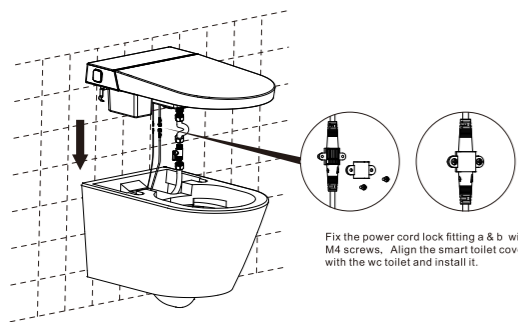

1-22. Screw on the nut and put the decorate accessory back.

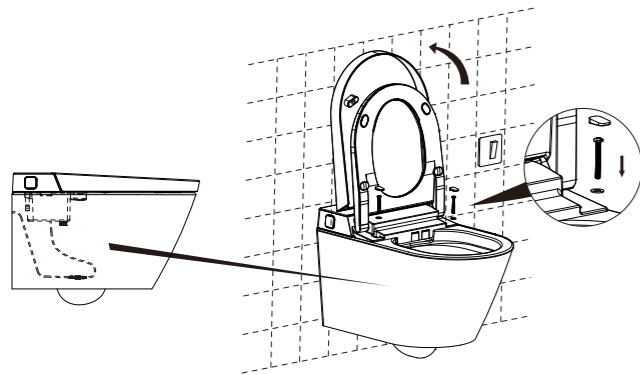

8

1-23.Completed.

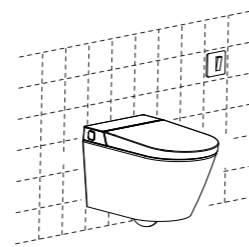

Side button

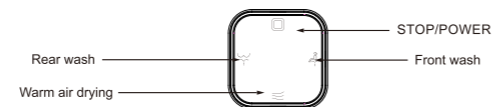

Product cleaning and maintenance methods

Warning: waterproof toilet cleaning precautions

- Do not clean the product with your hands in case of damage or failure, to avoid secondary failure.
- Do not use hydrochloric acid detergent, thinner, bleach, benzene or strong detergent to clean the surface of the toilet. Do not allow pesticides, air fresheners and deodorants to stick to the toilet bowl.
- The body discoloration, cracking and damage caused by the use of the above-mentioned reagents, even within the warranty period also need to paid the services.

1. Nozzle cleaning

- On the machine power mode, do not sit on the seat.
 - Press "Nozzle cleaning", entering the manual cleaning nozzle mode. (Can not activate "nozzle cleaning" mode when seated)
 - Please use soft brush or soft cloth when cleaning.
 - After the cleaning is completed, press the stop button or in the seating state, the cleaning tube is automatically retracted.
- Warning: do not force out or push into the cleaning tube during cleaning, or it may lead to machine failure.

9

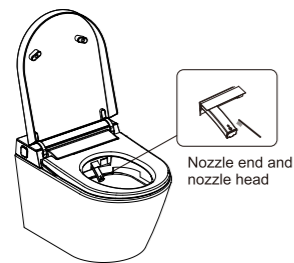

2.Toilet appearance cleaning method diagram

- Please unplug the power plug from the socket or press the reset button on the leak protection.
- Use a soft cloth or sponge stained with neutral detergent to clean the machine.
- Wipe the whole machine with cotton cloth after cleaning.

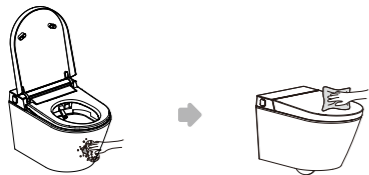

3. Seat toilet management methods in winter

In order to prevent freezing in winter, if there is no heating device inside the toilet, please wrap the connecting pipe with cloth or use other insulation materials for insulation.

When the ambient temperature is below 0°C.

- Stop using the product;
- Pull out the power plug or press the reset button on the leak protection;
- Close the inlet valve.

Note:

Please tighten the filter firmly, otherwise it may cause water leakage.

Do not grab the filter net too strongly as it may distort or rupture.

When blockage blocks the filter, the pressure of the flushing water may not be enough, so please clean the toilet regularly once in three months.

We recommend that you do not use detergent when cleaning. Clean it directly with tap water.

10

How to deal with common problems

Problems	Check	Handling	
Functions does not work at all.	The seat sensing area uses cloth cover, mat and other items.	Please remove the cloth cover, mat and other items.	
	Power is cut.	Please wait for power recovery.	
	Socket is loose or poor contact.	Plug in, ensure good power supply.	
Flushing	No water.	Please wait for the water supply to resume.	
	Water doesn't come out.	Whether the inlet valve is open. Whether the water supply tube is bent and clogged.	Open the inlet valve. Eliminate the water supply pipe bending.
	Flushing power is not strong enough.	Water pressure is set at low-grade. Clean the nozzle to see if there is any blockage.	Turn the water pressure up to high. Please clean the nozzle.
	Water temperature is not high enough.	Whether the water temperature is set at low or normal temperature.	Turn the water temperature up to high.
	No water supply when flushing.	Press the "Rear Wash" or "Front Wash" key for about 60s, the machine will automatically stop. The body is removed from the seat during the cleaning process.	Please restart cleaning. Please sit back in the seat circle and restart cleaning.
Toilet Seat	Thermal seat's heating strength is set in the low or off state.	Turn the seat temperature up to high.	
	The toilet is set in the energy-saving state.	Please exit energy-saving state.	
	Whether the power outage.	Please wait for power recovery.	

11

印刷材质：A3纸正反面