

# CARTON A PART LIST

**A** Left Armrest

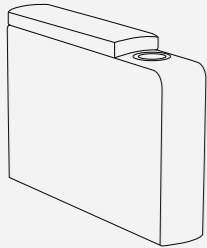

x1

**B** Right Armrest

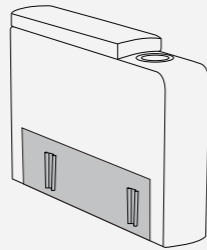

x1

**1** Plastic Leg

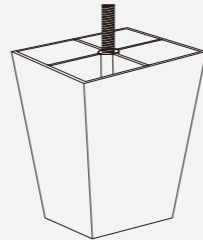

x4

**2** Plastic Washer

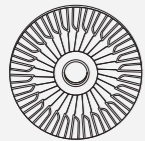

x4

# CARTON A ASSEMBLY

Armrests are in carton A, Remove all parts from the carton A ,  
Place them on protected surface or carpet.

## Step 1:

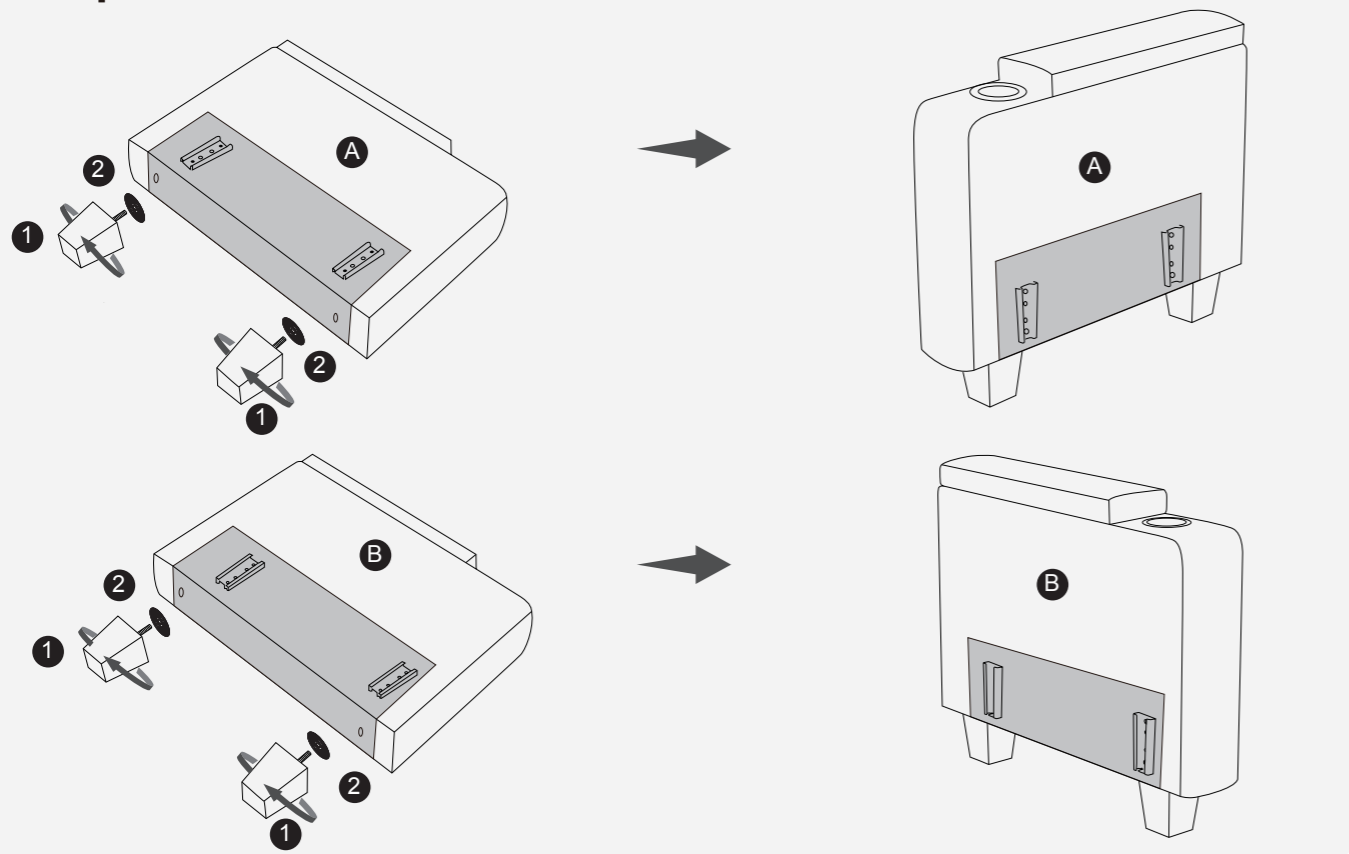

# CARTON B PART LIST

**C** Long Seat Frame

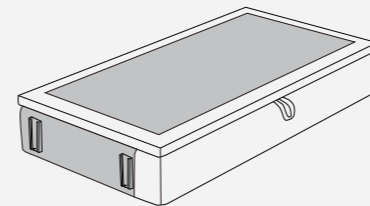

x1

**D** Long Back Frame

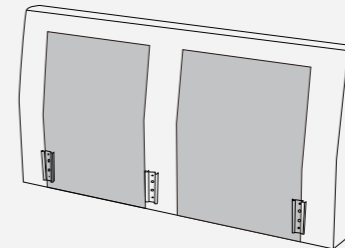

x2

**E** Seat Cushion

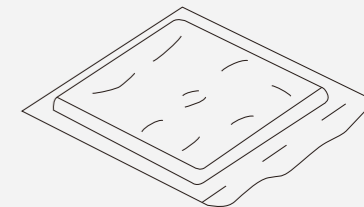

x2

**F** Back Pillow

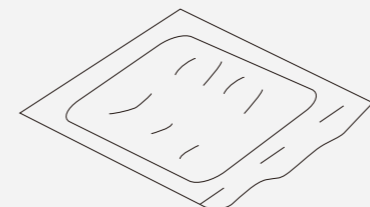

x2

**1** Plastic Leg

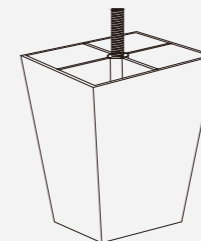

x4

**2** Plastic Washer

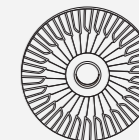

x4

3 Assembly Instructions

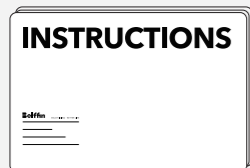

x1

# CARTON B ASSEMBLY

Long seat module is in carton B, Remove all parts from the carton B ,  
Place them on protected surface or carpet.

### Step1:

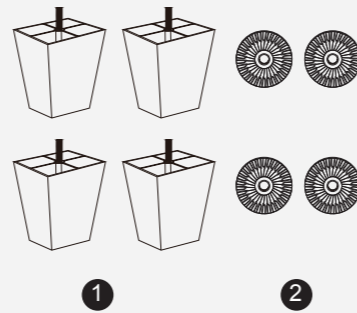
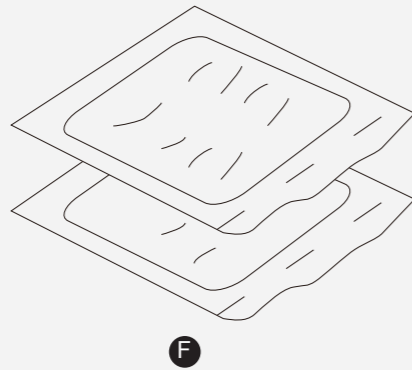
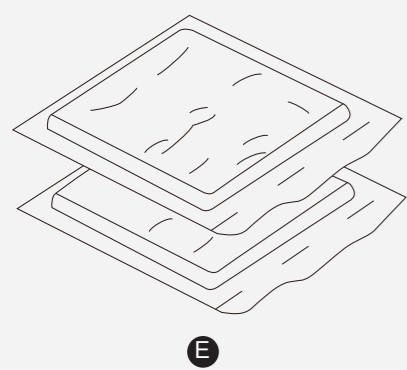
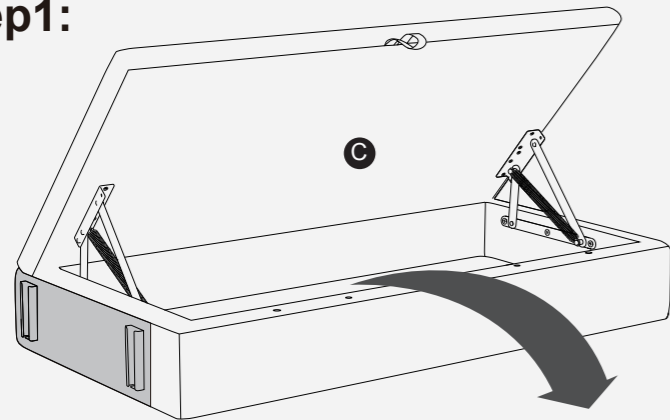

### Step2:

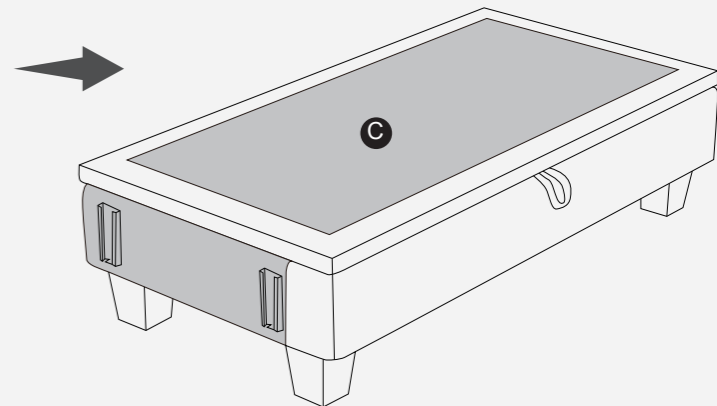
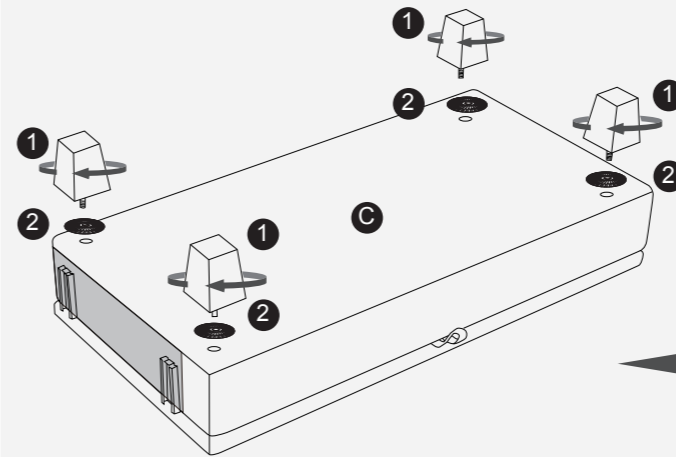

### Step3:

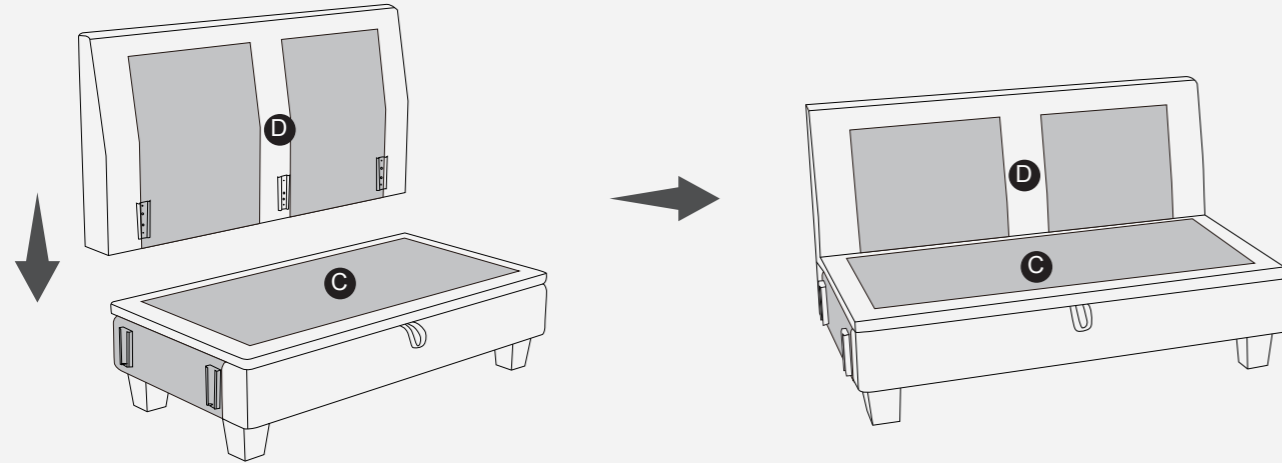

# CARTON C PART LIST

**G** Single Seat Frame

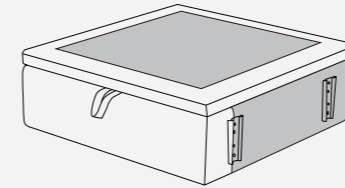

x1

**H** Single Back Frame

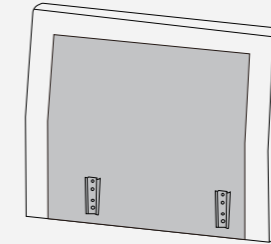

x1

**E** Seat Cushion

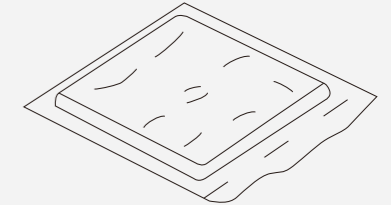

x1

**F** Back Pillow

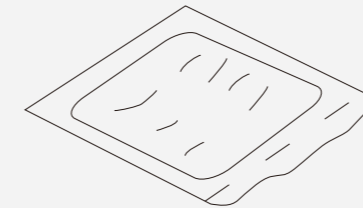

x1

**1** Plastic Leg

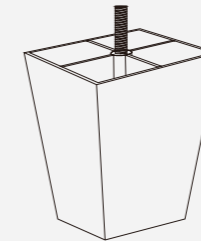

x4

**2** Plastic Washer

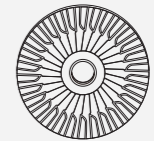

x4

# CARTON C ASSEMBLY

Single seat module is in carton C, Remove all parts from the carton C ,  
Place them on protected surface or carpet.

Step1:

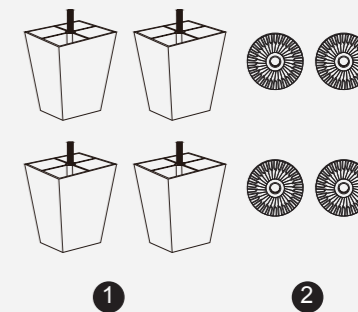
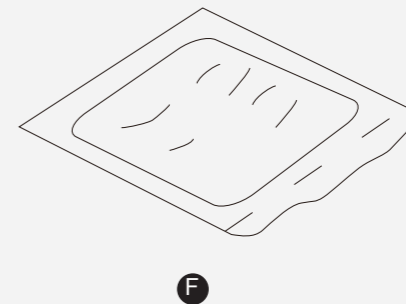
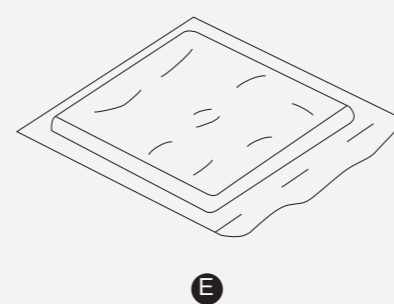
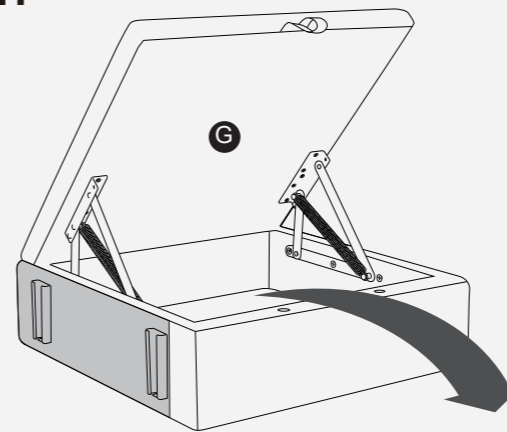

## Step2:

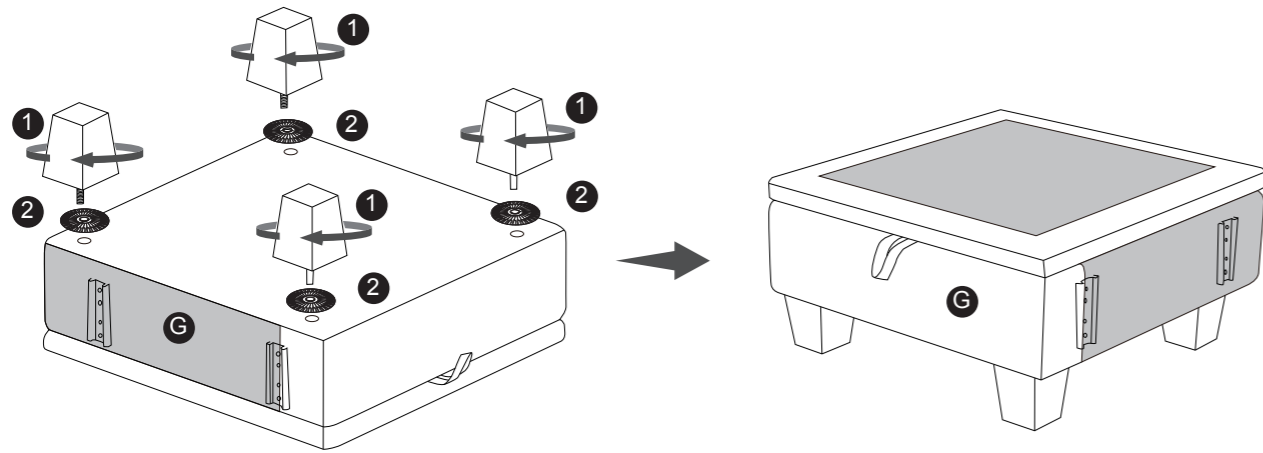

## Step3:

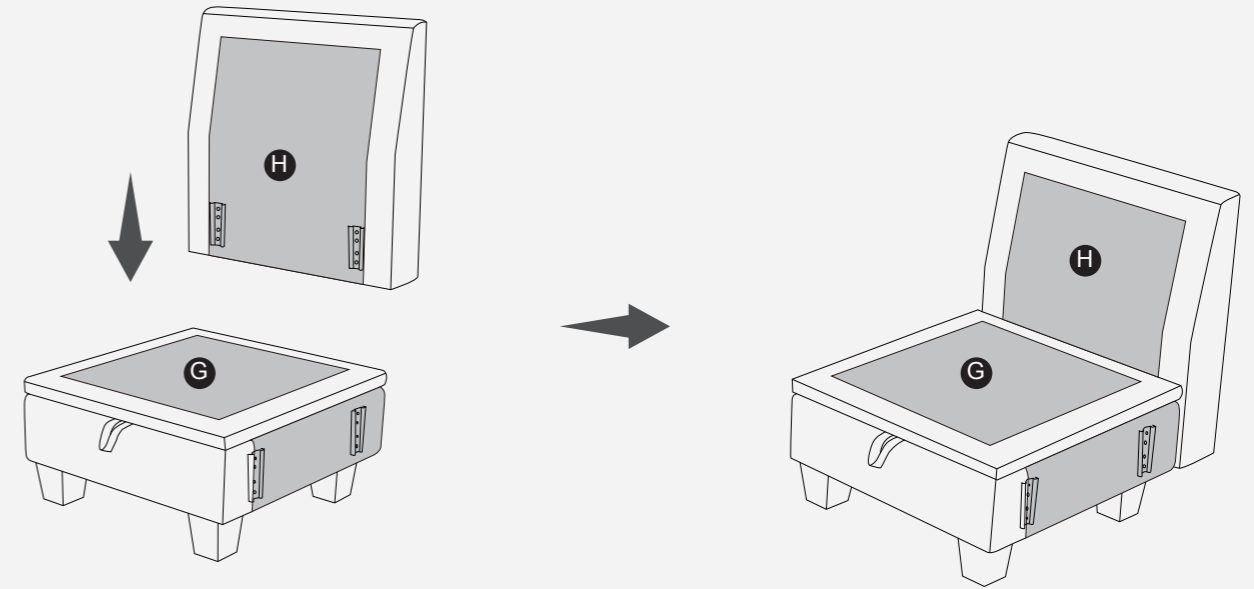

# CARTON D PART LIST

**J** Corner Seat Frame

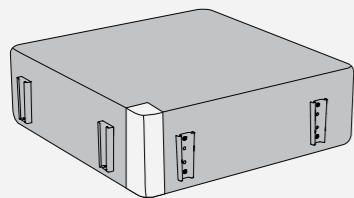

x1

**K** Corner Short Back Frame

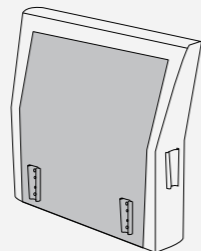

x1

**L** Corner Long Back Frame

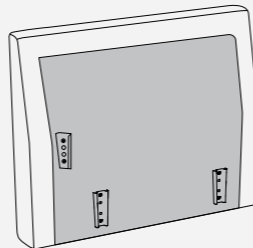

x1

**M** Corner Seat Cushion

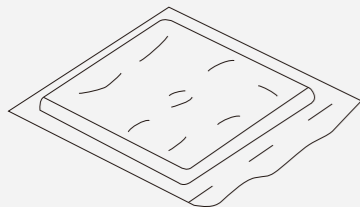

x1

**N** Long Corner Back Pillow

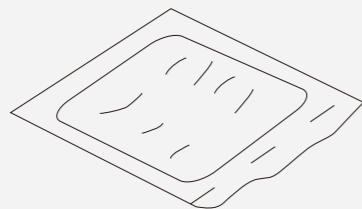

x1

**P** Small Corner Back Pillow

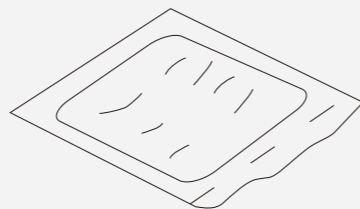

x1

**1** Plastic Leg

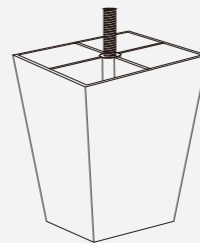

x4

**2** Plastic Washer

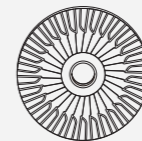

x4

# CARTON D ASSEMBLY

Corner seat module is in carton D, Remove all parts from the carton D, Place them on protected surface or carpet.

Step1:

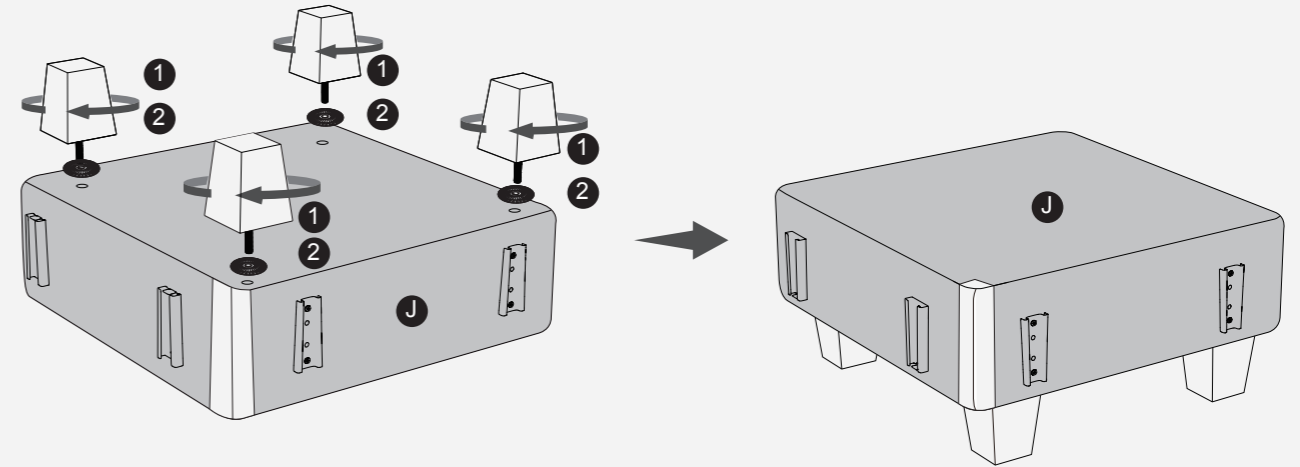

**Step2:** Install Corner Long Back Frame to Corner Seat Frame

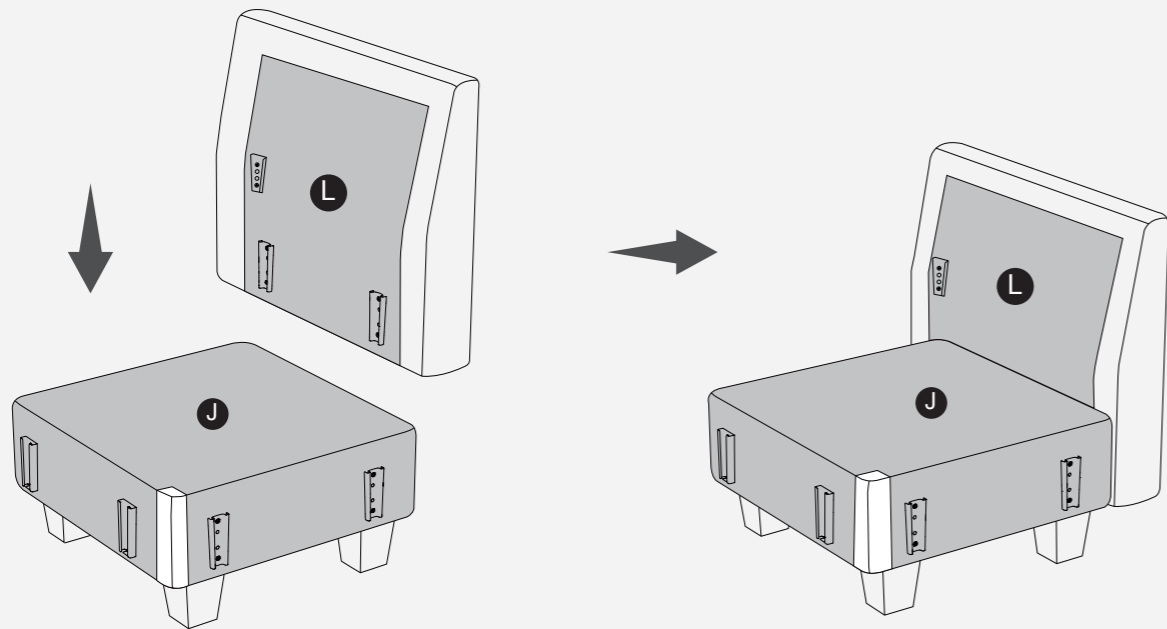

**Step3:** Install Corner Short Back Frame to Corner Seat Frame

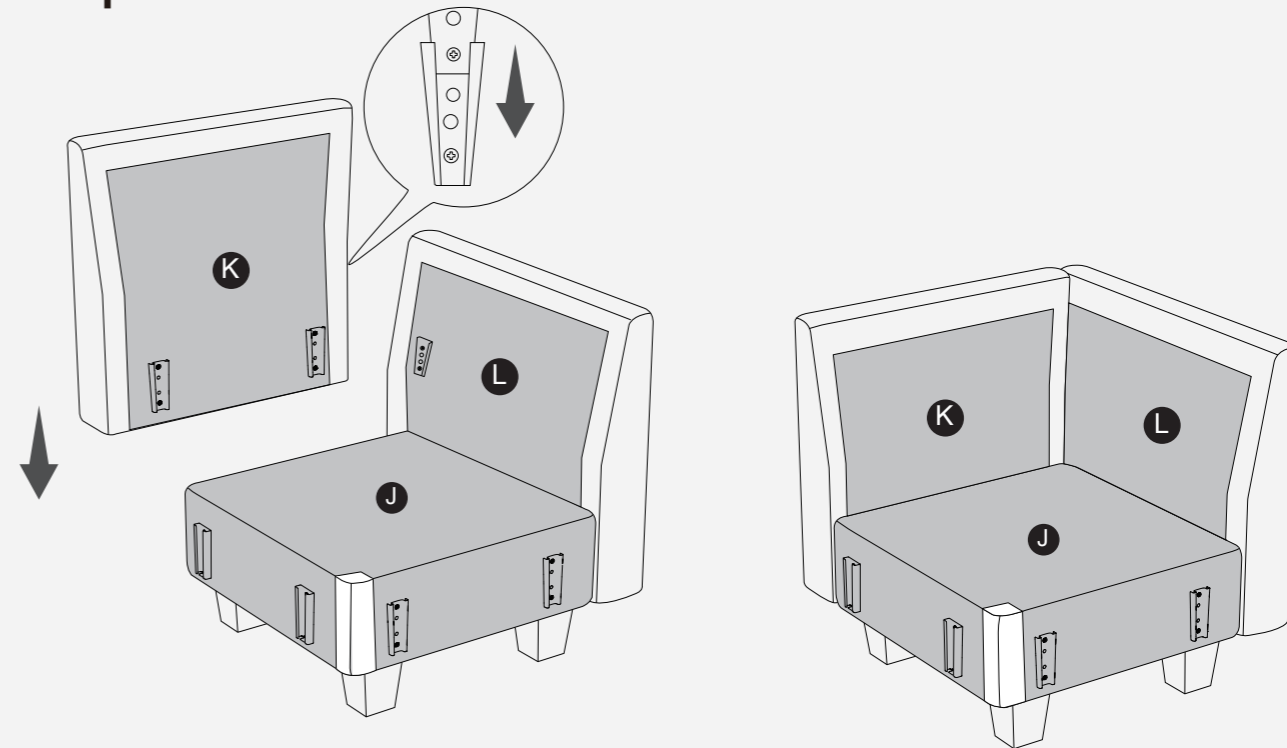

### Step4:

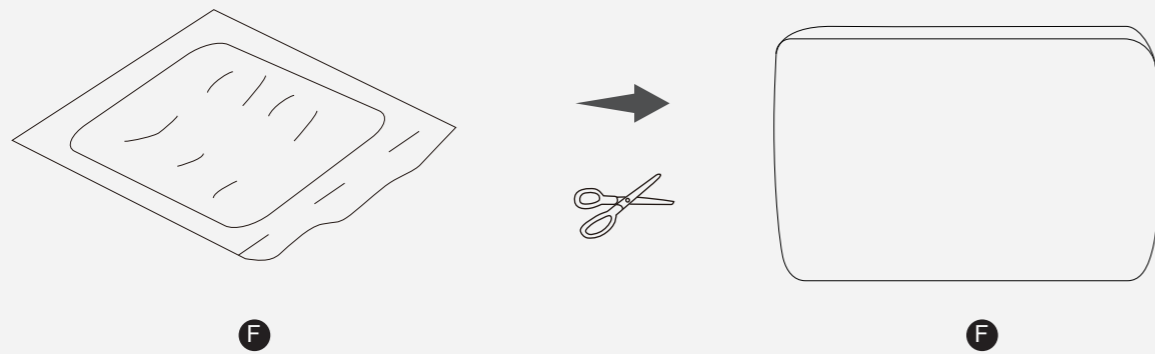
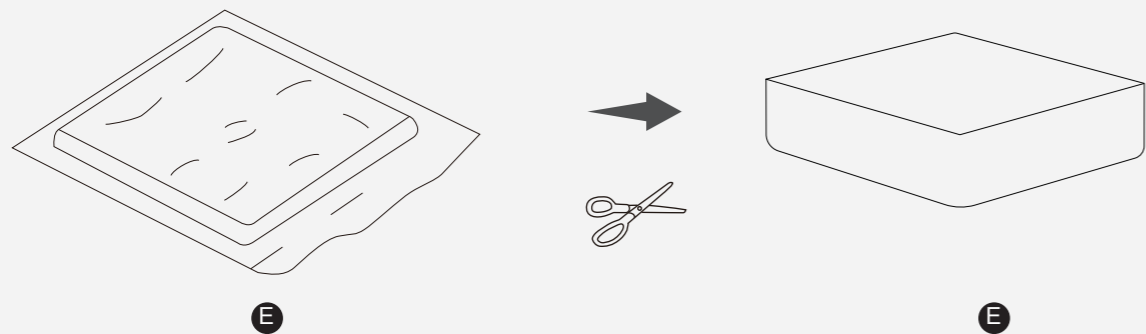

### Step5:

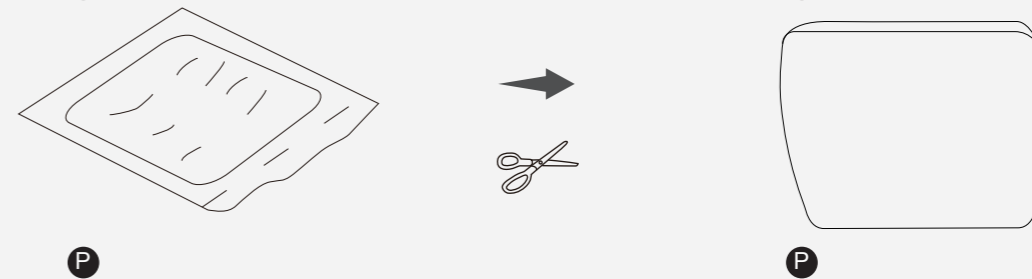
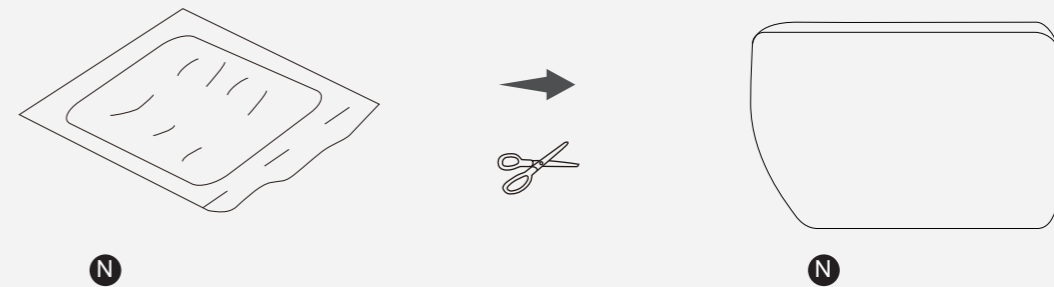
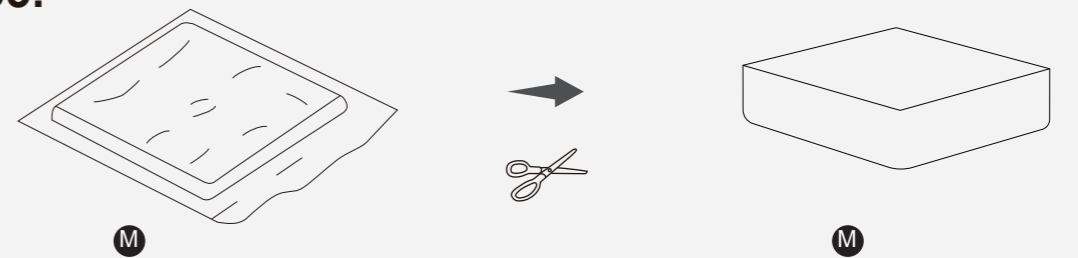

**Step6:**

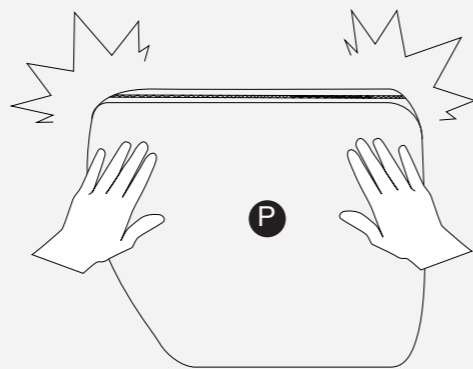
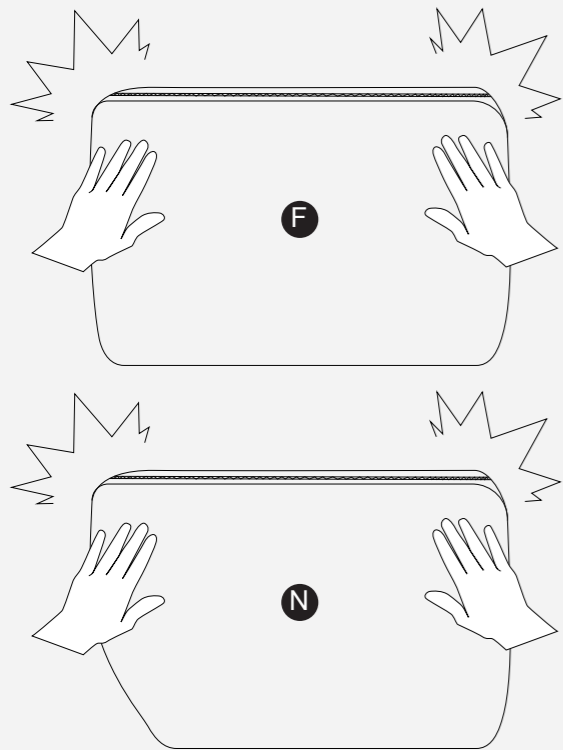

**CARTON (A+B+C+D)**

### Step1:

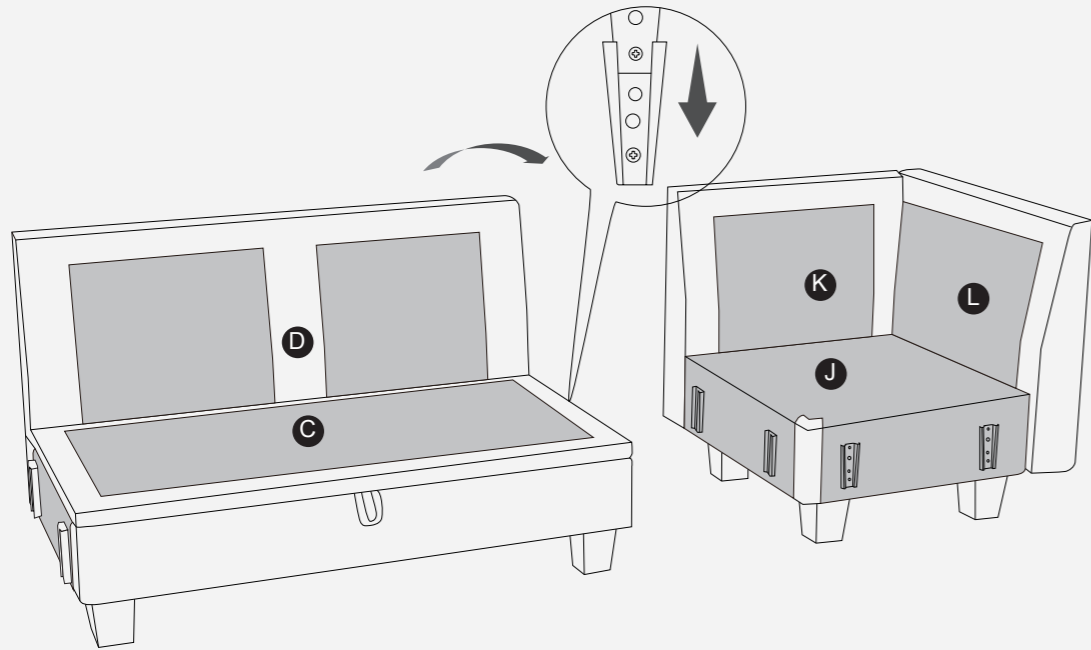

### Step2:

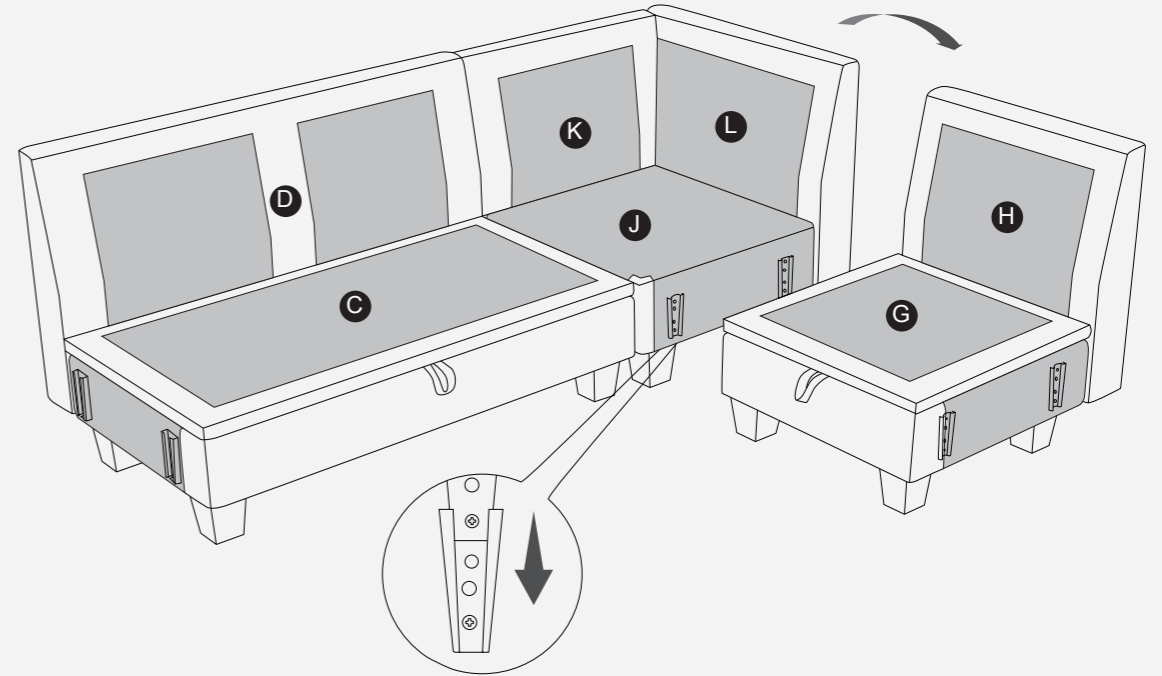

**Step3:** Install **A** to **C** Install **G** to **B**

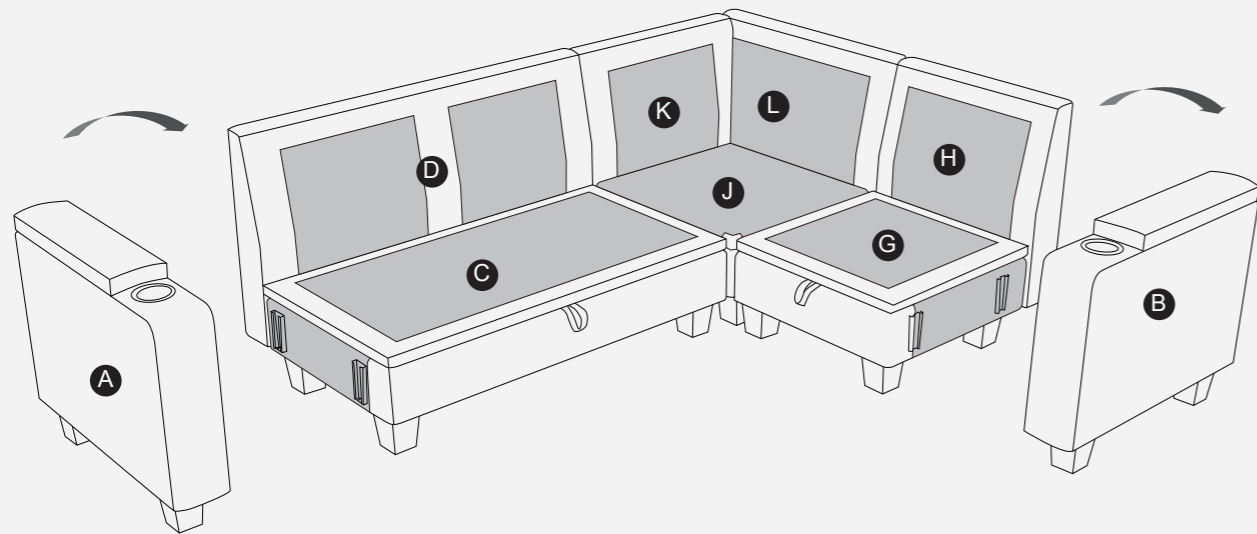

**Step4:**

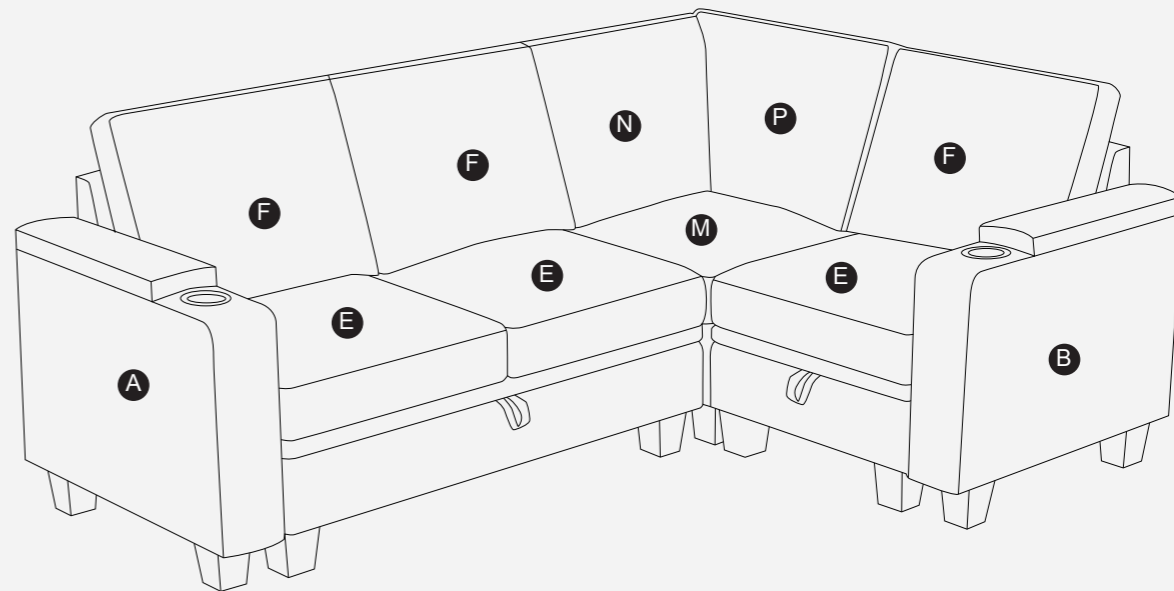

## FREE COMBINATION

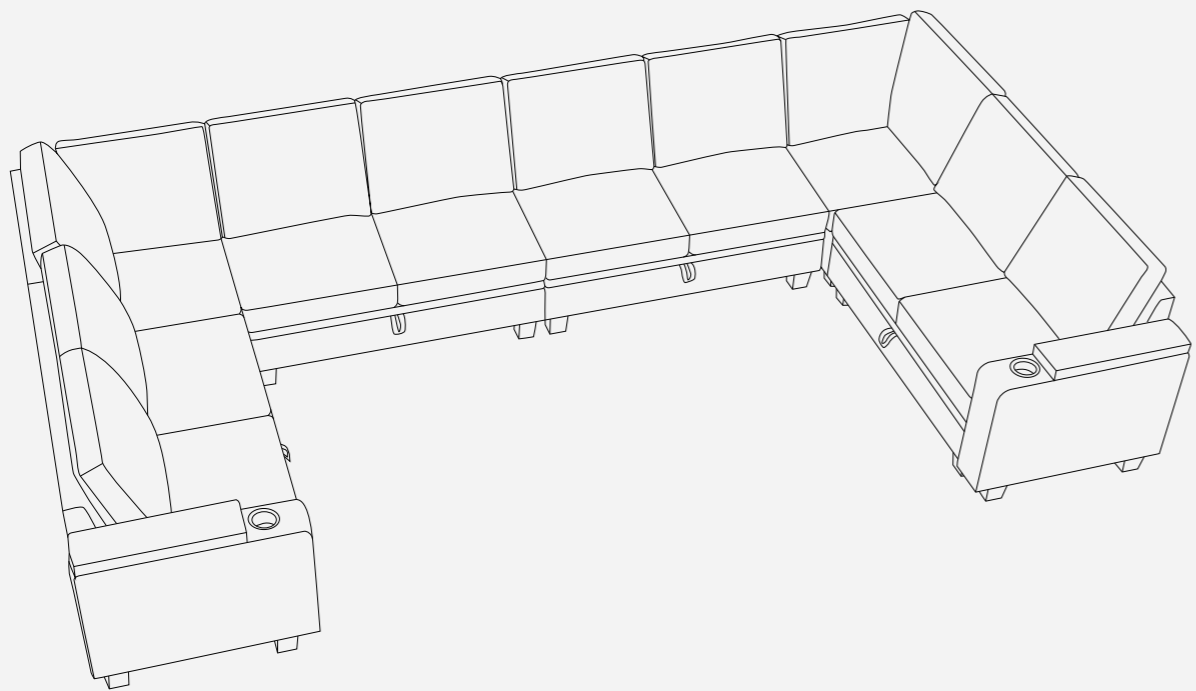

**CARTON (A + 4B + 2D)**

## FREE COMBINATION

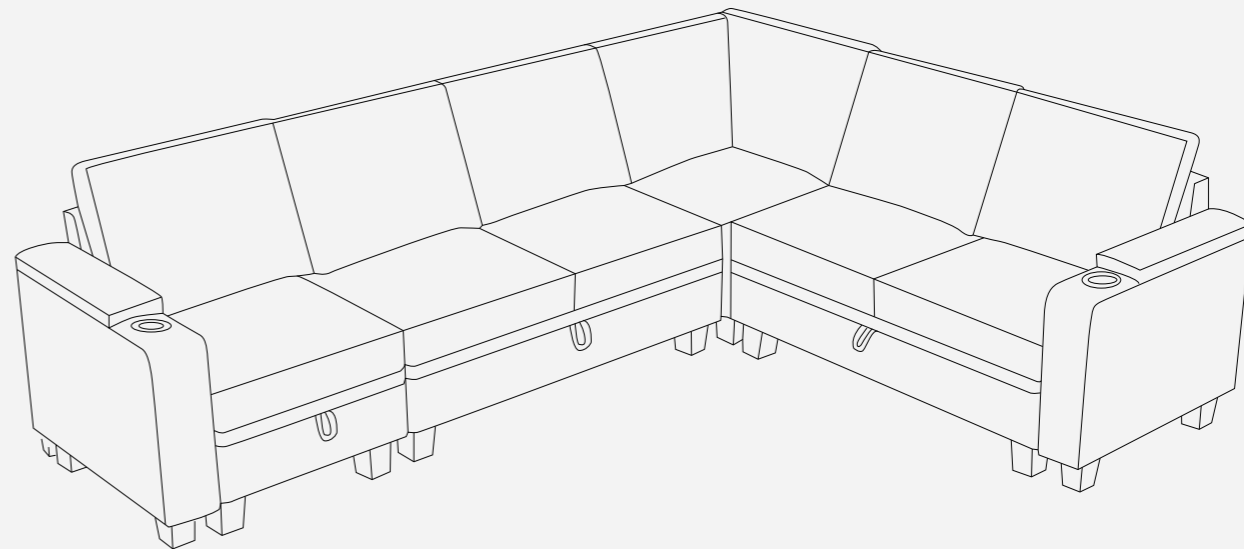

**CARTON (A + 2B + C + D)**