



4pcs x A



4pcs x ②



8pcs x ①

4pcs x ③



Step 1

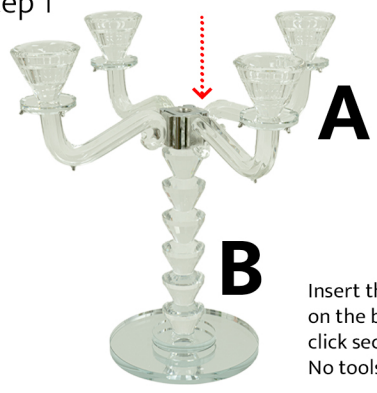

Insert the four arms (A) into the slots on the base (B). Push down until they click securely into place. No tools are required.

Step 2

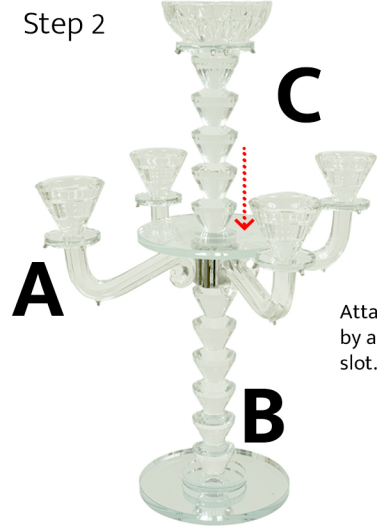

Attach the top piece (C) to the base (B) by aligning the pre-set screw with the slot. Turn gently until fully tightened.

Step 3

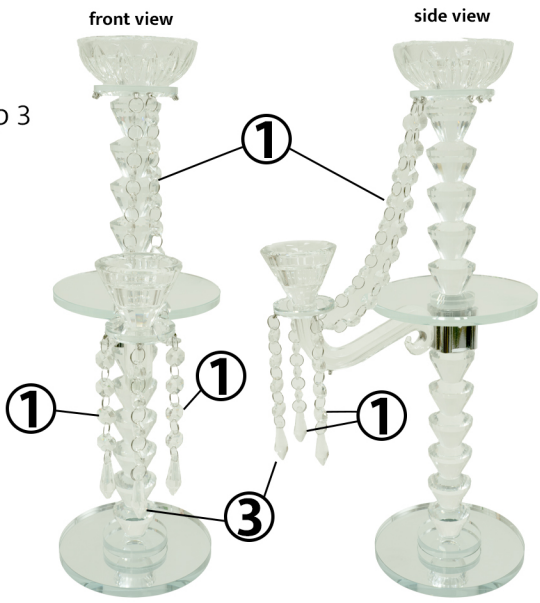

Hook the 8 chains (①) as shown in the diagram: Each chain starts from a metal loop on the top piece (C). Hook the other side (4 beads from the other end) to the side metal loop under each arm (A). Hook the 4 chains (③) to the middle metal loops on the arms (A), as shown in the diagram.

Step 4

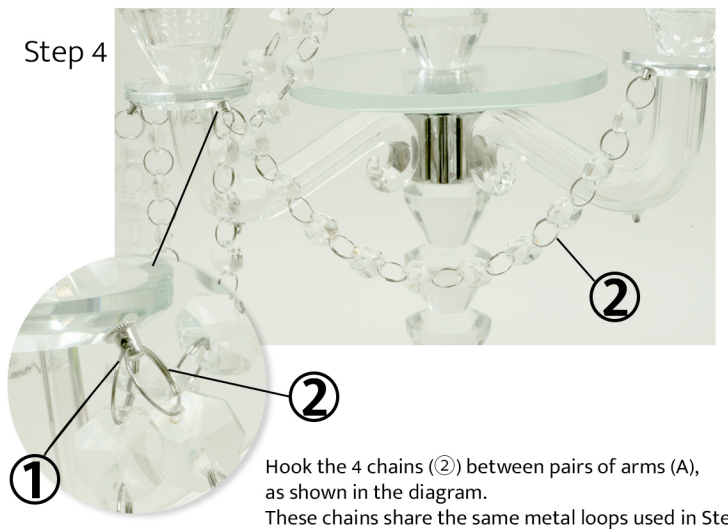

Hook the 4 chains (②) between pairs of arms (A), as shown in the diagram. These chains share the same metal loops used in Step 3.