

Assembly instructions

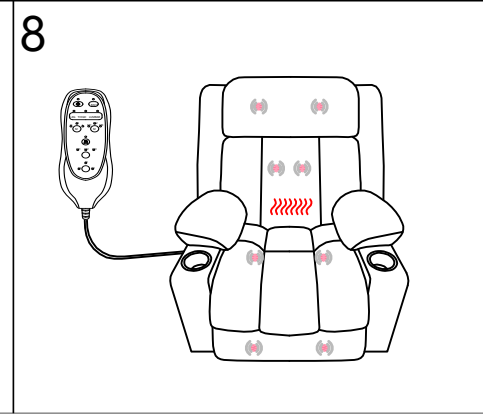
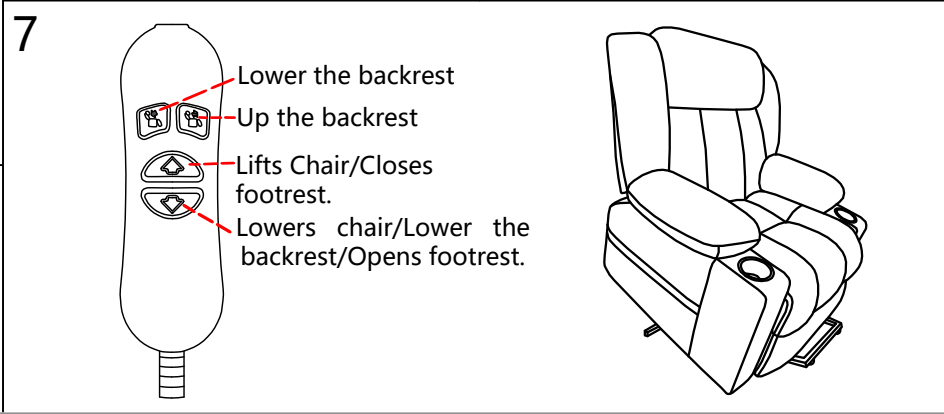
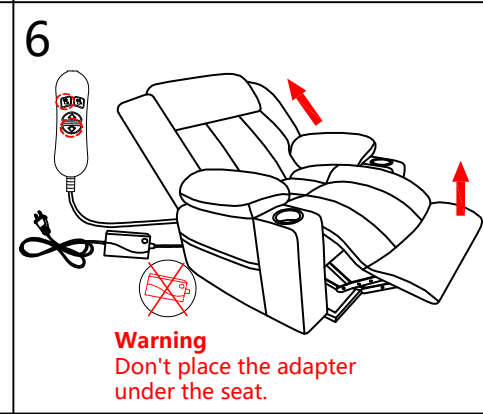
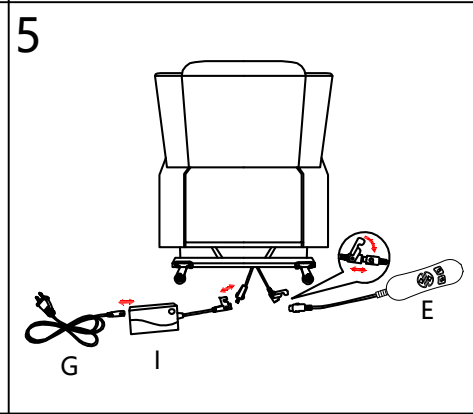
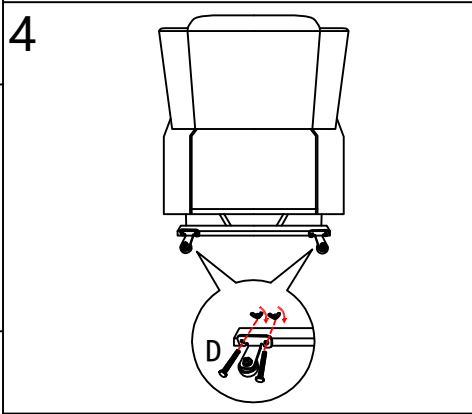
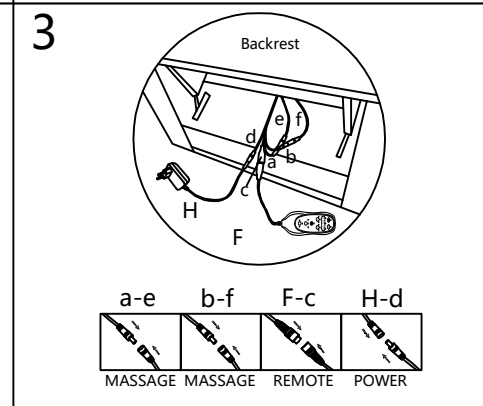
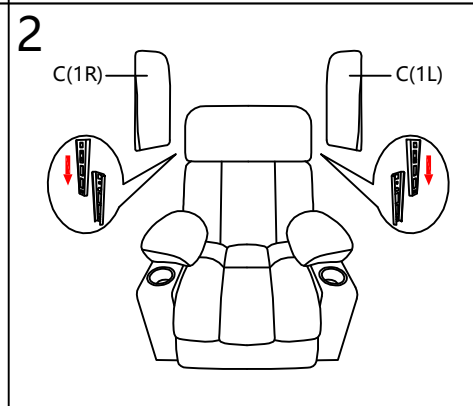
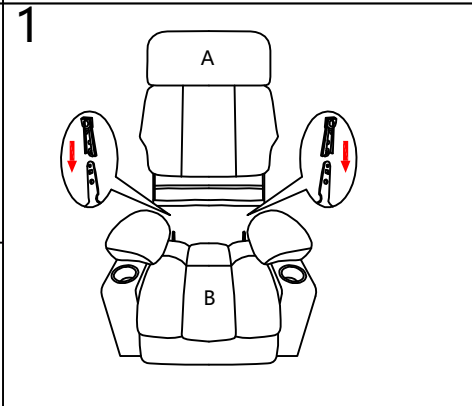
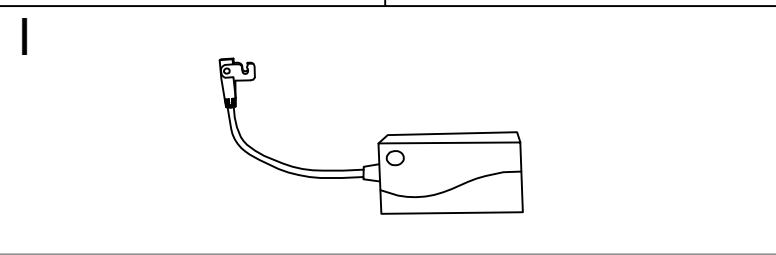
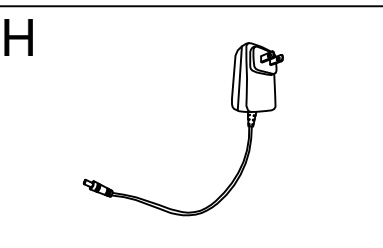
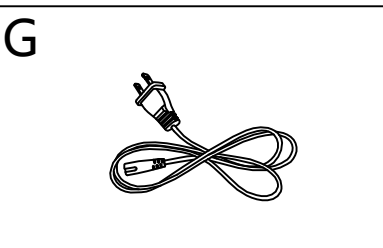
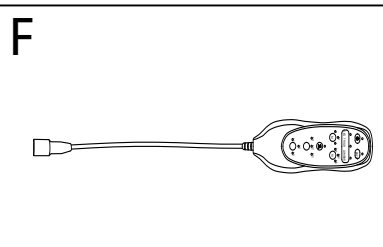
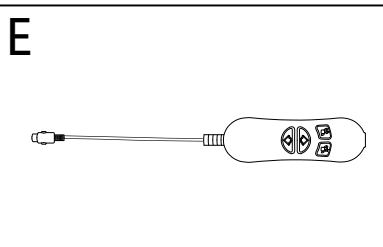
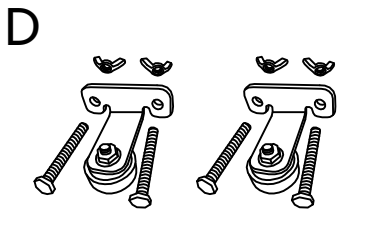
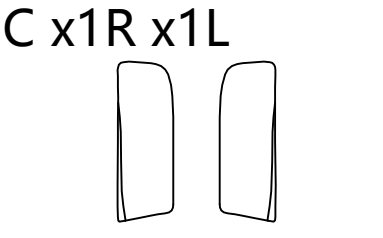
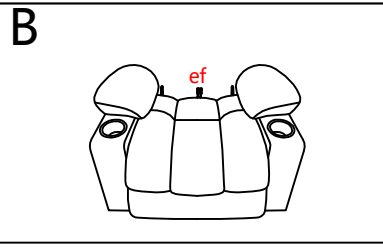
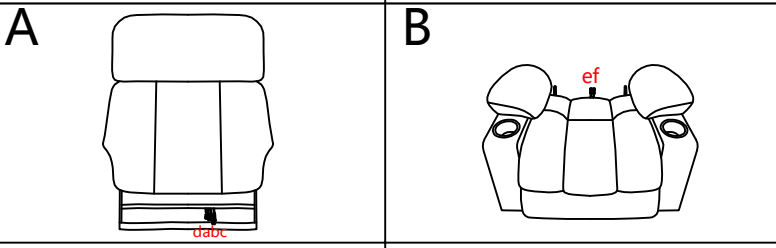

Warning: Never press both buttons together as this will damage your chair. Never stand up while the chair is still working in order to avoiding accident

Voltage parameters:

1. Voltage: AC110-240V DC12V
2. Current: 1A
3. Power: 12W
4. Voltage Grade: Class III
5. Frequency: 50-60Hz

PRODUCT FEATURES

1. Heating massage and temperature three-gear adjustment: M1-M2-M3
2. Eight vibration motors
3. Three massage modes
4. Three massage intensities
5. Four massage zones, each zone can be operated individually
6. The default timing is 15, 30 and 60 minutes

HOW TO USE

1. Insert the adapter jack into the socket on the back of the massage chair, then plug the adapter into a wall outlet.
 2. Turn the unit on by pressing the 'POWER' button once – the LED will illuminate when powered on.
 3. Turn on the massage for the zone you desire by pressing the 'BACK', 'LUMBAR', 'THIGH' or 'LEG' button. LED will illuminate the zone activated. To turn off a zone, press the button again.
 4. To choose a massage mode, press the 'MODE' button.
To change modes, press the 'MODE' button until the LED for the desired mode illuminates.
PULSE: For deep tapping massage
PRESS: Provides rapid tapping massage
WAVE: For a gradual, side-to-side vibrating massage
 5. Press the 'INTENSITY' button to change the massage intensity.
The HIGH or LOW LED will illuminate for the intensity chosen.
- NOTE: Stop using immediately if you feel any discomfort or pain.
6. The massage chair includes an auto shut-off feature.
 7. Do not use this chair continuously for more than 60 minutes.

