

# IMPORTANT OPERATIONAL FEATURES TO ENSURE A LONG LIFE FOR YOUR NEW SOFA SLEEPER.

## To Assemble

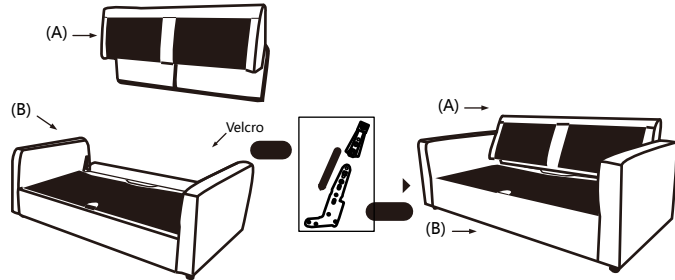

With assistance from your adult partner, hold up the Backrest(A), while standing behind the Sofa Bed.  
Insert the small metal arms on the sides of the Backrest(A) into the prefabricated slide lock gadget on the Base(B) as shown above.  
Firmly but gently, push the Backrest(A) downwards until the Backrest is fully slotted and locked into position.

## To Open

NOTE: Before opening remove all shipping and tie down materials.

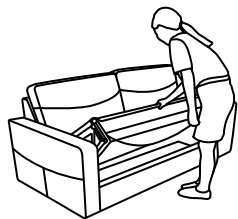

### Step 01

Grab the sleeper at the handle cut-out section and lift the unit up and out of the sofa to the first folded position.

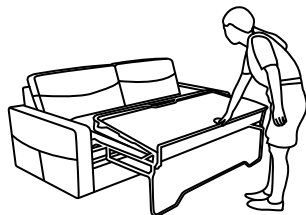

### Step 02

Lift up on the front leg tube until it rests on the floor and the bed is fully open.

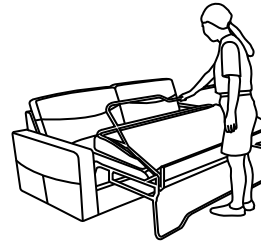

## To Close

Reverse steps 1 and 2 .Be sure the front leg tube closes completely against the folded bed.

This locks the bed securely in the closed.



## Position

Note: Disengage TV headrest before closing.



## TV Headrest Operation

To raise: Grab head tube only. Lift firmly on tube, then release.

To lower: Repeat raising procedure.

Your new sleeper mechanism is designed to provide years of reliable service.

To help your sleeper last as long as possible,

Please note these suggestions:



Don't sit on the end of bed.



Don't fold with liner or pillows on the mattress.



Don't jump on bed.