

Pull the kitchen pot faucet

Installation instruction

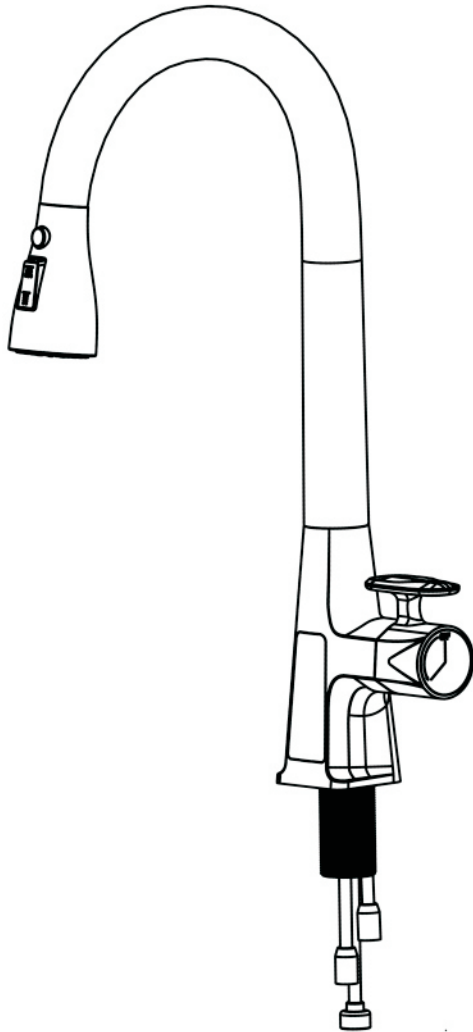

**Please specify the color number when ordering

Pull the kitchen pot faucet

Before installation

All information is based on the latest published product information. The Company reserves the right to change product characteristics, packaging or the types of products available at any time without notice.

The manual contains important installation, maintenance and cleaning information, please give these information to the user to read.

Note:

1. Be sure to rinse the water supply pipe thoroughly first to remove impurities in the pipe.
2. Shower working pressure :0.1MPa to 0.5MPa. When the water pressure exceeds 0.5 mpa, a reducing valve must be installed. Shower maximum operating temperature and ambient temperature: 60 °C. Please pay special attention to the arm tube connected to the shower head away from the heater, otherwise it may damage the shower head and its seal, and even cause injury to the user.

Instructions for use

Hand wheel switch, downward rotation of fixed temperature out of cold water, mixed water, hot water;

Turn up to turn off the water main switch(Induction hand wheel see use guide)

Installation dimensions

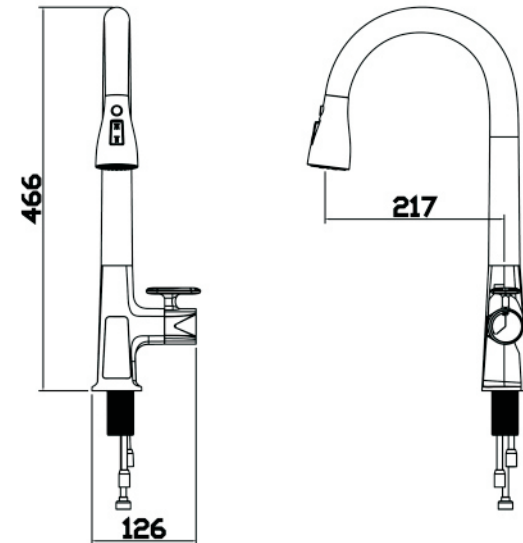

Installation steps

Skill in use

1. Insert the main body of the faucet into the water slot hole in the direction indicated by the arrow.

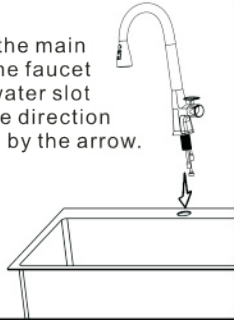

2. Screw the screw (1) into the mounting ring (2) until the screw is 6mm above the mounting ring.

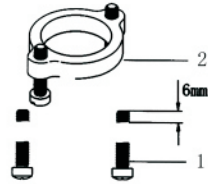

3. Install the gasket (3) on the tooth (4) and screw the mounting ring to the tooth tube.

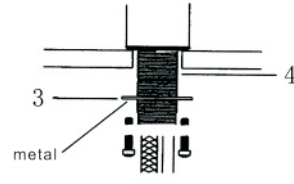

Hand wheel switch, turn left fixed temperature cold water, mixed water, hot water: turn right to close the water main switch.

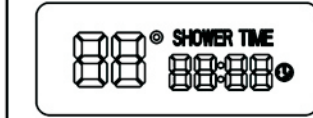

The number on the screen shows the outlet temperature and outlet time.

Pull head free drawing

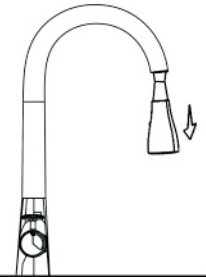

4. Adjust and tighten the screws on the mounting ring.

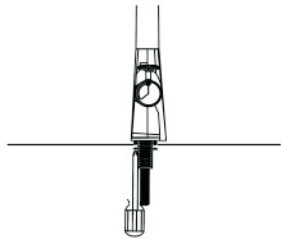

5. Connect and lock the hot and cold pipe (5) to the water source. The cold water is connected to the blue tube, and the hot water is connected to the red tube.

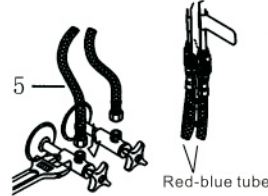

6. Install the hydroelectric power on the main body and lock it tightly.

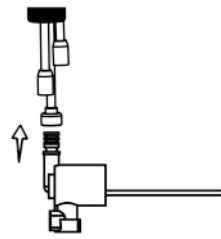

Press to switch shower water

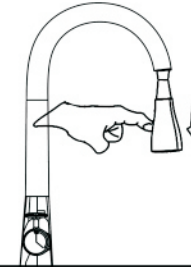

Press to switch bubble water

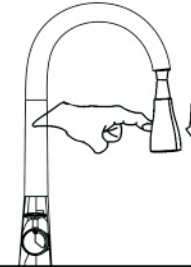

1. Sensing hand wheel, close to the control switch with the hand wheel, this state is mixed water.

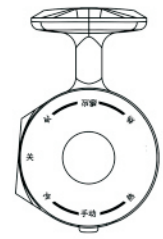

7. Install gravity ball (7) on shower hose (6) without locking gravity ball first.

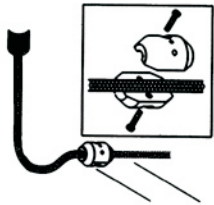

8. Connect shower hose to quick nozzle.

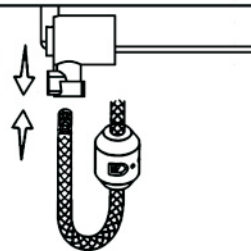

9. As shown in the figure, adjust the gravity ball to the appropriate position and lock it.

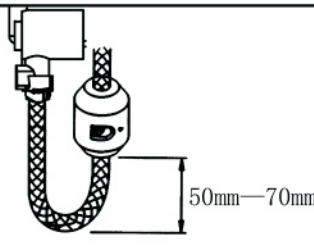

2. The sensor hand wheel rotates to the left to produce mixed water - hot water.

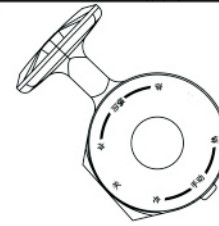

3. Rotate the sensor hand wheel to the right to release the mixed water - cold water.

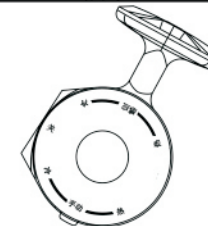

4. The induction handwheel continues to turn to the right to turn the manual switch into water; After manually boiling water, continue to rotate to the right to produce cold water - mixed water - hot water.

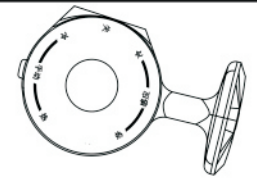

Faucet maintenance:

1. Open the faucet and rub the nozzle to clean up impurities.

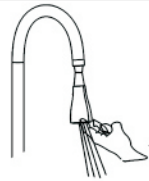

2. When there are impurities that make the water flow small, remove the shower head bubbler, clean the bubbler, and reinstall it.

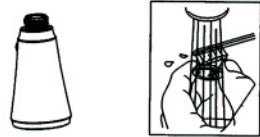

3. When the induction hand wheel has no power, please use the charging bank to charge the induction valve core.

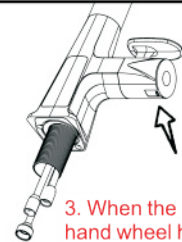

Complete installation check

Check and ensure that all joints are tight and that the handwheel is in the closed position. Open the main water source and drainage system, check and repair leaky interfaces.

Cleaning instructions

Suitable for all processed surfaces: Clean the coated surface with neutral soapy water and dry the entire surface thoroughly with a clean soft cloth. Many cleaning agents such as ammonia, detergent powder, toilet cleaner, etc., will cause damage to the surface of the coating, and should not be used. Abrasive cleaning appliances or cleaners should not be used on faucets and accessories.