

Assembly Instructions

Hardware List

6 PCS Machine Bolts(1-1/4")	3 PCS (1-1/4") Flat Head Wood Screws
4 PCS Wood Dowels (ø8x25mm)	6 PCS (3/4") Flat Head Wood Screws
2 PCS Keys For File Drawer Lock	

Parts List

A	PEDESTAL	1 PC	B	SIDE PANEL	1 PC	C	BACKPANEL	1 PC
D	CROSS BAR	1 PC	E	DESK TOP	1 PC	F	DROP FRONT CENTER DRAWER	1 PC
G	STRETCHER	1 PC	<p>Notes: Need two people to assemble.</p> <p>IMPORTANT NOTE: Please keep all hardware parts out of the reach of children.</p>					

Instructions:

1. Move the pedestal (A) and side panel (B) to the desired location.
2. Align the back panel (C) and stretcher (G) to pedestal (A) and side panel (B), insert and tighten (1-1/4") **Machine Bolts** (6PCS).
3. Using a mallet, carefully insert center cross bar (D) to the pedestal (A) and side panel (B), tighten (1-1/4") **flat head wood screws**(2 PCS).

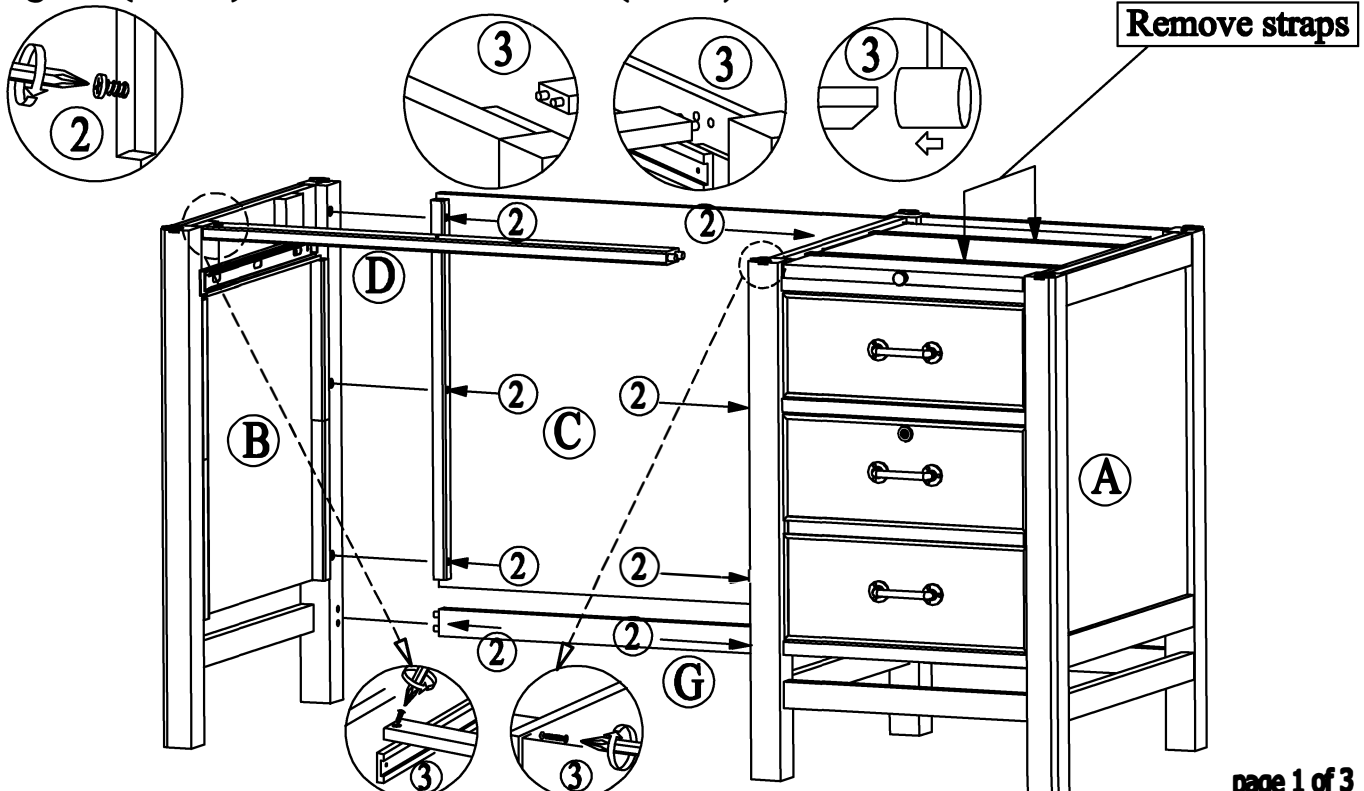

Assembly Instructions

4. Insert wood dowels (4 PCS) two in pedestal (A) and two in side panel (B).
5. Loosen the screw to adjust metal figure 8 (6 PCS) of its direction of the panel and re-screw.

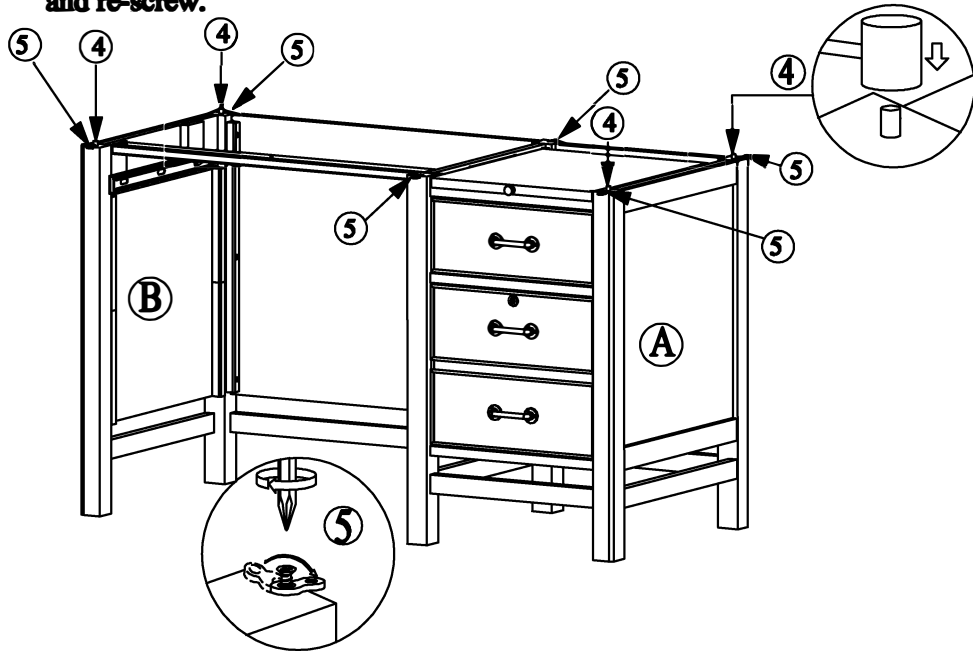

6. Insert (3/4") flat head wood screws (6 PCS) through metal figure 8 to connect desk top (E) to pedestal (A) and side panel (B). Use (1-1/4") flat head wood screws (1 PC) to connect cross bar (D) to desk top (E).

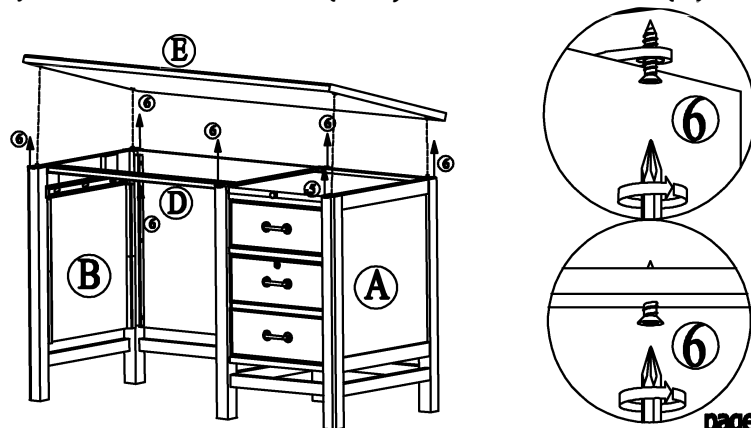

page 2 of 3

Assembly Instructions

7. Install the Drop Front center Drawer (F) to place.

Important:

(Be sure to move the ball bearing retainer all the way to the front of the glide and carefully slide the rails into the glides and ball bearing retainer.)

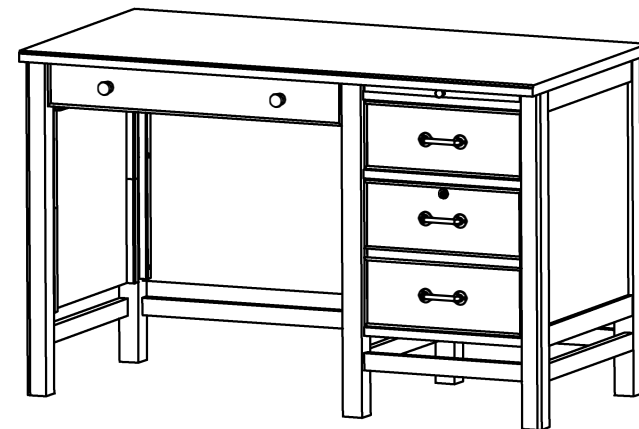
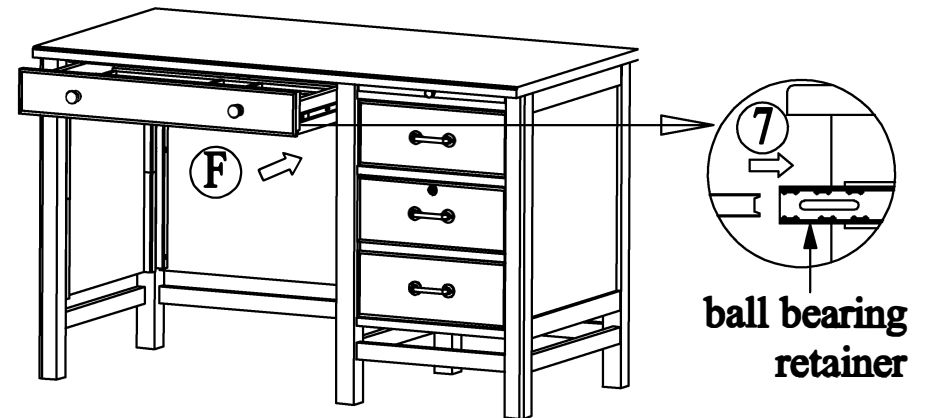

Assembly is now complete.

page 3 of 3