



ELISE W/ MIRROR

CLOSET

PLEASE READ

Thank you for purchasing this quality product.
A list of **PARTS** and **INSTRUCTIONS** are included to assist you.
Unpack and identify all parts included on the **PARTS LIST** and **HARDWARE LIST**.

Please retain all packaging until you are sure no parts and hardware are missing, then once you are satisfied with the product please dispose of all packaging responsibly.

If you require any additional information or help on assembly, please contact us at sales@garagetechusa.com

To expedite service, please indicate the model number and part number (letter code) of the part(s) needed.

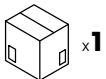
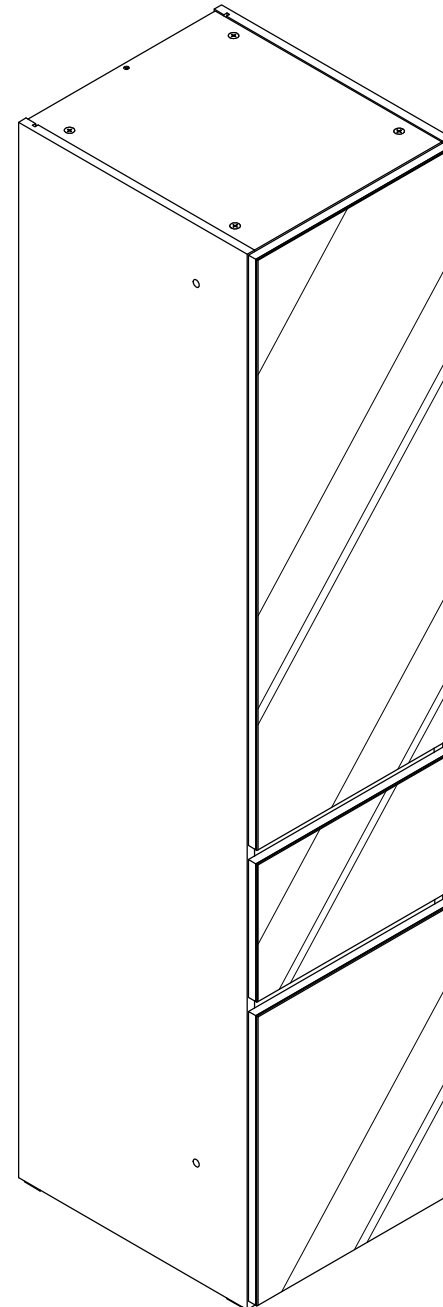

60 minutes
2 Persons Assembly

Additional tools required:

Cross point screwdriver

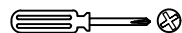

IMPORTANT! READ CAREFULLY AND RETAIN FOR FUTURE REFERENCE

Due to small parts keep children clear during assembly.

Ensure all fittings are fully tightened before use and checked regularly and re-tightened as necessary.

When positioning your furniture ensure the ground is firm, level and dry.

Do not position your furniture in direct sunlight or close to a source of heat.

Take care when handling or moving furniture, always lift with assistance to avoid damaging your product.

WARNING!

Serious or fatal crushing injuries can occur from furniture tipping over.

To help prevent this please observe the following:

Do not let children climb or hang on the drawers, doors or shelves.

Place heaviest items in the lower drawers or shelves.

Do not place heavy objects on top of this product unless it has been specifically designed to support them.

Never open more than one drawer at a time.

If you require any additional information or help on assembly, please contact us at **sales@garagetechusa.com**

PARTS LIST

- M1.** Left side 1pc
- M2.** Right side 1pc
- M3.** Top 1pc
- M4.** Bottom 1pc
- M5.** Fixed shelf 1pc
- M6.** Upper stretcher 1pc
- M7.** Lower stretcher 1pc
- M8.** Back stretcher 1pc
- M9.** Adjustable shelf 3pcs
- M10.** Drawer left side 1pc
- M11.** Drawer right side 1pc
- M12.** Drawer back 1pc
- M13.** Drawer bottom 1pc
- M14.** Back panel 1pc
- M15.** Upper door 1pc
- M16.** Drawer front 1pc
- M17.** Lower door 1pc

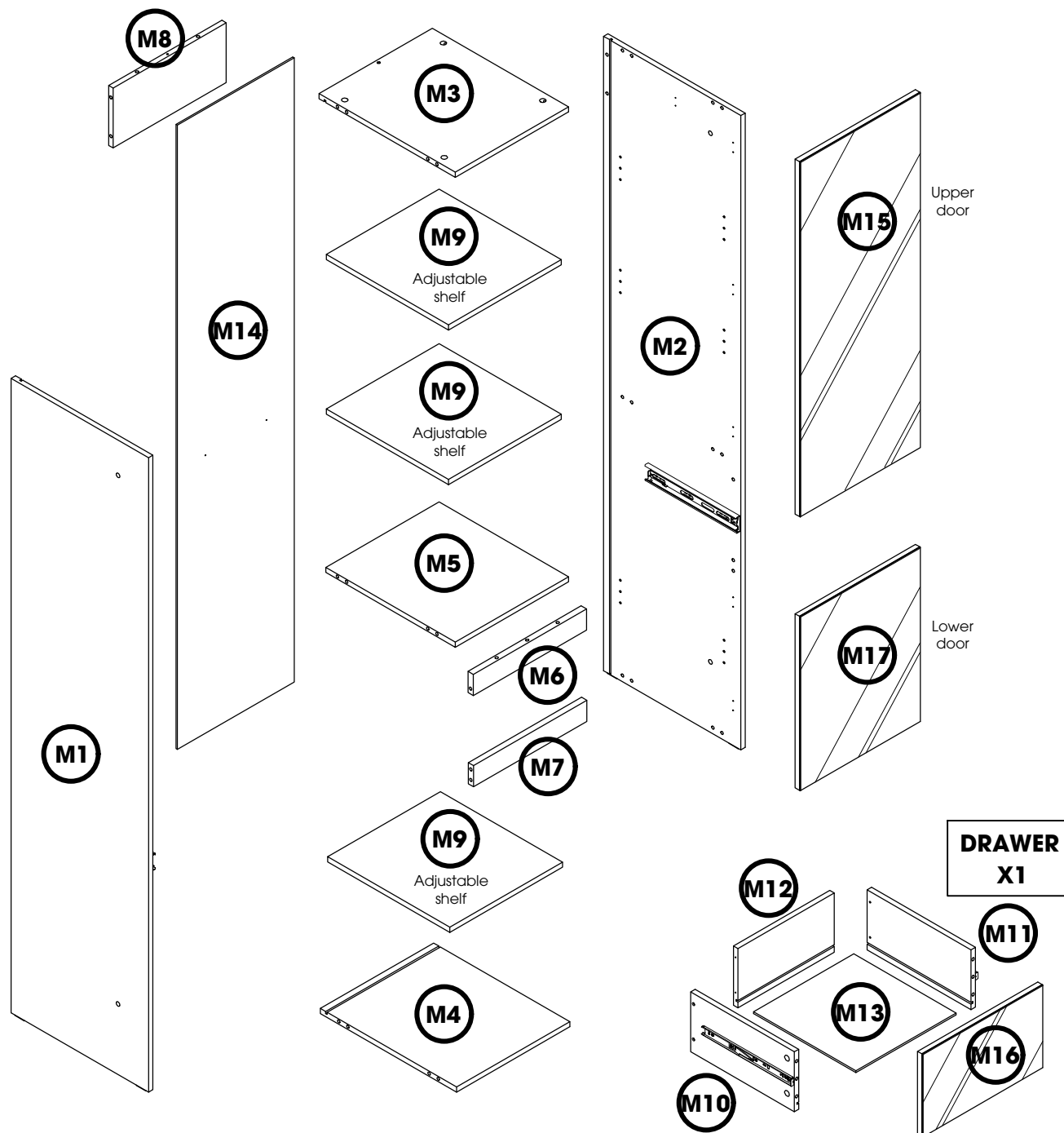

HARDWARE LIST

- 1.** Wood dowel 8 x 30 22pcs
- 2.** Spreading bolt 23pcs
- 3.** Housing 15T 23pcs
- 4.** Hinge 5set
- 5.** Sleeve nut M6 x 25 2pcs
- 6.** Bolt M6 x 20 2pcs
- 7.** Shelf Support 12pcs
- 8.** Hole cover sticker 4pcs
- 9.** Pan head screw M3 x 16 2pcs
- 10.** Flat head screw M4 x 30 4pcs
- 11.** Flat head screw M2.7 x 16 9pcs
- 12.** Plastic support 9pcs
- 13.** Confirmat screw M5 x 40 1pc
- 14.** Flat head screw M3.5 x 15 4pcs
- 15.** Hanger holder A 2pcs
- 16.** Hanger holder B 2pcs
- 17.** Hanger 1pc
- 18.** Anti-Tip Restraint 1set

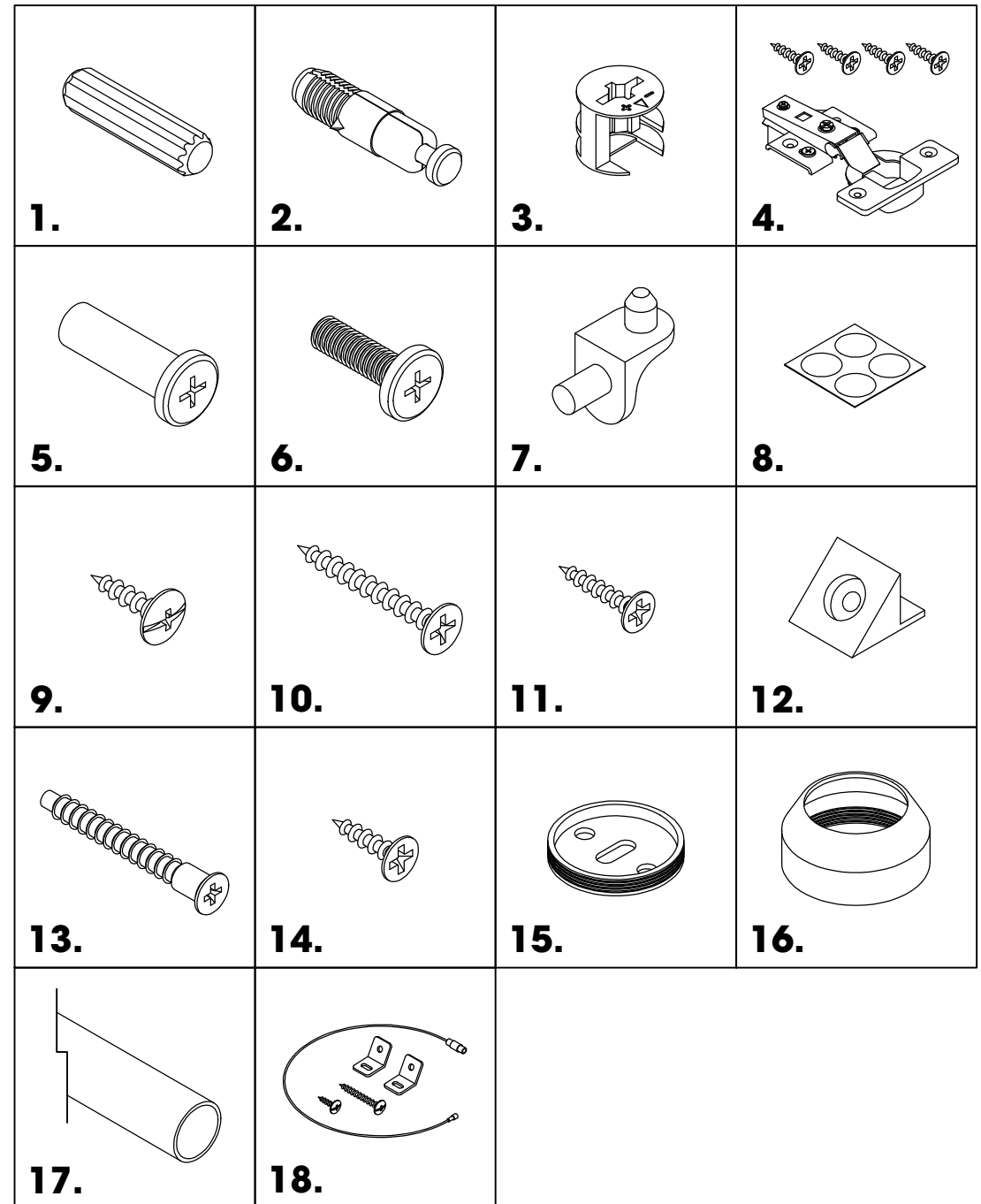

How to use the **SPREADING BOLT** and **HOUSING**

1.

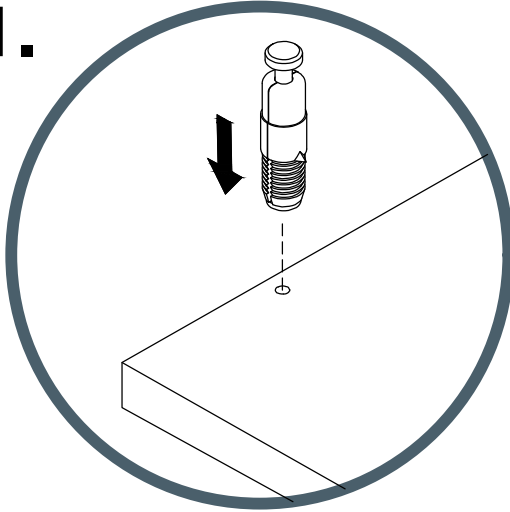

2.

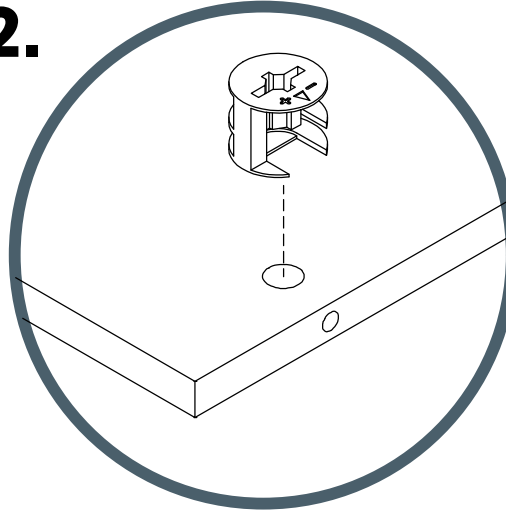

3.

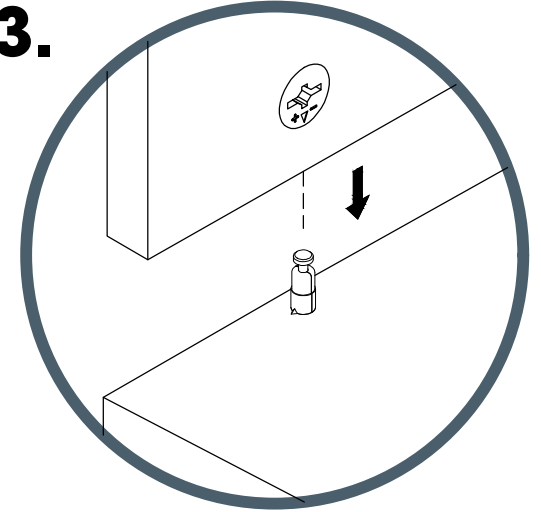

4.

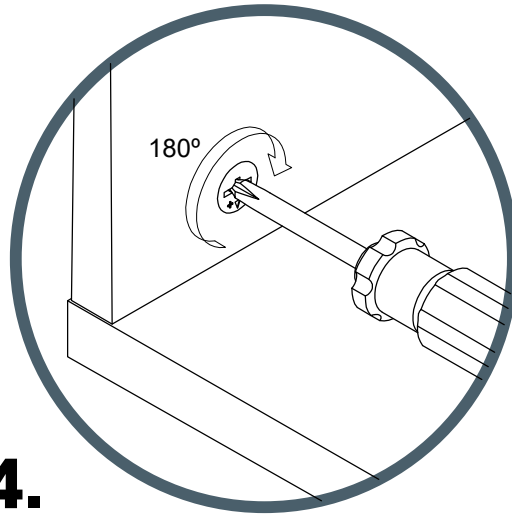

5.

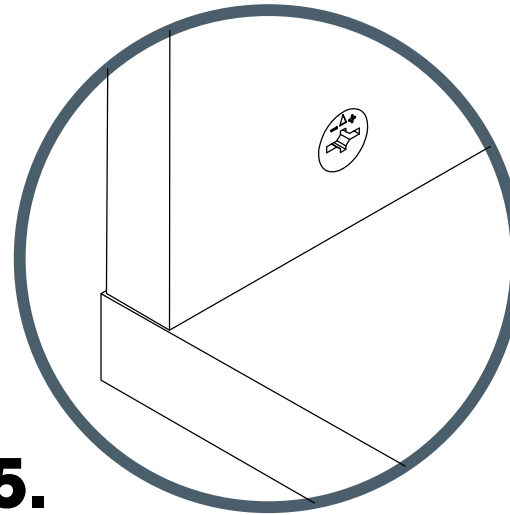

STEP 1

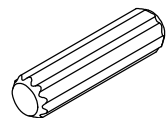

1 Wood dowel
8 x 30

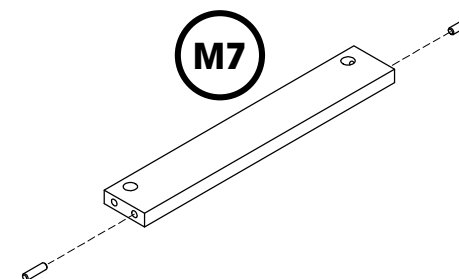
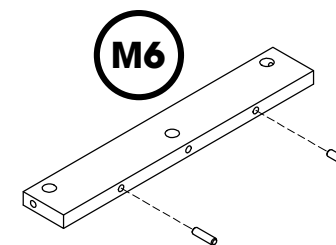
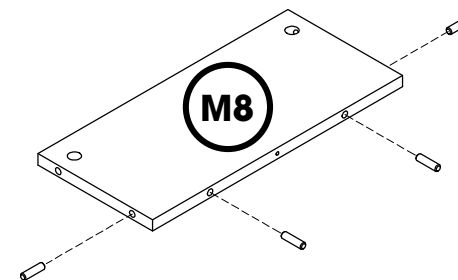
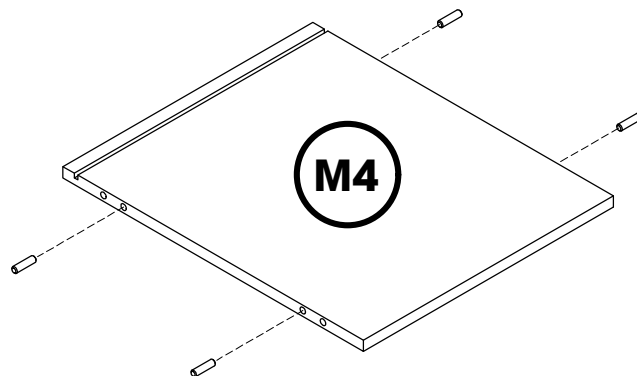
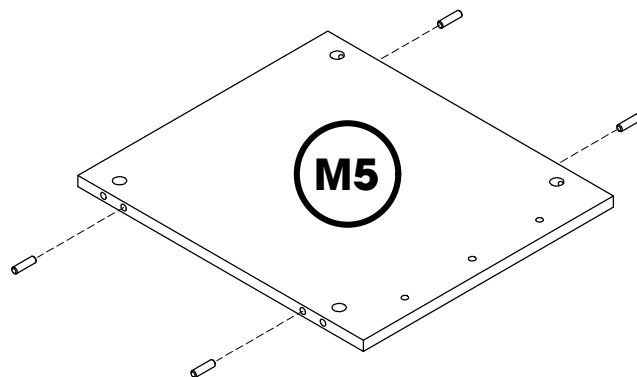
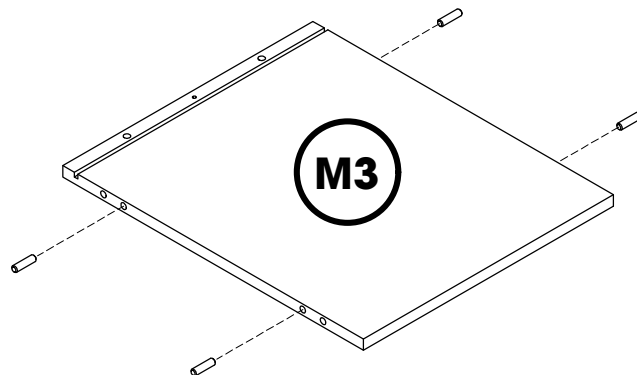
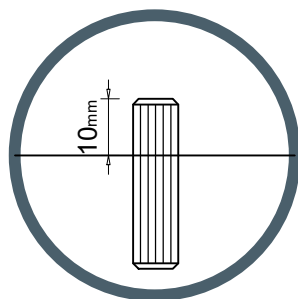

STEP 2

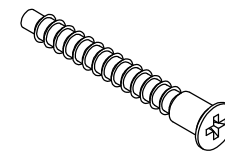
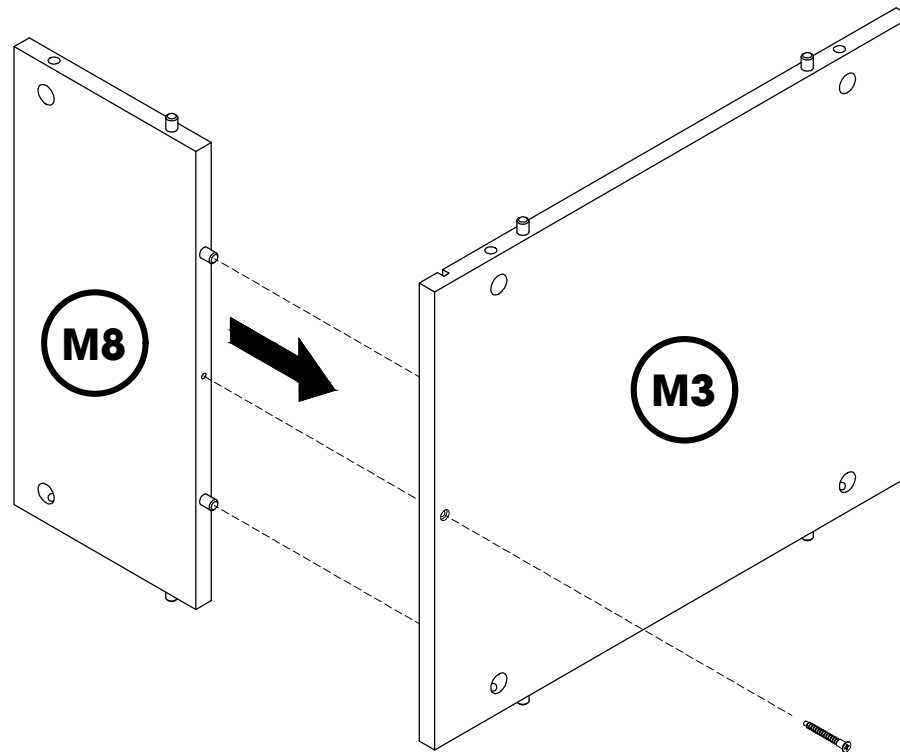

13 Confirmat screw
M5 x 40

STEP 3

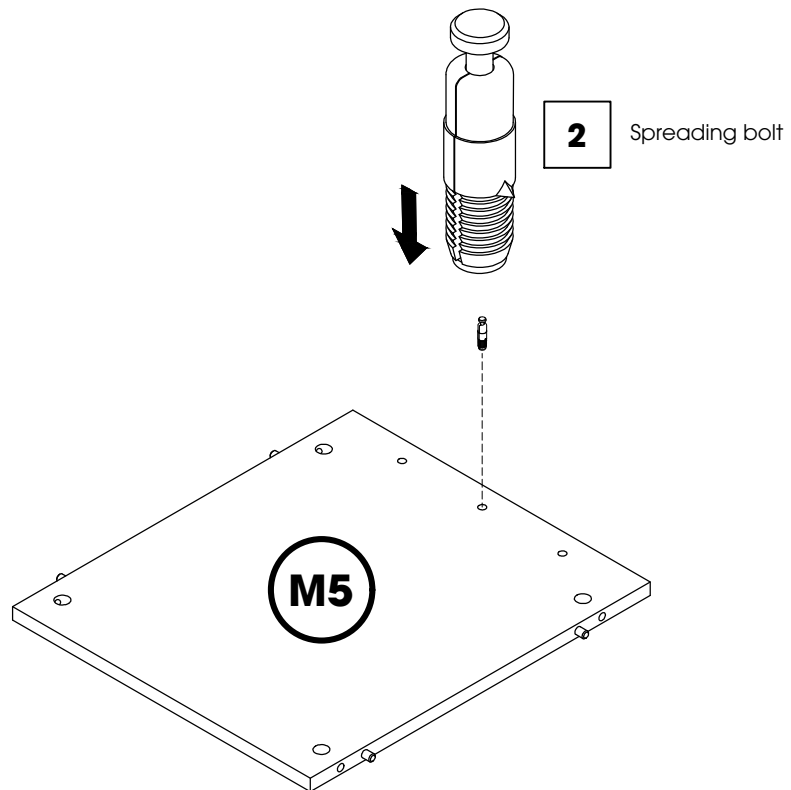

STEP 4

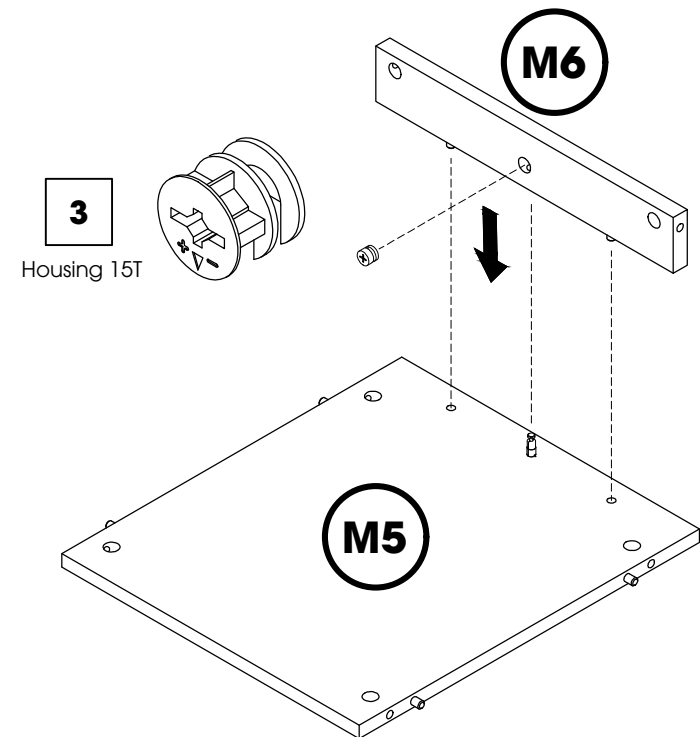

STEP 5

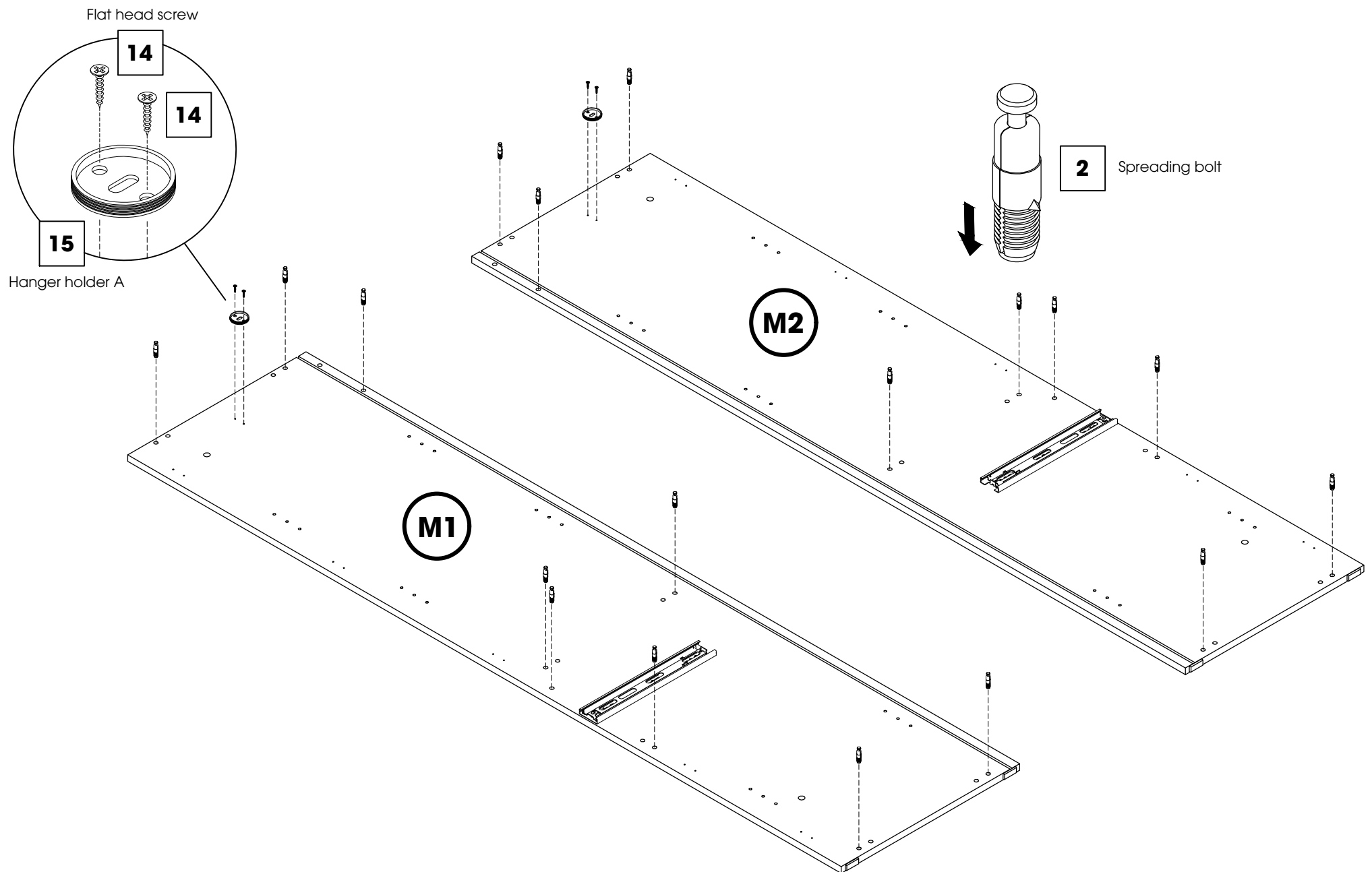

STEP 6

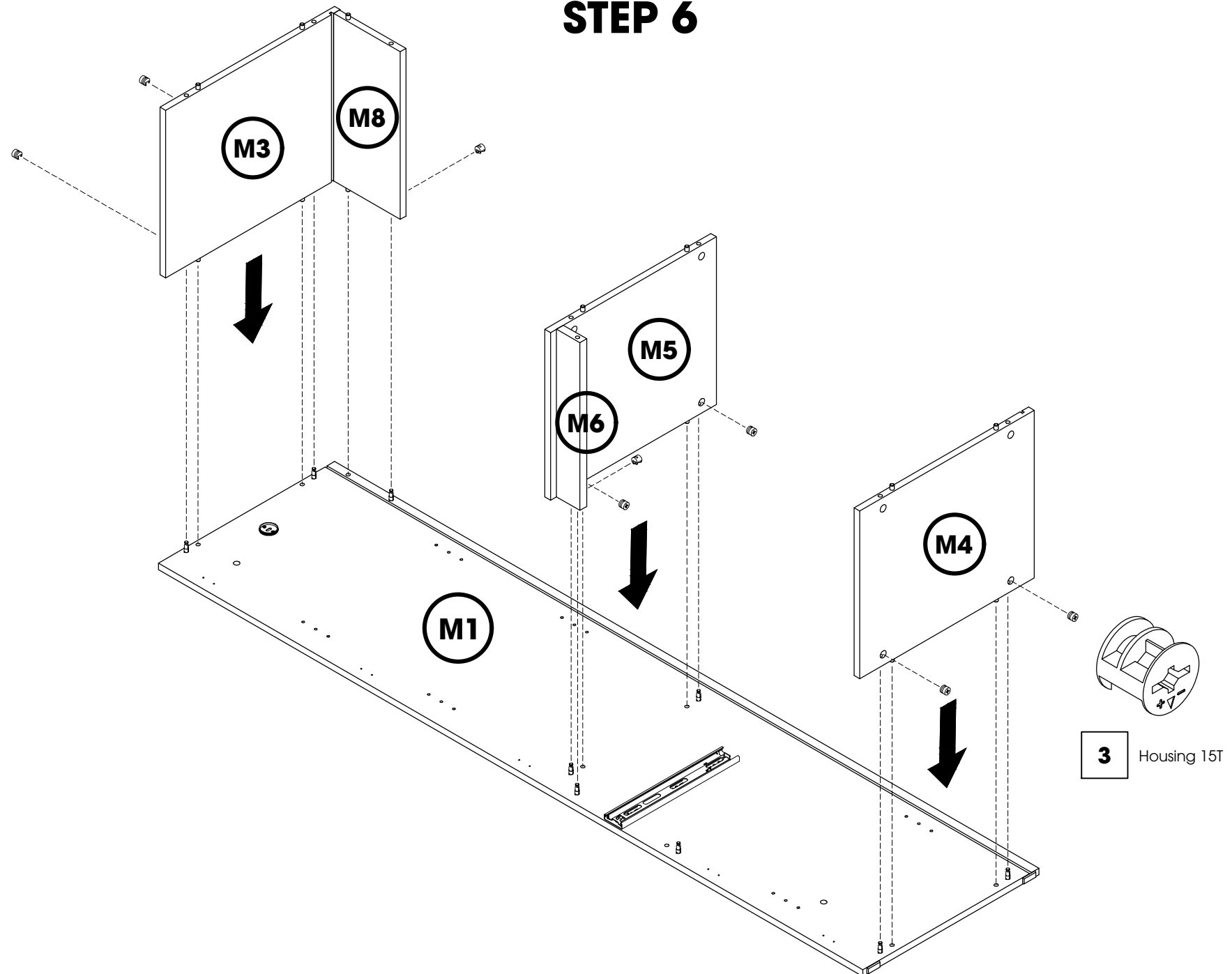

STEP 7

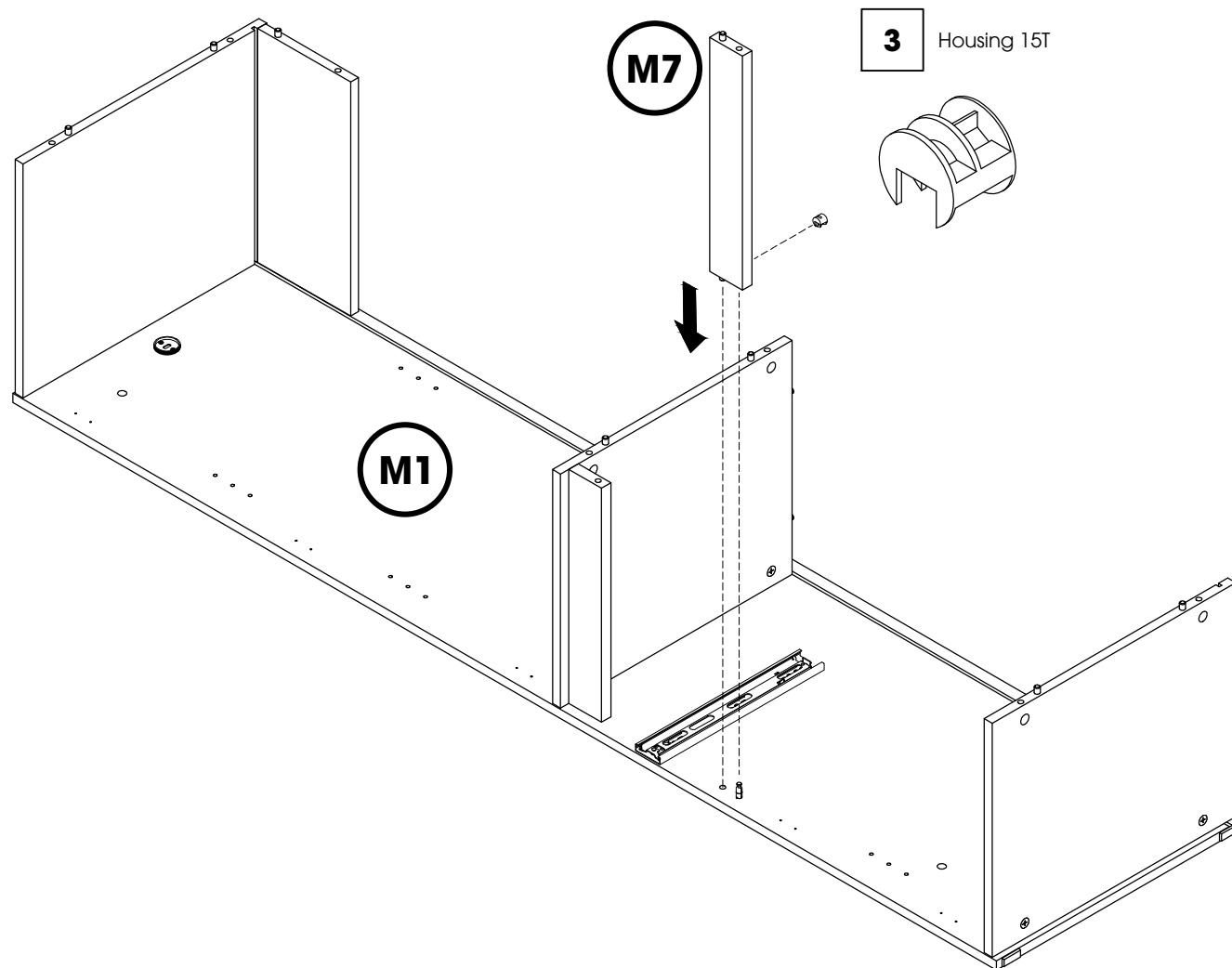

STEP 8

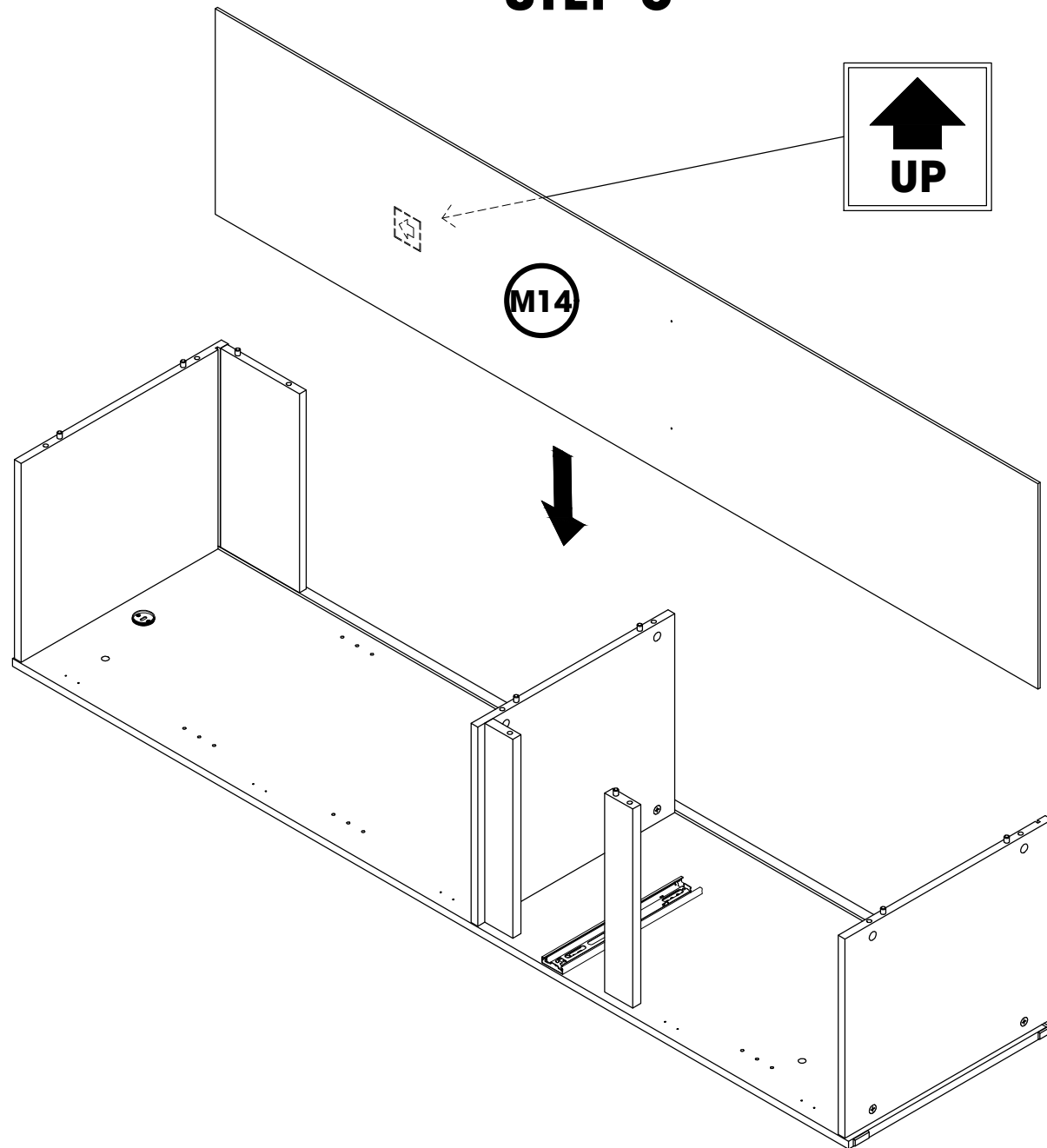

STEP 9

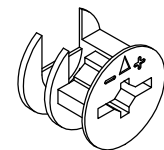
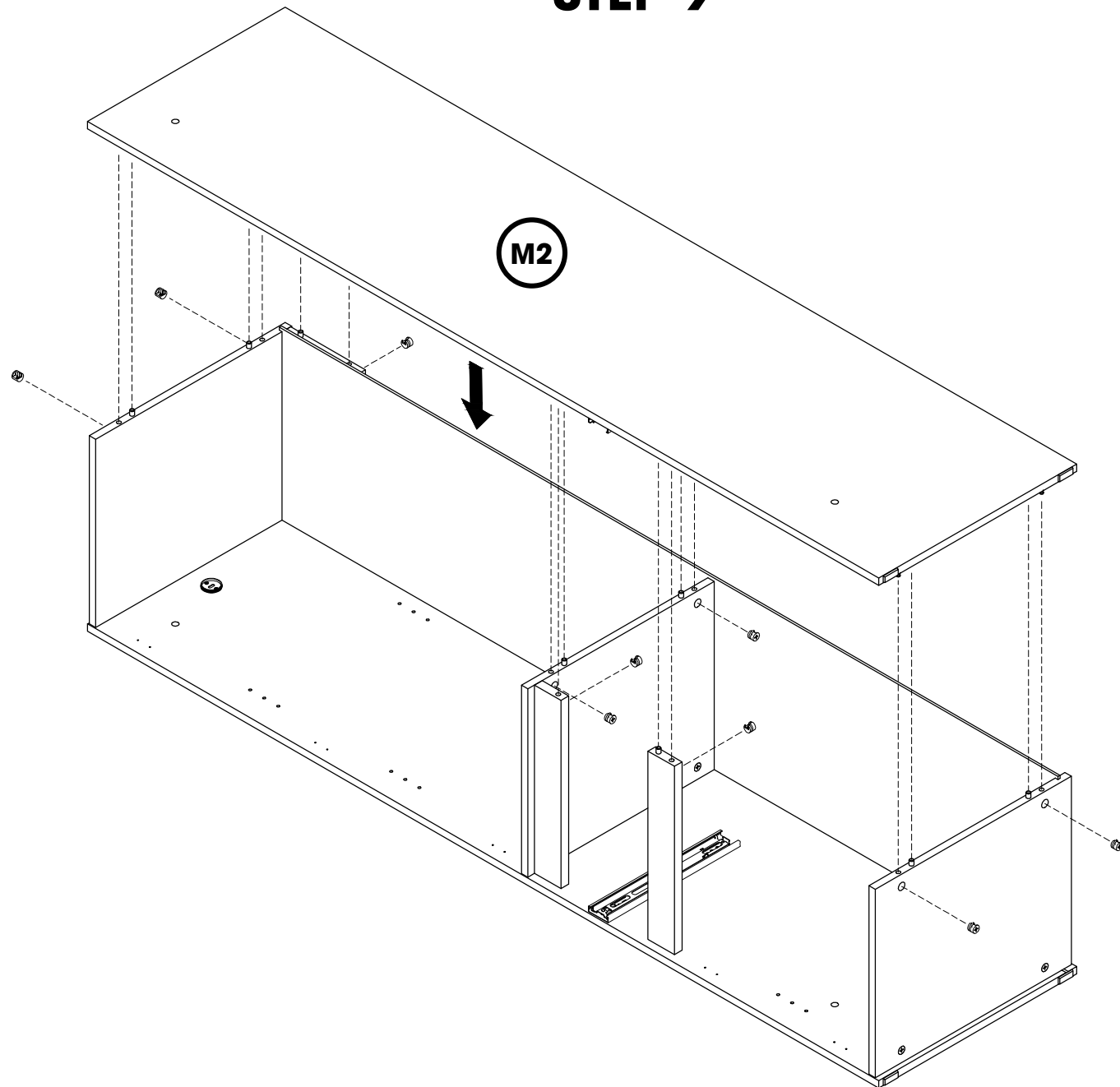

3 Housing 15T

STEP 10

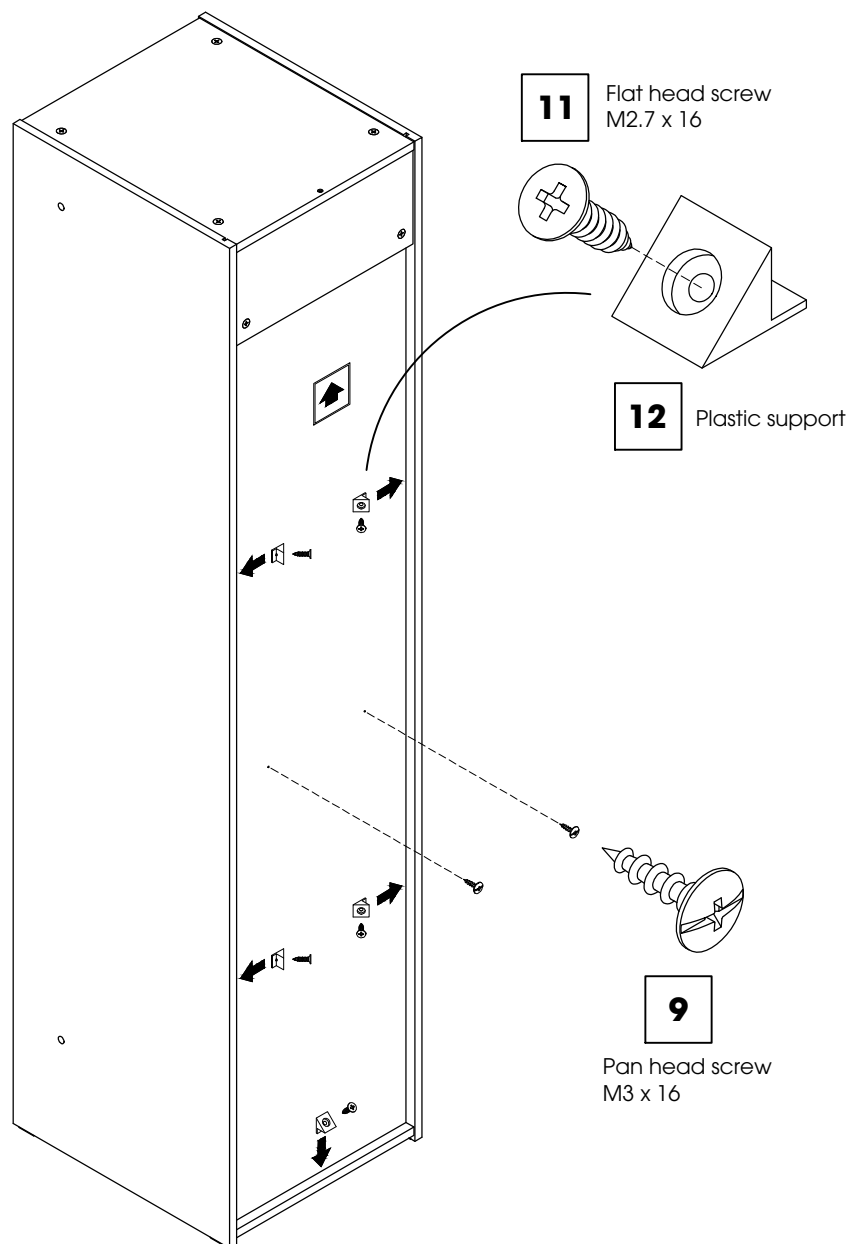

STEP 11

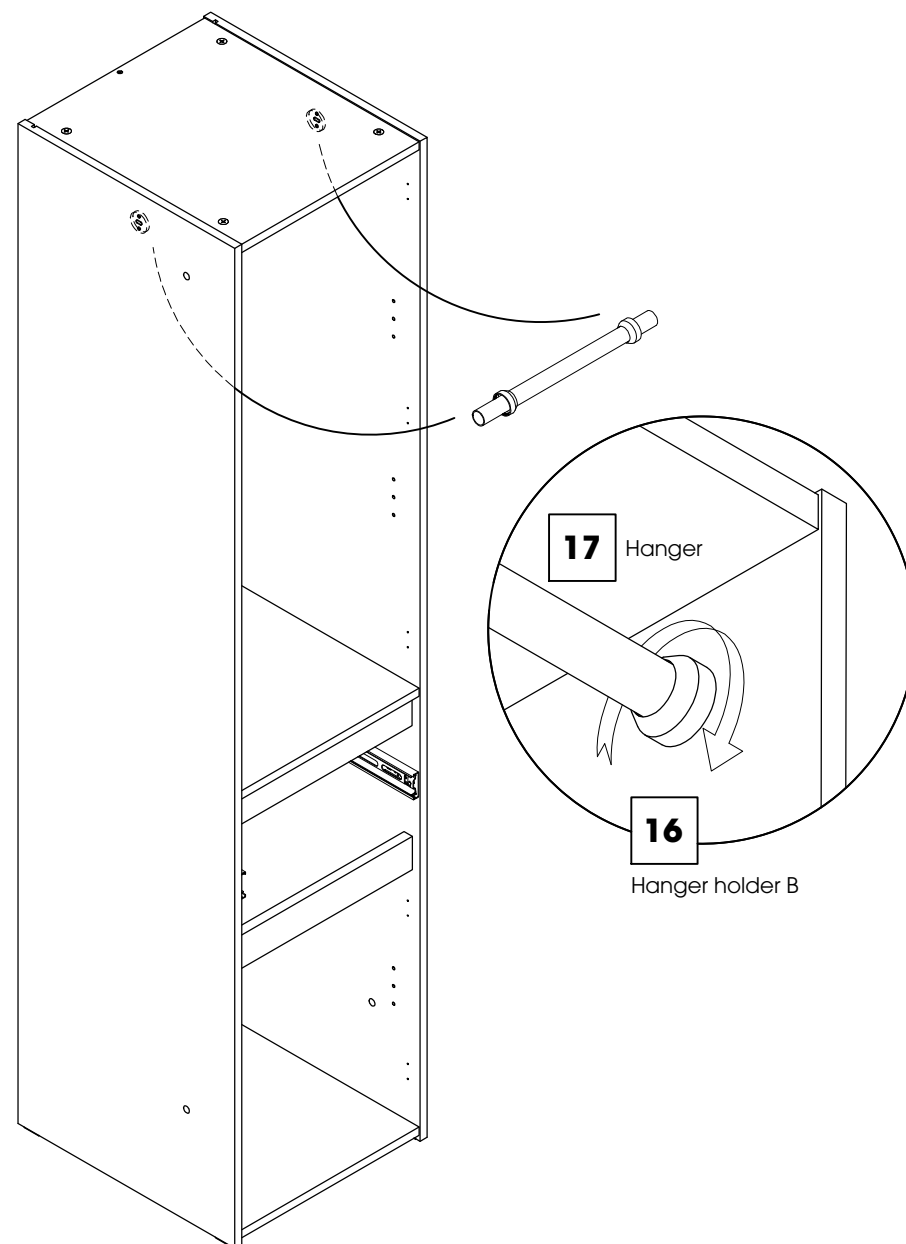

STEP 12

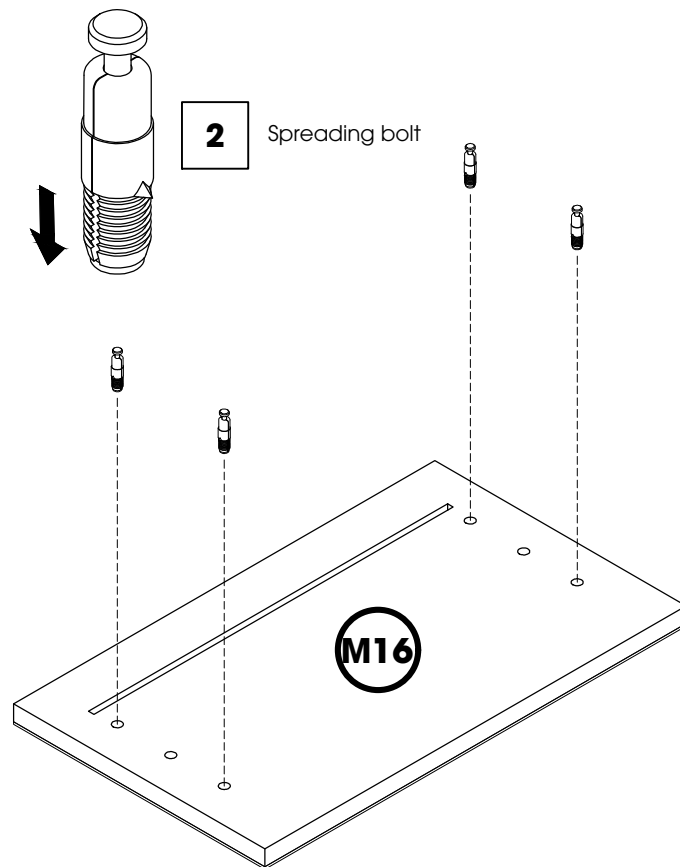

STEP 13

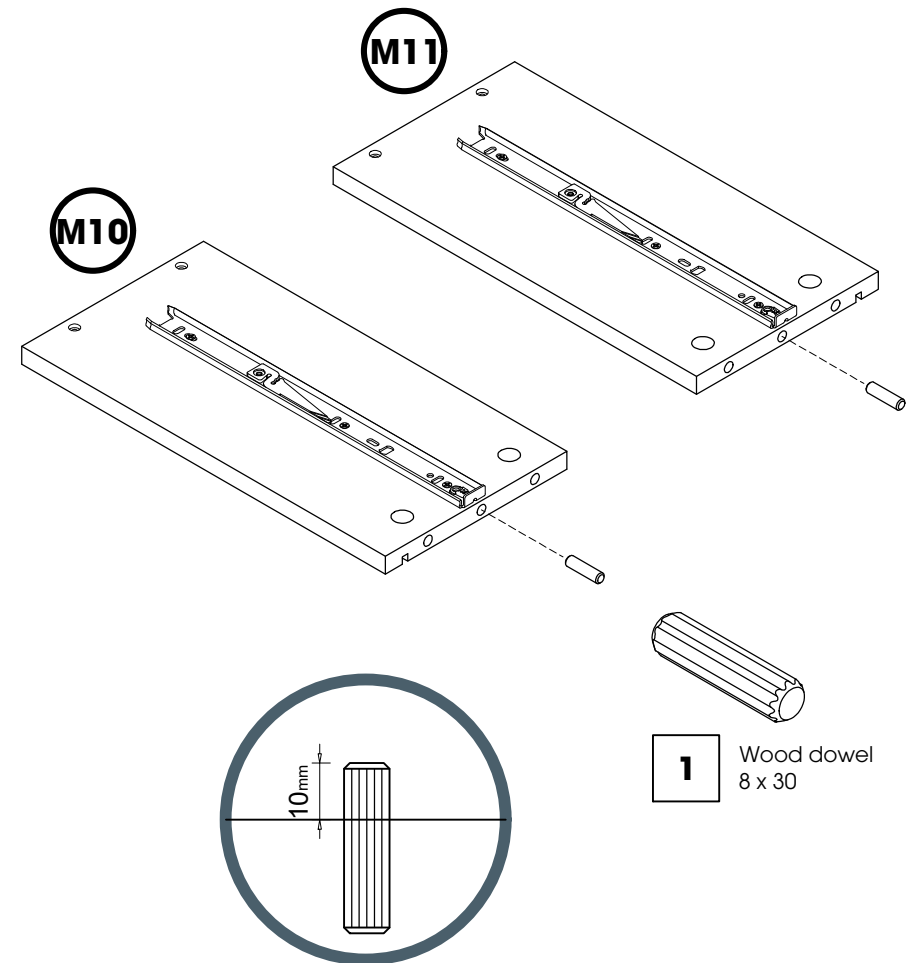

STEP 14

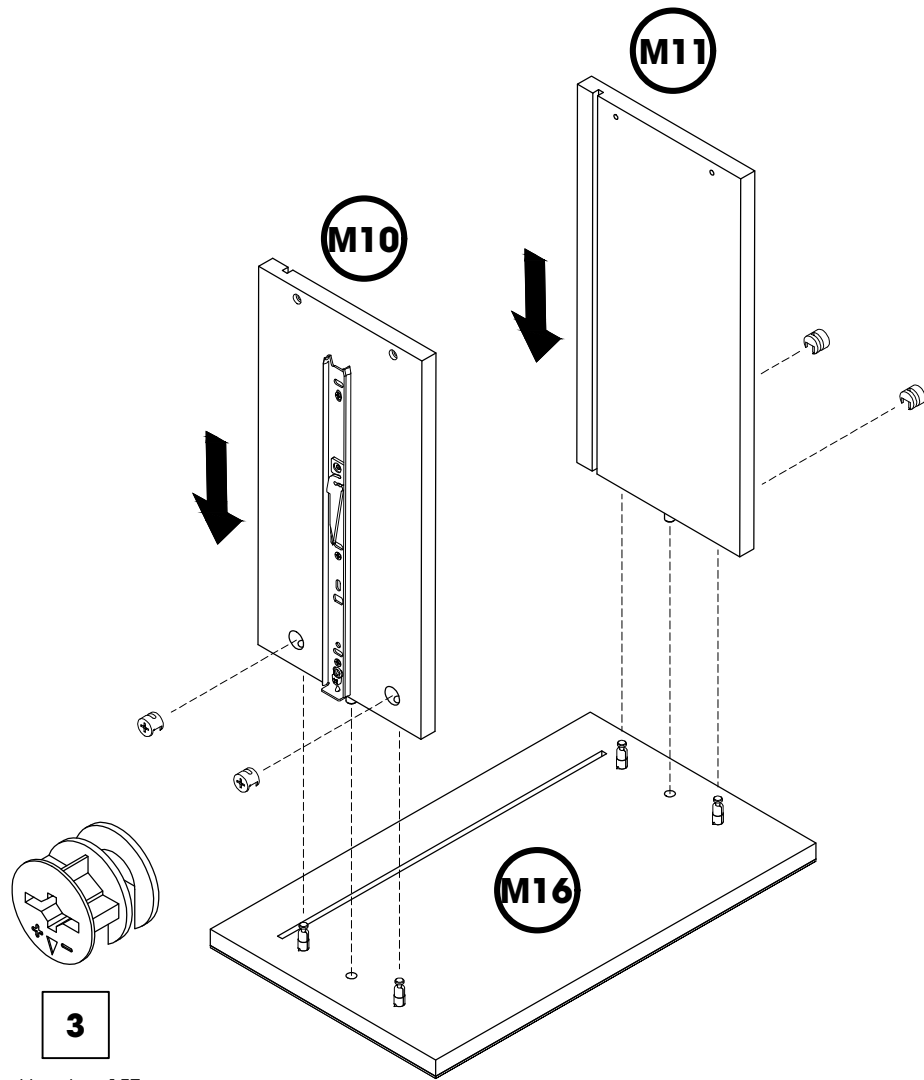

Housing 15T

STEP 15

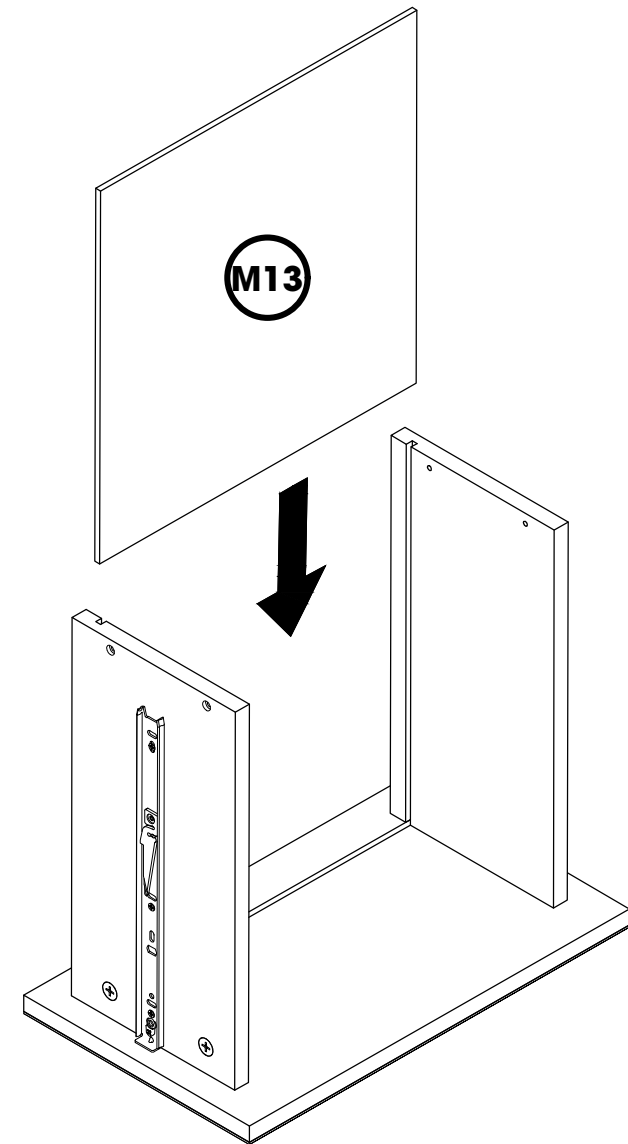

STEP 16

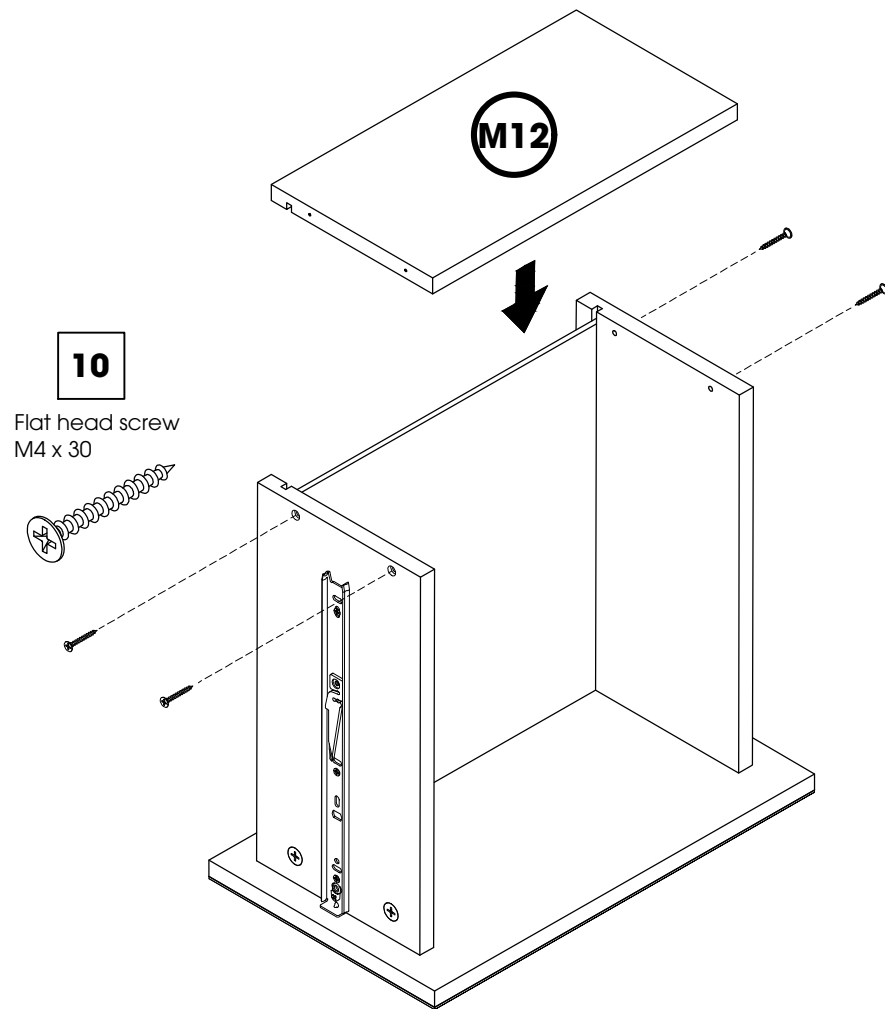

STEP 17

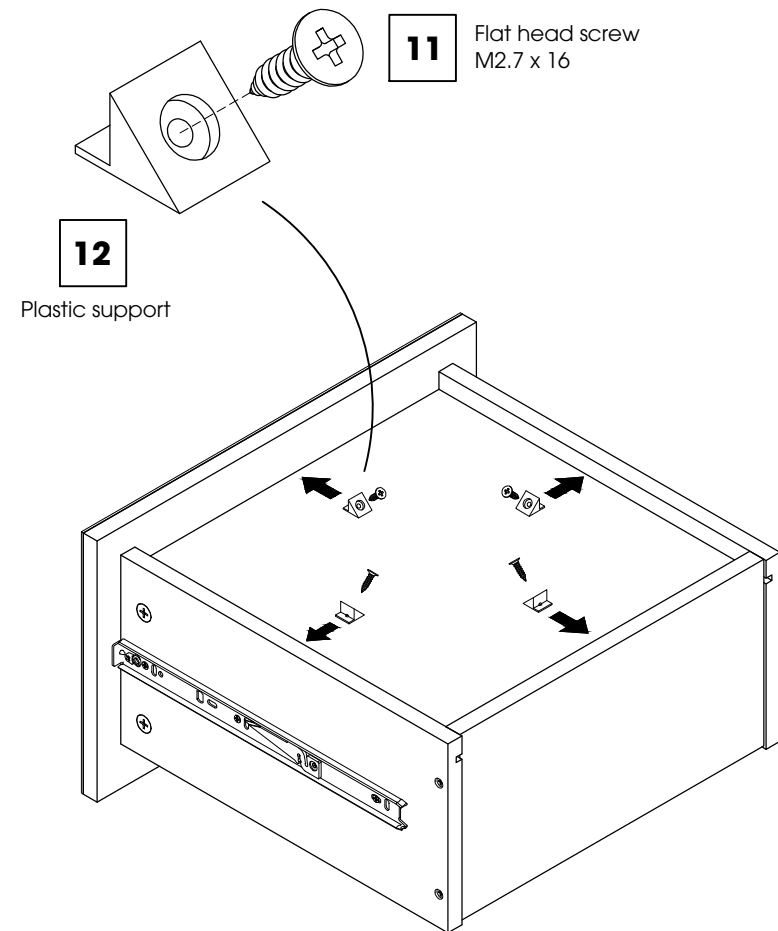

STEP 18

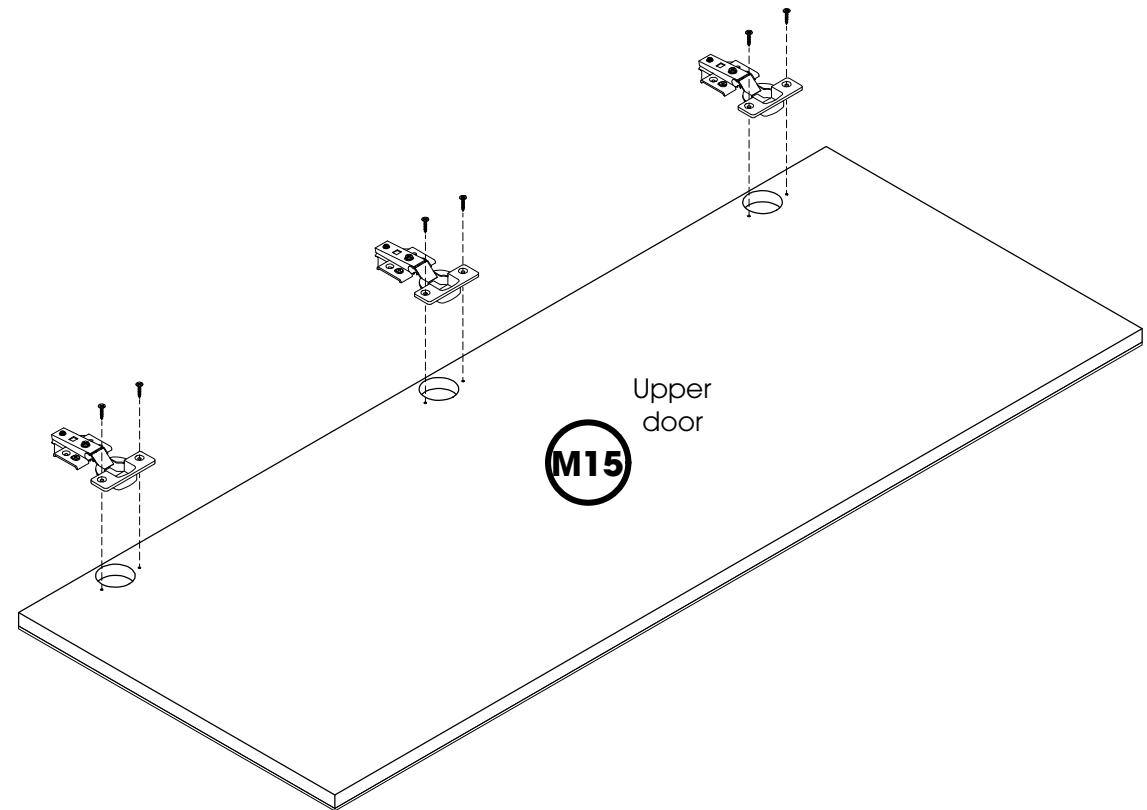
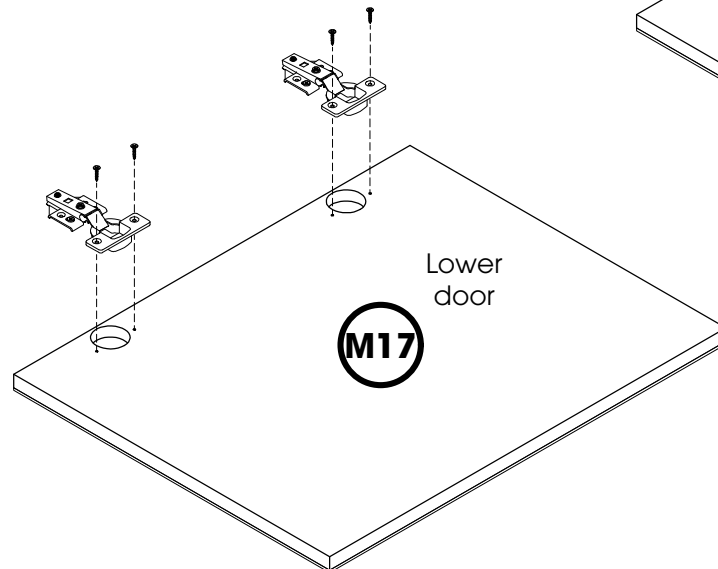
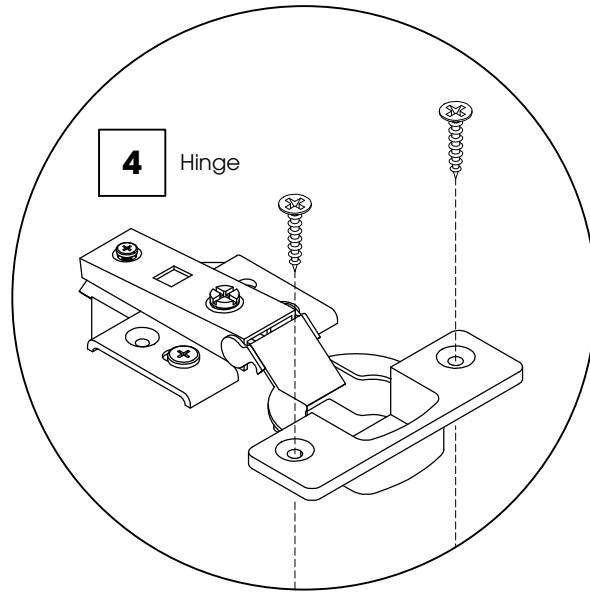

STEP 19

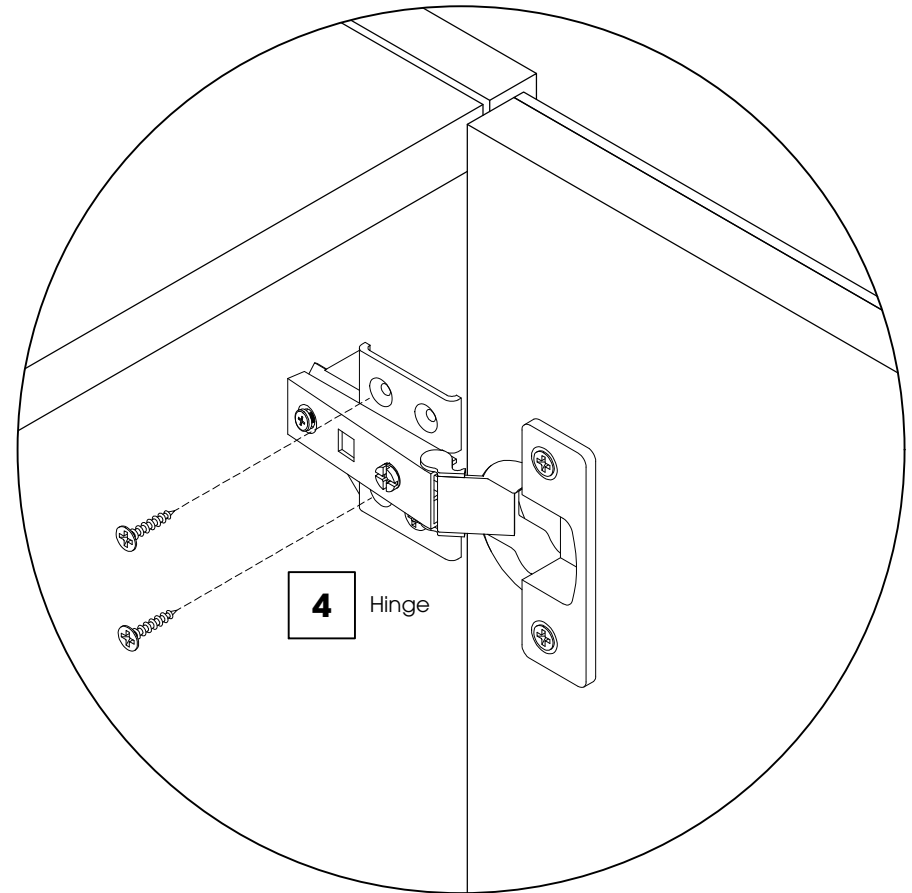
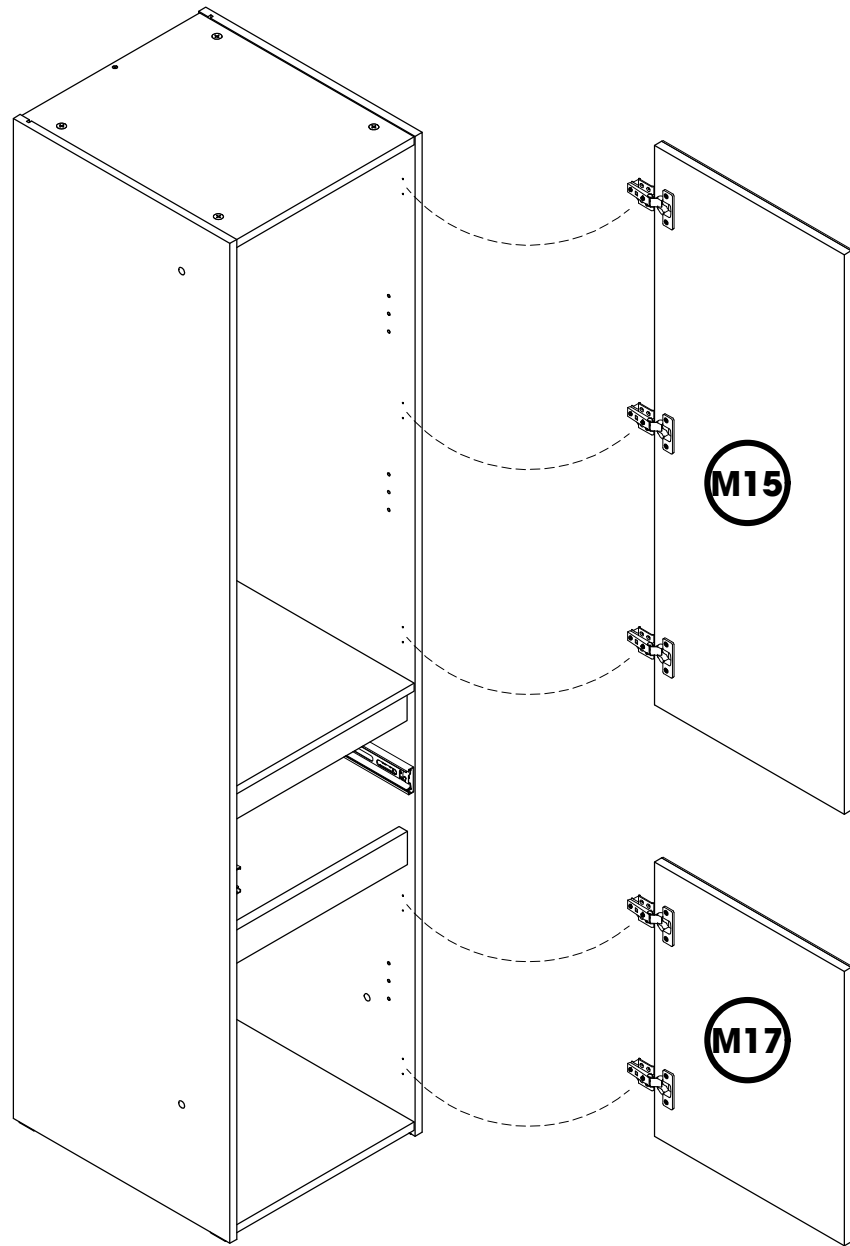

6 - WAY ADJUSTABLE HINGE

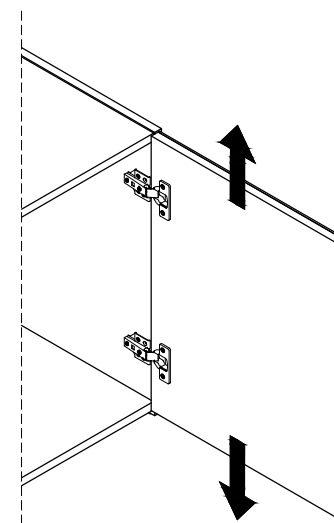
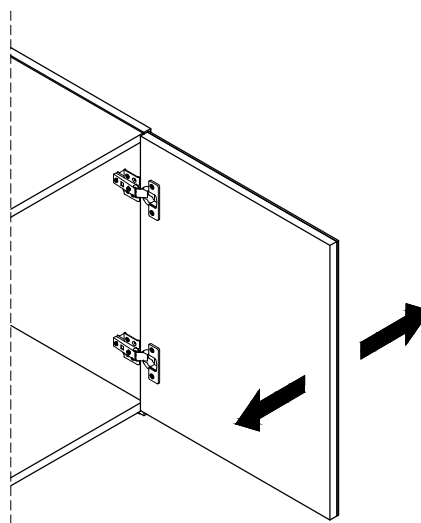
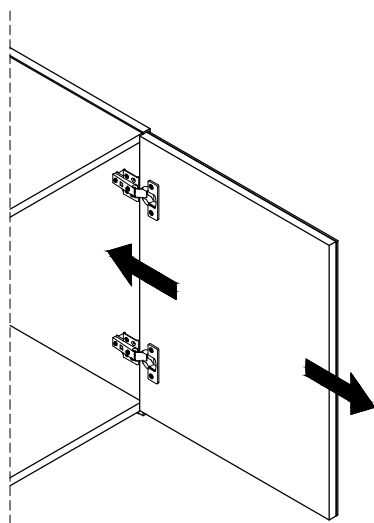
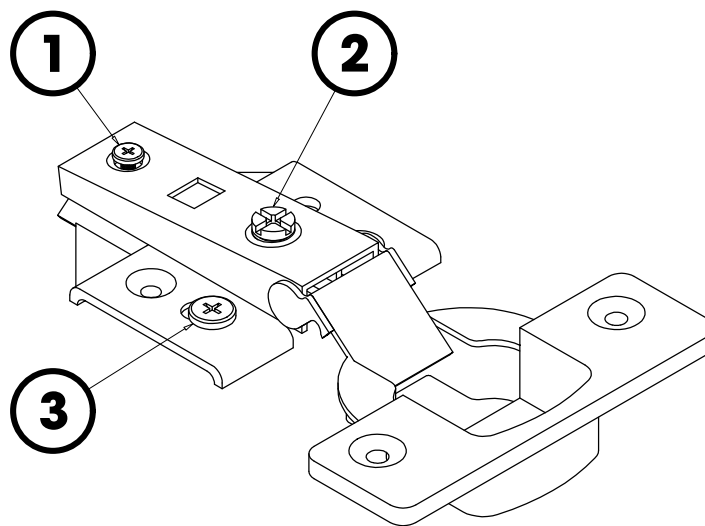

STEP 20

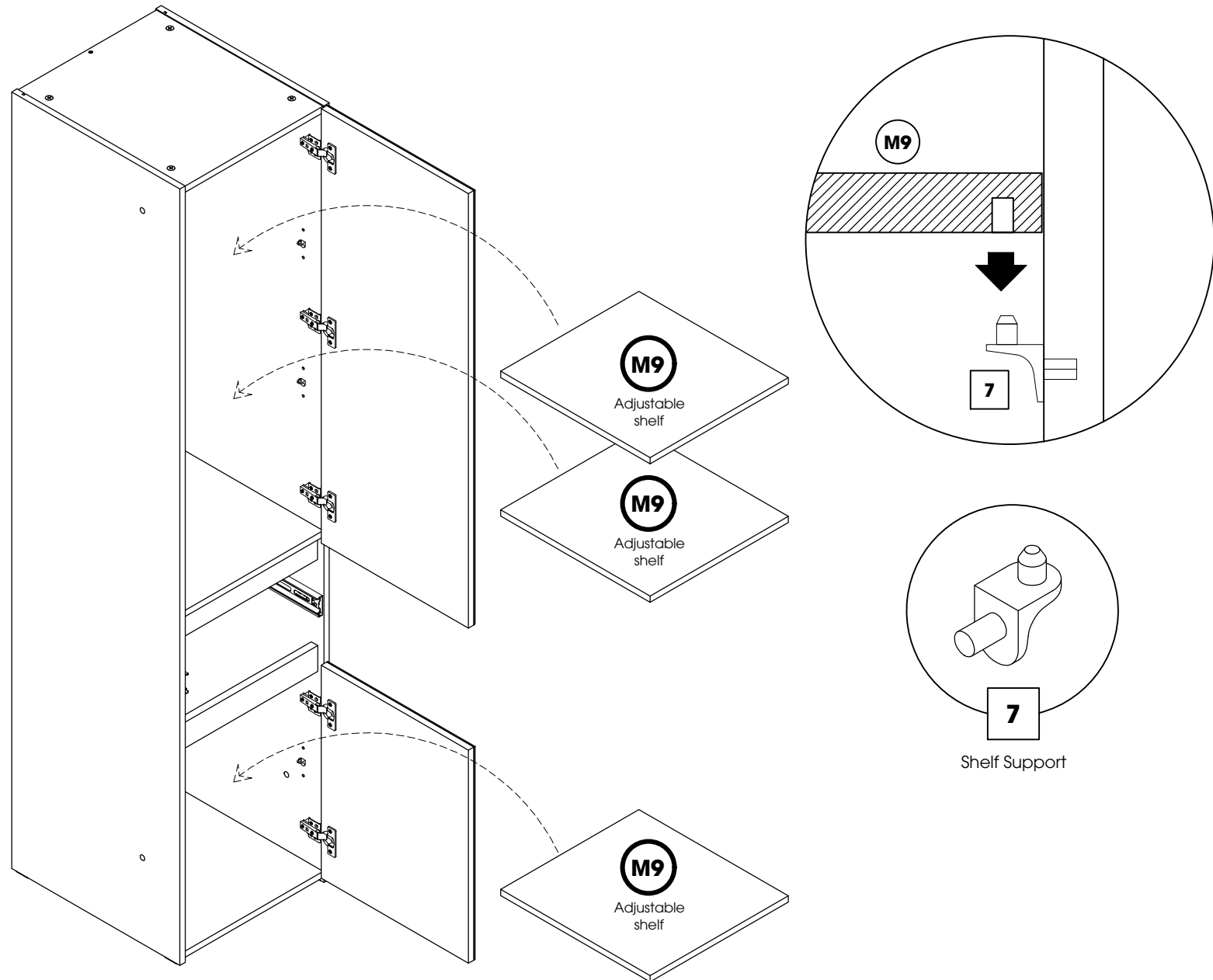

BE CAREFUL !

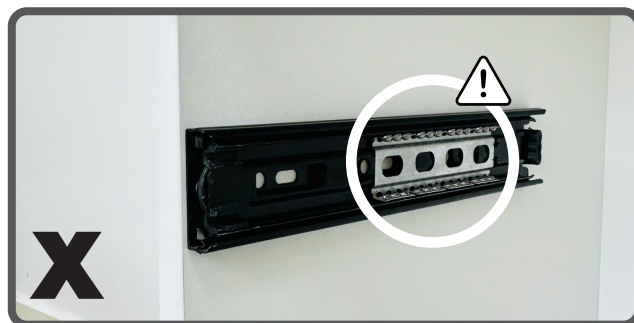

1. Push the ball to the outermost edge of the outer rail.
2. Drawer inner rail butts outer rail, then push it in parallel.
3. After hearing the click sound from both sides, firmly push the drawer in to ensure both drawer rails are installed properly.

STEP 21

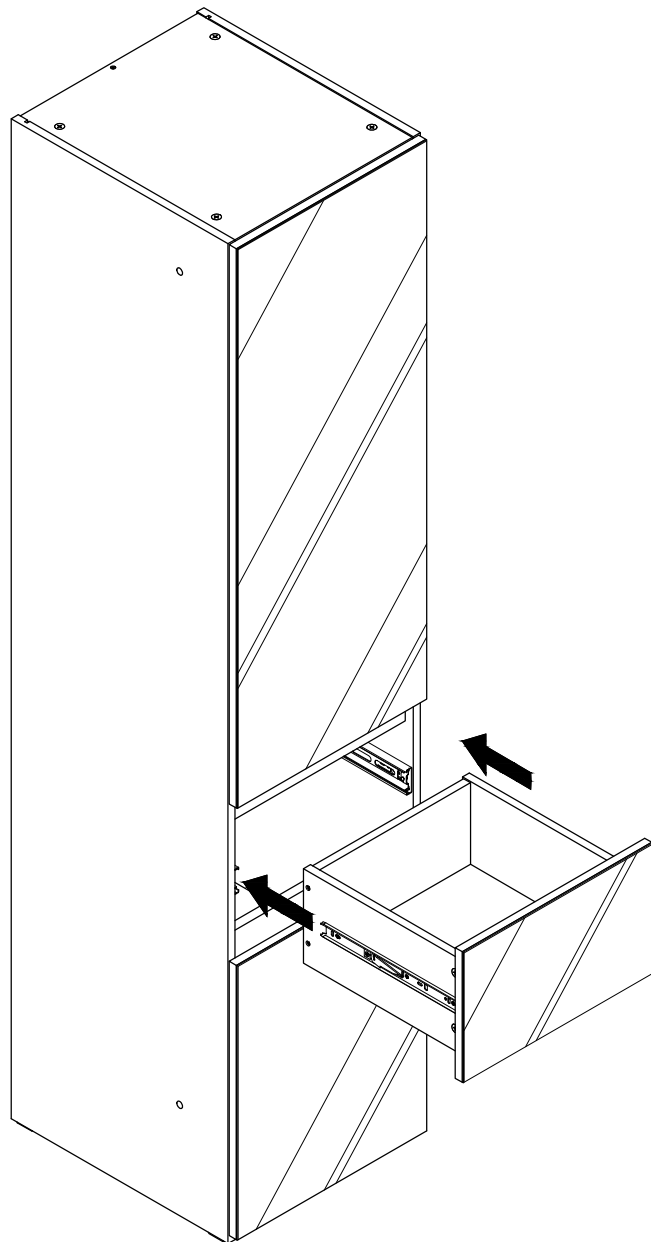

COMPLETE

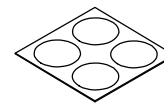
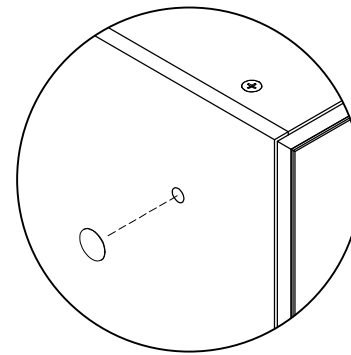

8

Hole cover sticker

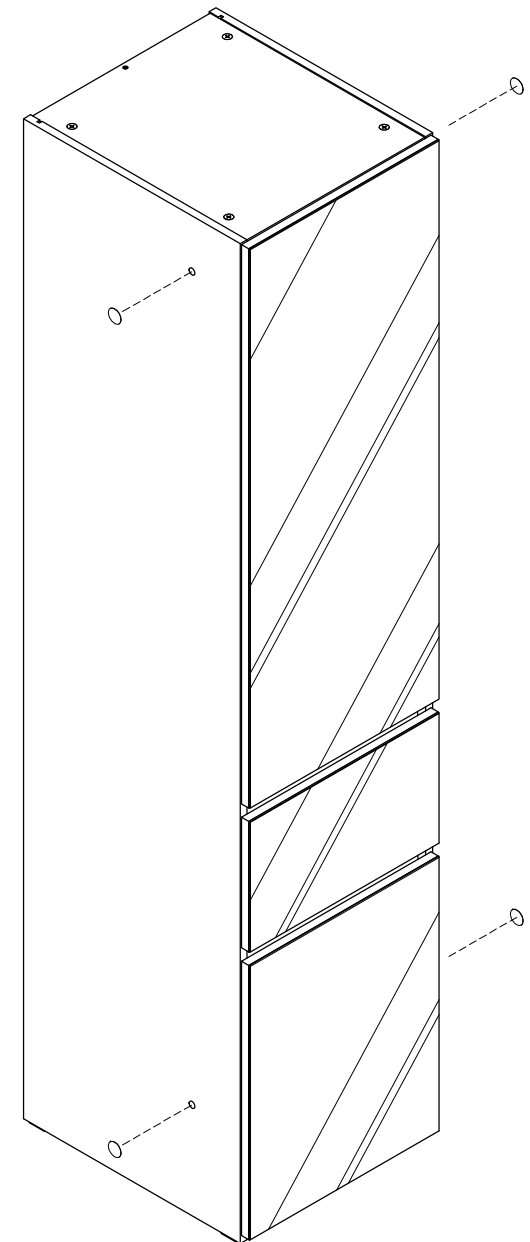

ANTI-TIP RESTRAINT

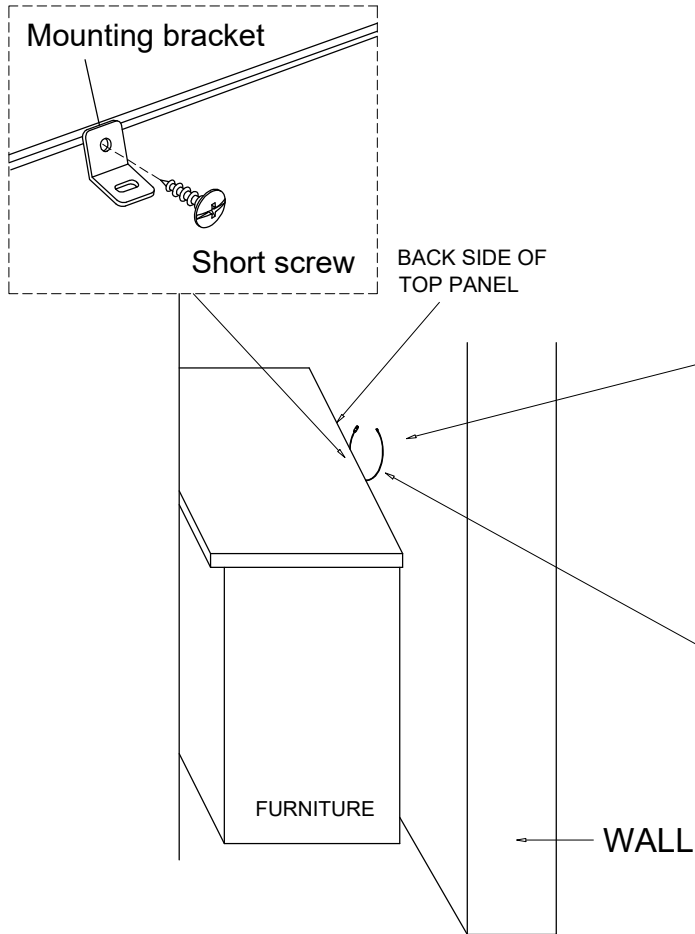

STEP 1:

- Attach the mounting bracket to the furniture in the solid part below the top panel a few inches away from the side of the unit.
- Short screw through the smallest hole of mounting bracket.

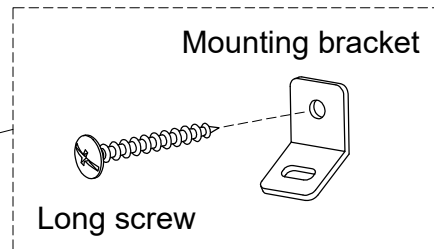

STEP 2:

- Locate a stud in behind the have to
- Place the other mounting bracket on the wall stud 2 inches below the mounting bracket secured to the back of your unit.
- Attach to the wall stud using long screw through the smaller hole of mounting bracket

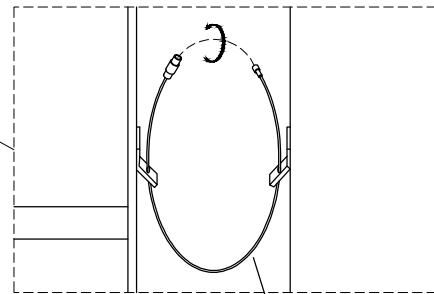

STEP 3:

- Repeat the same step a few inches away from the other side of the unit.
- Place the furniture into position so both mounting brackets are vertically in line.
- Lace the end of the restraint strap through the larger holes in each mounting bracket.
- Secure the straps and lock into place.

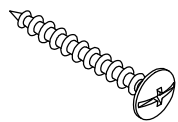

Long screw x 1

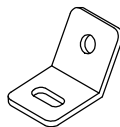

Mounting bracket x 2

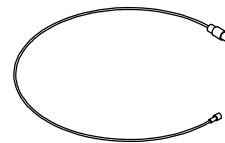

Restraint strap x 1



Short screw x 1