

## To Set 6 Shower Head Settings

Turn Dial Lever (Fig. 5) to select desired water pattern while holding Shower Head with free hand to prevent loosening of its connection.

## To Change Angle

Swivel Shower Head around ball joint to set desired angle.

## To Save Water while Lathering or Shampooing

Reduce water flow by using Economy Rain mode.

## To Open Showerhead and Replace Cartridge

(recommended after 6 months of average use).

### Replacement Cartridges Available at [ipshowers.com](http://ipshowers.com).

1. Remove Showerhead by unscrewing its Connection Nut COUNTERCLOCKWISE by hand (Fig. 5). Do not use tools.
2. Hold Back Section of Showerhead with one hand and twist its Front Section firmly COUNTERCLOCKWISE with other hand until stop. This will unlock connection and open Showerhead (Fig. 6).

Note: If Decorative Ring comes off, place it back before Step 6.

3. Remove used Cartridge.

4. Remove Clear Protective Film on each side of replacement cartridge (Fig. 7).

5. With Perimeter Cartridge O-ring facing IN, place Cartridge into Cavity inside Back Section and place Decorative Ring back over its edge (Fig. 6).

6. Line up Lock Guide inside Back Section with Lock Slot inside Front Section, then insert Front Section FULLY over Perimeter Rim of Back Section and twist Front Section CLOCKWISE until stop to lock connection.

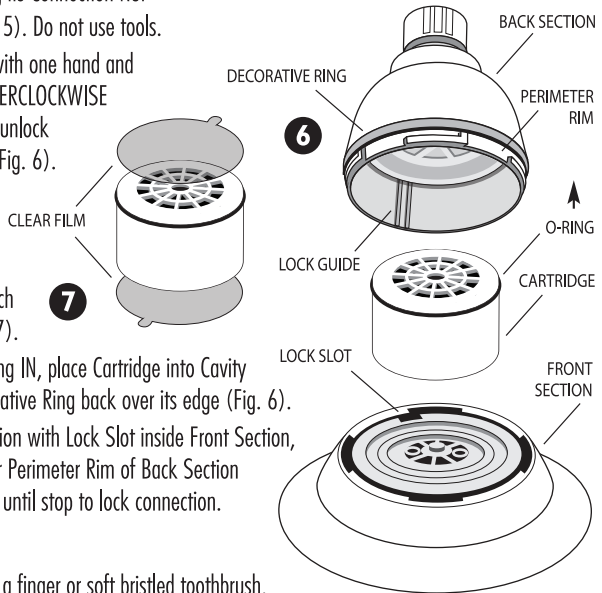

## Cleaning Instructions

Clean flexible nozzles by rubbing with a finger or soft bristled toothbrush, or clean with 50% white vinegar and 50% water solution. Do not clean or rinse any part with harsh chemicals, heavy-duty cleaners or abrasives. This may damage parts or finish and may void warranty.

*If you have installation problem or missing parts, please DO NOT return this product before calling us first. We can help on the phone or by quickly sending needed parts.*

For Questions/Part Replacement Call Toll Free

**1-888-869-4010**

Monday - Friday 9:00 AM - 4:00 PM Eastern Time

[www.ipshowers.com](http://www.ipshowers.com)

## LIMITED LIFETIME WARRANTY

Interlink will repair or replace any of this product's parts that exhibit defects in workmanship or materials for above stated period from date of purchase. If malfunction occurs, send only defective part(s) with proof of purchase to Customer Service Department at the address listed below. This warranty does not cover product purchased from unauthorized distributors, malfunction or damage due to accident, misuse, use of harsh chemicals or failure to follow any included written instructions. This warranty gives you specific legal rights. You may also have other rights that vary where you reside.