

# Assembly Instructions

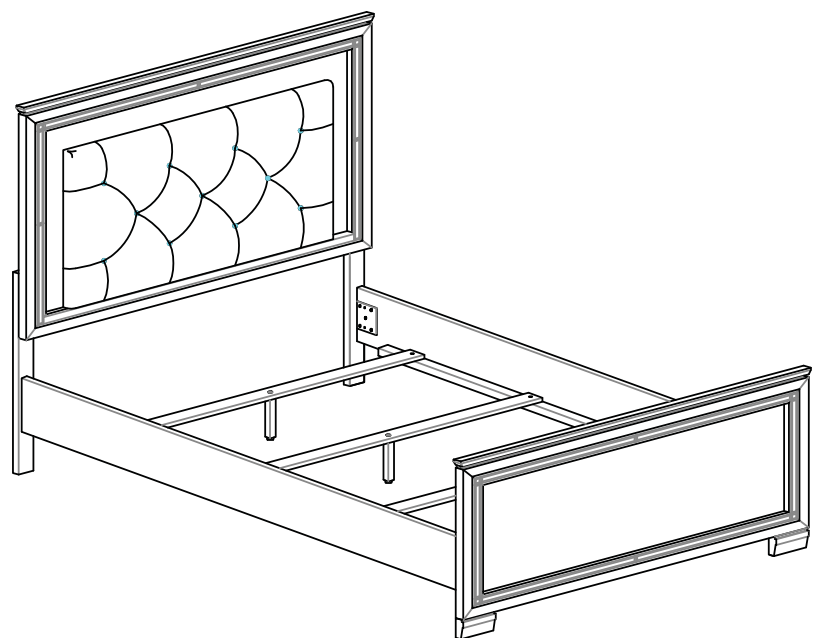

## ASSEMBLY RATING

The Assembly Rating is a 5-point system that shows the degree of effort needed in assembling a specific product (with 1 being easy and 5 being difficult). For some products, two persons are recommended.

EASY  DIFFICULT

## Tools Required For Assembly:

Allen Wrench

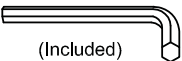

Phillips Screwdriver

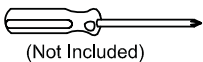

2 PERSONS RECOMMENDED

# ASSEMBLY & CARE ADVICE

FOR YOUR FURNITURE TO LAST, CORRECT ASSEMBLY AND PROPER MAINTENANCE ARE NECESSARY. PLEASE FOLLOW THE INFORMATION PROVIDED BELOW TO FULLY ENJOY YOUR FURNITURE.

## BASIC ASSEMBLY TECHNIQUES

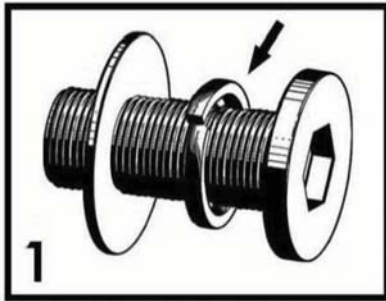

When lock or spring washer is used in an assembly, please make sure the lock or spring washer is placed between the larger flat washer and the head of the screw or bolt.

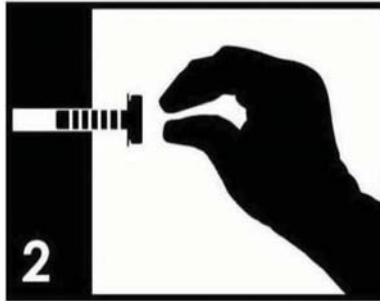

Position each part correctly and insert screws or bolts into their respective holes by hand tighten or using the proper hand tool. Only tighten when step is completed or when instructed to do so.

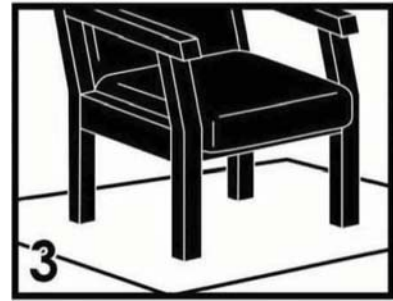

Use cardboard or carpet area when assembling furniture to prevent scratches. Make sure the furniture rests on a flat and level surface with each leg evenly touching the floor.

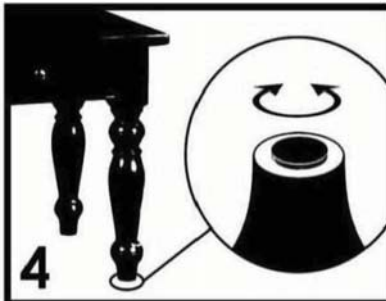

Some furniture comes with height adjustment knobs underneath each leg. To lower or to raise each leg, you need to turn clockwise or counterclockwise, respectively.

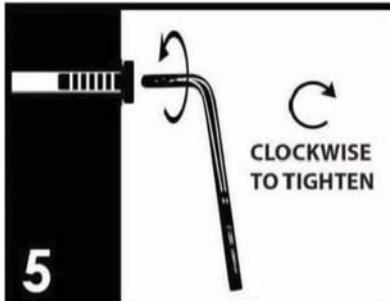

Make sure all parts are properly aligned, then use the appropriate hand tool to completely tighten the bolts or screws. Do not use power tools and do not overtighten.

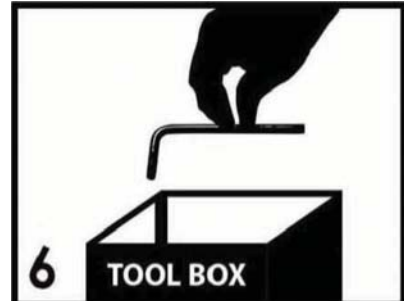

Save the instructions and store the Allen wrench or any supplied tool for later maintenance. After two weeks, check and tighten any loose hardware and repeat again every six months thereafter.

IT IS THE USER'S RESPONSIBILITY TO MAINTAIN THE FURNITURE. THE HARDWARE MAY LOOSEN OVER TIME AND MAY CAUSE THE FURNITURE TO BE WOBBLY AND UNABLE TO SUPPORT ITS INTENDED WEIGHT CAPACITY. THIS MAY LEAD TO COLLAPSE AND MAY CAUSE SERIOUS INJURY.

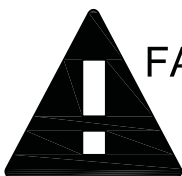

**FAILURE TO FOLLOW THE GUIDELINES ABOVE MAY RESULT IN INJURY AND/OR PROPERTY DAMAGE.**



Before you begin, please read Page 2 of "Assembly and Care Advice".

And remember, do not tighten until each step is completed or instructed.

## Parts List

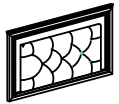

#1 x 1pc  
Headboard (LED)

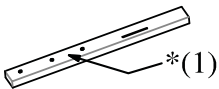

#2 x 1pc  
Headboard Leg (L)

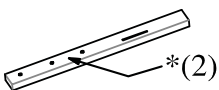

#3 x 1pc  
Headboard Leg (R)

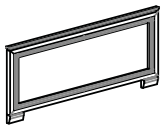

#4 x 1pc  
Footboard

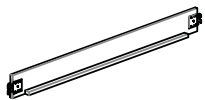

#5 x 2pcs  
Side Rail

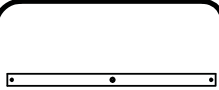

#6 x 3pcs  
Slat

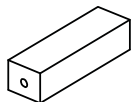

#7 x 3pcs  
Slat support leg  
190x30x30mm

## Hardware List



#A x 1pc  
Allen Wrench



#B x 9pcs  
JCBC 35mm



#C x 9pcs  
Lock washer M6



#D x 6pcs  
Flat washer M6



#E x 6pcs  
Screw 32mm

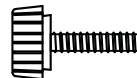

#F x 3pcs  
Adjustable Leveler

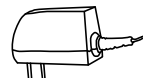

#G x 1pc  
AC Adapter



#B x 6pcs  
#C x 6pcs  
#D x 6pcs

1. Prepare 6 bolt assemblies by first inserting a lock washer (#C) onto the bolt (#B) then a flat washer (#D) onto that same bolt (#B).

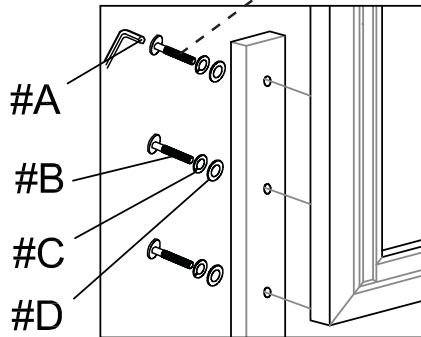

Note: Left and right is determined by facing the front of the headboard in its upright position.

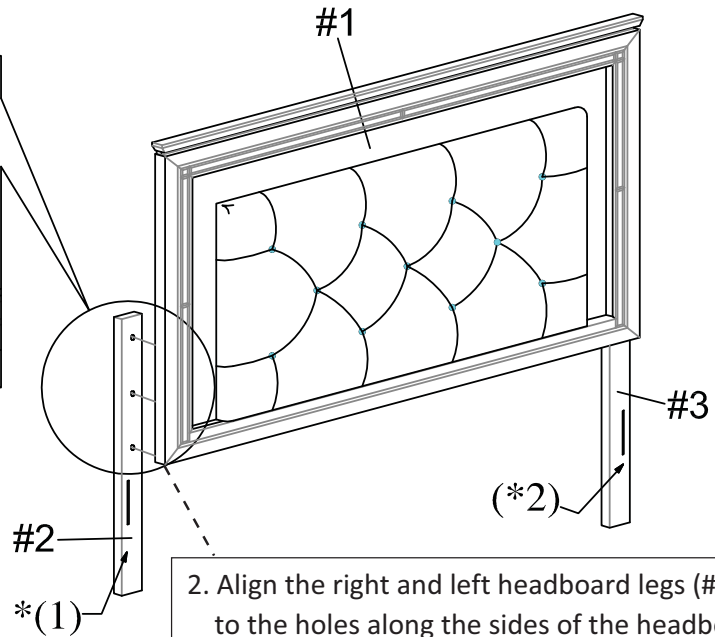

2. Align the right and left headboard legs (#2,3) to the holes along the sides of the headboard (#1), then insert 3 bolt assemblies into each leg and secure using the Allen wrench (#A).

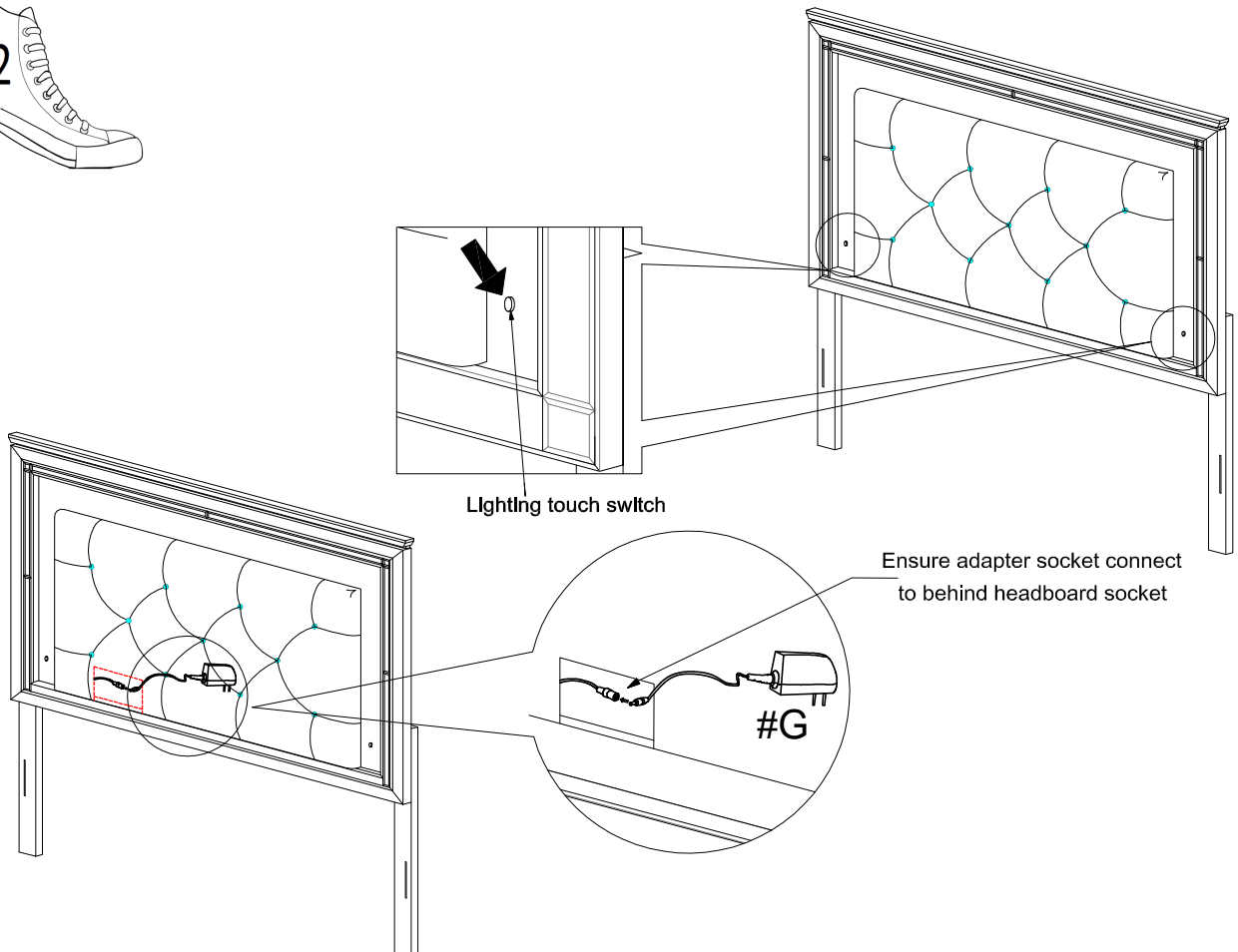

Lighting touch switch

Ensure adapter socket connect to behind headboard socket

#G



Carefully hook the ends of each side rail (#5) into the slots located along the headboard legs (#2,3) and footboard (#4).

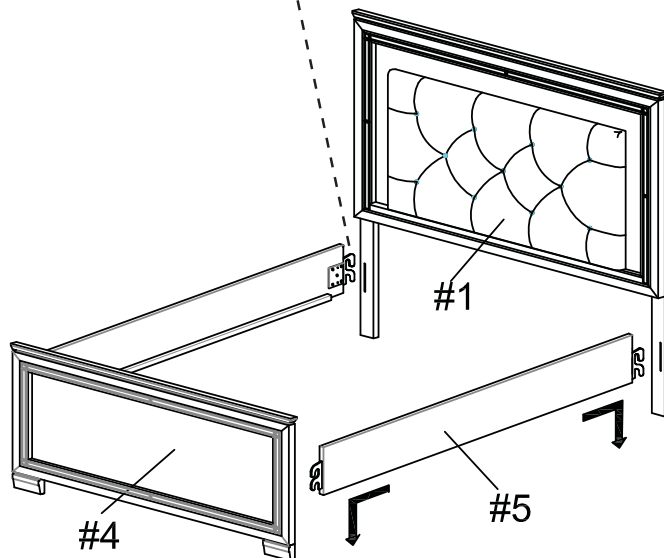

1. Prepare 3 bolt assemblies by inserting a lock washer (#C) onto the bolt (#B), then align the slat support leg (#7) to the holes along the center of the slats (#6) and insert a bolt assembly from the top. Secure using the Allen wrench (#A).

#B x 3pcs  
#C x 3pcs  
#E x 6pcs  
#F x 3pcs

Adjust the leveler accordingly.

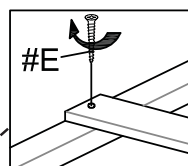
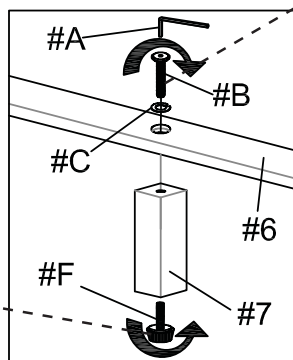

2. Align the ends of the slats (#6) to the side rails (#5), then insert a screw (#E) into each end and secure using the a Phillips screwdriver.

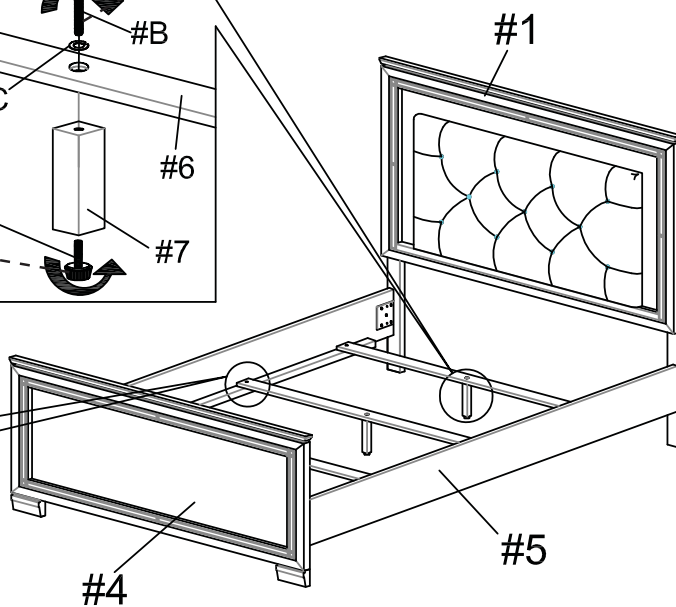

**ASSEMBLY IS COMPLETED**