

Bathroom Lighted Mirror Installation & User Guide

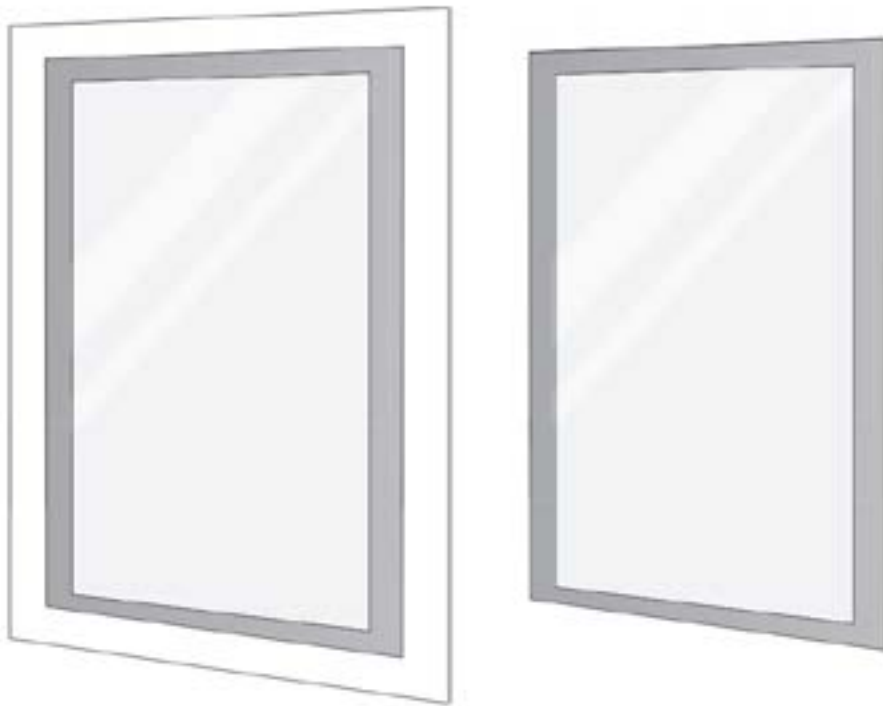

Warning

1. This product should only be installed by a fully qualified electrician.
2. Always switch off the electrical main supply before and after installation, as well as maintenance.
3. DO NOT connect to a plug and socket outlet. Suitable for indoor use only.
4. Do not use attachments not recommended by the manufacturer.
5. Never drop or insert any object.
6. Do not fix to damp or conductive surfaces .
7. Suitable for Bathroom Zones 2, 3 and non bathroom/dry areas. See diagram below.
8. NOT suitable for above baths or Zone 1 nor for installation in Saunas, Steam Rooms or shower Cubicles.



Before Installation

1. Inspect the product immediately upon receipt for transit damage or missing parts.
2. Handle the product with care and protect against knocks to all sides and edges of the glass.
3. Make sure that you have all the tools you need to complete the job (SEE BELOW)
4. Ensure there are no hidden pipes or cables in the wall before drilling.
5. If drilling holes in ceramic tiles use a piece of masking tape on the tile to stop the drill bit from slipping.
6. Ensure the domestic electrical mains supply to which the mirror is to be connected is turned off.
7. Before drilling, ensure that there are no hidden cables or pipes in the wall.

Note: All electric installation work should follow the local electrician regulations.

Aftercare Instructions

1. Clean using a soft dry cloth only when turned off.
2. Never use cleaning agents or abrasive materials.
3. Do not allow moisture to come into contact with lamps.

Tools Used



Installation Procedure

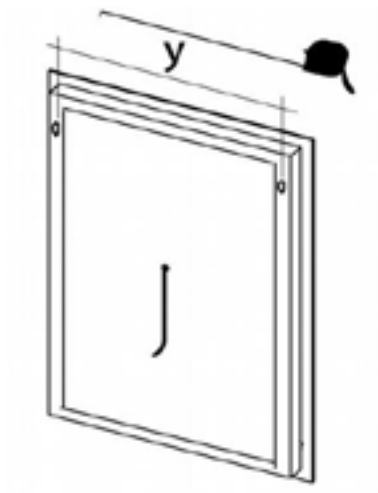

1. Measure the distance between the gourd hole centers on the back of the mirror.

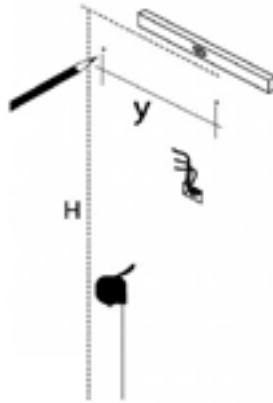

2. Mark the drill positions on the horizontal line, ensure the drill positions are horizontal by using a spirit level.



3. Wearing an eye protection, drill holes on the wall.

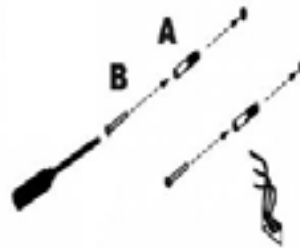

4. Insert wall plugs carefully.

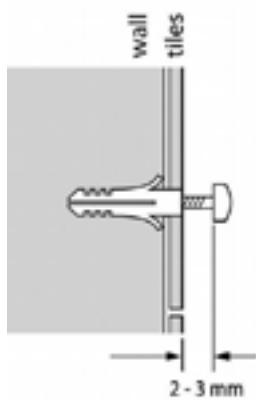

5. Put the screws to the wall plugs. Screw head should protrude approximately 5mm or more from hole.

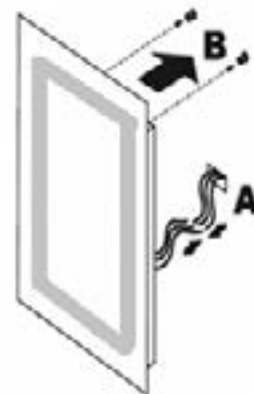

6. Carefully hang the mirror. Mount the backside gourd hole to the screws on the wall, ensure mirror is installed firmly.

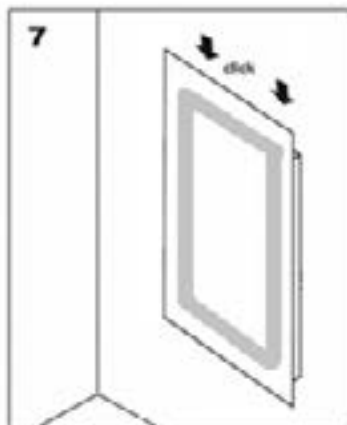

6. Click lightly to fix. Ensure mirror is securely mounted.

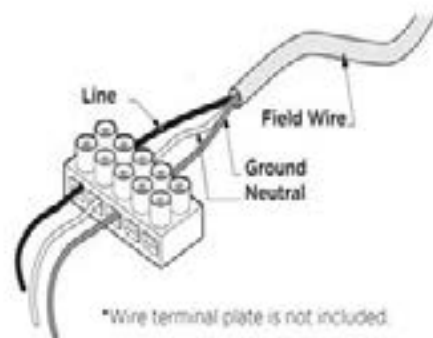

8. Connect mirror to electric power.

Operating Instructions

1. How to work the Touch Switch (CCT change)

- a. Touch the lit area of the touch switch to turn the light on or off.
- b. Press and hold the lit area of the touch switch to change the light color(changes between warm color and white color).
- c. Rememberance. (When the power to restart, the light remains the same light color with that before power off)
- d. "Flat touch area>80 of touch switch lit area" to make the switch sensitive.

2. How to work Mirror Defogger

The defogger works automatically when the mirror is connected to the power. (the anti fog function works after 5 minutes)

3. After Care Instructions:

- a. Always switch off the electrical supply at the mains during installation and maintenance.
- b. LED's have a life expectancy of 120,000 hours of continuous use. All LED light fittings and electric parts are replaceable and are available through NRG Mirror customer service.
- c. Cleaning & Maintenance: it is recommended that the unit is cleaned with a soft, dry, non-abrasive cloth when turned off. Never use cleaning agents or abrasive material on any type of surface finish.
- d. Do not strike glass components with hard or pointed items.
- e. Do not place very hot or cold items against or close proximity to glass surfaces.
- f. Wipe off all water spillages as soon as possible using a soft, damp cloth.