

POWER SECTIONAL ASSEMBLY INSTRUCTION (TOTAL 6 BOX)

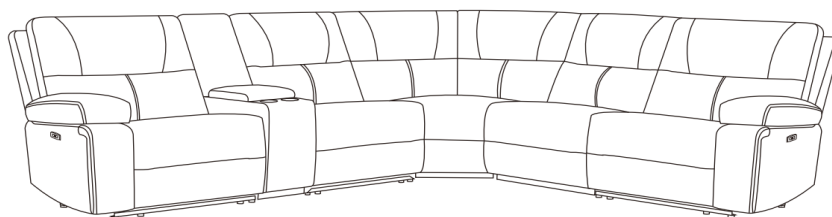

- 1 Please zip up the armrest bag and tuck the velcro into the seat cushion, and take out the console backrest, unscrew the five-star screw on the backrest, and install the backrest on the console as shown.

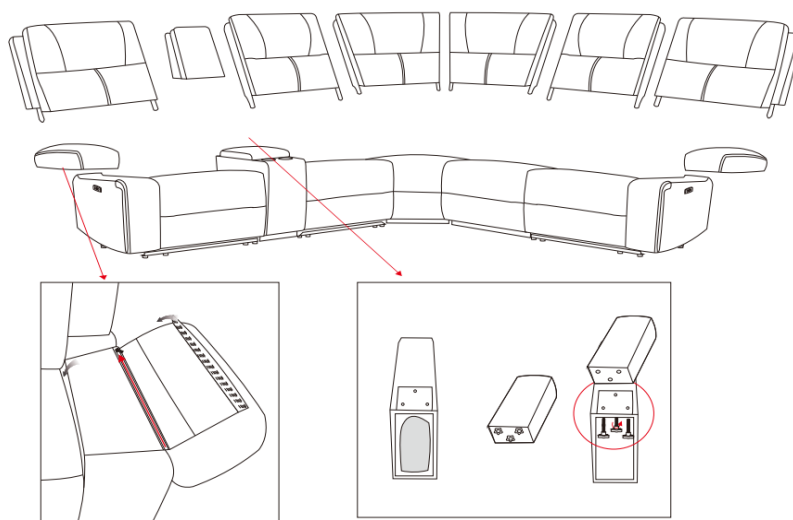

- 2 Fix the backrest by metal lock.

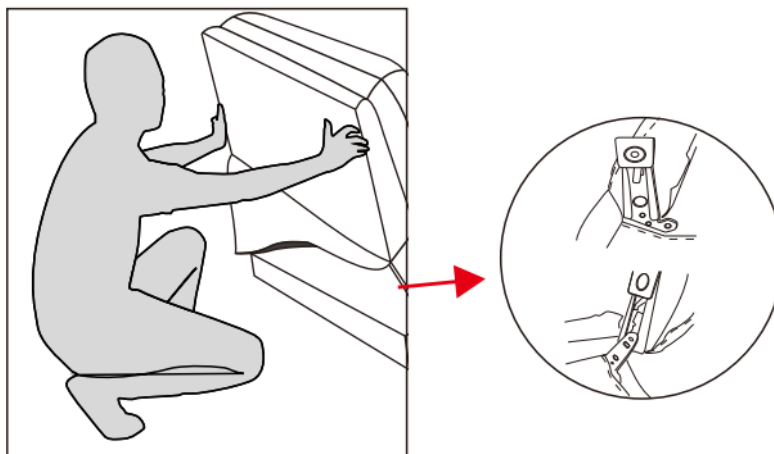

3

Lock the hook of different pieces.

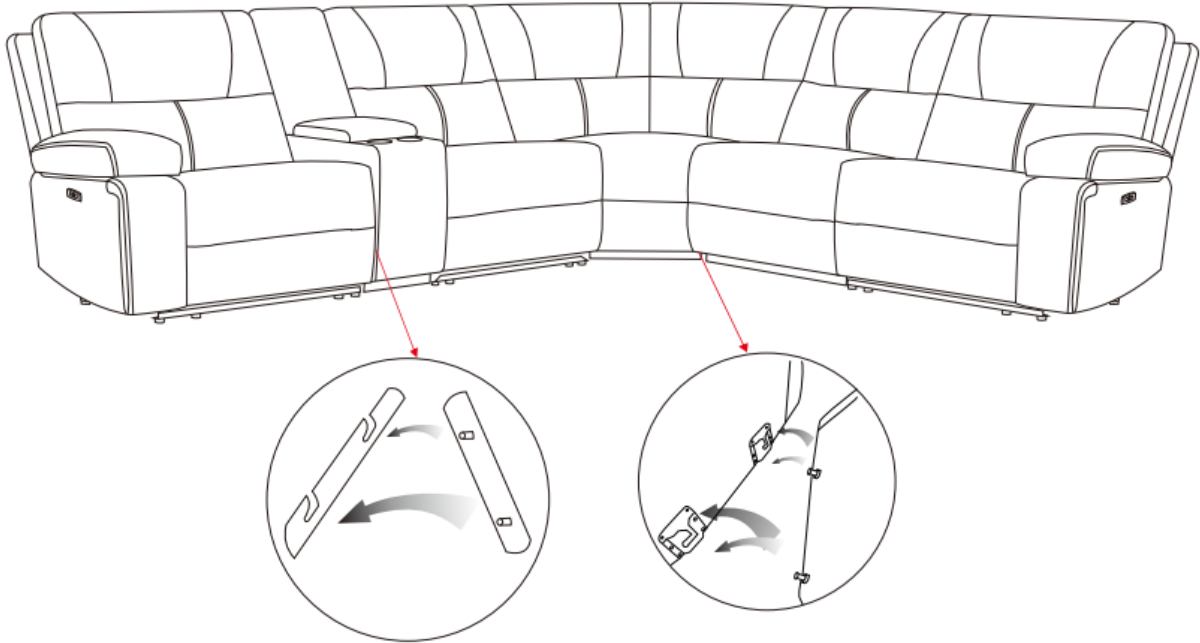

4

Connect the power plugs of each power unit and connect the power cable for each power seat when to power on.

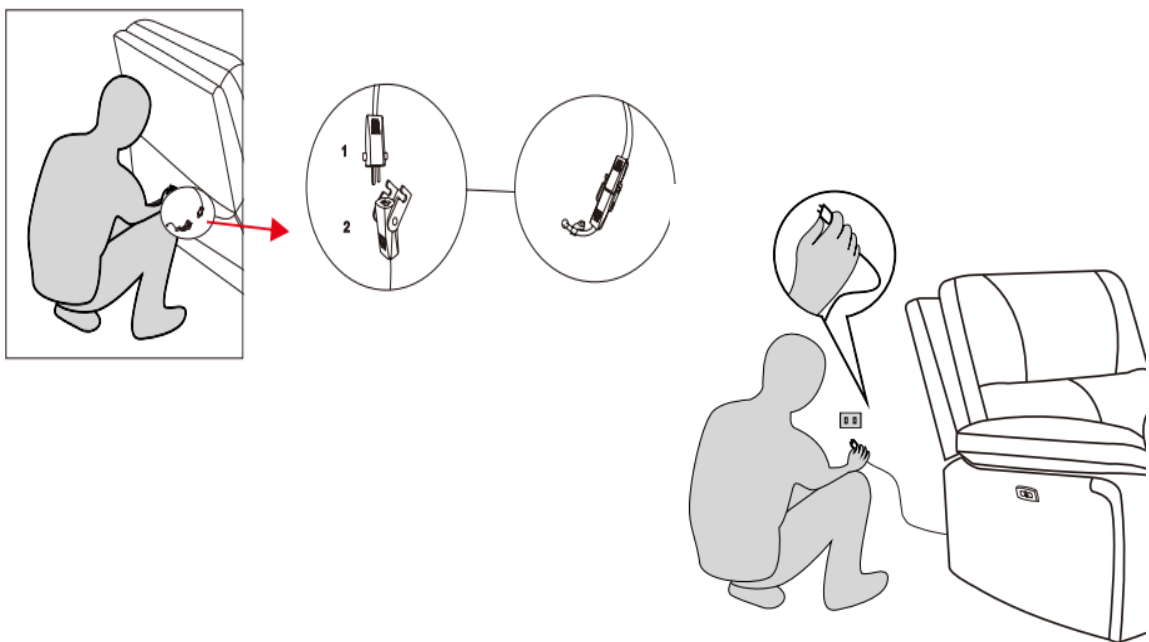

Thank you for your purchase