

ASSEMBLY INSTRUCTION

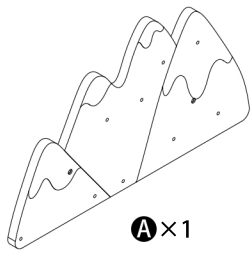

A × 1



B × 1

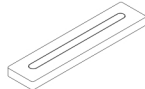

C × 1



D × 2



E × 1



1 × 8



2 × 1



3 × 2



4 × 2



5 × 1



6 × 1

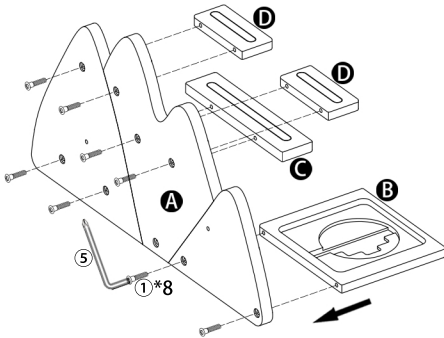

Screw parts A B C D together with screwdriver ⑤.

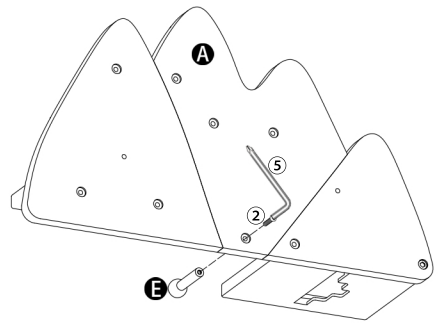

Screw parts A E together with screwdriver ⑤.

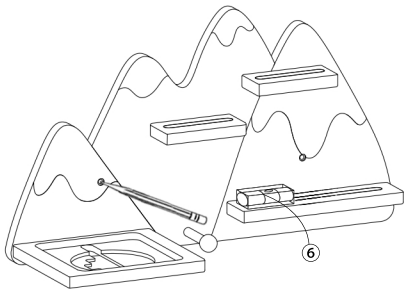

Mark the place where you want to install the shelf and check with a level.

Drill holes in sequence at the marked positions.

WALL

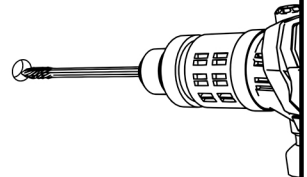

WALL

Use a hammer to hammer the expansion tube into the drilling hole.

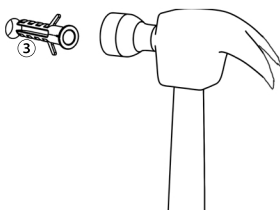

Use screwdriver to screw the long screws into the expansion tubes.

