

## INSTALLATION GUIDE

# 1X4, 2X2, 2X4 LED CCT & WATTAGE SELECT TROFFER

## LR25135, LR25136, LR25137

PLEASE read these instructions carefully before installation and keep for reference.

### WARNINGS

**WARNING - Risk of electric shock.** Do not open or remove covers

**WARNING -** Refer servicing to qualified service personnel

**DISCONNECT POWER BEFORE REPAIRS AND MAINTENANCE**

**WARNING - Risk of electric shock.** Use in dry or damp locations only

**WARNING - Risk of electric shock.** Not for use where exposed to weather

### IMPORTANT

- Read instructions carefully before installation.
- Keep these instructions for future reference.
- The troffer must be wired in accordance with the National Electrical Code and all applicable local codes.
- Proper grounding is required for safety.
- This product must be installed in accordance with the applicable installation code by a qualified electrician who is familiar with the construction and operation of the product and the hazards involved.

### CAUTION

- Inherently protected
- Access above ceiling required
- Suitable for damp location use
- This product must be installed in accordance with the applicable installation code by a person familiar with the construction and operation of the product and the hazard involved.
- Suitable for operation in ambient not exceeding 104°F
- Do not press the diffuser with your fingers (when installing the troffer).

• **RISK OF FIRE OR ELECTRIC SHOCK. THE TROFFER INSTALLATION REQUIRES KNOWLEDGE OF LUMINAIRES AND ELECTRICAL SYSTEMS. IF NOT QUALIFIED, DO NOT ATTEMPT INSTALLATION. CONTACT A QUALIFIED ELECTRICIAN.**

• **TURN OFF ELECTRICAL POWER AT FUSE OR CIRCUIT BREAKER BOX BEFORE WIRING FIXTURE TO THE POWER SUPPLY.**

• **TURN OFF THE POWER WHEN YOU PERFORM ANY MAINTENANCE.**

## RECESSED INSTALLATION

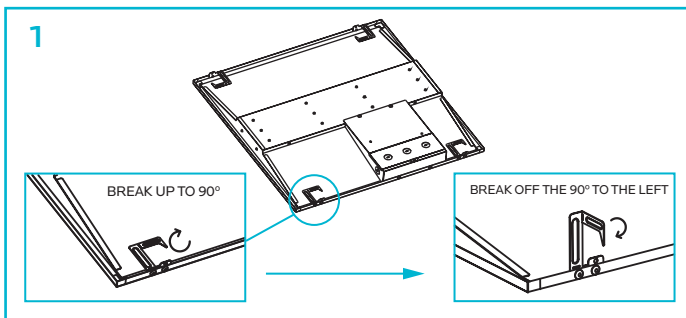

1. Remove the original ceiling tile for the Troffer.

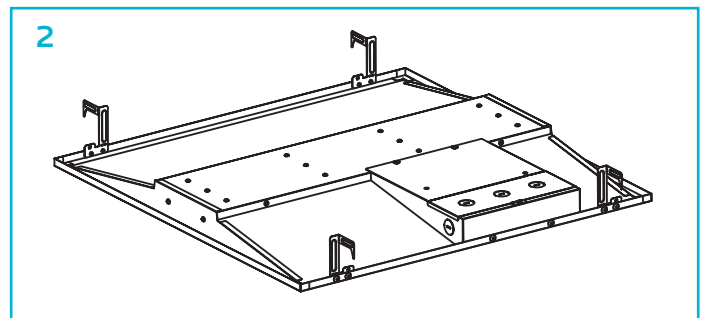

2. Turn off the electrical power then connect with L/N/GND wire leads.

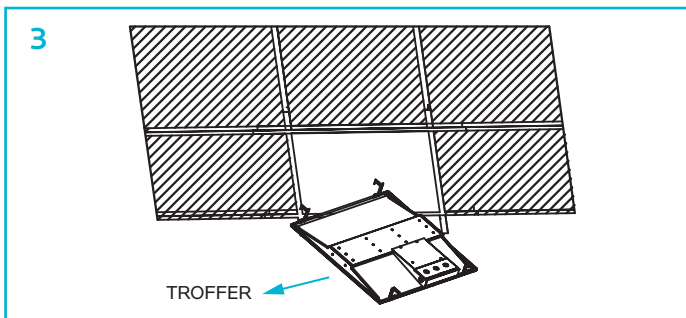

3. Use the protective brackets for safety.

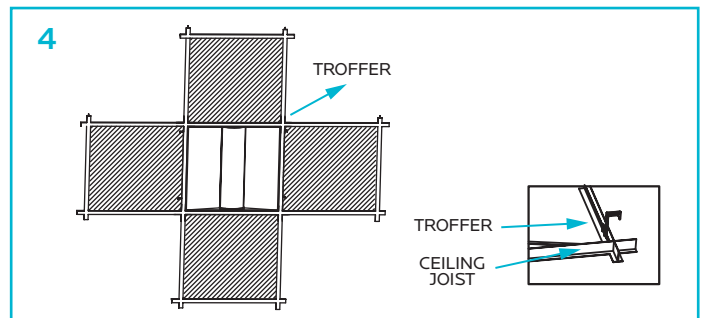

4. Adjust appropriate location in the T bar

## WIRING DIAGRAM

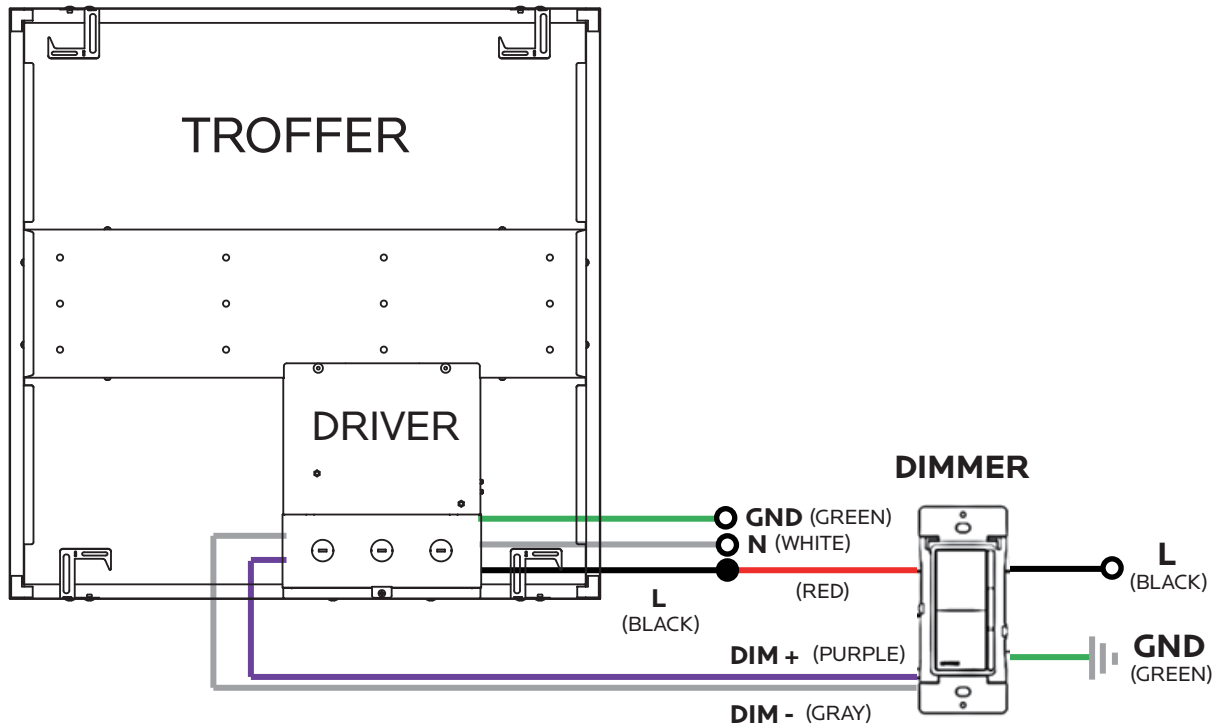

## CCT & POWER SWITCH

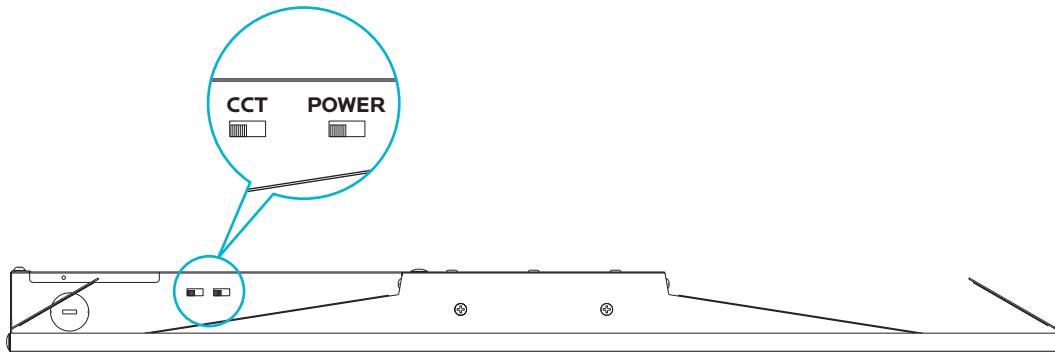

1X4 TROFFER			
3500K	<input type="checkbox"/>	16W	<input type="checkbox"/>
4000K	<input type="checkbox"/>	20W	<input type="checkbox"/>
5000K	<input type="checkbox"/>	30W	<input type="checkbox"/>

2X2 TROFFER			
3500K	<input type="checkbox"/>	20W	<input type="checkbox"/>
4000K	<input type="checkbox"/>	30W	<input type="checkbox"/>
5000K	<input type="checkbox"/>	40W	<input type="checkbox"/>

2X4 TROFFER			
3500K	<input type="checkbox"/>	30W	<input type="checkbox"/>
4000K	<input type="checkbox"/>	40W	<input type="checkbox"/>
5000K	<input type="checkbox"/>	50W	<input type="checkbox"/>