

Assembly Instructions



Assembly method

1. Hold the light fixture against the wall and mark the positions for the base mounting holes.



2. Remove the base and position it at the marked location.



3. Secure the base using wall anchors and screws.

Install as shown in the diagram.

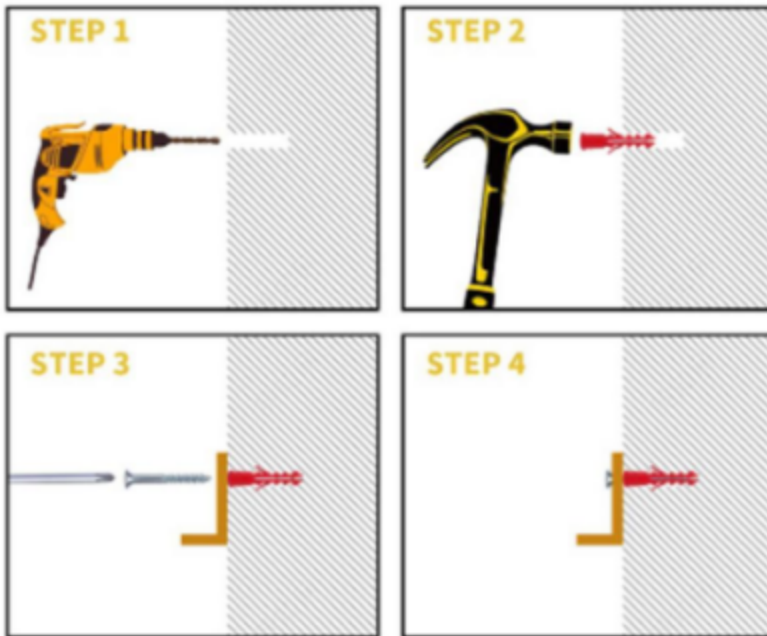

4. Connect the fixture wires to the power supply.

Connect the Live wire to the red/black wire on the fixture.

Connect the Neutral wire to the blue/white wire on the fixture.

5. Assemble the light body as illustrated.



The installation is complete.

Your fixture is now assembled and ready to use.