

Installation Guide

Tools Required

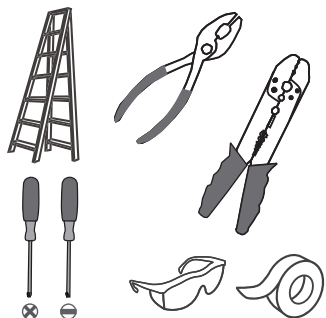

Light Source

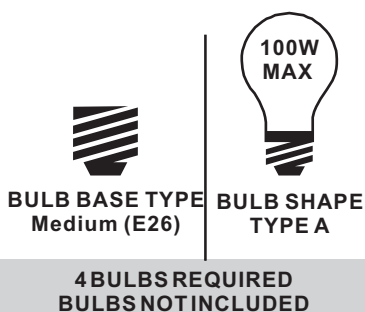

⚠ Warnings and Cautions

Turn off the electricity at the circuit breaker before installation. Consult a licensed electrician if in doubt about installation.

Turn off power to the fixture and allow the bulbs to cool before replacing.

Package Contents

Preparation: Identify and inspect all parts before beginning the installation.

Missing or damaged parts? Contact your original place of purchase.

PARTS BAG



A

Mounting Screw
x 4

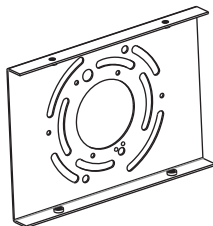

B

Inner Backplate
x 1



C

Outlet Box Screw
x 2



D

Wire Connector
x 3

Note: Shade shape is for illustration purpose only. Your shade shape may vary from illustration.

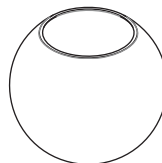

E

Shade (Varies according to style purchased)
x 4

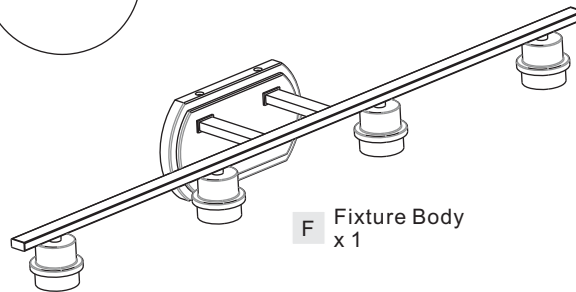

F

Fixture Body
x 1

Table of Contents

Inner Backplate

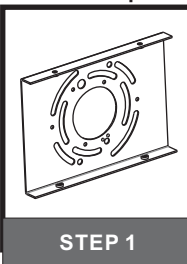

STEP 1

Wiring

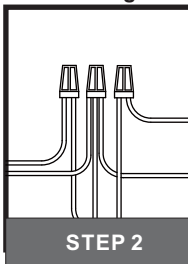

STEP 2

Fixture Body

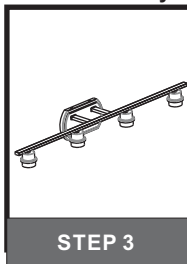

STEP 3

Shade & Bulb

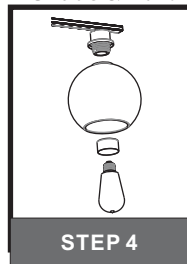

STEP 4

STEP 1

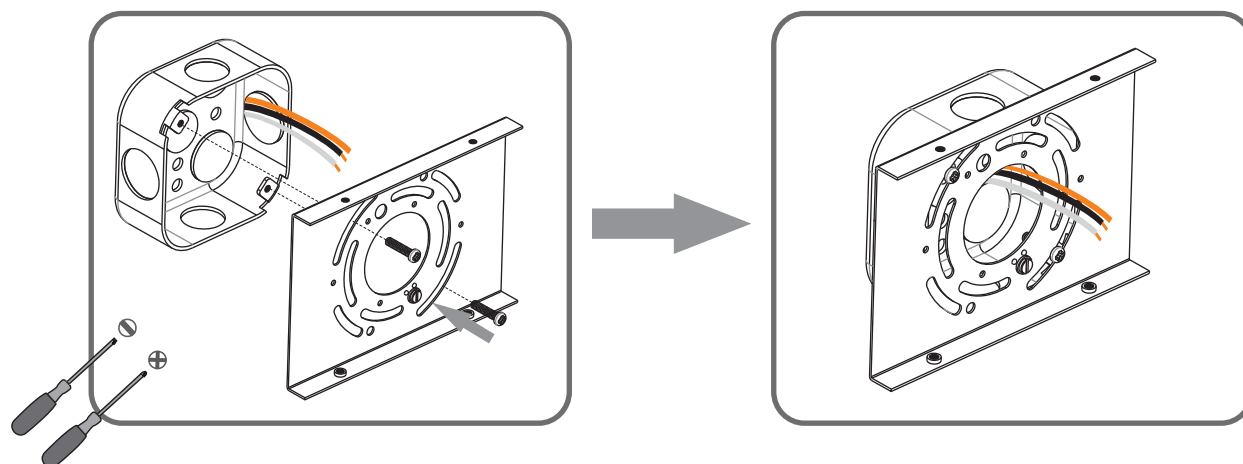

STEP 2

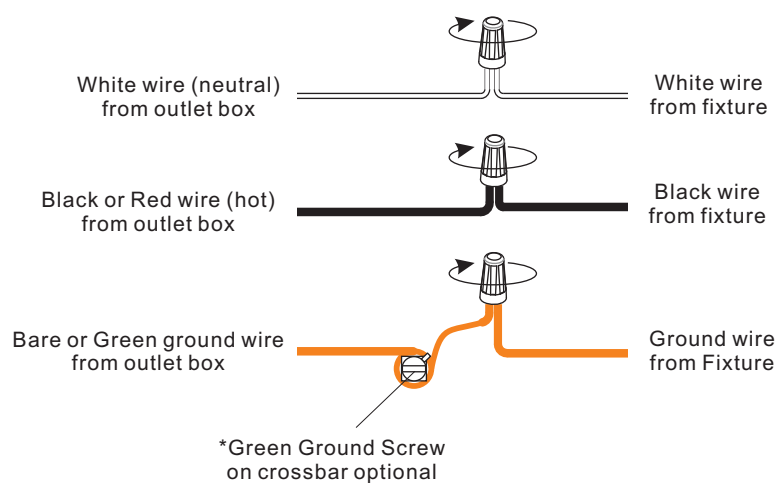

STEP 3

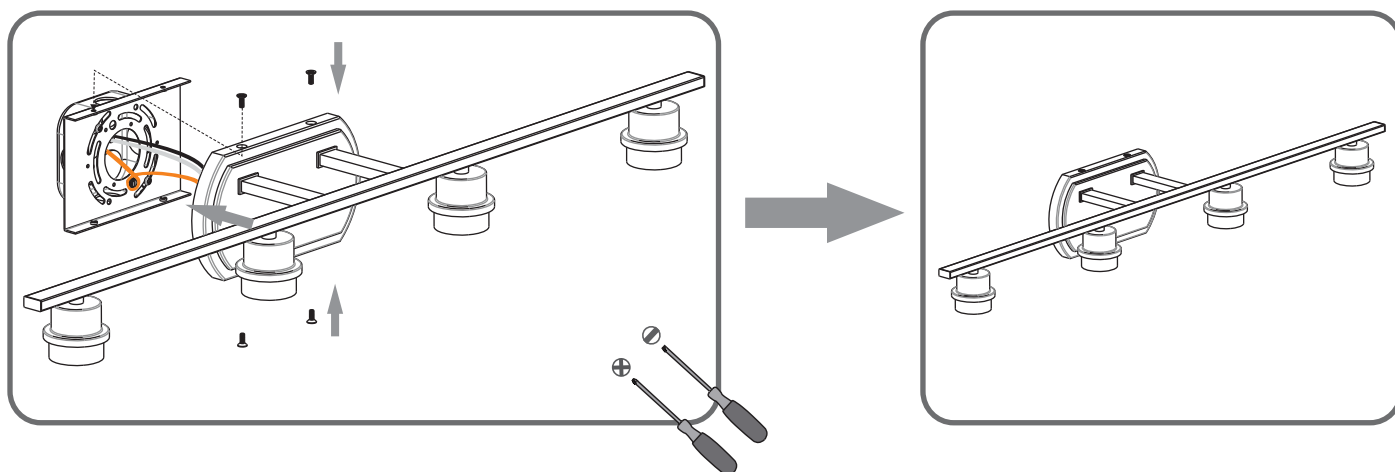

STEP 4

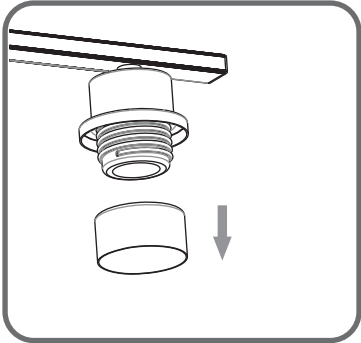
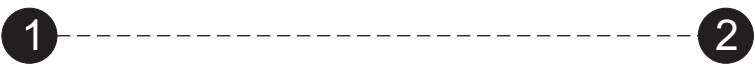

Note: Shade shape is for illustration purpose only. Your shade shape may vary from illustration.

