



ZIPPITY

Easy Does It!

BURBANK VINYL PICKET FENCE 2-PACK (44" W X 41"H)

ASSEMBLY INSTRUCTIONS ZP19057

45 MIN

Approximate assembly time for 2 panels

Want to see a video on how to
assemble this product?
Scan the QR code

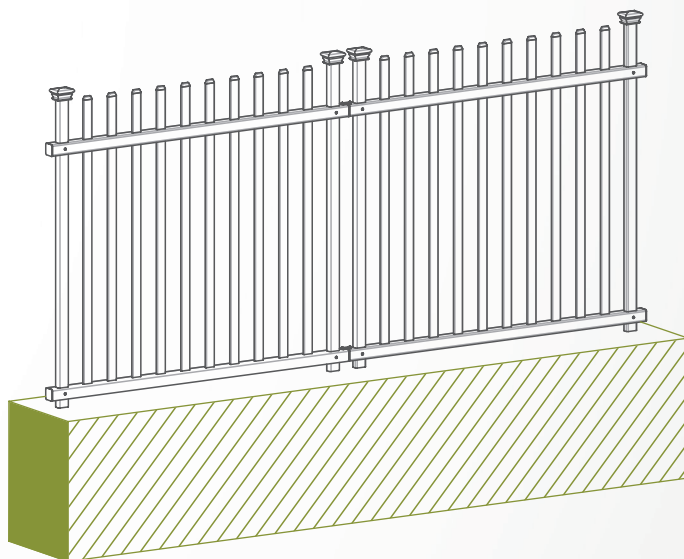
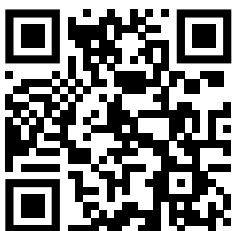

GENERAL INFORMATION



IMPORTANT

- Check the inside of the larger pieces in your box for other materials packed inside.
- When assembling components, place on a non-abrasive surface (i.e. shipping box) to avoid scratching.
- We recommend an area approximately 5'x 8' for unobstructed assembling.
- You should not need to use excessive force when assembling components.

MISSING OR DAMAGED PARTS?

VISIT OUR WEBSITE FIRST, SO WE CAN HELP YOU RIGHT AWAY!

Although great care has been taken to ensure proper packaging and handling of this product, occasionally problems occur. If you discover any missing, damaged or defective parts, please visit our website to order replacement parts. If you experience any further trouble with your product, please contact our customer service department.

 parts.nychbrands.com

 support@zippity-outdoor.com

 **704-892-5222 / 877-234-6196**

Customer service agents are available to take calls weekdays from 9am-5pm EST. If you call outside of business hours, please leave a voicemail.

To help you quickly and accurately, please have reference item number **ZP19057** and the specific part name which can be found on page 4. It is helpful if you can provide the batch lot which is a stamped number on the inside of the box.

NEED ASSEMBLY HELP?

If you are having problems with the assembly or installation of this product, we are happy to assist you with the process, **so please give us a call at 704-892-5222 / 877-234-6196.**

NEED TO RETURN?

If for some reason you need to return this product, please allow us to help resolve your issues first. If you still decide to return the product, **you will need to initiate the return from the company you originally purchased from.**

Detailed Product Dimensions & Specifications

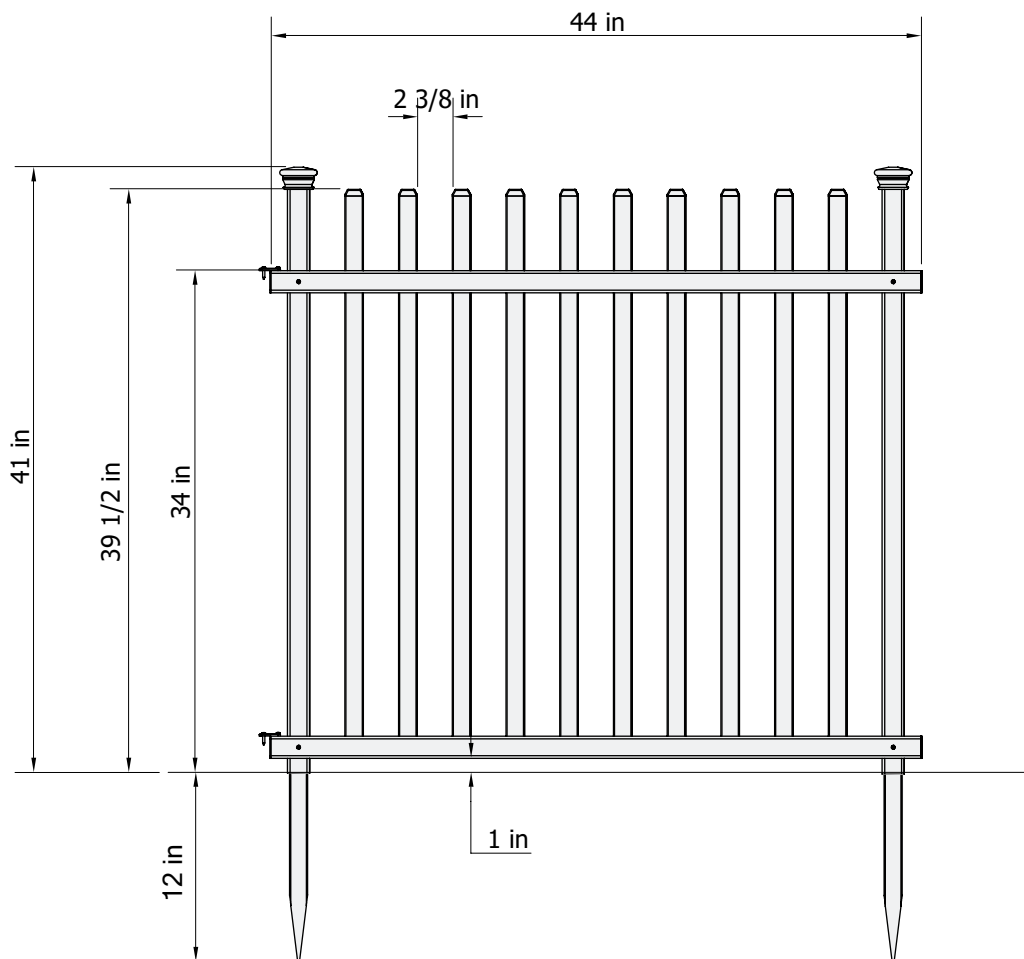

STEP 1: LAY OUT MATERIALS

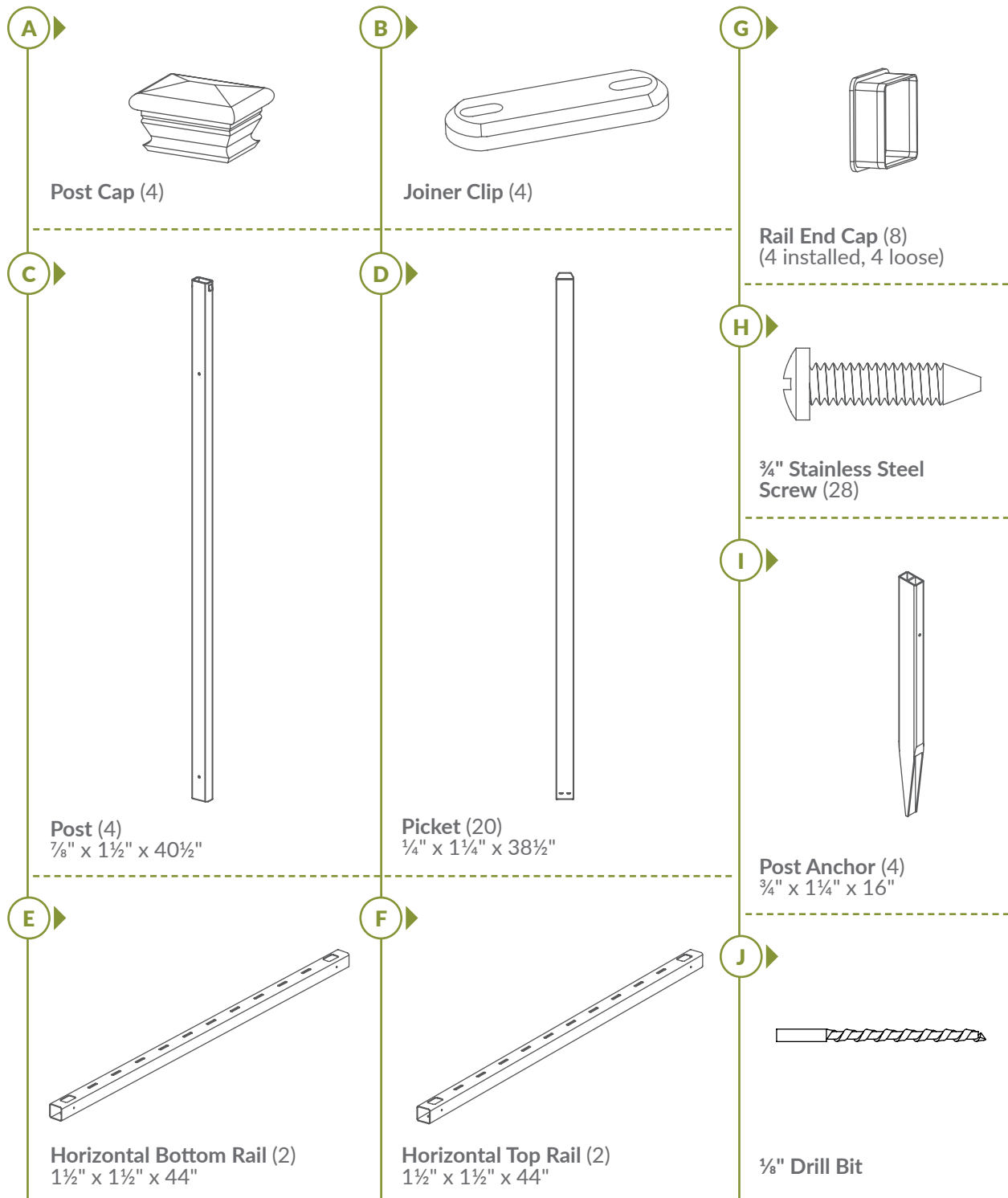

STEP 2: ASSEMBLE FENCE FRAME

STEP 2.1 ▶

- ▶ Identify the Top Rail (**F**), and Bottom Rail (**E**) as shown below. Pressure fit (1) loose Rail End Cap (**G**) into the end of each rail.

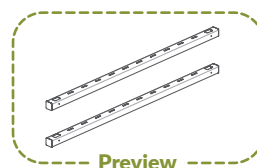
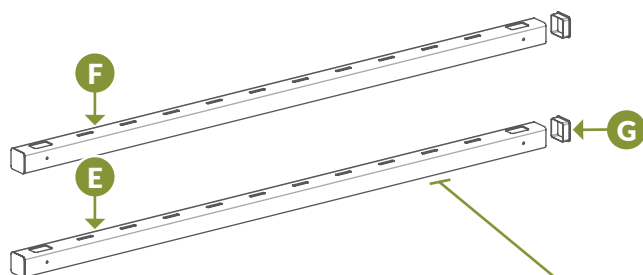

Note: Bottom rails only have picket holes on one side.

STEP 2.2 ▶

1. Orient (2) Posts (**C**) with the post tabs facing down.
2. Slide (1) top rail down over the posts until the pre-drilled holes in the posts and top rail align.
3. Drive (4) $\frac{3}{4}$ " Stainless Steel Screws (**H**) into the pre-drilled holes in the top rail.

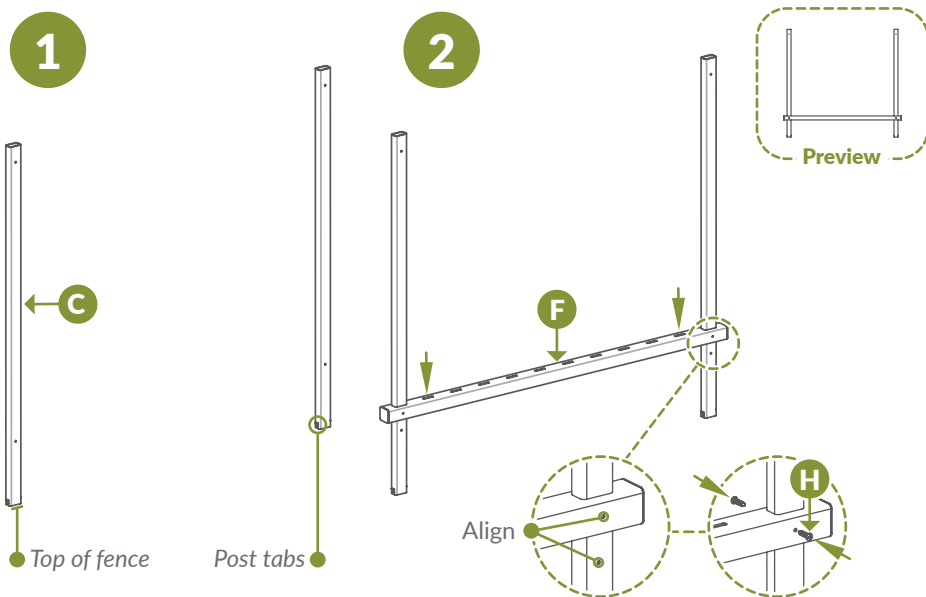

STEP 2.3

► Slide bottom rail over the posts and align the pre-drilled holes in the posts with the pre-drilled holes in the bottom rail.

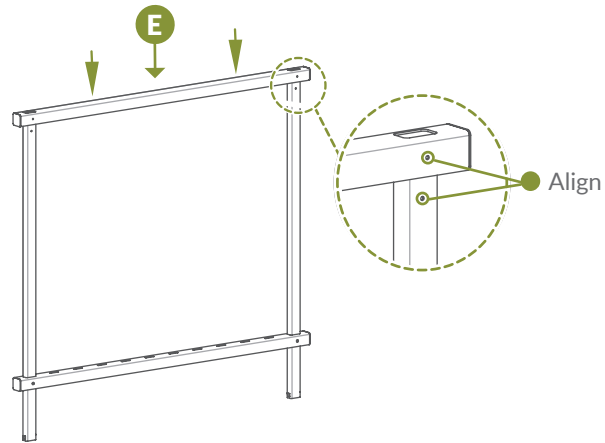
1**STEP 2.4**

1. Slide the bottom rail, with picket holes facing towards the top rail, over the posts until the pre-drilled holes align.
2. Slide the Post Anchors (I) up the posts until the pre-drilled holes in the anchors align with the pre-drilled holes on the bottom of the posts.
3. Drive (2) $\frac{3}{4}$ " stainless steel screws into the pre-drilled holes in the bottom of the posts.
4. Drill holes in the post anchor through the (4) pre-drilled holes in the bottom rail using the $\frac{1}{8}$ " Drill Bit (J).
5. Drive (4) $\frac{3}{4}$ " stainless steel screws into the pre-drilled holes in the bottom rail.

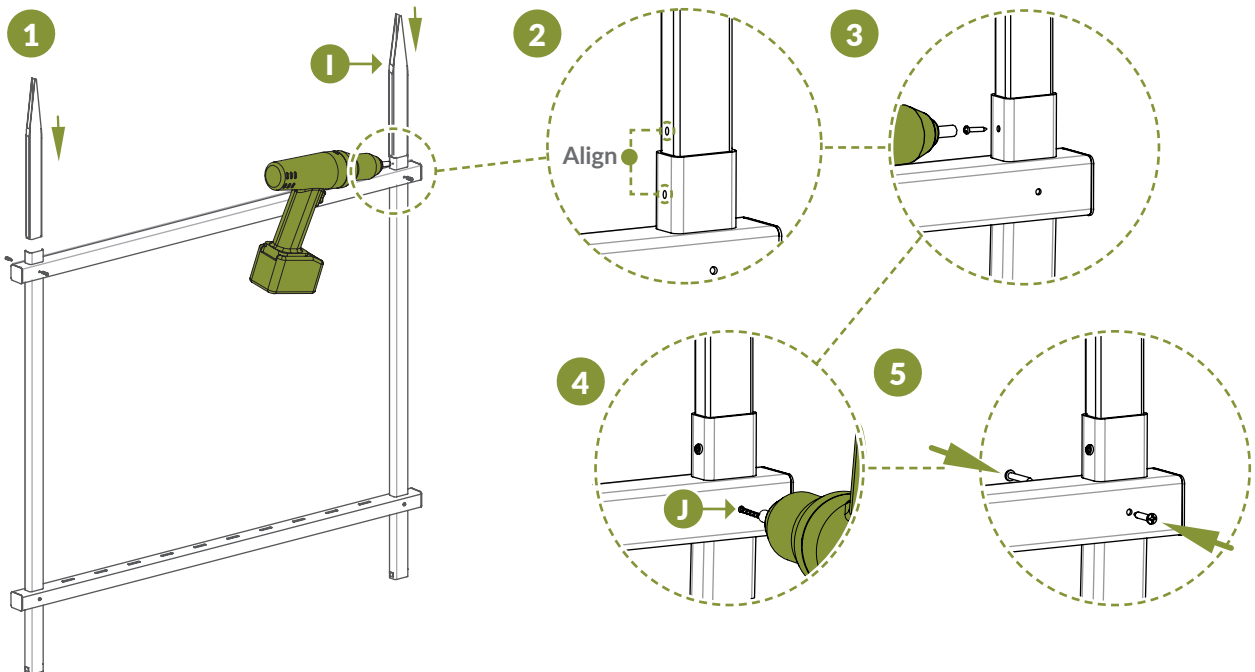

STEP 3: INSERT FENCE PICKETS

STEP 3.1 ▶

1. Rotate the fence panel so the ground stakes face down. Insert (1) Picket (D) into the rails until it locks in the bottom rail.

2. Insert (9) additional pickets into the pre-drilled holes in the rails.

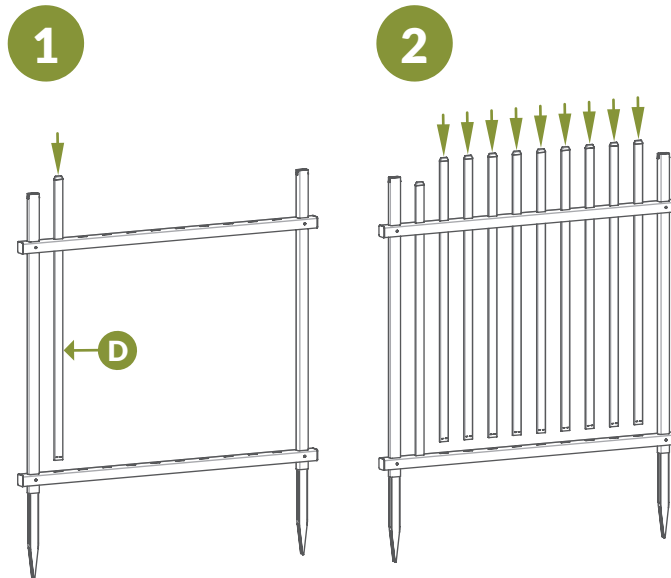

STEP 4: ASSEMBLE SECOND FENCE PANEL

STEP 4.1 ▶

▶ Repeat steps 2-3 to assemble the second fence panel.

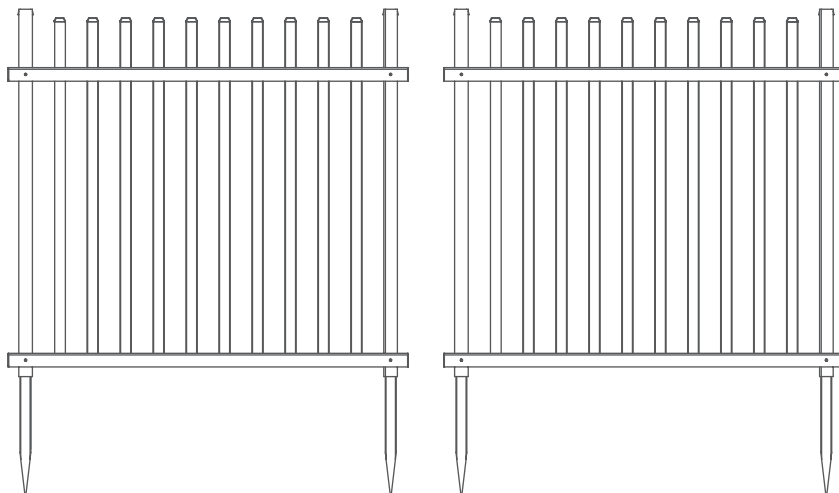

STEP 5: INSTALL FENCE INTO GROUND

STEP 5.1 ▶

1. Move the fence to its final location and mark the locations of the posts.

2. Attempt to push the fence into the ground.

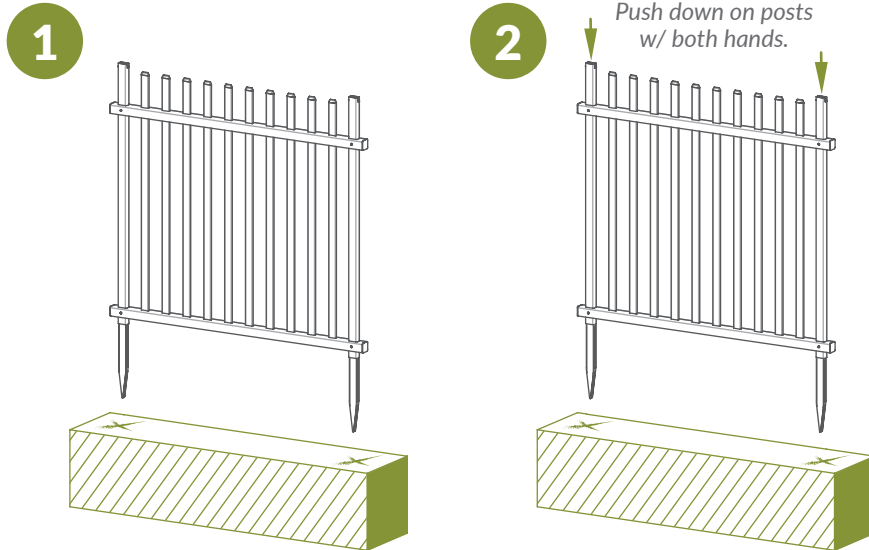

STEP 5.2 ▶

► *Steps 5.2 - 5.3 only to be completed if ground is too hard for Step 5.1*

1. Loosen the top 6" or 7" of the ground with a claw hammer as illustrated.

2. Add water to loosened soil.

3. Use a block of wood to protect the top of post, and gently hammer the post into the ground.

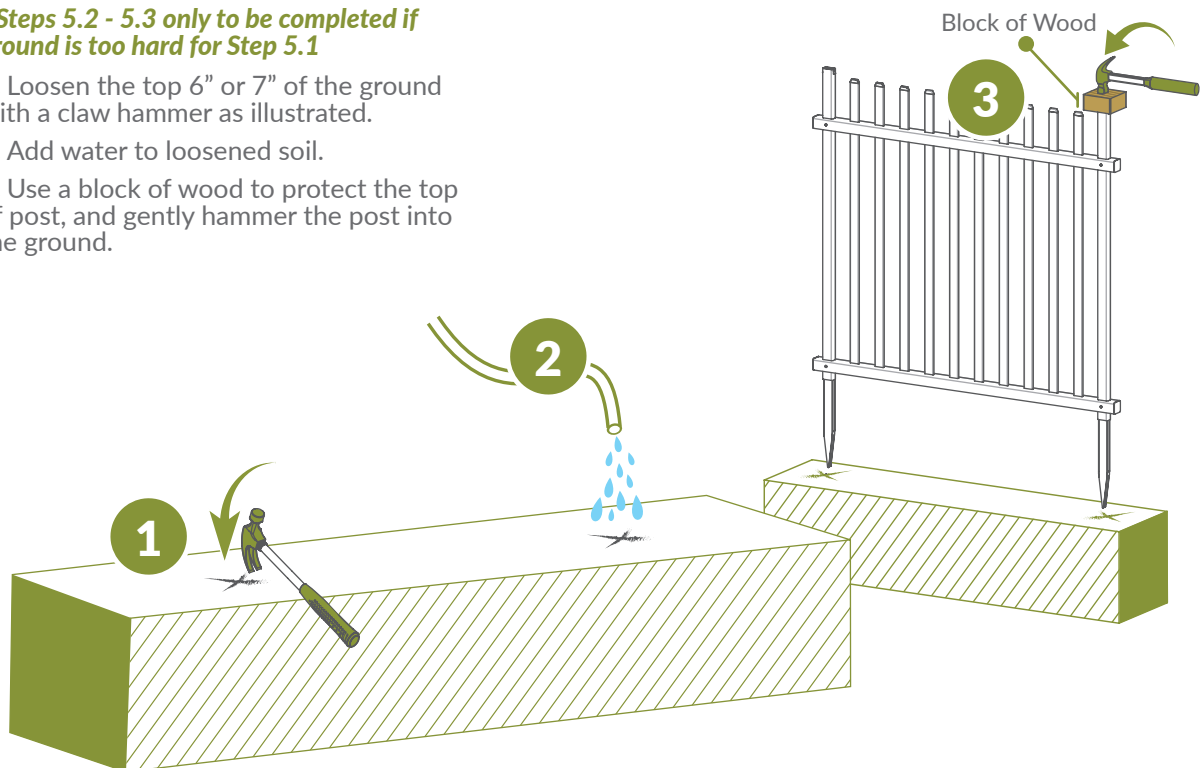

STEP 5.3 ▶

▶ If the ground is too hard, you may need to dig a hole large enough to accommodate one post from each panel in the same hole, as shown below.

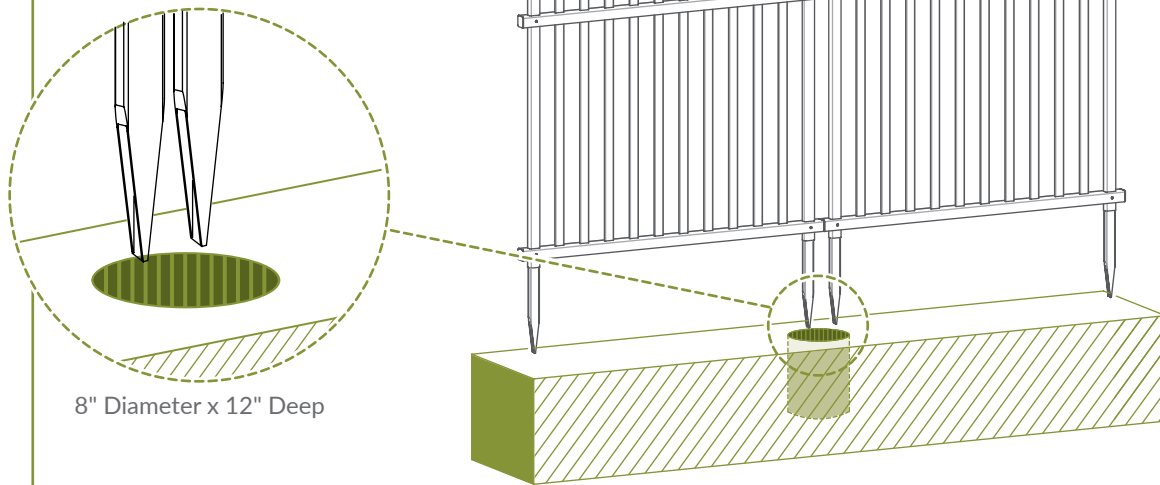
**STEP 5.4** ▶

▶ Level the screen, backfill excavated dirt, and tamp as necessary.

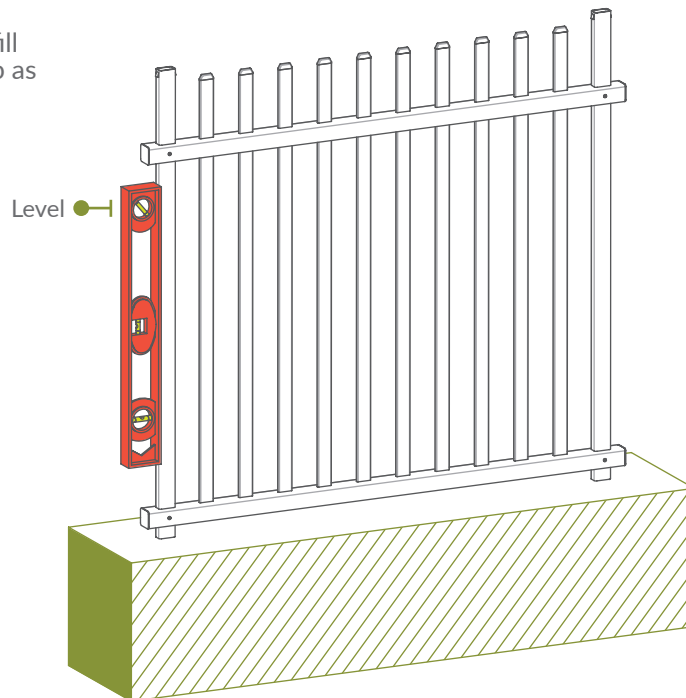

STEP 6: CONNECT THE FENCE PANELS

STEP 6.1 ▶

1. Straight Line Application: Fasten screens together with Joiner Clips (B) using (4) 3/4" stainless steel screws as illustrated.

1. Corner Application: Fasten screens together with Joiner Clips (B) using (4) 3/4" stainless steel screws as illustrated.

NOTE: Use the 1/8" drill bit to pre-drill holes in the rails as needed for joiner clip installation.

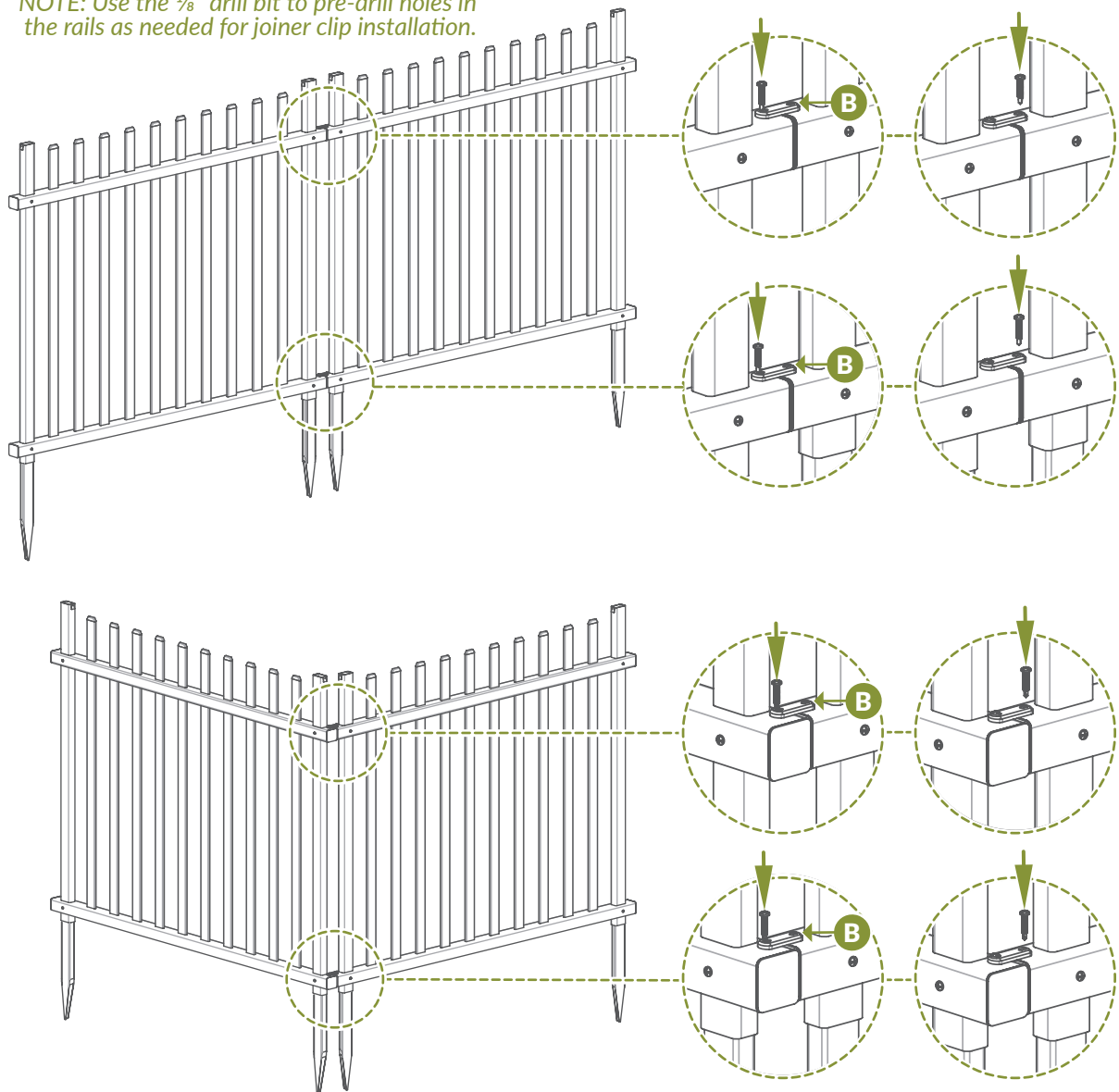

STEP 7: INSTALL POST CAPS

STEP 7.1 ▶

▶ Push the Post Caps
(A) down over the
posts to lock into
place.

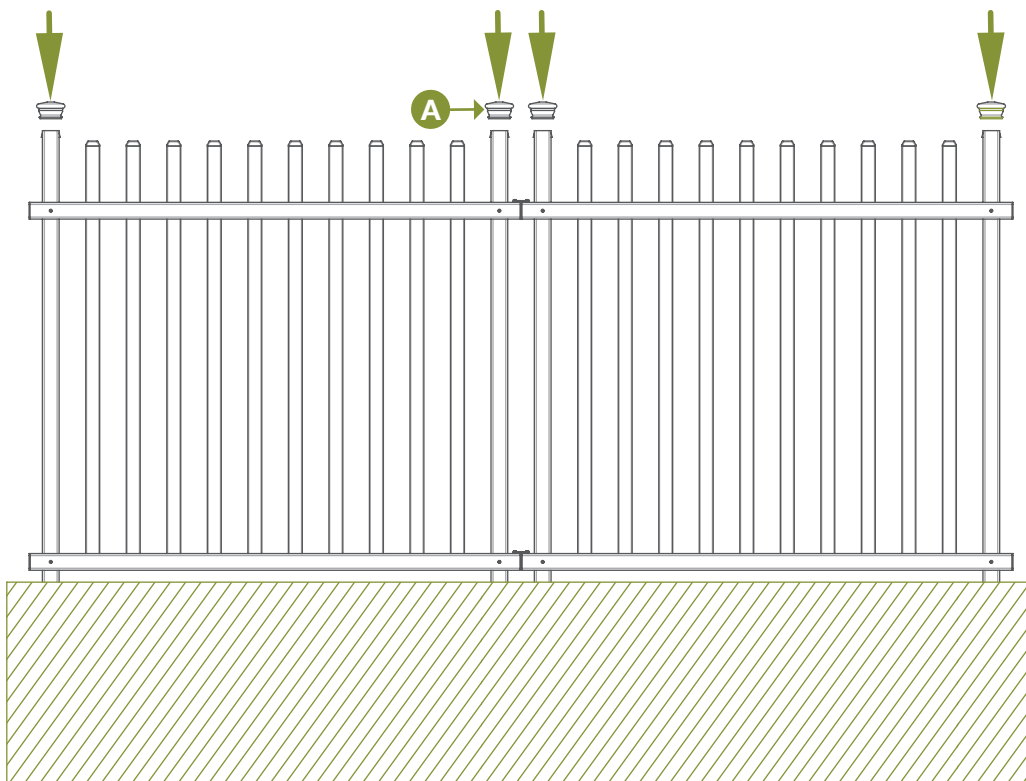



ZIPPITY

Easy Does It!



6935 Reames Rd. Ste. K.
Charlotte, NC 28216



support@zippity-outdoor.com

704-892-5222
877-234-6196



WWW.ZIPPITY-OUTDOOR.COM