

# Vertical Blind Installation and Care Instructions

## Recommended Tools

- Phillips head screwdriver
- Pencil
- Level
- Tape measure
- Safety glasses
- Drill/drill bits (1/16" drill bit may be used to pre-drill for screws)
- Drywall anchors (not included)

## Step 1

*Mark the bracket locations — outside-mount installation*

- Position one bracket at each end of the headrail, 3" in from the ends.
- Space any remaining brackets evenly, not more than 30" apart.
- Mark the bracket mounting hole locations at the desired height, making sure they are level and square. Allow at least 1/2" clearance for vanes above the floor or sill.

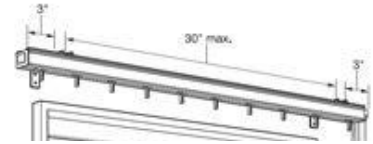

## Step 2

*Install the brackets— outside-mount installation*

- If mounting into drywall or plaster, use 3/16" drill bit and insert wall anchors (not included) before inserting screws.

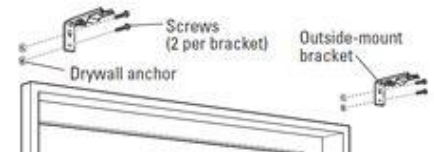

## Step 3

*Attach the headrail*

- **NOTE: For wide windows and sliding glass doors, two people are recommended for installing the headrail.**
- With the bracket positioned as shown, fit the top front lip of the headrail into the front part of the spring clip.
- Tip the back of the headrail up into the spring clip until it locks with a clicking sound.

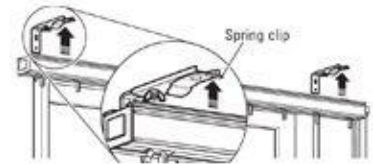

## Step 4

*Center the vane rotation*

- Attach the wand.
- Rotate the wand so that the vane clips are at a right angle to the window.

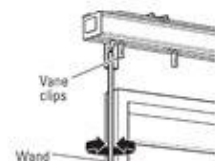

## Step 5

*Attach the vanes*

- Starting at one end, align the rectangular hole in the vane with the clip.
- Slide the vane fully into the clip; then pull down slightly to lock the hook on the clip into place. Repeat for the remaining vanes, making sure that all vanes are facing in the same direction.

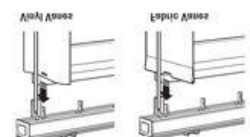

## Step 6

*Test the vane rotation*

- Turn the wand in alternate directions to ensure that the vanes rotate smoothly in both directions.

## Step 7

*Test the traverse*

- With the vanes in the open position (vanes at a right angle to the window), slide the wand in alternate directions to ensure that the vanes move smoothly in both directions.

## Step 8

*Install Valance Clips*

- Position one clip at each end of the headrail, next to the headrail mounting bracket locations. Make sure that the clips do not interfere with the mounting brackets.
- With the clip positioned as shown, rest front leg of the clip in the front channel of the track. Rotate the back leg down until you hear a click.
- Space remaining clips evenly between the ends, not more than 30" apart.

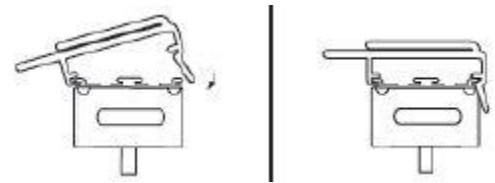

## Step 9

*Attach valance to the track*

- Slide the valance dust cover into the valance clips.

## Step 10

*Attach valance returns*

- Insert the ends of the valance and returns into the valance corner slots.

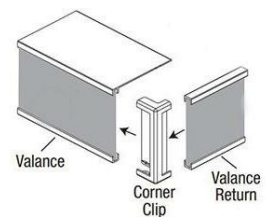

## Cleaning and Care

**Vinyl Vanes:** Dust or vacuum with an upholstery attachment. For soil removal, sponge with a mild detergent and warm water solution and blot dry. Vinyl or PVC vanes may be removed and immersed in water. Also, if a thin film of mild detergent is left on vanes, it will eliminate static electricity.

**Fabric Vanes:** Dust or vacuum with an upholstery attachment. For soil removal, sponge with a mild detergent and warm water solution (or dry fabric cleaner) and blot dry. Do not immerse in water or dry clean.