

Instruction Manual

Flush Mount Ceiling Light



If you have any questions, please contact us directly for a faster and better solution.

ATTENTION

1. Please check each part before installation.
2. Please turn off the power supply in your home before hard-wiring it.
3. Please use this product in a dry environment.

QUESTION & ANSWER

Q: After powering on, my lamp doesn't work. What should I do?

A: First, make sure your bulbs are working well. If your bulbs work, but not on the lamp, please pull the legs of the bulbs to the sides. This operation is to ensure that the bulb makes good contact with the copper in the bulb socket.

FACTORY STORY

Our first factory was established in 2000, and we have since specialized in farmhouse-style lamps and have supplied over 1 million products throughout the world for over 20 years. Our factory is involved in ceiling lights, pendant lights, chandeliers, wall lights, and island lights, and we are dedicated to solving the basic problems of daily lighting for our customers.

To save our customers' time and effort in shopping and using our lamps, we do our best to provide every customer with high-quality products and 24/7 service with a long-term warranty. If there is any issue, please feel free to let us know. We will do our best to make it right and let you shop with a smile.

A LETTER TO MY PRECIOUS CUSTOMER

Dear Customer,

Thanks for choosing this lamp! To save your time and effort, please try to light up the lamp before installation to ensure the sockets are working correctly. If you have any issue when you receive it, please contact us directly through "Amazon Message" or our email address at "light_server001@outlook.com". We will offer a solution without you even having to send the broken light back. Thank you for your support!

-Customer Support Team

FEATURES

1. 6-sockets design, each bulb supports up to 40 watts.
2. Comes with a glove to prevent fingerprints.
3. This color will match your home decor nicely.
4. Comes with all hardware for quick installation.
5. Use high-quality crystals for a more beautiful refraction effect.
6. Comes with anti-injury caps on the steel wires to keep you safe.
7. Compatible with LED/HALOGEN G9 bulbs.
8. It is highly recommended to use LED bulbs. HALOGEN bulbs will get a little hot.

INFORMATION AND PACKAGE

Specification		Package List	
Voltage	110-120V	Ceiling Canopy with Bulb Holder	1
Bulb Socket	G9 Base	Brunch of Crystal	36
Wattage	Max 40W x 6	Glove	1
Bulb Type	LED/Halogen	Pack of Hardware	1
Certification	Bulb Socket(s) is UL Listed		
Warranty	2 Years		

INSTALLATION

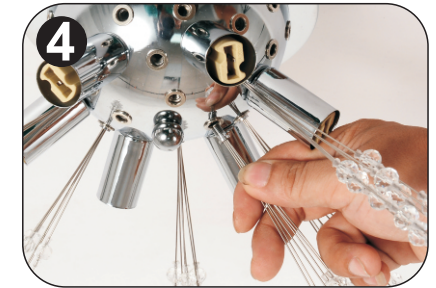
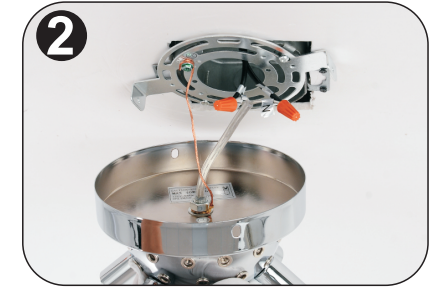
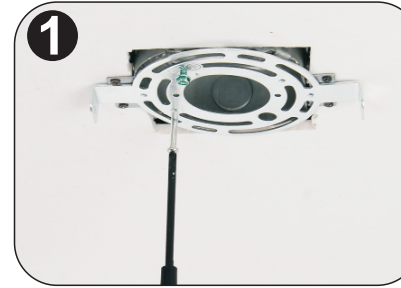

1. Attach the metal bracket to your junction box with Phillips head screws. (Anchor screws are only useful for those customers who do not have a junction box).
2. Connect the "L" wire to your "live" wire through the orange terminal caps and the "N" wire to your "neutral" wire, the copper wire needs to be wrapped around the green screw.
3. Attach the canopy to the metal bracket with screws.
4. Screw the crystal harnesses to the holes of the ceiling base (please don't cut off the zip ties).
5. Insert the bulbs into the ceiling light. (Bulbs not included).
6. When you finish the installation, you can cut off the zip ties.