

Before you begin

I. Important Safety Instructions:

- Please read these instructions carefully to familiarize yourself with the required tools, materials, and installation sequences. Follow the sections that pertain to your particular installation. This will help you avoid costly mistakes. In addition to proper installation, read all operating and safety instructions.
- All information in these instructions is based upon the latest product information available at the time of publication. Reserves the right to make changes in product characteristics, packaging, or availability at any time without notice.
- These instructions contain important care, cleaning, and warranty information-please leave instructions for the consumer.
- Before installation carefully inspect the new fixture for any signs of damage.
- Assembly by two or more adults is highly recommended.
- To connect the wires to electrical junction box, a qualified technician or electrician is highly recommended.
- Ensure that the fixing location is able to take the weight of the complete fitting.(solid stone/brick walls).

2. Pre-assembly:

- After opening the package, inspect the product immediately upon receipt for transit damage or missing parts.
- Keep the voltages between 100V and 120V. If the voltage exceeds 120V, please use transformer.
- You can connect the wires directly to your junction box or the plug.



WARNING: Risk of electrical shock.

A licensed electrician should make all electrical connections.



WARNING: Risk of electrical shock.

Connect only to a circuit protected by a typical two-pole circuit breaker.



WARNING: Risk of electrical shock.

Disconnect power before servicing.

INSTALLATION DIAGRAM DISPLAY

TOOLS REQUIRED

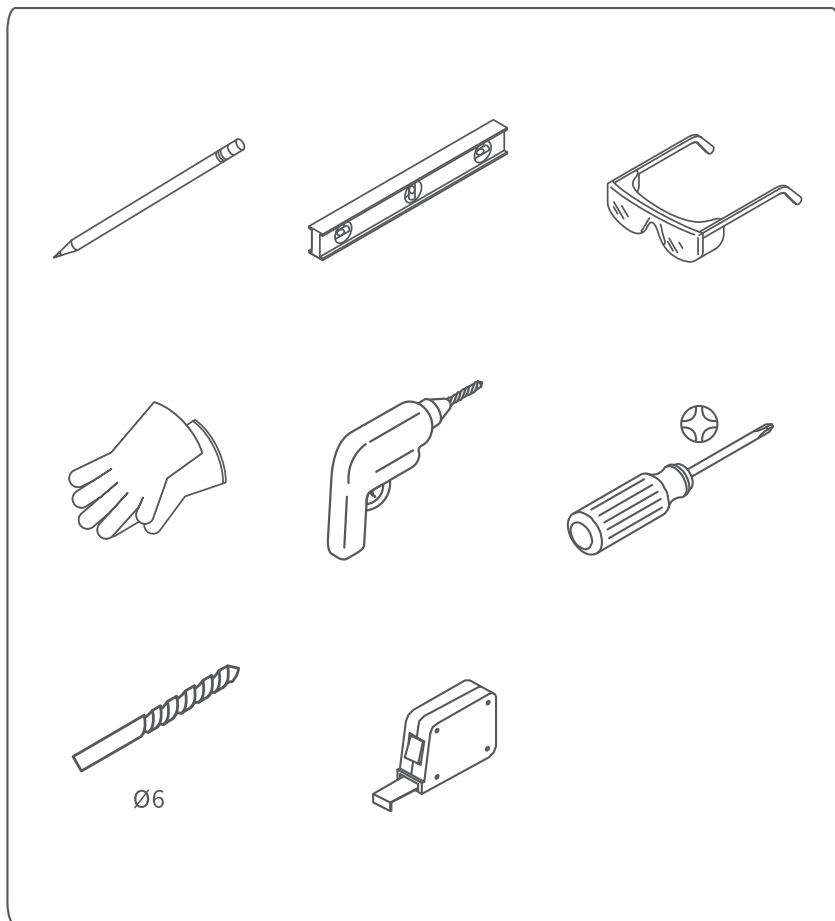

ACCESSORIS LIST

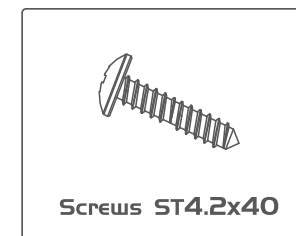
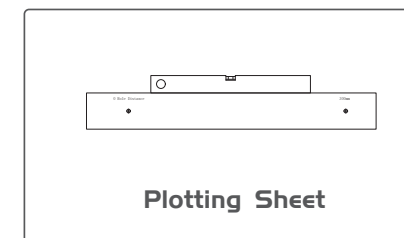
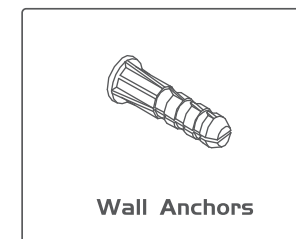

Step 1

Prepare the tools

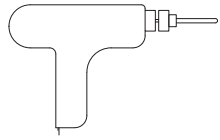

Percussion drill

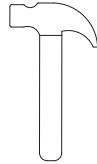

hammer

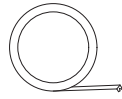

tape measure



pencil

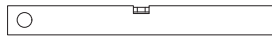

levelling instrument

Step 2

Mark point ①② or ①③ on the wall with a marker pen based on the corresponding product size and positioning paper

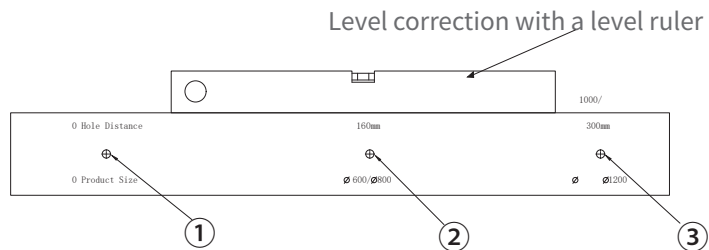

Step 3

Use an impact drill to install a 6mm drill bit and drill a hole with a depth of 45mm on the marked positioning hole. Then, use a hammer to hammer the expansion screw tube into the marked positioning hole

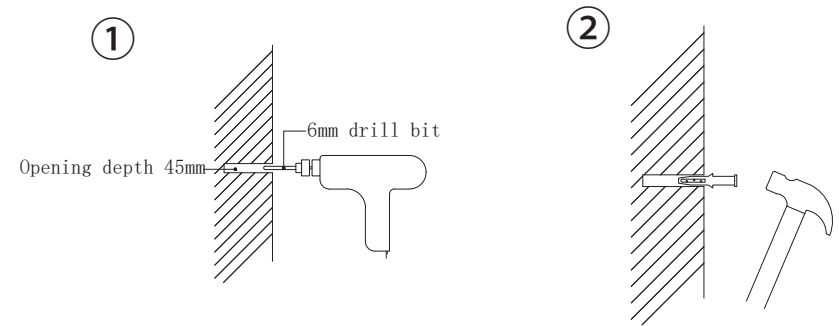

Step 4

Lock the screws into the expansion screw tube, leaving a distance of 7mm to the wall.

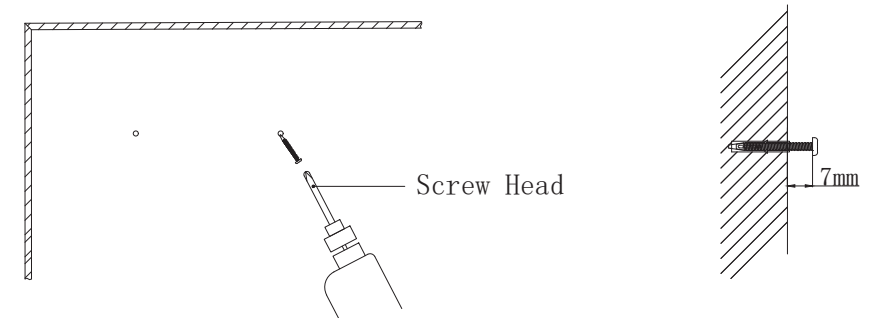

Step 5

Hang the two hooks of the mirror corresponding to the two screws on the wall, push them tightly to the left or right, and ensure that they are inserted into the correct position and securely suspended.

(PS: It is recommended to install it by two people)

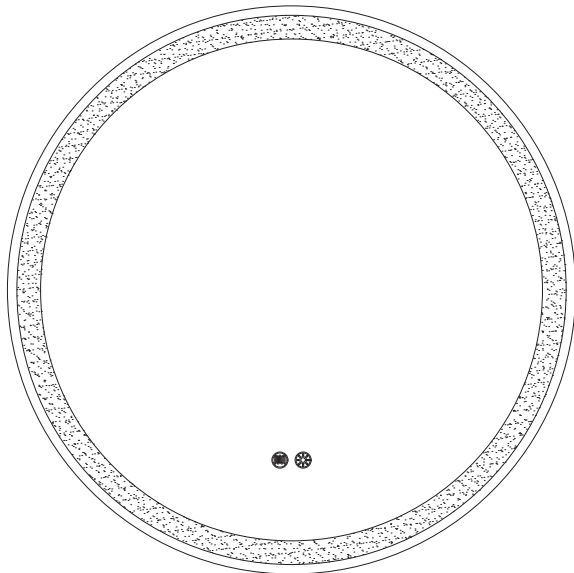
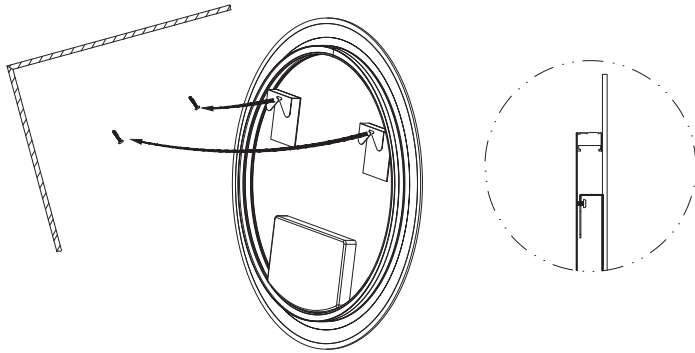

Connect the power (Suitable for lamp mirrors)

- There are three power wires behind the mirror, including the live wire (black), the neutral wire (white) and the ground wire (green). You can connect the wires to standard switched lighting circuit or plug.

- If you want to connect power wires to plug, you can refer to the steps:

- ① Remove the plug cover.
- ② Unscrew the screws on each of the plug's pins.
- ③ Insert the tisted copper wires into the holes in the pins.
- ④ Tighten the little screw on each of the plug's pins.
- ⑤ Make sure the wire is tightly clamped by the brake or clip.
- ⑥ Replace the cover of the plug.

Other power connection methods are on the same principle.

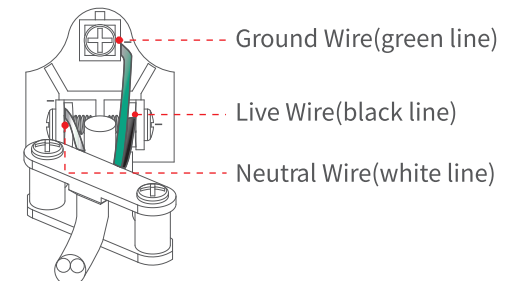
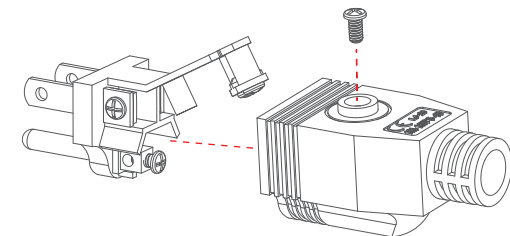

Power checking mirror (Products without lights are not applicable)

• **Please check to make sure the mirror is working properly**

When the power is switched on, the two circular buttons turn white, and the LED and anti-fog functions have been turned on automatically. If you don't need to use either of them, just touch it off and then the button will be dimmed.

 **is the smart switch.**

Tricolor light: This switch can control the light brightness and color temperature switch. Keep holding it down and the brightness will change. You can adjust the color of the light to your liking: white light for the first touch, yellow for the second touch, and natural light for the third touch. Monochrome lamp: This switch can control the light brightness. Keep holding it down and the brightness will change.

 **is the anti-fog switch.**

When you are not using it, remember to turn off the switch to prevent wasting energy. Anti-fog film working principle: Anti-fog film can effectively convert electric energy into heat, and transfer heat directly to the mirror, so that the mirror temperature. Specific power to maintain constant temperature, effectively prevent water vapor condensation on the mirror, play the role of anti-fog.

