

Coffee Table

IMPORTANT

Carefully remove all the parts from the carton and place them individually on a soft cloth to prevent scratches or other damage.

Carefully and strictly follow these assembly instructions to ensure a completed product as designed.

Do not use power tools above 8 volts to assemble.

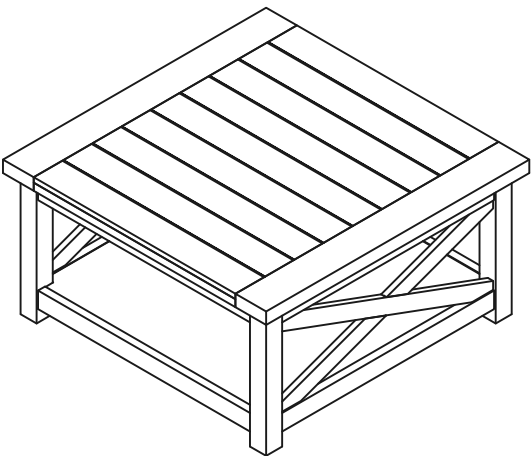

Part List

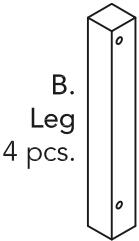
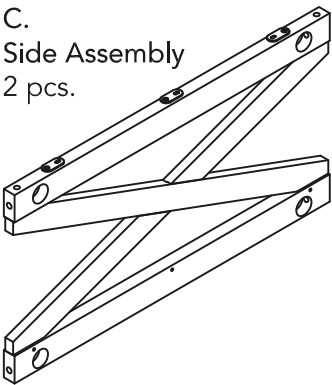
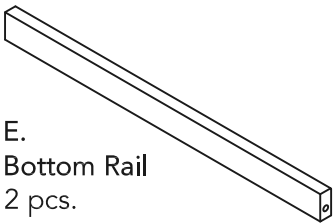
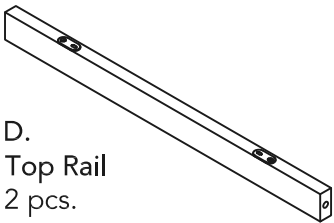
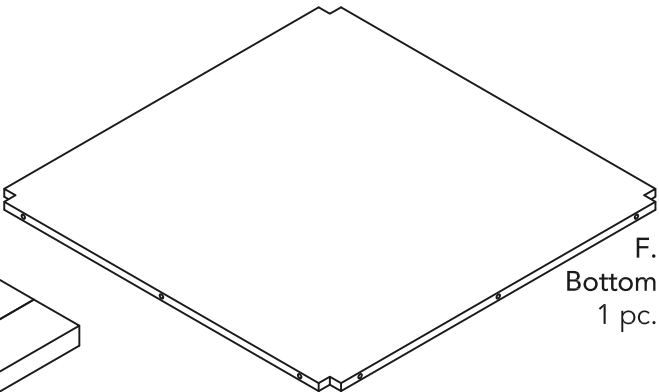
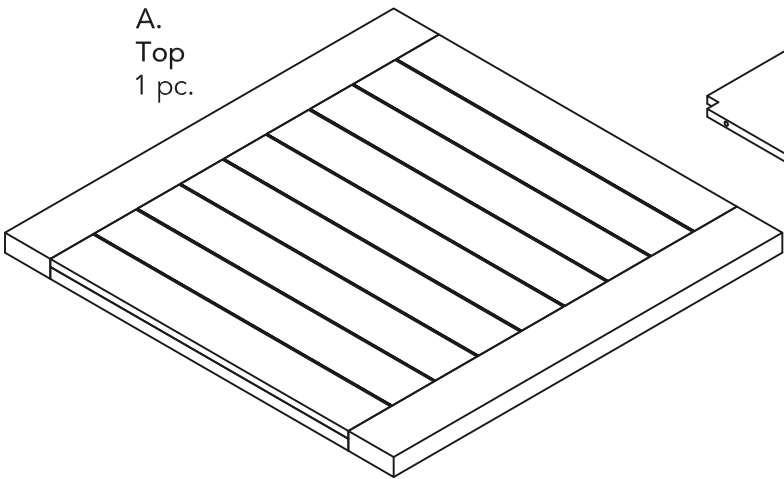

Hardware List



Cam Lock Screw
12 pcs. (+2 extra)



Cam Lock
12 pcs. (+2 extra)



M4x19
3/4" Flat Head Screw
10 pcs. (+1 extra)

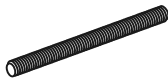

5/16"x3 5/32"
Bolt
16 pcs. (+1 extra)



Flat Washer
16 pcs. (+1 extra)



Nut
16 pcs. (+1 extra)



Wrench
1 pc.

Tool(s) required for assembly: Phillips screwdriver, Level

Assembly Instructions 2/4

IMPORTANT

- Use a soft cloth between these parts and the floor.
- Do not use power tools above 8 volts to assemble.
- Do not tighten all the screws until each part is properly assembled.
- The unit must be level to work properly. Use the included adjustable levelers to level.
- Keep Wrench in a safe place as the Nuts may need to be tightened up in the future.

STEP 1

Insert Cam Lock Screws into the pre-drilled holes of Side Assemblies (C) and Bottom Rails (E).

Insert Bolts into the pre-drilled holes of Legs (B).

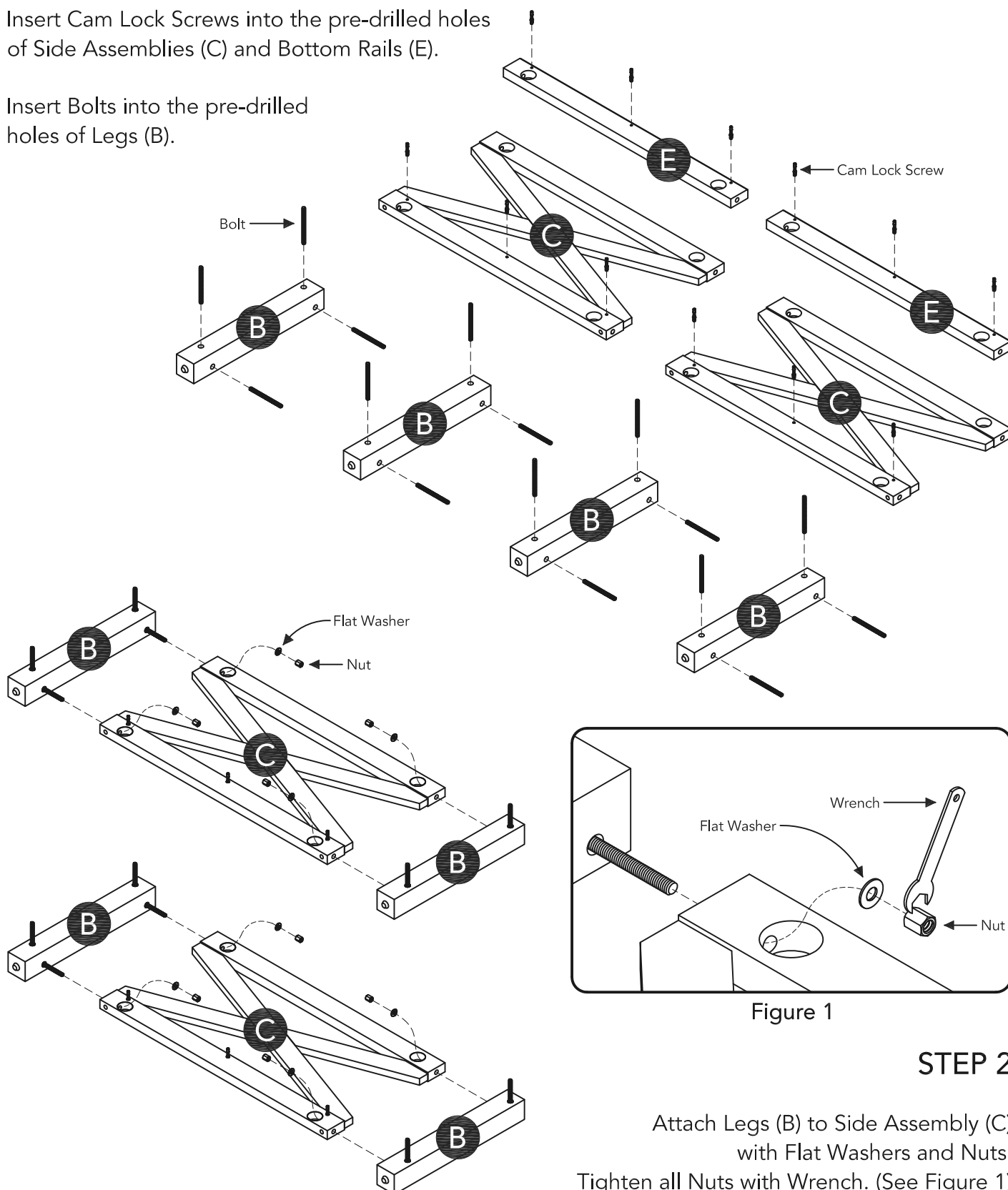

Figure 1

STEP 2

Attach Legs (B) to Side Assembly (C) with Flat Washers and Nuts. Tighten all Nuts with Wrench. (See Figure 1)

Assembly Instructions 3/4

STEP 3

Attach Bottom Rails (E) to Bottom (F) with Cam Locks.
(See Figure 2)

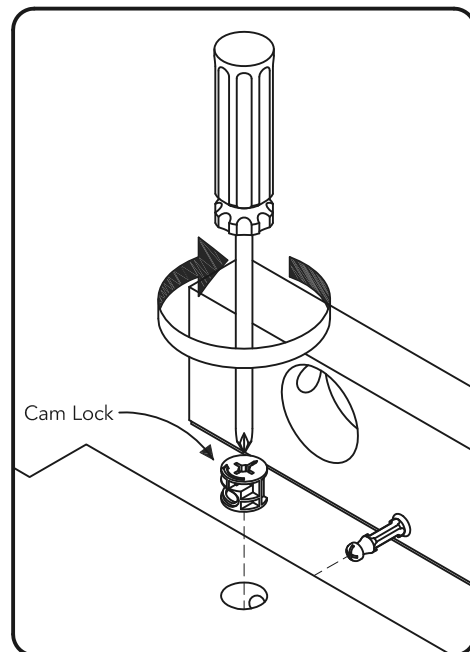
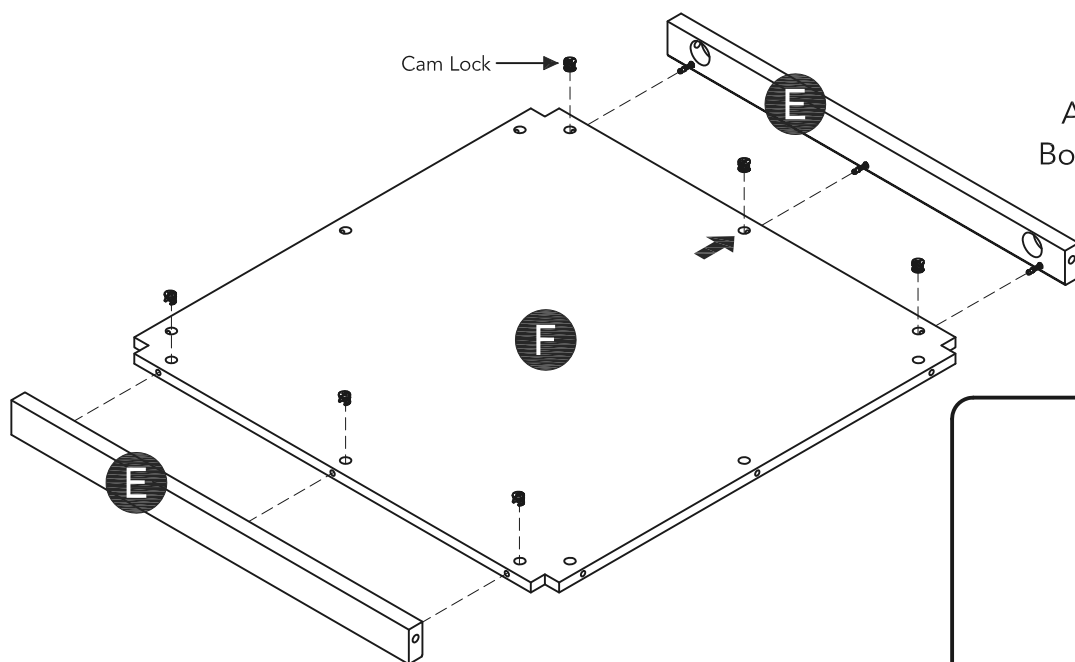
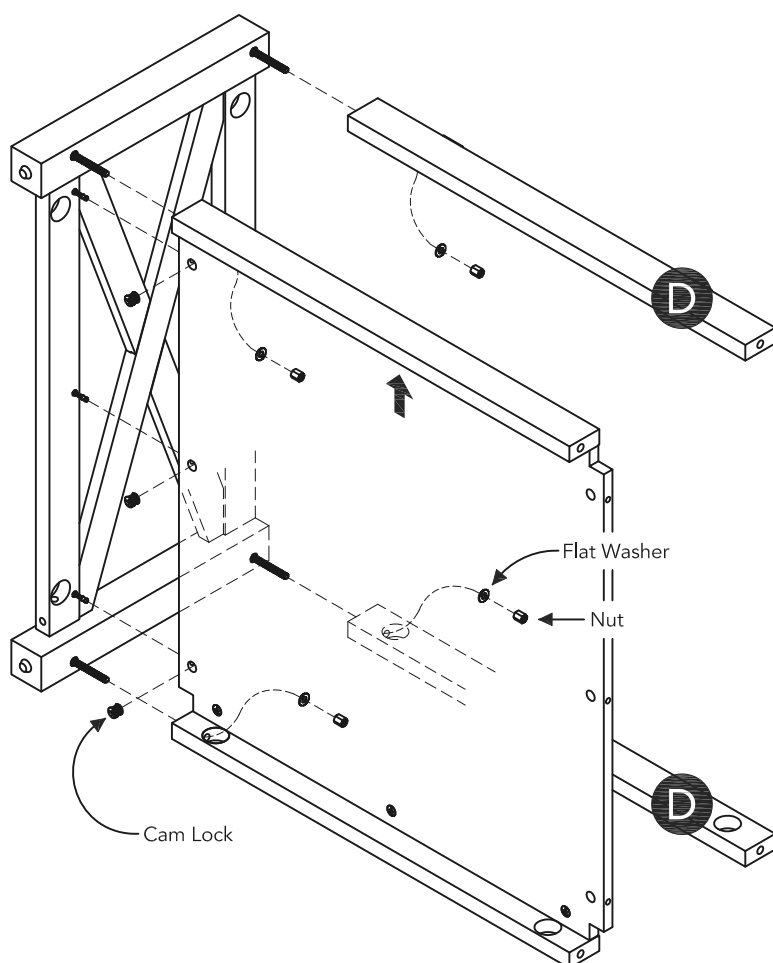

Figure 2



STEP 4

Attach Top Rails (D) and unit from Step 3 to side unit with Flat Washers, Nuts and Cam Locks.
Tighten all Nuts with Wrench.

Assembly Instructions 4/4

STEP 5

Attach side unit to unit from Step 4 with Flat Washers, Nuts and Cam Locks. Tighten all Nuts with Wrench.

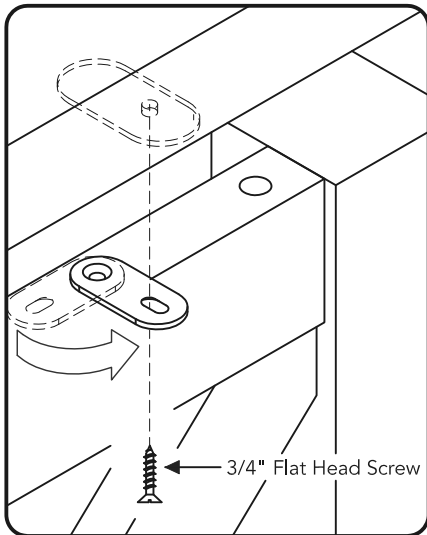

Figure 3

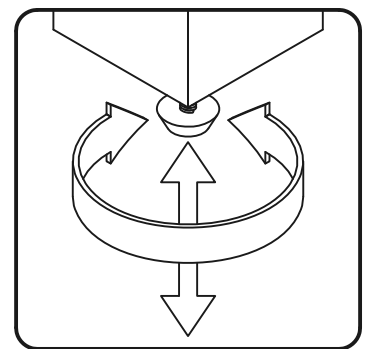
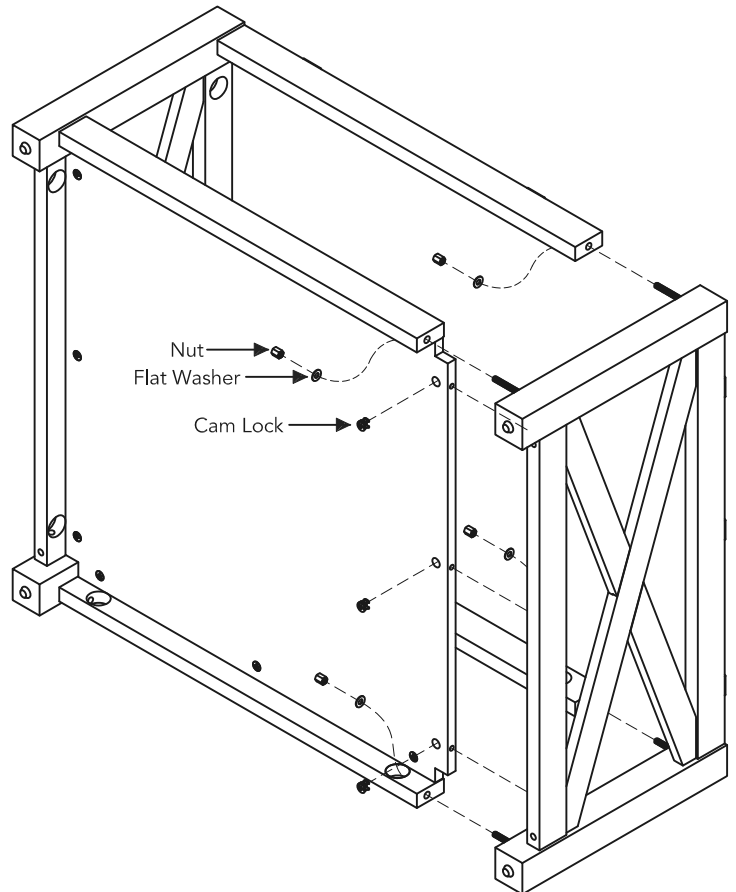
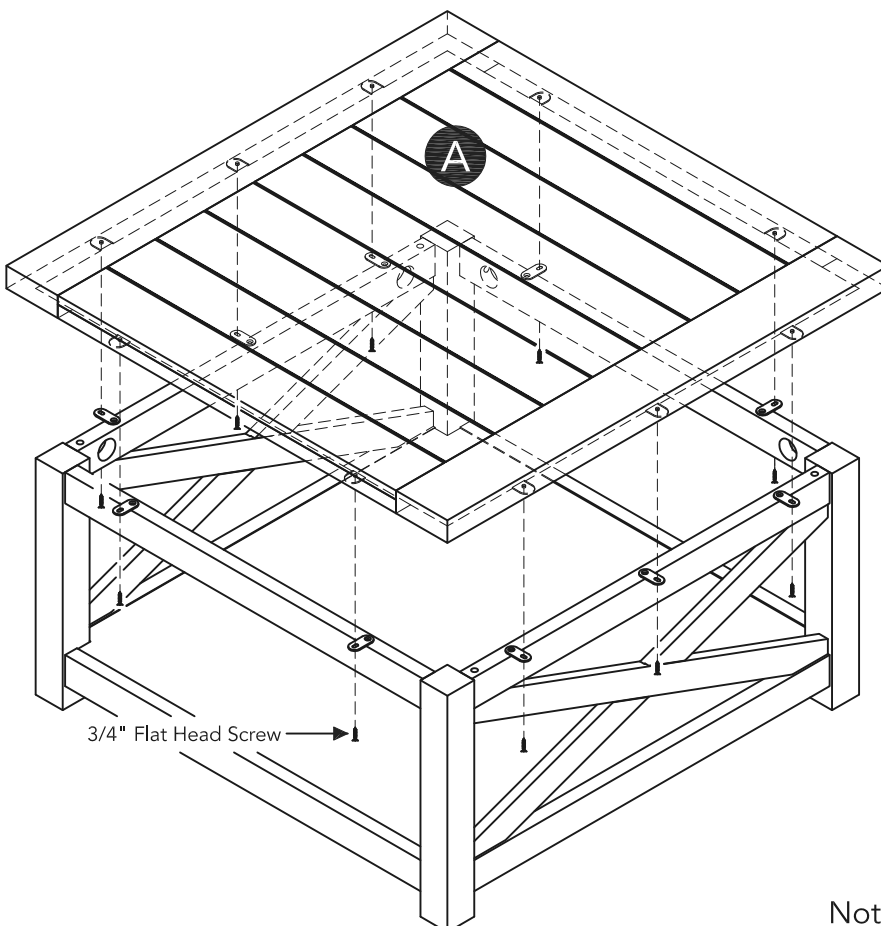

Figure 4



STEP 6

Rotate metal tabs on the unit out and attach Top (A) to unit with 3/4" Flat Head Screws. (See Figure 3)

To level the unit, adjust the adjustable levelers on the bottom of the legs. (See Figure 4)

Note: Unit must be level to work properly.

CARE INSTRUCTIONS

NEVER

allow liquids to remain on furniture.
Absorption causes parts to warp
and split and finishes to delaminate.

NEVER

use glass cleaners on
finished furniture. Ammonia
chemically attacks the finish.



Do not use power tools
above 8 volts to assemble.

**PREVENT
CRACKING**



Do not place
in direct sunlight.

**PREVENT
FADING**



Do not write
directly on surface.

**PREVENT
MARKING**



Do not place hot
objects on surface.

**PREVENT
FINISH DAMAGE**



Do not use rubber
based placemats.

**PREVENT
DISCOLORING**



Do not use commercial
waxes and polishes.

**PREVENT
YELLOWING**

CLEAN

with a soft cloth moistened
in lukewarm soap and water.
Buff with a dry clean cloth.

