

ASSEMBLY INSTRUCTIONS

EEI-6851

V0.12.19.23

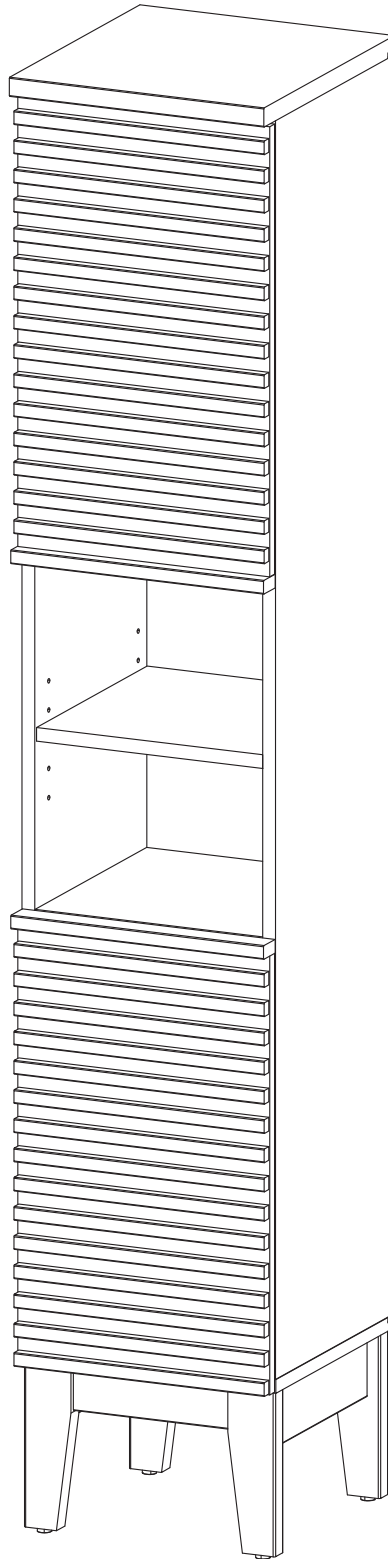

Questions? Contact us!

609.256.9000 • cs@modway.com
www.modway.com

***modway**

Let's get started!

*modway



Read through all of the instructions before starting



Approx. 60 minutes assembly time



2 people recommended for assembly



Care instructions are listed in the last step of this manual



Make sure you have all parts and components before discarding any packing materials

Only use hand tools to assemble this item. Do not use power tools. Do not tighten bolts or screws completely until all hardware is lined up and inserted into the holes.

Do not over-tighten screws and bolts to avoid stripping the hardware or cracking the item.

Assemble your item on a flat, carpeted area, with plenty of space to work. This will prevent damage and scratches to your floors or the item while you're assembling the product.

Keep all components and packaging out of reach of children or animals to avoid risk of choking or suffocation.

Furniture components:

1	Top Board	x1	11	Support Board	x1
2	Bottom Board	x1	12	Back Board	x1
3	Side Board Left	x1			
4	Side Board Right	x1			
5	Adjustable Shelf	x5			
6	Fixed Shelf	x2			
7	Assembly Leg	x2			
8	Bottom Skirt	x2			
9	Door 1	x1			
10	Door 2	x1			

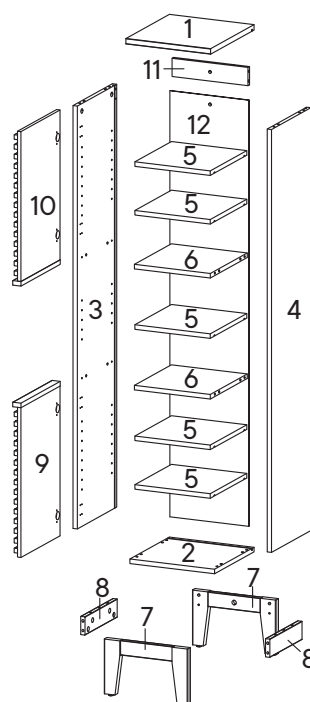

Provided hardware:

A		Cam Bolt Ø6 x 35 mm	x24	J		Screw Cap Ø15 mm	x4
B		Cam Lock Ø15 mm	x22	K		Screw 5.5 x 45 mm	x1
C		Wood Dowel Ø8 x 30 mm	x26	L		Ring	x1
D		Screw M 7 x 50 mm	x4	M		Wall Plug	x1
E		Allen Key	x2	N		Wood Dowel Ø6 x 30 mm	x4
F		Screw M 4.5 x 12.5 mm	x24	O		Cam Lock Ø12 mm	x2
G		Shelf Pin	x20	HS26A		Hinge	x4
H		Wedge	x12				
I		Screw M 3.5 x 15.5 mm	x12				

What you need:



Phillips



Phillips Head Screwdriver

Wait!

Missing parts or hardware? Need assistance?
Contact us before returning your item. We're here to help!
609.256.9000 • cs@modway.com

Step 1

HARDWARE

A	Cam Bolt Ø6 x 35 mm	x14
C	Wood Dowel Ø8 x 30 mm	x16
N	Wood Dowel Ø6 x 30 mm	x4

COMPONENTS

1	Top Board	x1
3	Side Board Left	x1
4	Side Board Right	x1
6	Fixed Shelf	x2
11	Support Board	x1

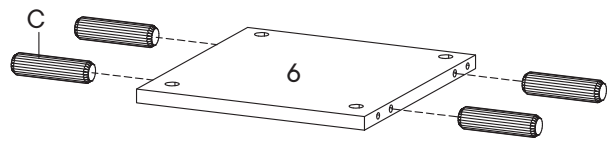
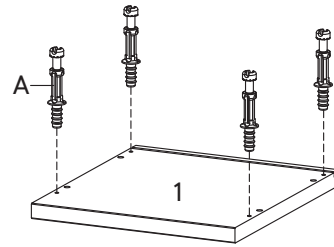
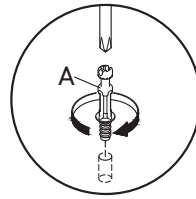

x 2

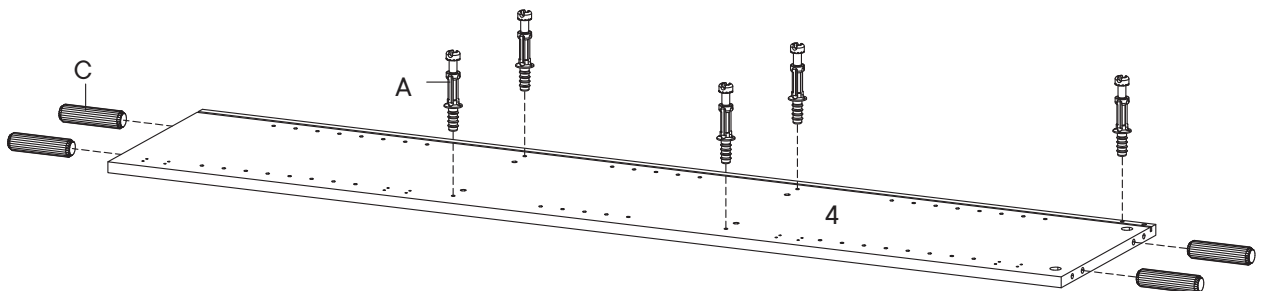
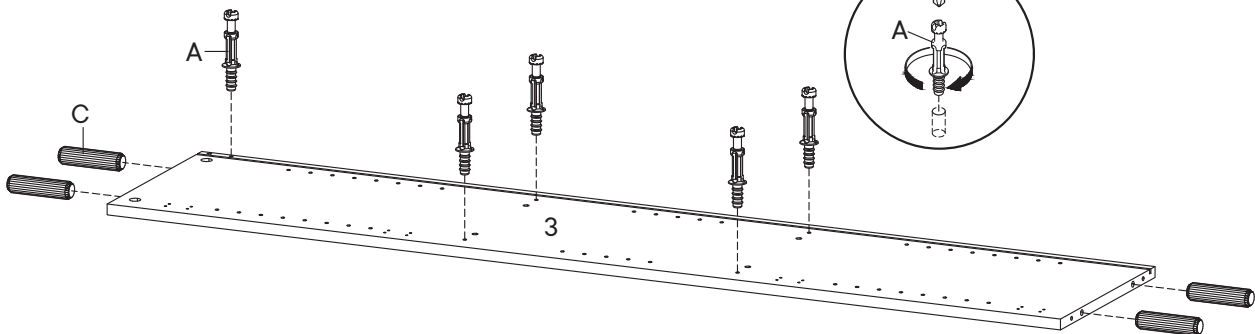
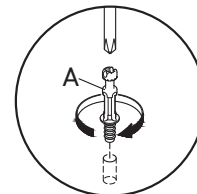
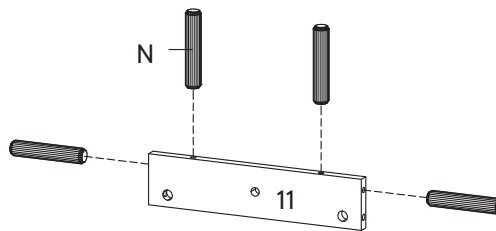

Step 2

HARDWARE

- | | | |
|----------|-----------------|----|
| B | Cam Lock Ø15 mm | x4 |
| O | Cam Lock Ø12 mm | x1 |

COMPONENTS

- | | | |
|-----------|------------------|----|
| 4 | Side Board Right | x1 |
| 6 | Fixed Shelf | x2 |
| 11 | Support Board | x1 |

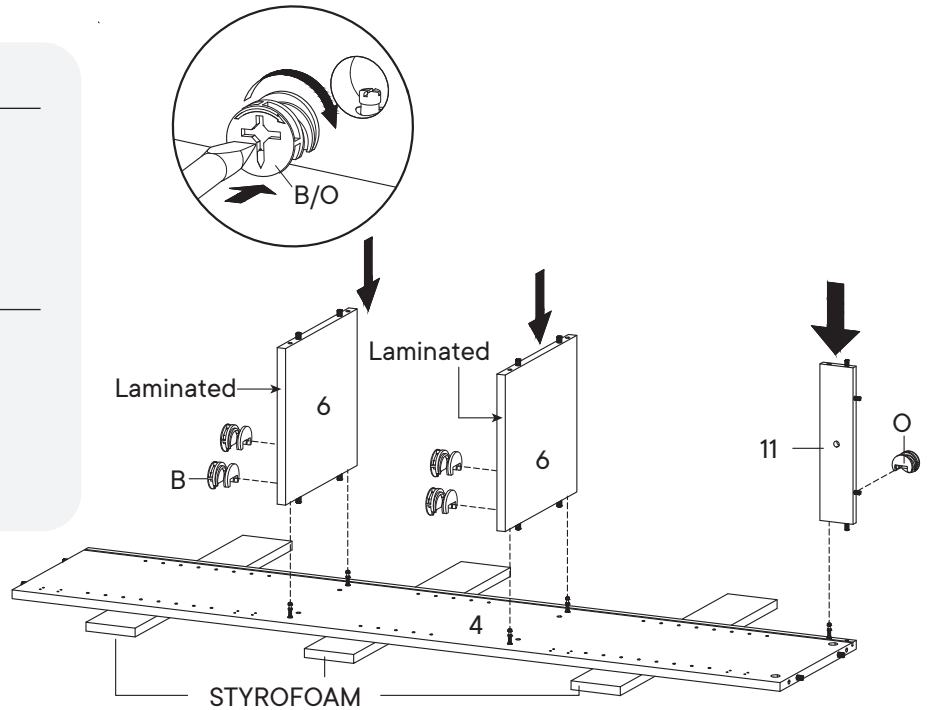

Step 3

HARDWARE

- | | | |
|----------|-----------------|----|
| B | Cam Lock Ø15 mm | x4 |
| O | Cam Lock Ø12 mm | x1 |

COMPONENTS

- | | | |
|----------|-----------------|----|
| 3 | Side Board Left | x1 |
|----------|-----------------|----|

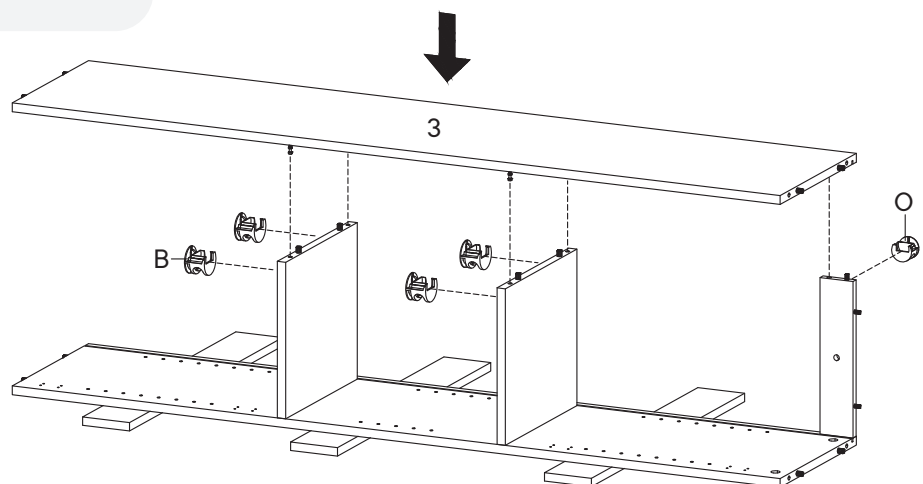
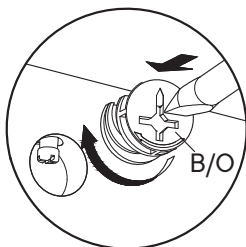

Step 4

HARDWARE

B Cam Lock Ø15 mm x4

J Screw Cap Ø15 mm x4

COMPONENTS

1 Top Board x1

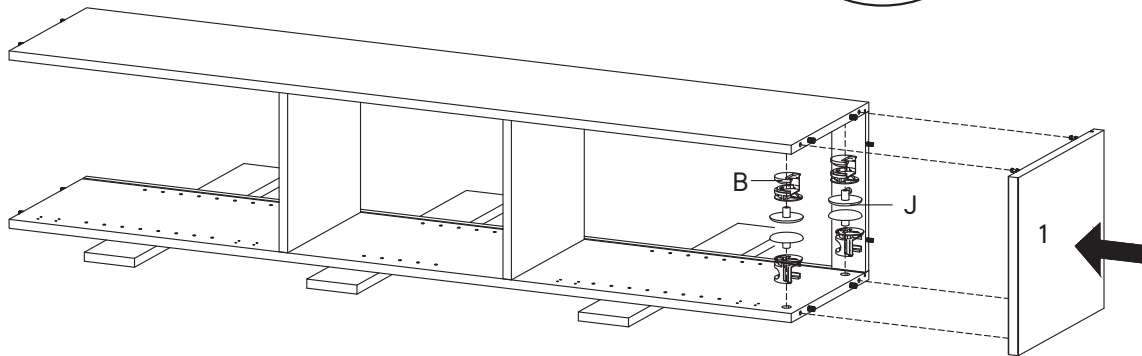
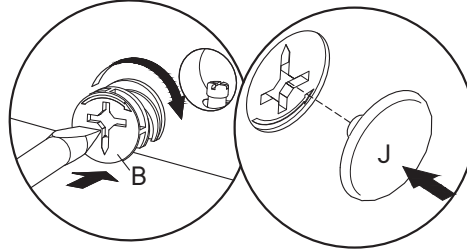

Step 5

COMPONENT

12 Back Board x1

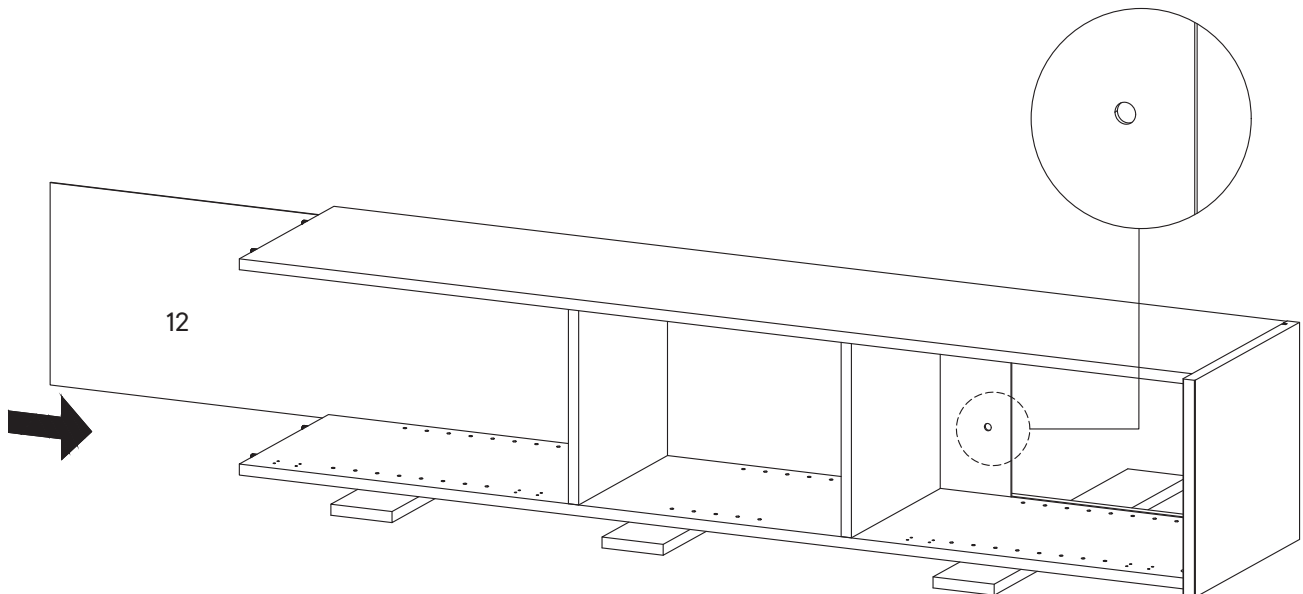

Step 6

HARDWARE

- D** Screw M 7 x 50 mm x4
- E** Allen Key x1

COMPONENTS

- 2** Bottom Board x1

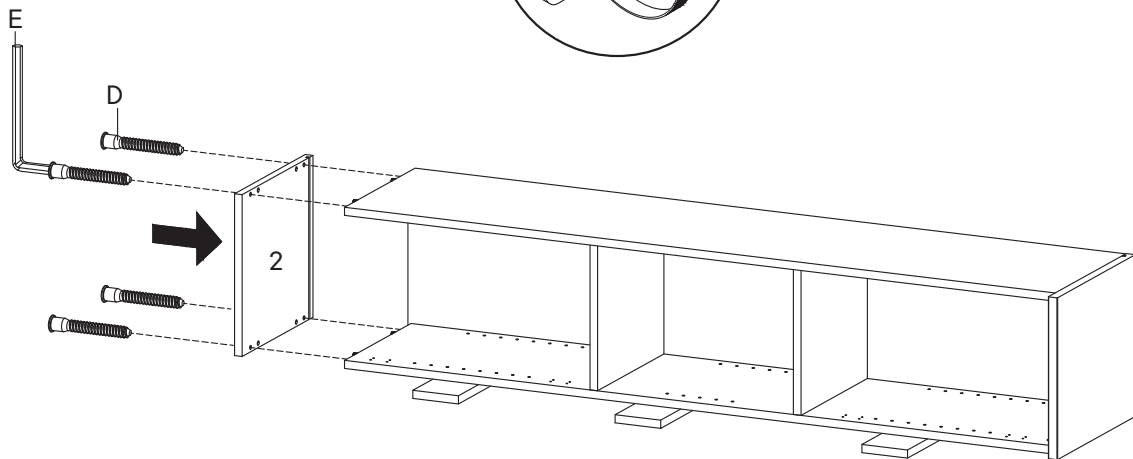
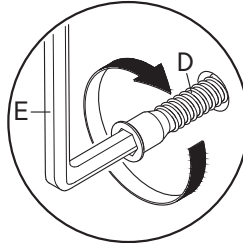

Step 7

HARDWARE

- A** Cam Bolt Ø6 x 35 mm x6

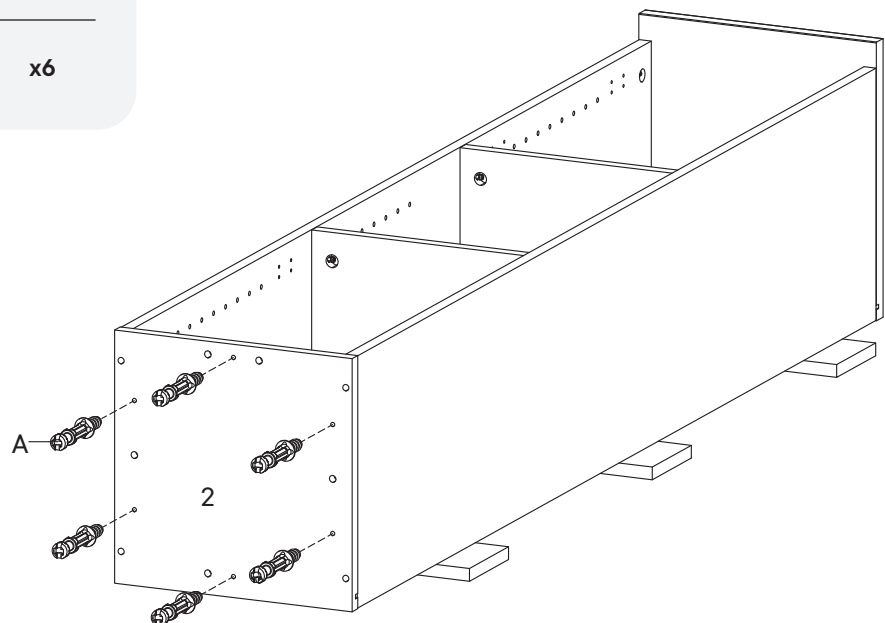
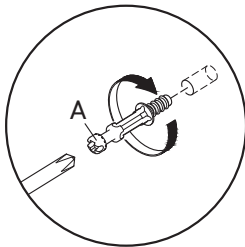

Step 8

HARDWARE

- A** Cam Bolt Ø6 x 35 mm x4
- C** Wood Dowel Ø8 x 30 mm x4

COMPONENTS

- 7** Assembly Leg x2
- 8** Bottom Skirt x2

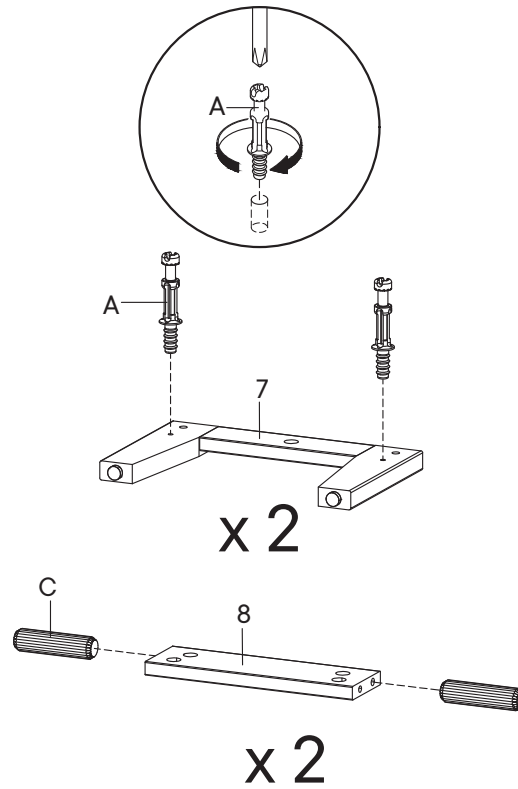

Step 9

HARDWARE

- B** Cam Lock Ø15 mm x4

COMPONENTS

- 7** Assembly Leg x2
- 8** Bottom Skirt x2

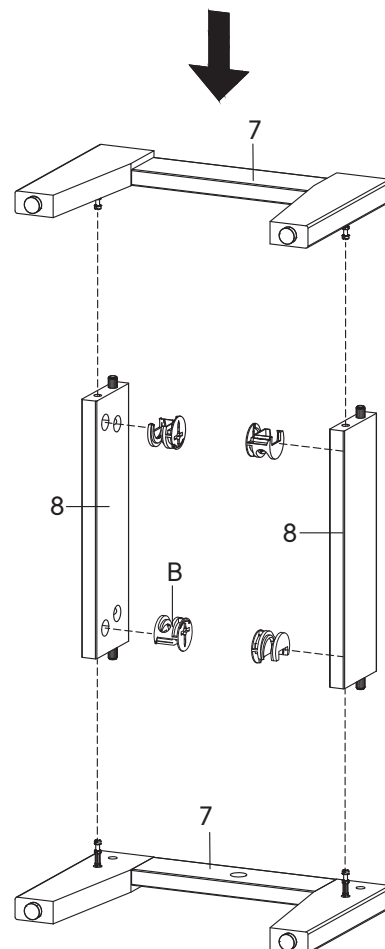
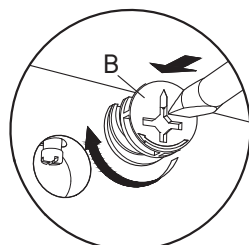

Step 10

HARDWARE

C Wood Dowel Ø8 x 30 mm x6

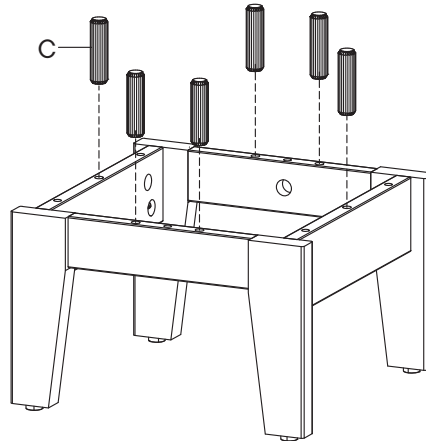

Step 11

HARDWARE

B Cam Lock Ø15 mm x6

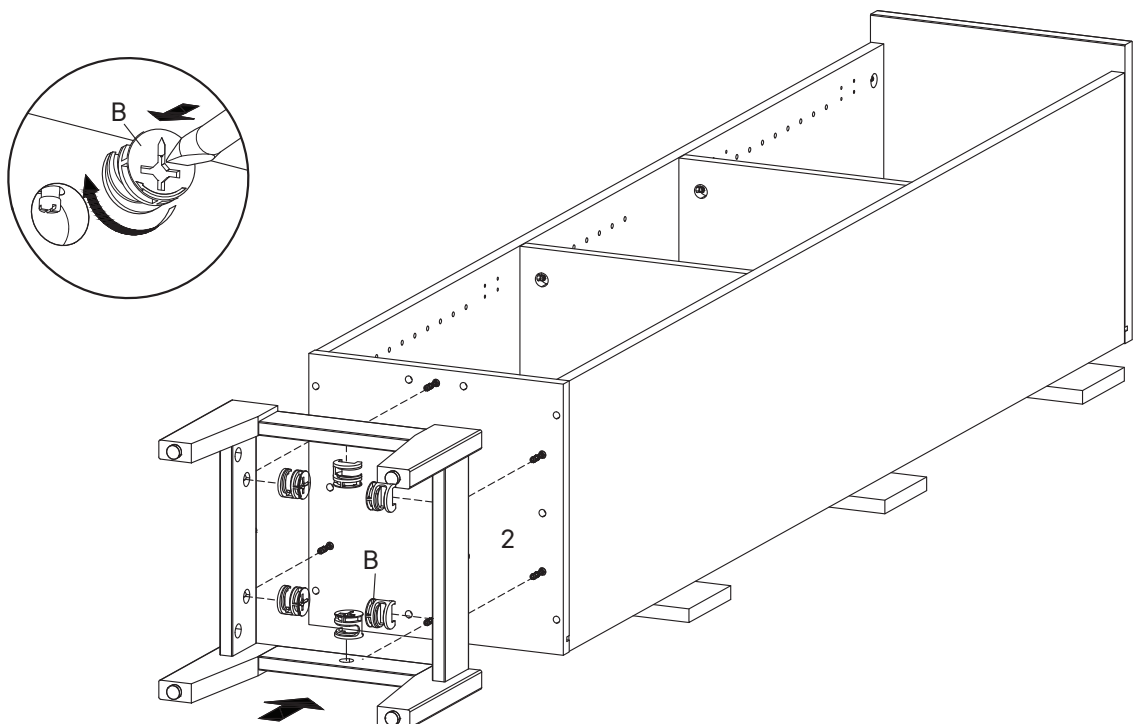

Step 12

HARDWARE

- | | | |
|----------|-----------------------|-----|
| H | Wedge | x12 |
| I | Screw M 3.5 x 15.5 mm | x12 |

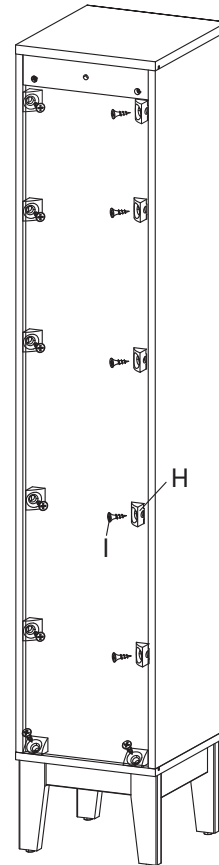
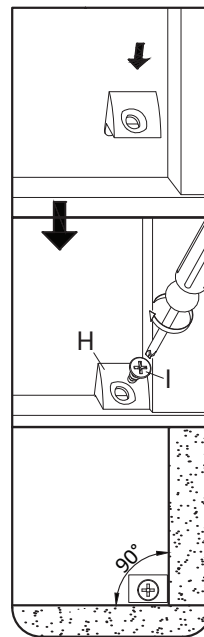

Step 13

HARDWARE

- | | | |
|----------|-------------------|----|
| K | Screw 5.5 x 45 mm | x1 |
| L | Ring | x1 |
| M | Wall Plug | x1 |

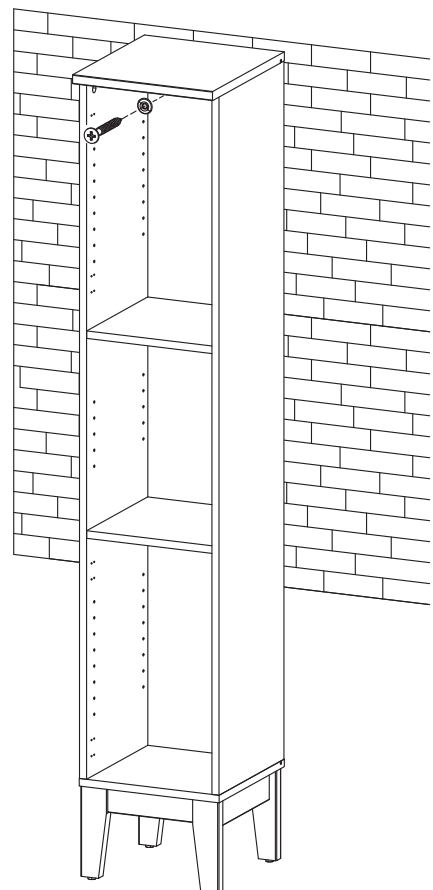
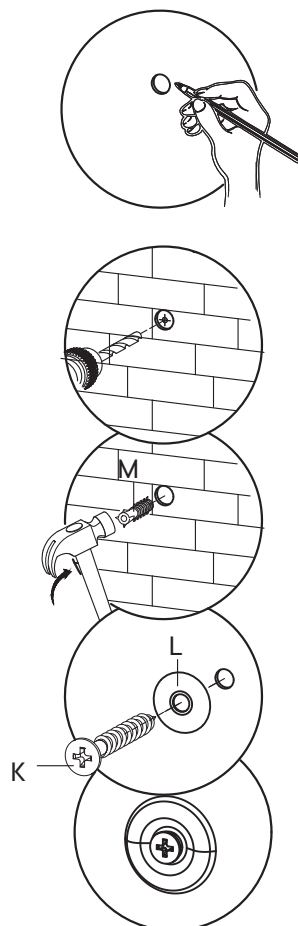

Step 14

HARDWARE

G Shelf Pin x20

COMPONENTS

5 Adjustable Shelf x5

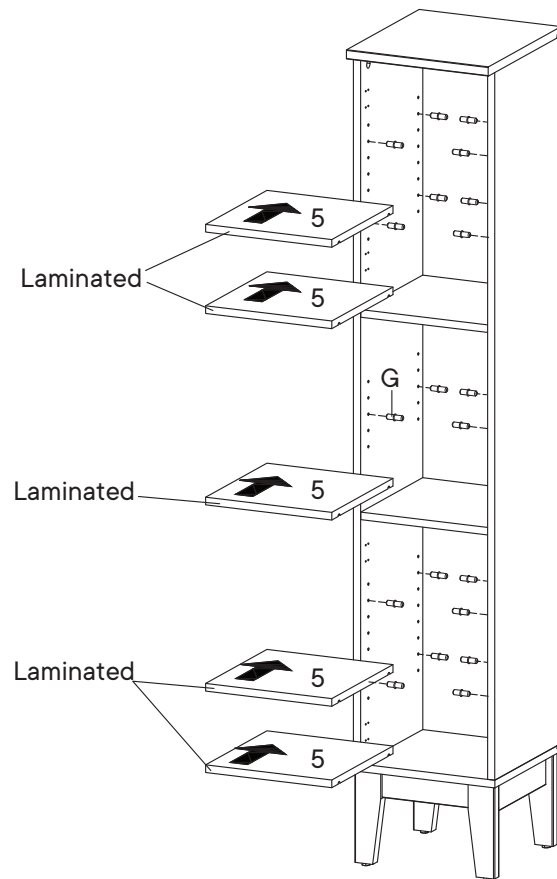
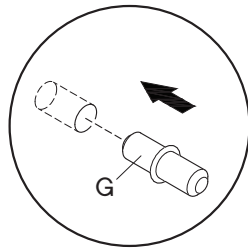

Step 15

HARDWARE

F Screw M 4.5 x 12.5 mm x8

HS26A Hinge x4

COMPONENTS

9 Door 1 x1

10 Door 2 x1

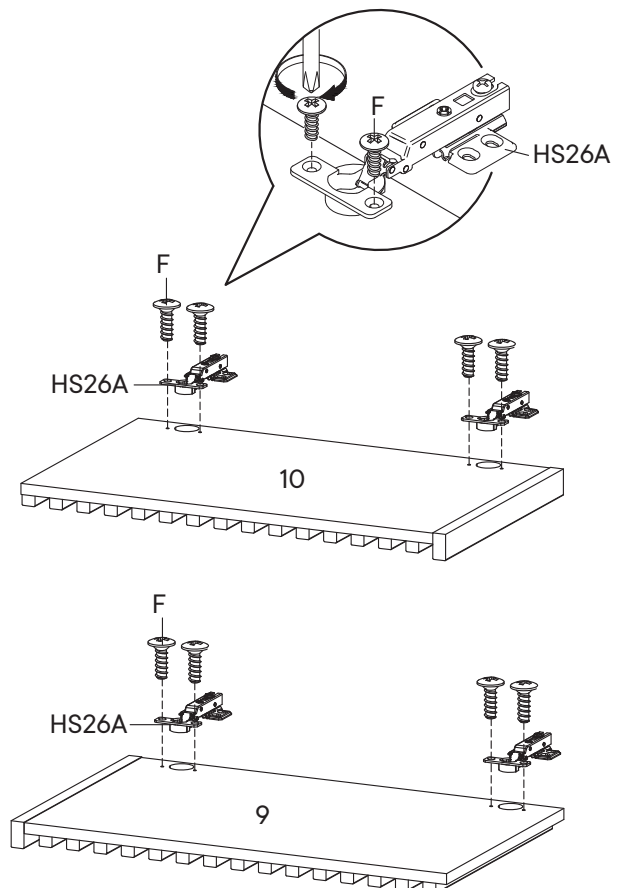

Step 16

HARDWARE

F Screw M 4.5 x 12.5 mm x16

COMPONENTS

9 Door 1 x1

10 Door 2 x1

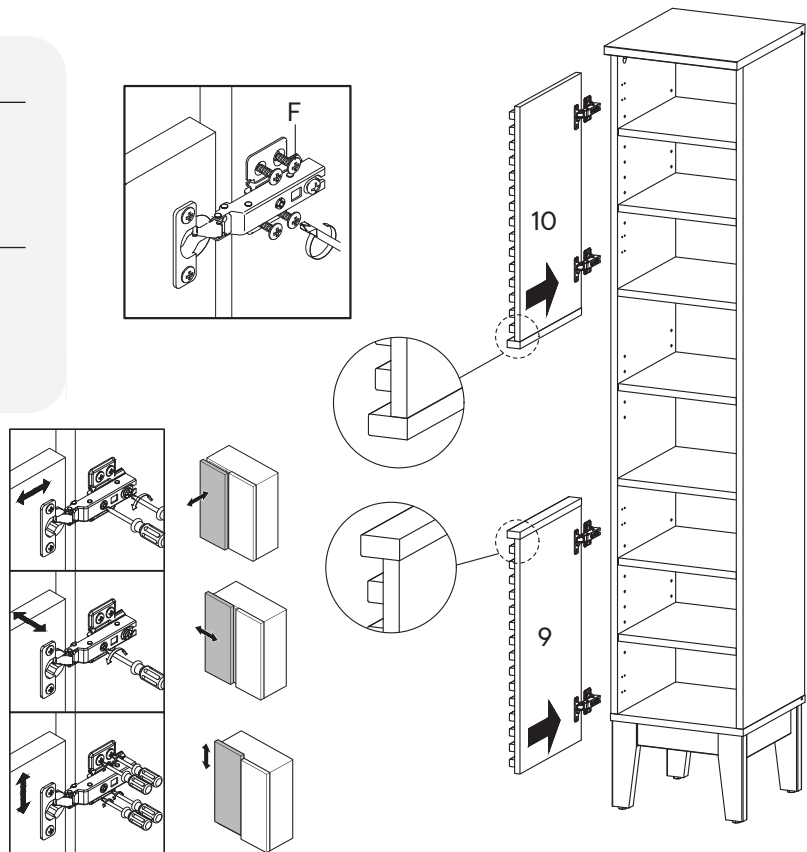

Step 17

HARDWARE

F Screw M 4.5 x 12.5 mm x16

COMPONENTS

9 Door 1 x1

10 Door 2 x1

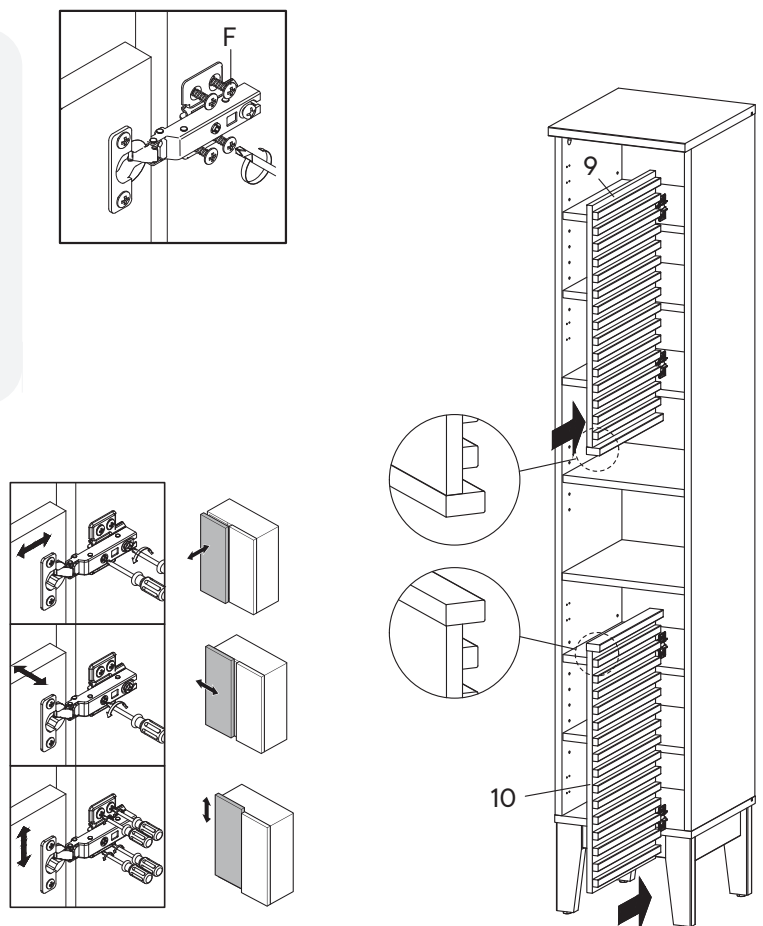

OPTIONAL

Great job!

Cabinet assembly is complete.

♥ CARING FOR YOUR ITEM

Indoor use only.

Not contract grade.

Clean using a non-abrasive cloth
and a mild cleaner.

Never use harsh chemicals,
as they could damage the finish
or integrity of the item.

CONNECT WITH US!



Tag us **@modway_furniture** and **#modway**
for a chance to be featured.

