

Assembly Instructions



CAUTION

- Inspect the wire insulation for any cuts, abrasions, or exposed copper that may have resulted during shipping. If there is a defect in the wire, do not attempt installation.
- Before starting installation of this fixture or removal of a previous fixture, disconnect the power by turning off the circuit breaker or by removing the fuse at the fuse box.

TOOLS REQUIRED



Ladder



Safety glasses



Electrical tape

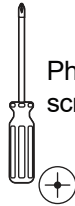

Phillips screwdriver



Flat blade screwdriver



Pliers

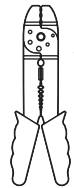

Wire strippers

Fixture*1

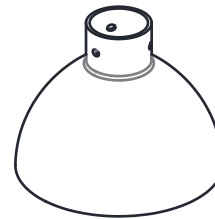
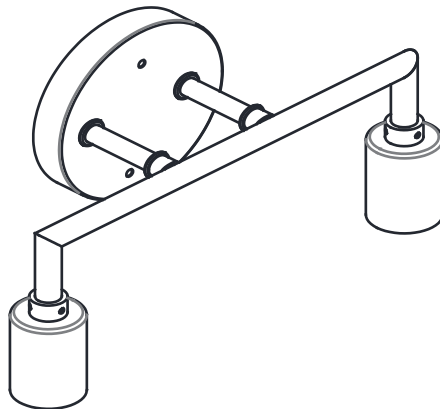

Glass shade*2



Set screw*6

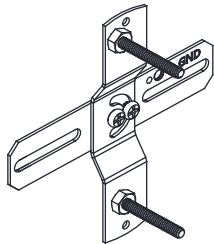

Mounting Unit*1

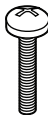

Mounting Screw*2



Wire Nut*3



Cap Nut*2

***PARTS SHOWN MAY DIFFER SLIGHTLY PER LIGHT FIXTURE**

Assembly Instructions

STEP 1

Remove the cap nuts from the mounting unit. Then, remove the cap nuts from the mounting unit. Then, remove the cap nuts from the mounting unit.

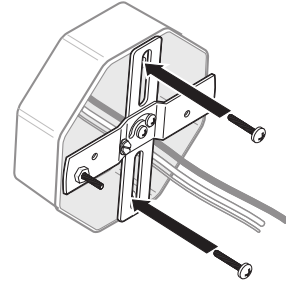

STEP 2

Make the electrical connection from the junction box to the fixture. Connect the ground wire to the mounting unit using the preinstalled green ground screw. Then, connect the positive, negative and ground wires with the supplied wire nuts. Secure with electrical tape.

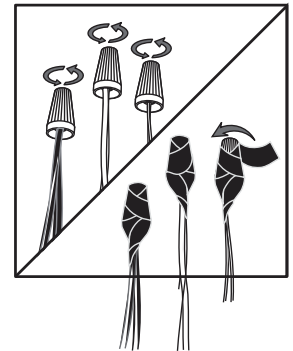
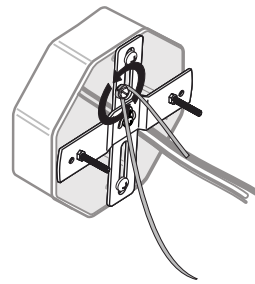

Connect Clear, Brown, Gold or Black Parallel Wire without tracer (round & smooth) or Black Fixture Wire to:

Black or Red Supply Wire or Insulated Wire (other than green) with copper conductor.

Connect Clear, Brown, Gold or Black *Parallel Wire with tracer (square & ridged) or White Fixture Wire to:

White Supply Wire or Insulated Wire (other than green) with silver conductor

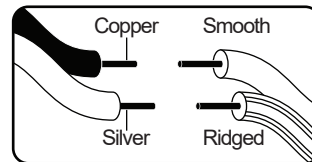

STEP 3

Place the fixture over the mounting unit and secure with the cap nuts. Place the glass shades on each socket and secure with the set screws. Install E26*2*60W Bulbs (not included).

