

hardware

(J) x 12
Wood dowel
Ø7.8 X 30mm



(K) x 6
Cam bolt



(L) x 6
Cam



(M) x 4
Adjustable leg



(N) x 16
Screw Ø4 X 16mm



(O) x 6
Screw Ø5 X 50mm

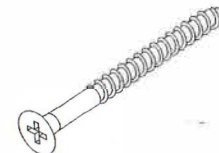

(P) x 22
Screw Ø3.5 X 12mm



(Q) x 4
Hinge

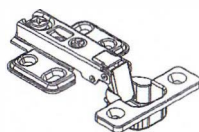

(R) x 24
Screw Ø4 X 14mm



(S) x 2
Handle

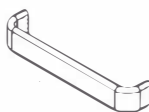

(T) x 4
Bolt M4 x 20mm



(U) x 4
Bolt M6 x 28mm



(V) x 1
Allen key M4

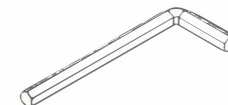

(W) x 2
Wall anchor



(X) x 4
Shelf pin

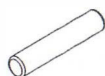

(Y) x 12
PVC cover Ø20



(Z) x 4
PVC cover Ø40

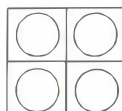

(Aa) x 1
Allen key M5

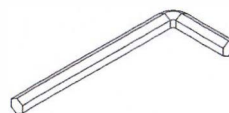

(Bb) x 1
Glue



ITEM DESCRIPTION QUANTITY

A	Left side panel	1
B	Right side panel	1
C	Bottom	1
D	Back rail	1
E	Top	1
F	Back panel	1
G	Left door panel	1
H	Right door panel	1
I	Adjustable shelf	1
J	Wood dowel Ø7.8 X 30mm	12
K	Cam bolt	6
L	Cam	6
M	Adjustable leg	4
N	Screw Ø4 X 16mm	16
O	Screw Ø5 X 50mm	6
P	Screw Ø3.5 X 12mm	22
Q	Hinge	4
R	Screw Ø4 X 14mm	24
S	Handle	2
T	Bolt M4 X 20mm	4
U	Bolt M6 X 28mm	4
V	Allen key M4	1
W	Wall anchor	2
X	Shelf pin	4
Y	PVC cover Ø20	12
Z	PVC cover Ø40	4
Aa	Allen key M5	1
Bb	Glue	1

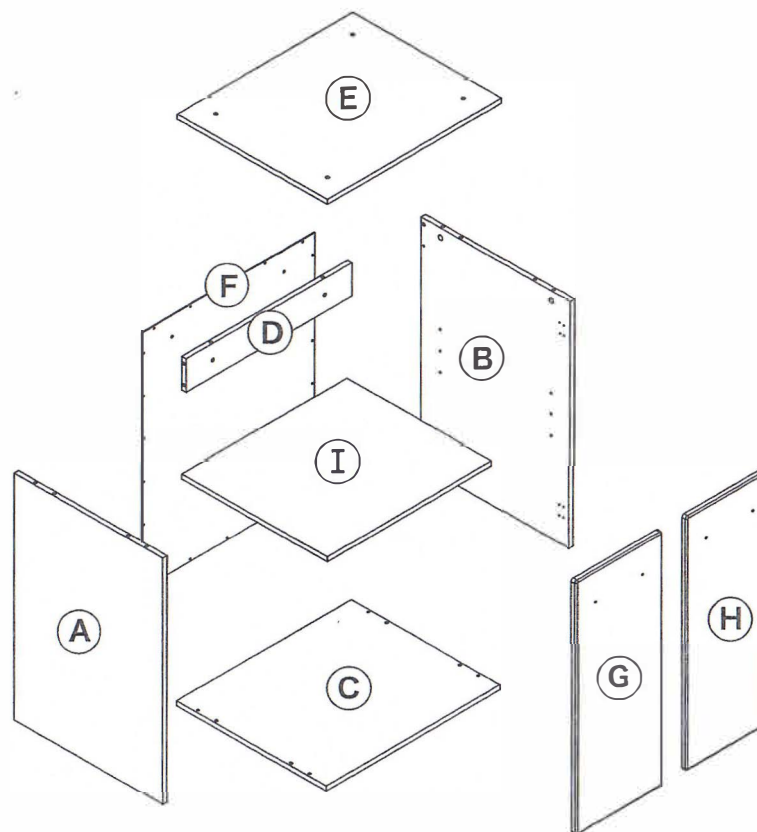

how to use the cam lock system

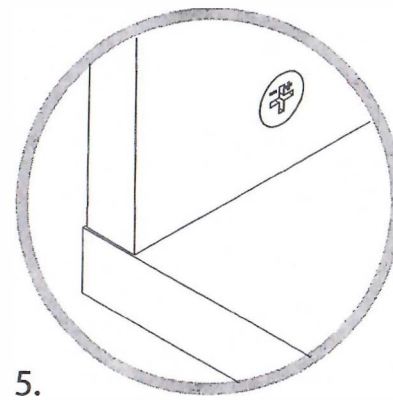
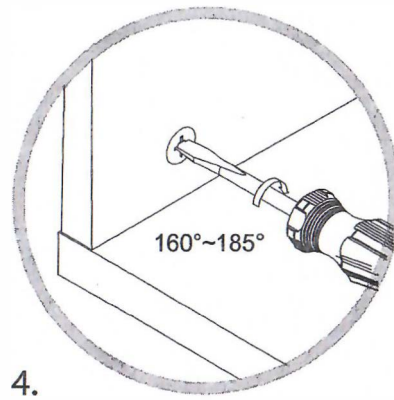
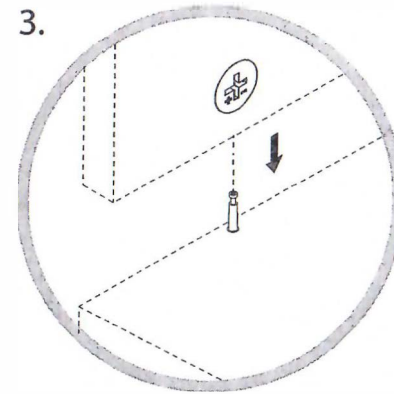
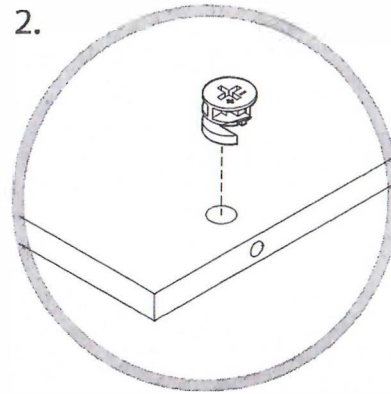
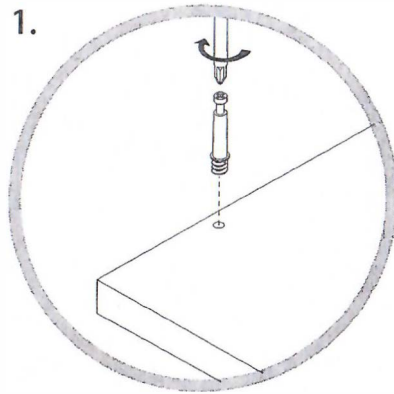

step 1.

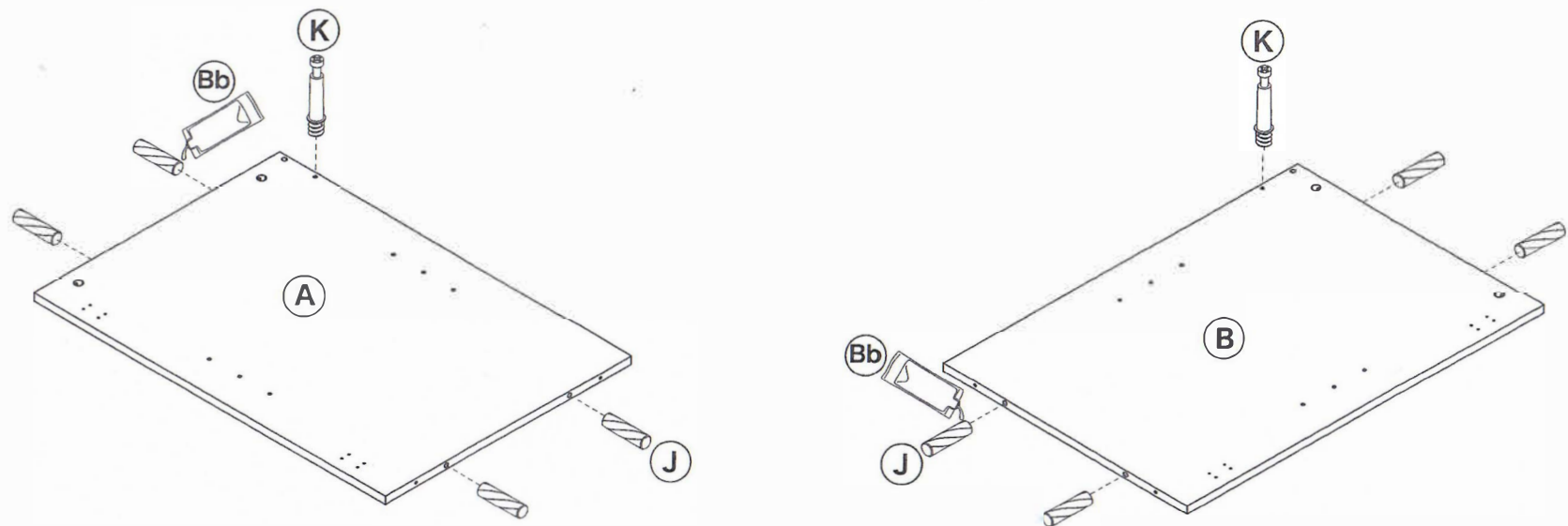

(J) x 8
Wood dowel
Ø7.8 X 30mm



(K) x 2
Cam bolt



(Bb)
Glue

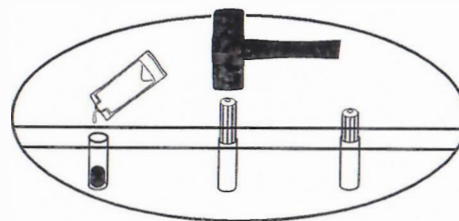

1. Instill the glue (Bb) to the wood dowel hole as image shown.
2. Insert the wood dowel (J) to the part (A) and (B).
3. Attach the cam bolt (K) to the part (A) and (B).

step 2.

Note: If you want to stack the cabinet with 3 drawer cabinet, don't assemble the adjustable leg (M).

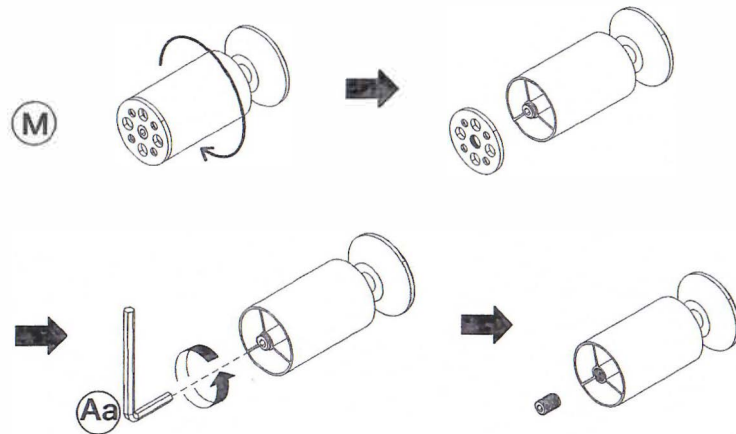

(M) x 4 Adjustable leg
(N) x 16 Screw Ø4 X 16mm
(Aa) x 1 Allen key M5

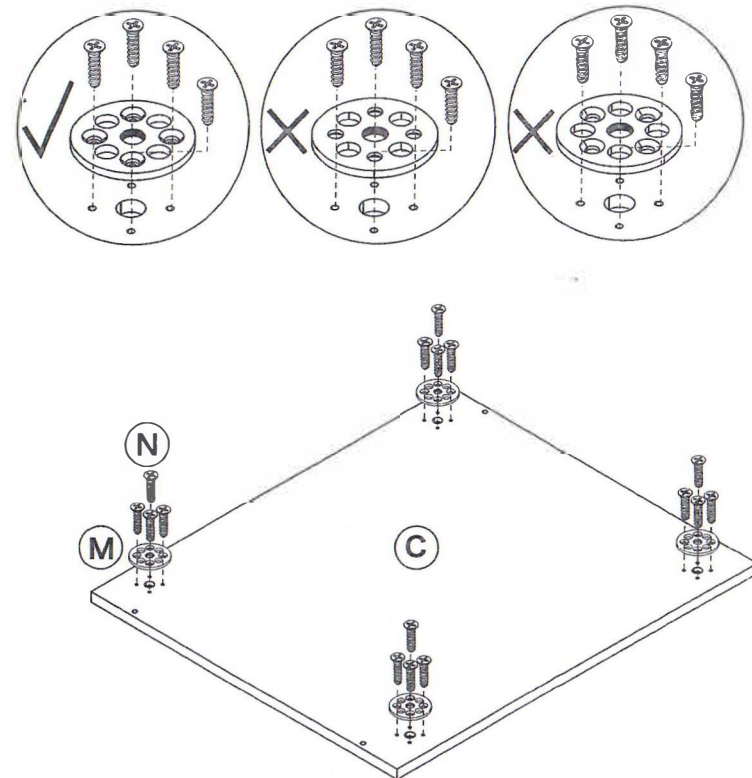

1. Knock down the adjustable leg (M) as image shown.
2. Attached the metal plate to the part (C) with screw (N), take notice on the metal plate screw hole.

step 3.

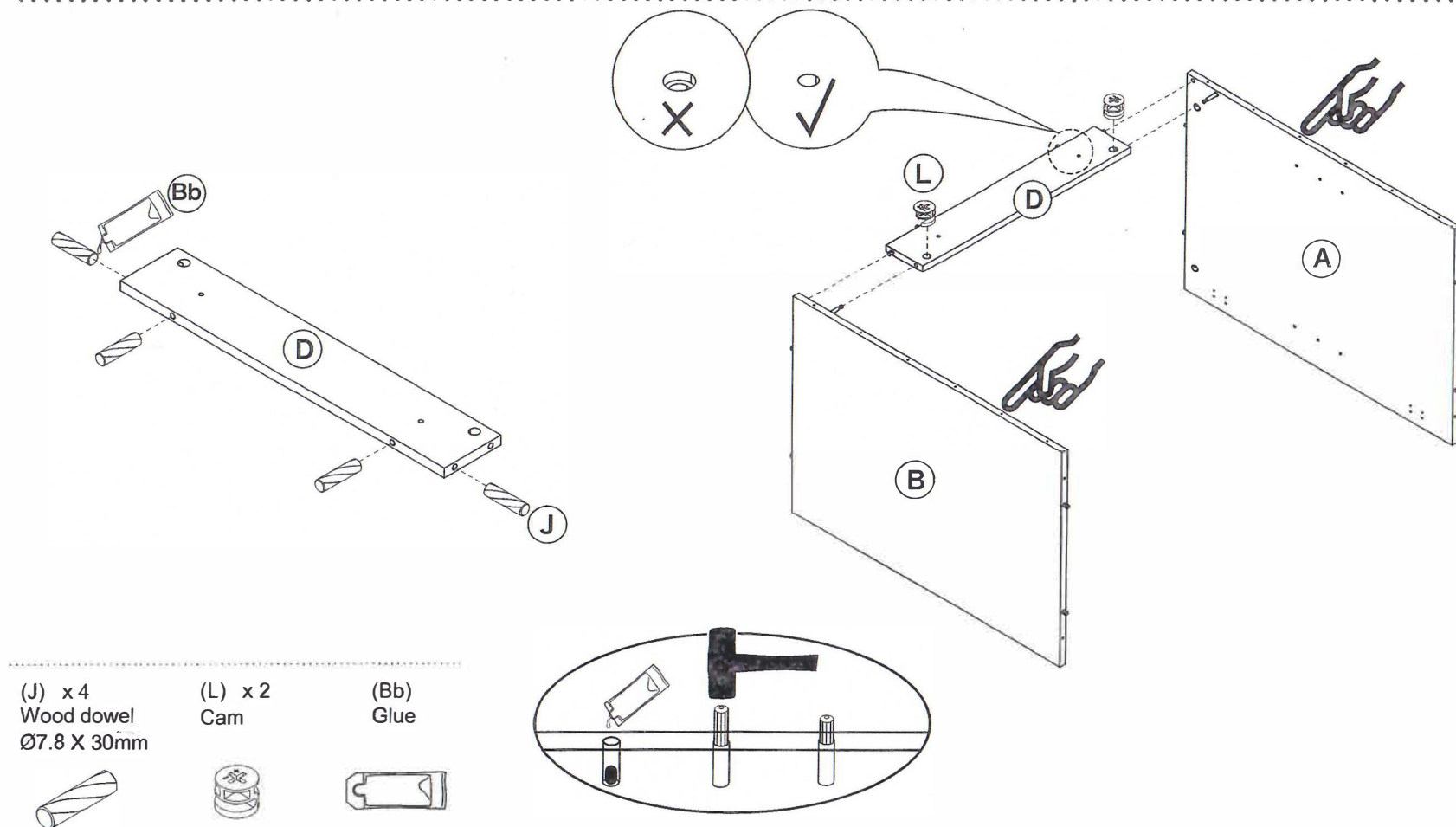

1. Instill the glue (Bb) to the wood dowel hole as image shown.
2. Insert the wood dowel (J) to the part (D).
3. Attach the part (A) and (B) to part (D) using the wood dowel (J) and cam bolt (K).
4. Tighten the part (D) using cam (L) as image shown.

step 4.

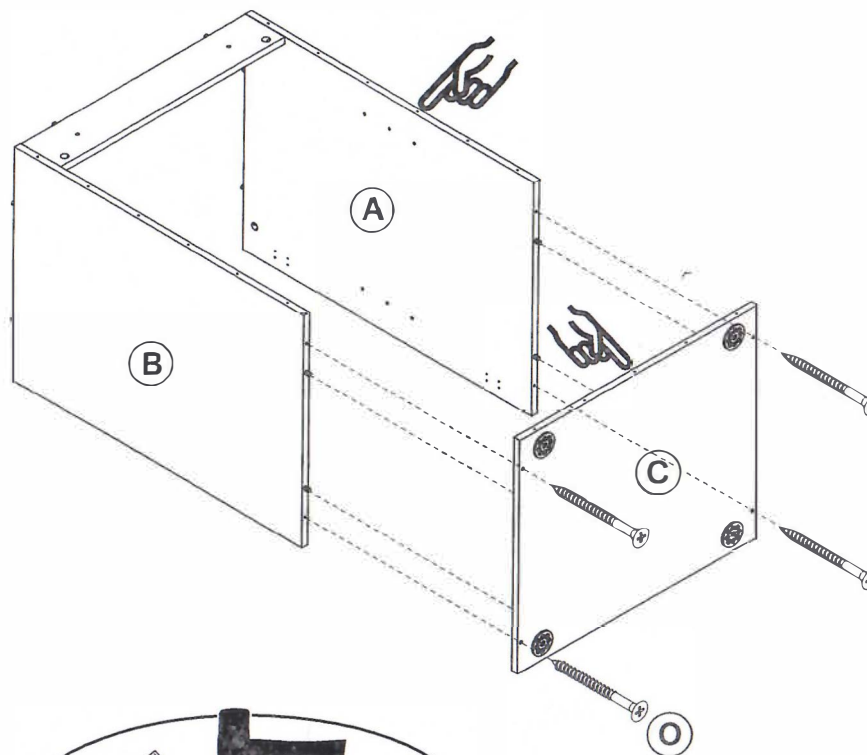

(O) x 4
Screw Ø5 X 50mm

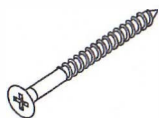

(Bb)
Glue

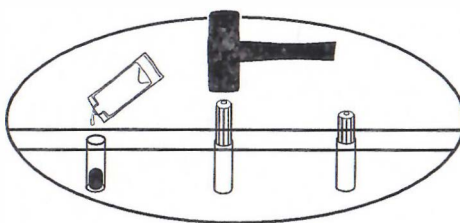

1. Instill the glue (Bb) to the wood dowel hole as image shown.
2. Attach the parts (A), (B) and (C) using screw (O).

step 5.

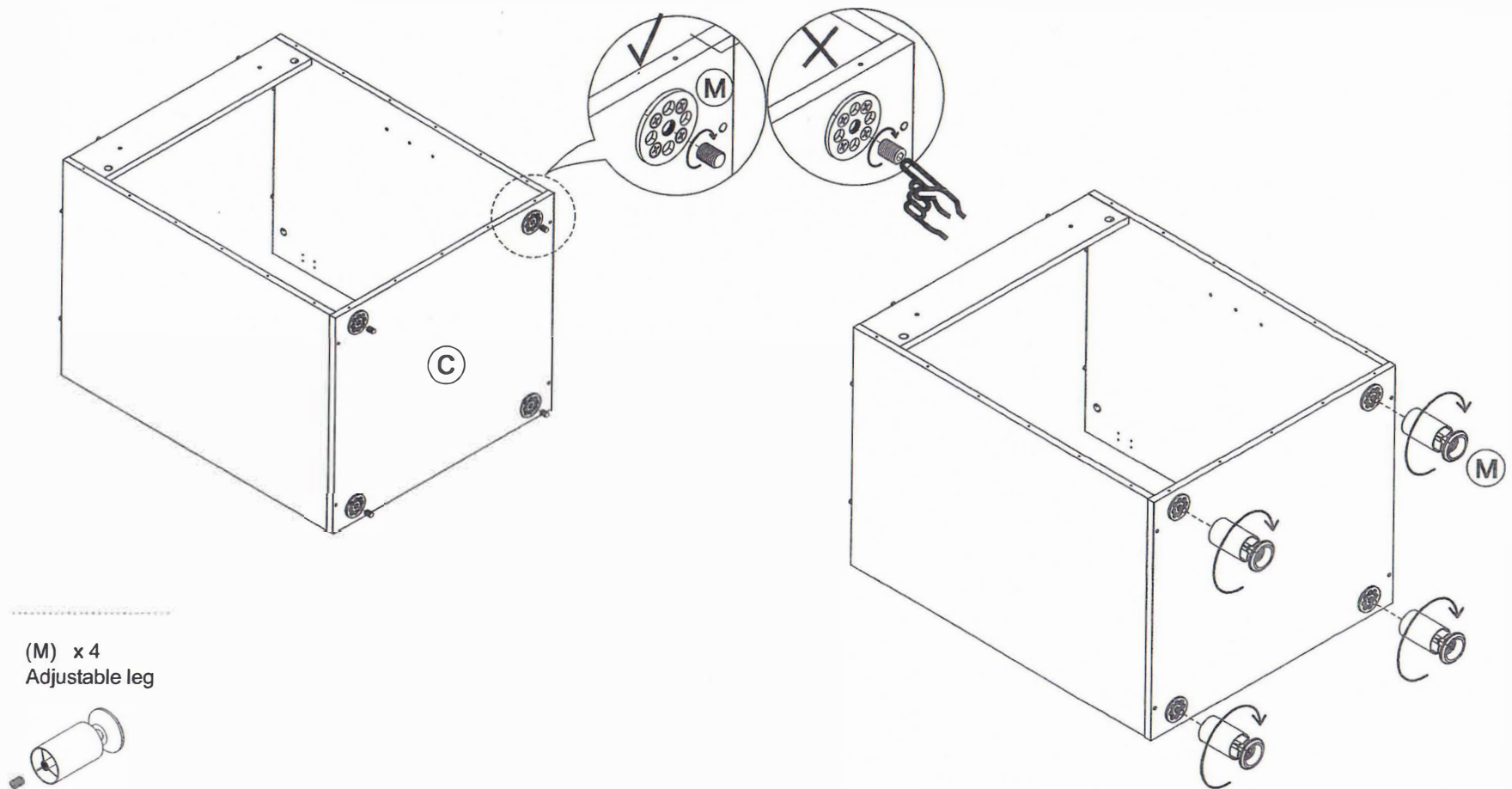

1. Rotate the screw into the metal plate on part (C).
2. Attach the leg to the part (C) as image shown.

step 6.

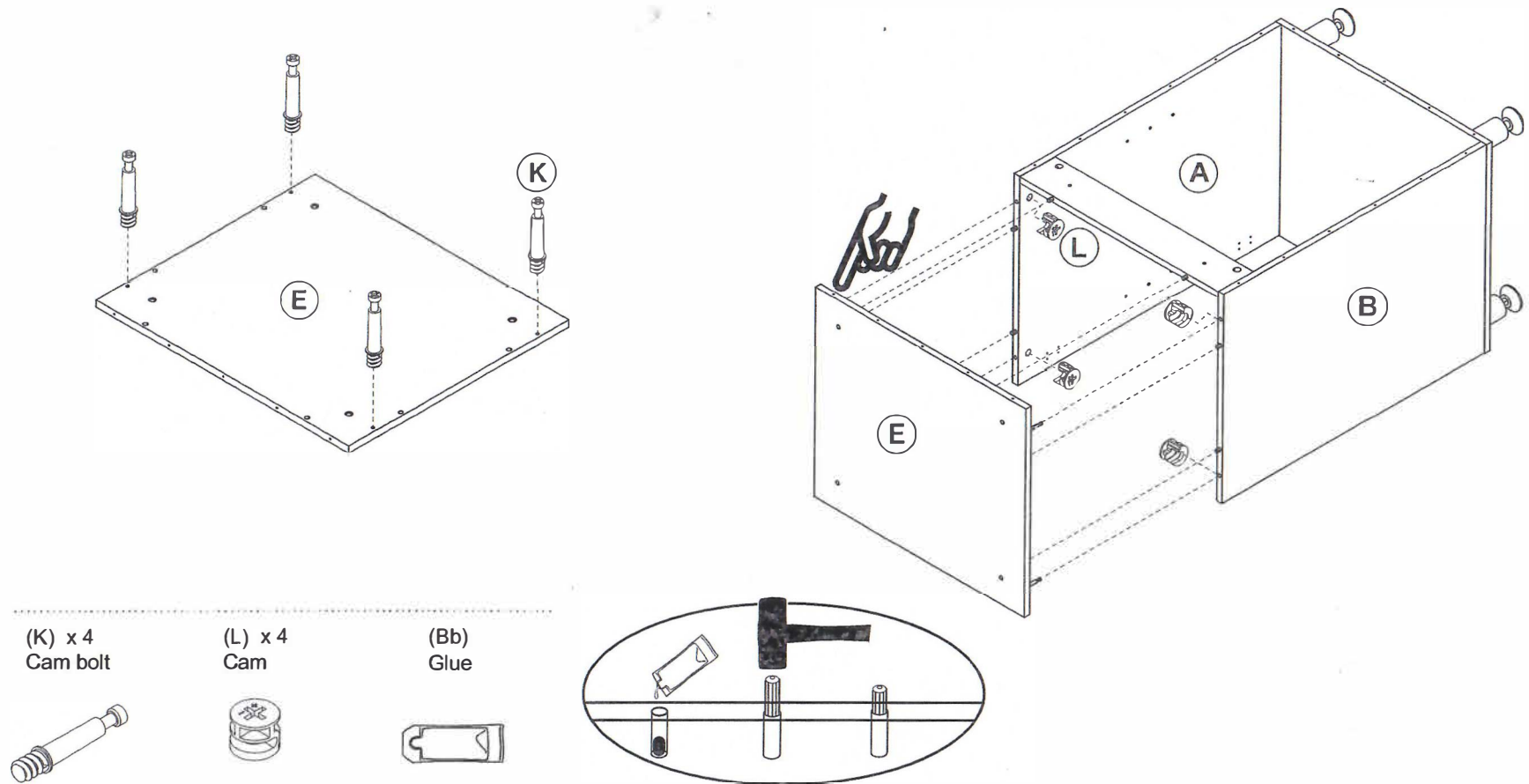

1. Attach the cam bolt (K) to the part (E).
2. Instill the glue (Bb) to the wood dowel hole as image shown.
3. Attach the part (E) to the assembled parts using wood dowel (J) and cam bolt (K). Take notice on the direction of the part (E).

step 7.

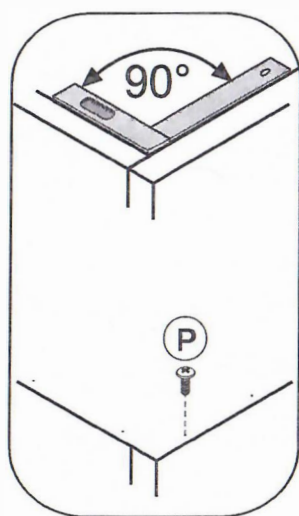

(P) x 22
Screw Ø3.5 X 12mm

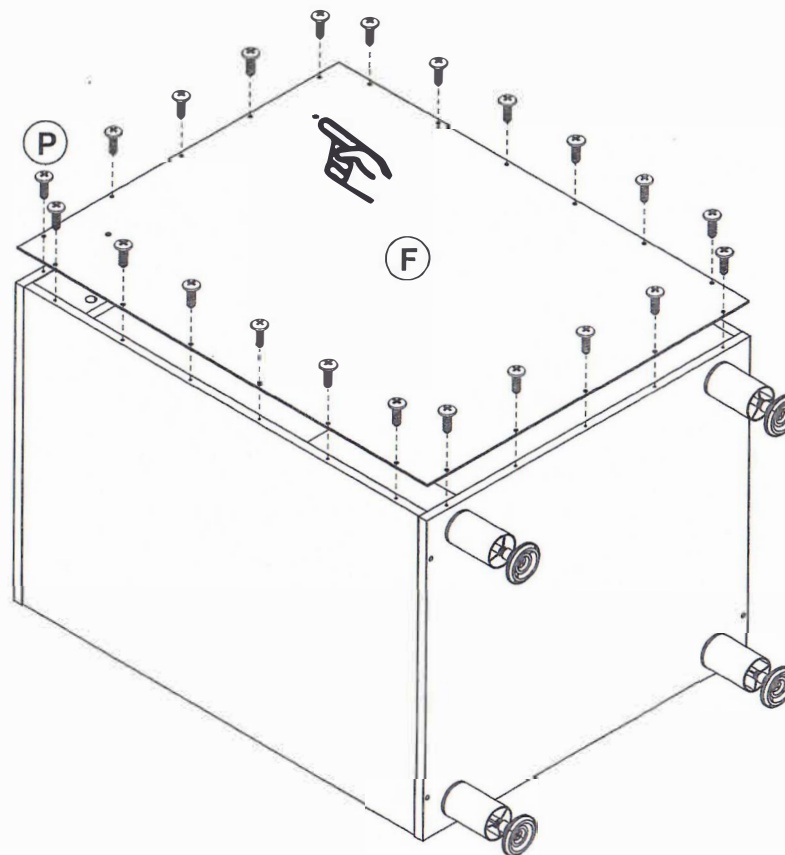

1. Attach the back panel (F) to the body using screw (P).
Notice: Make sure the body angle should be in right angle before attach the back panel in.
And take notice on the back panel direction.

step 8.

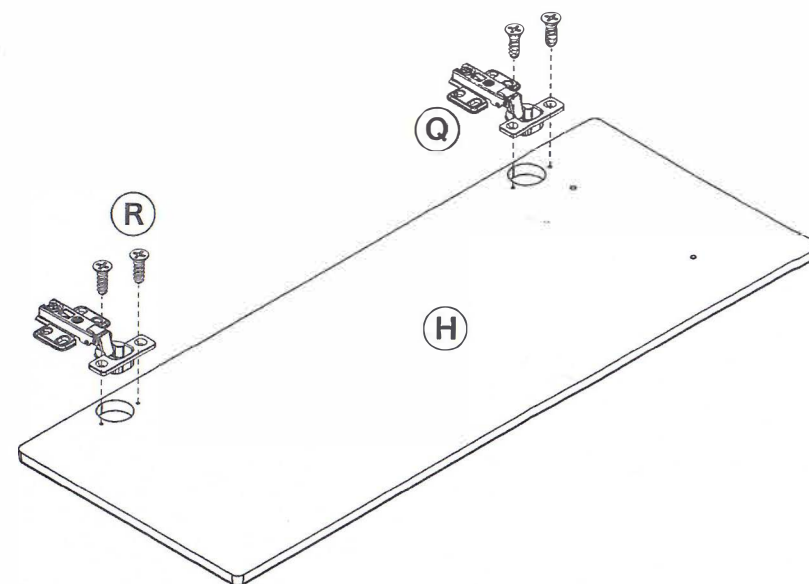
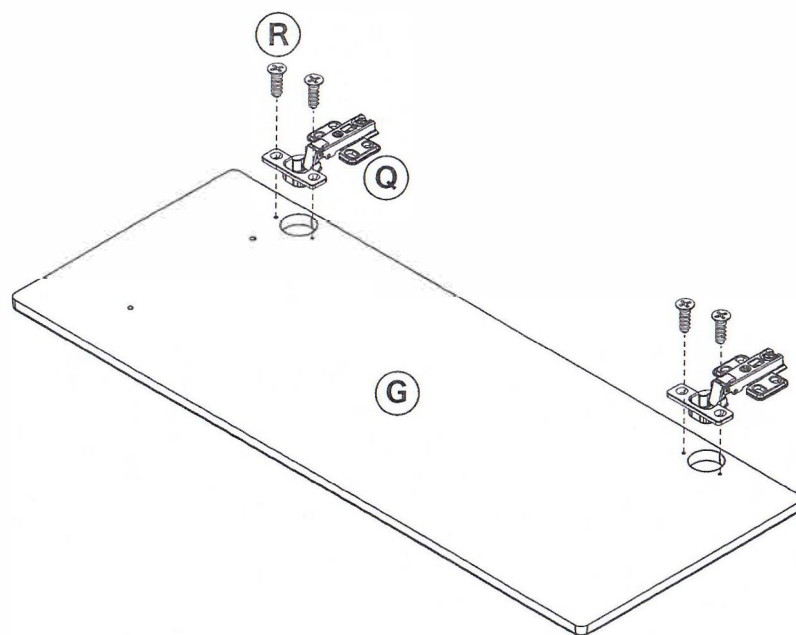

(Q) x 4
Hinge

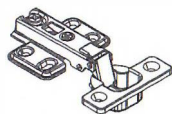

(R) x 8
Screw Ø4 X 14mm



1. Attach the hinge (Q) to the part (G) and (H) using screw (R).

step 9.

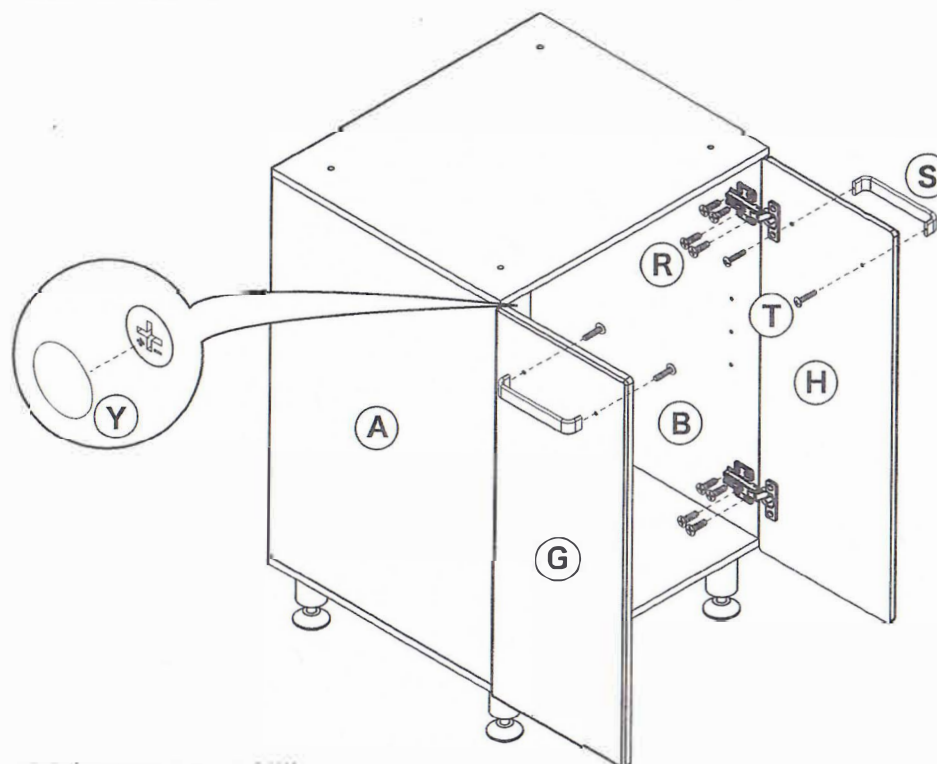
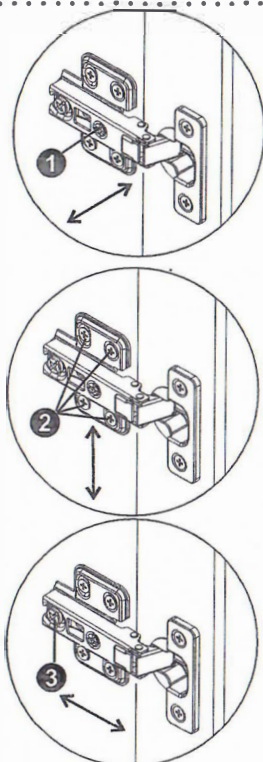

(R) x 16
Screw Ø4 X 14mm



(S) x 2
Handle

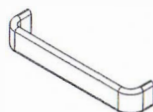

(T) x 4
Bolt M4 x 20mm



(Y) x 4
PVC cover Ø20



1. Attach the door panel (G) and (H) to the side panel (A) and (B) using screw (R).
 2. Attach the handle (S) to the door panel (G) and (H) using screw (T).
 3. Cover the cam (L) with PVC cover (Y).
- Notice: Adjust the hinge as the image shown if the door gap is not in line after close the door.

step 10.

If you purchase 24201 24" Counter top meanwhile, please refer to the manual 24201 24" Counter top;

If you purchase 24200 71" Counter top meanwhile, please refer to the manual 24200 71" Counter top;

If you purchase 24203 Three drawer base cabinet meanwhile, please refer to below Step 12 - Step 15 for assembly.

If you just only purchase this sku, please proceed with below steps to finish the assembly.

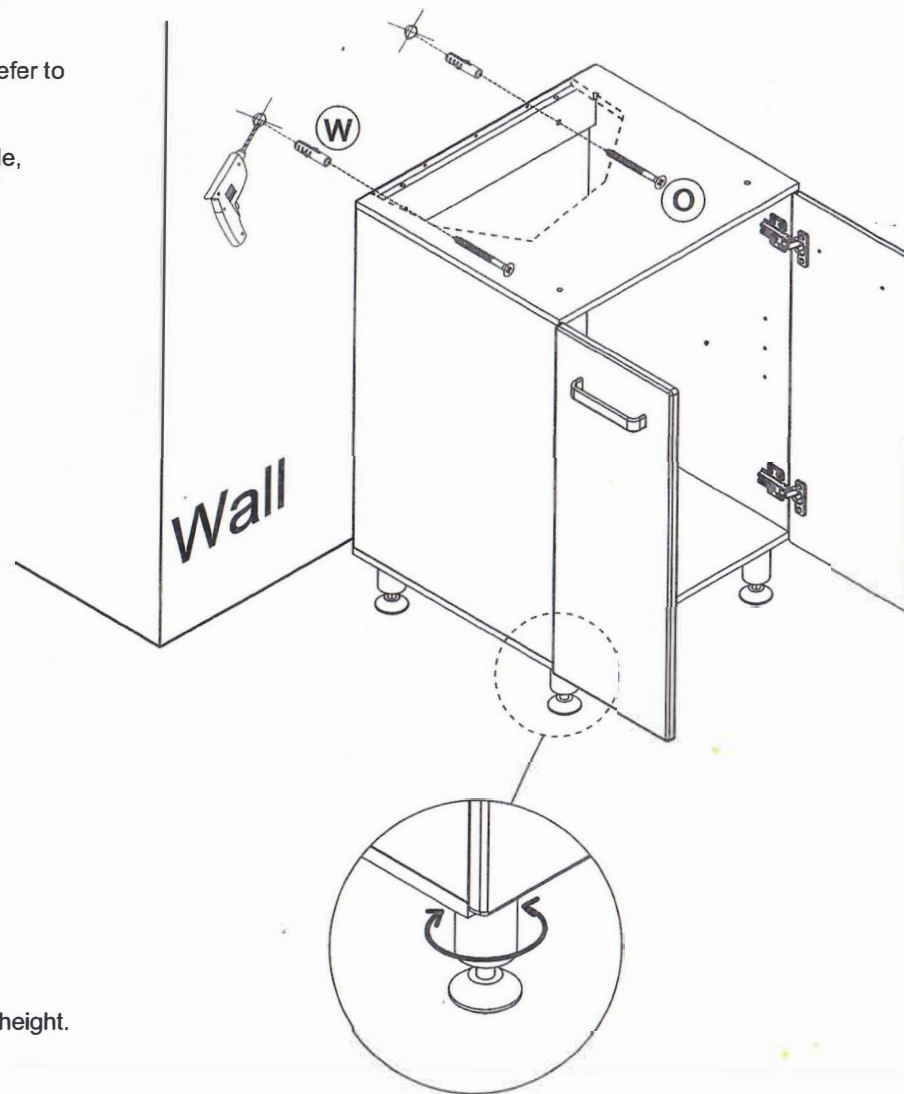

(O) x 2
Screw Ø5 X 50mm

(W) x 2
Wall anchor



1. Mark the screw hole in the wall according to the product height.
 2. Drill the hole in the wall using drill Ø8.
 3. Knock the wall anchor (W) into the hole.
 4. Attach the screw (O) to the wall anchor (W) through the product screw hole.
- Notice: You could adjust the adjustable leg if the floor is not flat.

step 11.

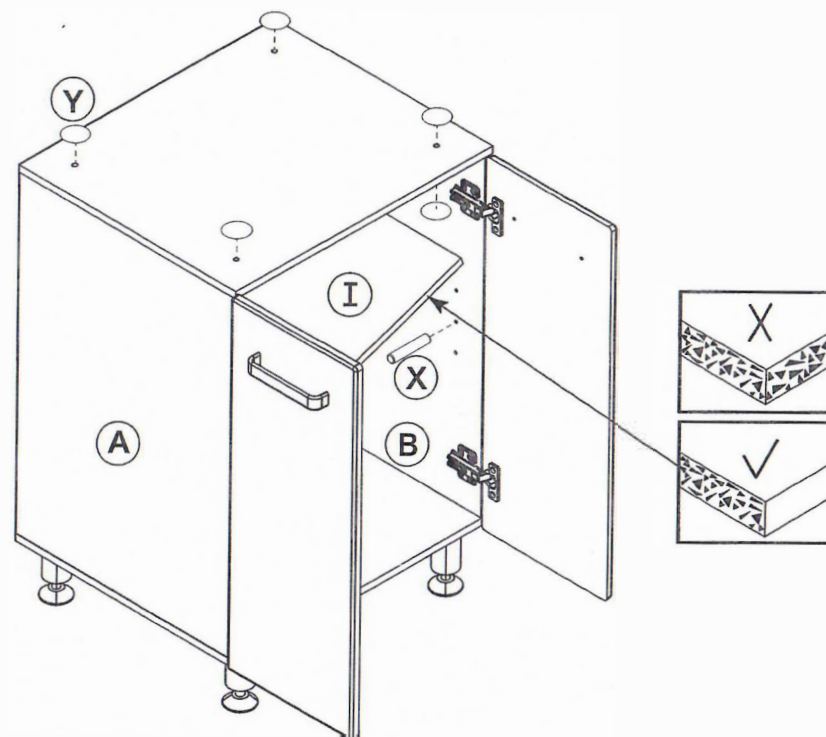

(X) x 4
Shelf pin



(Y) x 8
PVC cover Ø20



1. Cover the screw holes with PVC cover (Y).
2. Insert the shelf pin (X) to the shelf pin hole on parts (A) and (B). You can adjust your using height by adjust the shelf pin.
3. Put the shelf (I) into the product as image shown.

step 12.

How to stack the two door base cabinet to
3 drawer base cabinet?

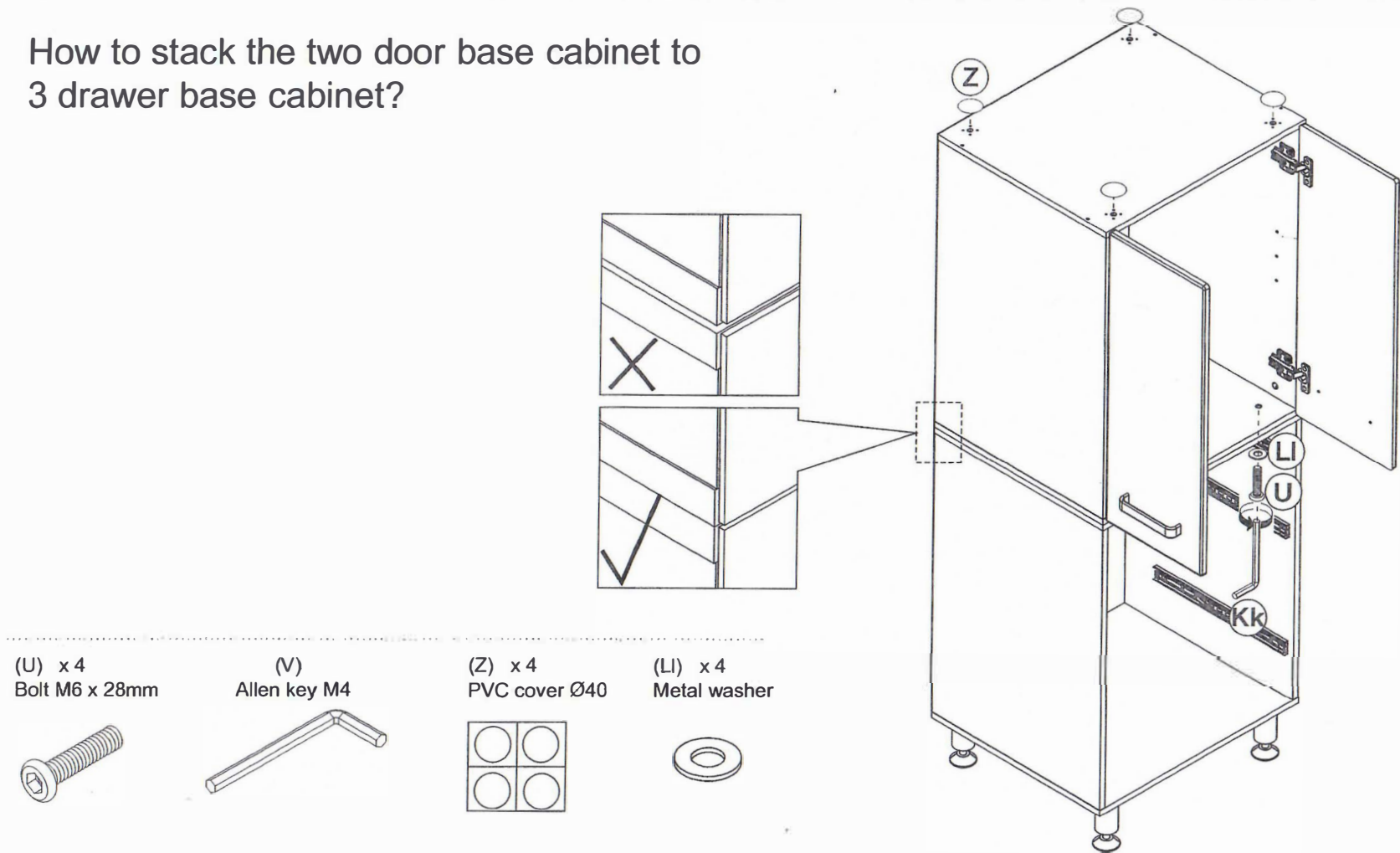

1. Cover the screw holes with PVC cover (Z).
2. Flipped the two door cabinet on the 3-drawer cabinet, fasten them together with screw (U) and metal washer (LI) using allen key (V).

step 13.

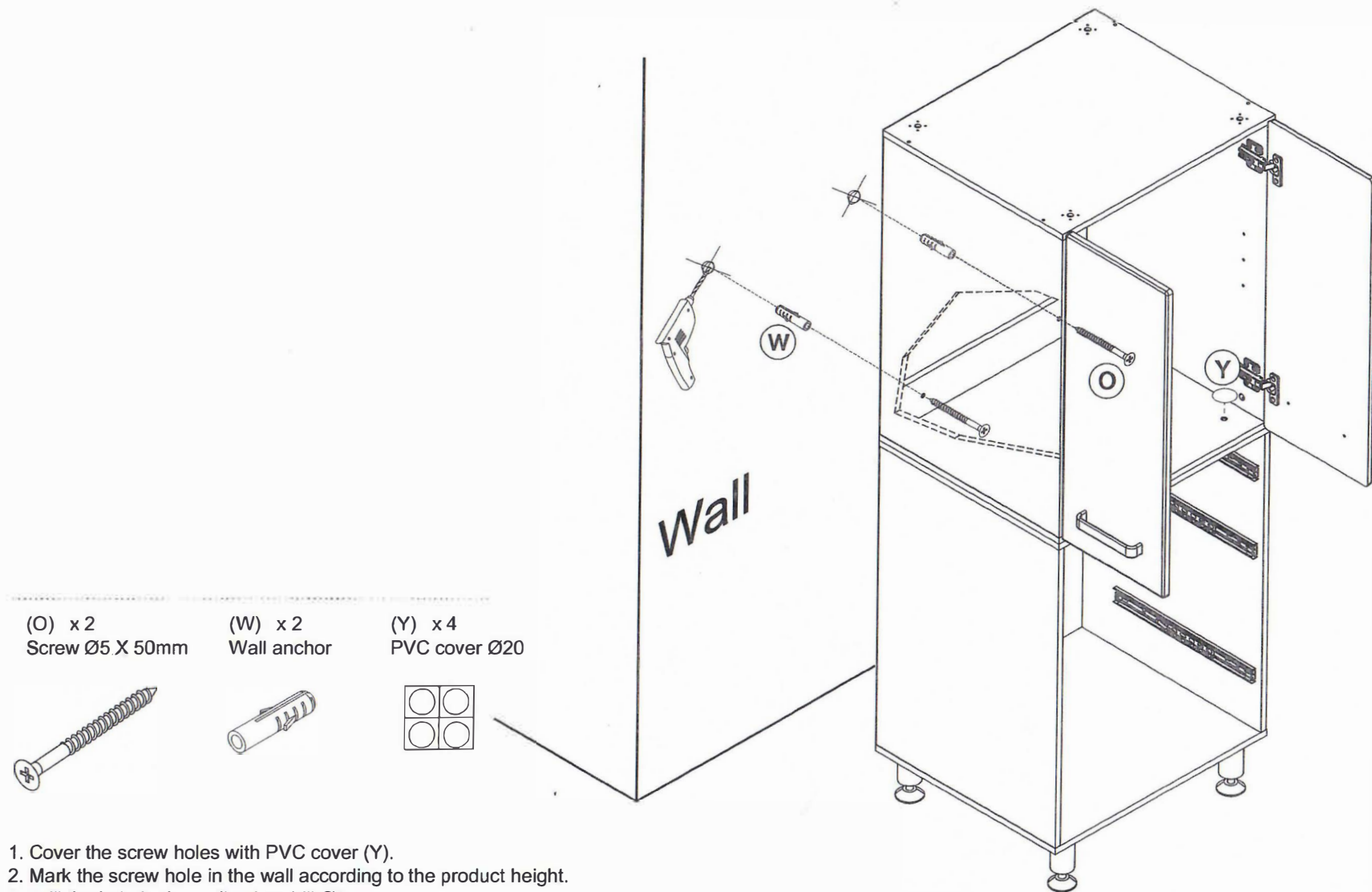

step 14.

(X) x 4
Shelf pin

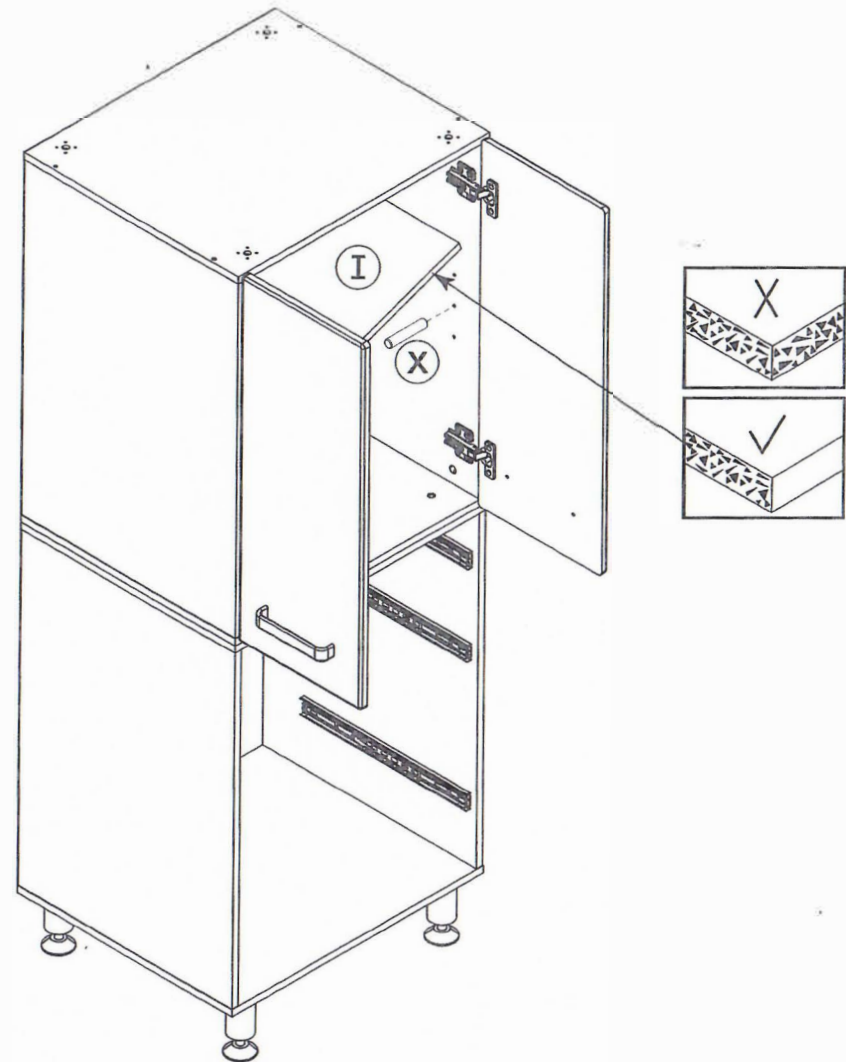

1. Insert the shelf pin (X) to the shelf pin hole on parts (A) and (B). You can adjust your using height by adjust the shelf pin.
2. Put the shelf (I) into the product as image shown.

step 15.

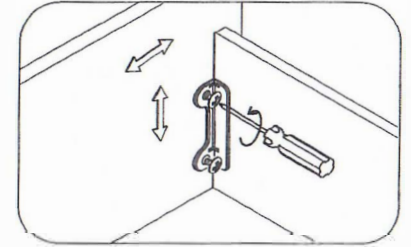
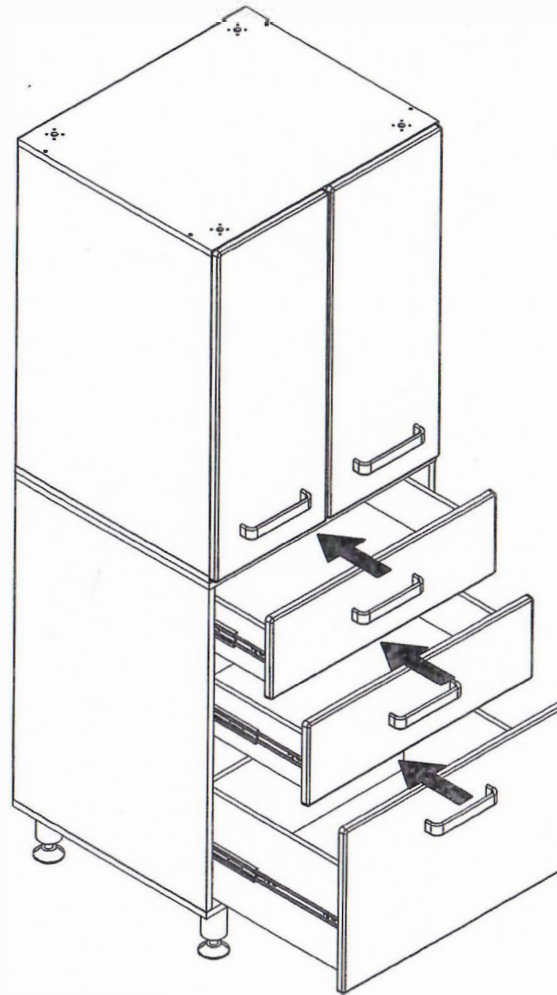
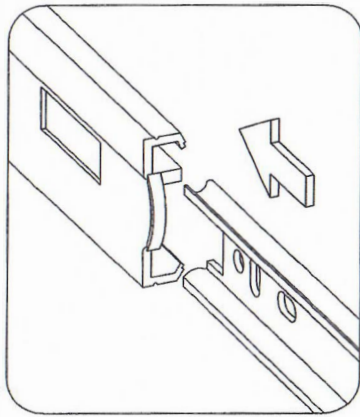
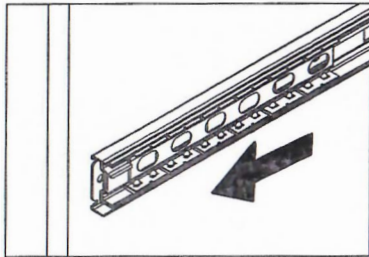

Install the drawers to the cabinet as image shown.
Please note a small degree of force may be necessary to get the slides to engage.