

Installation sequence

1

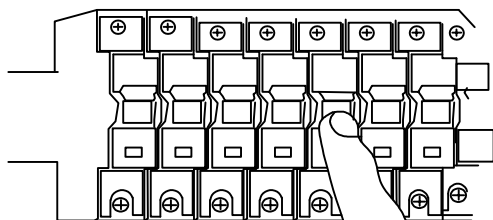

OFF

STEPS

Turn off the power

2

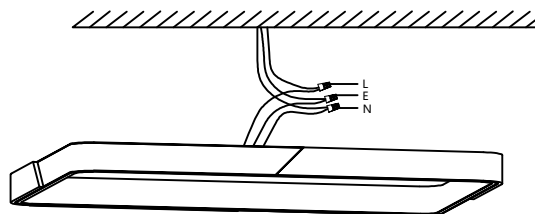

black L
white N
Earth E

STEPS

Use wire caps to connect the wires from the lamp to the junction box, connect Black to Black, White to White and Ground to Ground (usually green or bare copper)

3

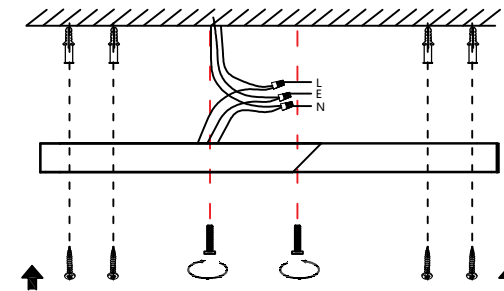

STEPS

Lift the ceiling plate of the whole lamp to the hole of the hanging plate, and fix it with screws

4

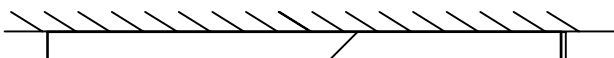

Can be used to change color temperature

- 1 3000K
- 2 3500K
- 3 4000K
- 4 5000K
- 5 6500K

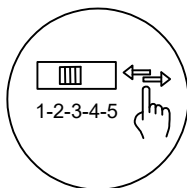

STEPS

1. Toggle the button on the driver to adjust the color temperature
2. Please note that there are two DIP switches inside the lamp body. You need to set them to be synchronized before use.

5

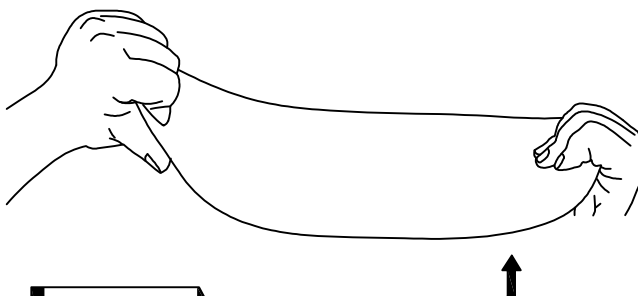
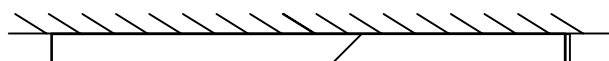

STEPS

1. Take out the lampshade from the package
2. Slightly bend the lamp shade inward with both hands and put it into the lamp body

Advertencia:

1. Voltage: 110-135V ~ 50 / 60Hz
2. For indoor use only
3. Please, professional installation to avoid the risk of electric shock
4. Before installation, check whether the accessories are complete, if there is not enough, please contact customer service in time for replacement
5. Before installation, please cut off the power supply to prevent leakage
6. Please be sure to install according to the company's installation instructions,