

Thank you for choosing our product.

Please read carefully the following installation instructions in order to avoid component damage or injury to the installer.

Keep the installation manual available for future maintenance or reference.

**PRECAUTIONS:** Follow all safety precautions to avoid bodily injury or damage to property.

"Prohibited activities"

 <b>PRECAUTIONS</b>		<p>·Do not stand or place heavy objects on the seat cover. The weight could damage the seat and cove and may cause fall.</p>	
		<p>·Do not use strong abrasive cleansers, as they will scratch and dull the surface. Clean the outside surface of your toilet seat with mild soap water. Wipe the entire surface completely dry with a clean and soft cloth.</p>	
		<p>·Keep children out of reach of the seat, to avoid body injury.</p>	

## Care Instructions

Do not open/close the seat cover using excessive force. (Doing so may cause cracks or failure of performance.)

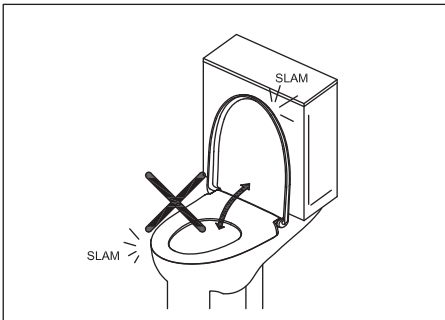

Do not expose the product to direct sunlight. (Doing so may cause color fading.)

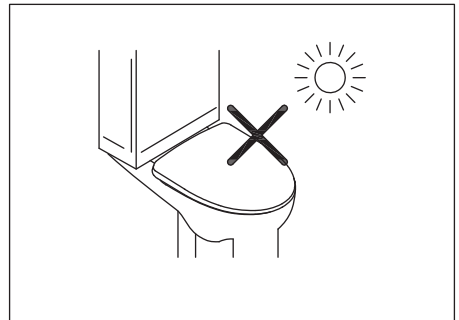

● The seat is available with optional slow close and non slow close function.

※ The closing speed of seat with slow close function can vary with the changing of room temperature and use cycles.

※ The seat without slow close function should be opened manually to fully open position or fully closed position to avoid injuries.

## Installation and disassembly of toilet seat

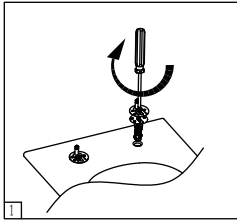

1. Install expansion nut, rubber washer, hinge and screw into the hole, tighten with screwdriver.

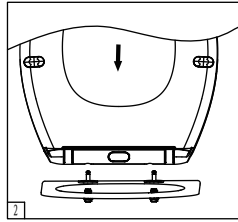

2. Align toilet seat with hinge pin and install it.

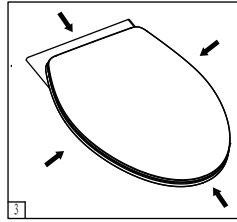

3. Adjust seat on the bowl for perfect fit.

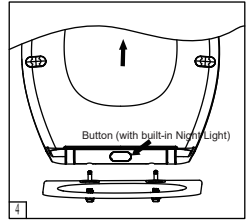

4. Open cover to 90 degrees, press the button to pull it out.

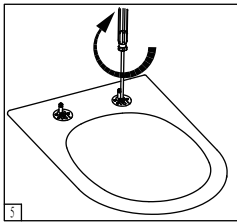

5. Tighten screws.

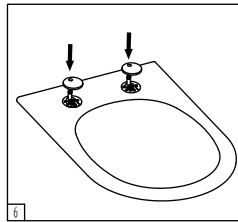

6. Install hinge cover.

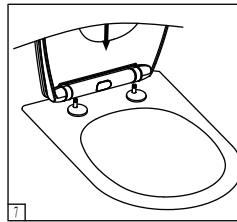

7. Align toilet seat with hinge pin and install it.

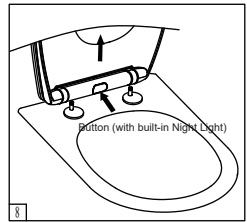

8. Open cover to 90 degrees, press the button to pull it out.

## Installation and disassembly of batteries

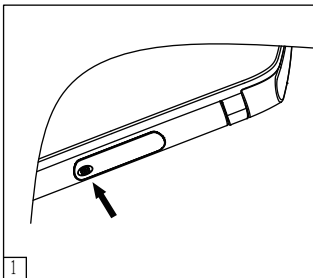

1. Press the position shown in the figure until it clicks: battery cover is released.

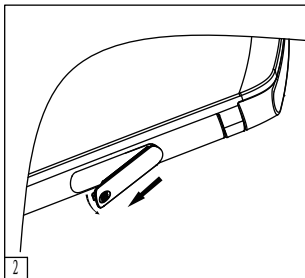

2. Remove battery cover.

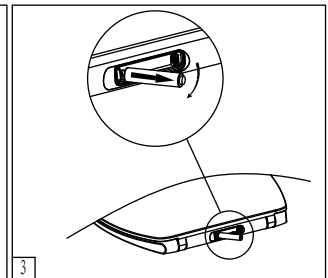

3. Remove old battery.

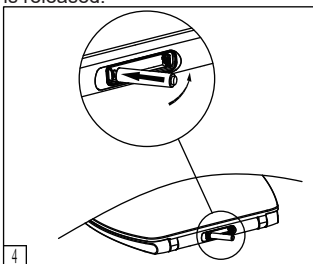

4. Insert new battery (1\* AAA battery).

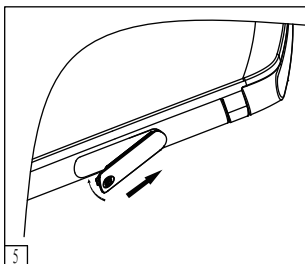

5. Install battery cover.

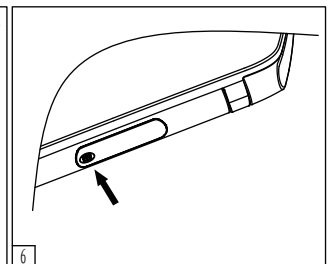

6. Press the position shown in the figure until it clicks: battery cover is locked.

Note: Battery not provided.