

Installation & Assembly

NO	Description	QTY
G	Headrest	1
A	Backrest	1
B1	Seat Cushion	1
B2	chassic	1
C	Armrests	2
D	Gas Lift (Air Rod)	1
E	Casters (Wheels)	5
F1	Base (5-star Foot)	1
F2	5-legs	5
j	M6 X 45mm	6+1
h	M8 X 20mm	3+1
i	M6 X 30 mm	4+1
k	Allen Key	1
m	M6 X 16mm	2+1
n	M6 X 12mm	10+1
o	T-bar	1

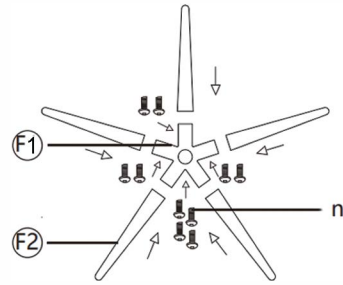

1. Assemble the Base:

- Attach the five legs (F2) to the 5-star base(F1) using Screw n (M6 × 12mm) using Allen Key (k).

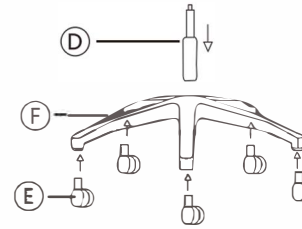

2. Install the casters and gas lift:

- Insert the casters(E) into the holes at the bottom of the base.
- Insert the gas lift(D) into the center of the base until it fits securely.

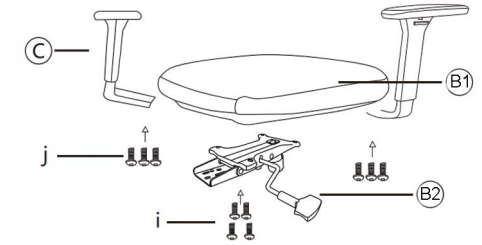

3. Install the Seat Mechanism and Armrests:

- Secure the chassis(B2) to the seat(B1) using Screw i (M6 × 30mm).
- Attach the armrests(C) to the seat using Screw j (M6 × 45mm)

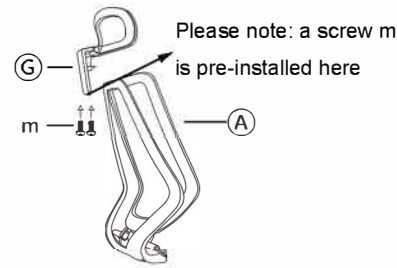

4. Attach the Headrest:

- Secure the headrest(G) to the backrest(A) using Screw m (M6 × 16mm).

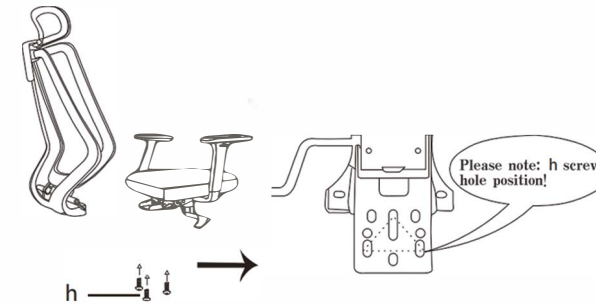

5. Install the Backrest to the Seat:

- Align the backrest with the seat and attach using Screw h (M8 × 20mm).



6. Connect the Seat to the Base:

- Carefully place the entire seat assembly onto the gas lift until it clicks into place.

Please note: One additional screw of each type is provided in the kit as a spare, in case any parts are lost or damaged during assembly.

Warnings:

- Read the instructions carefully before assembly.
- Do not use the product until it is fully assembled.
- Check the product's load capacity and do not put full body weight on the armrests.
- Use on flat ground only.
- Do not stand on the product.
- Dispose of damaged products properly.
- Indoor use only.
- Only trained personnel should repair the back angle adjustment component with energy accumulator.
- Keep the instructions for future reference.