

# ASSEMBLING & INSTALLATION INSTRUCTIONS

The drawing shown may not exactly match the product enclosed.  
However, the installation instructions do apply to this product.

- ◆ **WARNING! SHUT POWER OFF AT FUSE OR CIRCUIT BREAKER.**
- ◆ **ATTENTION! COUPER LE COURANT AU FUSIBLE OU UN DISJONCTEUR.**

## ASSEMBLING THE FIXTURE (Fig.1).

1. Shut off the power at the circuit breaker and remove old fixture from ceiling, including the old single bar.
2. Carefully unpack new fixture and lay all the parts on a clear surface.
3. Attach the mounting plate (A) to the junction box using screws (B). The side of the mounting plate marked "GND" must face out.  
**The junction box is not included.**
4. Determine the desired hanging height and thread rods (E & F & G) to fixture body (H).
5. Feed fixture wires through center tube (G & F & E). Connecting center part (G & F & E) to fixture body (H) and turn clockwise until firmly tightened.
6. Connecting canopy (C) to part (E) and turn clockwise until firmly tightened.
7. Using the end of cluster crystals(J) hang to the small holes of the round frame(I).
8. Attach the frame (I) and the collar ring (K) onto the socket of fixture body (H), and then lock it securely with the check ring (L).
9. Place the canopy (C) over the mounting plate (A) and secure with brass balls (D).
10. Install the light bulb(not included) in accordance with the fixture specifications.  
**NOTE: DO NOT EXCEED THE SPECIFIED WATTAGE!**

## CONNECTING THE WIRES (Fig.2)

1. Take the black wire from the ceiling junction box and the smooth wire leg from the fixture and twist bare ends together. Twist wire connector onto end of wire until snug.
2. Repeat same process with white junction box wire and ribbed wire leg of fixture wire. NOTE: Twist wires together in the same direction you twist the wire connector onto wires.
3. If your junction box has a grounding wire (green or bare copper), attach this wire and the bare copper wire from the fixture together as **step 1**. If junction box has no ground wire, attach the bare copper fixture wire to the green ground screw on the single bar.
4. Tuck these wire connections neatly into the ceiling outlet box and then raise the canopy (C) all the way to the ceiling.

**Your installation is now complete. Return power to the junction box and test the fixture.**

FIG.1

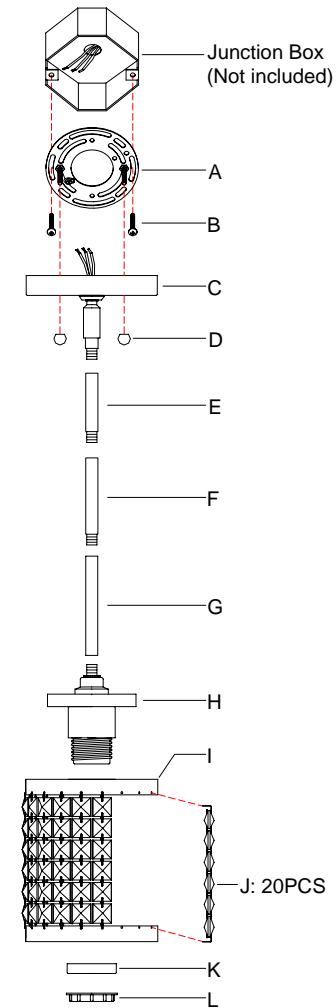

FIG.2

