

ASSEMBLY INSTRUCTIONS

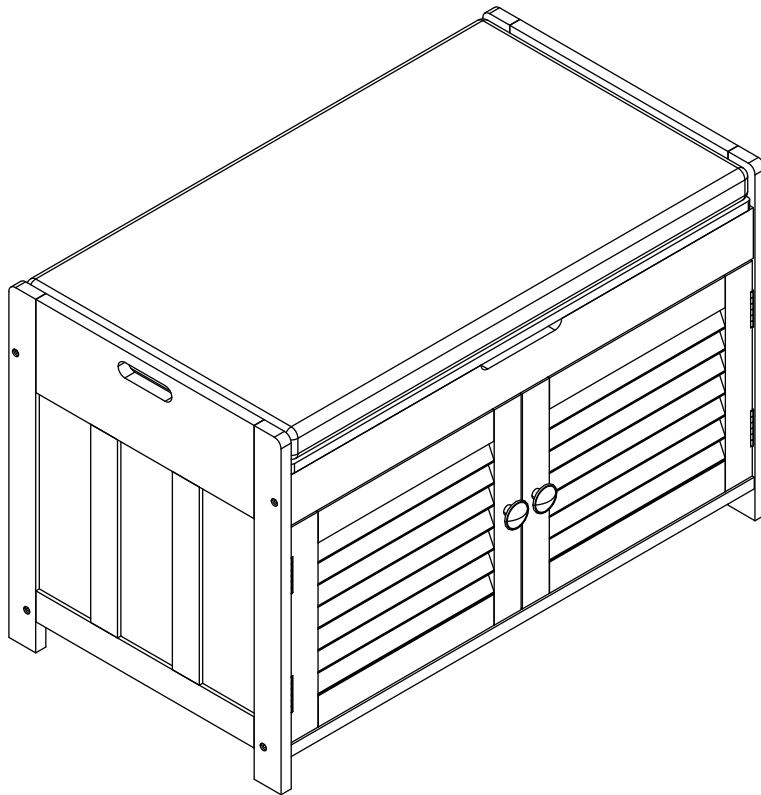

Whether the hardware or parts are lost or damaged, or any problems issue during installation, please contact us in time, we will provide you with the best after-sales service,

Warmhoniu-Service@outlook.com

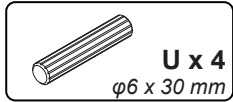
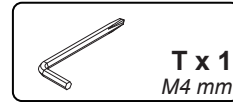
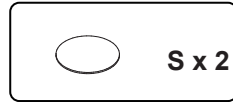
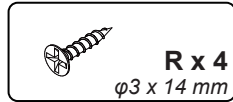
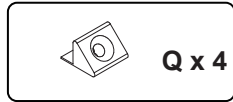
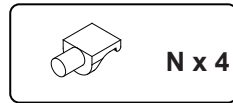
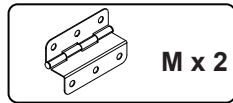
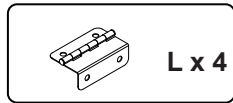
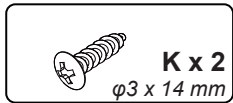
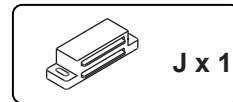
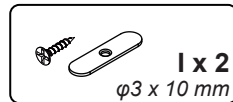
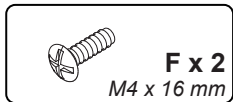
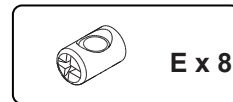
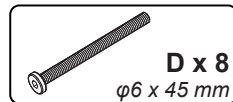
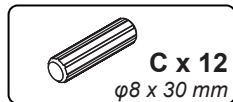
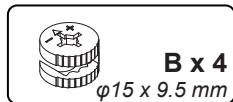
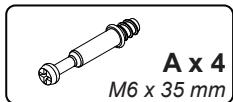
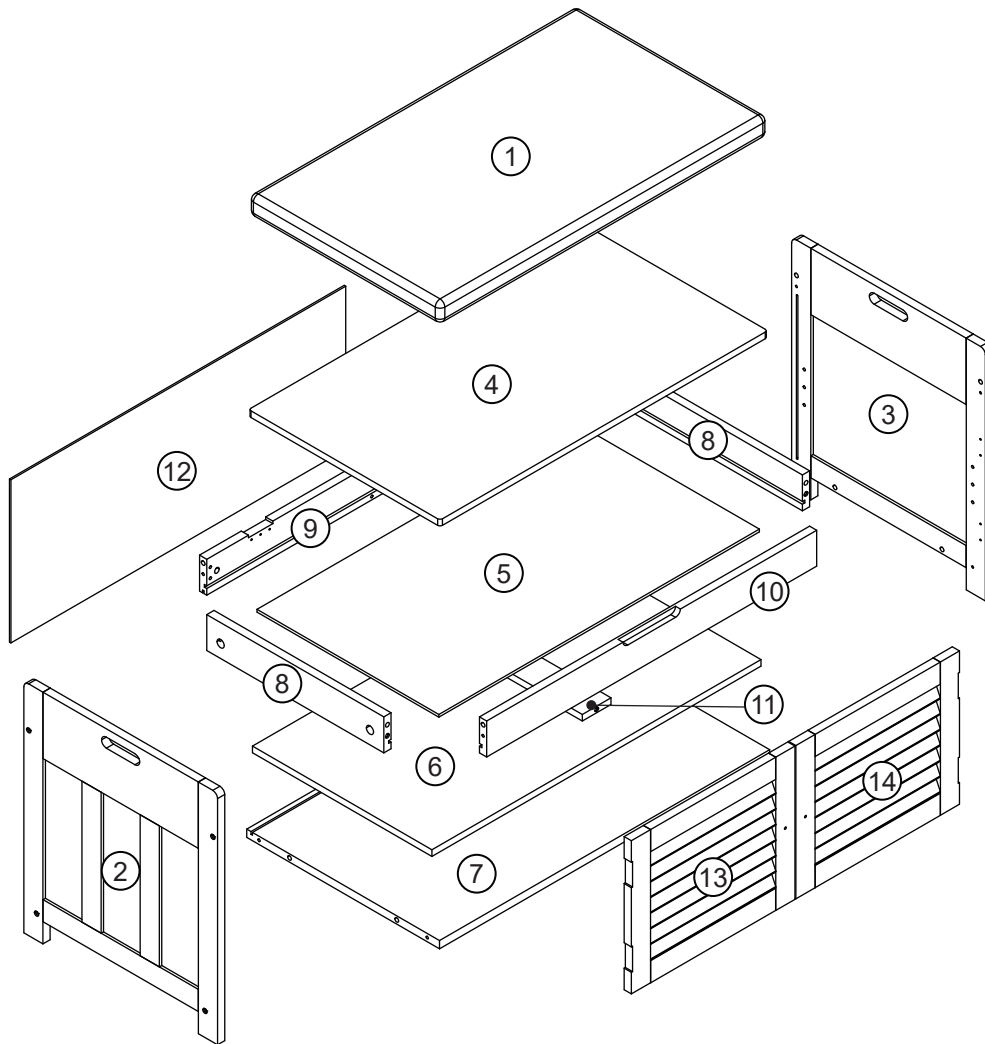

TOOLS REQUIRED

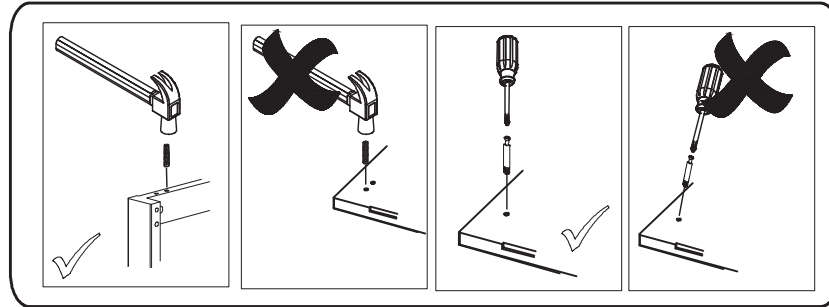
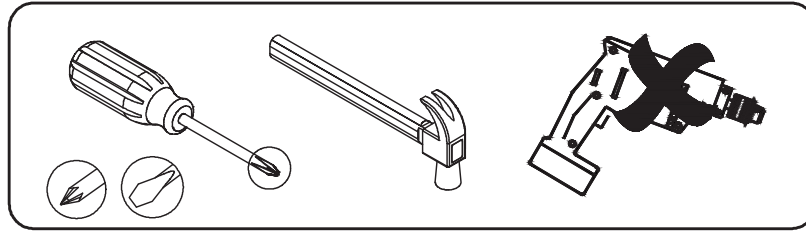

Note: Do not use tools other than those required, as this may damage your item.

IMPORTANT NOTES

Please check that you have all the hardware and screws. If you are missing any hardware or screws, please contact us.

Please be careful not to drag the boards on the floor during the installation process, causing worn.

Don't attempt to repair or modify parts that are broken or defective. Please contact the store immediately.

Do not tighten screws until all screws are in the correct position.

Do not use this product unless all bolts, screws and knobs are securely fastened.

Check that all bolts, screws and knobs are securely tightened at least once every 3 months.

WARNING

If parts are missing, broken, damaged or worn, discontinue use of the product until all repairs have been made using parts authorized by the manufacturer.

Failure to comply with these regulations may result in serious injury.

DANGER

Children must be under parental supervision when using the product.

Step 1

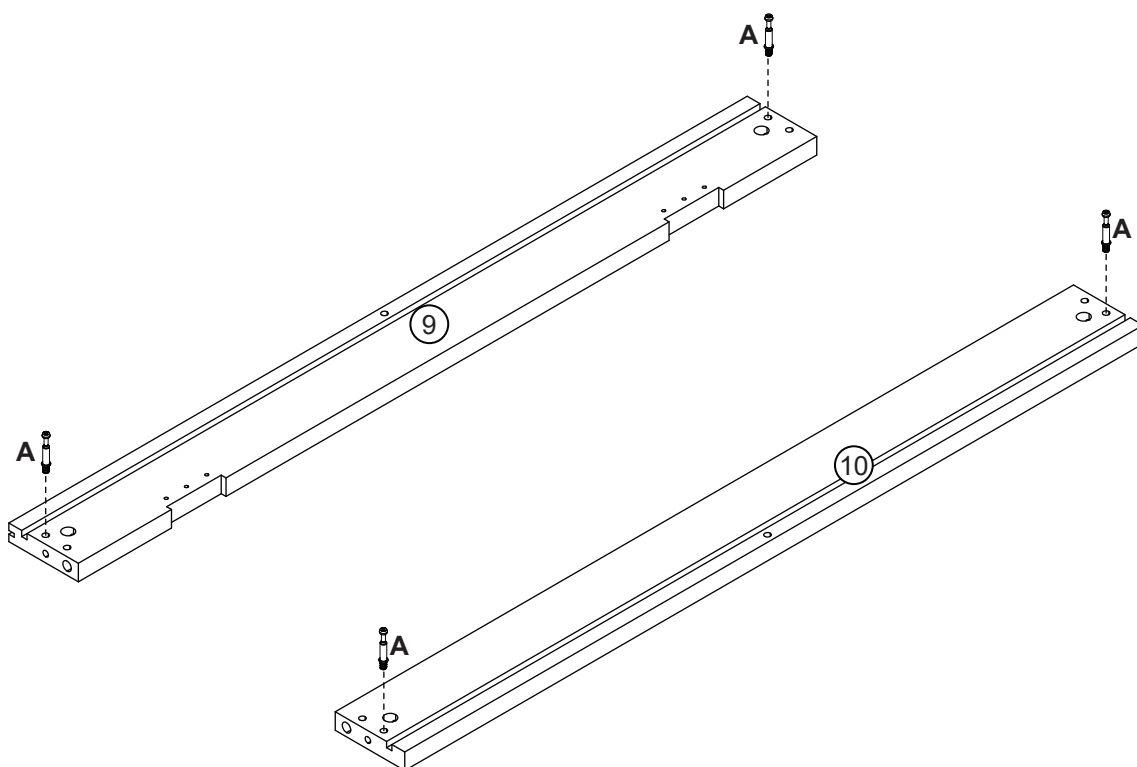
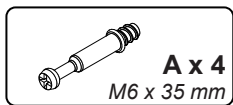

First, find the corresponding board as shown in the picture. Then screw part A into the corresponding hole.

Step 2

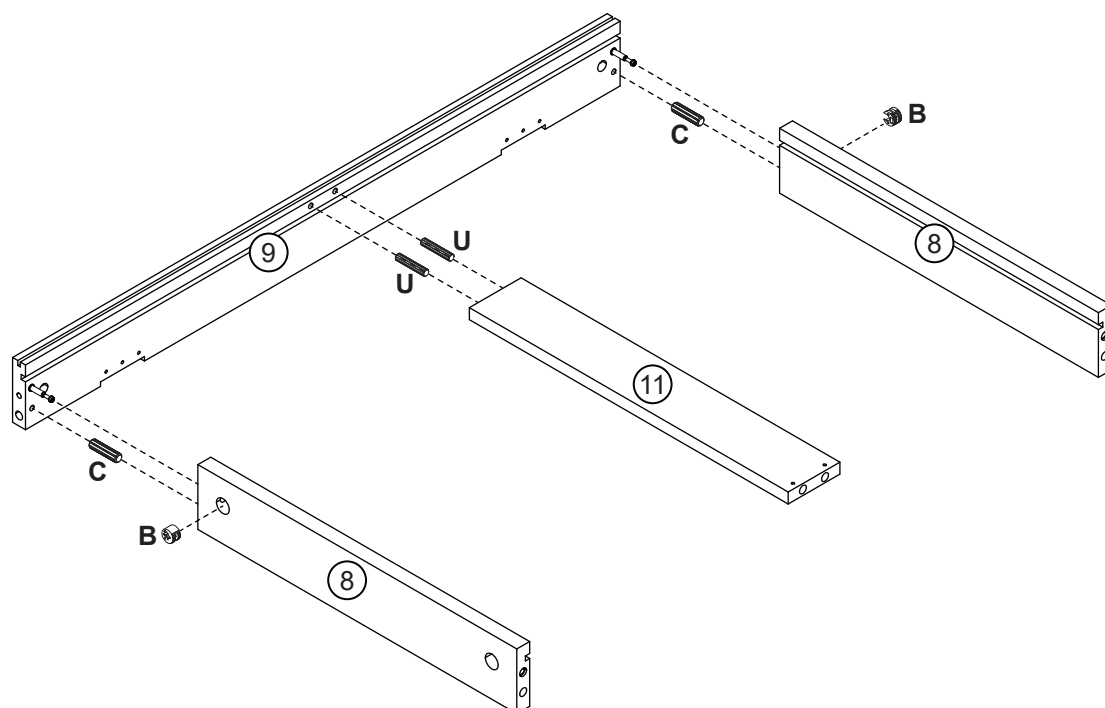
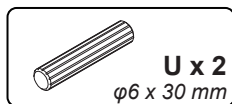
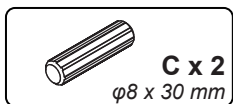

Make sure that the B part is fully inserted into the hole and the screw is clamped before locking.

Step 3

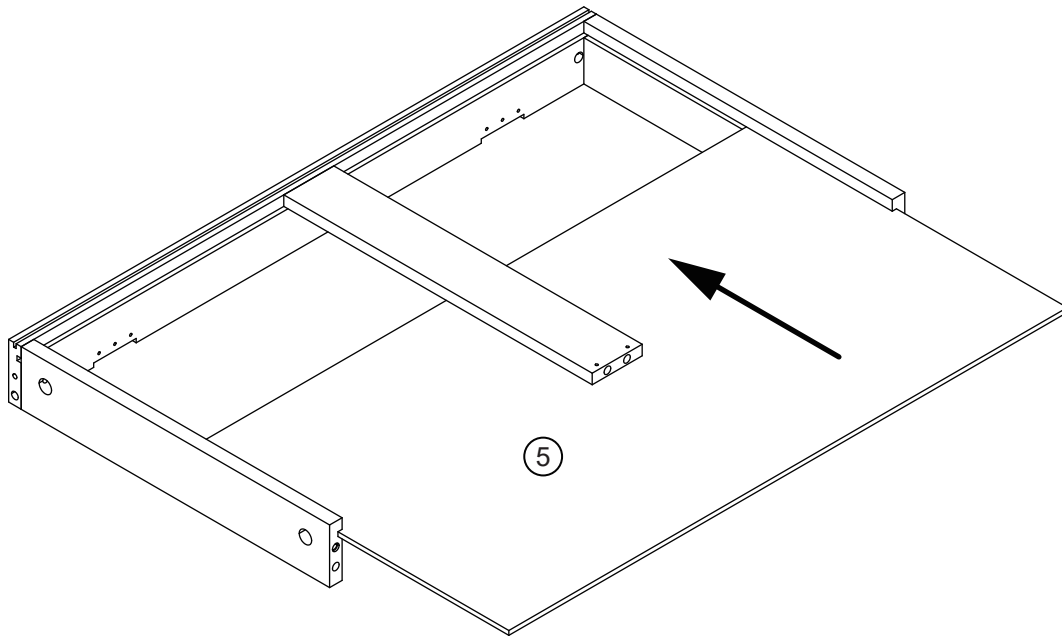

Step 4

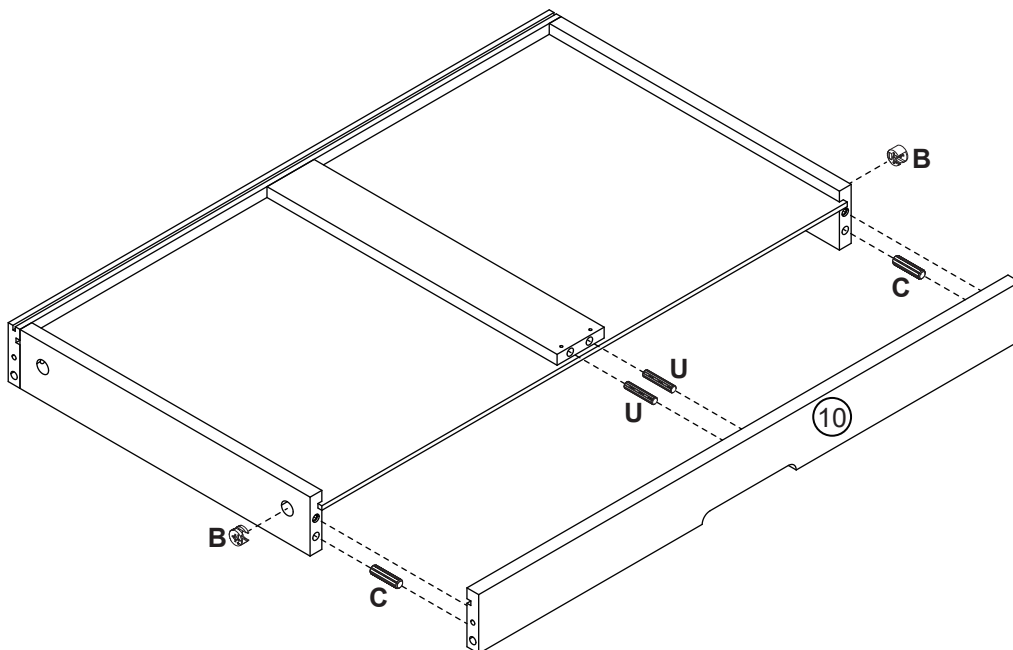
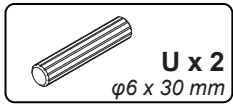
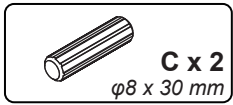
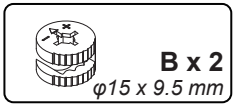

Make sure that the B part is fully inserted into the hole and the screw is clamped before locking.

Step 5

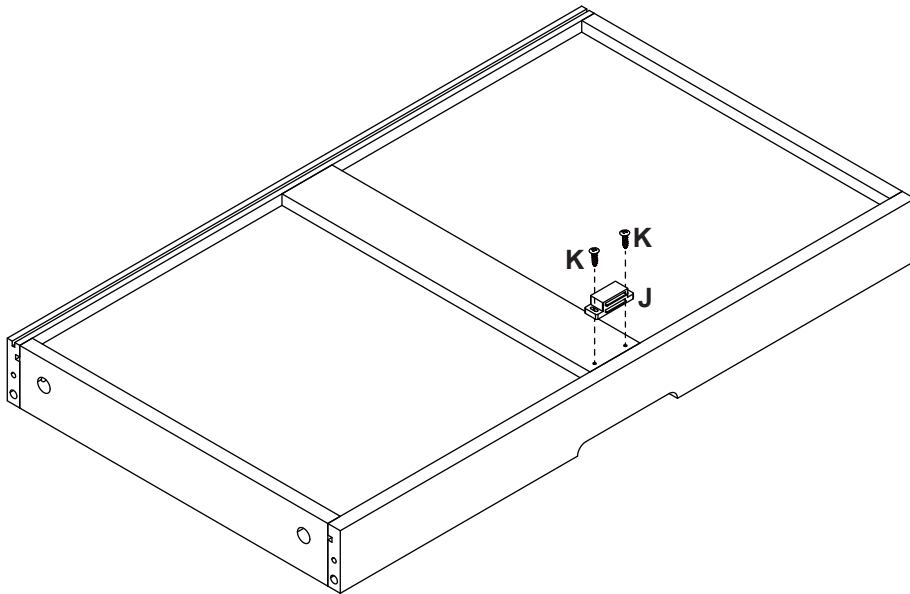
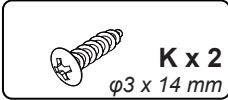
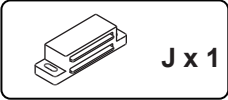

Step 6

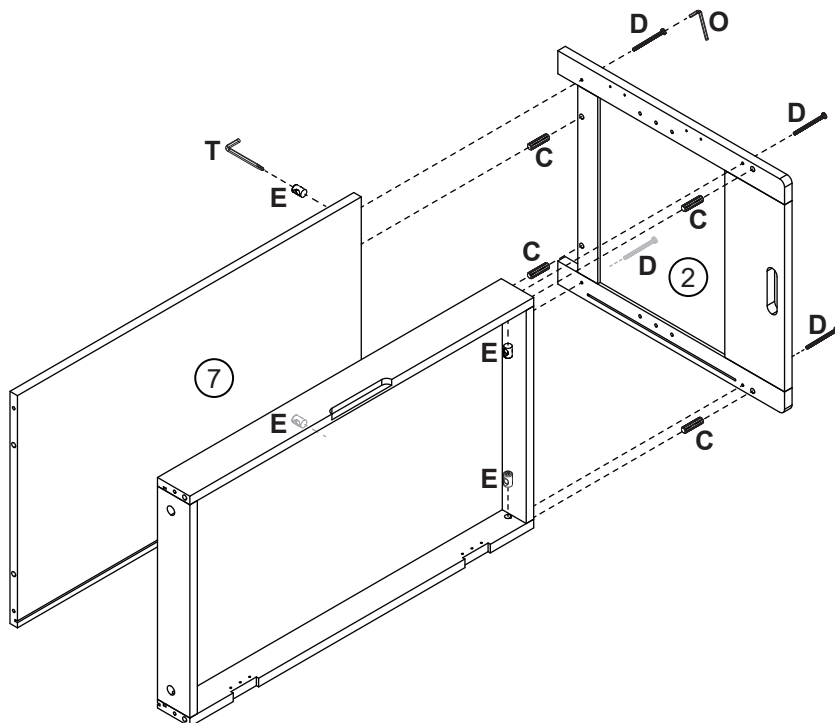
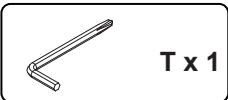
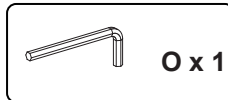
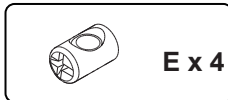
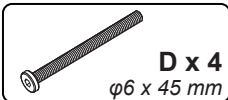
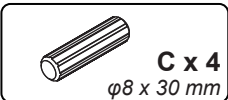

Step 7

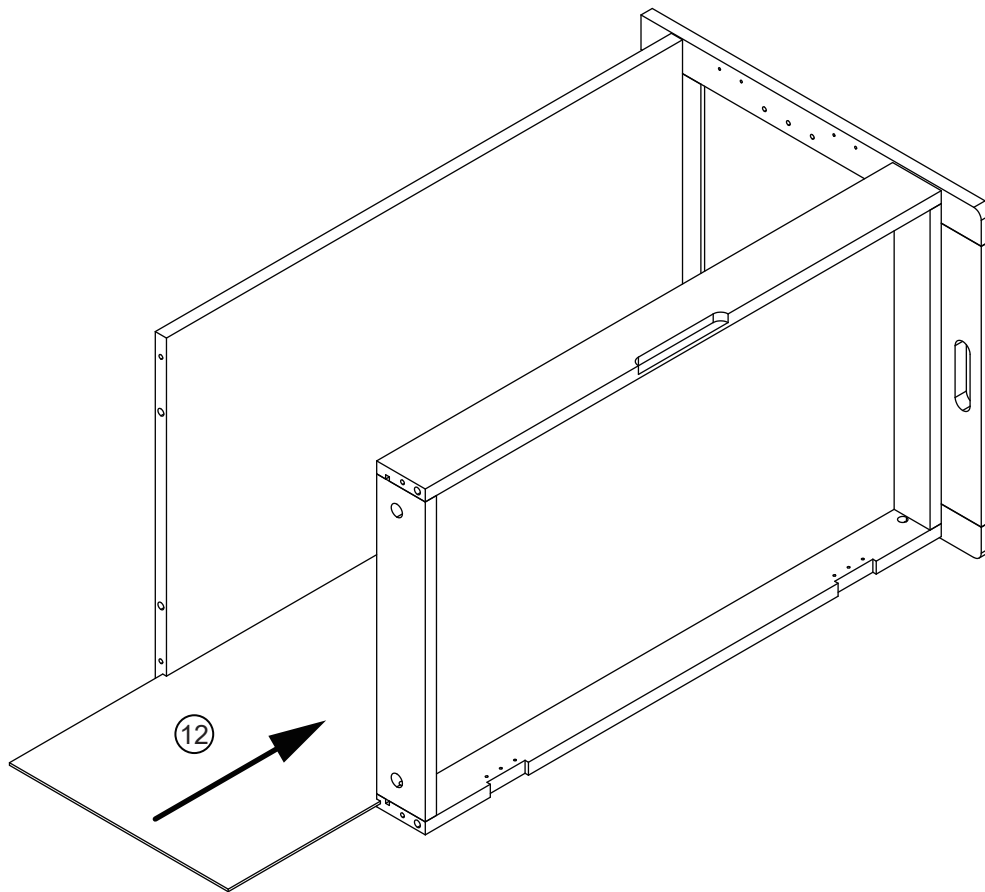

Step 8

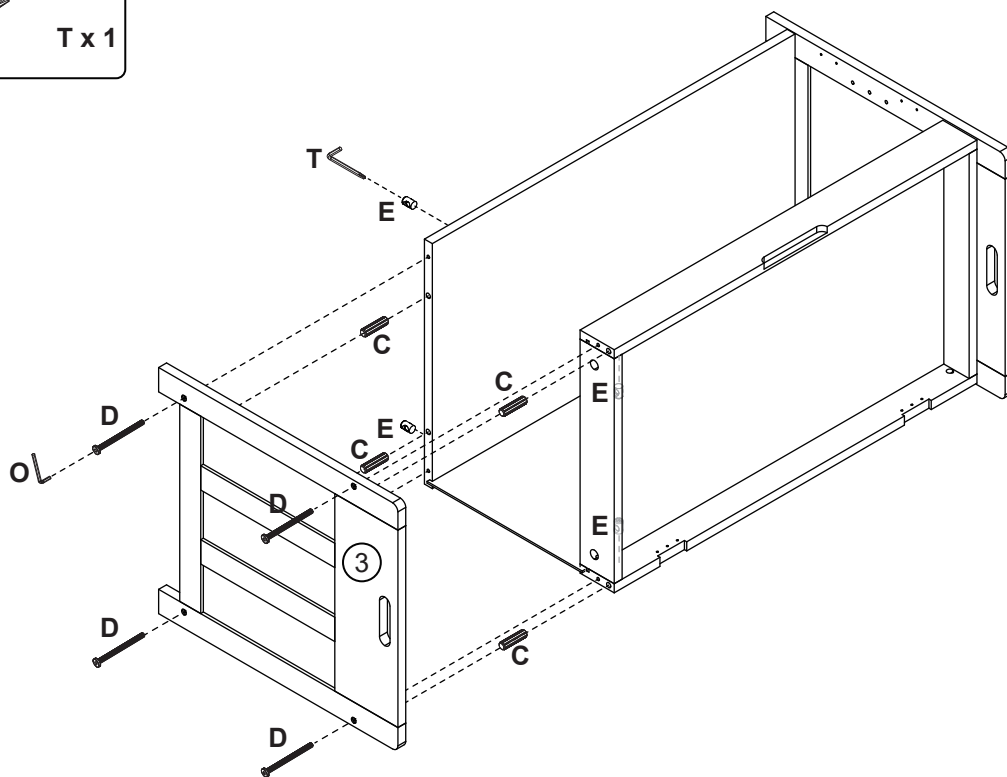
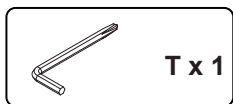
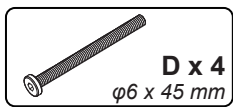
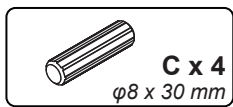

Step 9

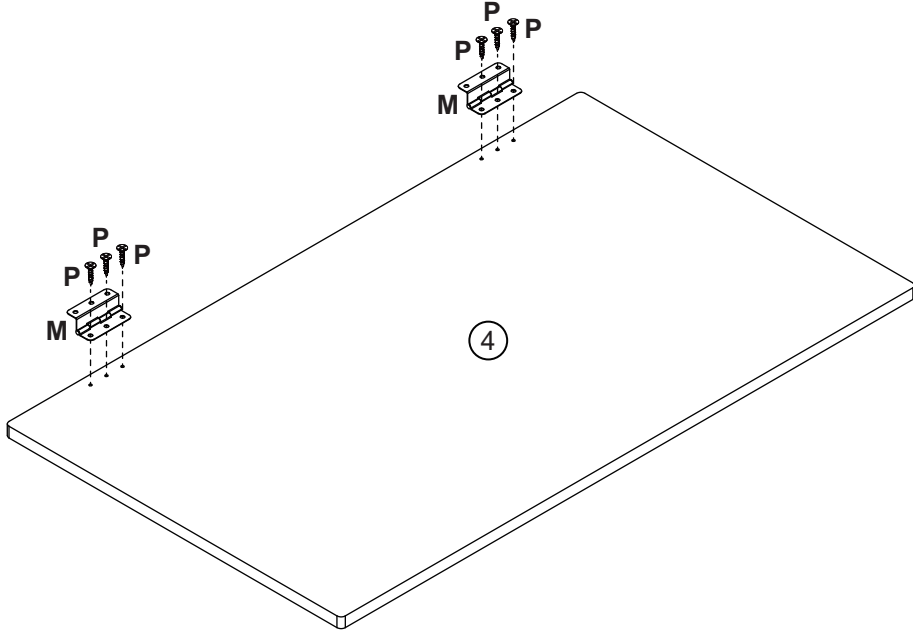
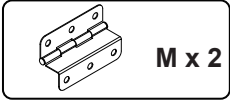
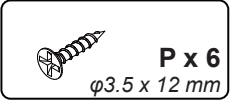

Step 10

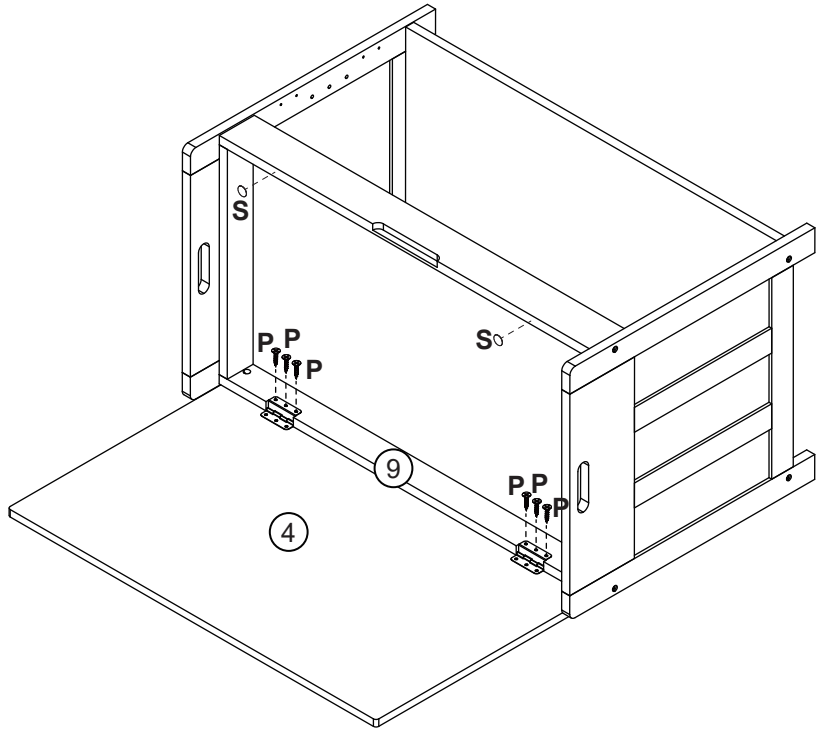
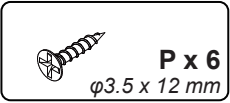

Step 11

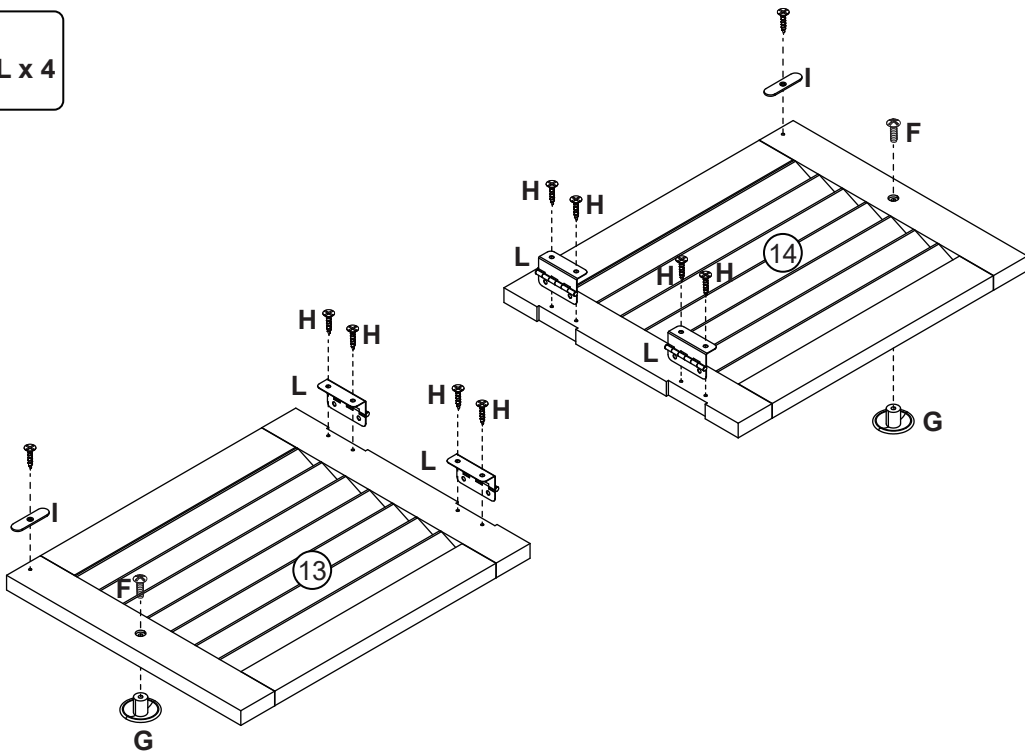
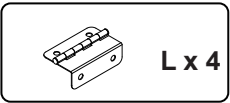
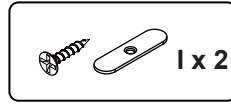
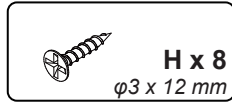
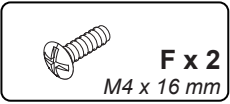

Step 12

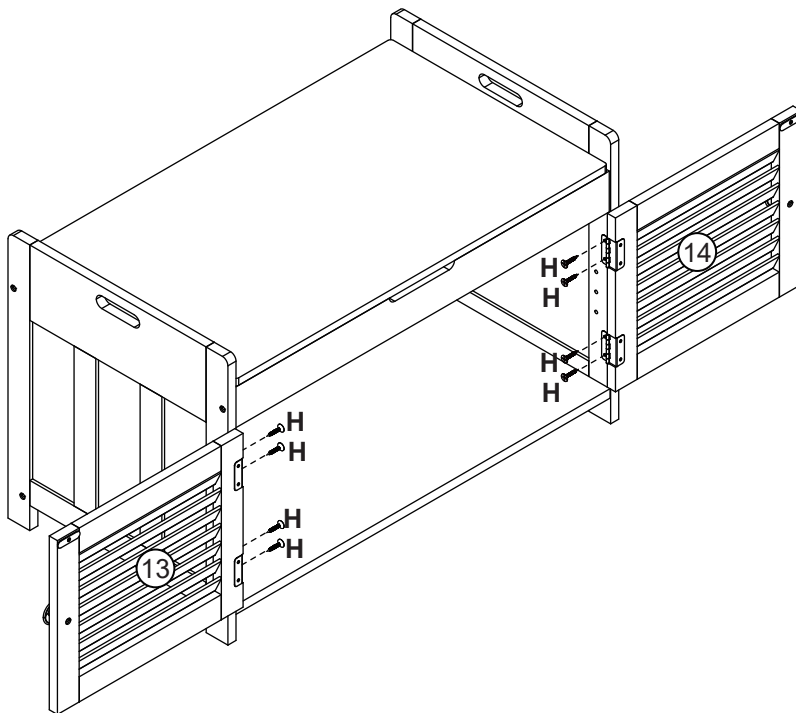
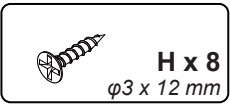

Step 13



N x 4

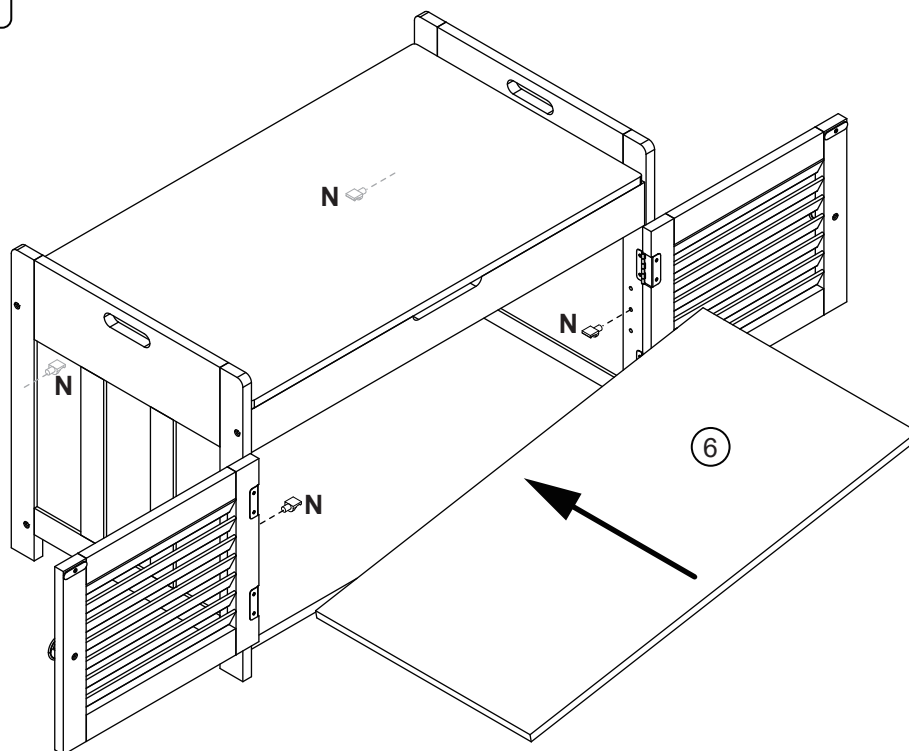

Step 14

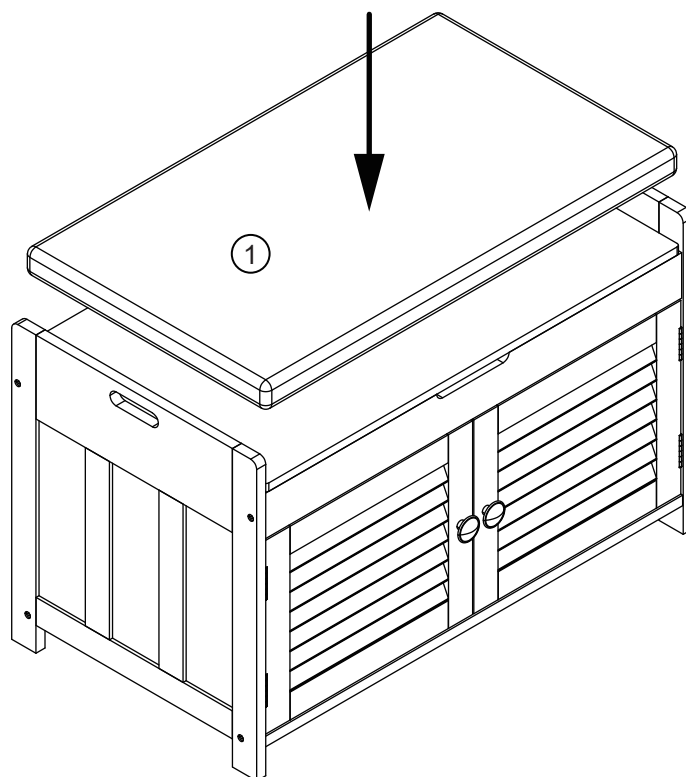

Step 15

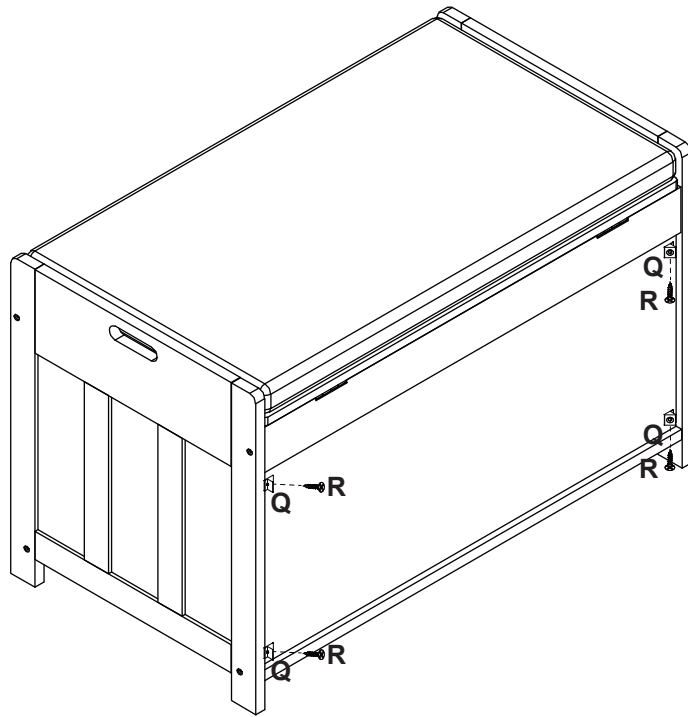

Step 16

