

Owner Manual

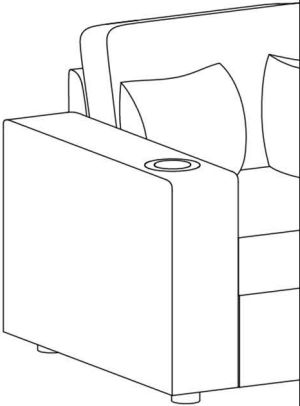

WARRANTY

We strive to offer high quality product and we also try our best to satisfy each customer that order from us, no matter on products or services as needed. Each customer receives a record of their order, such as the order number or item receipt. For any items that are out of warranty period, you may still be able to purchase the replacement parts from our company if they are available.



MAINTENANCE AND WARNING

Please read the manual thoroughly
before you start installing.

Please keep the product away from
sharp object.

Packaging and small parts may have
chocking hazard, please keep them away
from children and pets.

Please clean the product according to each
clean code, check the product description
for more information.

Please keep the product away
from fire.

If you have any other questions, please
contact us, we will be glad to help you out.

If the product is placed under direct
sunlight, the pattern or color might fade
away overtime.

Check the product periodically to make
sure everything is secured and tightened.

Always use proper tools for installation.

Do not jump on the product.

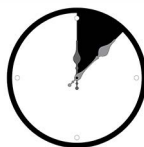

Around 45 min

PRODUCT DESCRIPTION

Plush genuine fur for a soft, durable seating experience that enhances comfort and style.

Generously filled cushion with spring packs for exceptional comfort, support, and long lasting resilience.

Ergonomically designed backrest that offers superior support for extended lounging and relaxation sessions.

Convenient built in cup holder on the armrest for easy access to your drink while you relax.

Spacious ottoman with hidden storage to keep your living space tidy, organized, and clutter free.

EXPLODED VIEW

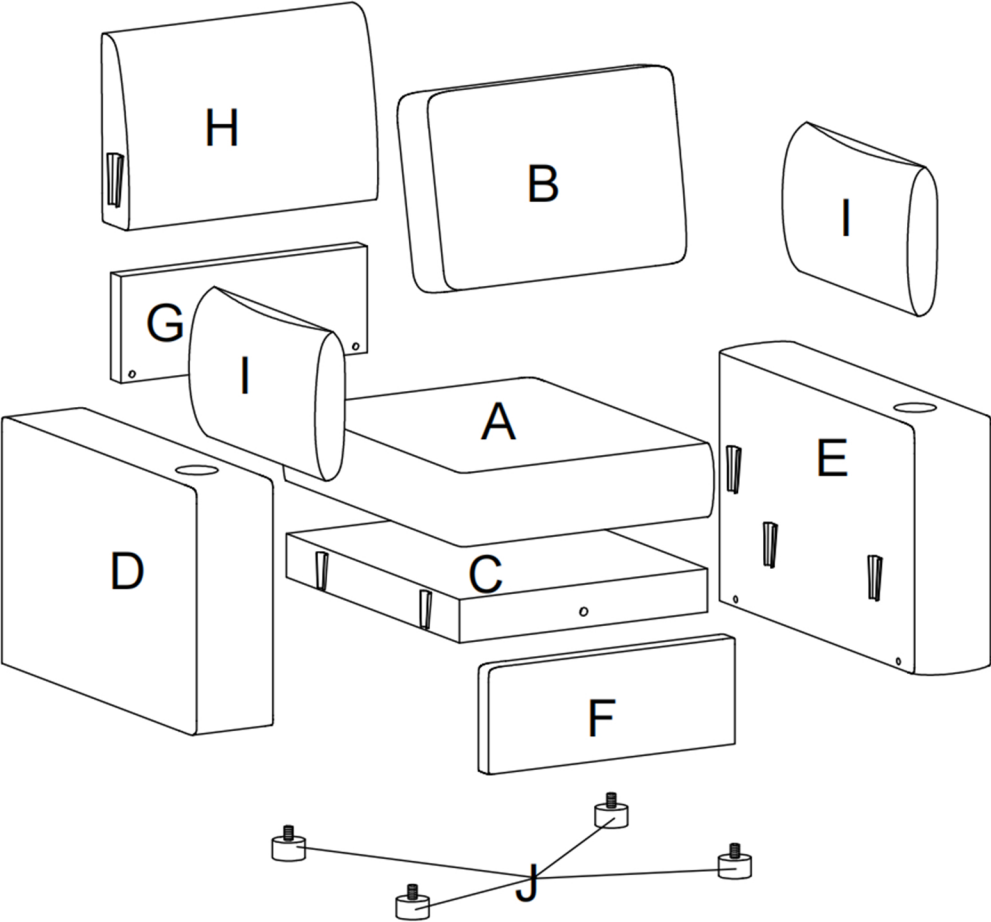

PARTS

A*1

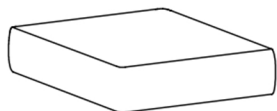

Seat cushion

C*1

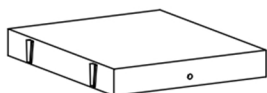

Seat frame

E*1

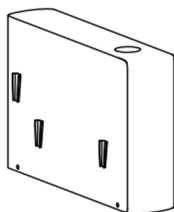

Left armrest

G*1



Back panel (in part D)

I*2



Pillow (in part D)

B*1



Back cushion

D*1

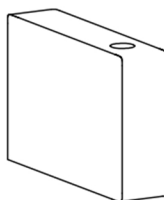

Right armrest

F*1



Front panel (in part D)

H*1

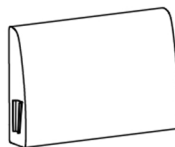

Backrest frame (in part E)

J*4



Legs

HARDWARE

TOOL LIST

NOTE: Designated with (★) We provide additional spare parts in the hardware package

①*8



M8*20mm
Bolts

②*2

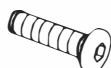

M8*25mm
Bolts

③*10



Flat washer

④*4



L-shaped
locking plate

⑤*1

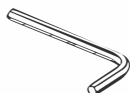

Allen key

⑥*4



Plastic washer

Please make sure all hardware & packing material fitting the list. Especially some small accessories may be missing during transportation. Please contact us if you have any question.

step 1

After taking out of the cushions (A&B) from the air compression bag, please allow it to recover for a period of time.

It might take up to 48 hours to be fully recovered, you may gently slap onto the cushion to speed up the process. Take out two panels (F & G) and two pillows (I) from the right armrest (D), then take out the backrest frame (H) from the left armrest (E).

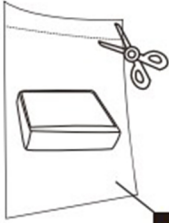

A



B

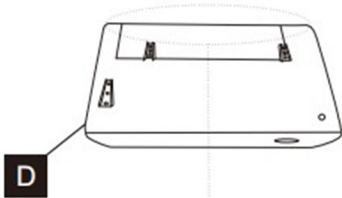
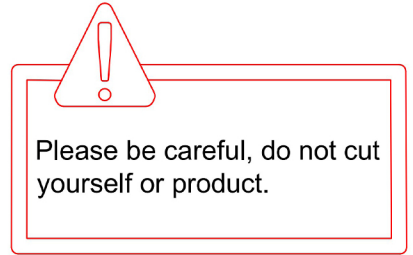

D



F



G



I*2

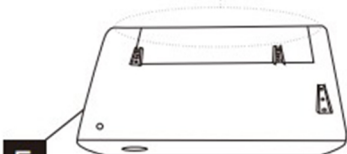
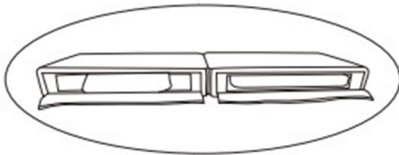

E



H

step 2

Align the connectors on the seat frame (C) with the slots on the armrests (D & E) as shown, and push down the seat frame until they lock. Then push the edges of the seat frame to make sure they are fully interlocked.

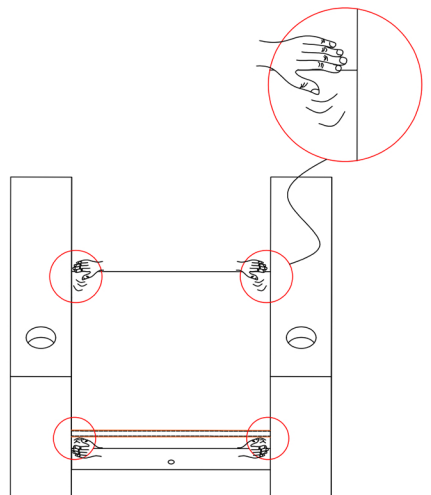
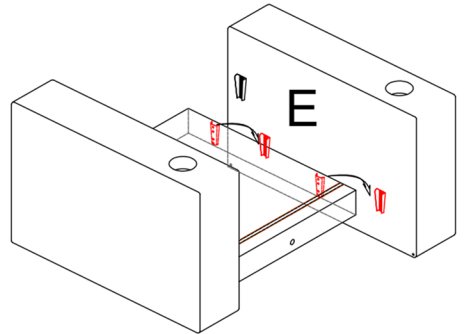
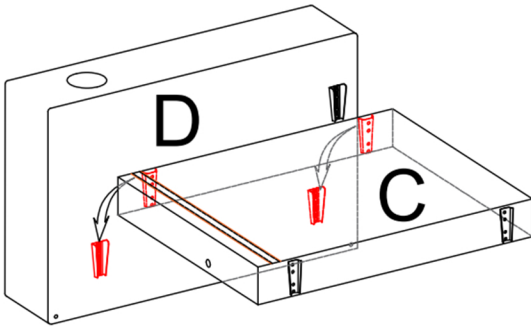

step 3

Place one flat washer on each bolt (1), and then use the allen wrench (5) provided to install the L-shaped locking plate on pre-drilled holes of the armrests (D & E) as shown.

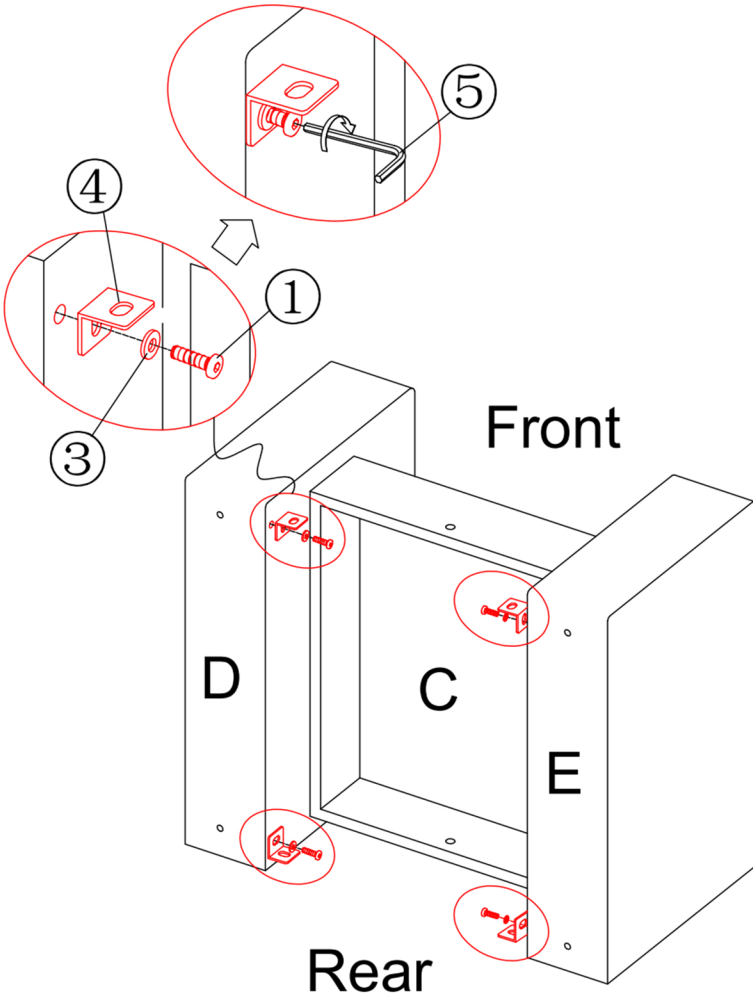

step 4

Install the Front panel (F) onto the seat frame and armrests as shown. Place one flat washer(3) on each bolt (2) &(1) first, then make sure all three bolt holes on armrests and seat frame are aligned with the front panel.

Notice:

We suggest tightening the bolts for 30-50% first, make sure the process is correct and bolt holes are aligned, then fully tightening them all.

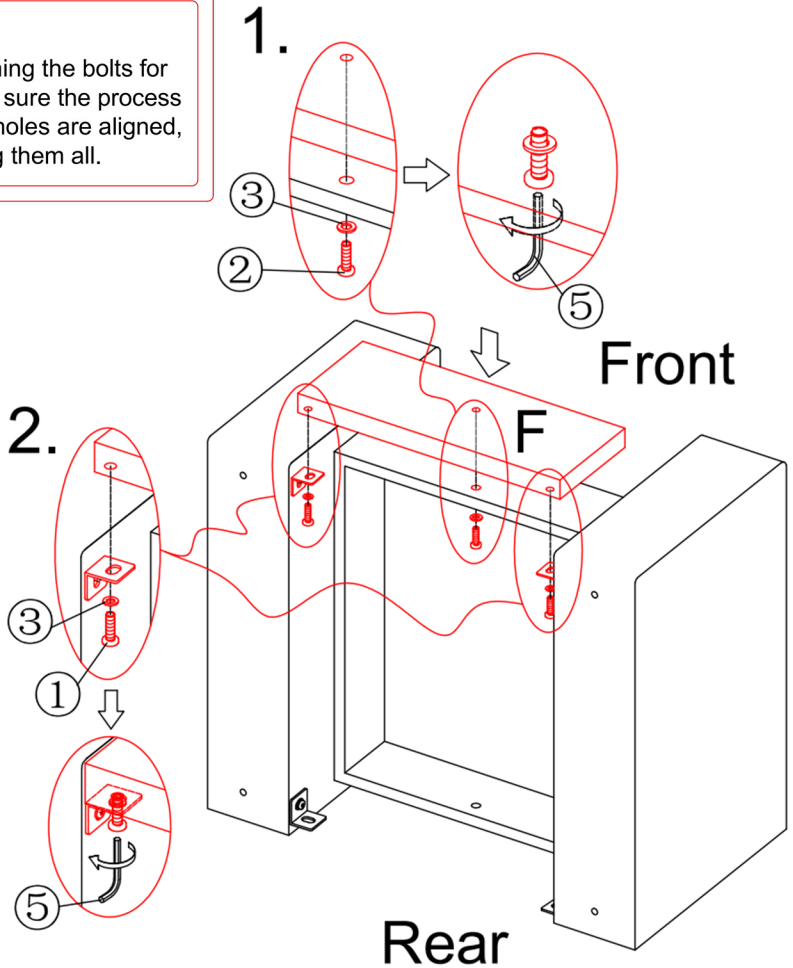

step 5

For convenience, lift up the seat frame and slide in the back panel (G) as shown.

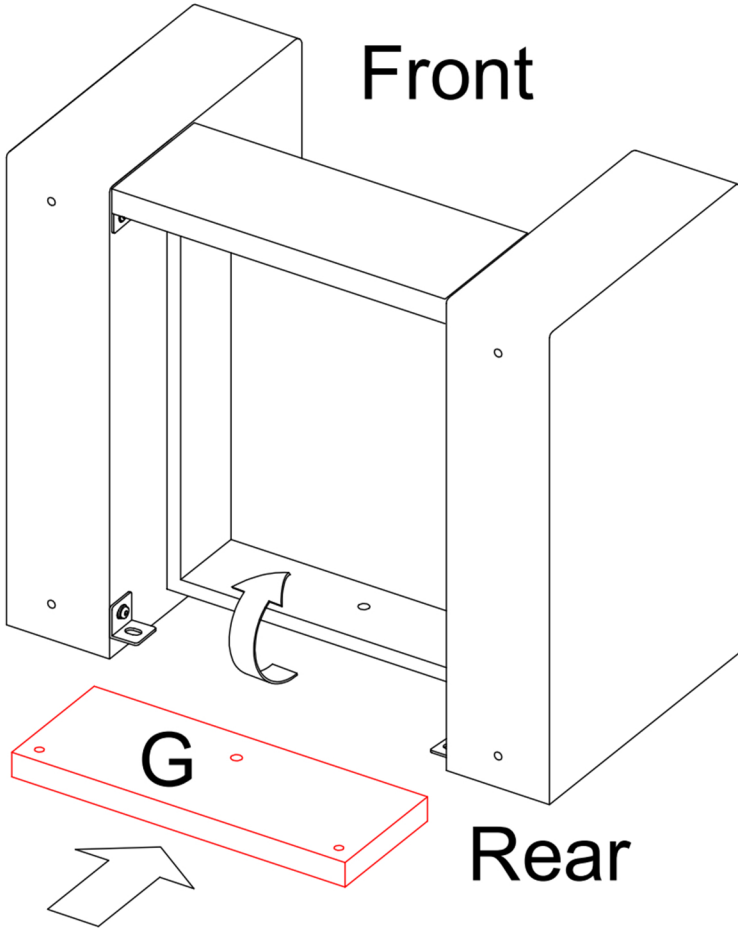

step 6

Install the back panel (G) onto the seat frame and armrests as shown. Place one flat washer(3) on each bolt (2)&(1) first, then make sure all three bolt holes on armrests and seat frame are aligned with the back panel. Then make sure all the bolts are fully tightened.

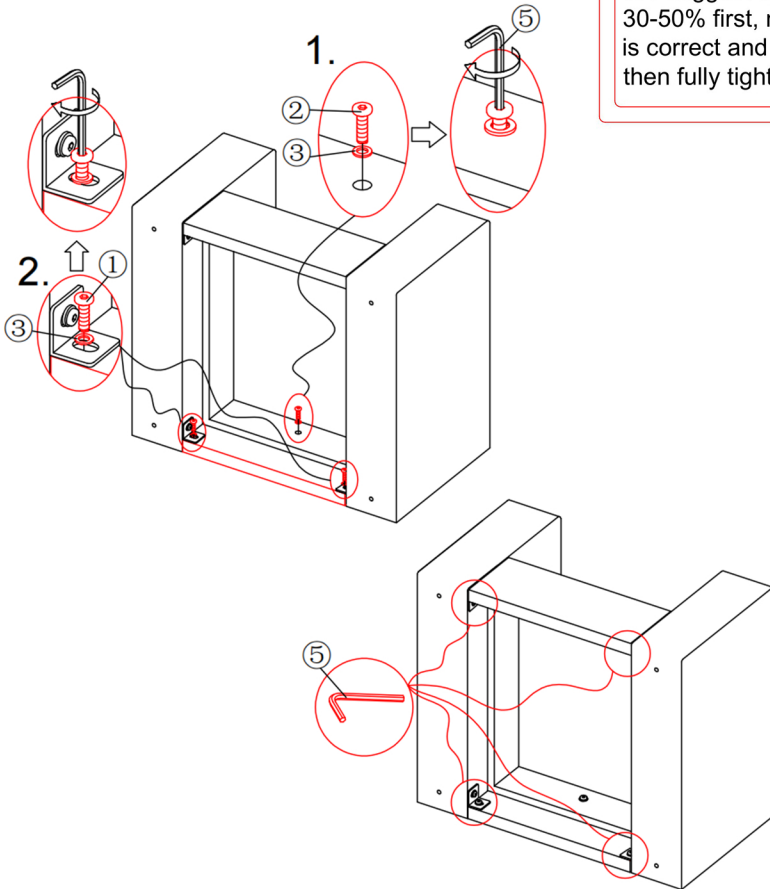

Notice:

We suggest tightening the bolts for 30-50% first, make sure the process is correct and bolt holes are aligned, then fully tightening them all.

step 7

First place one plastic washer (6) on each leg as shown, then twist them into each pre-drilled holes under the armrests.

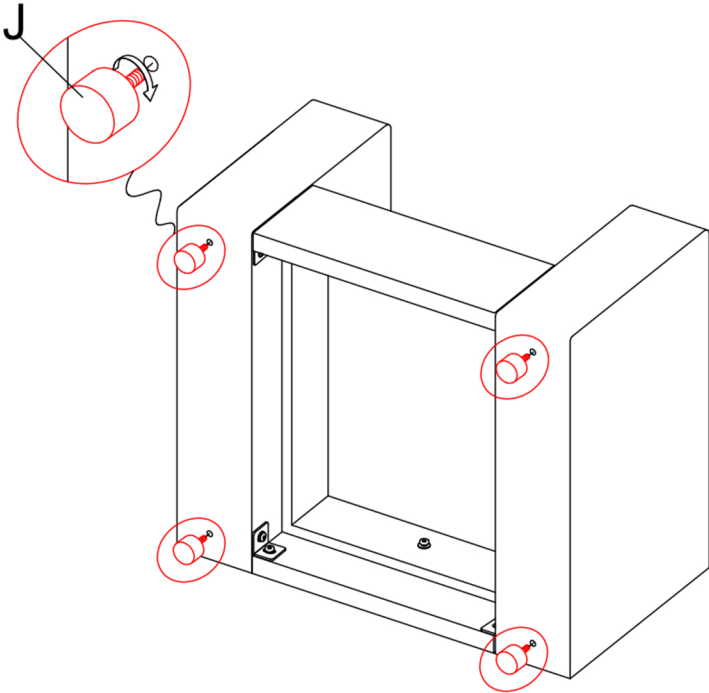
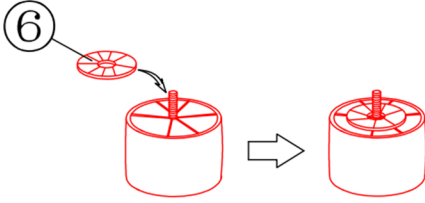

step 8

Align the connectors on the backrest frame (H) with the slots on the armrests as shown, make sure they are correctly aligned before pushing down.

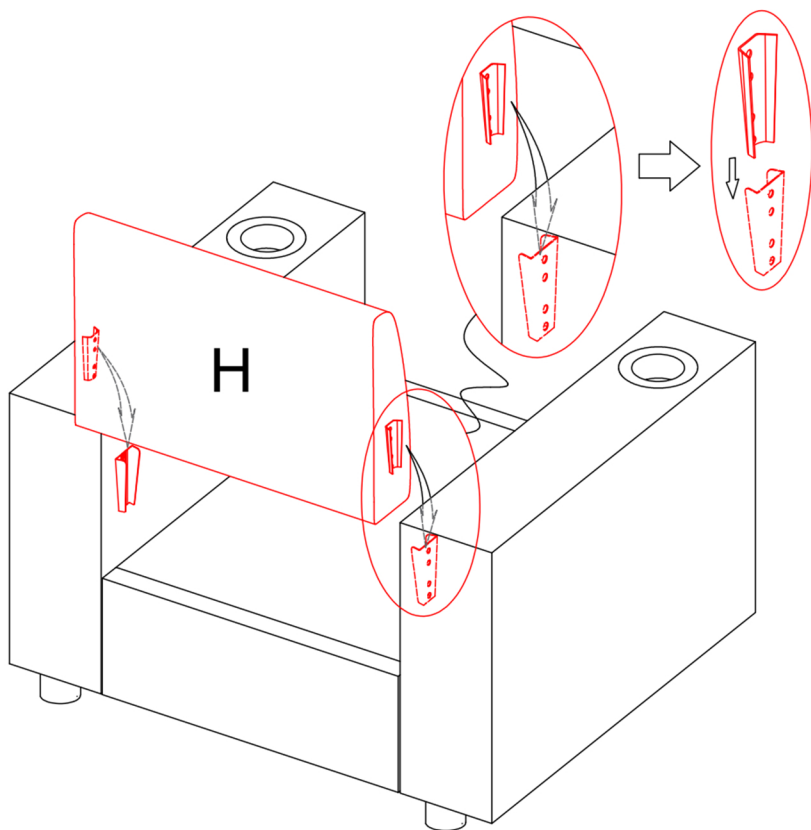

step 9

Tear off the Velcro stripe covers on both backrest frame and the seat frame as shown.

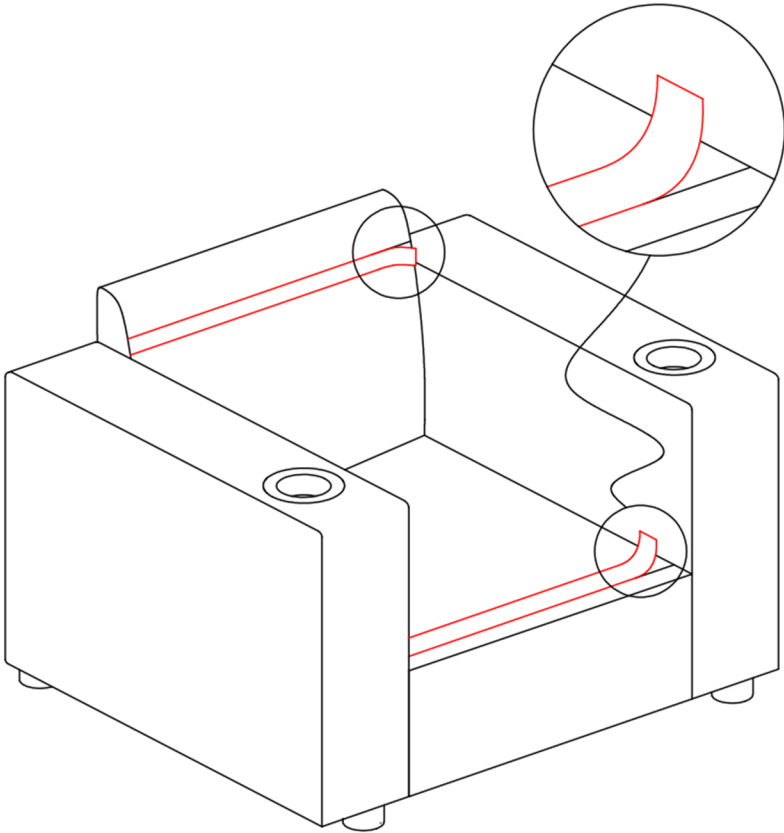

step 10

Place the seat cushion (A) onto the seat frame as shown.

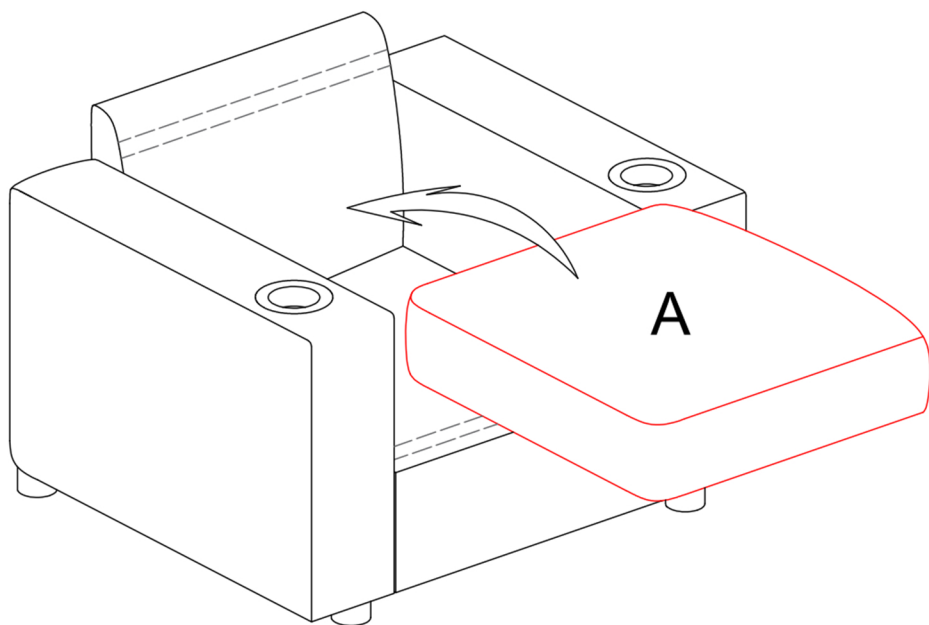

step 11

Place the back cushion (B) on the backrest frame as shown.

