

# Instruction Manual

## Manual

Name: LED FAN LIGHT  
Model: LEC017R  
Size: φ500\*H200mm  
Input voltage : 100-240V/50~60hz  
Power: 32W 3000K-6500K

## Packing List



X1

Lamp Body



X6

Fan Blades



X1

Remote Control

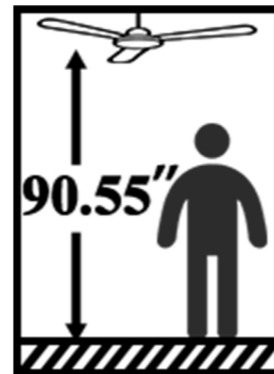

## Installation

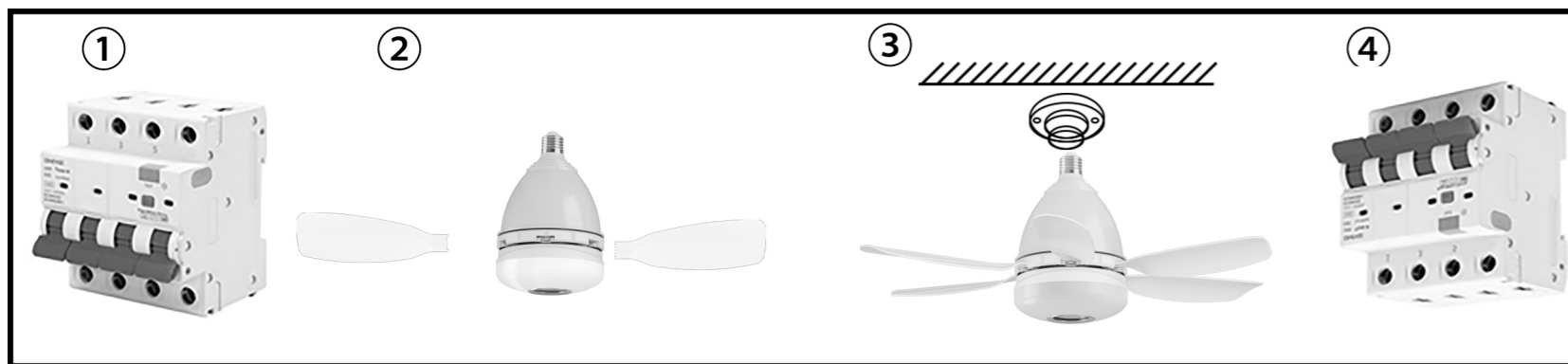

## Matters needing attention

- Step 1: Be sure to cut off the power before installation.
- Step 2: Assemble the S fan blades as shown in the figure
- Step 3: Install the entire lamp onto the socket.
- Step 4: After installation is complete, turn on the power and you can use the fan light through the remote control.
- Step 5: Turn on your phone's Bluetooth for pairing, and you can control the speakers through your phone and remote control.

## Installation precautions



Please pay attention to safe installation during suspension use and follow best practices during installation.  
When installing the fan blade model, attention should be paid to the installation height of the lighting fixtures and maintain a certain safe distance from people.  
When hanging and installing, be careful not to have obstacles around.

## Matters needing attention

1. Please do not put fingers or other things into the working fan blades
2. For daily cleaning, you can use a damp cloth to wipe the surface without using corrosive chemicals.
3. The fan blades can also be disassembled directly, convenient for cleaning and storage.
4. In case of any accident, disconnect the power first, then ask an electrician to check and fix it.
5. The remote control requires AAA \* 2 batteries, please bring your own

## Remote Control

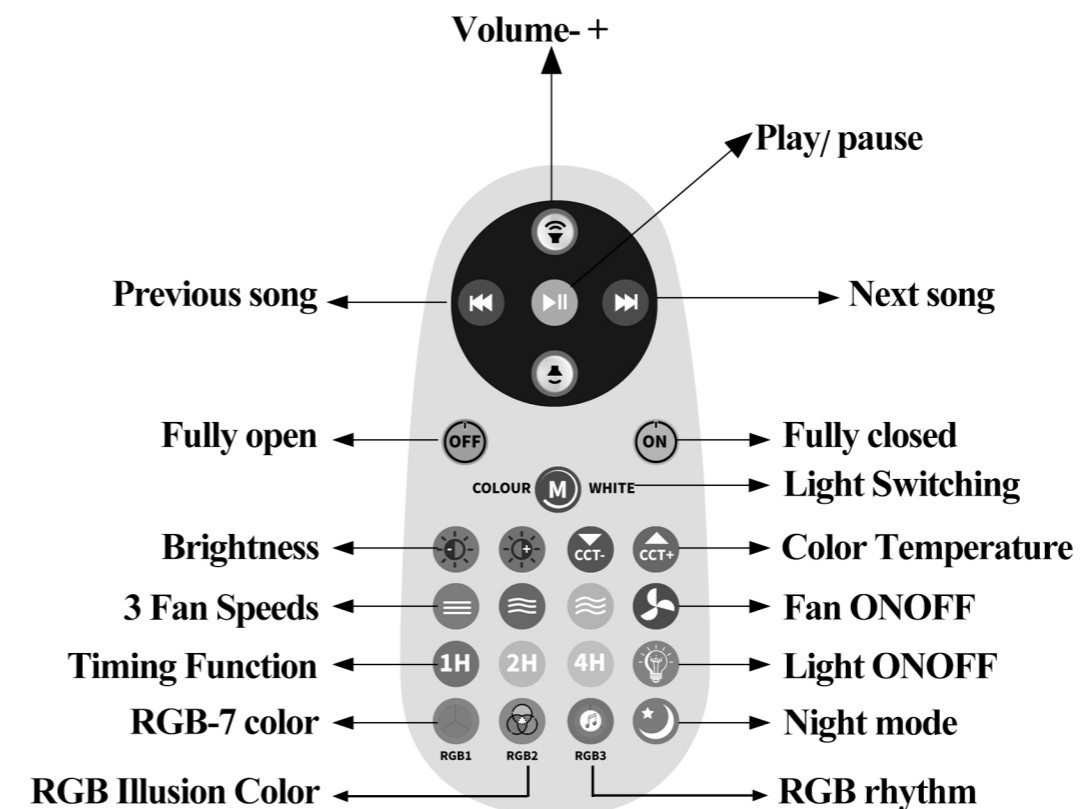

This device complies with part 15 of the FCC Rules. Operation is subject to the following two conditions: (1) This device may not cause harmful interference, and (2) this device must accept any interference received, including interference that may cause undesired operation