

Installation instructions

Pantry and Workboard Faucets

23195A1C
unit:inch (mm)

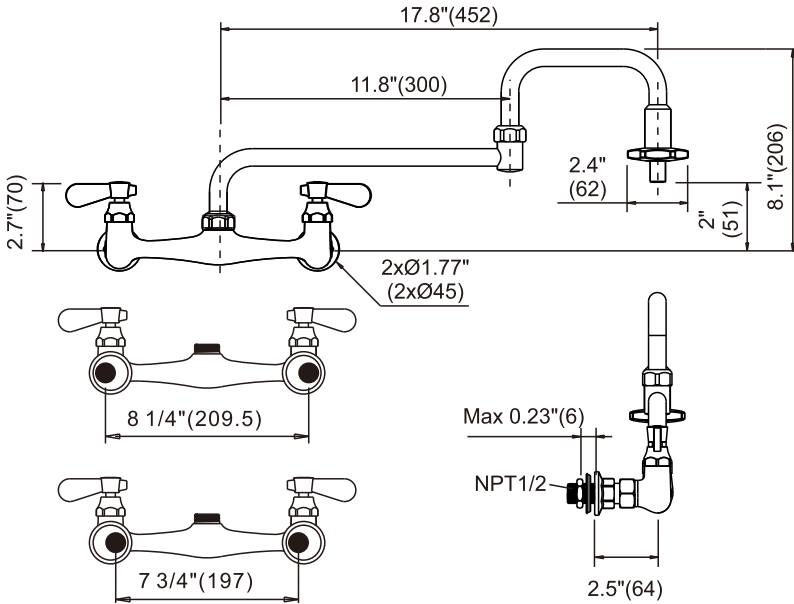

Attach supply lines (not included).

8 inches adjustable center hole distance,

Deck-mount faucet using a pair of G1/2" female inlets with 2" flanges.

those inlets can adjust from 7 3/4" (197mm) to 8 1/4" (209.5),

allowing you to fit them directly onto your facility's water lines with ease.

With 1.8 gpm are compliant with California water efficiency regulations,
Complies with California Proposition 65 and with the Federal Safe Drinking Water Act.

1.8GPM WATER
FOLW REGULATOR
(O-ring facing downwards)

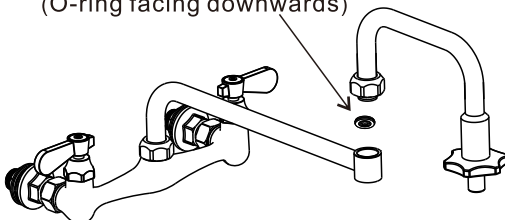

Water Use Information: 1.8 gpm
6.8L/min,
You can choose to replace the current limiting device and O-ring facing downwards.

In areas with extremely low water pressure causing the faucet water flow to be unsatisfactory, Remove the water flow regulator.

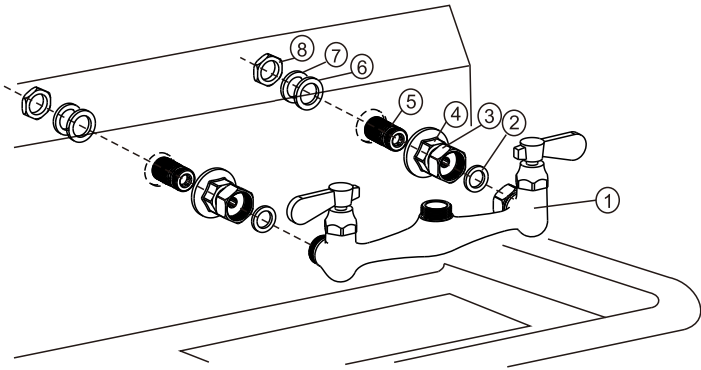
1

1. Connect the two flanges (3) into the two inlets (5) . Screw them tightly.

2. Connect the body (1) to the flanges (3), do remember the gaskets (2) inside.

The two flanges (3) are adjustable inlets.

Unscrew the hexagon nut (4) on the flange (3) , rotate the flange(3) to the right the distance and screw the hexagon thread back tightly.

You can adjust the distance from 7 3/4"to8 1/4".

3. Turn out the hexagon (6) with the washer(6) and the metal plate(7),

Use the hexagon nut to lock the faucet and sink.

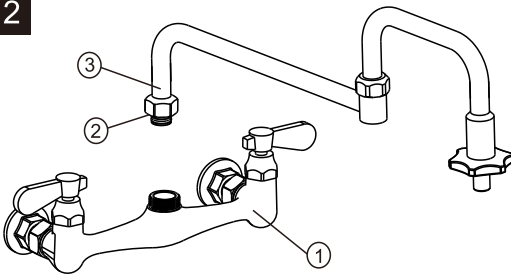
2

Put the swing nozzle (3) into the body (1), screw the nut (2).

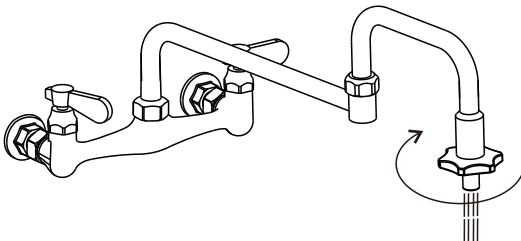
3

Notice:

Simple on/off control by rotating handle .
Shut off both handle cartridges when not in use or left unattended. Improper use or inadequate drainage below faucet may cause water damage.

FLUSH SYSTEM/CHECK FOR LEAKS.
Turn on hot and cold water supplies and flush water lines for one minute.
Check all connections at arrows for leaks.
Retighten if necessary, but do not overtighten.