

ASSEMBLY INSTRUCTION

Thank you for purchasing the quality product. Be sure to check all packing material carefully for small parts which may have come loose inside the carton during shipment. Separate, identify and count all parts and metal hardware. Compare with all parts list to be sure all parts are present. If any part(s) are missing or damaged, please contact your local furniture dealer. For efficient and speedy service, please indicate the model number and code letter of part(s) needed.

*****Do not fully tighten screws until fully assembled*****

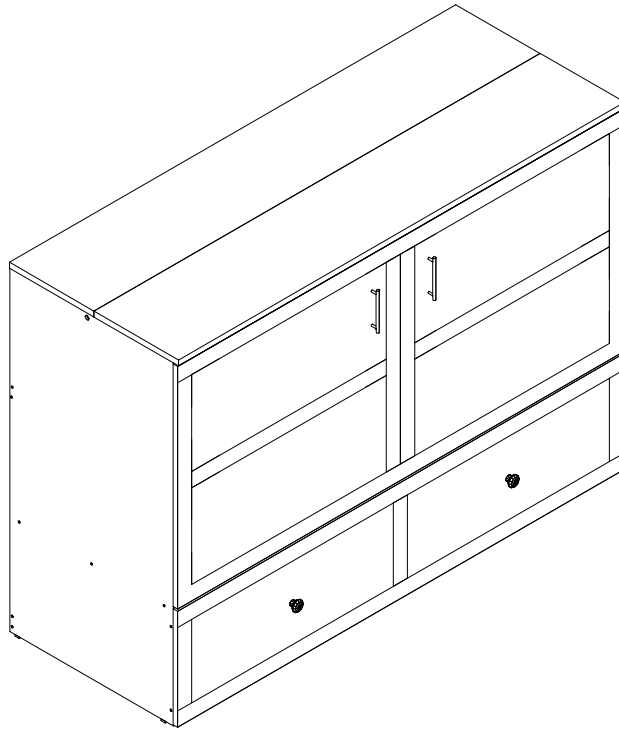

General Assembly Guidelines

- I. Ensure that all parts and hardware are available before beginning assembly.
- II. Follow each step carefully to ensure the proper assembly of this product.
- III. The three main types of hardware used to assemble this product are: wood dowels, screws and bolts.
- IV. A Phillips head screwdriver is required for the assembly of this product.

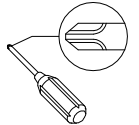

V. Cam bolt and Cam lock Assembly instruction.

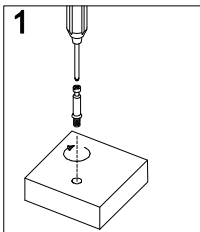

**Cam bolt
vertical installation**

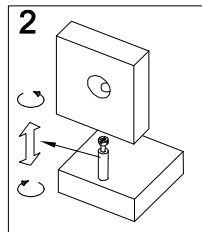

**Cam bolt is
adjustable**

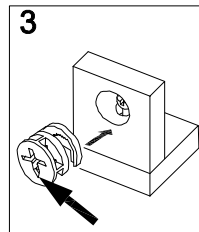

**Cam lock
the arrow is towards
the Cam bolt**

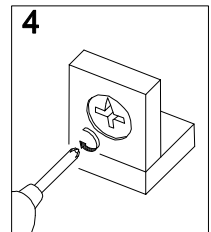

**Ensure locking
the Cam bolt**

VI. Power tools should not be used to assemble this product.

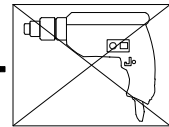

VII. Two people are recommended for ease in the assembly of this product.

VIII. Do not step on.

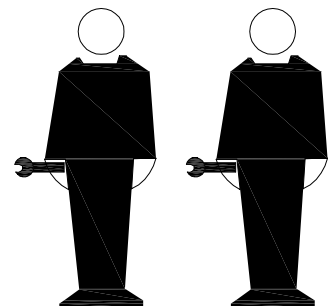

Part List

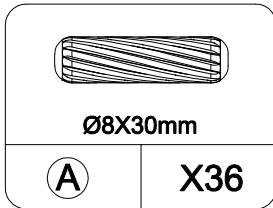

WOOD DOWEL

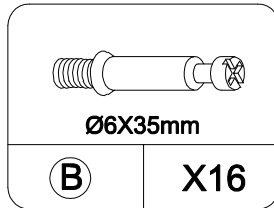

CAM BOLT

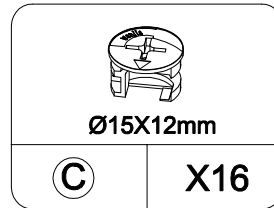

CAM LOCK

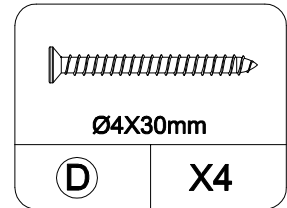

SCREW

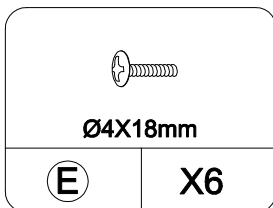

BOLT

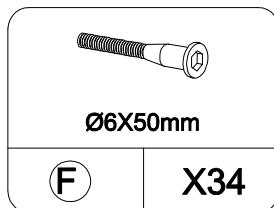

SCREW

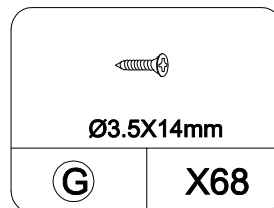

SCREW

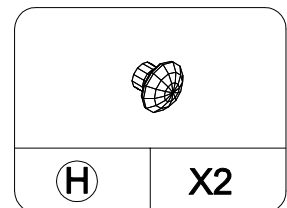

HANDLE

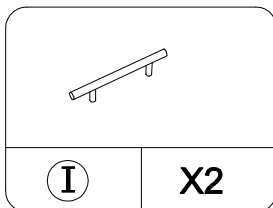

HANDLE

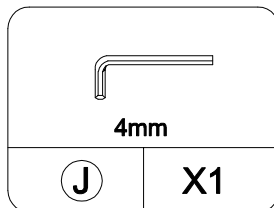

ALLEN KEY

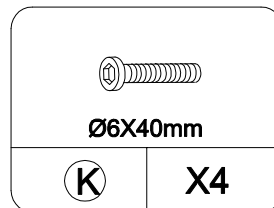

BOLT

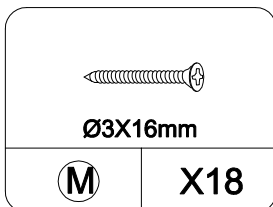
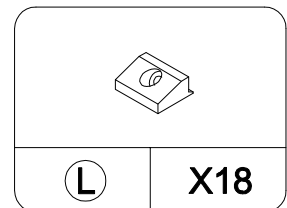

SCREW

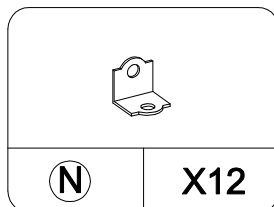

Hinge

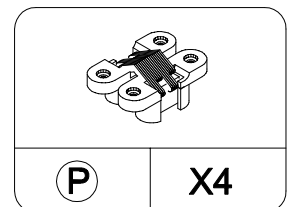
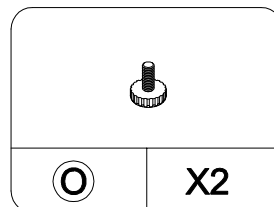

Hinge

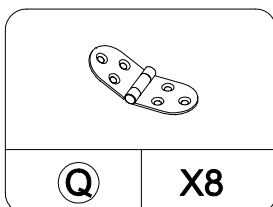

Hinge

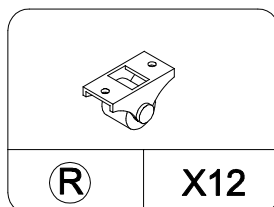

Wheel

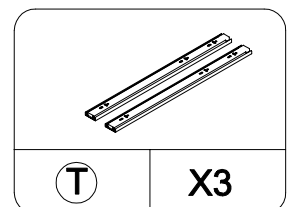
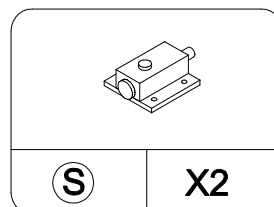

Track

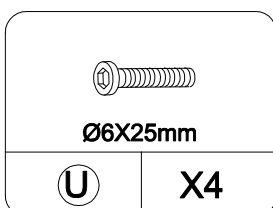

BOLT

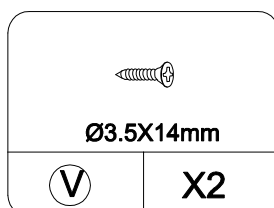

SCREW

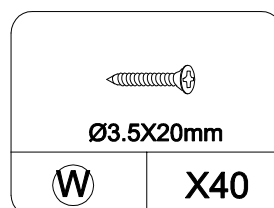

SCREW

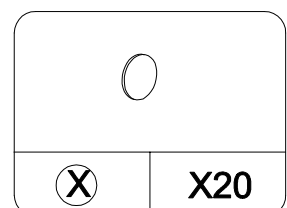

Sticker

Part List

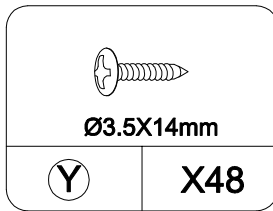

SCREW

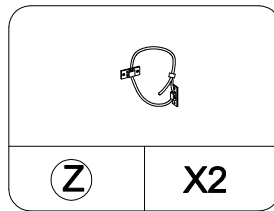

Anti Tipping hardware

Cam Lock Fastening System

Insert the cam bolt into the hole first, then insert the cam lock and lock it.

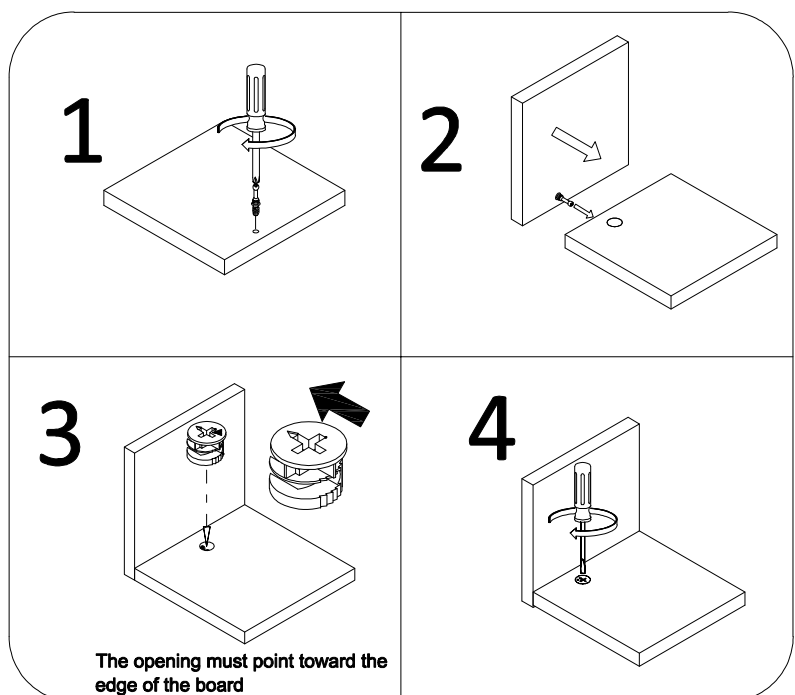

Board Identification

Not actual size

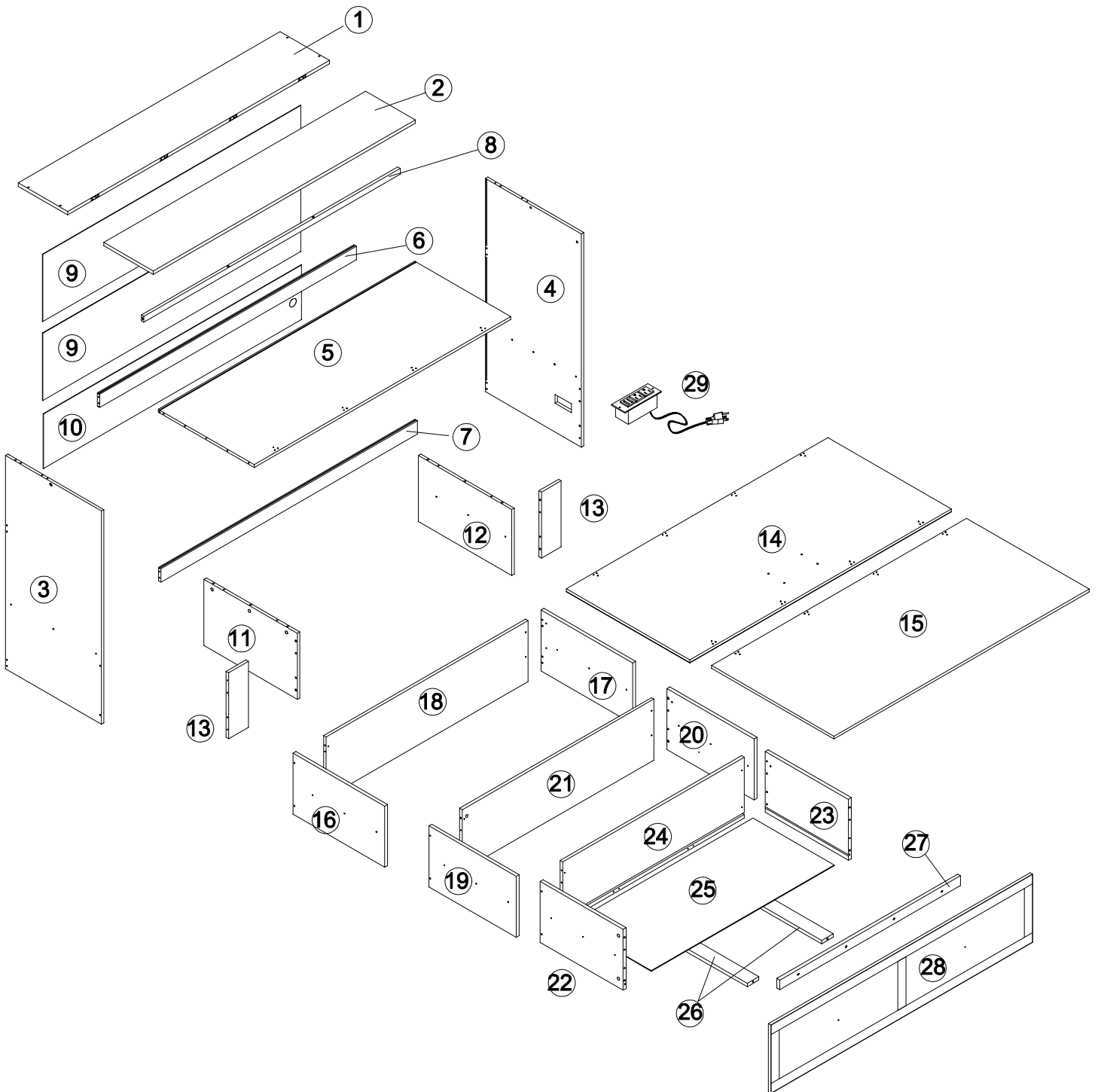

STEP 1

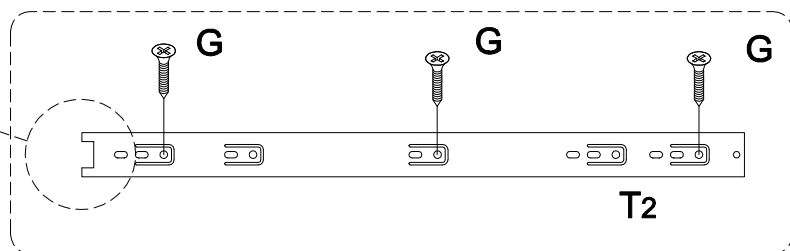
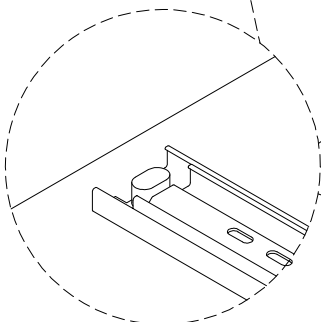
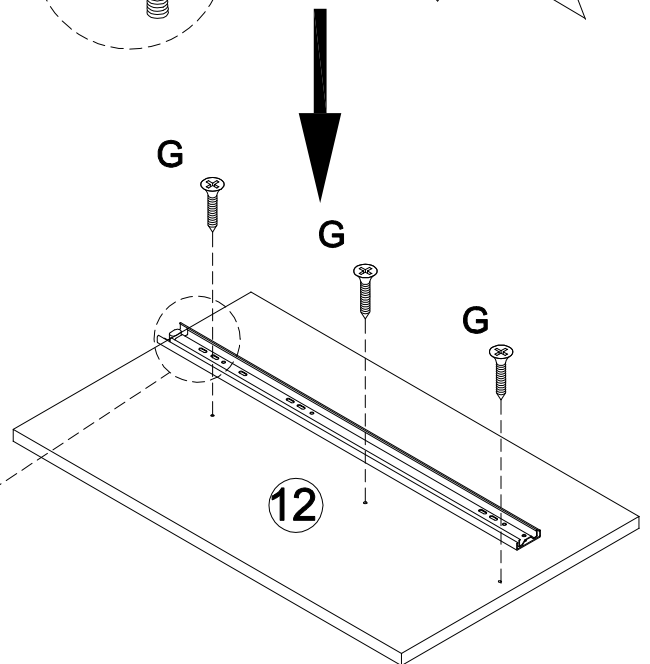
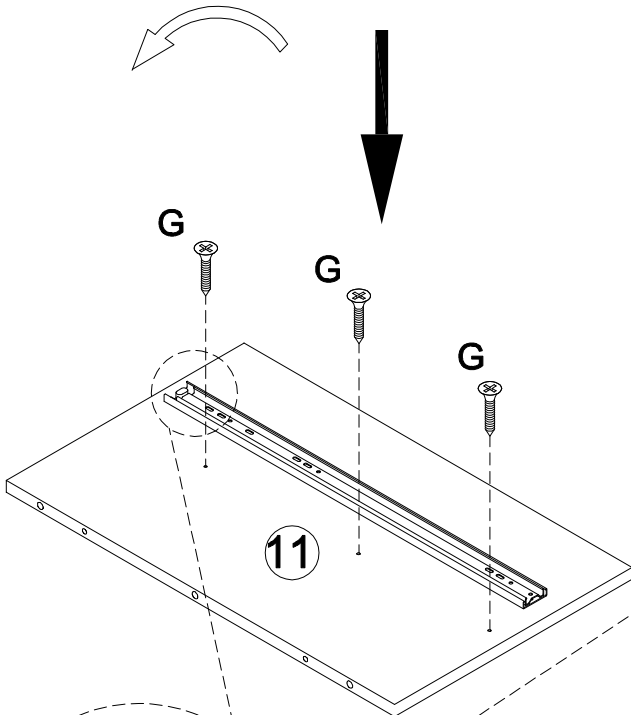
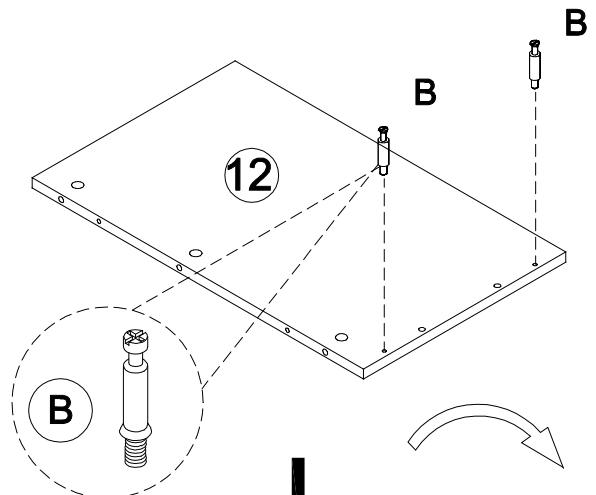
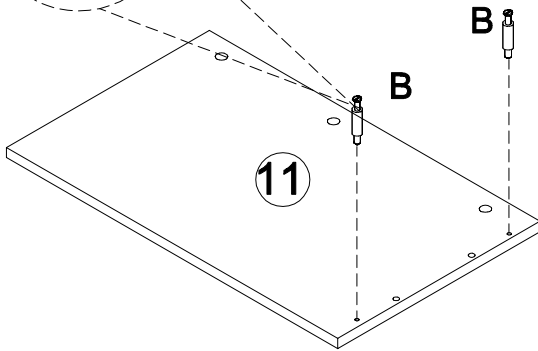
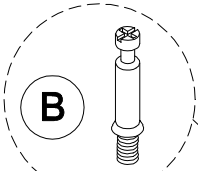
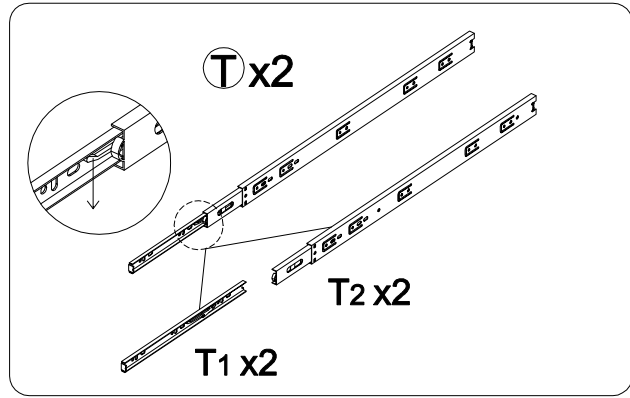
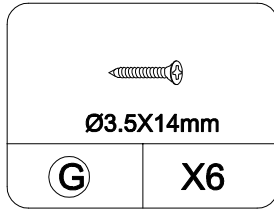
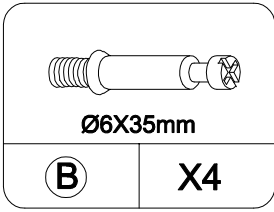

STEP2

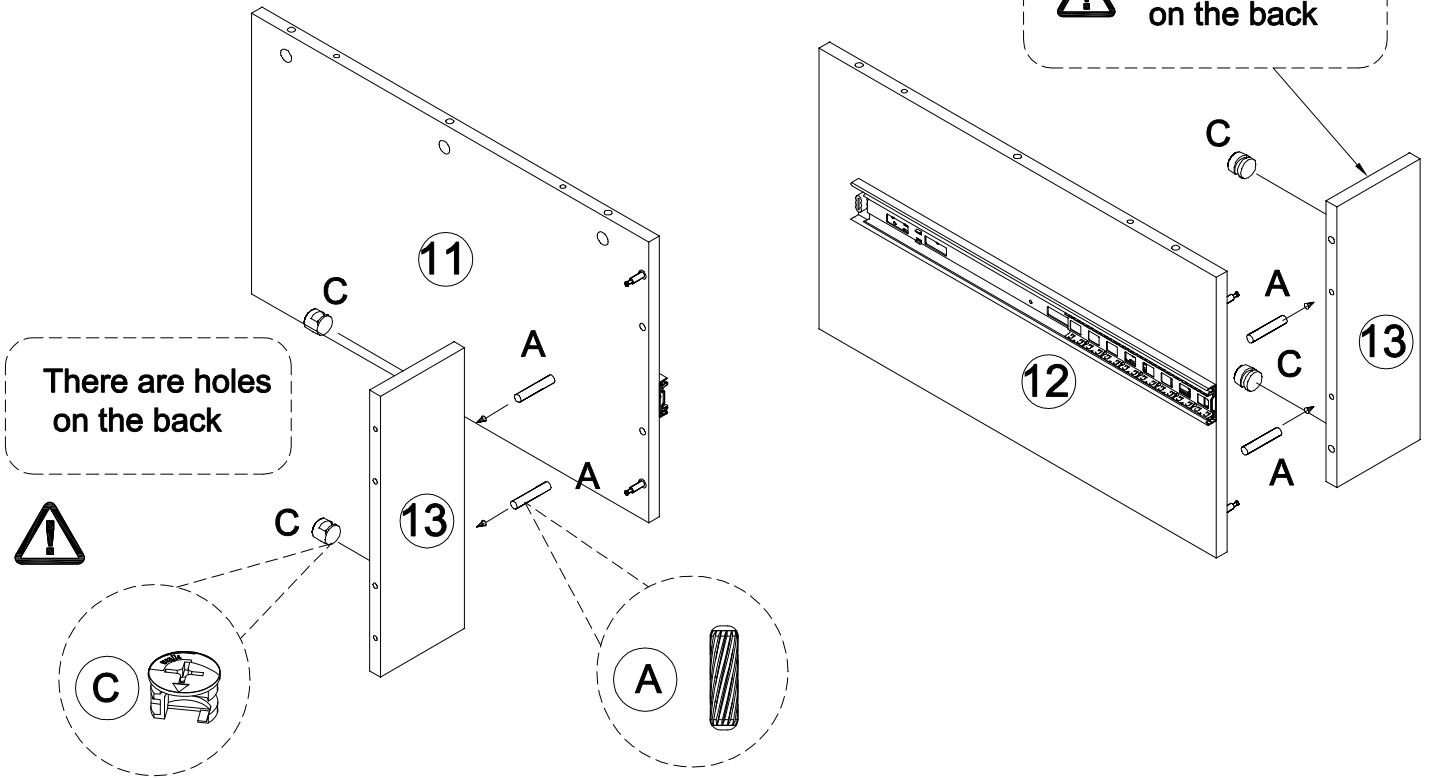
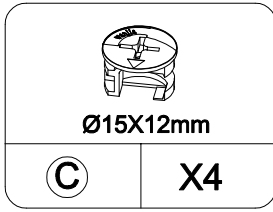
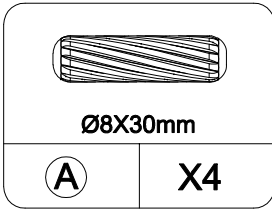

STEP3

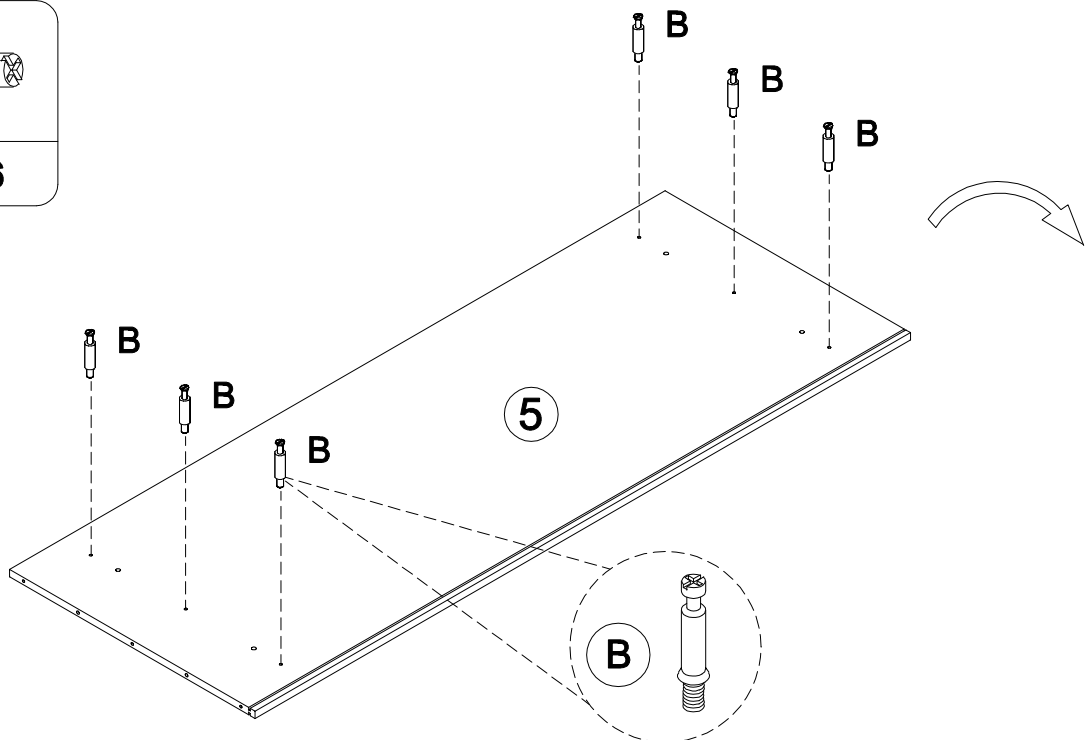
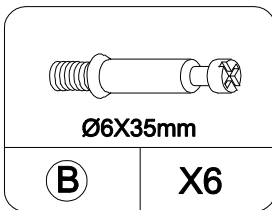

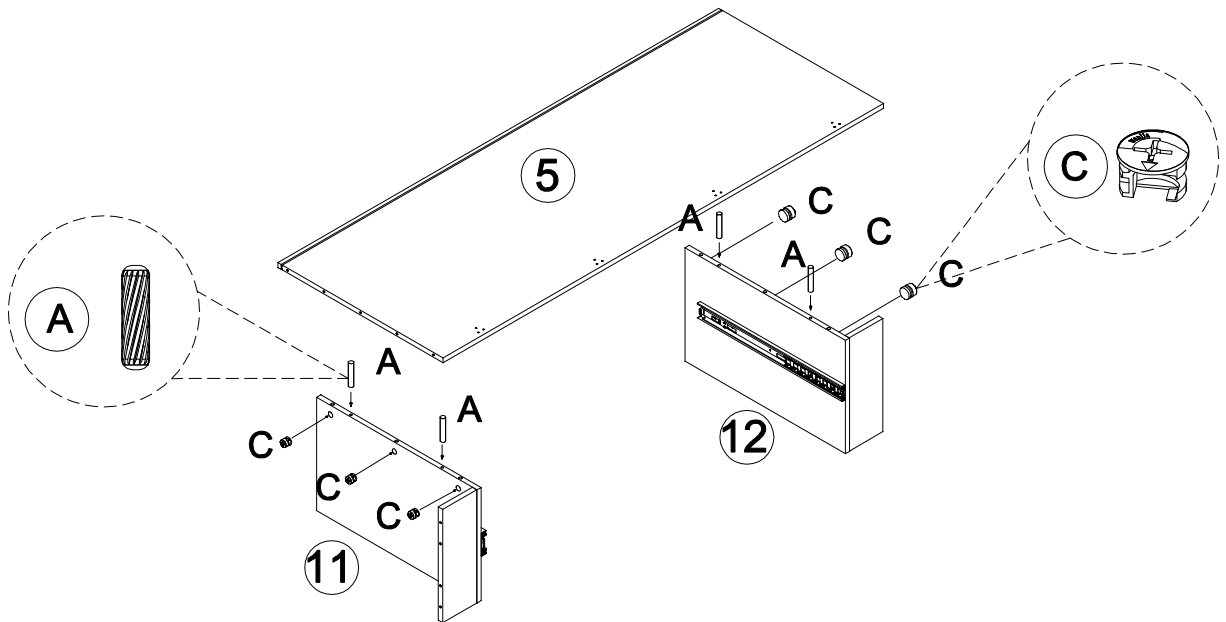
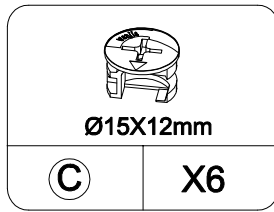
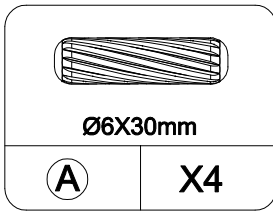

STEP4

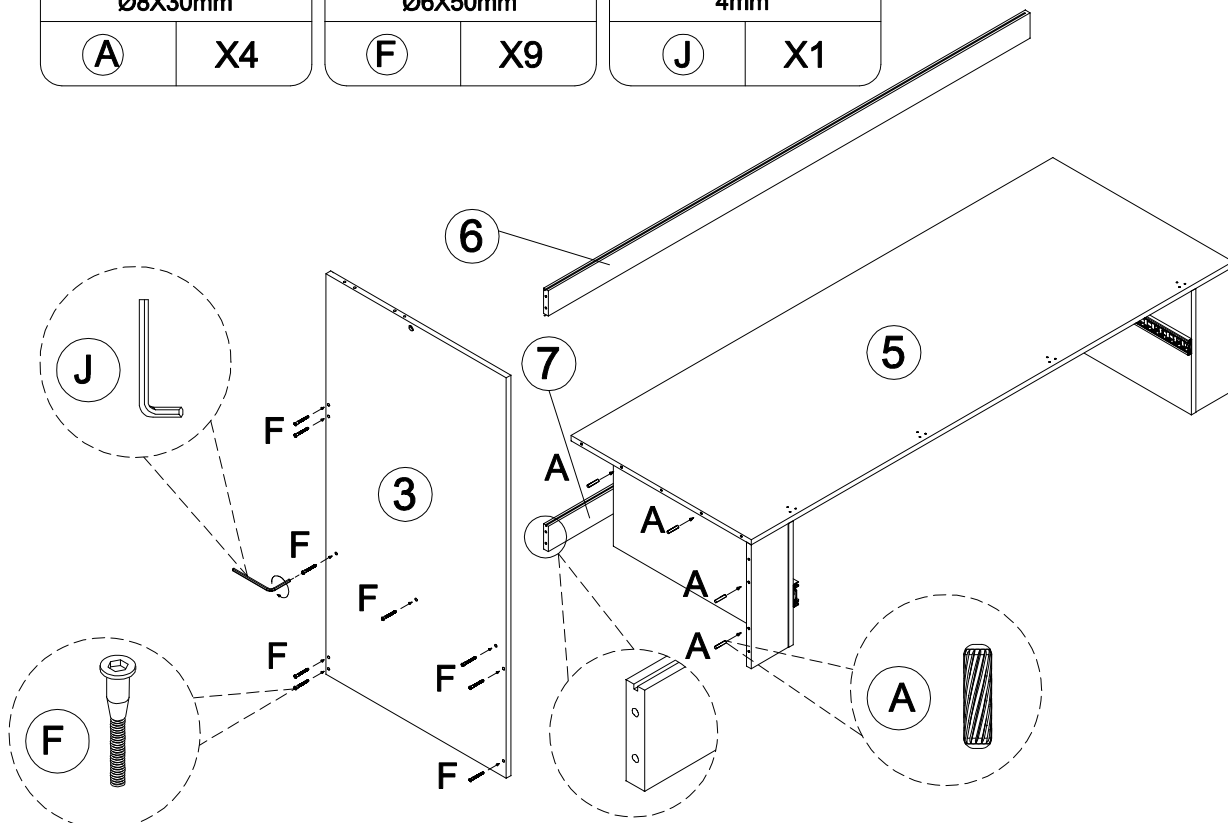
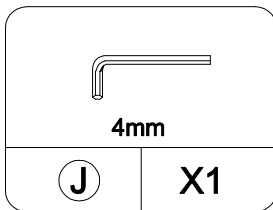
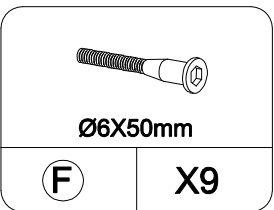
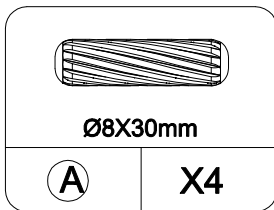

STEP5



STEP 6

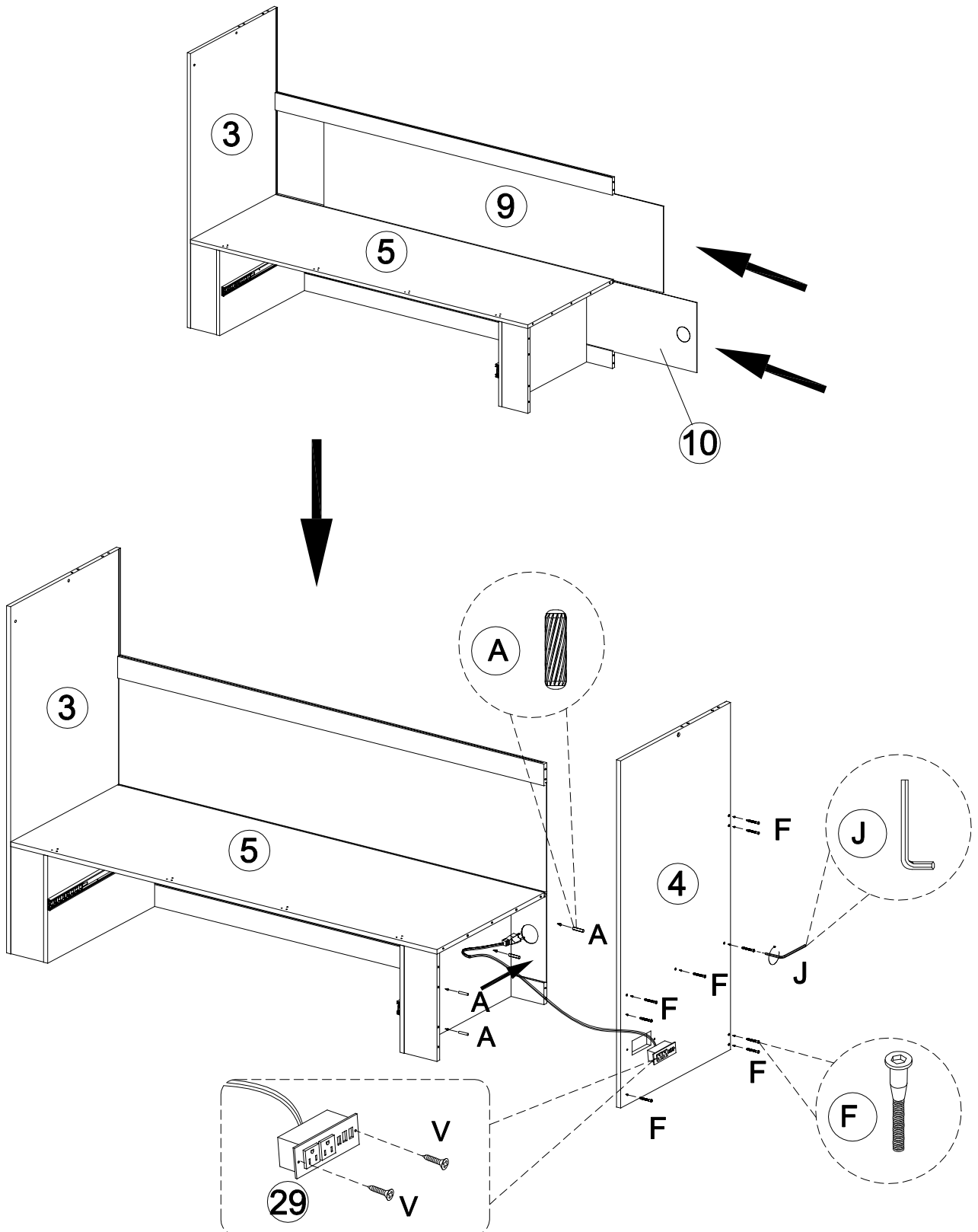

 Ø8X30mm	 Ø6X50mm	 Ø3.5X14mm
A X4	F X9	V X2

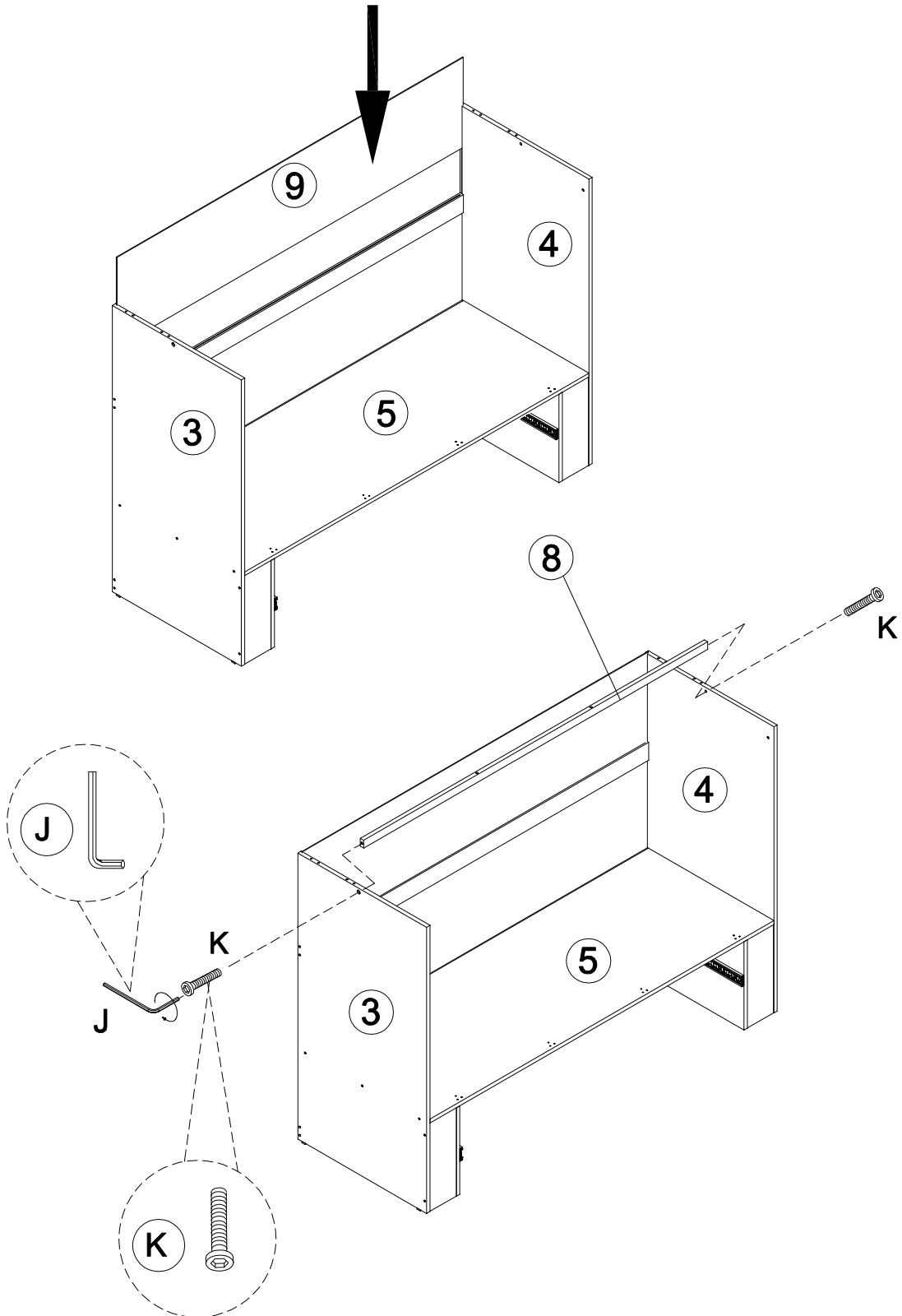
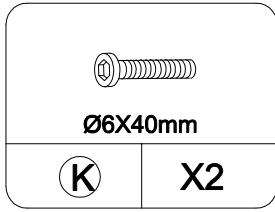
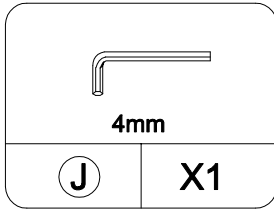

STEP 7



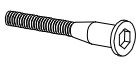

STEP 8

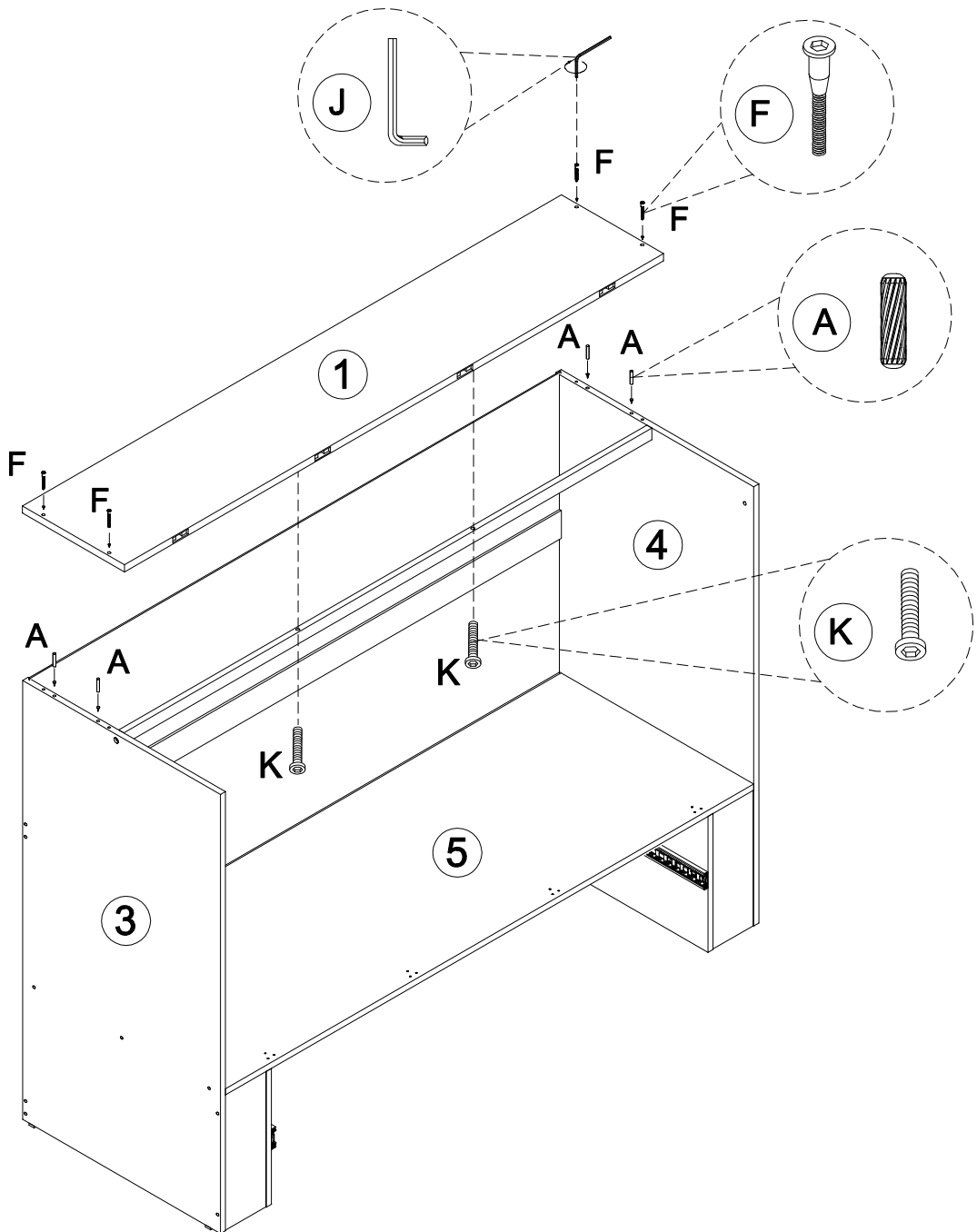
 Ø8X30mm	 Ø6X50mm	 4mm	 Ø6X40mm
(A) X4	(F) X4	(J) X1	(K) X2

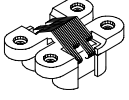

STEP 9

		 Ø3.5X20mm			
P	X4	W	X16	O	X2

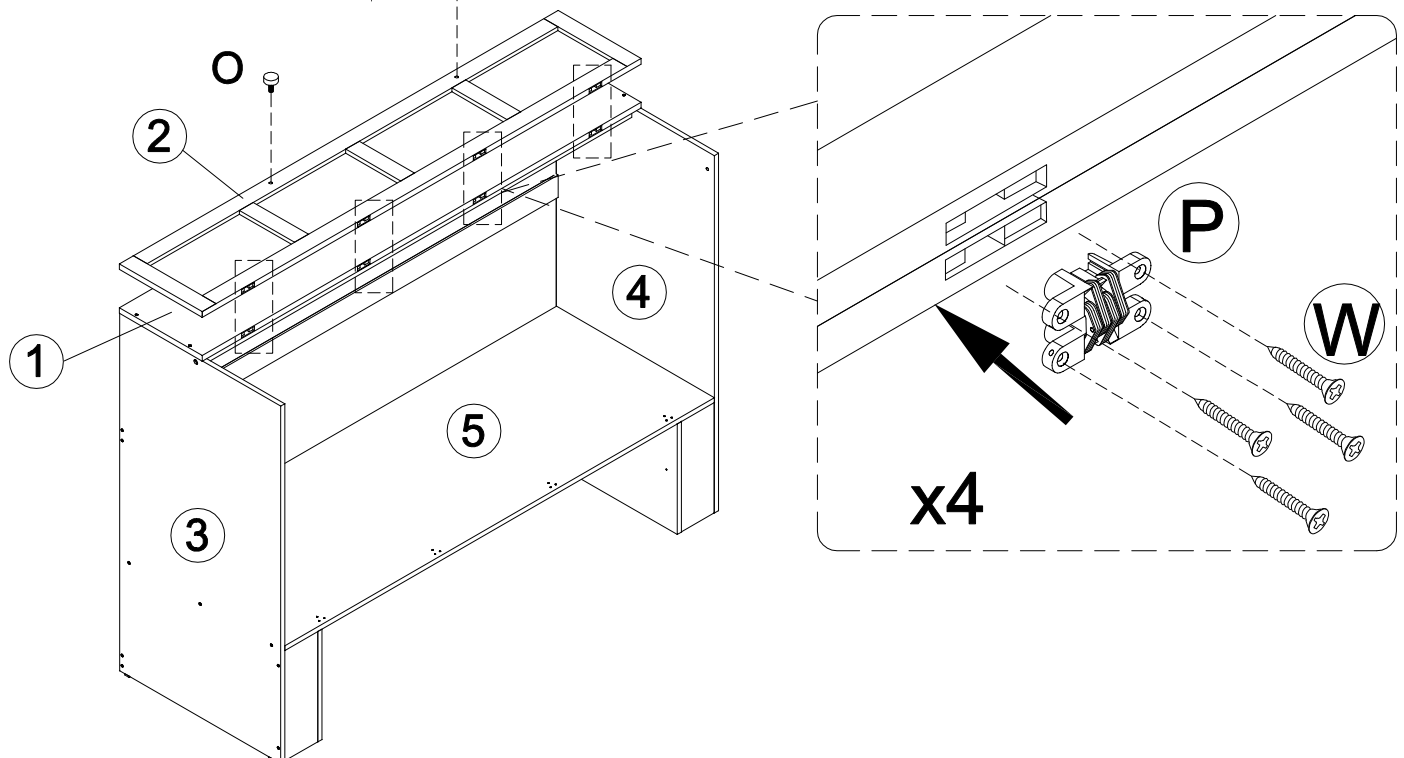
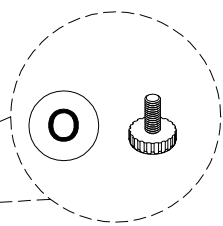
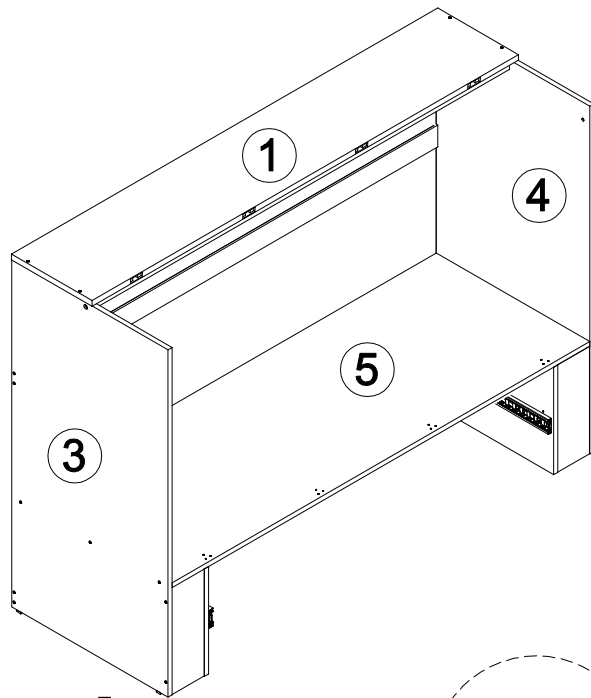

STEP 10

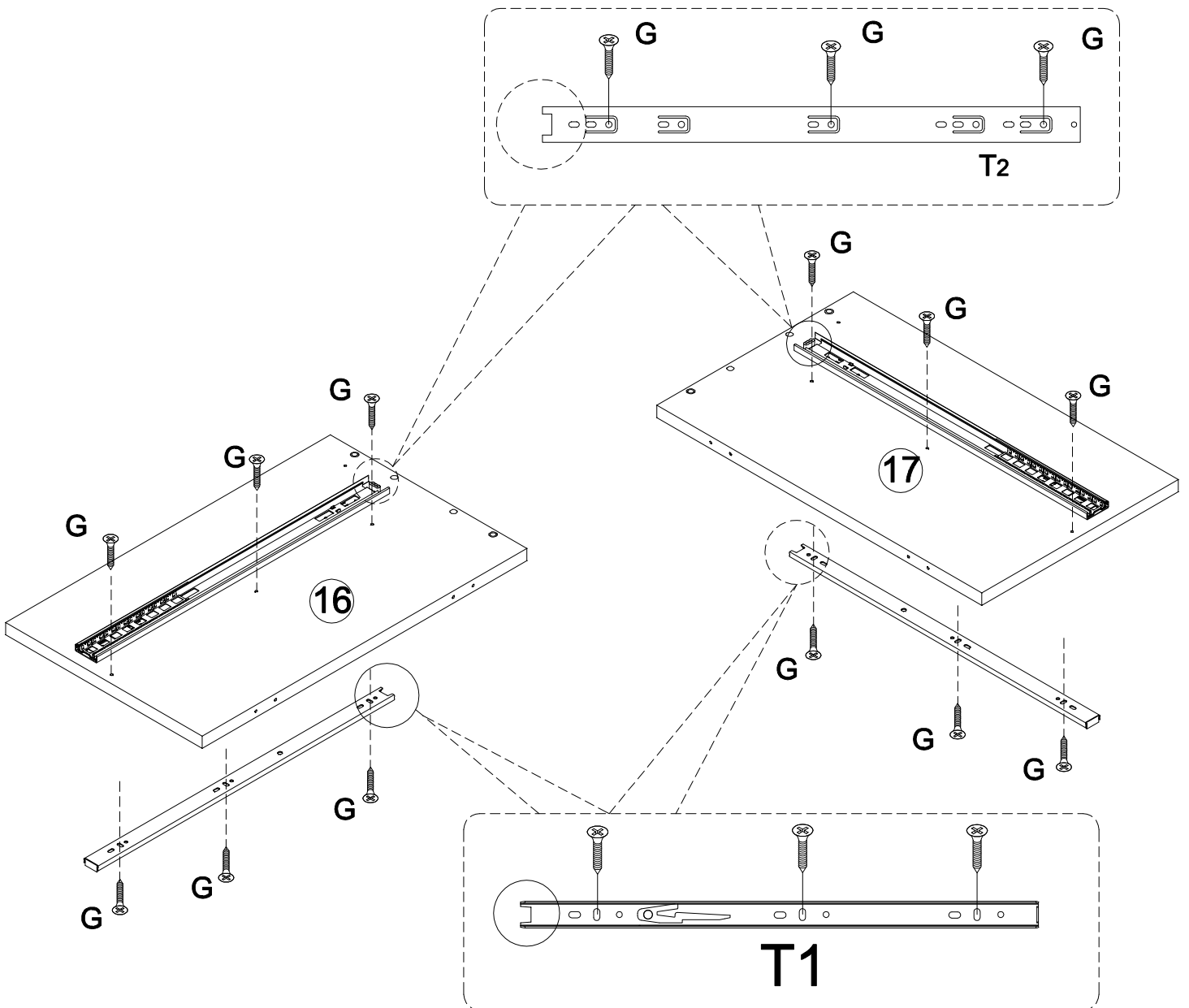
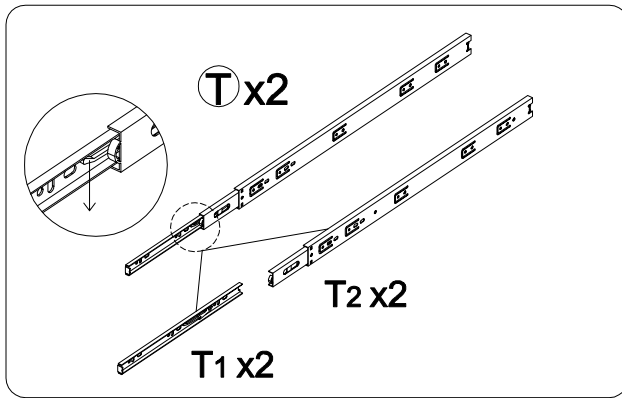
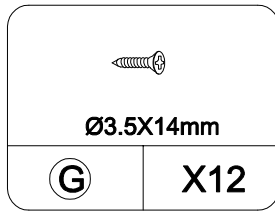

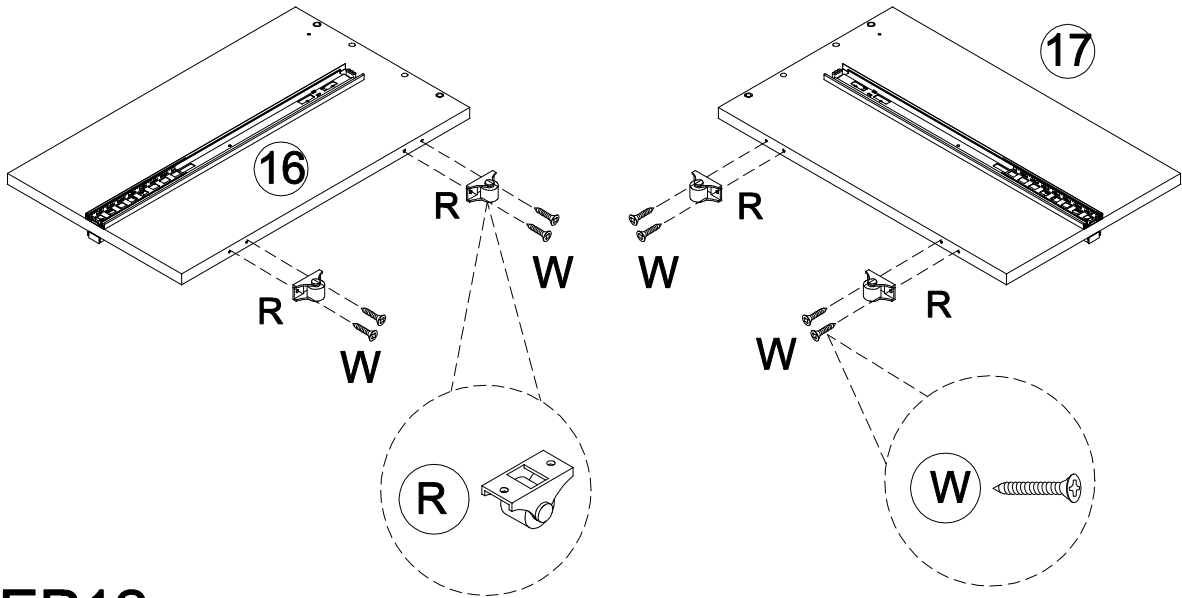
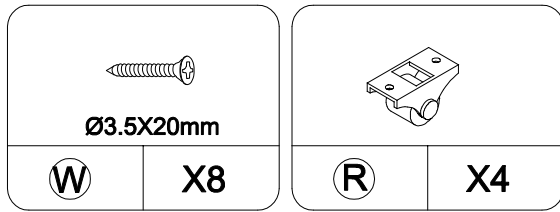

STEP 11

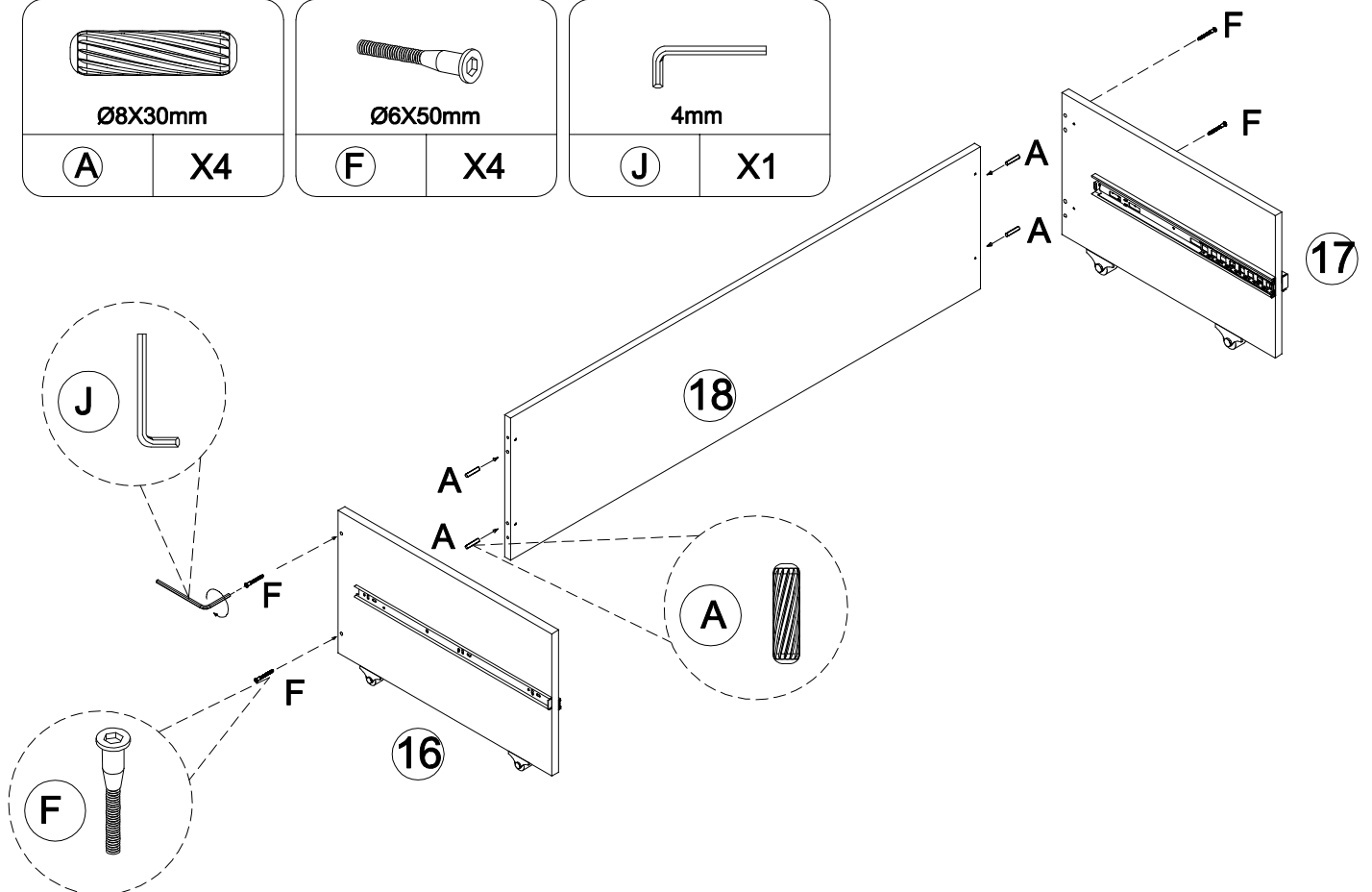
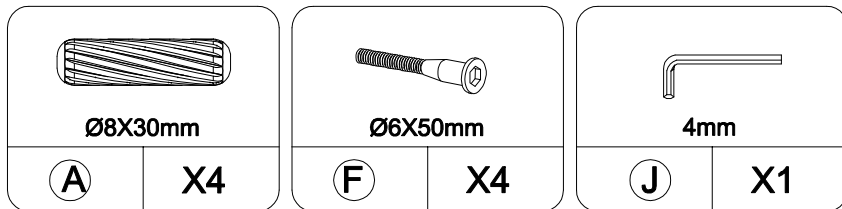

STEP 12

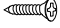

STEP 13

 Ø3.5X14mm			
G	X8	N	X4

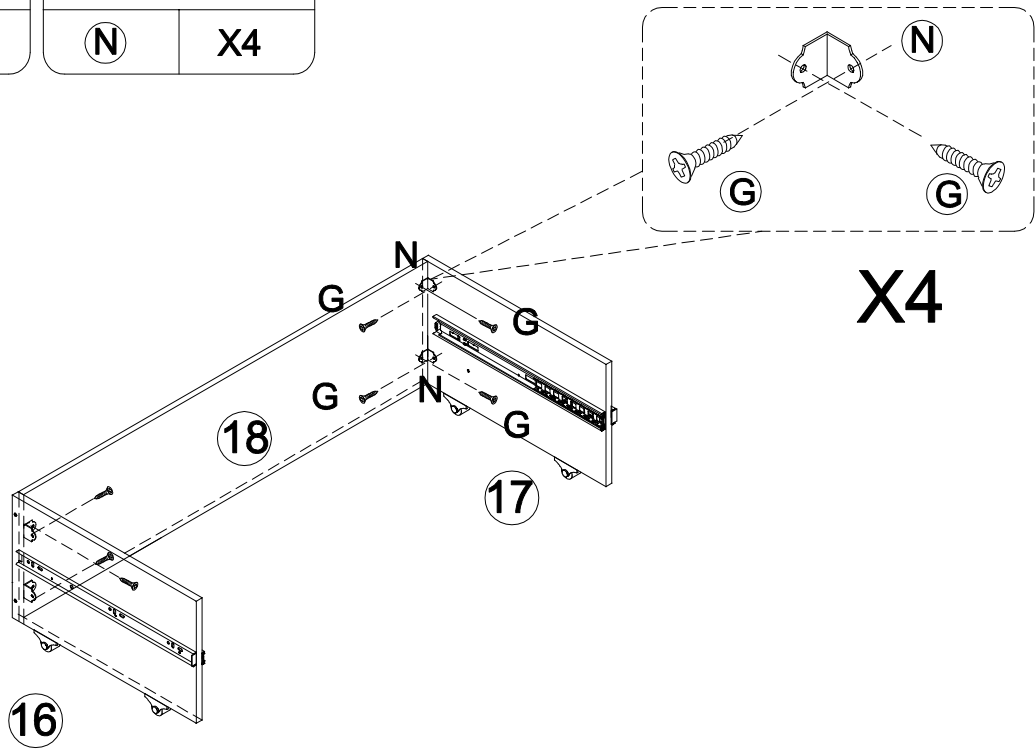

Move the ball slide to the outermost position

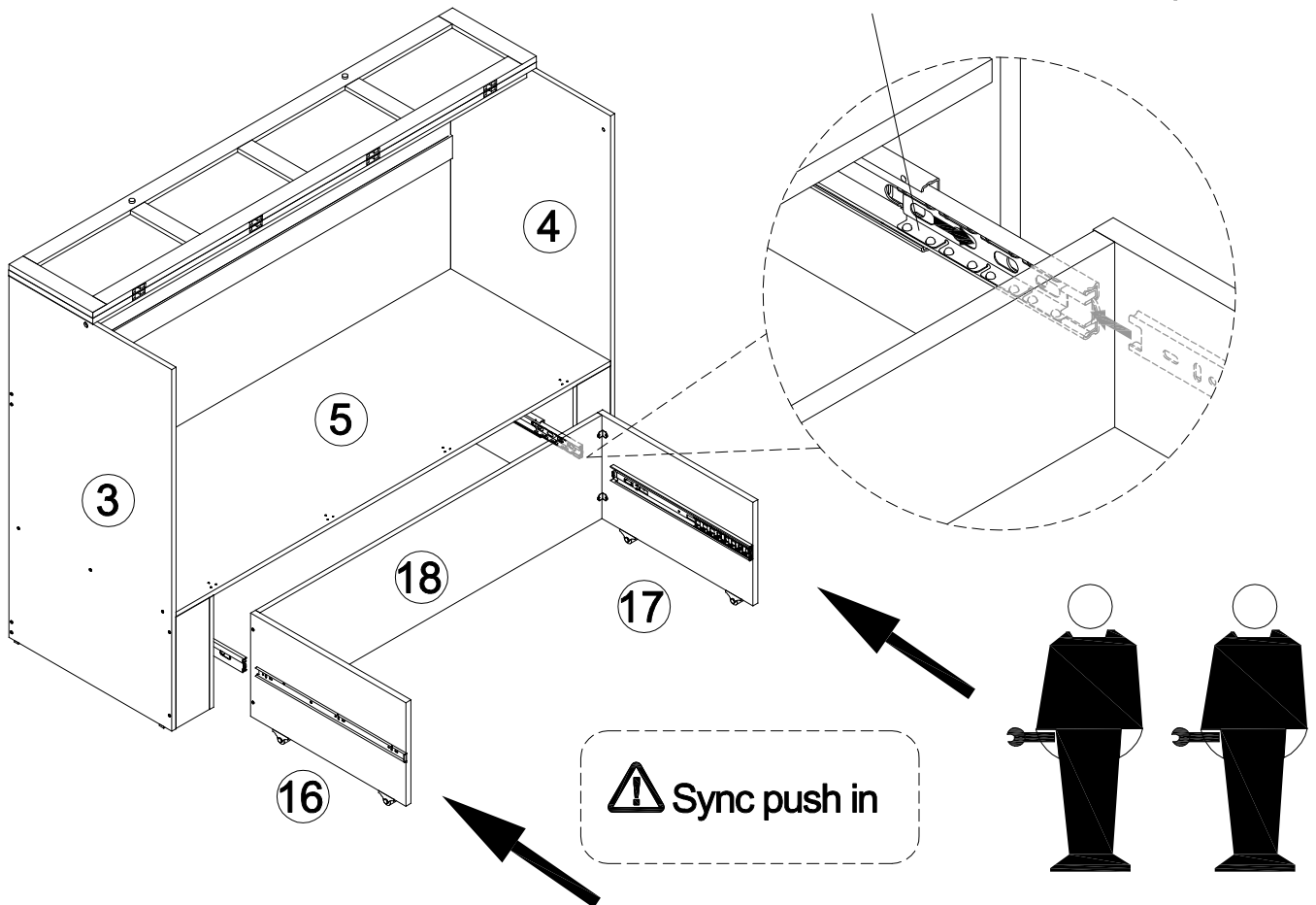

STEP 14

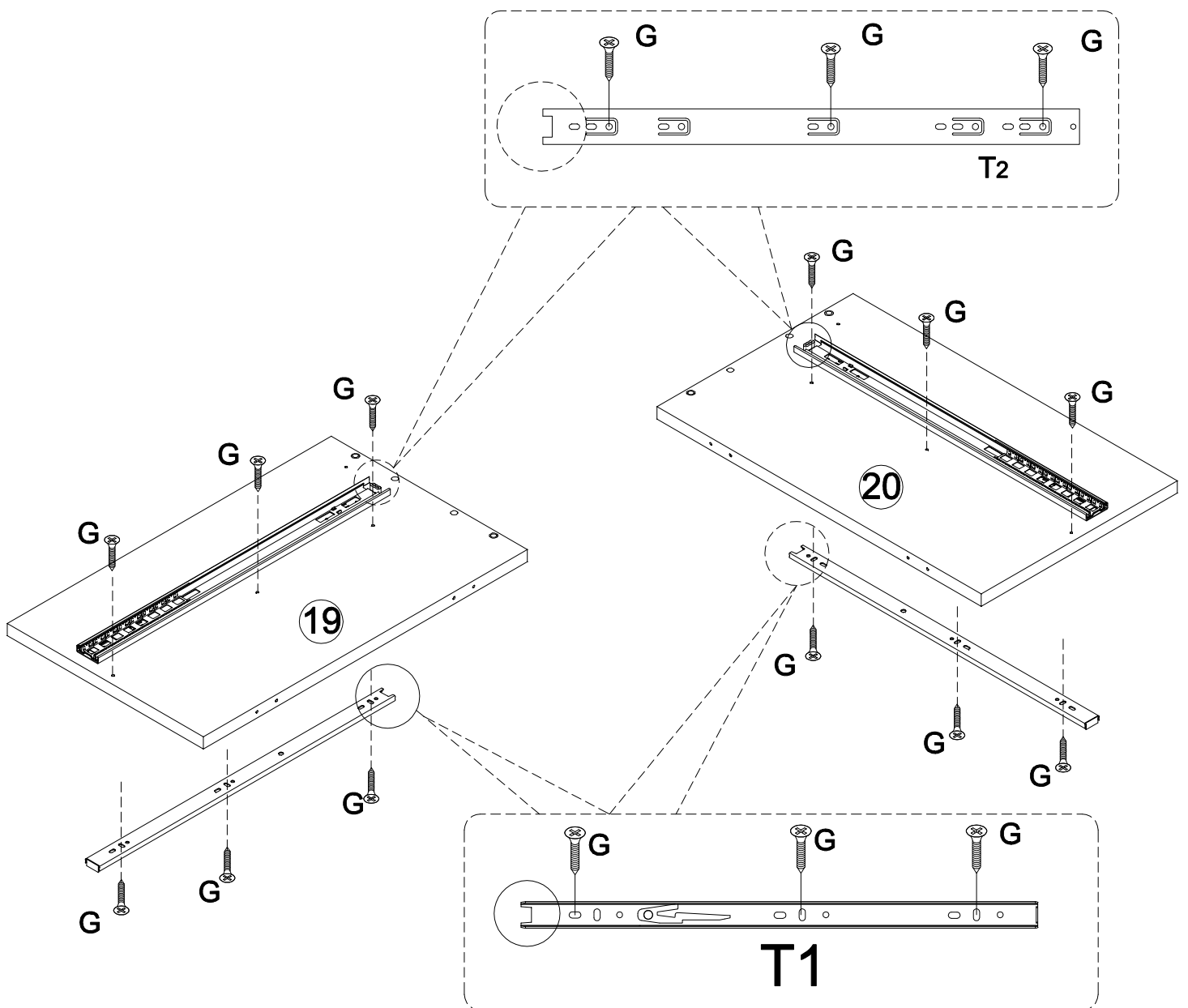
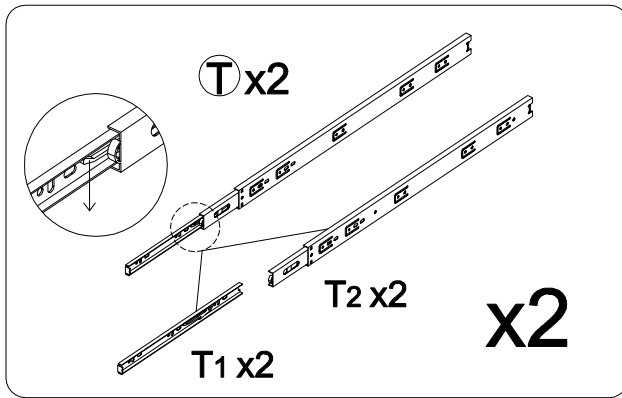
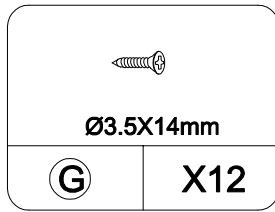

STEP 15

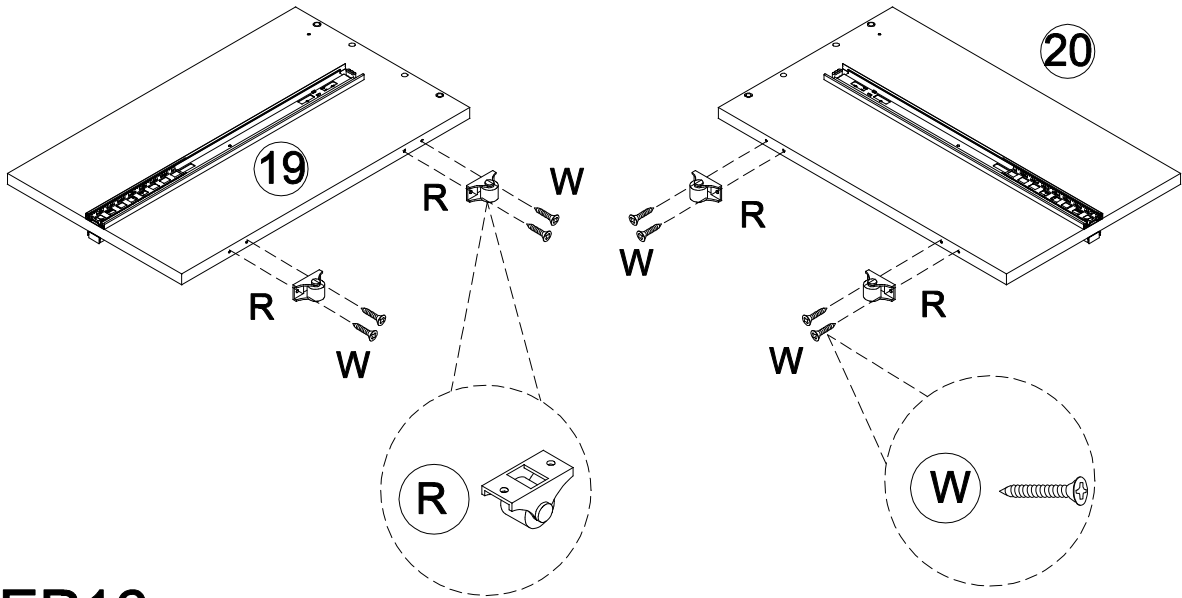
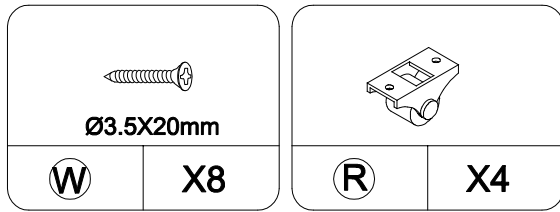

STEP 16

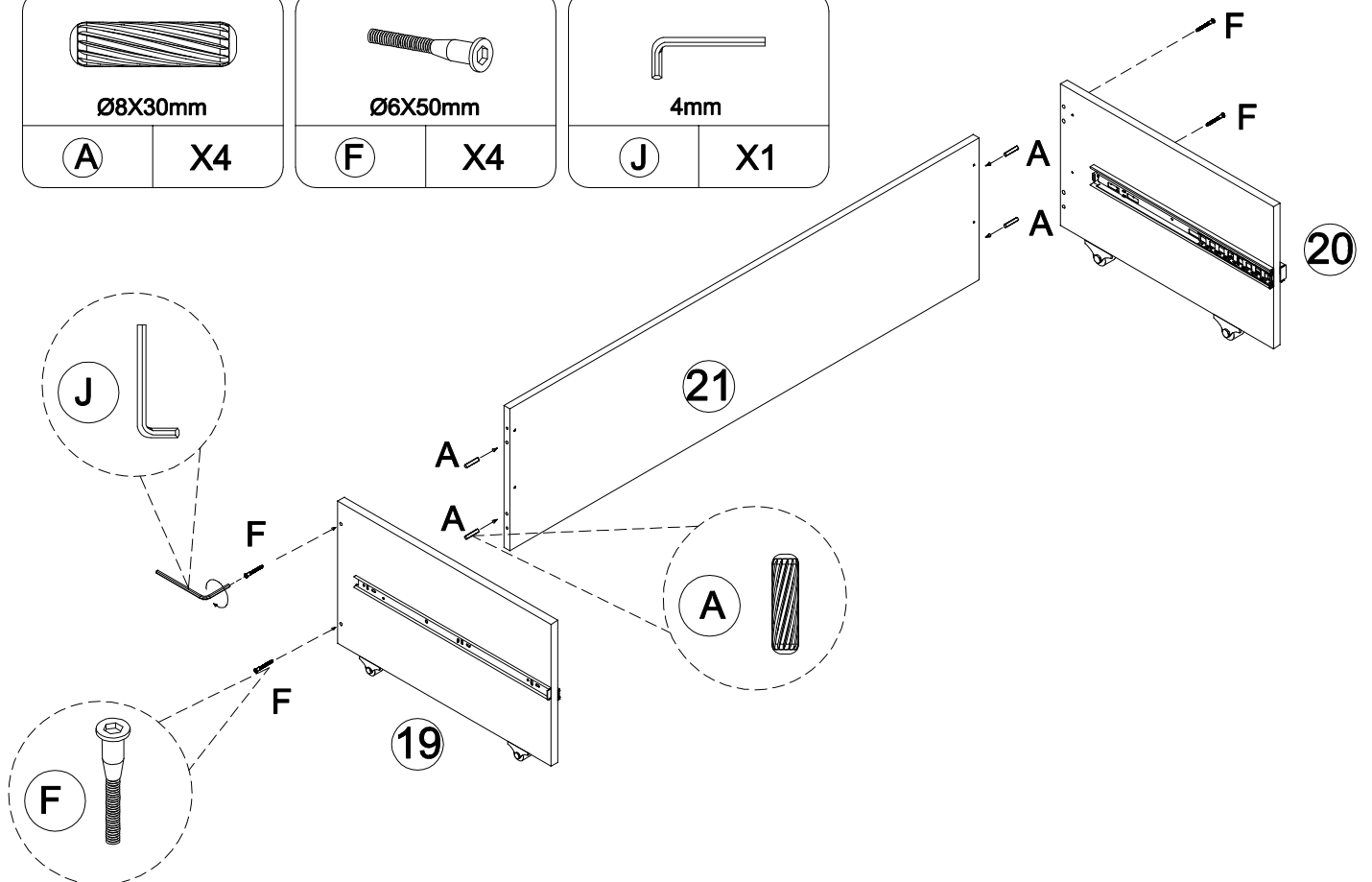
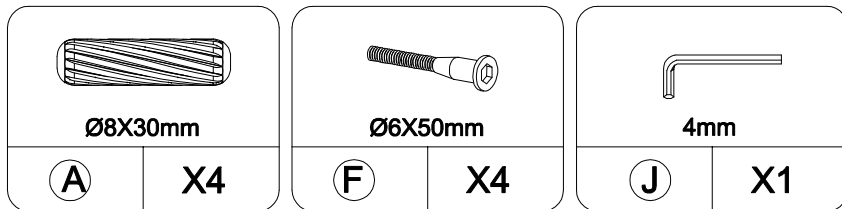

STEP 17

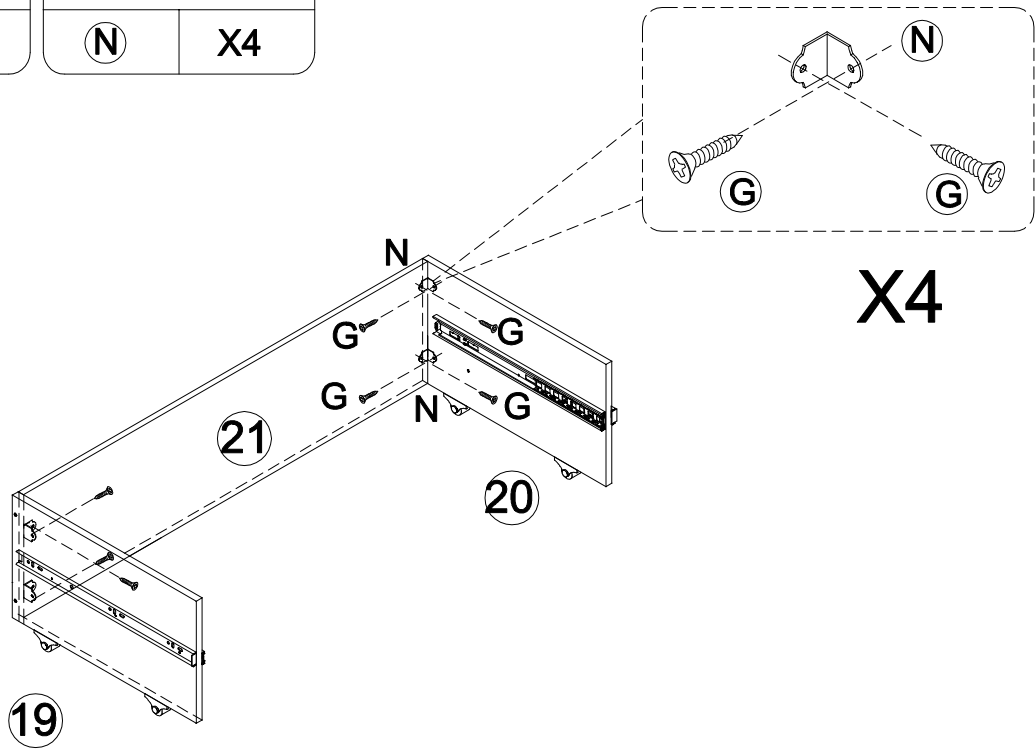
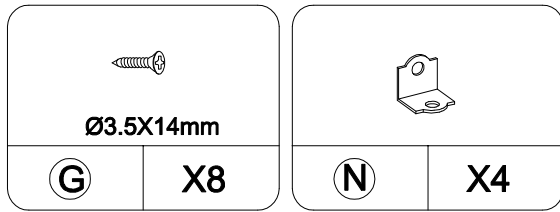

Move the ball slide to the outermost position

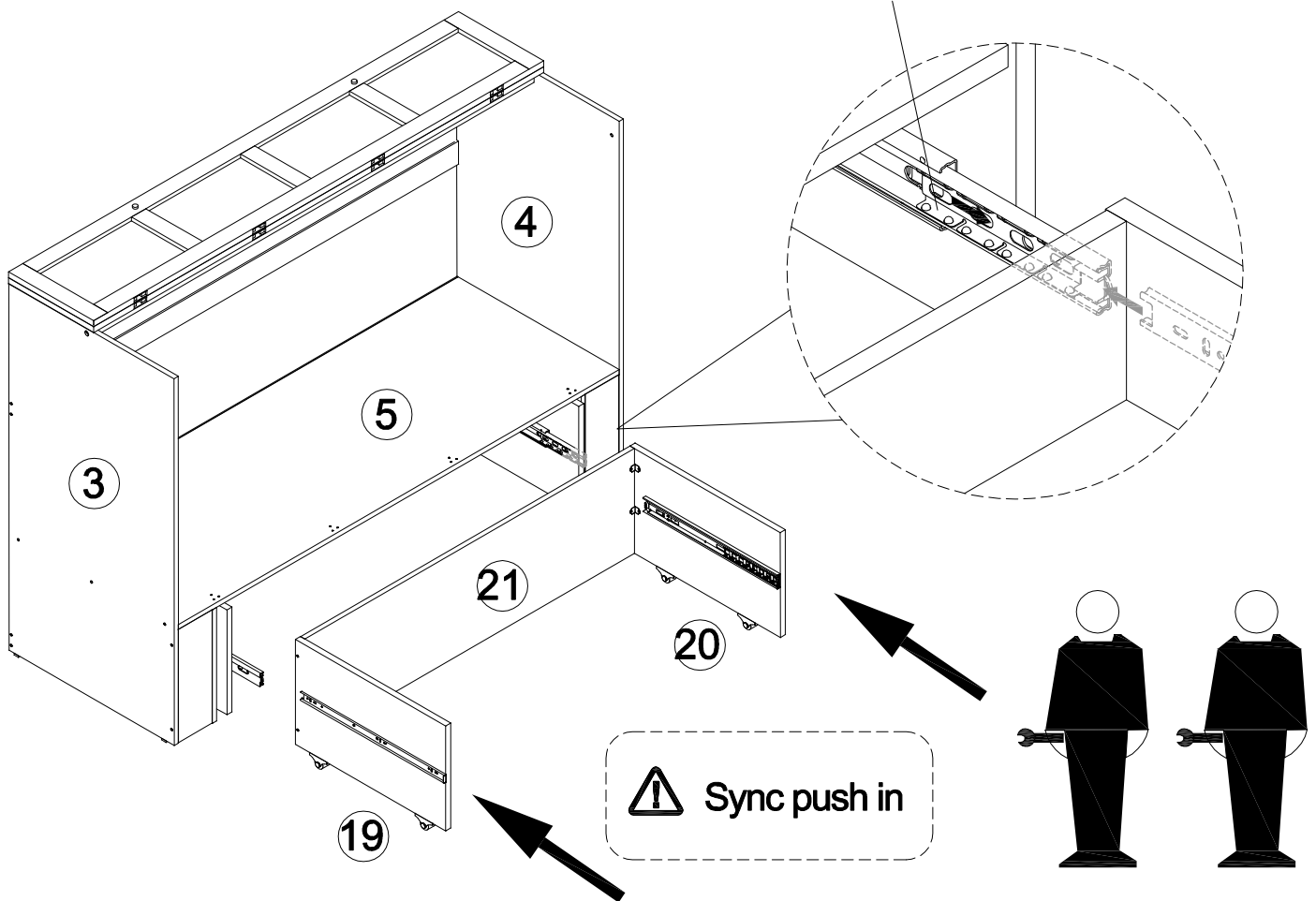



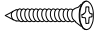
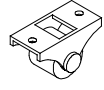

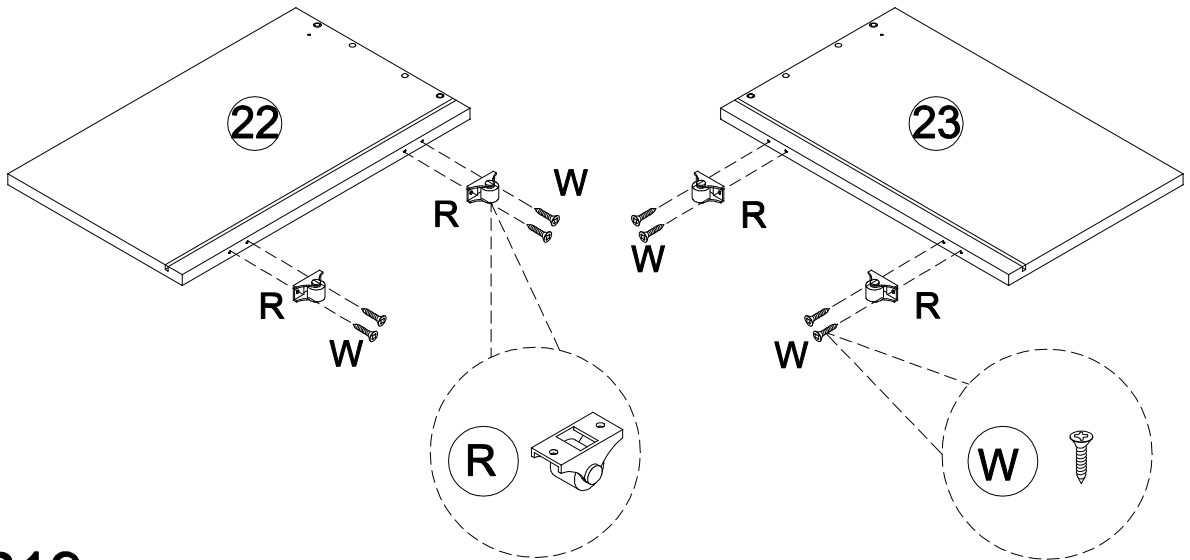
STEP 18

			
Ø3.5X20mm			
(W)	X8	(R)	X4

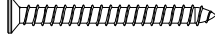

STEP 19

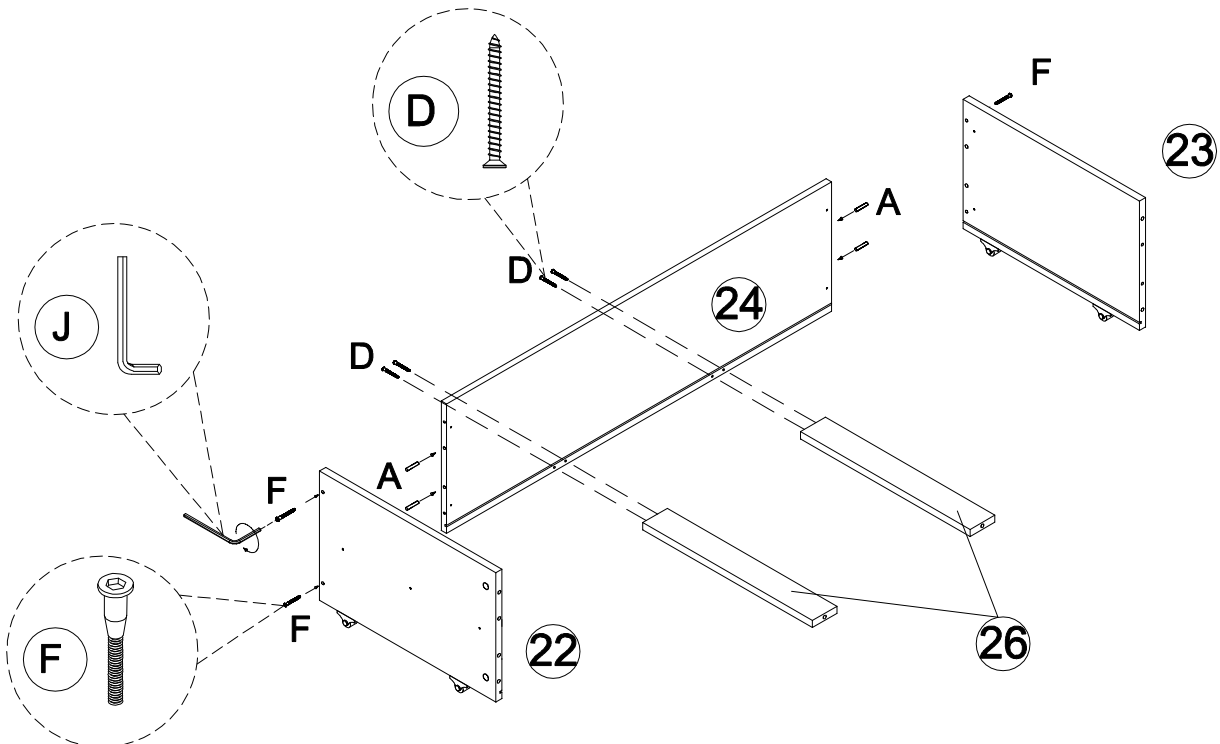

							
Ø8X30mm		Ø6X50mm		Ø4X30mm		4mm	
(A)	X4	(F)	X4	(D)	X4	(J)	X1

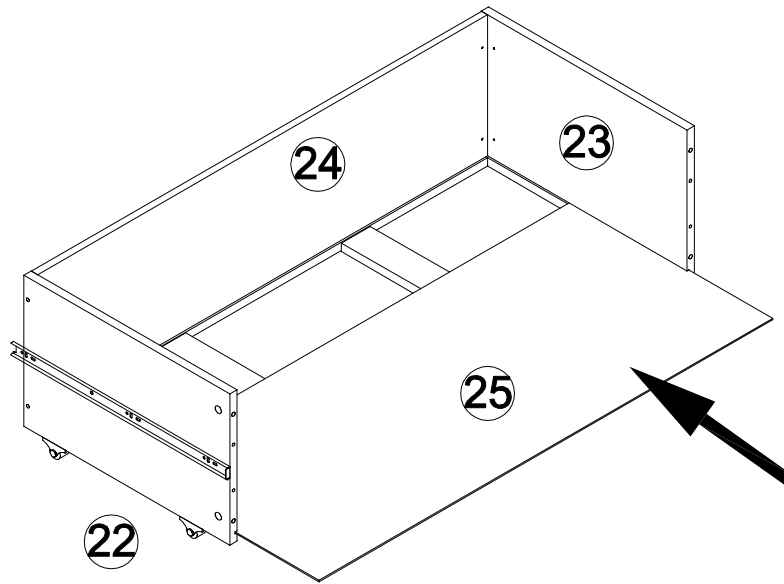

STEP20



STEP21

 Ø6X35mm	 Ø4X18mm	
(B) X6	(E) X2	(H) X2

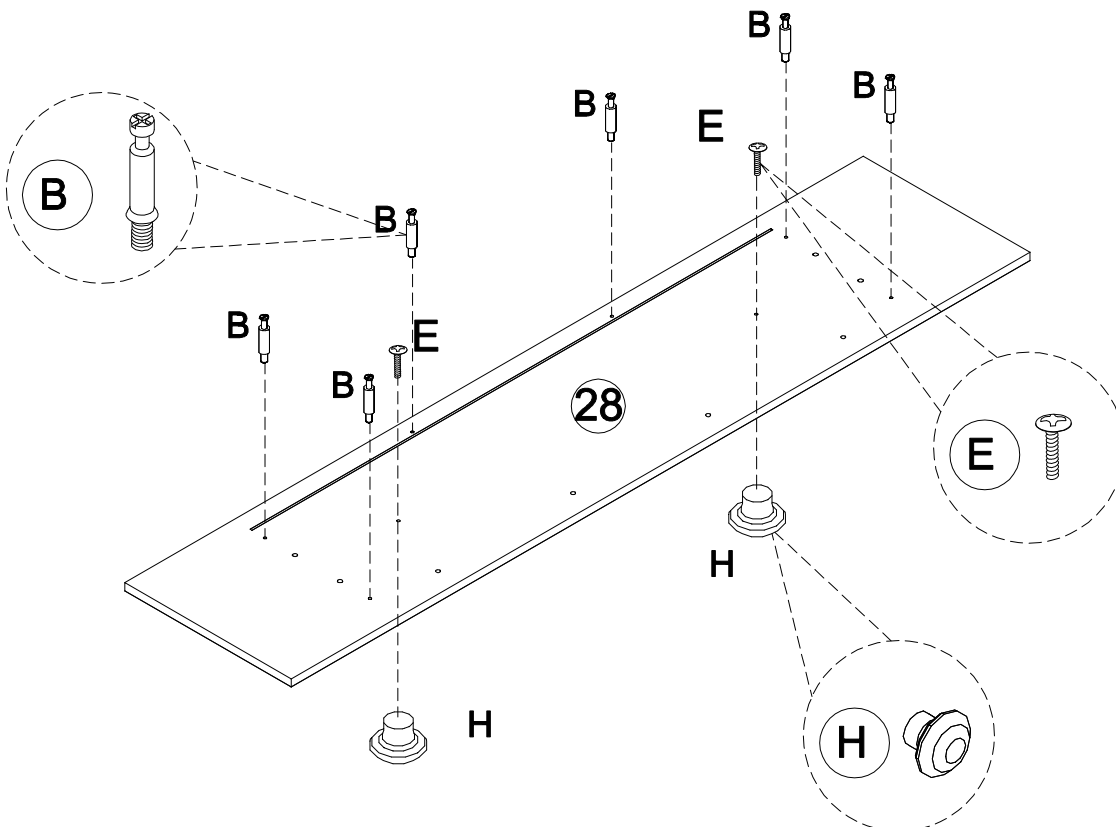

STEP22

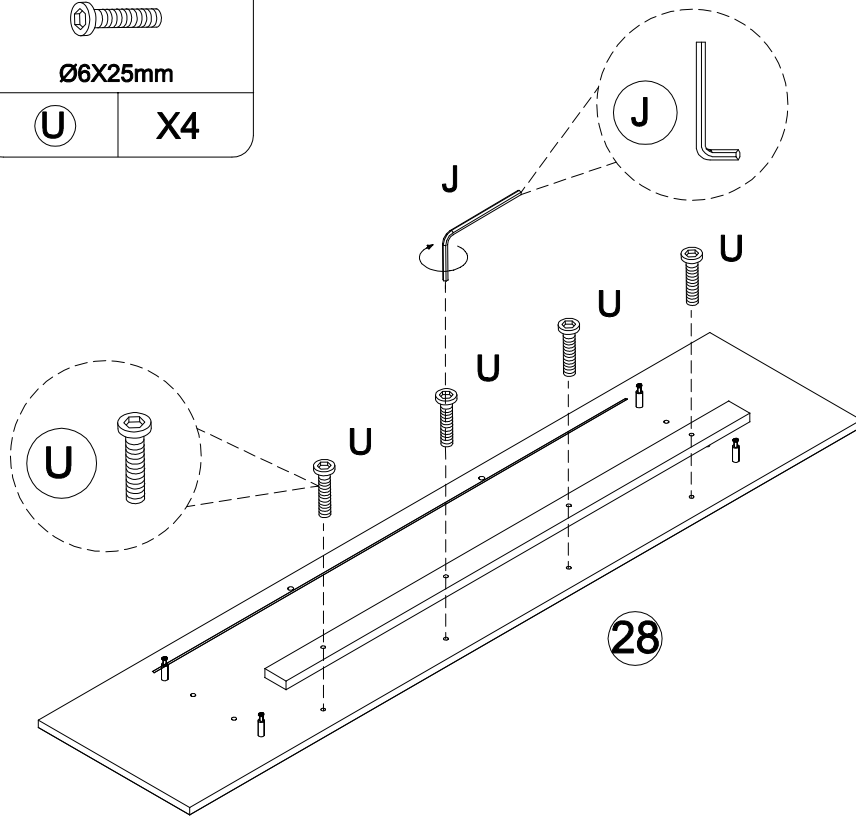
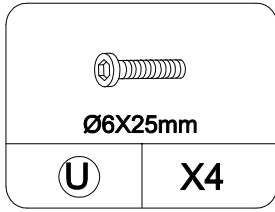
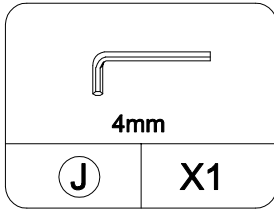

STEP23

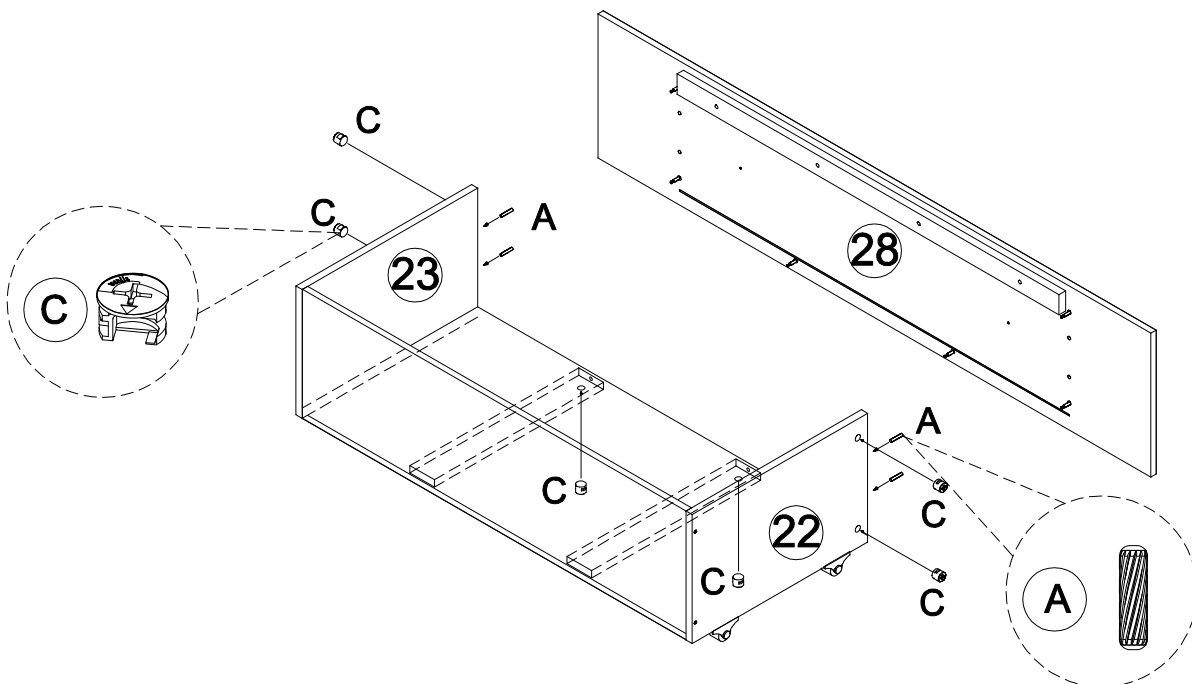
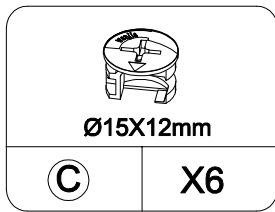
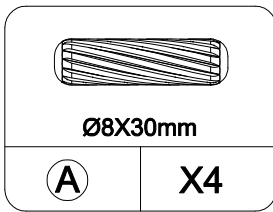

STEP24

 Ø3.5X14mm	
G	X14

	
N	X4

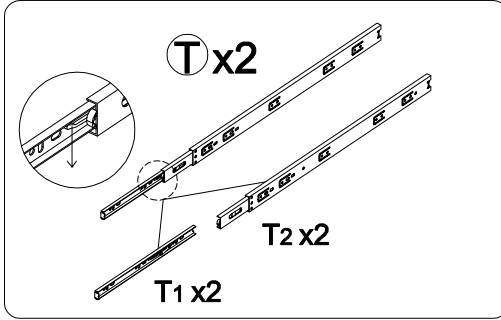

T x2
T2 x2
T1 x2

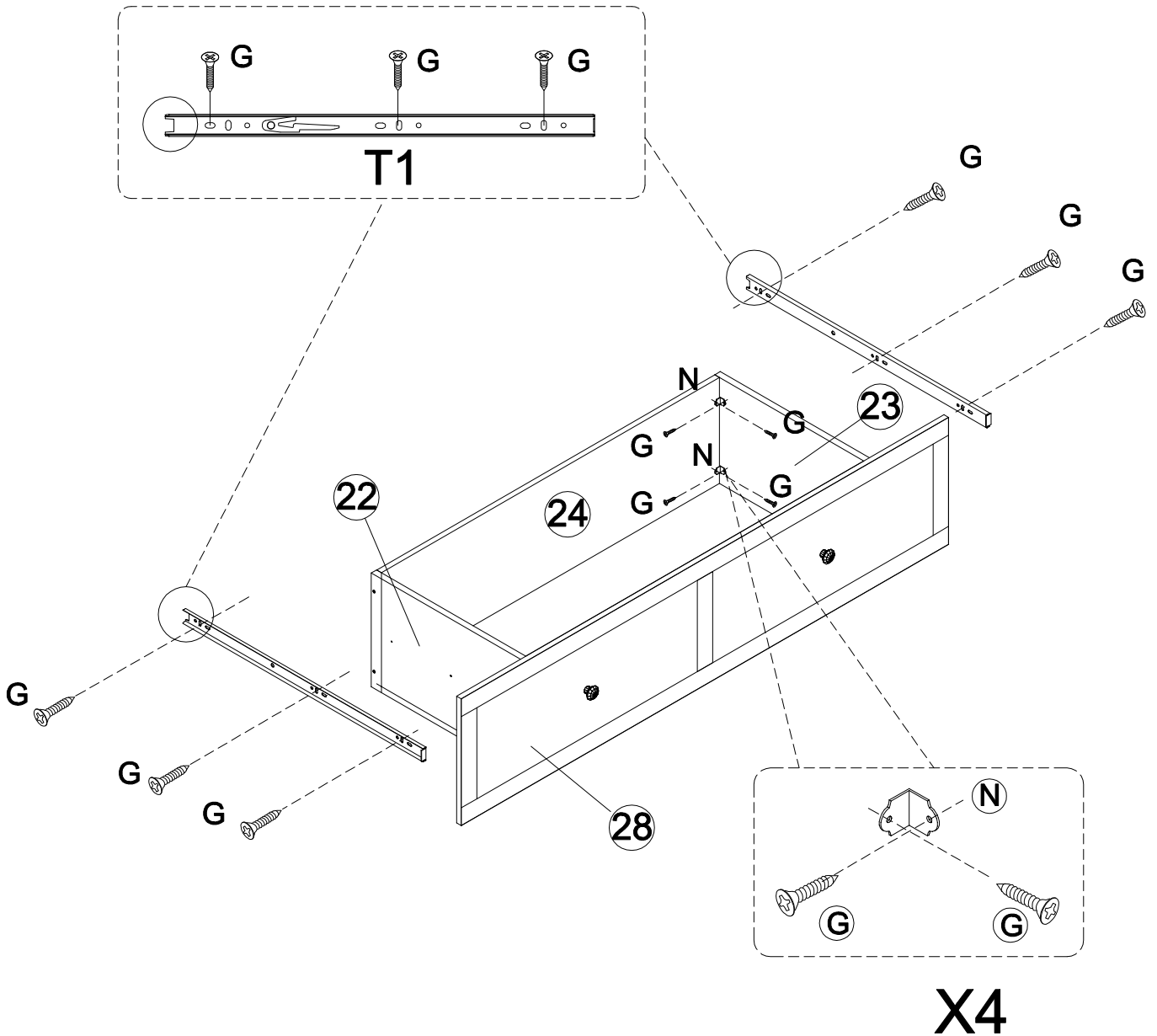

G **G** **G**
T1

G **G** **G**

N **G** **G**

22 **23** **24** **28**

N **G** **G**

X4

STEP25

Move the ball slide to the outermost position

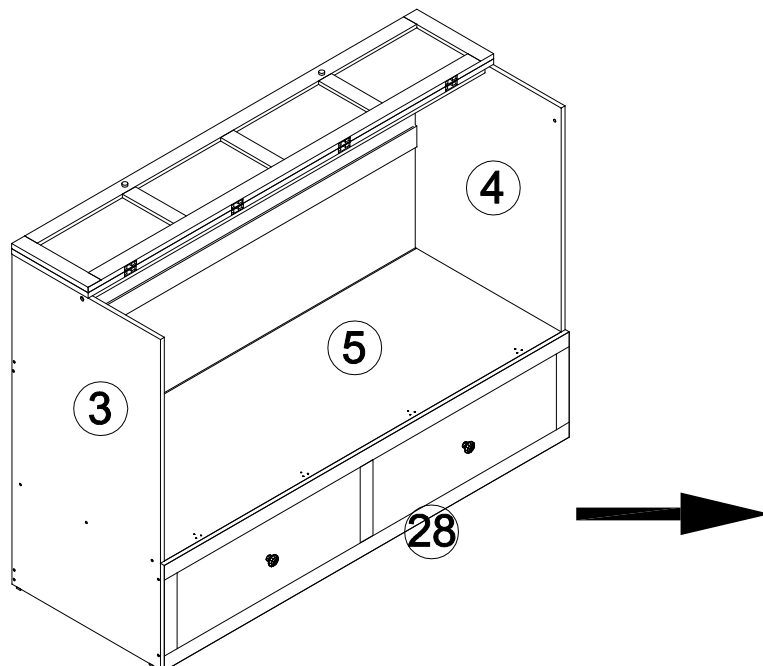
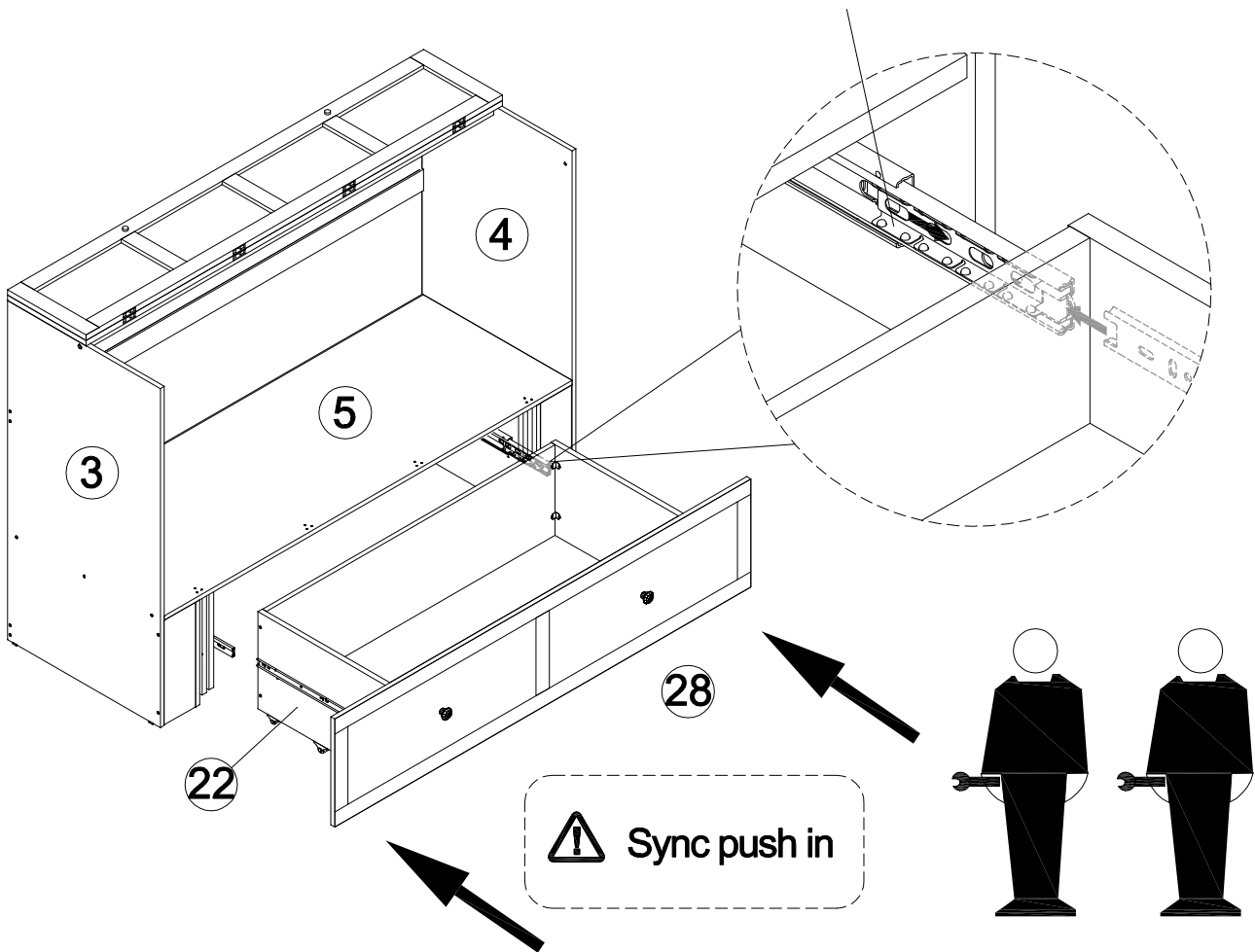

STEP26

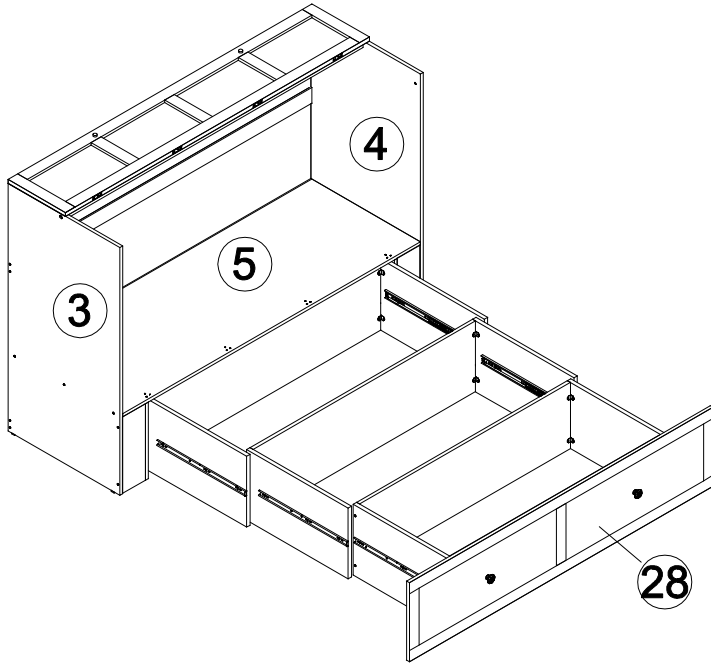

STEP27

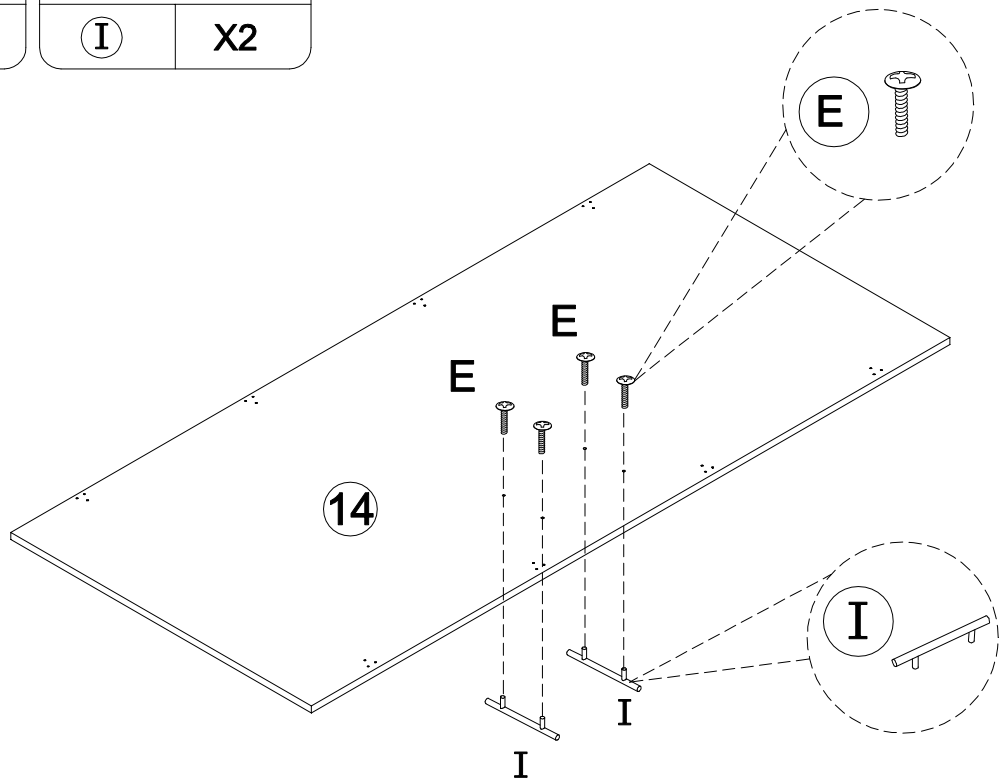
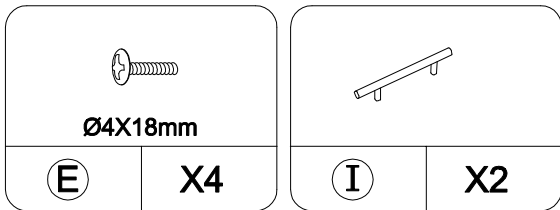

STEP28

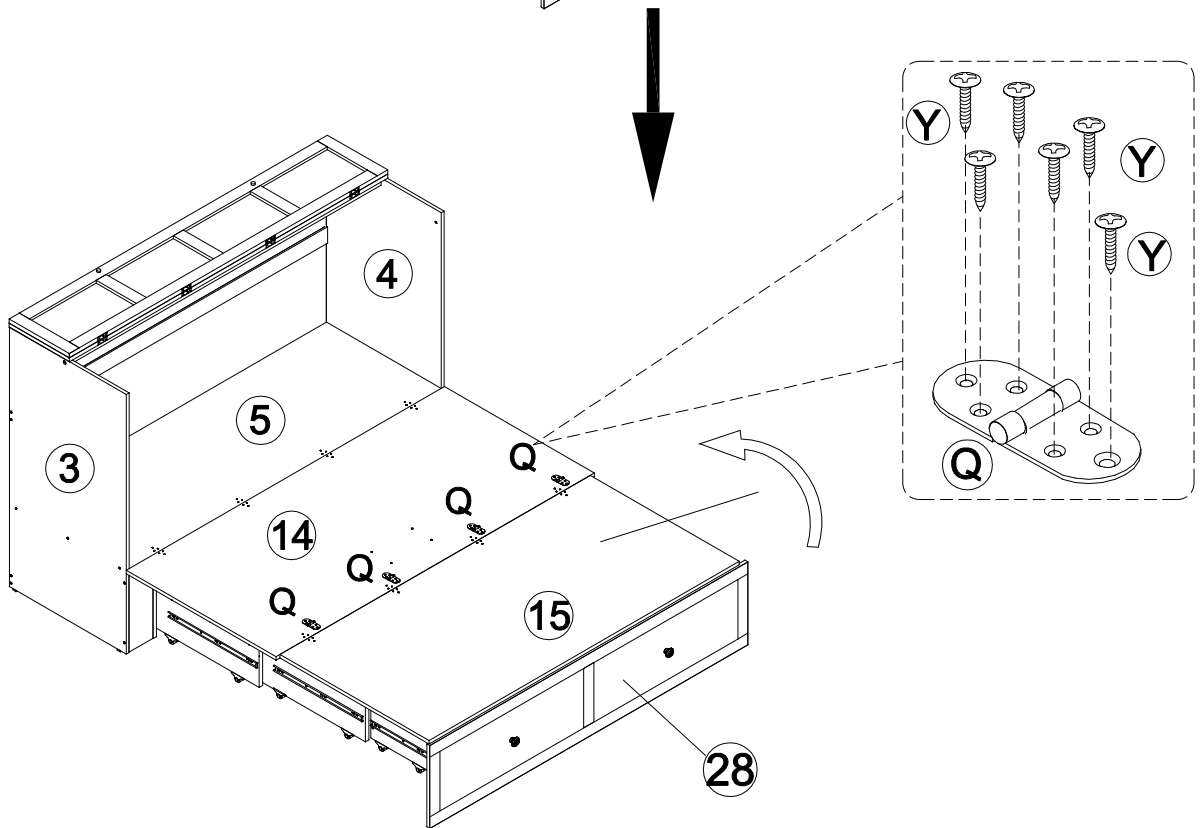
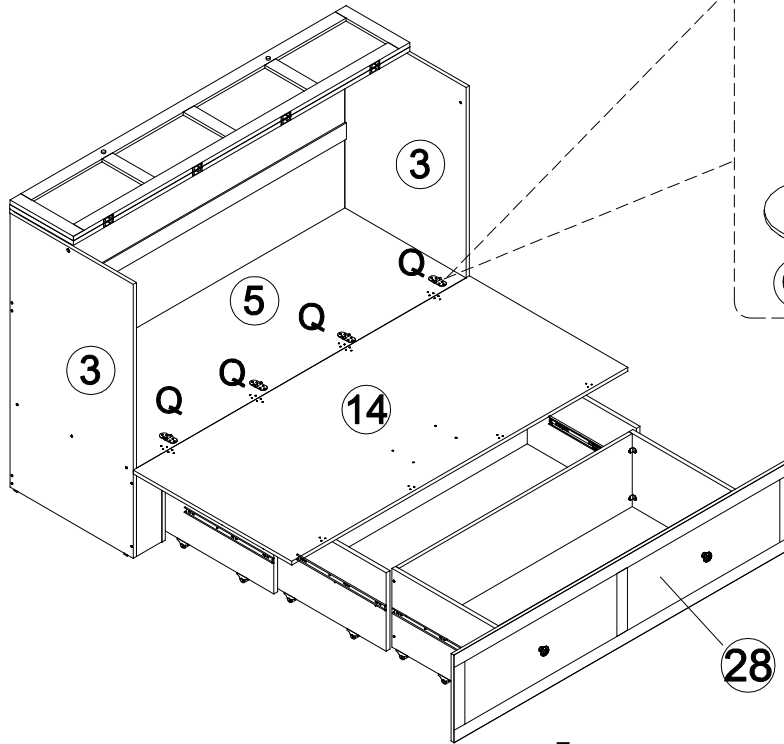
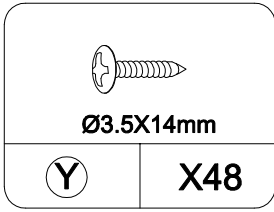
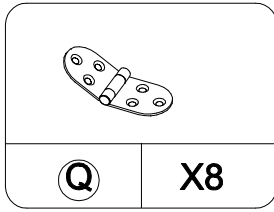

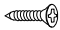

STEP 29

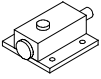
 Ø3.5X14mm	
G	X8

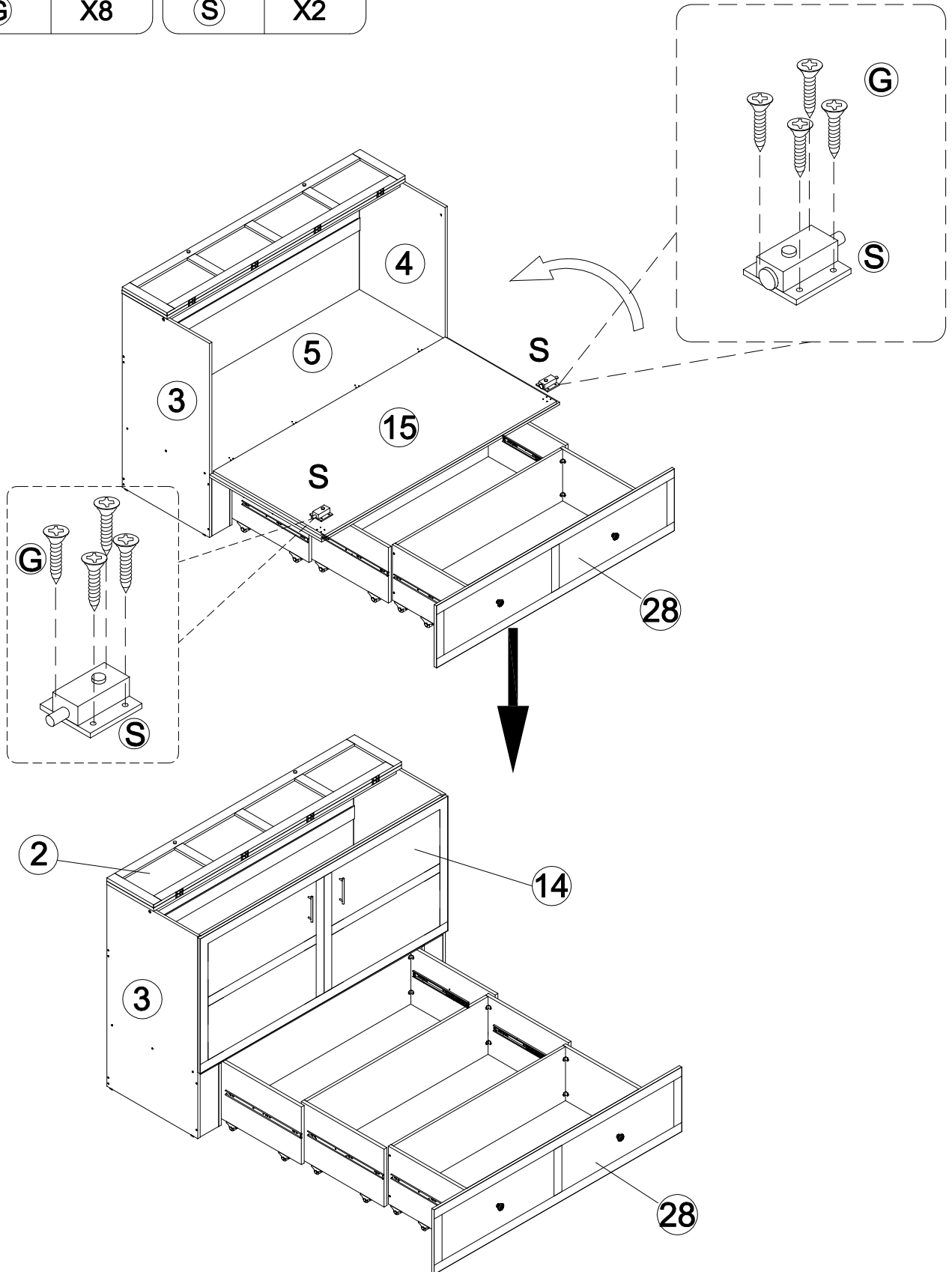
	
S	X2



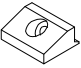

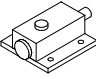
STEP 30

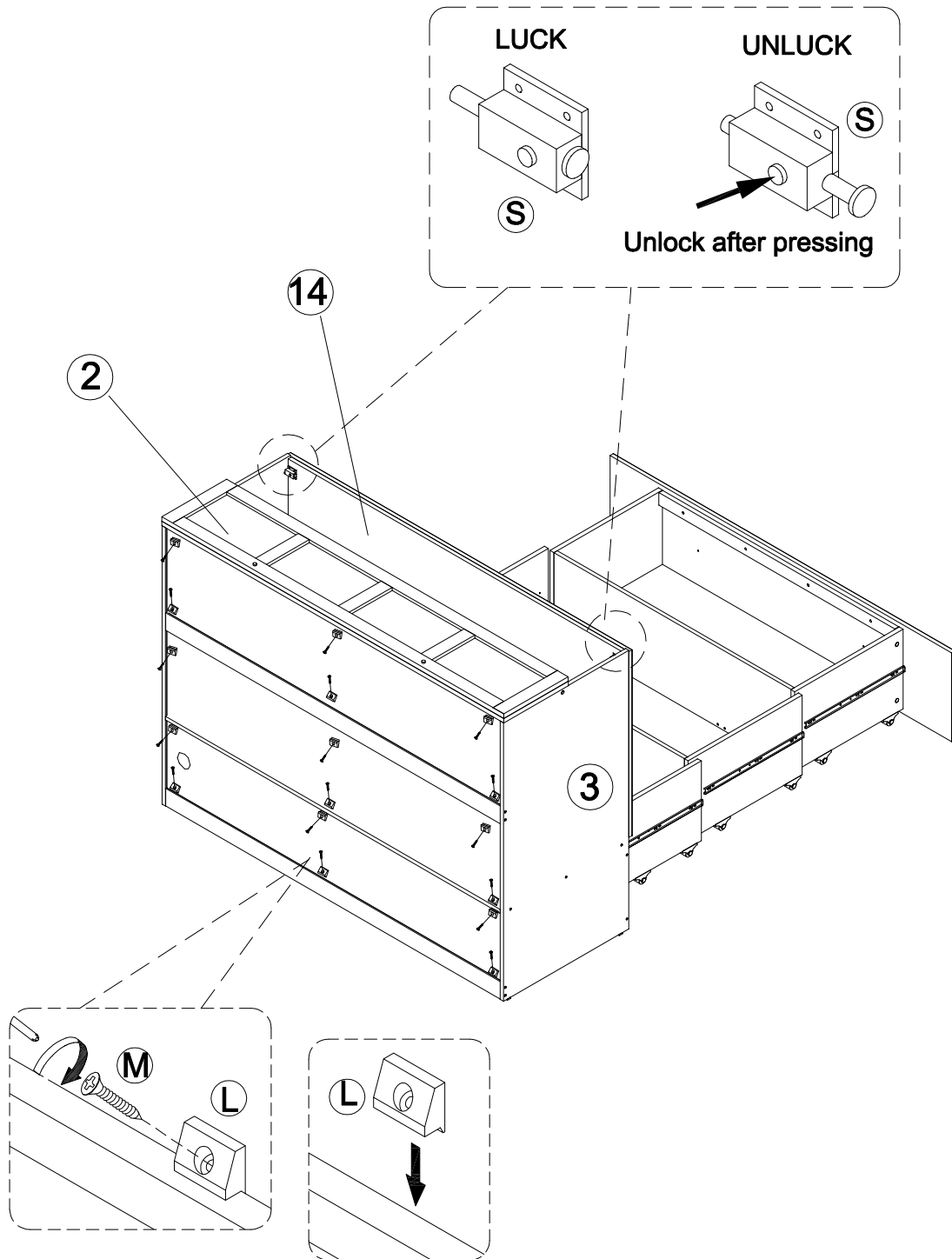
		 Ø3X16mm			
(L)	X18	(M)	X18	(S)	X2



STEP31

					
(Z)	X2	(O)	X2	(X)	X20

For Assemble
Anti Tipping
hardware

For Assemble
Anti Tipping
hardware

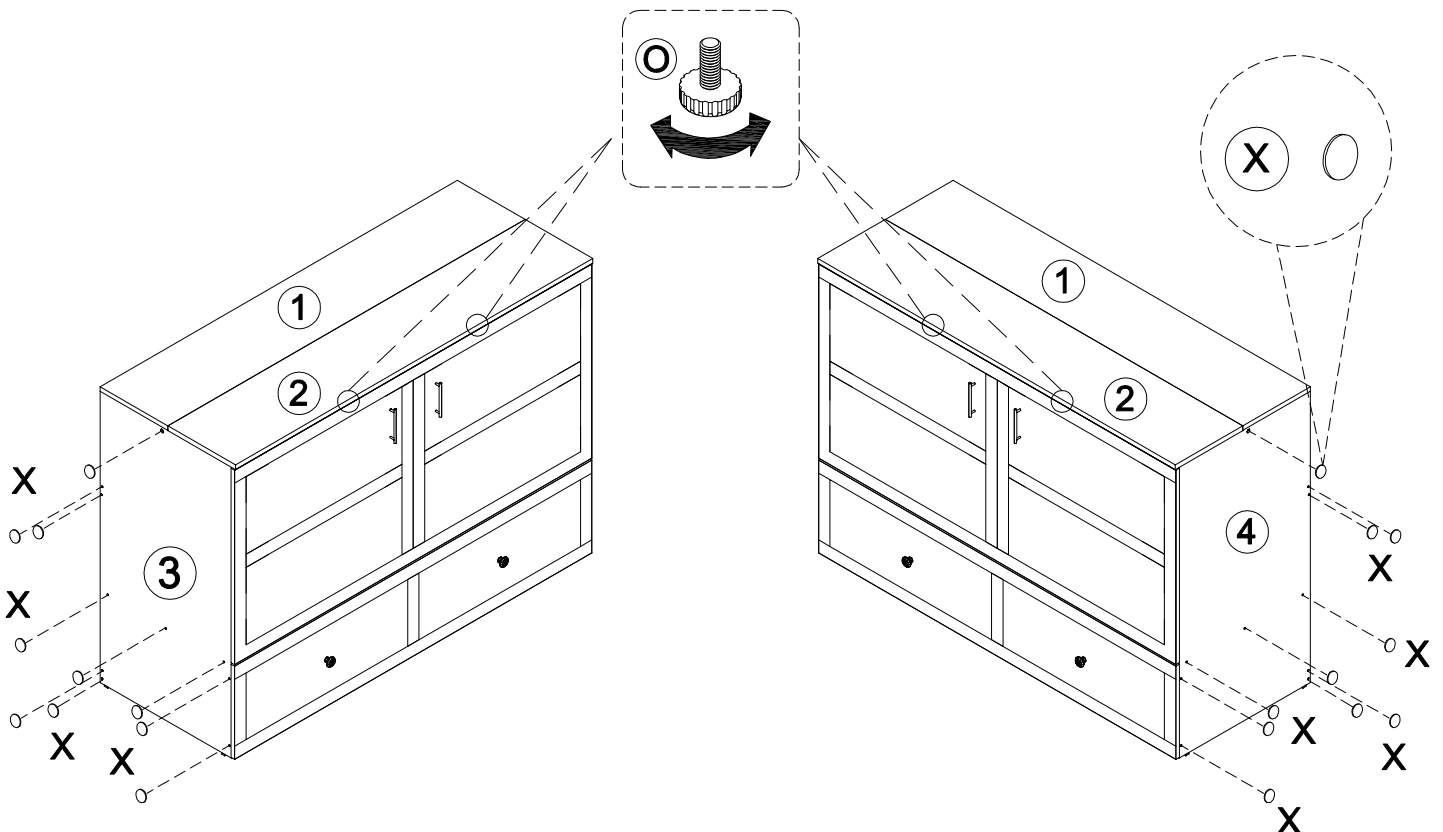
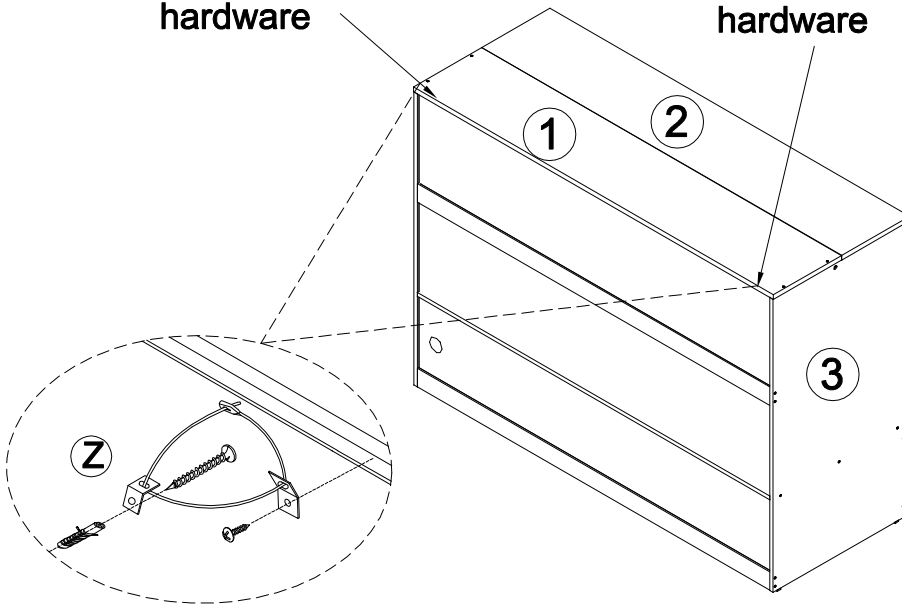

STEP32

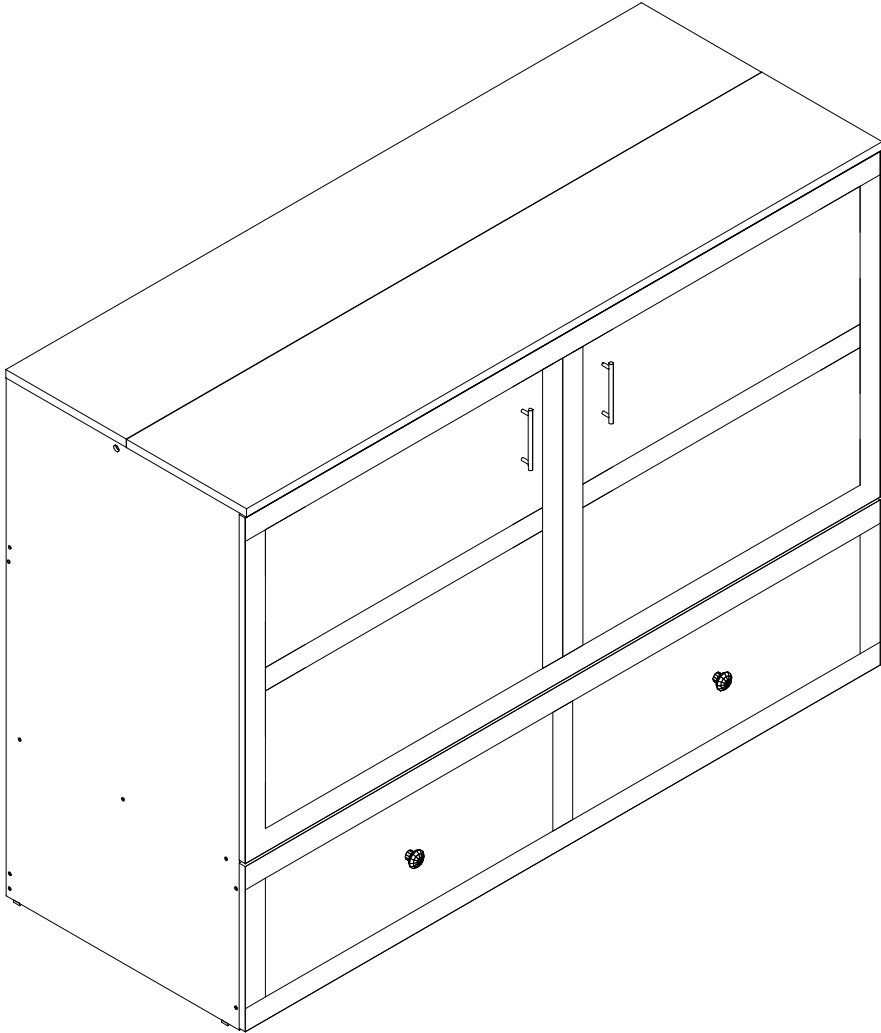

Final Assembly