

# DRESSER



## INSTALLATION INSTRUCTIONS

### NOTE:

The installation method of the same style and different colors is the same.

## MIRROR INSTALLATION

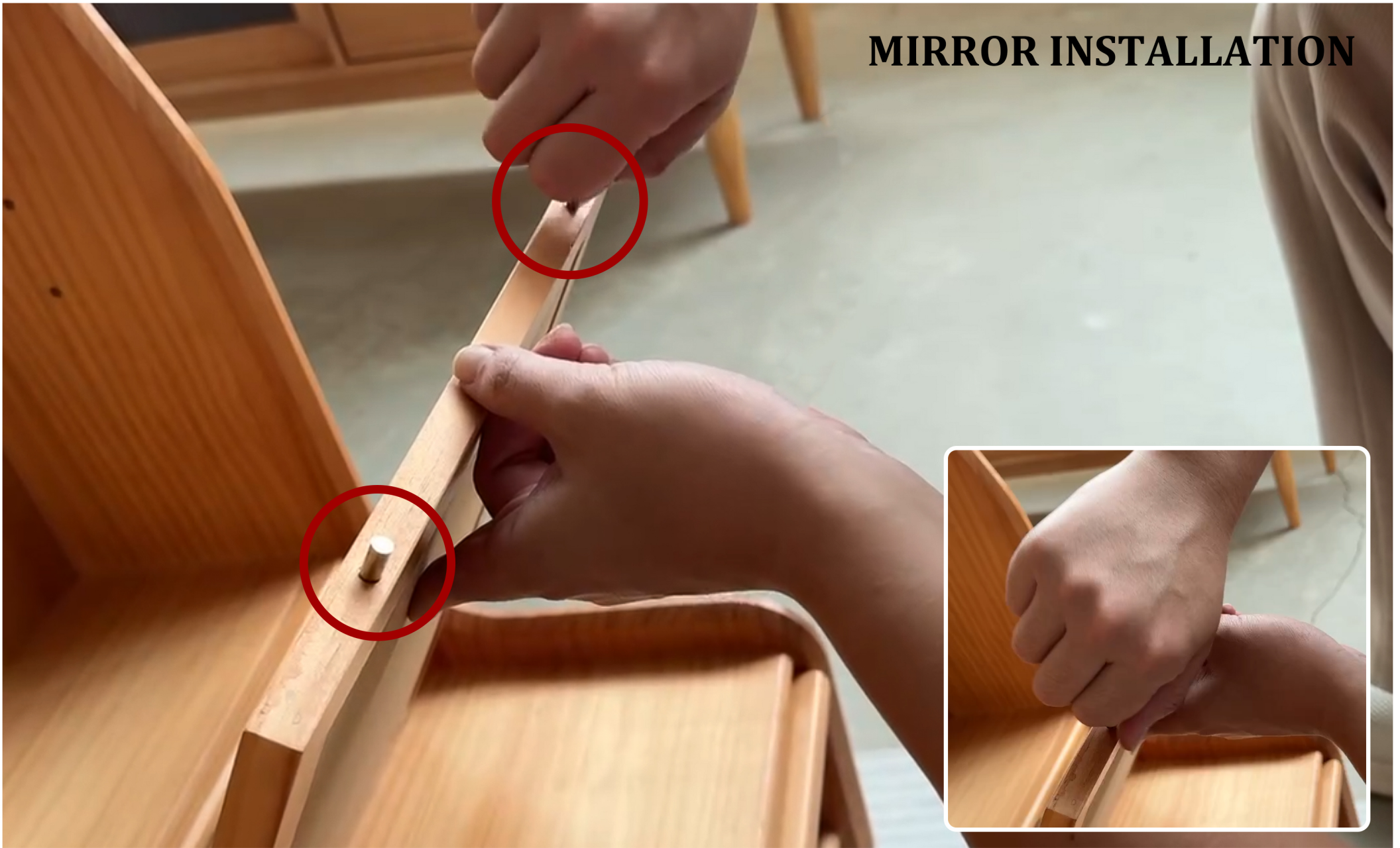

**Screw in the top and bottom two iron pins**

**NOTE : There is no upper or lower part of the mirror, and both sides can be installed**



**Align the holes at the bottom of the top plate and install the top and then the bottom**

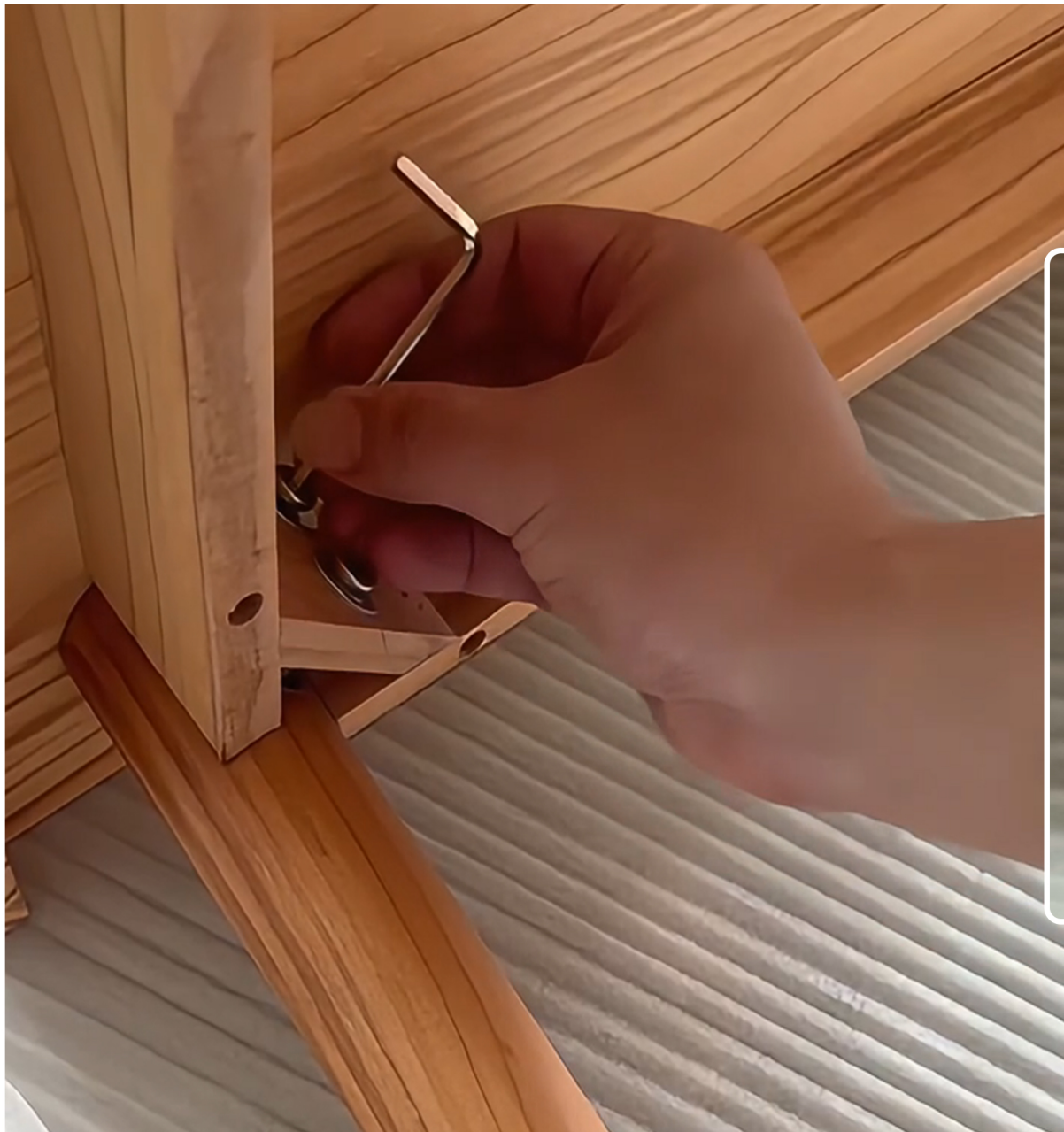

## TABLE LEG MOUNTING



Parts and components

**Align the legs with the holes at the bottom of the table with screws**

**NOTE: The other legs are installed the same way**