

Lift Seat

Product Description

Applicable model: Standard model, Comfortable model

Model No. : SLD-LS-19-A2

Executive Standards: : Q/320583 YGSL 001-2020



Content

1. Product introduction

1.1 Function

1.2 Package

2. Installation

2.1 Transportation

2.2 Armrest instruction

2.3 Other matters

3. Specification

3.1 Size

3.2 Specification parameters

4. Using manual

4.1 Precautions for use

4.2 Methods of use

5. Maintenance and service

5.1 Maintenance method

5.2 After-sale service

1. Product introduction

1.1 Function

This product is a special cushion which can help the users with weak knees and legs to solve the problem of getting up through the lifting device driven by linear motor. The products are safe, antiskid, ultra-thin, portable, quiet and comfortable. Lithium battery is provided in the product, which can be used after charging or external charger.

There are two types of this product, please choose according to the actual needs.

- 1). Standard model: No armrest in the product, plug in power supply.
- 2). Comfortable model: The product has its own armrest, which needs to be used after installation to ensure stability and safety.

1.2 Package

Open the product package and check whether all parts are complete and in good condition according to the packing details in the manual.

In case of any problem, please contact the supplier immediately.

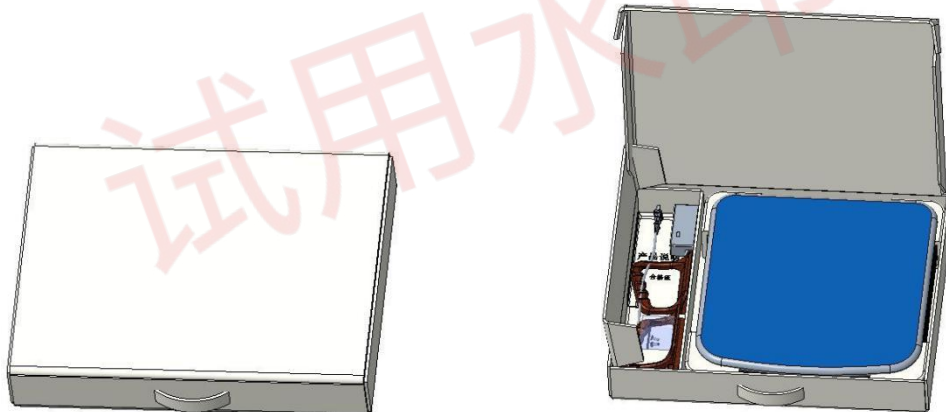

Figure.1 product packaging

The product box contains the following items:

- the Anti-skid sponge pad A×1
- Care lift B×1;



Figure.2 the anti-skid sponge pad and Care lift

Left armrest C×1 (Comfortable model)

Right armrest D×1 (Comfortable model)

Charger E×1 (Comfortable model)

Accessories and tools F×1 (Comfortable model)

(Including: set screw × 4, hexagon wrench × 1, screw hole decoration cover × 4)

Product description×1

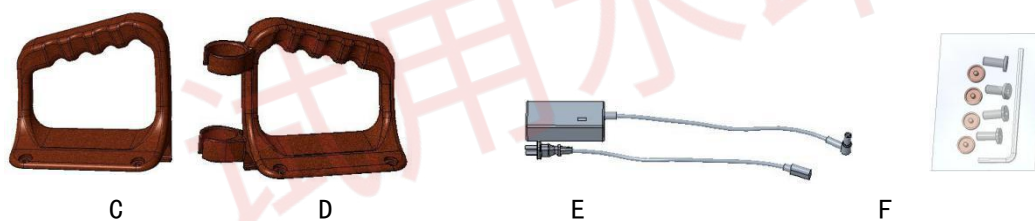

Figure.3 Accessories included in the small box of the product on the left

Warning:

Before using this product, please read the product manual carefully to confirm the correct installation and standard use method of the product.

2. Installation

2.1. Transportation

The product has handle hole. Lift the front end of the product and put your hand into the handle hole to easily lift the product.

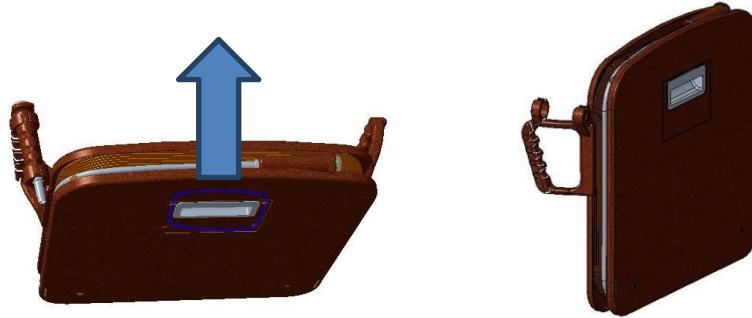

Figure.4 Handle hole

2.2 Armrest instruction (Comfortable model)

Accessories required:

Left armrest × 1, right armrest × 1, fixing screw × 4,
hexagon wrench × 1, screw hole trim cover × 4

Step 1: Take out the screw hole plug on the cushion;



Figure.5 The screw hole plug

Step 2: Align the mounting holes on the left and right armrest with the screw holes of the cushion and fix them with screws.

Step 3: Press the screw hole trim cover into the screw hole.



Figure.6 Installation of armrest cover



Figure 7 Installation of screw hole trim cover

Warning:

1. Pay attention to distinguish the left / right armrest, and do not mix them up (there is a handle slot on the right armrest).
2. Pay attention to the fastening screw of the armrest to prevent the armrest from loosening when using the product.

2.3 Other matters

2.3.1 Remove the switch cover:

In order to prevent the switch from being touched by mistake during transportation, the switch protection cover is set at the front end of the control switch. Please remove the protective cover before the first use.



Figure.8 Remove the switch cover

2.3.2 Control handle:

The control handle can be placed in the handle slot on the front of the right armrest.



Figure.9 fixing of control handle

2.3.3 Instructions for use of anti-skid sponge pad

According to the user's personal needs, the anti-skid sponge pad can be placed on the cushion for use.

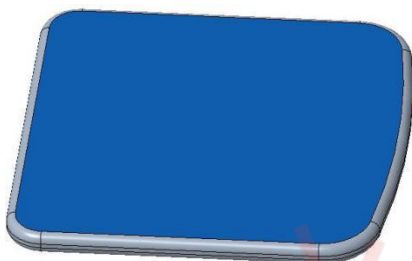

Figure.10 the Anti-skid sponge pad

3. Specification

3.1 Size

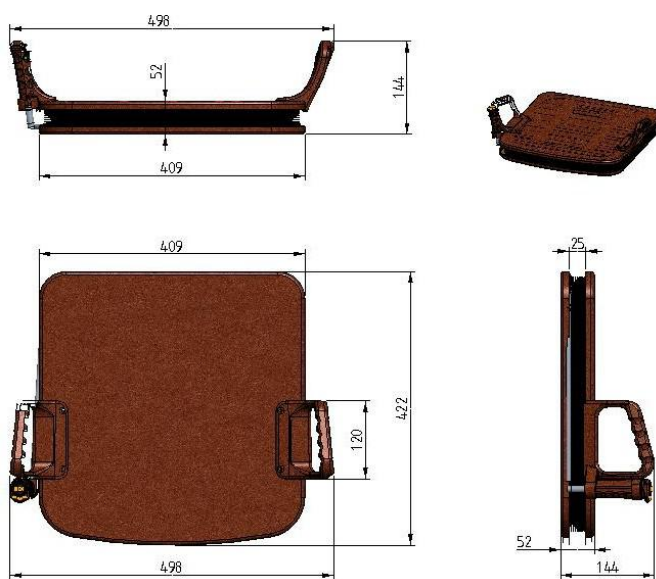

Figure.11 Initial state size

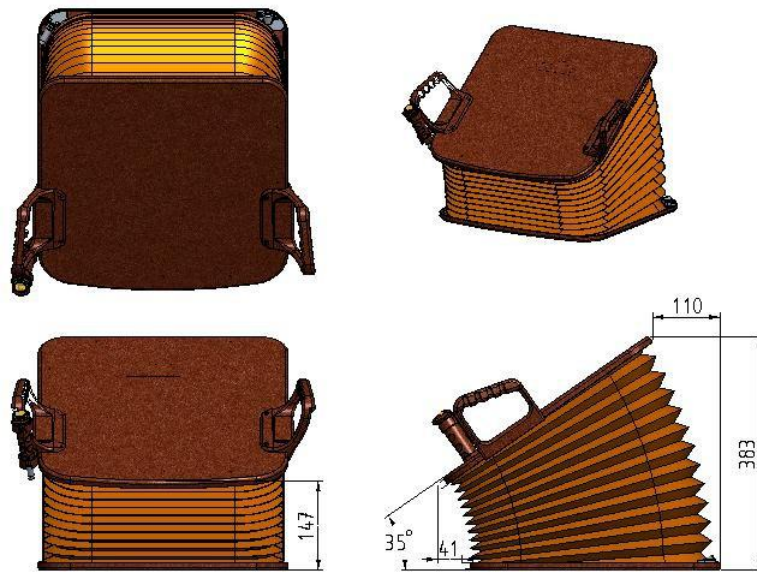

Figure.12 Working state size

3.2 Specification parameters

	Project	Parameter data	Instructions
1	Package size and gross weight	60*45*9cm、 7.0Kg	
2	Product size and net weight	42*41*5.4cm、 6.5Kg	
3	Rated bearing capacity	100Kg Max (Overweight will cause irreversible damage to the product)	
4	Uplift distance	Front end: 100mm Max Back end: 330mm Max	
5	Uplift angle	34° Max	
6	Running speed	30 seconds/ running cycle	
7	Working voltage of motor	DC:24V	
8	Rated power of motor	50W	
9	Motor working load rate	20%	
10	Size of power adapter	AC: 100~240V, 50~60HZ DC: 24V 3A	Standard
11	Battery voltage and capacity	DC 24V, 1.5AH	Comfortable
13	Battery charger specifications	Current input:AC100~240V, 50~60HZ0.65A Max Current output:DC 29.4V 1A	Comfortable
12	Number of uses when fully charged	About 80 cycles	
14	Protection level	IP44	
15	Security certification	CE	

4. Using manual

4.1 Precautions for use

4.1.1 Not applicable people:

This product is not suitable for people whose lower limb function is completely lost and whose legs can not support the upper body! Do not let children use this product!

4.1.2 Inapplicable scenarios:

This product is suitable to be placed on the seat, sofa and other seats, and can not be used for other purposes.

Examples of misuse:

- 1) It should not be placed on the object with roller on the foot, which may cause the product to slide and cause danger in the process of use;
- 2) It should not be used in a narrow space with no safety distance. It may cause pinch injury due to extrusion during use.

4.1.3 Safety distance of product use:

When using, a safety distance of > 150 mm must be left on the left and right sides of the product, and a safety distance of > 100 mm must be left behind the product. There must be a space height of more than 1.5 m above the product

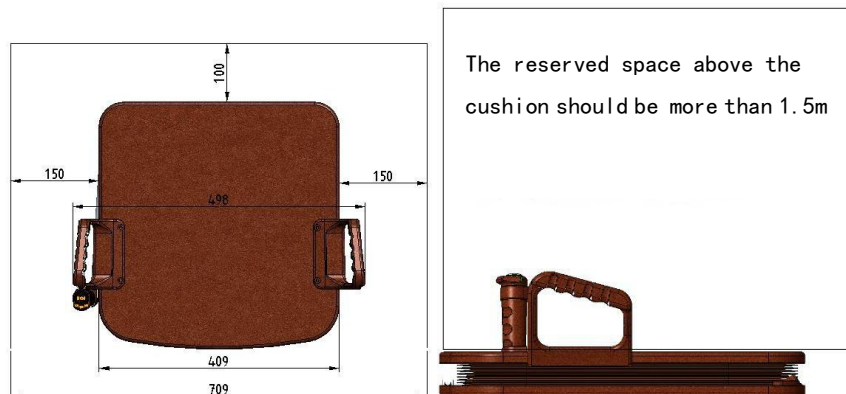

Figure. 13 product installation distance

Warning:

1. Before using this product, please read the above safety precautions carefully and follow them.
2. Improper use and operation of this product may cause danger and product

4.2 Methods of use

4.2.1 Product charging

Before using the product for the first time, it is recommended that the product be fully charged before use.

Charging: the lifting cushion obviously slows down, and it fails to move, indicating that the battery power is insufficient. Use a special battery charger to plug into the charging jack on the left rear side of the product for charging. It takes about 2 hours to fully charge the battery. (the charger indicator changes from red to green, which means the battery is fully charged).

When in use, insert the power charger into the power interface on the left rear side of the product for power on.



Figure.14 Charging

4.2.2. Operating instructions of control buttons:

The control button of the device is located at the front of the control handle, and the switch has three states:

- Left key "Press down" --- Cushion up,
- Middle key "Horizontal" --- Cushion stop,
- Right key "Press down" --- Cushion down.

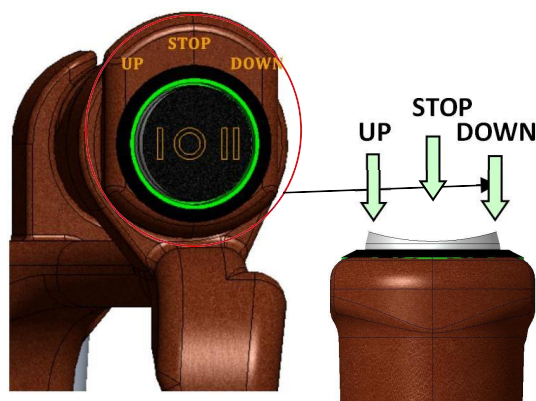

Figure.15 Operation of control button

4.2.3 Operation method:

1.) 1. The user shall sit on the cushion and adjust the sitting posture to a proper position (the tall user shall sit back and the short user shall sit forward to ensure that his feet can land on the ground during the whole use process).

2.) The user can press the control button on the right armrest to control the rise, fall and stop of the product. During the lifting process, the user can hold the left and right armrests with both hands.

3.) When the ascending or descending reaches the end of travel, the product will stop automatically. If you need to stop at any position in the middle, you can press the switch to the intermediate stop state at any time, and the product will stop at the current position immediately.

4.) After the seat cushion stops stably and before getting ready to get up, the user can push the armrests on both sides with both hands to help get up.

Warning:

1. The rated static load of the product is 100kg, and it is not recommended to use it over weight.
2. The maximum load rate of the motor of this product is 20%, which can not be used continuously. The interval time of single operation should be more than 60 seconds.
3. This product is only for adults and children are not allowed to play. To avoid product damage and danger.

Warning:

1. The product must use special charger.
2. After the battery of the product is short of power, it should be charged in time, otherwise the performance of the battery will be reduced or damaged.

5. Maintenance and service

5.1 Maintenance method

It is recommended to maintain the products regularly:

- 1) Wipe the equipment with a clean soft cloth dipped in a mild, non abrasive, neutral detergent.
- 2) The product can prevent the common splashing of domestic water, but it can not be washed or immersed in liquid.
- 3) The product should not be exposed to the sun for a long time to prevent aging and discoloration of the product surface.
- 4) If the product is not used for a long time, it is recommended to store it in a dry and cool environment after full charge.

5.2 After-sale service

- 1) This product provides 1 year warranty and lifelong maintenance service;
- 2) Users should use and maintain the products according to the instructions;
- 3) This product has no self repairing parts and can not be disassembled.

Warning:

This product is strictly prohibited to disassemble, so as to avoid damage and danger! No free repair will be allowed for any damage caused by self disassembly.

Annex: warranty card and after sales service

Warranty card

User file date

Name	Gender	Age
Contact address:		
Phone number	Postcode	
Product model:		
Purchase date:		
Place of purchase:		

Warranty terms:

1. Within three months from the date of sales, if there is a functional failure happens, the product itself and the outer packaging must remain intact, free from scratches, and the same model of product can be replaced (subject to inspection) but does not include man-made damage.
2. The product is guaranteed for one year from the date of sale, and it is maintained for whole life. Spare parts are not covered by the warranty.
3. The warranty service is only valid under normal use.
4. All external damages such as man-made damage, self-dismantling, unpacking, improper use, etc. are not covered by the warranty. The card must be provided during the warranty. If the card is not provided or the card is altered privately, the company has the right to do Non-warranty processing.

试用水印

Lift Seat

Model: SLD-LS-19-A2

Executive Standards: :Q/320583 YGSL 001-2020

试用水印