

## Maintenance and Care

- Clean with a soft cloth. Use mild soap and water if needed.
- Do not use abrasive cleaners or harsh chemicals.
- Avoid prolonged contact with standing water or constantly wet soil.
- If the surface coating is scratched, touch up promptly with rust-resistant outdoor metal paint.
- At the end of the season or during harsh weather conditions, clean the trellis, allow it to dry completely, and store it indoors.
- Periodically check the trellis for stability as needed.

## Warranty

Warranty: 3 Years Structural Guarantee

Exclusions: Damage caused by misuse, improper installation, or modifications is not covered.

  
**Gardening  
Made Easier.  
Anytime,  
Anywhere.**

---

## Contact Us

 +1 (866) 597-1888

 Vego Garden Academy

 hello@vegogarden.com

 vegogarden.com

 vego\_garden

 Houston, TX



# FlexGrow A-Frame Trellis Classic User Manual

Models: VPSSATCDG-2

Gardening Made Easier. Anytime, Anywhere.

Copyright © 2026 Vego

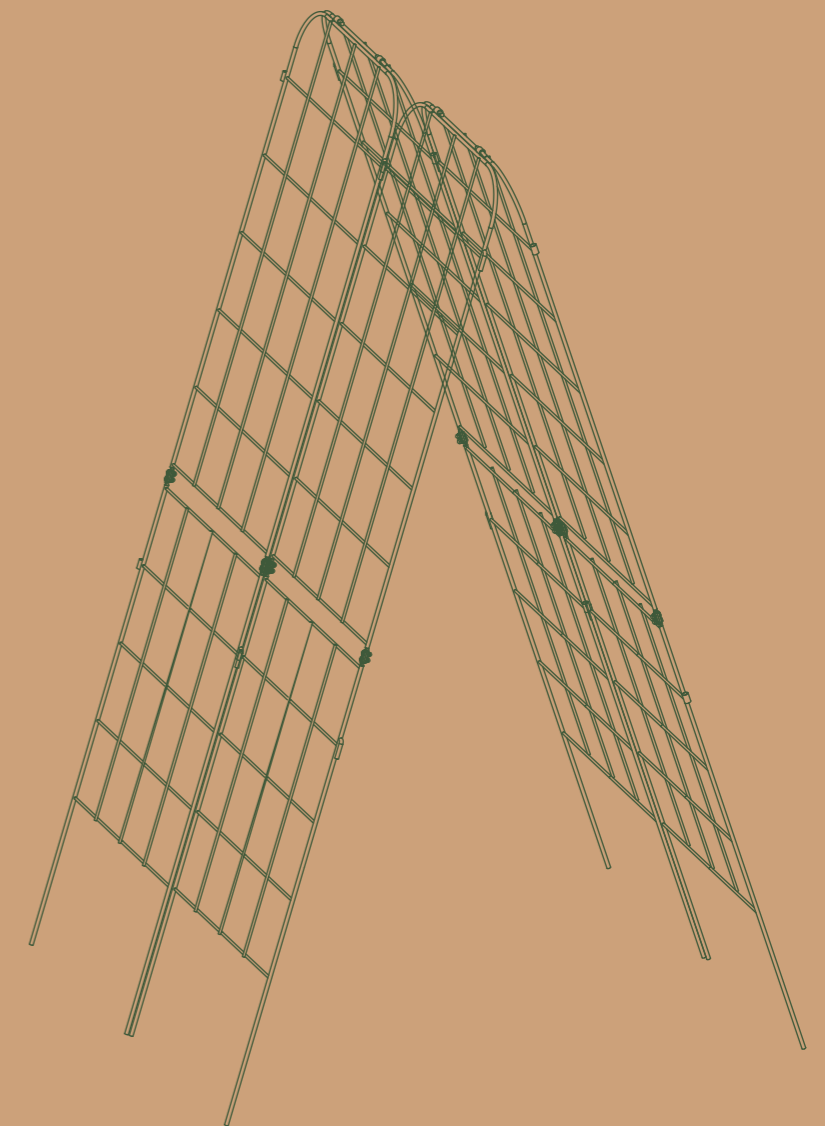

## Parts List

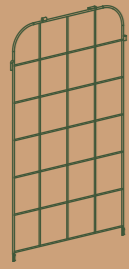

P1

Qty: 4

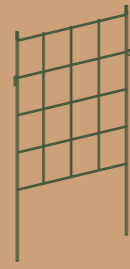

P2

Qty: 4



F1 R-shaped pin  
(Includes 2 spare parts)

Qty: 6



F2

(Includes 2 spare parts)  
Qty: 18



F3

(Includes 2 spare parts)  
Qty: 18

## Safety Precautions

This product may contain sharp corners and edges. To prevent injury:

- Handle with care at all times
- Wear gloves, closed-toe shoes & long pants when handling
- Work on a stable, clean surface away from children and pets
- Follow all instructions carefully and use tools only as directed

If you are unsure about any step, pause and seek assistance.



## Installation Instructions

- 1 Connect P1 and P2, Overlap the connection ends of P1 and P2 panels as shown in the diagram. Make sure all mounting holes are fully aligned. Secure each hole using the F2 and F3 fasteners, and tighten firmly.

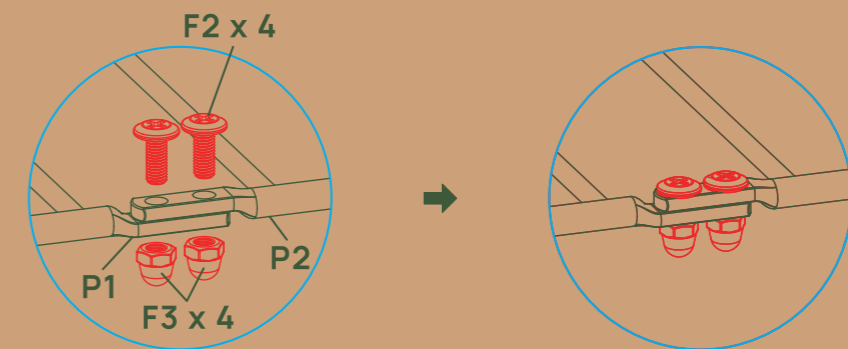
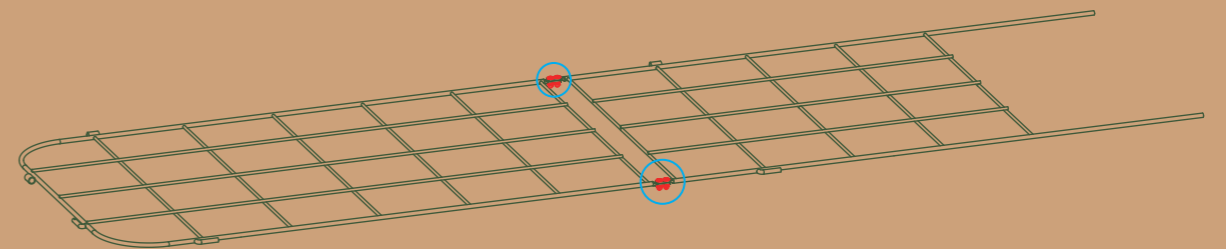
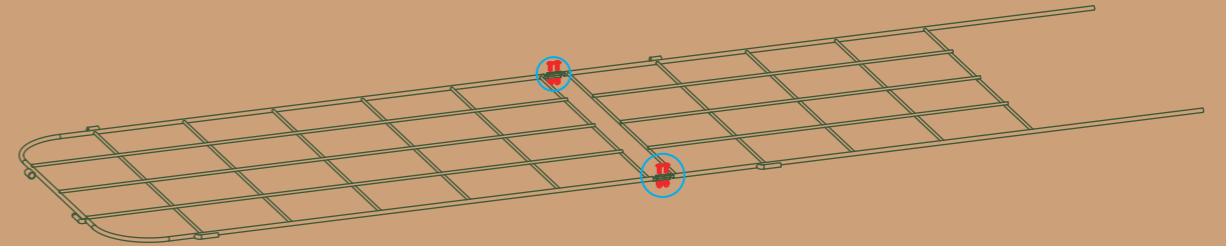

- 2** Lay the assembled panels flat on the ground, with the top ends facing each other as shown in the diagram. Align the L-hooks with the sleeves and insert them fully.

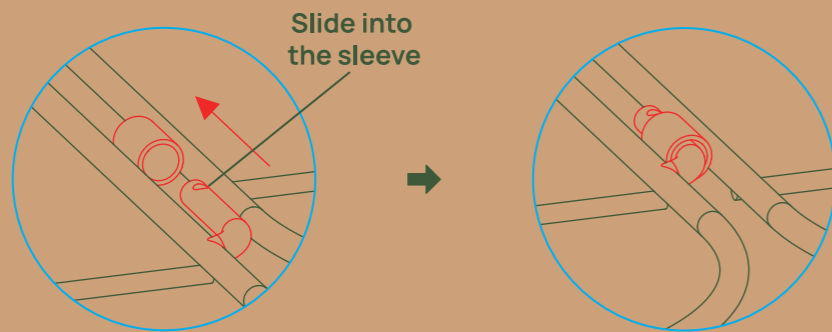
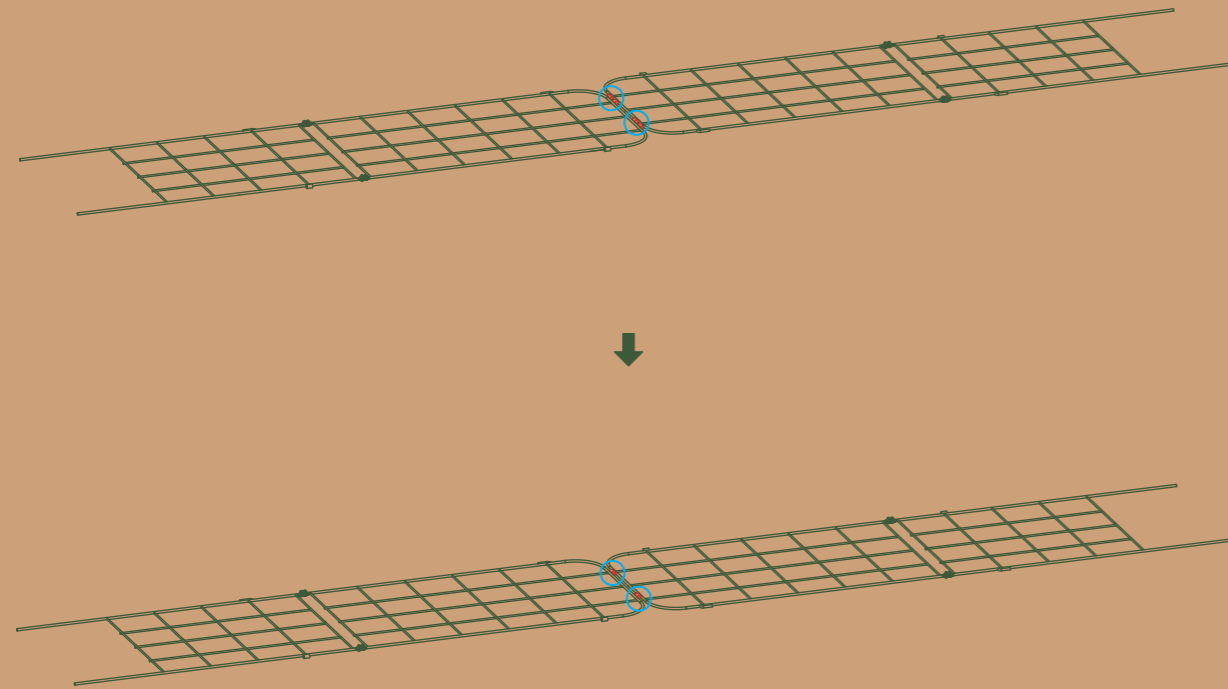

- 3** Lift the assembled trellis into the upright position.

**Note:** The locking stops are directional. If the trellis cannot be lifted smoothly, flip the entire assembly over, then lift again.

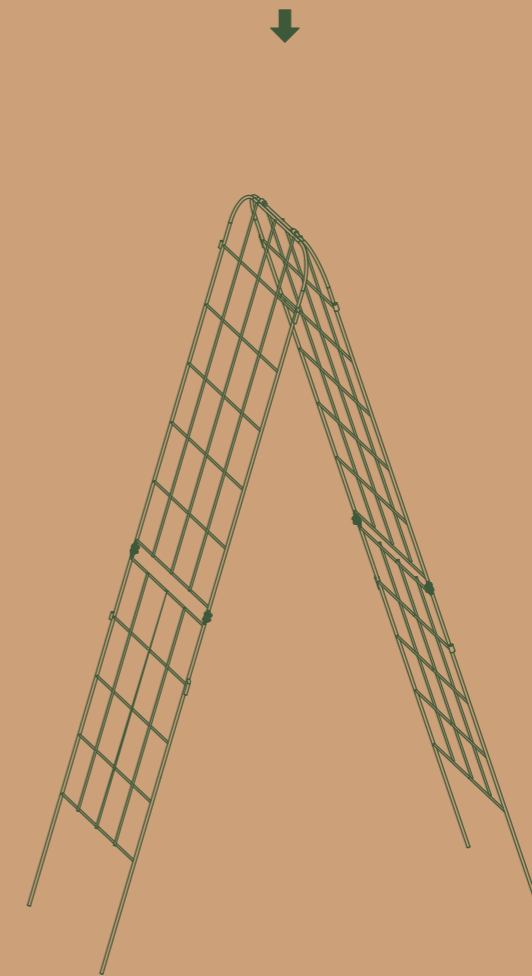
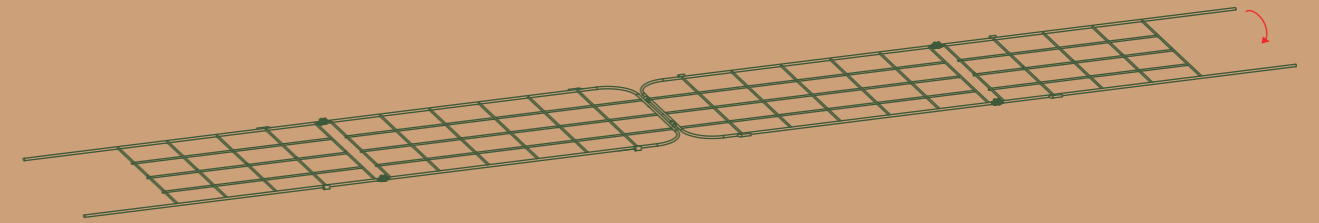

- 4** Lay the assembled A-frame trellis on its side as shown in the diagram. Insert the F1 R-shaped pin into the hole above the L-hook at the top to prevent the trellis from coming loose.

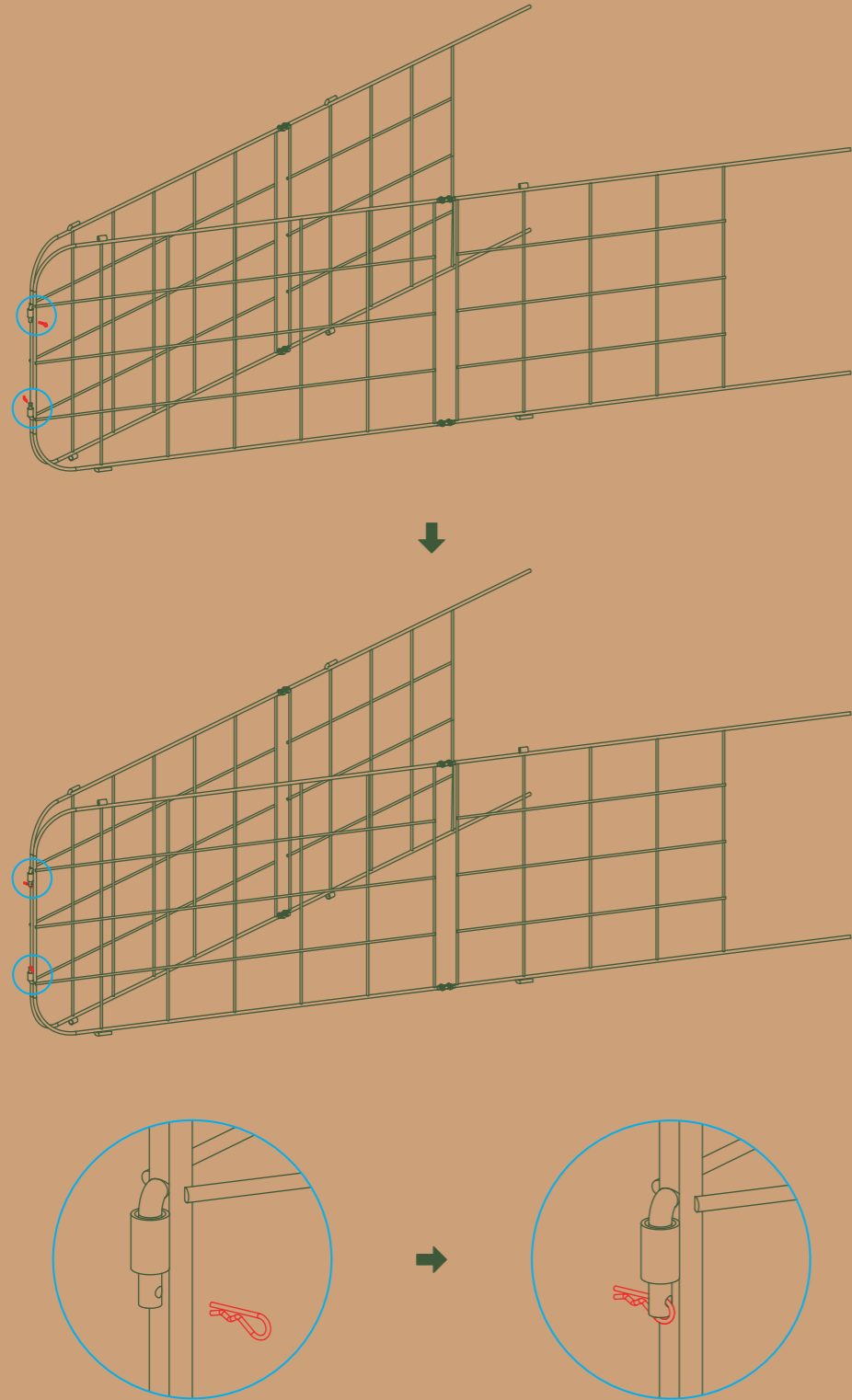

**Note:** Ensure F1 is fully inserted until the large ring is completely engaged with the pin.

- 5** For side-by-side installation, place two trellis units next to each other on the ground as shown in the diagram. Align the L-hooks with the sleeves between the trellises and insert them fully. Lift the entire assembly upright to complete installation.

