

ASSEMBLY INSTRUCTIONS

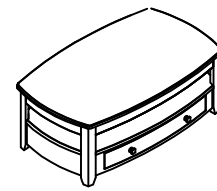

066-910

TOOLS REQUIRED:

Allen Wrench (Provided, Part D)
Spanner Wrench (Provided, Part G)

BEFORE YOU START:

PLEASE NOTE (IMPORTANT):
when you assembly this bottom shelf you must keep the drawer in the top opening opposite position

1. Check the hardwares against the hardware list to make sure all items are present.
2. Assemble your furniture on a soft, flat surface to avoid scratching the finish.
3. **CAUTION:** Do not over tighten screws, nuts or bolts during assembly.
4. Your furniture may require occasional tightening.

INSTRUCTIONS:

1. Turn the table on to a clean soft surface.
2. Assemble the legs to the bottom drawer box shelf using Bolt (C), Lock Washer (B), Flat Washer (A) and Allen Wrench (D). DO NOT FULLY TIGHTEN! As shown in Figure 1 .
3. Attach the dust proof panel to the bottom of drawer box frame using Screw (H). Install the Casters (E) into the bottom rail with Flat Washer (A), Spanner Wrench (G) As shown in Figure 2 .
4. Turn the table upright ,assemble Top to the legs using Bolt (C), Lock Washer(B), Flat Washer (A) and tighten all bolts using Allen Wrench (D), as shown in Figure 3 .
5. Cover the bolt's hole by Plastic cap (F) under the lift top.
6. Tighten all bolts before using the table.

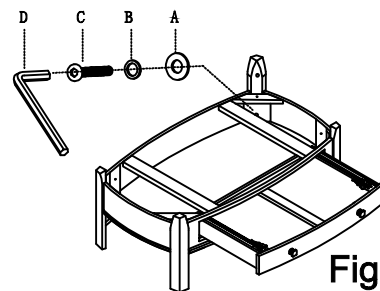

Figure 1

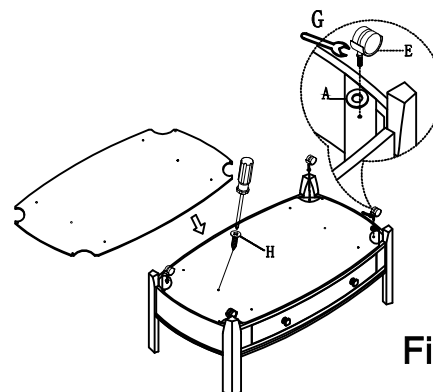

Figure 2

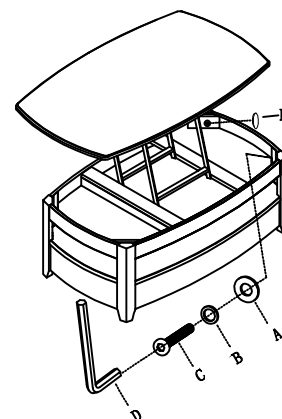

Figure 3

HARDWARE LIST			
A		Flat Washer (Ø5/16")	16pcs
B		Lock Washer (Ø5/16")	12pcs
C		Bolt (Ø5/16"x1-3/4")	12pcs
D		Allen Wrench	1pcs
E		Caster	4pcs
F		Cap	4pcs
G		Spanner Wrench	1pcs
H		Screw (#8*15")	10pcs