

Installation Guide

Tools Required

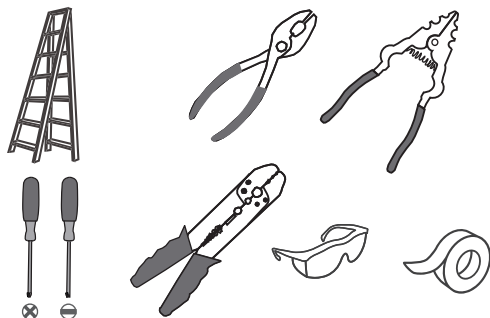

Light Source

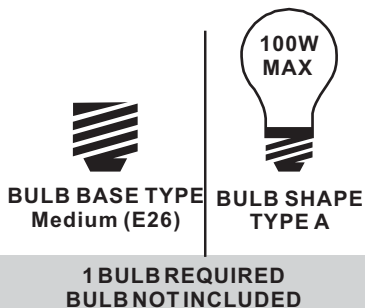

Fixture Height Adjustable 19" to 116.5"

⚠ Warnings and Cautions

Turn off the electricity at the circuit breaker before installation. Consult a licensed electrician if in doubt about installation.

Turn off power to the fixture and allow the bulbs to cool before replacing.

Package Contents

Preparation: Identify and inspect all parts before beginning the installation.

Missing or damaged parts? Contact your original place of purchase.

PARTS BAG

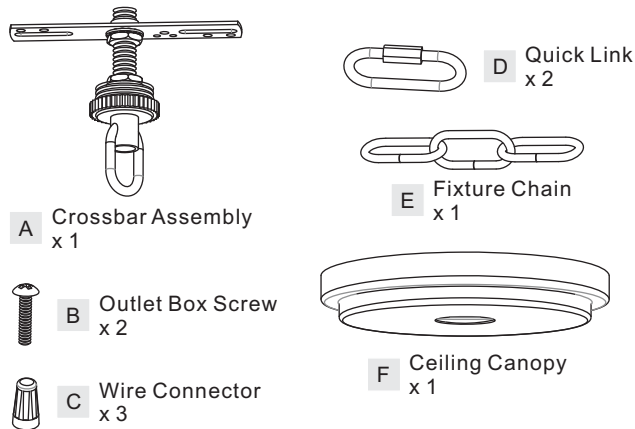

G Fixture Loop
x 1

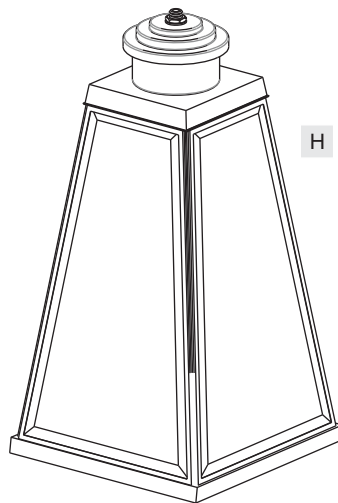

H Fixture Body
x 1

Table of Contents

Fixture Loop	Crossbar Assembly	Fixture Chain	Wiring	Ceiling Canopy	Bulb
STEP 1	STEP 2	STEP 3	STEP 4	STEP 5	STEP 6

STEP 1

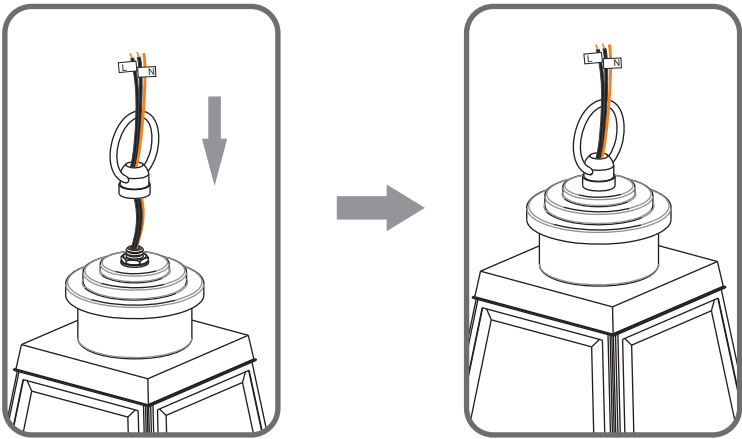

STEP 2

1

2

3

Step 1
Install crossbar assembly

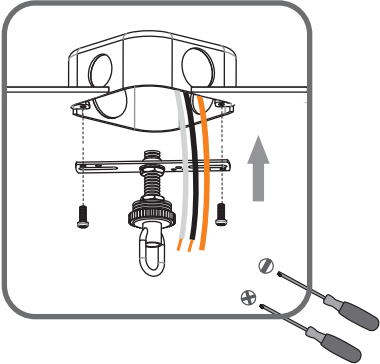

Step 2 - 3
Test fitting ceiling canopy to nipple

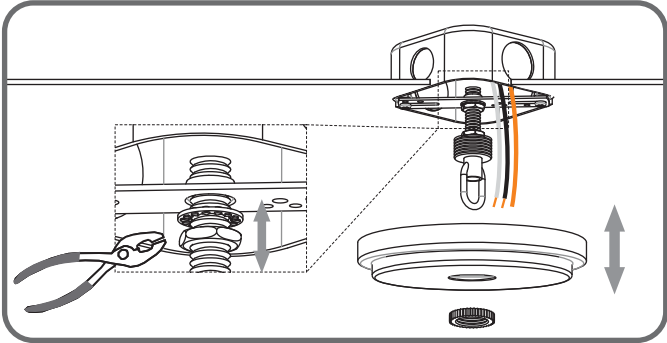
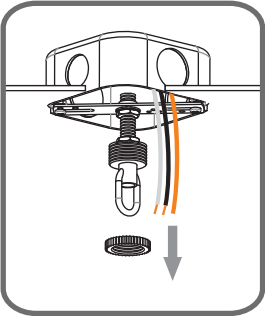

STEP 3

1

Step 1
Adjust fixture chain length

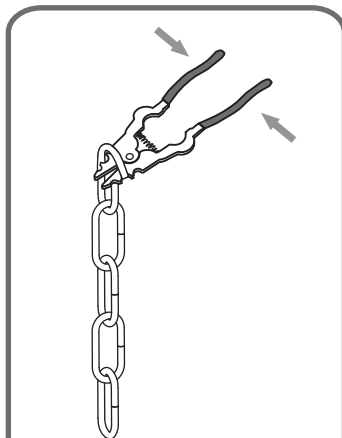

Suggested Chain Length:

8' ceiling: 10" Chain
9' ceiling: 22" Chain
10' ceiling: 32" Chain

2

Step 2 - 3
Install Fixture Chain

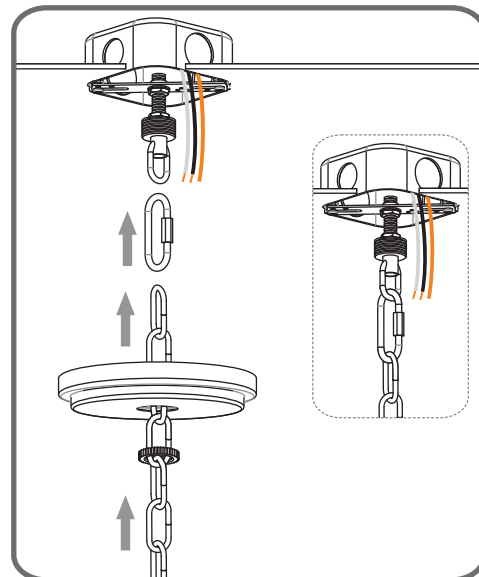
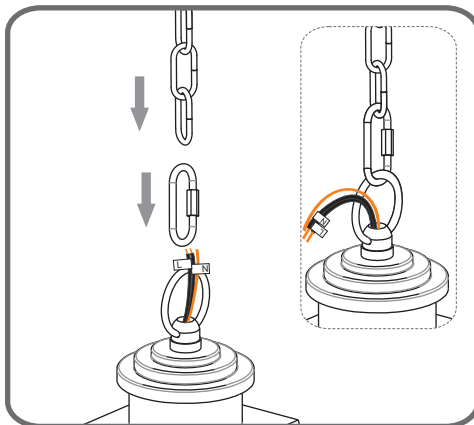

STEP 4

1

Step 1
Feed the fixture wires
through the loop

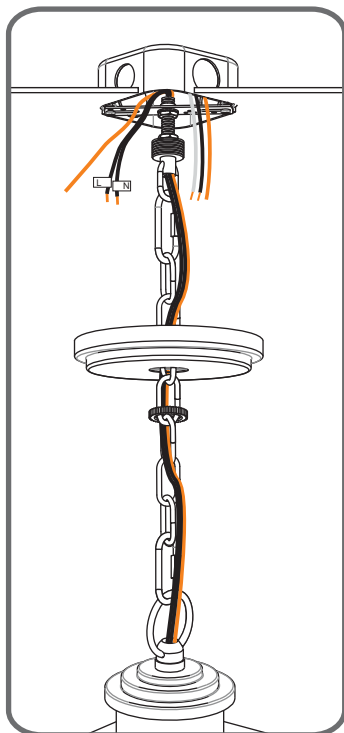

2

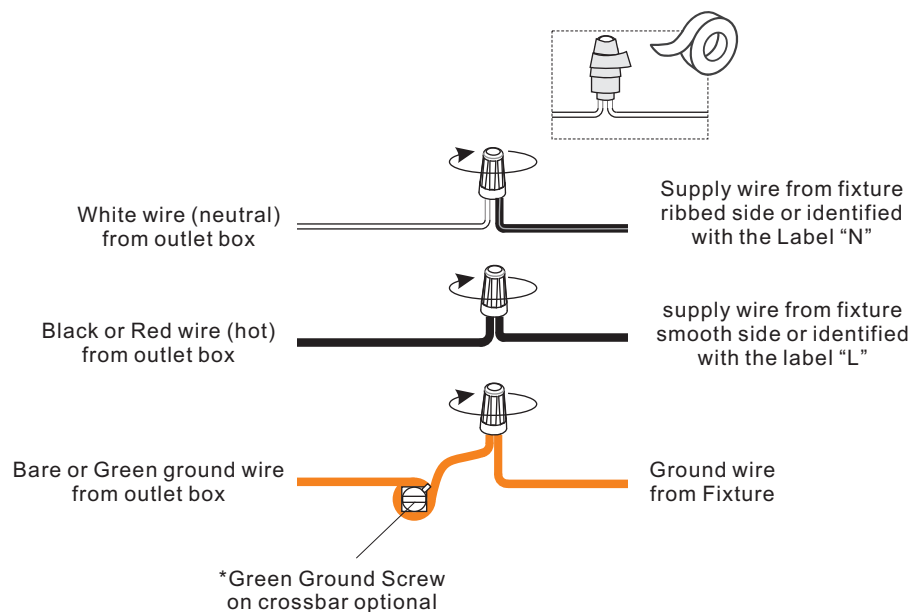

STEP 5

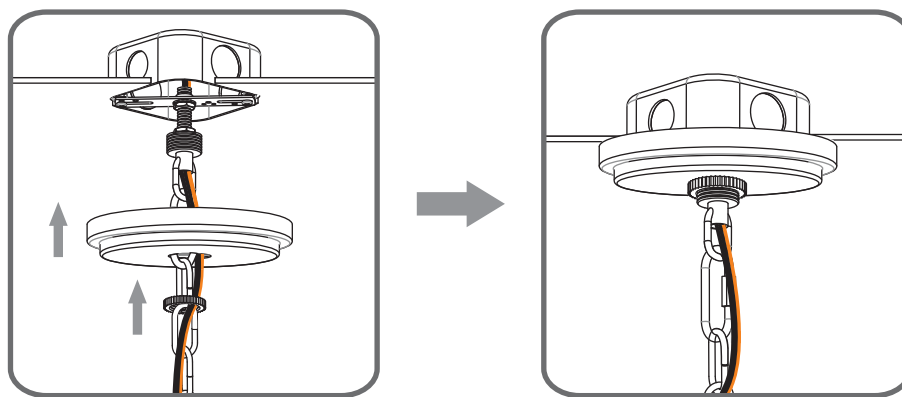

STEP 6

