

Full Bed

Assembly Instructions

WII-0619

1 Assembled View

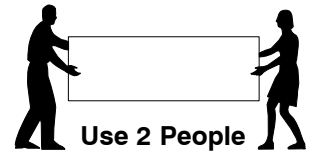
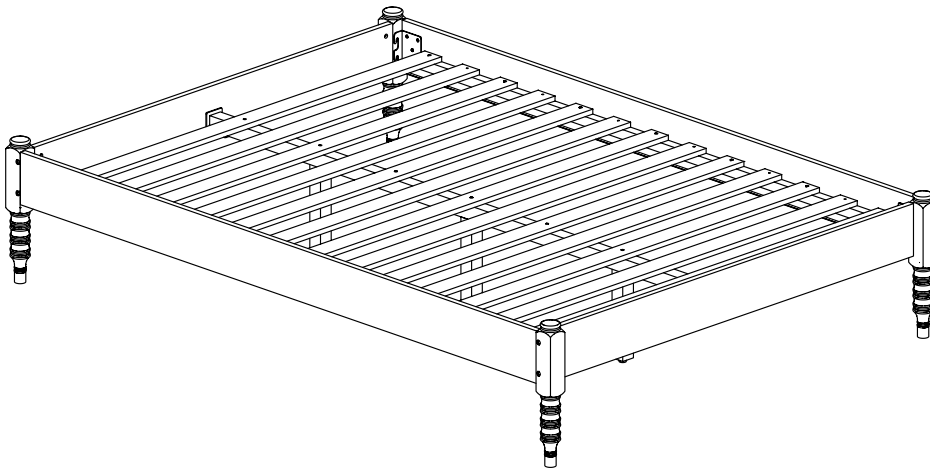

Note: Do not assemble using power tools. This can cause the bolts to be overtightened

2 Parts List

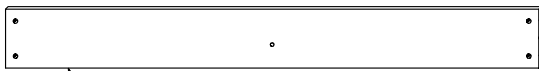

A Head / Footboard Panel x 2



B Side Rail x 2

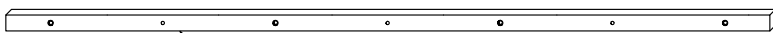

C Long Support x 1



D Support Leg x 3

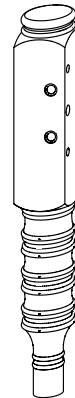

E Post (Left hand) x 2

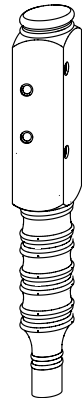

F Post (Right hand) x 2

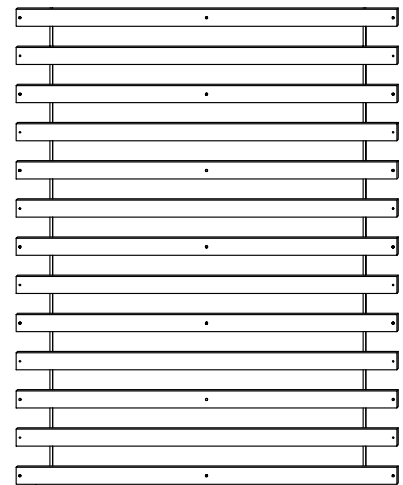

G Set of Bed Slats x 1

Full Bed

Assembly Instructions

W11-0619

3 Hardware List



1 M4 Allen Key
x 1

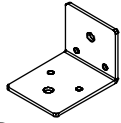

2 Center Rail
Bracket x 2

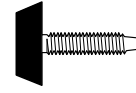

3 Adjustable
Foot x 3

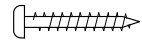

4 Wood Screw
(M4 x 32mm) x 12



5 Wood Dowel
(10 x 40mm) x 4



6 Barrel Nut
x 11



7 Spring Washer
x 8



8 Flat Washer
x 8



9 M6 x 15mm JCB
x 4



10 M6 x 20mm JCB
x 8



11 M6 x 40mm JCB
x 18



12 M6 x 90mm JCB
x 8



13 M6 x 100mm JCB
x 3

4 Fix the Adjustable foot to the bottom of the Support Leg (D).

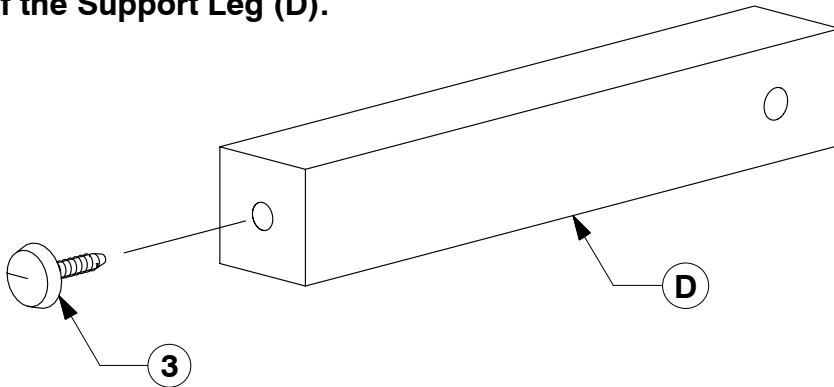

5 Assemble the Post (E & F) to the Head / Footboard Panel (A). Fit the Center Rail Bracket to the Head / Footboard Panel (A).

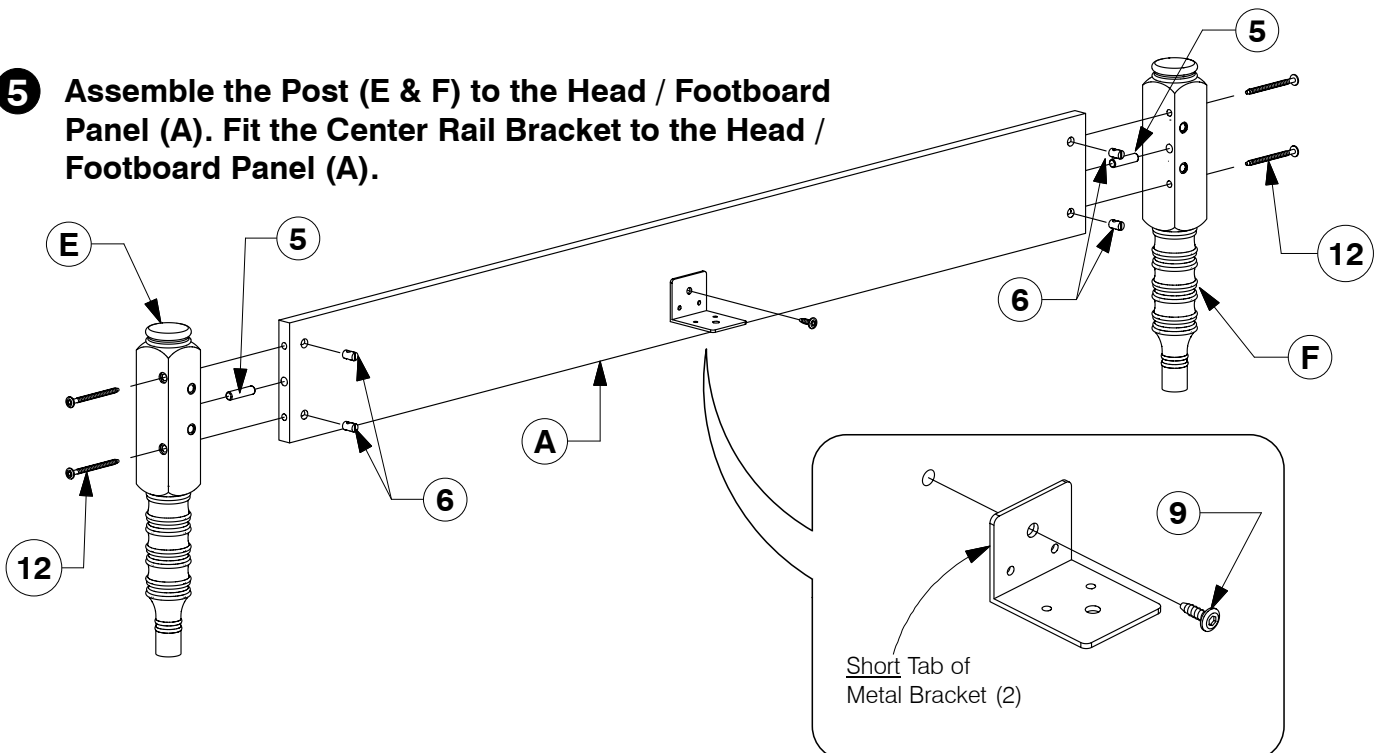

Full Bed

Assembly Instructions

W11-0619

- 6 Assemble the Side Rail (B) to the Headboard / Footboard Panel (A).**

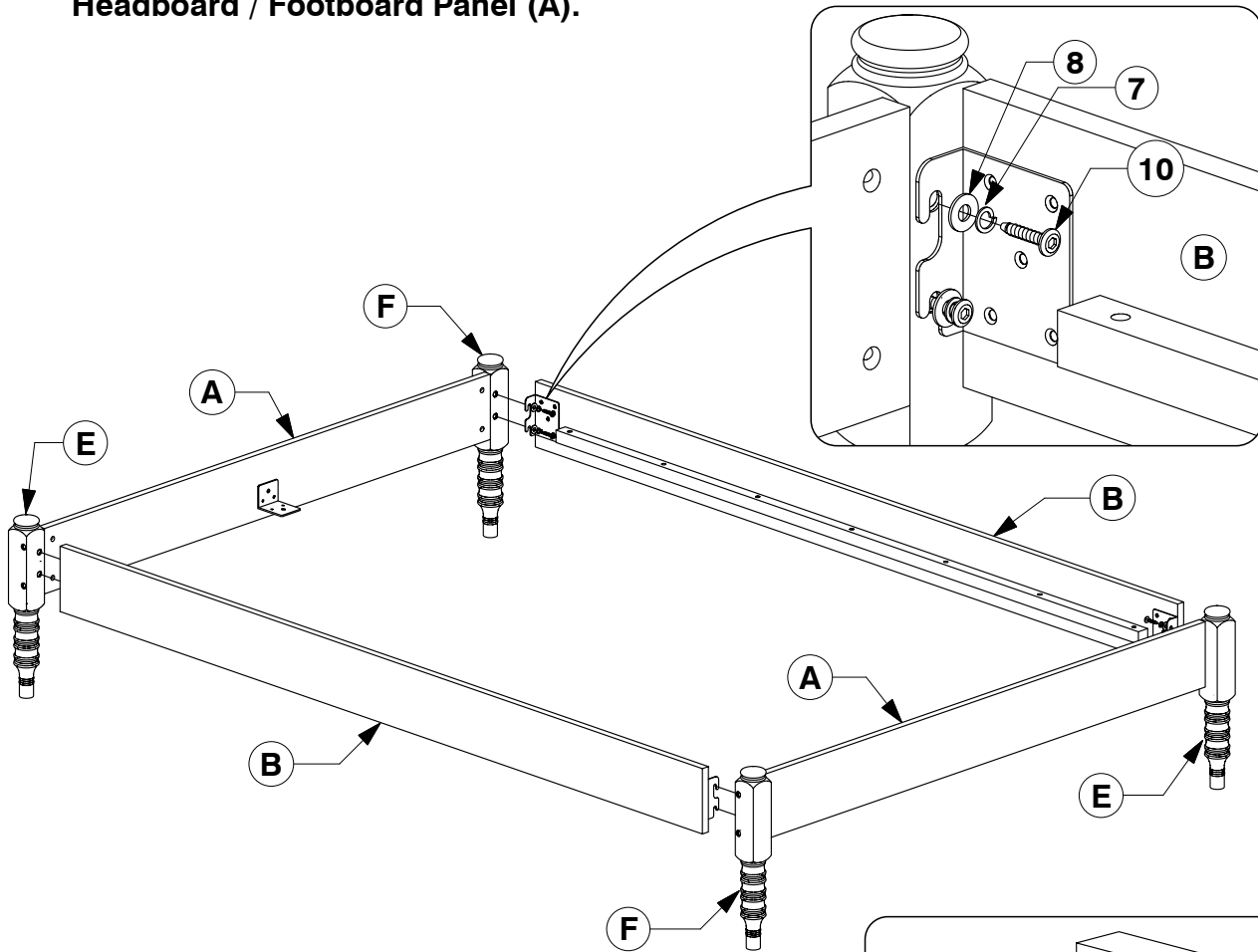

- 7 Bolt the Long Support (C) to the Center Rail Brackets (2) on the Headboard / Footboard Panel (A).**

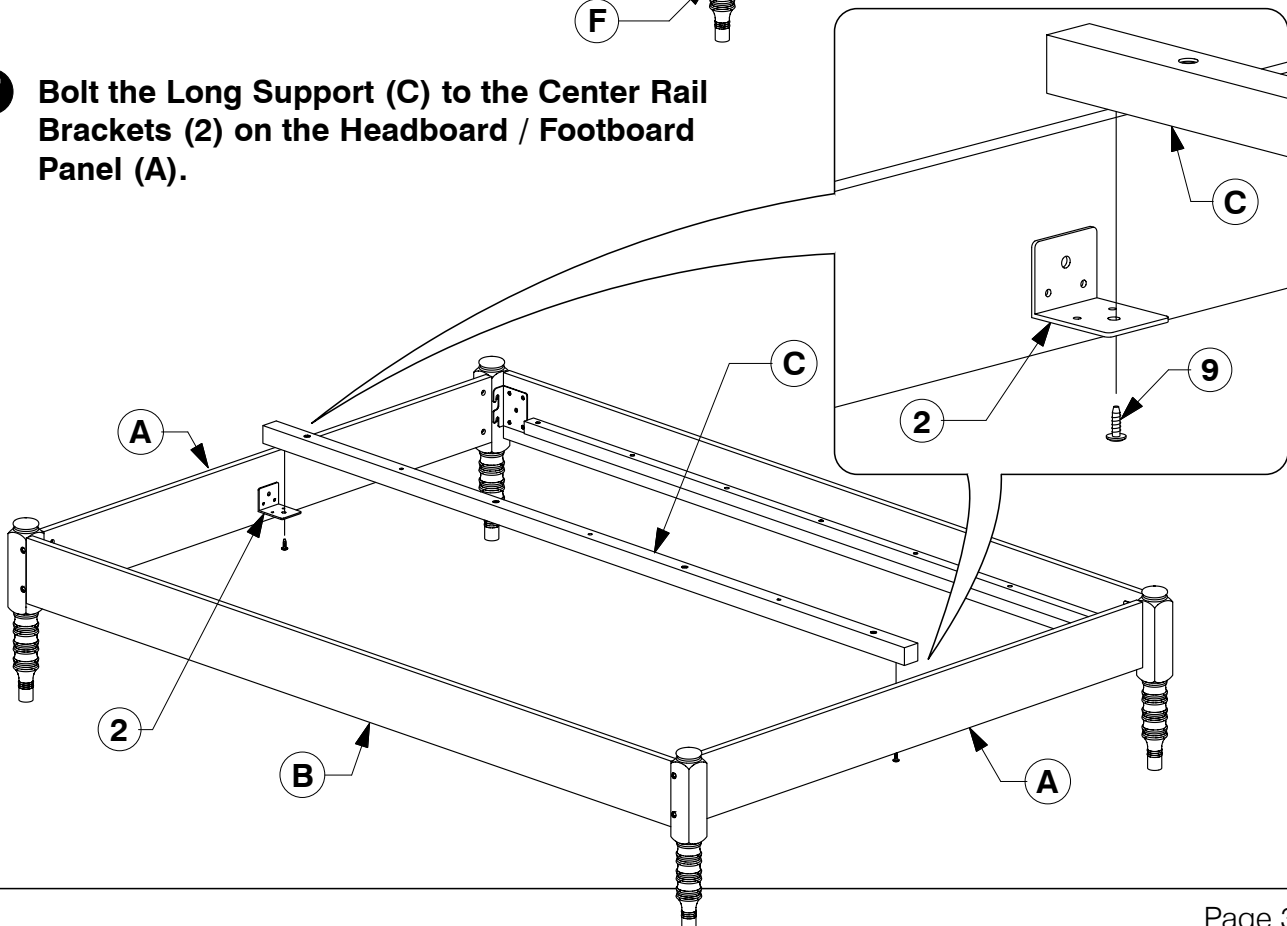

Full Bed

Assembly Instructions

W11-0619

- 8** Fit the first 3 Slats and assemble the Support Leg (D) to the Bed Slat (G). Bolt & screw the Bed Slats (G) to the Side Rail (B) & Long Support (C).

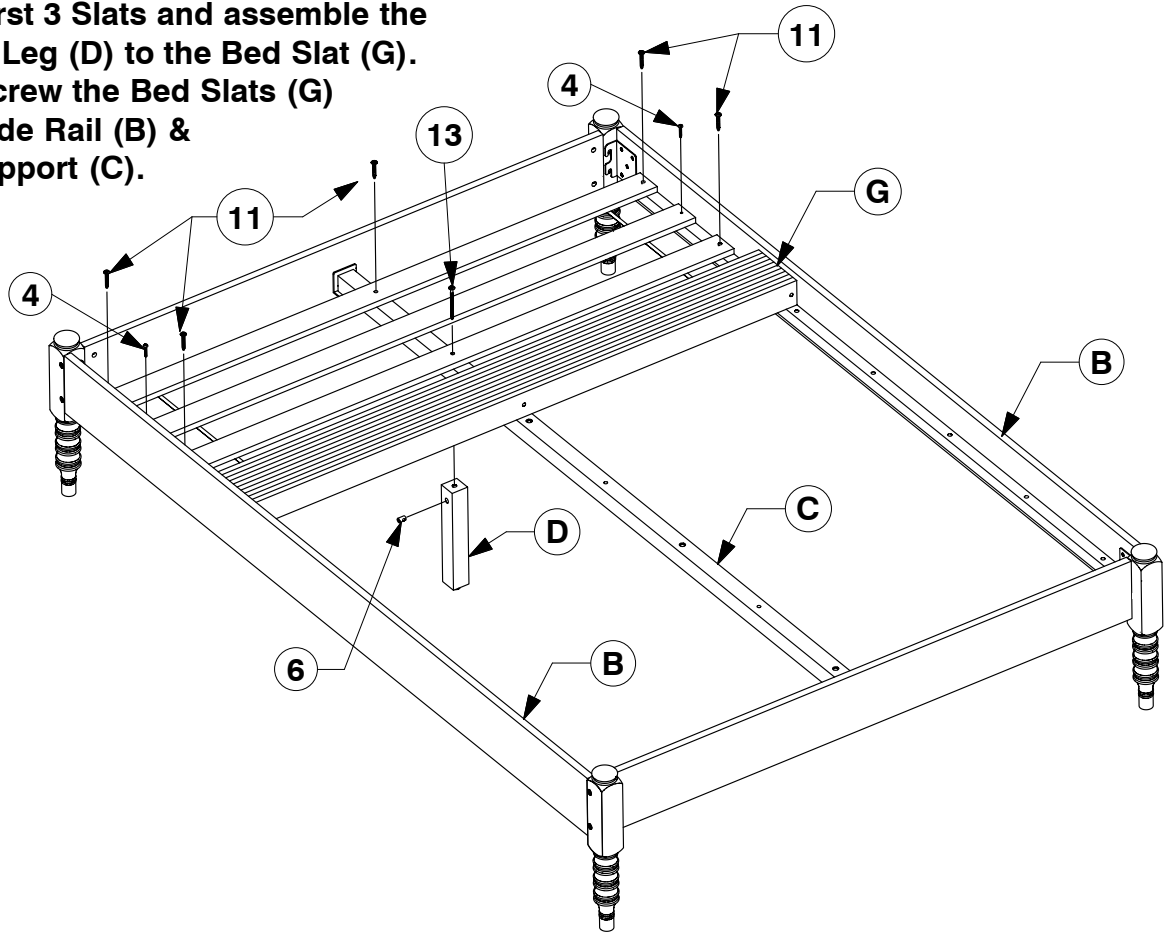

- 9** Fit the other Slats out and assemble the Support Leg (D) to the Bed Slat (G). Bolt & screw the Bed Slats (G) to the Side Rail (B) & Long Support (C).

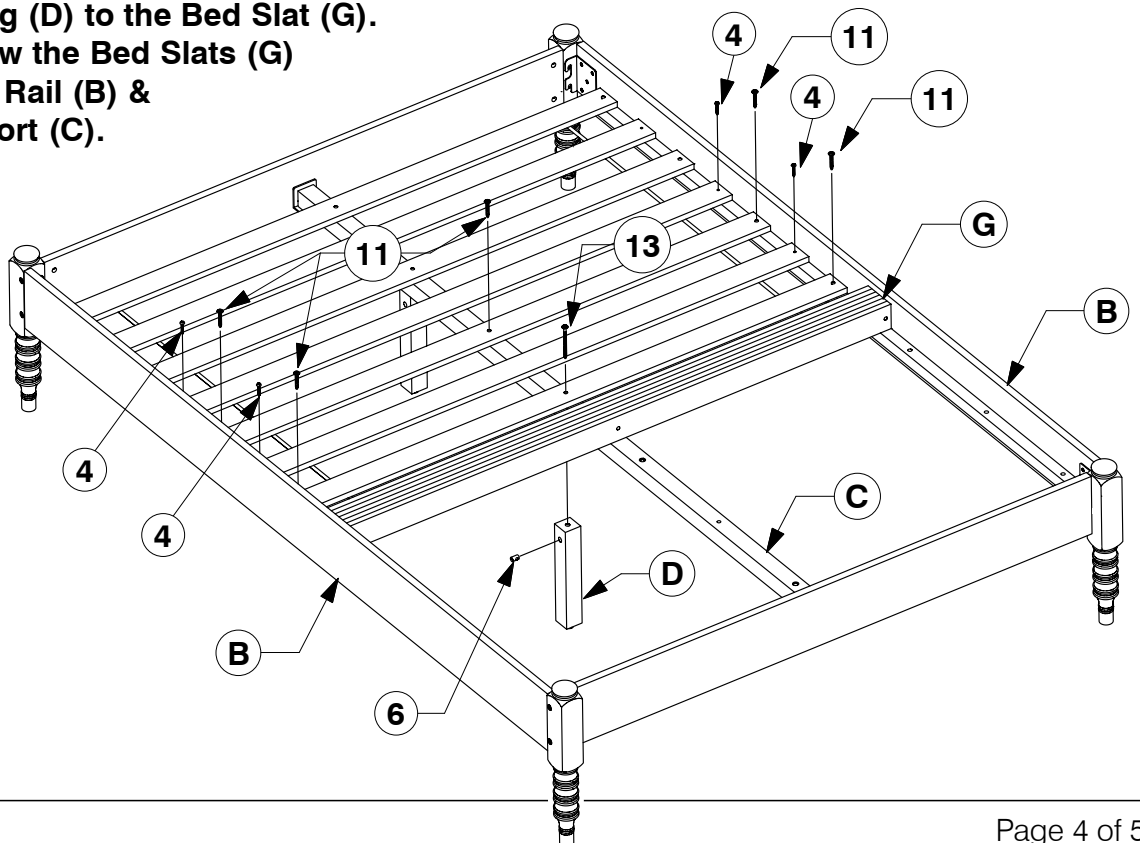

Full Bed

Assembly Instructions

W11-0619

- 10** Fit the other Slats out and assemble the Support Leg (D) to the Bed Slat (G). Bolt & screw the Bed Slats (G) to the Side Rail (B) & Long Support (C).

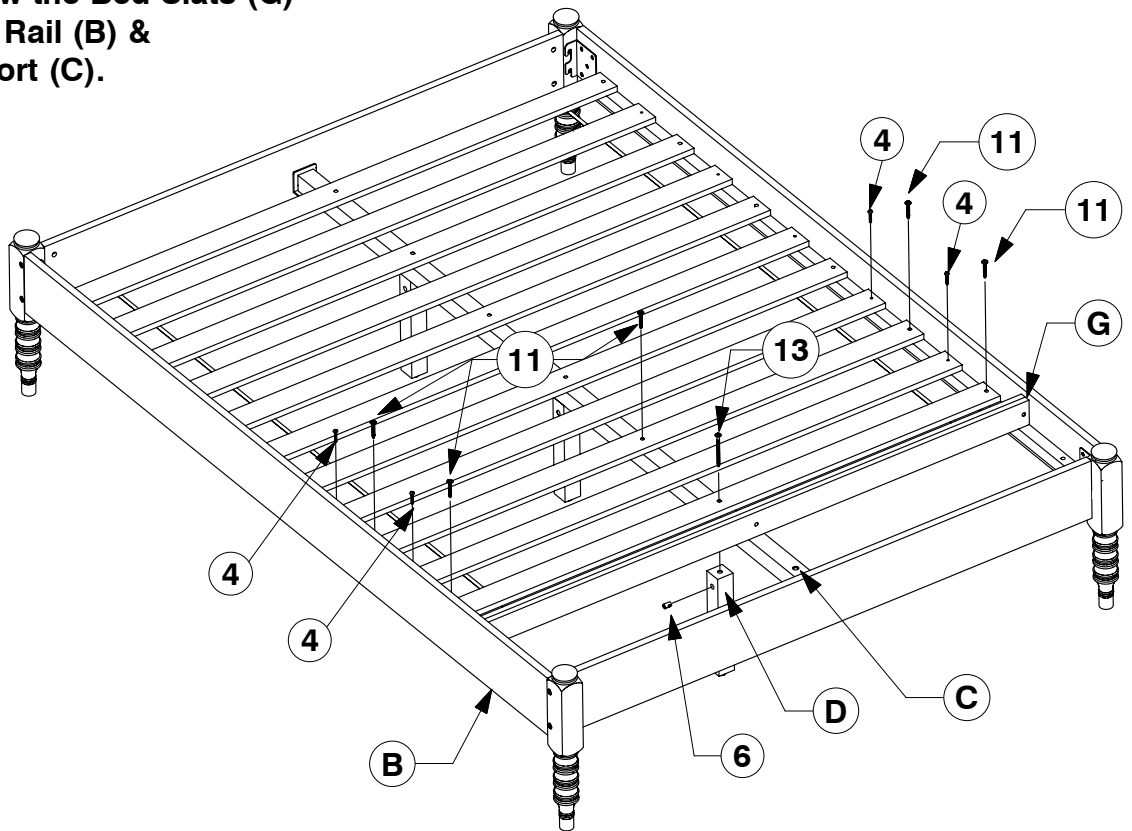

- 11** Bolt & screw the remaining Bed Slats (G) to the Side Rail (B).

