

Purolinear 360

purolinear™

assembly instructions

SONNEMAN®
A WAY OF LIGHT

Purolinear™ Product Information and Warnings

Important

- **Always disconnect the power before installing or replacing Luminaires and before cleaning or other maintenance.**
- **Consult a qualified, licensed electrician to ensure correct branch circuit conductor.**
Consulter un électricien qualifié pour vous assurer que les conducteurs de la dérivation sont adéquats.
- Please read all included assembly instructions and warnings carefully before installation. Contact Customer Service if you have any questions or concerns. Before installation, please confirm that the fixture is compatible with your supply voltage and dimming system, if present.
- LEDs are highly sensitive electronic devices, and must be treated with care. Do not open any factory sealed compartments, and avoid touching the LEDs with your hands or any object.
- Although all our fixtures are equipped with protective devices, LED electronic systems are vulnerable to power surges and supply variations. Do not install LED fixtures on the same circuit as any motors, appliances, or HVAC systems.
- Any mounting hardware is provided for your convenience and should be used with discretion. Always use the appropriate hardware for the mounting surface.

Welcome to Purolinear™

A Purolinear configuration is built from LED luminaires and connecting hubs. Illumination radiates from the luminaires, which can be rotated in their connectors to shine in any direction. The connectors form a structural and electrical connection between the luminaires, and can be configured in many different ways. Any connector can be used as a power input.

Connectors

Large 'X' Connector

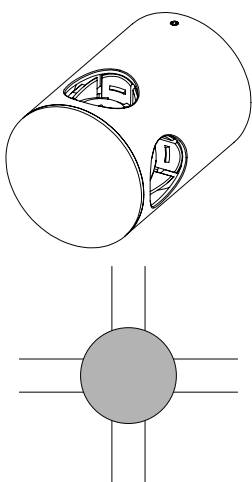

Large 'T' Connector

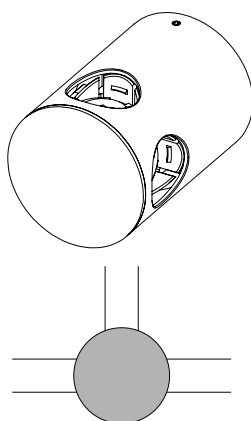

Corner Connector

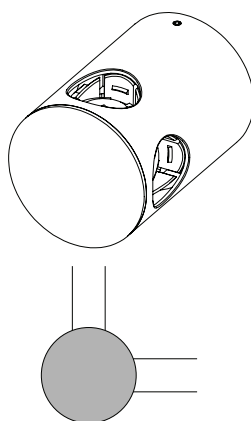

Large Linear Connector

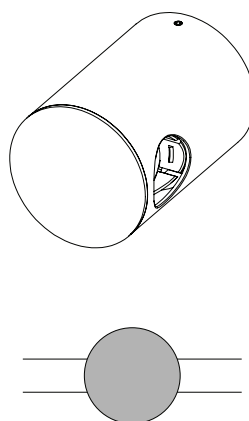

Large End Connector

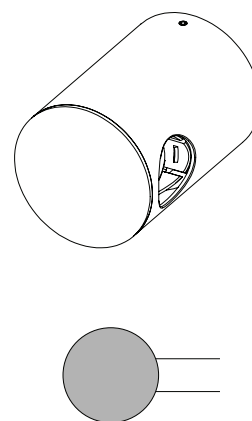

Small Linear Connector

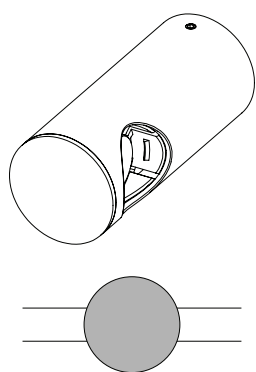

Small End Connector

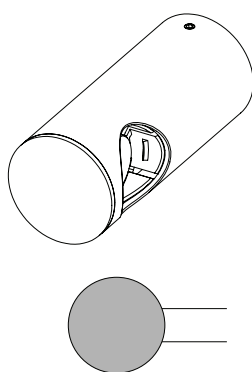

Small Linear Connector with Canopy

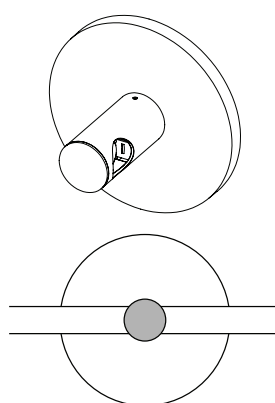

Small End Connector with Canopy

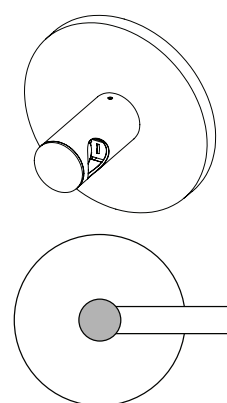

Small Hex Wrench (1)



Luminaires

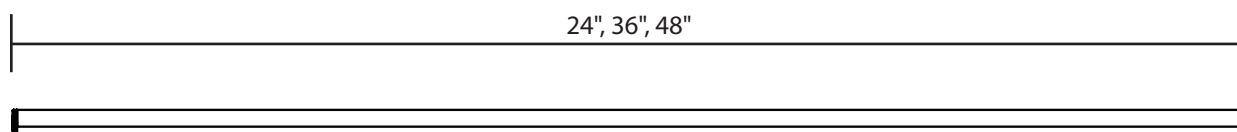

Luminaires

Power Limitations

- There must not be more than 8 ft of luminaire travel from power feed (X) in any direction (Fig. 1).

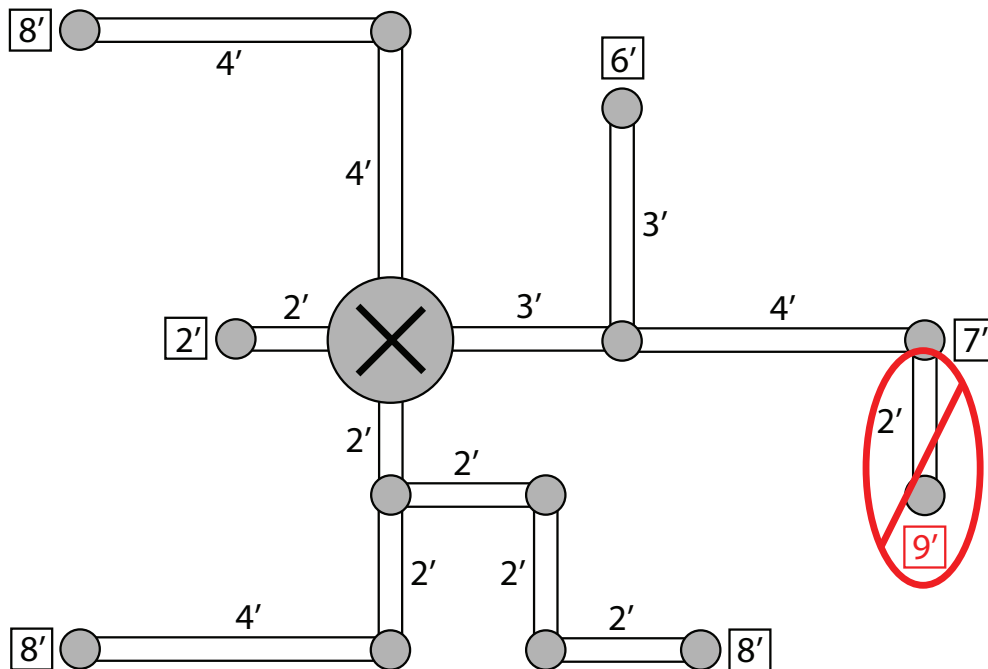

Fig. 1

- If more than 8 ft is used, place included stickers (A) on luminaire PCBs (B) (Fig. 2) to separate luminaires from different power feeds. Try to keep luminaire distances similar in length (e.g. two sets of 5 ft, rather than one of 2 ft and one of 8 ft) (Fig. 3).

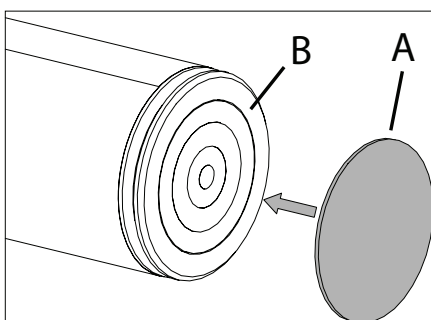

Fig. 2

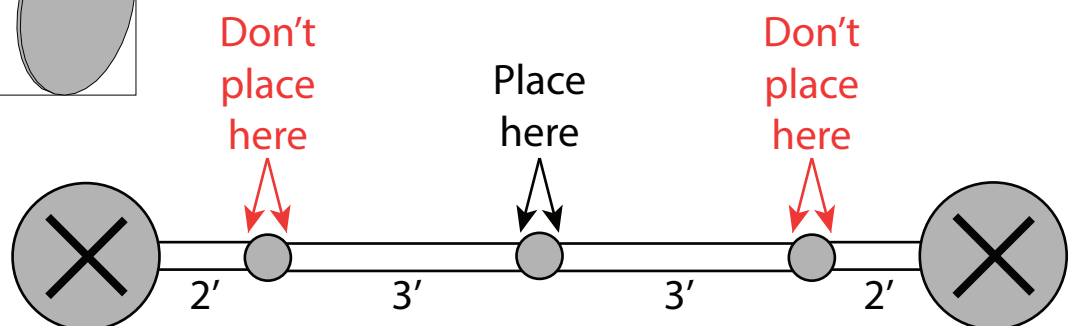

Fig. 3

Luminaire Installation

1. Turn off power.
2. Install any powered connectors and canopies being used as instructed on pages 6 and 7.
3. Using the luminaires as a guide, mark locations of other connectors on the wall or ceiling and install anchors as instructed on page 6. Loosen set screws and remove connectors from anchors.
4. Starting at a power feed (A), place one tip of the luminaire in the slot of the feed and the other in the connector (B) so that it is lined up with its wall anchor (C) (Fig. 4).
5. Carefully pivot luminaire into both slots in connectors while moving the B connector straight down until it is in position on the anchor.
If connector and anchor do not align properly, the anchor can be adjusted slightly by loosening the anchor screw, moving the connector to the correct position, and tightening the screw again.
6. Tighten set screws.
7. Repeat Steps 3-6 for all remaining luminaires. If multiple power feeds are used, the connector they share (D) will need to be installed with luminaires from both feeds simultaneously (Fig. 5).
8. Note: Luminaires can be rotated about their axis to any angle.

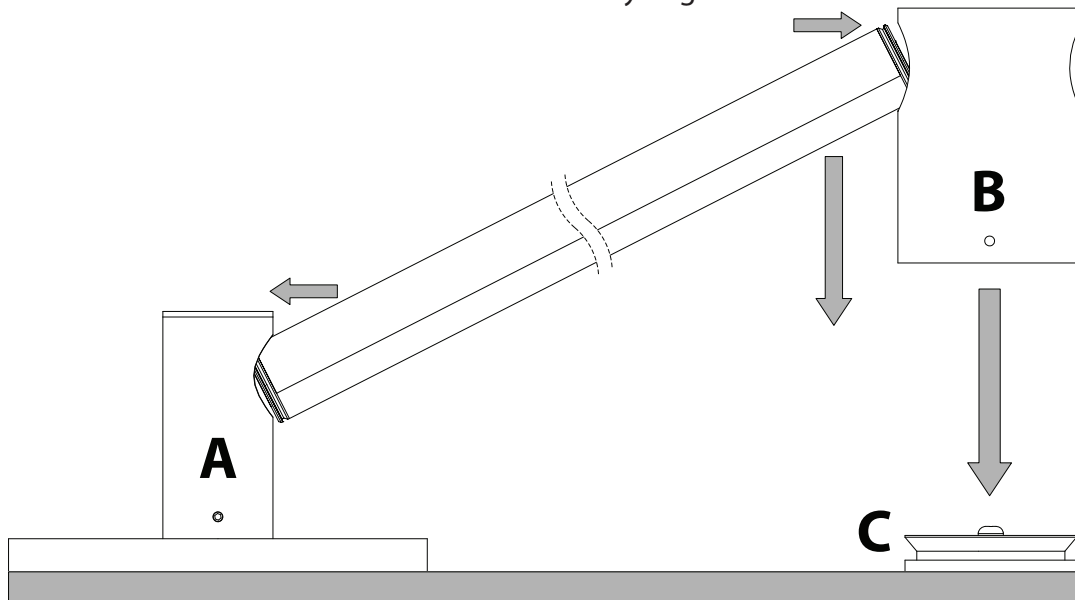

Fig. 4

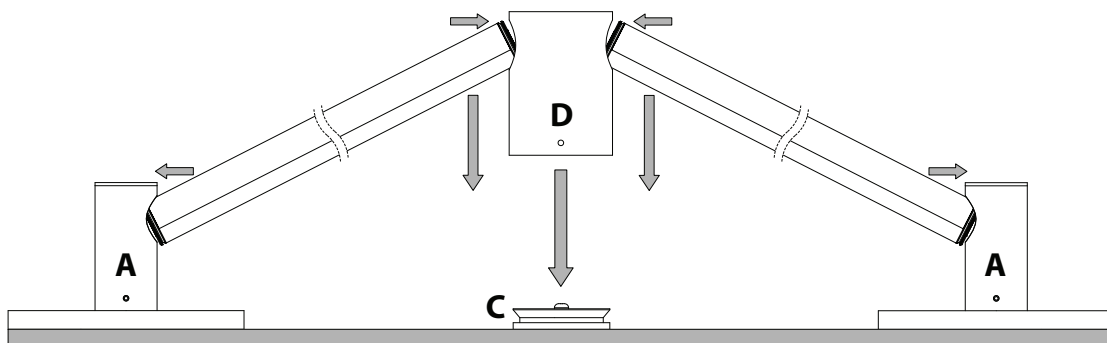
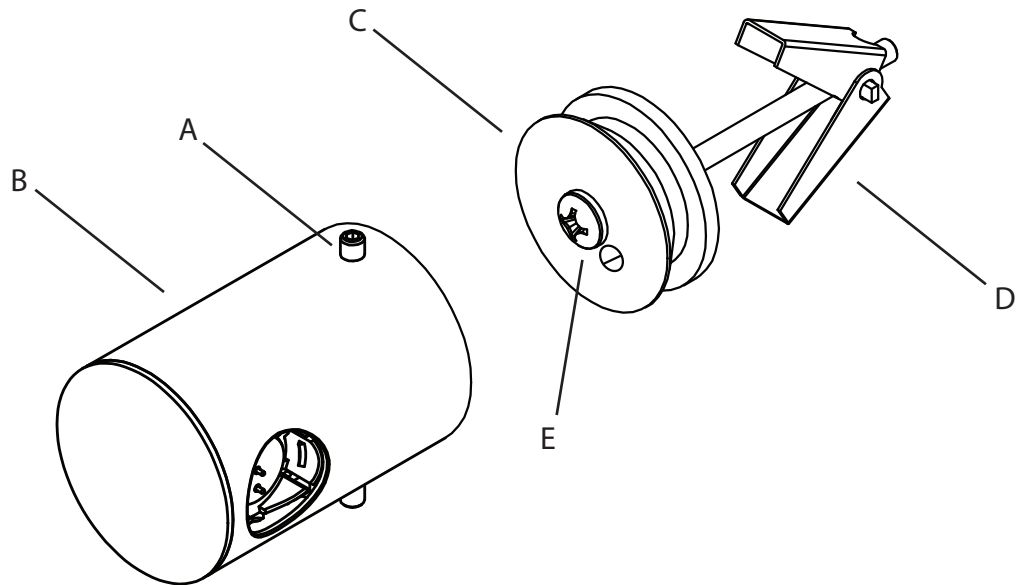

Fig. 5

Installing Unpowered Connector - Shown with End Connector

1. Drill a $\frac{3}{4}$ " hole where the connector is to be installed.
2. Using hex wrench, loosen set screws (A) and remove connector (B) from anchor (C).
3. Insert toggle anchor (D) through hole in wall and tighten screw (E) until it is secured in place.
4. Place connector back on anchor and retighten set screws to secure.



Installing Powered Connector - Shown with End Connector

1. Shut off power.
2. Drill a $\frac{3}{4}$ " hole where the connector is to be installed.
3. Using hex wrench, loosen set screws (A) and remove connector (B) from anchor (C) and pull wires (F) through hole in anchor. Make sure to use the off-center hole (H).
4. Connect low voltage wires to fixture wires using wire nuts (G) and push connections through hole in wall.
5. Insert toggle anchor (D) through hole in wall and tighten screw (E) until it is secured in place, making sure not to pinch the wires.
6. Place connector back on anchor and retighten set screws.
7. Restore power.

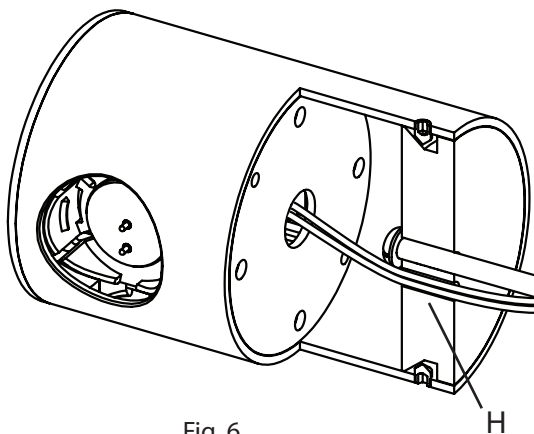

Fig. 6

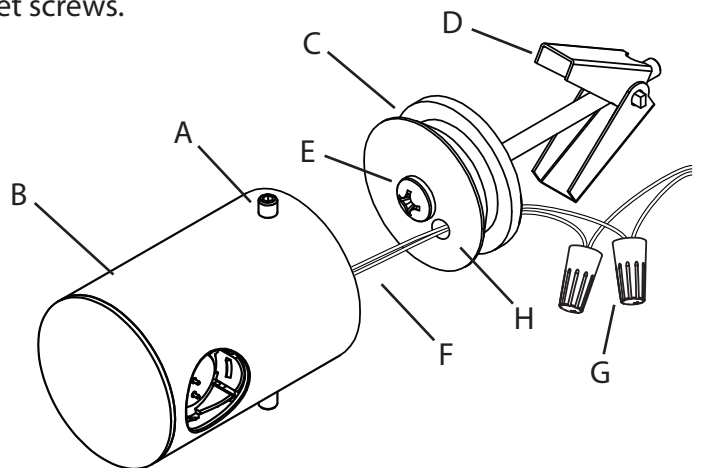

Fig. 7

Installing Canopy - Shown with End Connector

1. Shut off power to outlet box.
2. Screw cross bar (A) to outlet box using outlet box screws (B).
3. Bring the low voltage wires through the canopy and cross bar and make connections using wire nuts (C). These connections should be in the canopy, as shown.
4. Using hex wrench, loosen set screws (D) and remove connector (E) from anchor (F).
5. Screw canopy nipple (G) into hole in cross bar (H), being careful not to twist the wires.
6. Place connector back on anchor and retighten set screws.
7. Restore power to outlet box.

