

ASSEMBLY INSTRUCTION
ITEM NO. N760P237958

CONSOLE TABLE

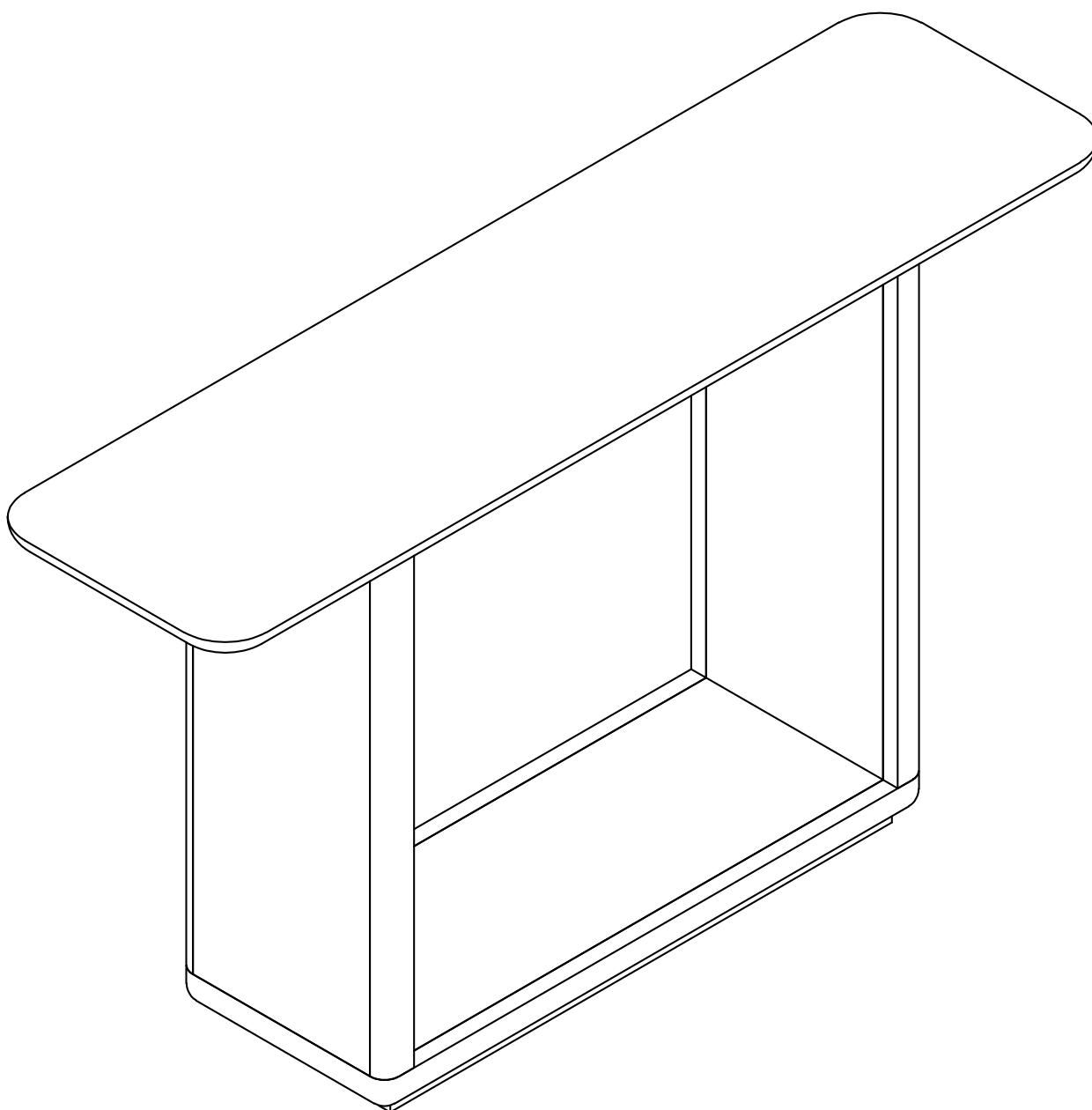

ASSEMBLY INSTRUCTION

ITEM NO. N760P237958

Please read these instructions fully before starting assembly:

1. Place all wooden parts on a clean and smooth surface such as a rug or carpet to avoid scratching the parts.
2. Kindly follow the assembly instructions step by step.
3. Do not tighten all screws and bolts until the table is fully assembled.
4. Unscrew the protective plastique supports from the metal insert of the table legs before assembly.
5. Parts of the assembly will be easier with 2 people.

Care and maintenance:

Only clean using a damp cloth and mild detergent, do not use bleach or abrasive cleaners.

ASSEMBLY INSTRUCTION

ITEM NO. N760P237958

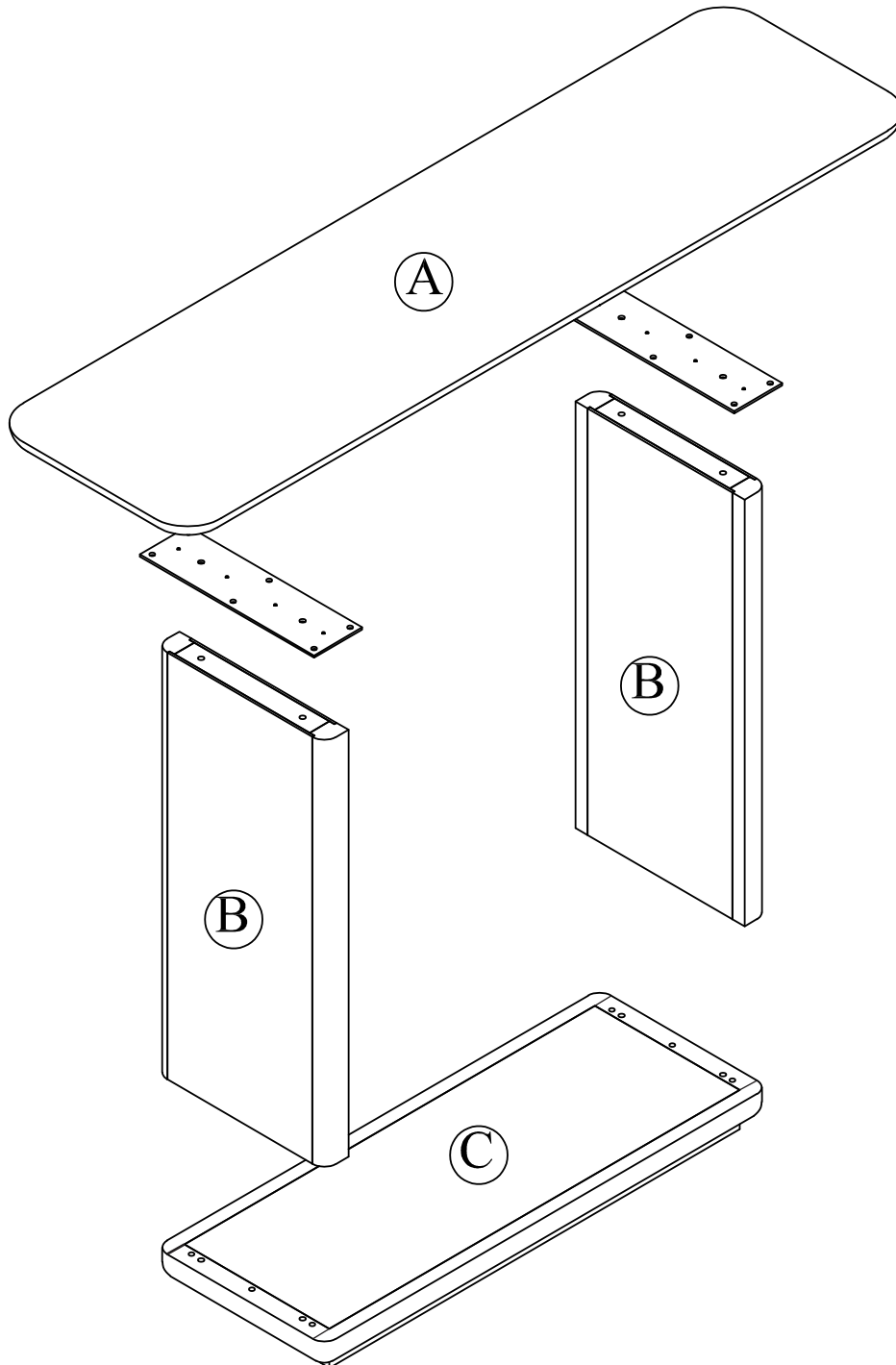

ASSEMBLY INSTRUCTION

ITEM NO. N760P237958

Part List

Ⓐ

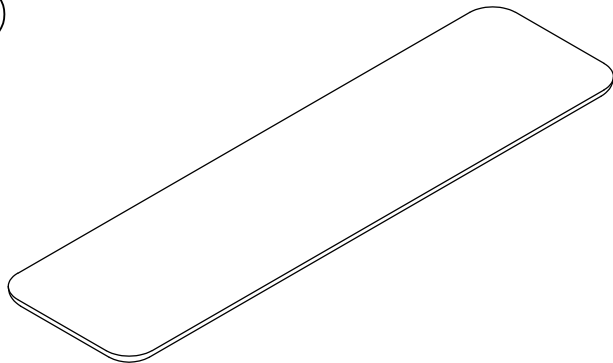

TOP = 1PC

Ⓑ

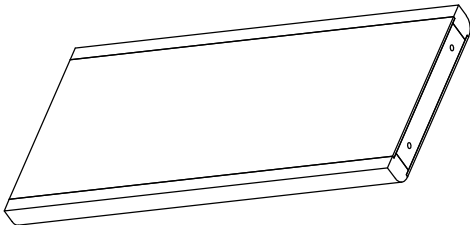

LEGS = 2PCS

Ⓒ

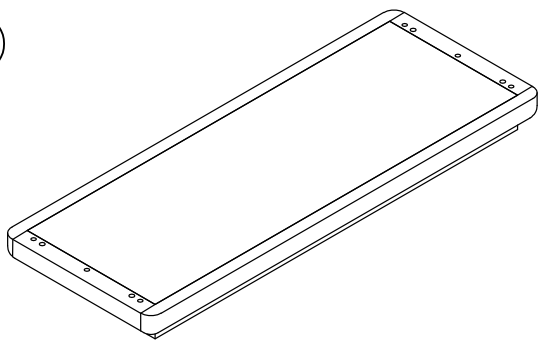

BOTTOM = 1PC

ASSEMBLY INSTRUCTION

ITEM NO. N760P237958

Hardware List

①

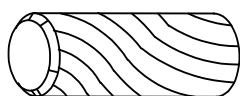

Wooden Dowel 10 x 30 =8pcs

②

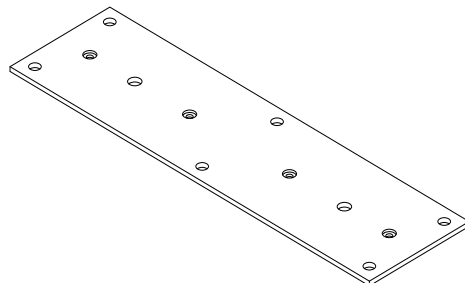

Support Legs 4x100 x 360 =2pcs

③

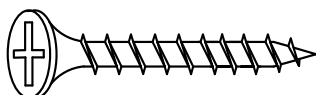

Wood screw Ø4 x 45mm =8pcs

④

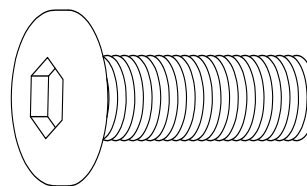

Short Bolt 1/4 x 25mm =12pcs

⑤

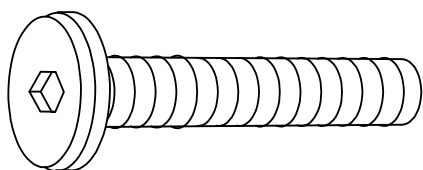

Long Bolt 1/4 x 60mm =6 pcs

⑥

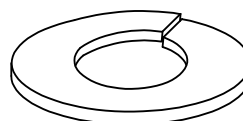

Spring Washer 1/4 x 12 mm =6pcs

⑦



Flat Washer 1/4 x 12 mm =6pcs

⑧



Allen Key K4 =1pc

ASSEMBLY INSTRUCTION

ITEM NO. N760P237958

Step 1

Now, attach the Support Legs (2) to Legs (B),

Align hole with Wooden Dowels (1)

Note. when attach the metal support to legs of Table, It is always have the face with the sarla drill hole facing upwards to attach the screws.

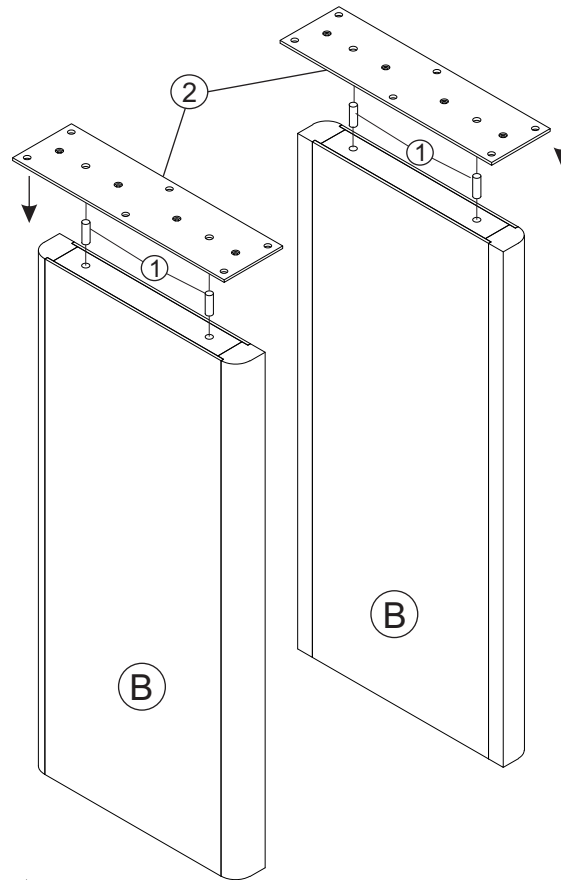

Wooden Dowel	Support Legs
Ø 10 x 30	
① x 4	② x 2

Step 2

Next, Use the wooden screw Ø 4 x 45 (3) to Tighten to 100% by Hand or Drill

Note: When bolting is always flat, do not tilt the screw head.

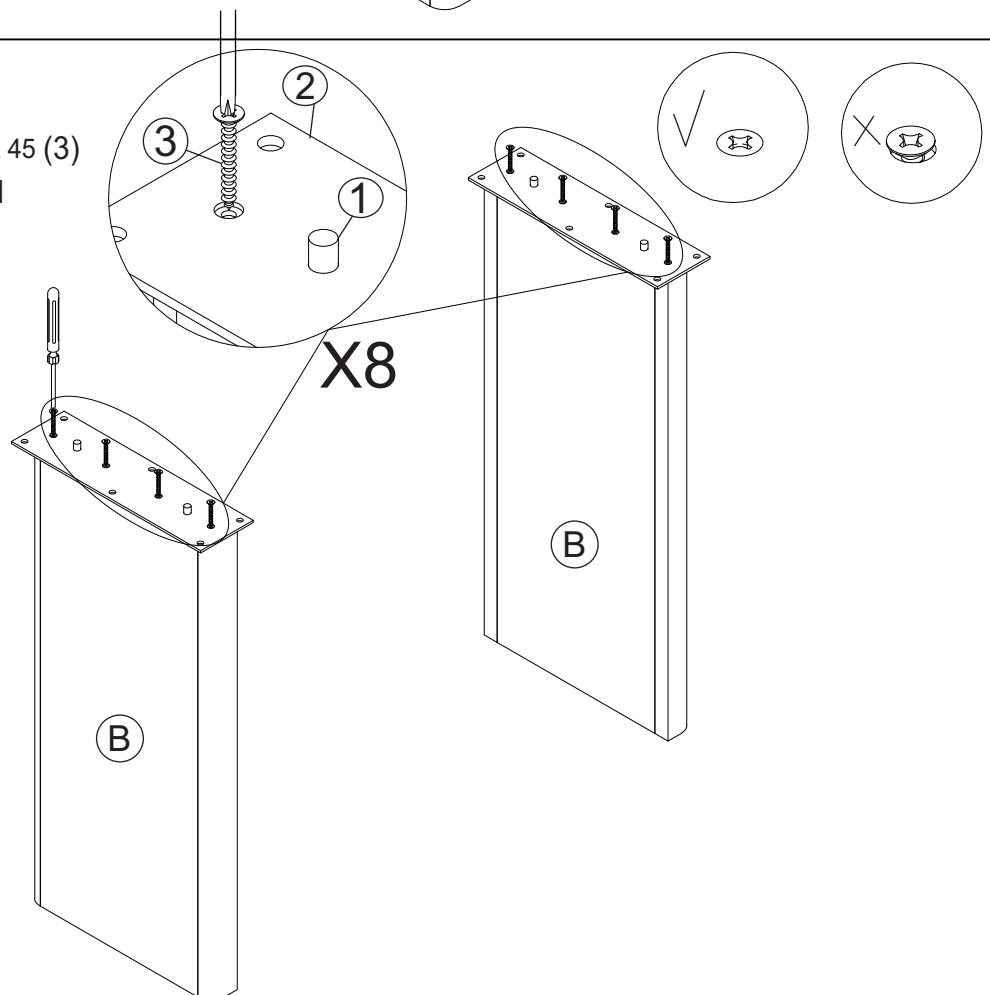

Wood screw
Ø 4 x 45



③ x 8

ASSEMBLY INSTRUCTION

ITEM NO. N760P237958

Step 3

Now, attach the Legs (B) to the Table Top (A), align hole with Wooden Dowels (1) use the Short Bolt (4) 1/4" x 25mm and Do not overtighten hardware. Tighten to 75% for now.

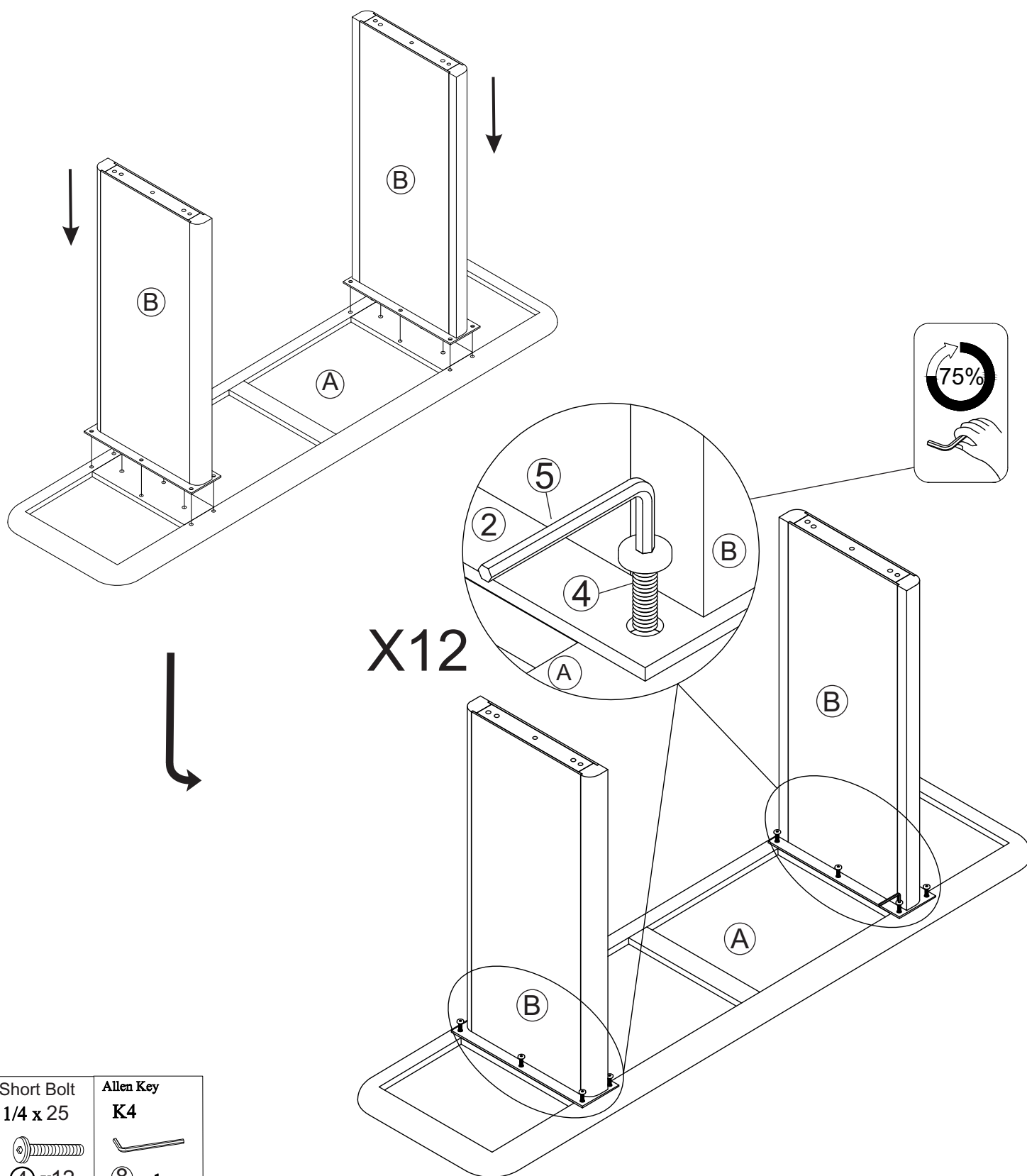

ASSEMBLY INSTRUCTION

ITEM NO. N760P237958

Step 4

Now, attach the Bottom (C) to Legs (B), align hole with Wooden Dowels (1) use the Long Bolt (5) 1/4" x 60mm. Insert the Flat Washers (6) and Lock Washers (7) to the Bolts (5) before assembling secure the all part in place and tighten to 100% using the Allen Key (8)

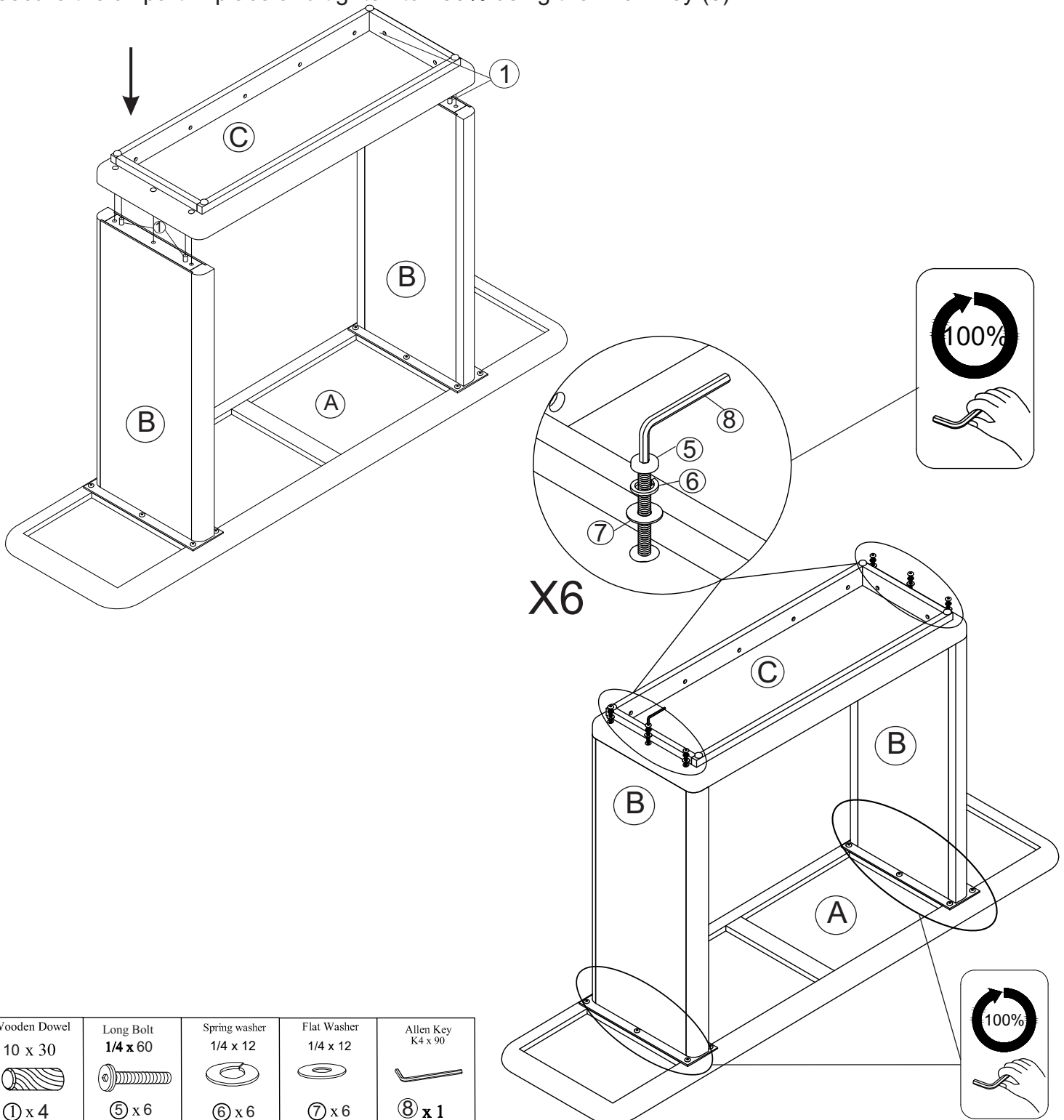

ASSEMBLY INSTRUCTION

ITEM NO. N760P237958

Once tightened, carefully flip the unit over so it's upright.
Time to enjoy your new Console Table.

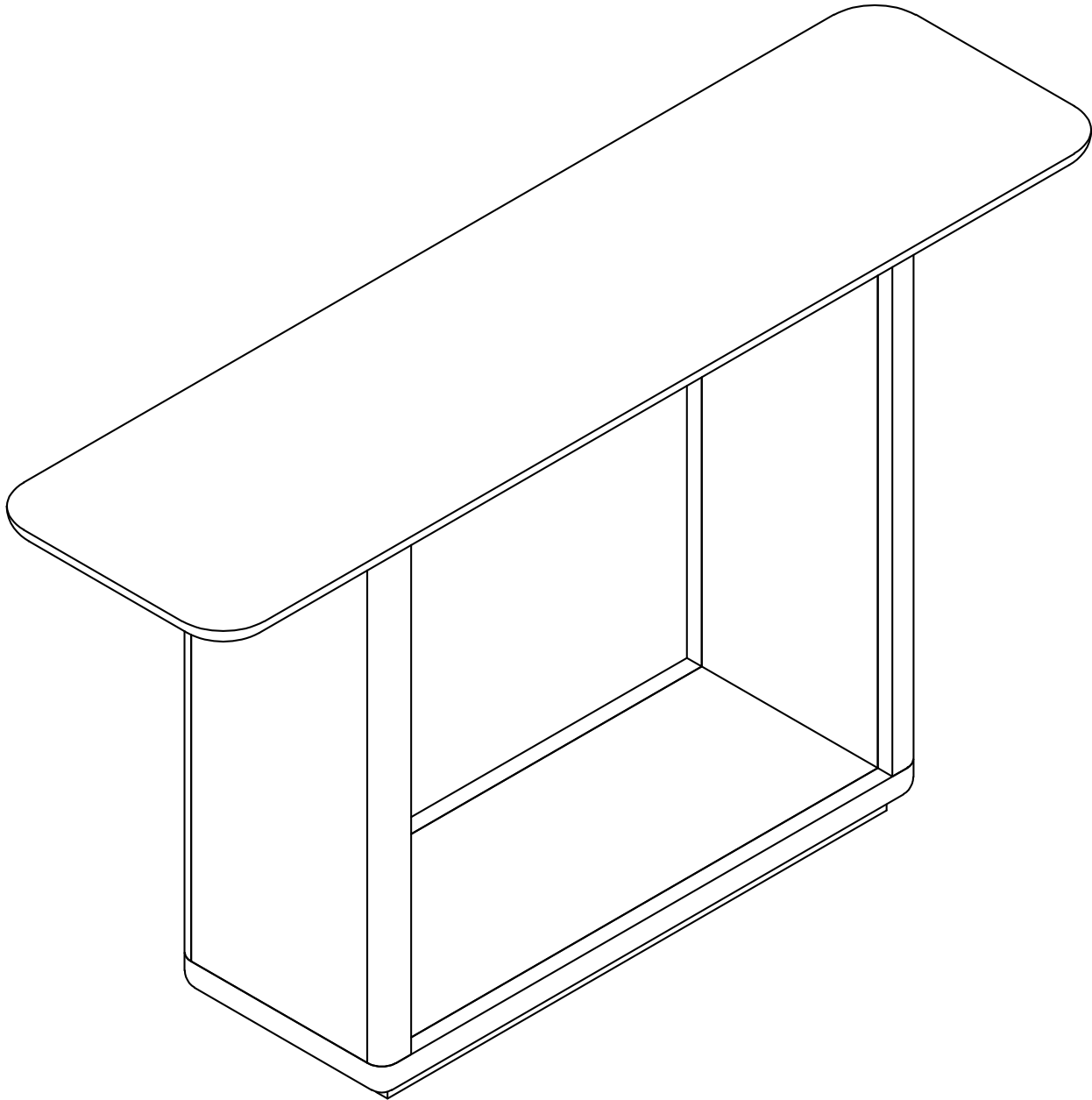

Finished