

Instructions for doors with 1-1/2" (38mm) holes

1. Temporarily insert latch bolt.

If your latch bolt cannot be inserted all the way to the end, you need to extend the latch hole. Follow the instruction in Step 2. If the latch bolt sits properly, skip to Step 3.



2. (OPTIONAL): If you do not need to extend the latch hole, goto Step 3.

For a 1-1/2" (38 mm) bore hole, use a 1" (25.4 mm) Drill Bit to extend the latch hole at least 13/64" (5 mm) deep. No need to extend the latch hole for a 2-1/8" (54 mm) bore hole.

After extending the latch hole, insert the Latch Bolt again to ensure it fits correctly.

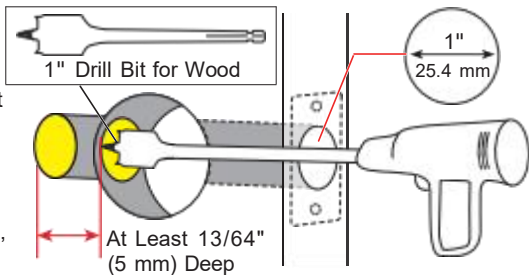

3. Test latch bolt operation.

Install the Latch Bolt and rotate it with a screwdriver to confirm smooth rotation.

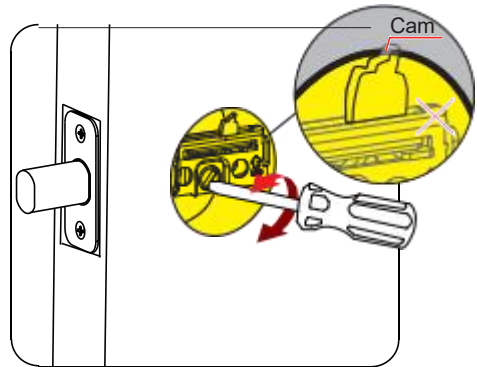

4. (OPTIONAL): If the latch bolt operation is smooth, skip to nextstep.

If it cannot rotate smoothly because the door hole is too small.

Remove the Latch Bolt and chisel out a small channel at the top of the hole to give the cam of the Latch Bolt room to rotate.

