

## Round Sphere LED Fountain



**Have Questions or Issues? Need help with assembly?**

**Contact us and we will resolve immediately.**

# Warranty

## **Manufacturer warranty covers:**

- Parts that are deemed defective within 30 days will be shipped free of charge, within the 48 contiguous states.
- Any warranty claim after 30 days, will require shipping to be paid by the customer.

Any visible damage due to the neglect, misuse, or abuse will void the limited warranty of the product.

## What is included



A. Fountain Top



B. Fountain Bottom



C. Hose



D. Cap



E. Auto Shut-Off Pump



F. LED Lights

# Assembly instructions

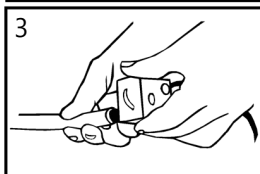
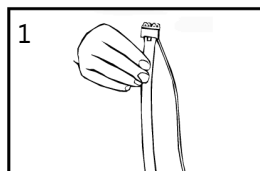

1. Attach the LED cord to the hose and place it on the fountain top.
2. Pass the pump's long connection through the fountain pipe, securing it with the connector.
3. Combine the cords of the LED and pump, then connect the hose to the pump.
4. Connect the long pump cord and the adapter and fill the fountain with water.

Make sure the pump is fully submerged in water. The LED lights can be turned off if preferred. Just disconnect them from the pump and cap the connections.

---