

# PROFESSIONAL IONIC STAND BONNET HAIR DRYER

With 20 years of manufacturing and sourcing experience, integrates expertise, quality and innovation, just for bringing the best salon products into the market with you.

“



This product has revolutionized my salon! It's incredibly efficient, enhancing workflow and allowing for exquisite hairstyles. Its sophisticated design elevates my salon's ambiance, making it radiate professionalism and elegance. A must-have for a high-caliber styling experience!

”



Colour options

in, propelling it to become a leading brand in the salon equipment segment today.

## • Instruction and Warning •

1. Position dryer at a comfortable location; it has wheels and locks for easy mobility and stability.
2. Ensure power/heat switch is OFF and plug the cord into an outlet.
3. Clip the cord onto the telescoping tube.
4. Adjust airflow vents and select the temperature for your needs.
5. For ionic function, turn the switch ON; it enhances conditioning and reduces frizz.

### **WARNING:** To reduce the risk of burns, electrocution, fire, or injury to persons:

- An appliance should never be left unattended when plugged in.
- Close supervision is necessary when this appliance is used by, on, or near children or individuals with certain disabilities.
- Never operate this appliance if it has a damaged cord or plug, if it is not working properly, if it has been dropped or damaged in any manner or dropped into water. Return the appliance to us for repair or replacement.
- Keep the cord away from hot or heated surfaces. Do not wrap the cord around the appliance.
- Never block the air openings of the appliance or place it on a soft surface, such as a bed or couch, where the air openings may be blocked. Keep the air openings free of lint, hair, and the like.
- Never drop or insert any object into any opening or hose.
- Do not use outdoors or operate where aerosol (spray) products are being used or where oxygen is being administered.
- Do not use an extension cord or operate this appliance with a voltage converter.
- Do not direct hot air toward eyes or other heat-sensitive areas.
- While using the appliance, keep your hair out of it. Keep your hair away from the air inlets.

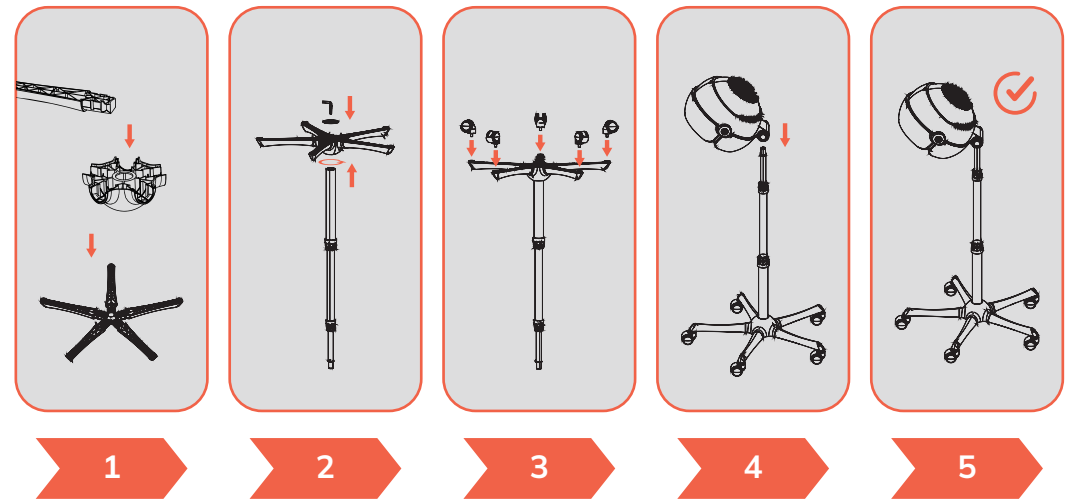

Exclusive Offer



Early Access



Extended Warranty



Online Support

- 1 Wheels
- 2 Legs
- 3 Bolt & Metal plate
- 4 Center hub
- 5 Hood
- 6 Clips
- 7 Telescoping pole

