

INSTRUCTION MANUAL

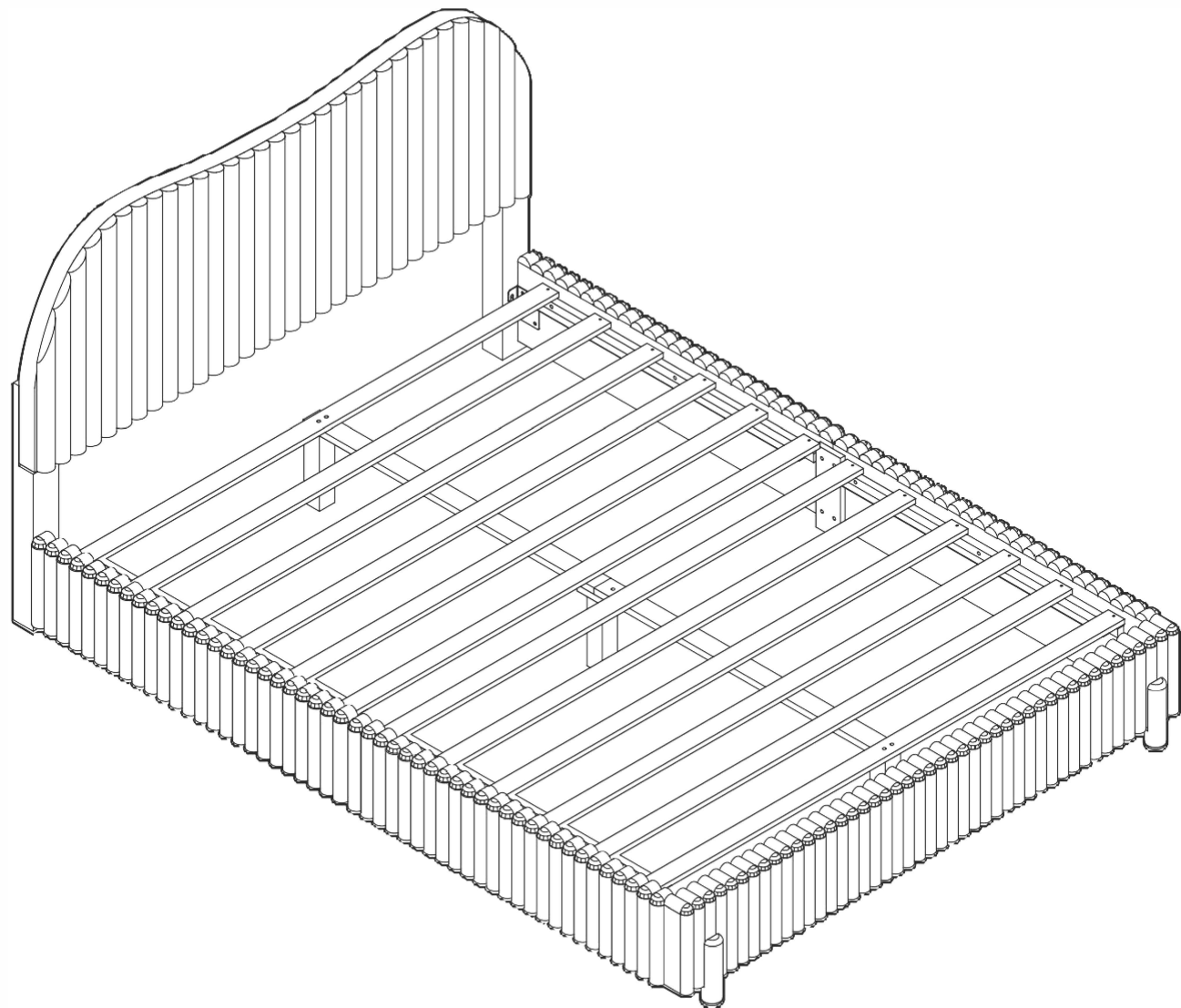











Upholstered Platform Bed Frame

IMPORTANT SAFETY INFORMATION

- PLEASE READ THE ENTIRE INSTRUCTION MANUAL BEFORE BEGINNING INSTALLATION.
- IF THIS MANUAL DOES NOT MATCH YOUR INSTALLATION, PLEASE CONTACT US.

WARNING

-  The product is intended for indoor use only. The product must be assembled and used in accordance with the provisions of the manual. Personal injury and/or damage to the product may occur if products are used outside of their intended purposes and/or if products have been changed/modified from their original design. The seller does not assume any responsibility or liability with respect to any injury/damage caused by incorrect assembly or improper use.
-  If there are any defective or missing parts after unpacking, please call technical support or email customer service.
-  To prevent mildew, avoid long-term exposure to humid environments.
-  Keep the product away from fire sources and high temperatures. DO NOT expose the product to direct sunlight.
DO NOT place any hot objects on the surface of the product.
-  To avoid potential damage to the product and flooring during assembly, use a blanket or underlayment to lay out parts.
-  Wear gloves during the assembly and/or disassembly process.
-  Keep the product away from sharp, pointed objects and corrosive substances.
-  Only assemble and use this product on level and solid flooring.
-  Periodically inspect screw tightness after assembly. If necessary, retighten to ensure structural integrity.
-  If you accidentally spill liquid on the surface, immediately wipe clean with a dry towel.



- The product is heavy. Children should not participate in handling. In the event of injury, the seller does not assume responsibility.
- Children should not climb or play on the product during assembly, as this can result in the product turning over and/or falling on top of children, resulting in injury.
- Keep children away from the work area during assembly. Screws and other small accessories may pose a choking hazard.
- To avoid the potential risk of suffocation, keep all parts and packaging (films, plastic bags and foam, etc.) away from babies and children.
- Please store spare parts in a safe place away from children.

Unpacking & Installation Tips

- Make sure you have enough space to lay the parts out before assembling.
- It is recommended that at least two people install this product together.

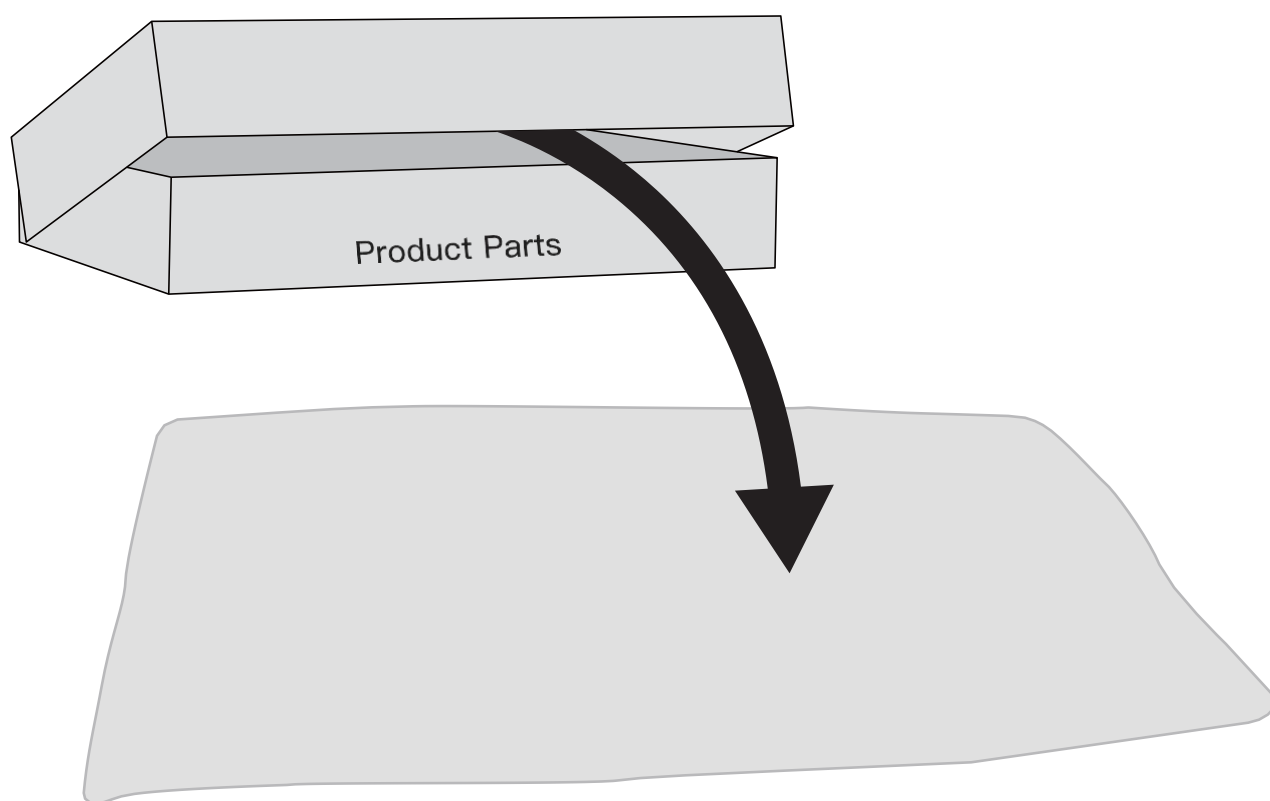

Tools Needed (Not Included)

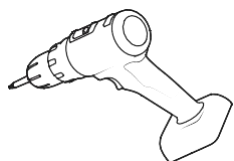

Drill

OR

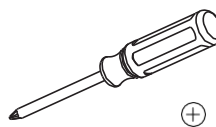

Phillips Screwdriver

Exploded Drawing

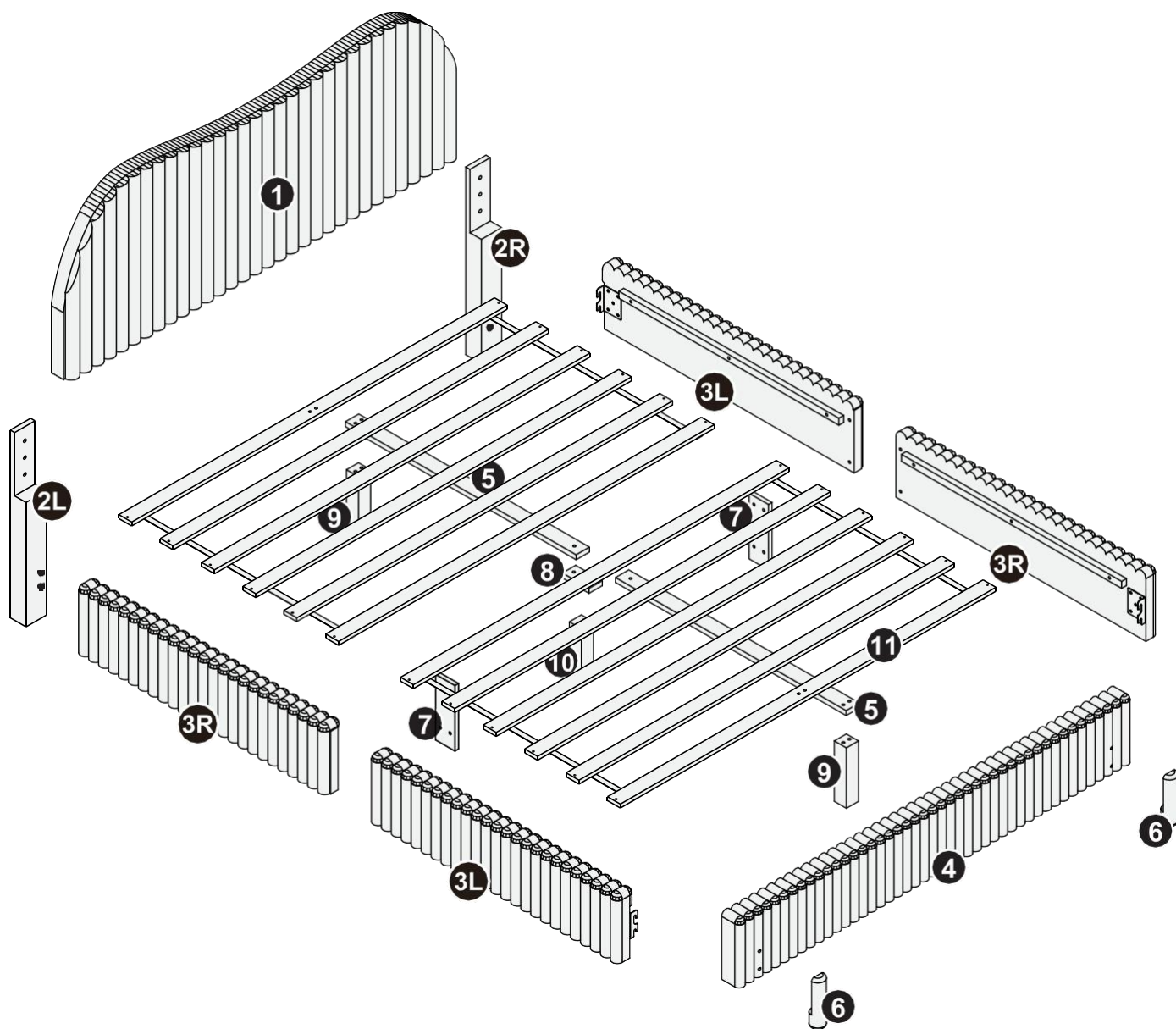

Supplied Parts and Hardware

1 x 1

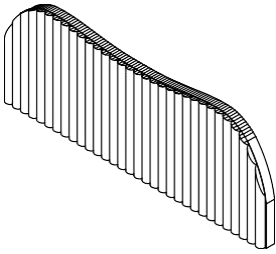

Headboard

2L x 1

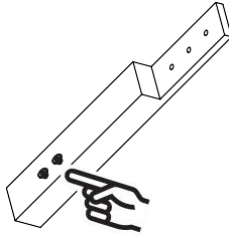

Headboard Leg

2R x 1

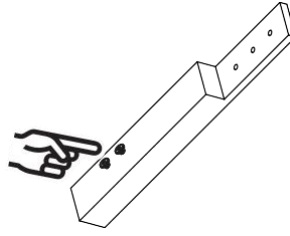

Headboard Leg

3L x 2

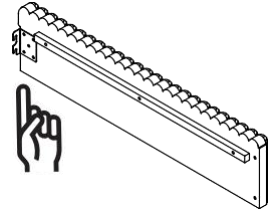

Side Rail

3R x 2

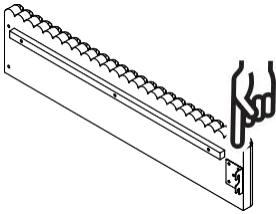

Side Rail

4 x 1

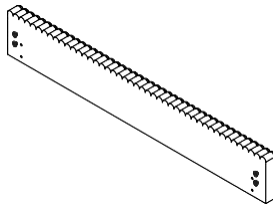

Footboard

5 x 2

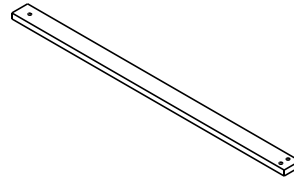

Center Rail

6 x 2

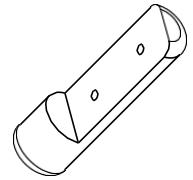

Footboard Leg

7 x 2

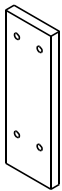

Side Rail Connector

8 x 1

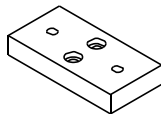

Center Rail Connector

9 x 2

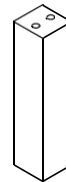

Tall Center Leg

10 x 1

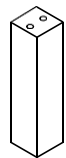

Short Center Leg

11 x 1

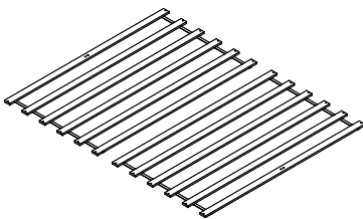

Slats

Supplied Parts and Hardware

A x 1



5/32" (4mm)
Small Allen Key

B x 1



3/16" (5mm)
Large Allen Key

C x 4



M6 x 70mm
Bolt

D x 4

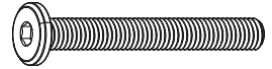

M6 x 50mm
Bolt

E x 6



M8 x 45mm
Bolt

F x 12



M6 x 35mm
Bolt

G x 6



M8
Washer

H x 6

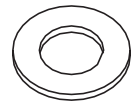

M8
Washer

I x 24



M4 x 25mm
Screw

1

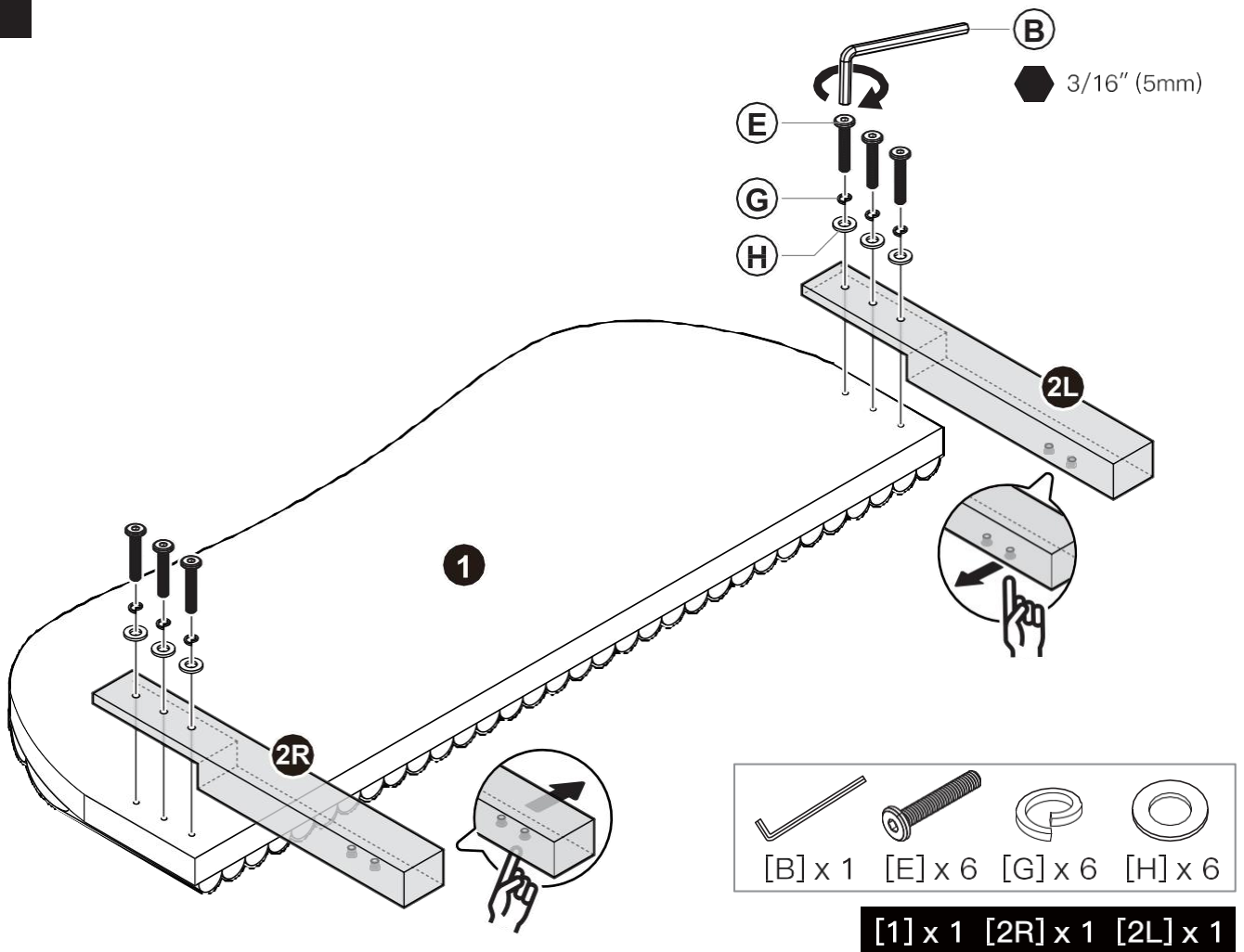

2

x 2

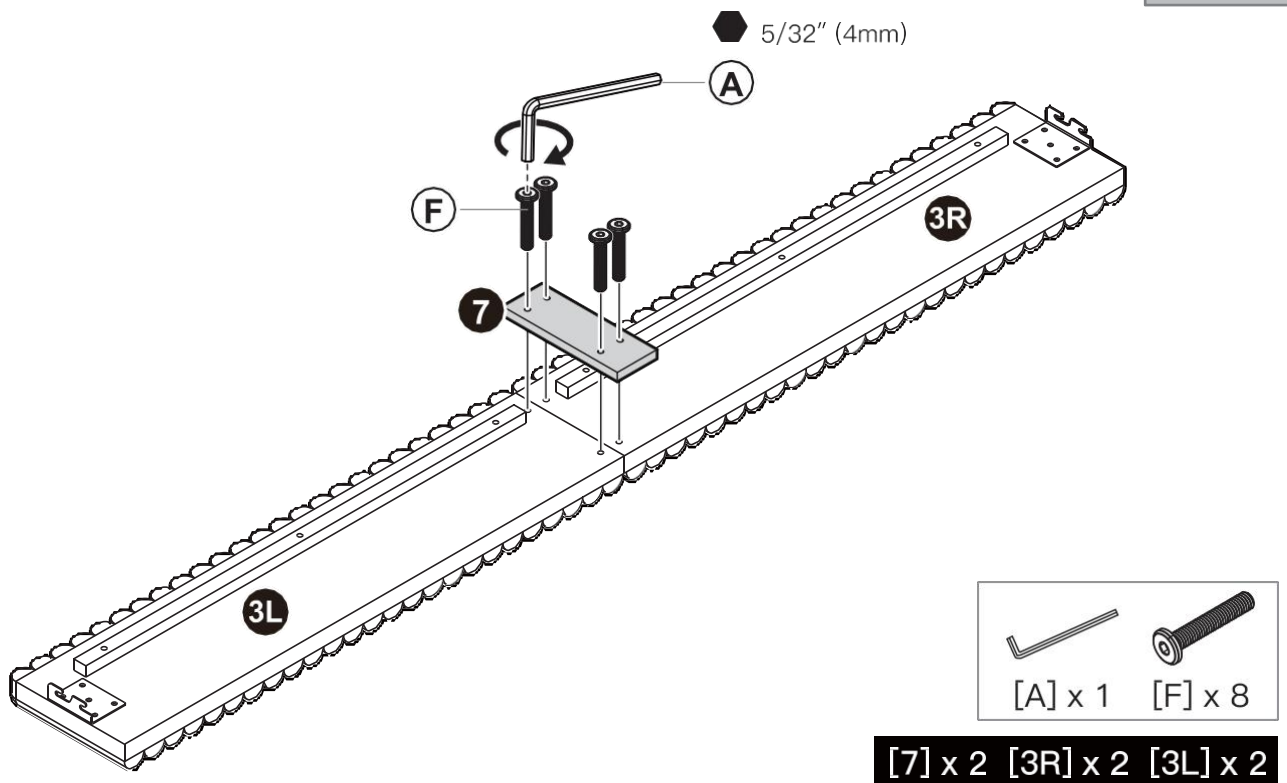

3

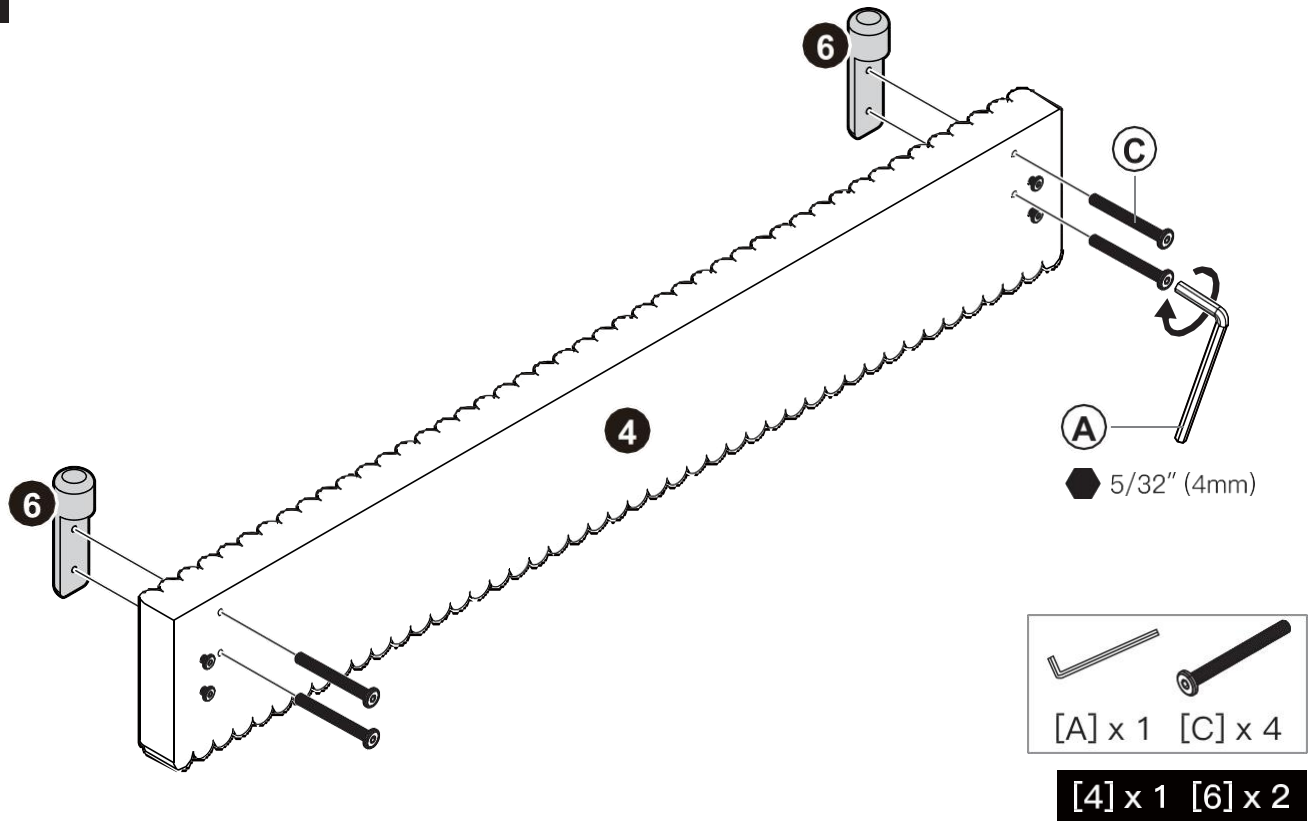

4

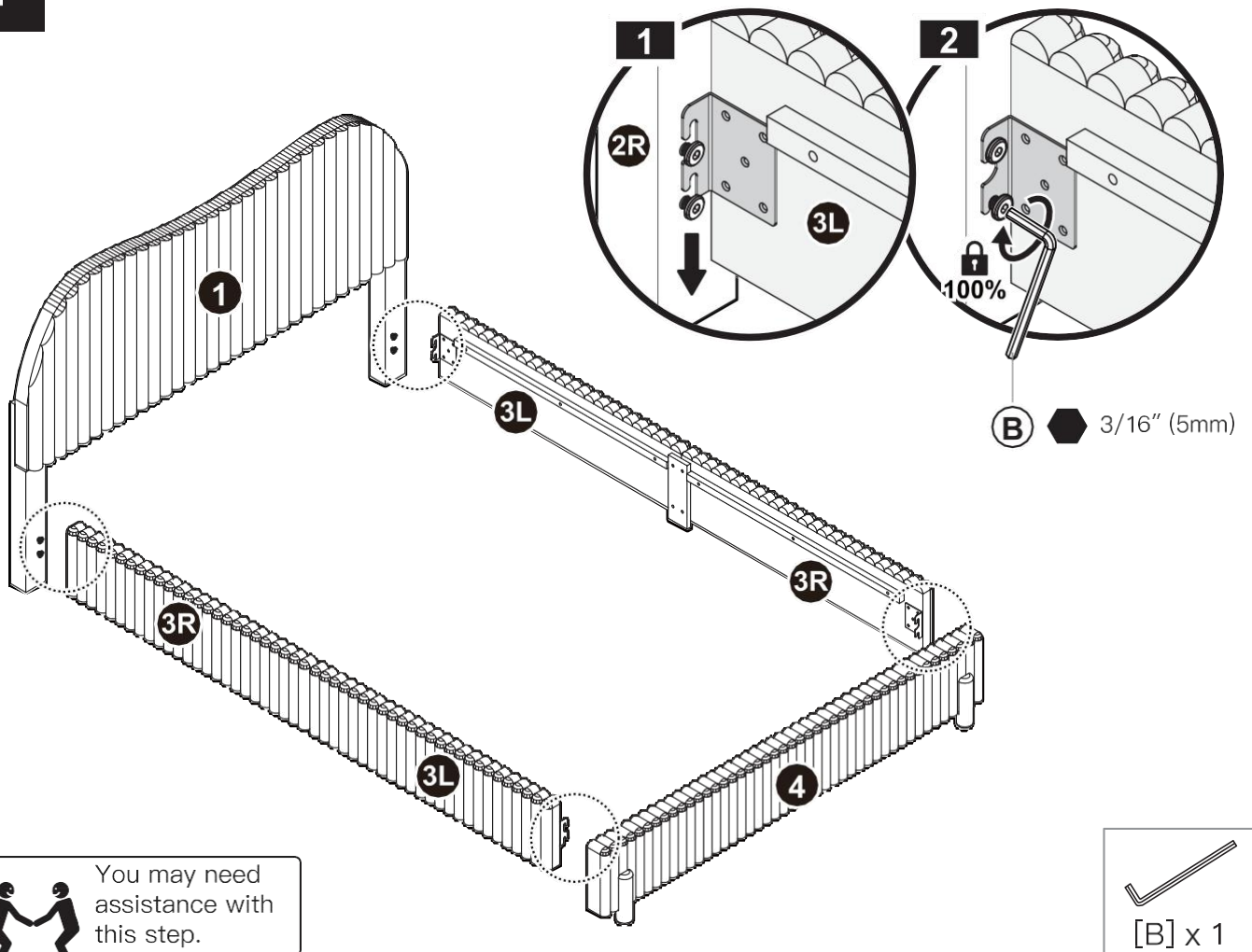

5

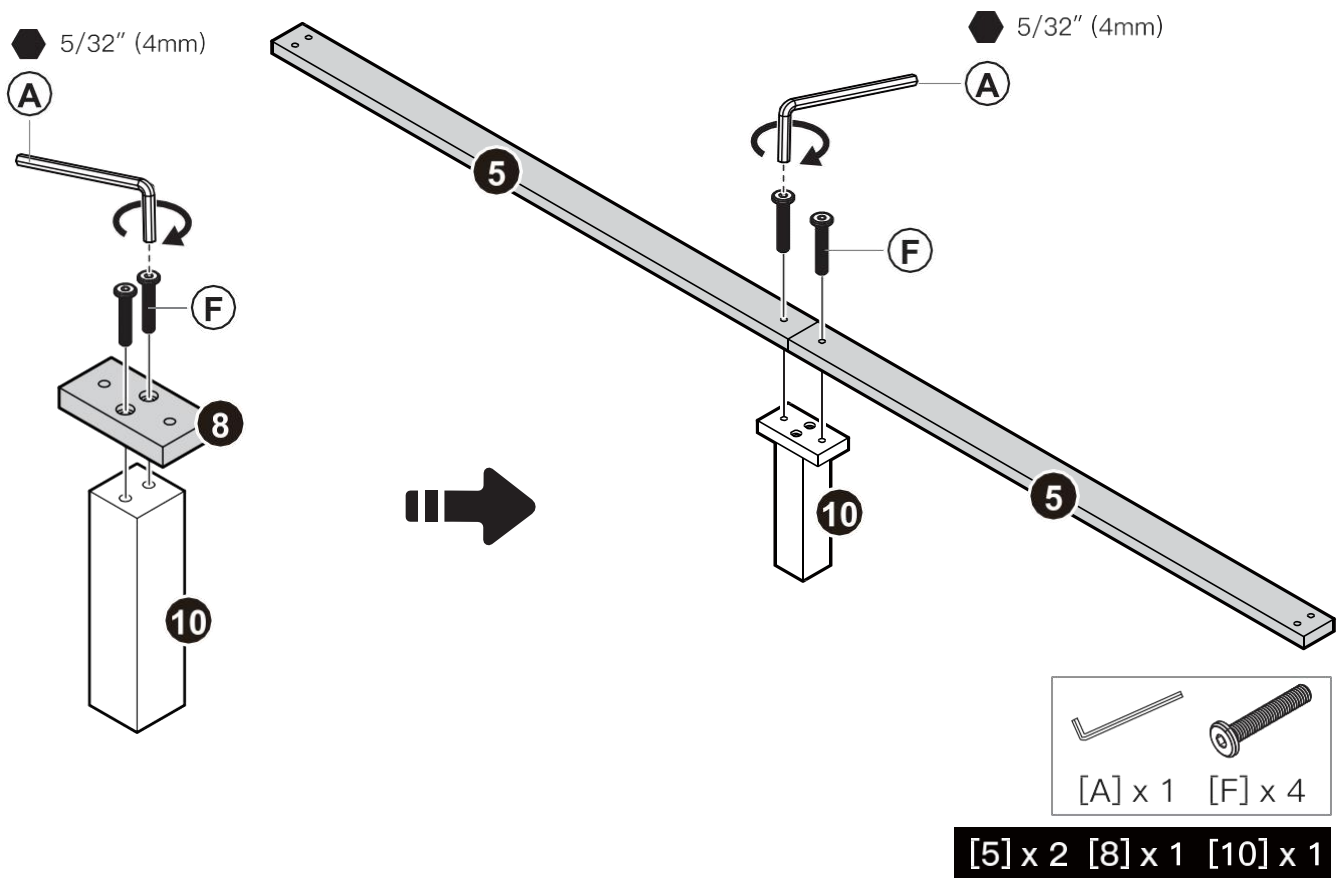

6

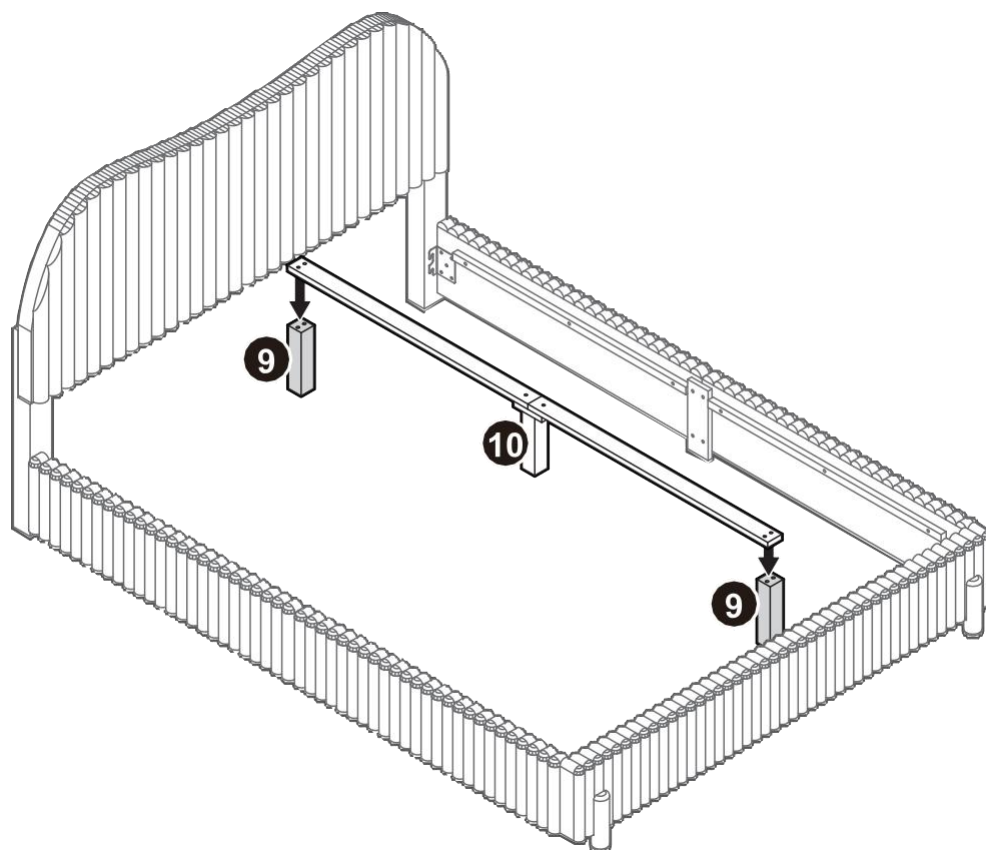

[9] x 2

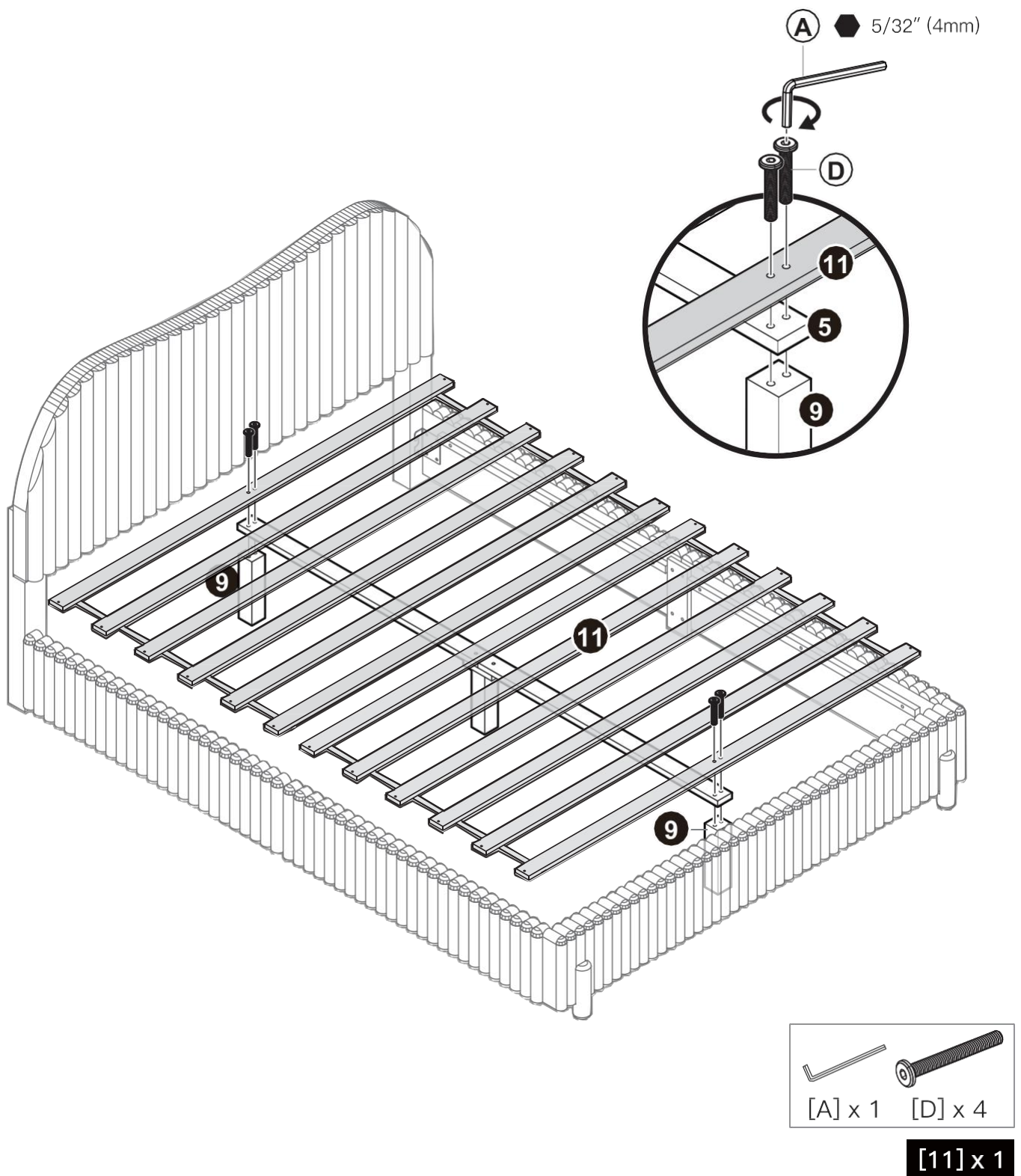

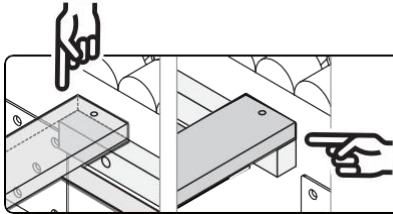

⚠ Important:

Before securing the slats, adjust them to ensure they are aligned, flush, evenly spaced, and straight.

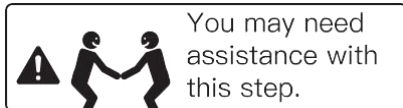
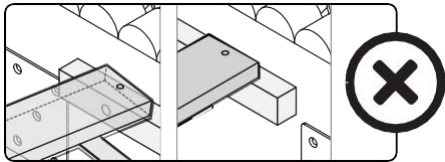
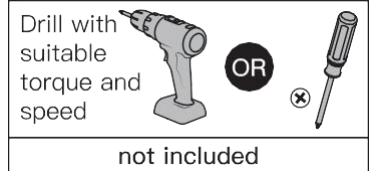

Note: There are no pilot holes on the side rails for screws. It is recommended to tighten 4 screws in the middle of the frame first, then the remaining screws.

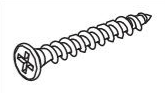
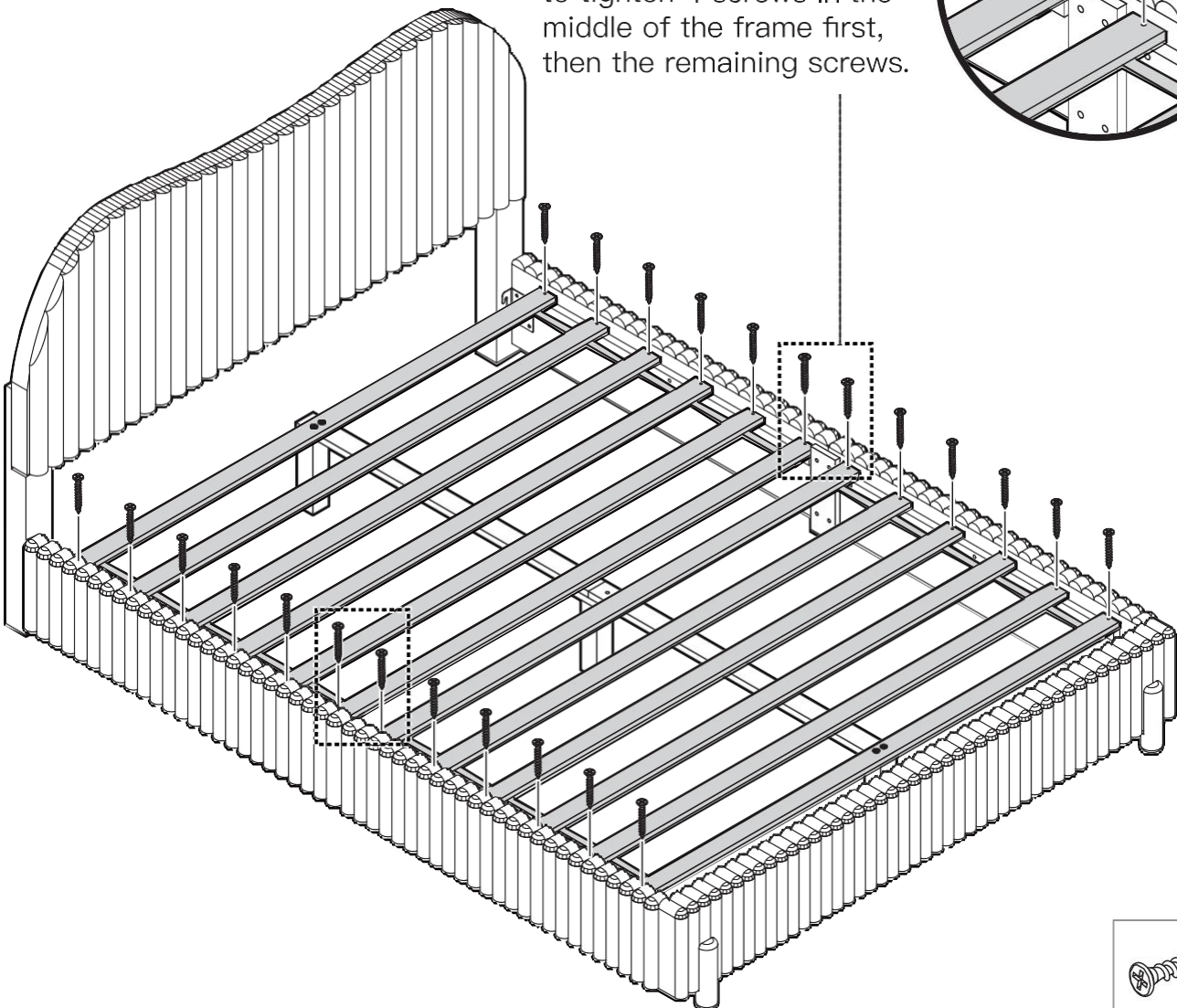
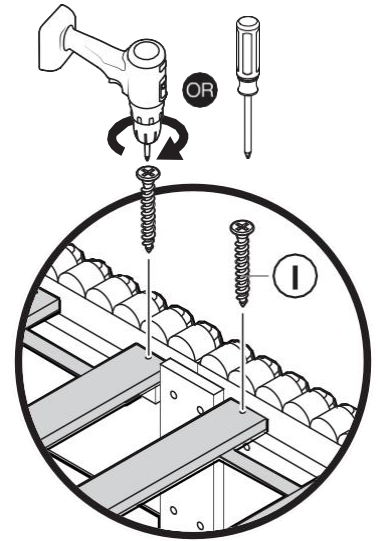

[1] x 24