

INSTRUCTIONS

ANWEISUNG

取扱説明書

INSTRUCTION

사용설명서

ISTRUZIONI PER L'INSTALLAZIONE

LIBRO DE INSTRUCCIONES

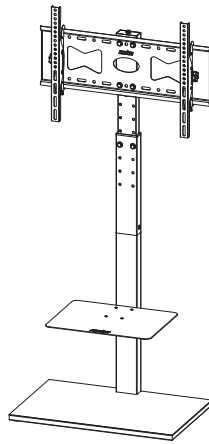

VESA 600*400mm

32" - 65"

30KG

±15°

⚠ WARNING

Children have died from furniture tipover.

- NEVER allow children to stand, climb or hang on drawers, doors, or shelves.
- ALWAYS secure your television with an anchor device.

This is a permanent label. Do not remove!

A		(M8*15)	X4
B		(M6*15)	X4
C		(M5*15)	X4
D		(Ø5,Ø6,Ø8)	X4
E		4mm	X1
F		5mm	X1
G			X2
H		(Ø8*40)	X2
I		(M5*40)	X2
J		(M8*50)	X6
K		(M8)	X6
L		(Ø8*1.0)	X4
M		(M8*20)	X2
O		(M4*8)	X6

P		(Ø4)	X6
Q		(M4*6)	X4
R		(M6*10)	X4
S		(Ø6)	X4
T			X1
U			X1
V			X1
W			X1
X			X1
Y			X1
Z			X1
A1			X1
B1			X1
C1			X1
D1			X1

1. Do not over tighten the screws, or it will damage the screws and decrease the holding power.
2. Before the installation is finished, do not remove or loosen any screws as it will case the TV to fall down. Using the wrench to tighten all the screws for safety after installation finished.
3. It is highly recommend to install this panel TV mount by professionals.

1. Schrauben Sie bitte die Schraube nicht zu fest, um die kaputt zu vermeiden.
2. Entfernen oder lösen Sie die Schrauben nicht, bevor die Installation abgeschlossen ist. Um der Bildschirm herunterfallen zu vermeiden. Bitte ziehen Sie alle Schrauben mit dem Schraubenschlüssel fest.
3. Es wird empfohlen, Fachmann mit der Montage zu beauftragen.

1. ネジ止めをするときは、ネジを締めすぎないでください。ネジを潰す可能性があります。
2. 組立て完了後すべてのネジをしっかり締めてください。勝手にネジを外したり緩めたりしないでください。落下によるケガや破損の原因となります。
3. 経験ある工事専門業者へ取り付け工事を依頼するようおすすめします

1. Veuillez ne pas serrer les vis trop fort pour éviter de les casser.
2. Ne pas retirer ou desserrer les vis avant que l'installation a été finie. Sinon la télé aura une possibilité de tomber. Veuillez bien serrer toutes les vis avec la clé à la fin de l'installation pour des raisons de sécurité.
3. Il est recommandé de confier l'installation à un spécialiste.

- 1: 나사가 손상되고 유지력이 떨어지지 않게 너무 조이지 마십시오.
- 2: 설치가 완료되기 전에 TV가 넘어질 수 있으므로 나사를 제거하거나 풀지 마십시오. 렌치를 사용하여 설치가 완료된 후 모든 나사를 안전하게 조입니다.
- 3: 전문가가 설치하는 것을 권장합니다.

1. Non stringere eccessivamente le viti, altrimenti danneggerai le viti e ridurrai la forza di presa.
2. Non smontare o allentare alcuna vite prima di completare l'installazione, per evitare che il televisore cada.
3. Dopo l'installazione, stringere tutte le viti con una chiave per garantire la sicurezza.
3. Si consiglia vivamente di far installare questo supporto per TV a pannello da un professionista.
1. No apriete demasiado los tornillos, ya que esto podría dañarlos y reducir su capacidad de sujeción.
2. No desmonte ni afloje ningún tornillo antes de completar la instalación para evitar que el televisor se caiga.
3. Después de la instalación, apriete todos los tornillos con una llave para garantizar la seguridad.
3. Se recomienda encarecidamente que un profesional instale este soporte para TV de panel.

Warning:
Do not lean on it
Es ist verboten, sich an das Produkt zu lehnen.
Interdiction de s'appuyer
Non appoggiarsi al prodotto
Prohibido apoyarse
製品に寄りかからないでください。
기대지 마세요.

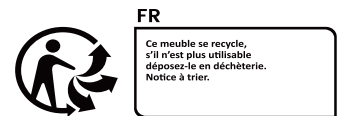
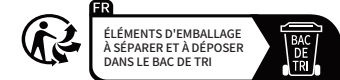

We simply act as an EU representative for cross-border sellers, and are not manufacturer/importers/distributors for the product, nor involved in the manufacture/import/sale of the product. Therefore, we are not responsible for any after-sales services related to the product. In case of any product quality infringement issues, the manufacturer/importer/seller shall be solely held responsible.



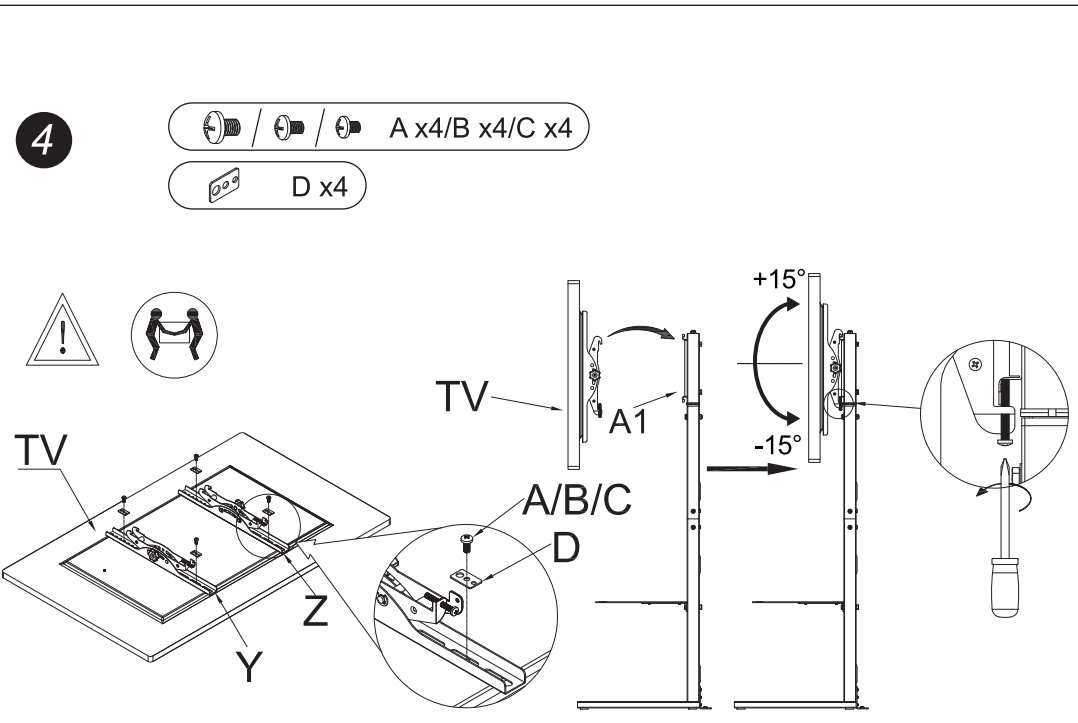
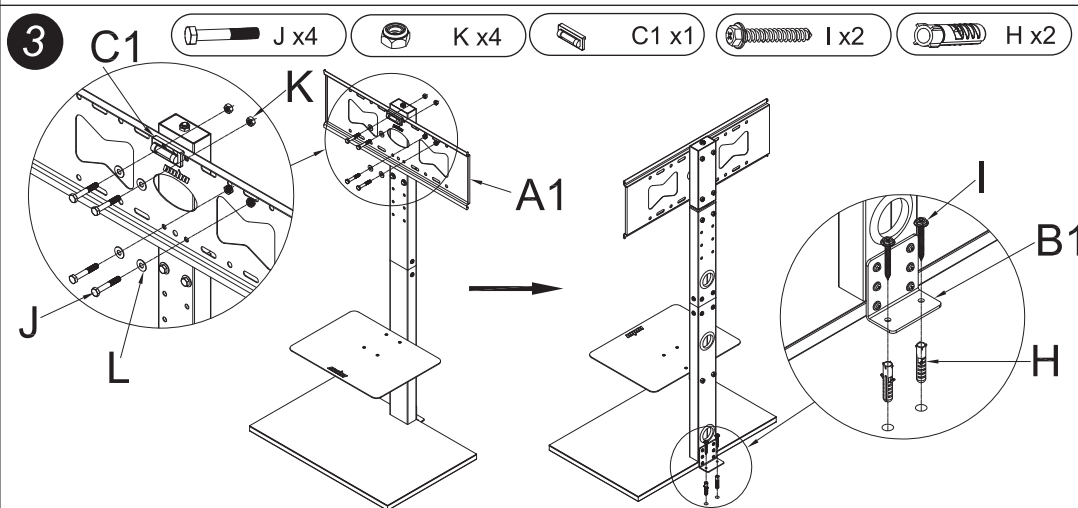
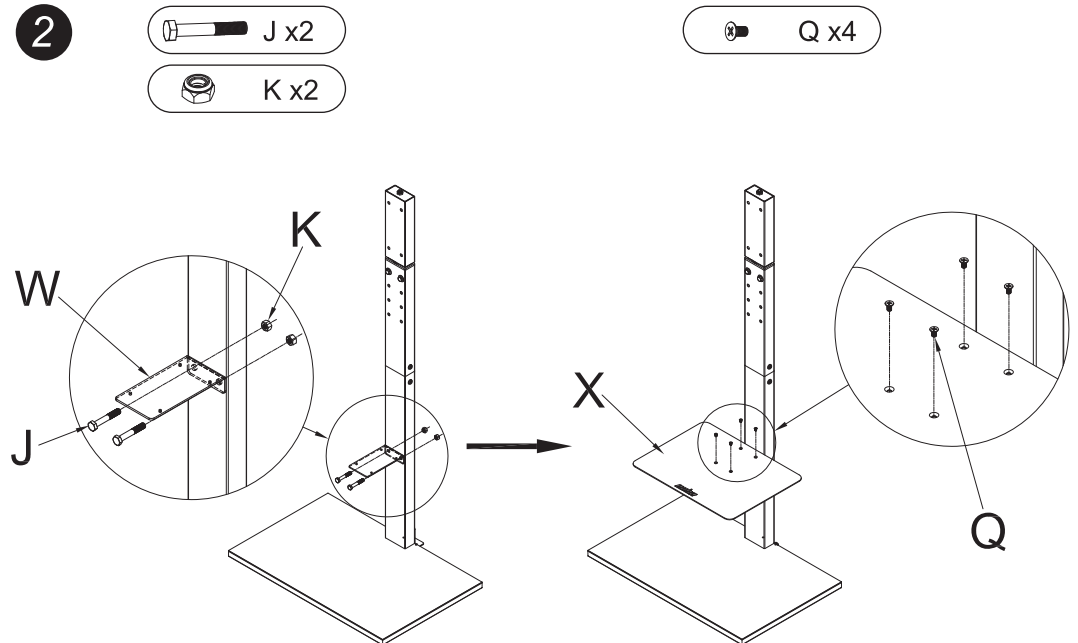
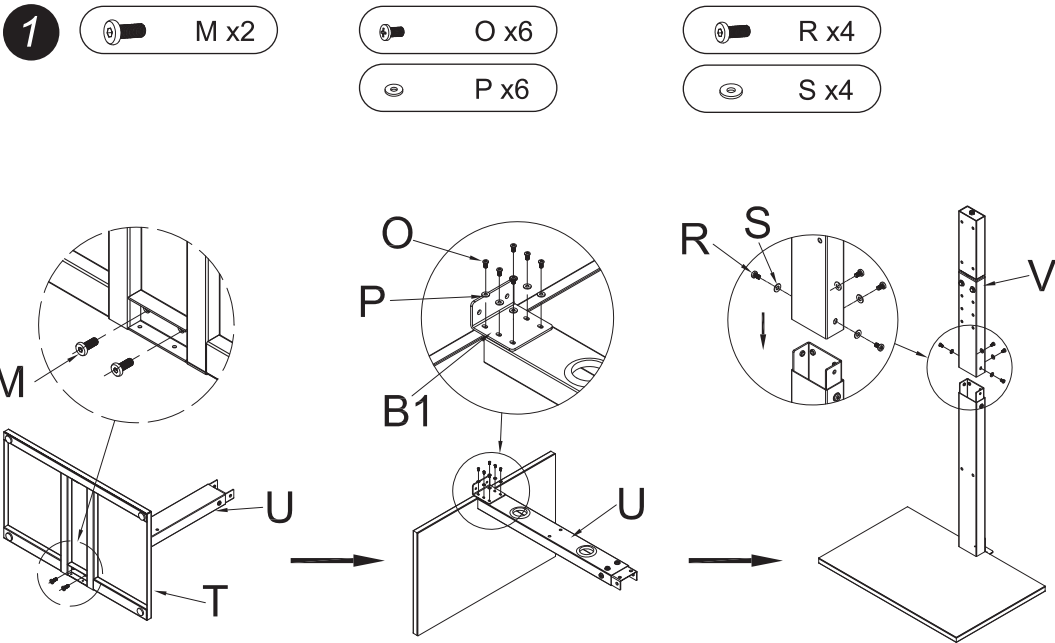

- ▶ To make the stand more stable, we recommend to drill holes in the ground, then drive H into the hole, fix with I
- ▶ Um den Ständer stabiler ist, bohren Sie Locher auf den Boden, klopfen Sie H in diese Locher und mit Schrauben I befestigen
- ▶ 安定性を高める必要があれば、地面に穴をあけて、Hを穴の中に打ち込み、Iでスタンドを固定します。
- ▶ Pour rendre le support plus stable, nous vous recommandons de percer des trous au sol, puis fixez le pied avec les chevilles H et les vis I
- ▶ 스탠드를 더 안정적으로 설치하기 위해 땅에 구멍을 뚫은 다음 H를 구멍에 몰아넣고 I로 고정하는 것이 좋습니다
- ▶ Per rendere il supporto più stabile, consigliamo di praticare dei fori nel pavimento, inserire H nei fori e fissarlo con I.
- ▶ Para hacer el soporte más estable, recomendamos perforar agujeros en el suelo, insertar H en los agujeros y fijarlo con I.