

■CODE : 782575\_取説USウサコPP1280H  
■サイズ : W210 x H297mm (A4)  
■材 質 : 上質紙70kg(81.4g/㎡)  
■刷 色 : 1 C / 1 C (Black)



# WOOD-LOOK OPEN PET PEN

## GENERAL INSTRUCTIONS

Thank you for purchasing this product.  
Please read these instructions carefully before use.  
Misuse may lead to injury to pet or owner and damage to product.  
Keep these instructions for future reference.

OPP-1280H

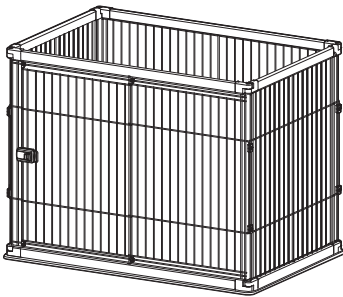

OUTER DIMENSIONS (in/cm)	W47.24" × D31.50" × H35.43" / W120.0 × D80.0 × H90.0 cm
INNER DIMENSIONS (in/cm)	W42.71" × D26.97" / W108.5 × D68.5 cm
MAIN ENTRANCE DIMENSIONS (in/cm)	W19.09" × H30.12" / W48.5 × H76.5 cm
MATERIAL	●Panel Frame: synthetic resin ornamental fibreboard (vinyl chloride resin), ABS resin ●Latch: iron(painted with epoxy resin powder) ●Door Lock: ABS resin ●Tray:PVC resin ●Plastic Bolt: polyacetal ●Joint: polypropylene

●PRODUCT SPECIFICATIONS ARE SUBJECT TO CHANGE WITHOUT NOTICE.

MADE IN CHINA

### PRECAUTIONS

MISUSE CAN LEAD TO INJURY TO THE USER OR DAMAGE TO THE PRODUCT OR PROPERTY.

SMALL DOGS & MEDIUM DOGS

For use only with small and medium dogs.



### WARNING

IMPROPER USE MAY CAUSE DEATH OR SERIOUS INJURY.

- The product is not suitable for pets whose heads are smaller than the gap between the panel grids.
- After the installation is completed, please check the stability of the product.
- Do not place the product near the stove or other sources of high heat, and do not pour hot water on it.Doing so may lead to fire, burns to people and pets, or deformation of the product.
- Keep product on a flat, stable surface.
- Children should not be allowed to play with the pet pen. Do not exert strong force when moving or adjusting the product.



### ATTENTION

IMPROPER USE MAY CAUSE INJURY OR DAMAGE TO PEOPLE, PETS, OR PROPERTY.

- Due to ages, breeds and sizes, personalities, and other individual differences, it is possible that some pets may get stuck in the gaps of the panels or may be able to escape from the pet pen.
- Mind your fingers and your pets when opening or closing the pet pen.
- The pet's feet or claws may get stuck in the wire gap. Please use this product where you can see it.
- Do not move the pet pen with your pet inside.
- When moving, take pets, pet pads, etc. out of the products, and lift the panels and tray to move them.
- Do not place anything on top of the pen.
- Extended periods of use may cause discomfort for your pet. Please ensure your pet's physical needs are met.
- Collars and chains may get stuck in the pet pen. Do not use them when your pet is in the product.
- To avoid injury or damage, do not place objects on or lean on the product.
- Make sure the pet pen door has been securely closed and locked, otherwise your pet may escape.
- Some pets may be able to figure out how to open the pet pen door. In this case, please use a padlock.
- Please pay attention to the following matters to avoid corrosion, rust, deformation or discoloration.
  - Keep away from direct sunlight or high humidity.
  - Wipe away any water, oil, or soap immediately.
  - Do not place hot or wet items on the product.
  - Do not place stickers or tape on product.

- The company is not liable for injury, accident, or damage to your pet due to improper use.
- The company is not liable for injury, accident, or damage due to natural hazards or improper repair or modification of the product.
- Please dispose of product and packaging materials according to local regulations.

### CLEANING METHOD

TO MAINTAIN HIGH PERFORMANCE OF THE PRODUCT, PLEASE MAKE SURE TO OBSERVE THE FOLLOWING:

- The whole tray can be washed with water.
- The stains on panels may be difficult to clean, so use soft cloth with diluted neutral detergent to clean the panels, then use a dry cloth to wipe away detergent.
- Do not clean with ethyl alcohol, gasoline, bleach or detergent powder.
- Please use pet deodorant and disinfectant to remove smell.

IRIS USA, INC.

ADDRESS: 13423 W Cactus Rd. Surprise, AZ 85379  
WEBSITE: [www.irisusainc.com](http://www.irisusainc.com)

IRIS USA,Inc.

TEL: 800-320-4747  
FAX: 262-612-1010

782575  
130618-XXX-QIU-01

## PARTS

- PLEASE CONFIRM THE FOLLOWING PARTS ARE INCLUDED BEFORE ASSEMBLING.
- PACKAGING MATERIAL IS NOT MARKED. EXTRA HARDWARE MAY BE INCLUDED FOR CONVENIENCE.

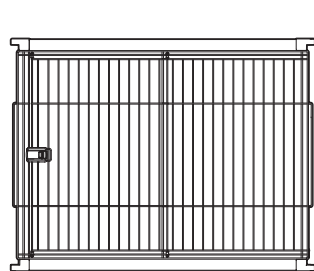

Front Panel(1)

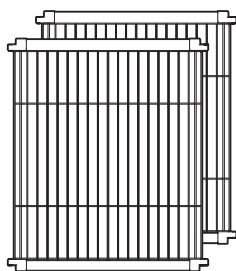

Side Panels(2)

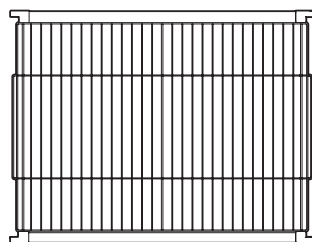

Back Panel(1)

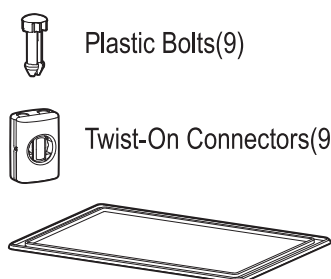

Tray(1)

Plastic Bolts(9)

Twist-On Connectors(9)

## ASSEMBLY METHOD

- PLEASE ASSEMBLE ON A FLAT SURFACE, AND BE CAREFUL NOT TO SCRATCH THE FLOOR.
- PLEASE CONNECT PARTS CORRECTLY. ●THE ASSEMBLY DRAWINGS ARE DIAGRAMS FOR REFERENCE ONLY.

- 1 Assemble the panels as shown (4 in total).
- 2 Secure the panels by inserting the plastic bolts into the **1** connected panels (8 in total).
- 3 Please attach the twist-on connectors to the outside corners of the panels (8 in total).

- ① Before attaching to the panels, turn the connector front 90 degrees.
- ② Arrange the twist-on connector as shown, firmly inserting the panel wires into the positioning grooves.
- ③ Rotate the connector front clockwise to secure twist-on connector.  
To disassemble, rotate counterclockwise.

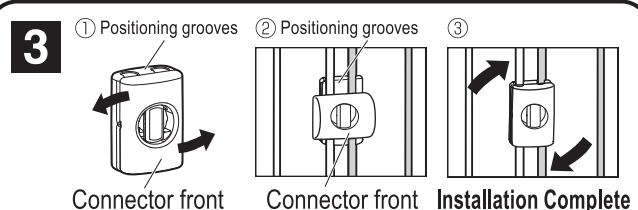

2

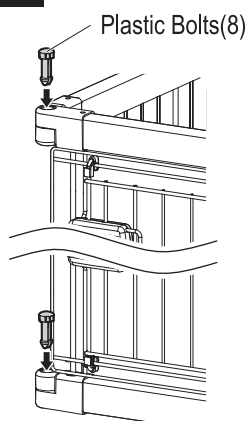

### ATTENTION

Please ensure the plastic bolt is completely installed.

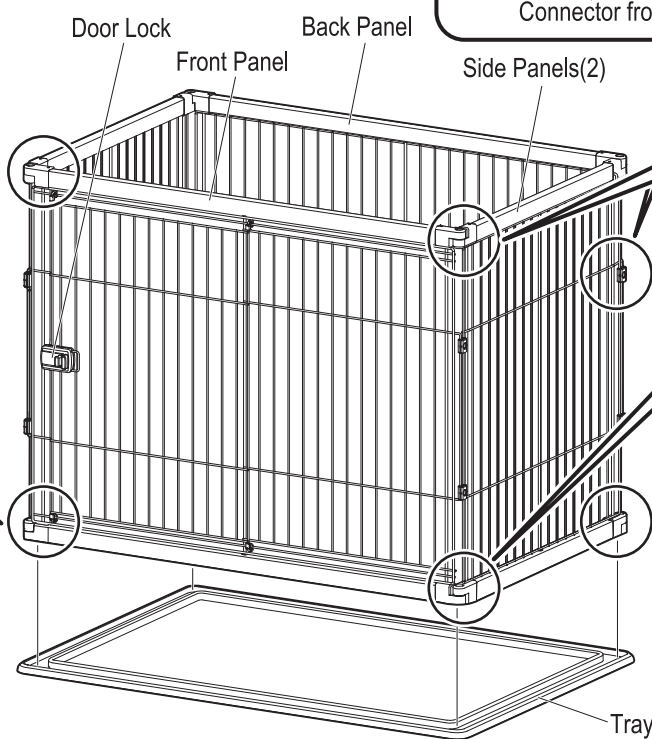

1

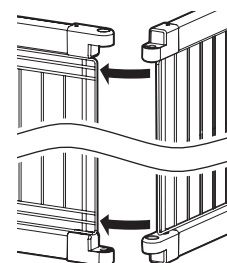

### Removing the Plastic Bolts

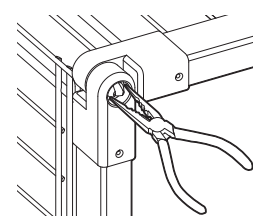

Please use round-nose plier to clamp and pull out the bolt.

## USING THE PET PEN DOOR

### Open

Squeeze the latch on the pen door to release the door lock, and slide the door open.

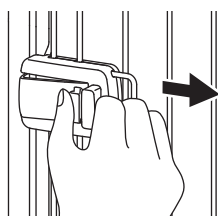

### Close

Slide the pen door closed. Squeeze the latch and clasp the door lock onto the panel when the door is fully closed.

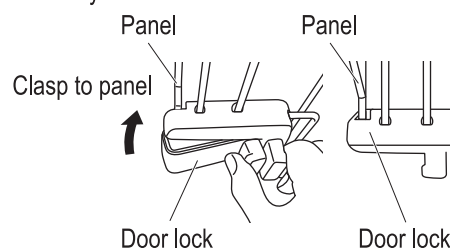

### For Added Security

Some pets may be smart enough to open the pen door by themselves. In such cases, please use a padlock and attach as shown below.

Lock 2 Panels with the padlock.

