

Installation Instruction

CAUTIONS :

- DO NOT** exceed weight limit of 330 lbs.
- DO NOT** use on slippery or uneven surfaces, scaffolding, or unstable bases.
- DO NOT** use ladder if it is damaged, worn, or if ladder has been exposed to fire or chemical corrosion.
- DO NOT** attempt to repair damaged or missing parts.
- DO NOT** use ladder for anything other than its intended use. Ladder is for HOUSEHOLD USE ONLY.
- DO NOT** overreach while standing on ladder or attempt to move ladder while standing on it.
- WARNING:** Metal ladder conducts electricity. **DO NOT** make contact with live electrical wires.

SAFETY GUIDELINES:

- When using ladders, basic safety precautions should always be followed.
- Inspect all parts prior to each use to insure that all parts are securely fastened and in good working condition.
- Keep step ladder dry and clean, free from grease, oil, mud, snow, wet paint, and other slippery materials.
- Ladder is meant for one person only.

ASSEMBLY INSTRUCTIONS:

- Right and left handrails are different, they are determined by standing in front of the ladder.
- Parts included: Bolts(4), Nuts(4), Washers(4)



Bolt X 4



Nut X 4



Washer X 4

- Tools needed (not included): Ratchet, 10mm Socket, Pliers.

Figure 1

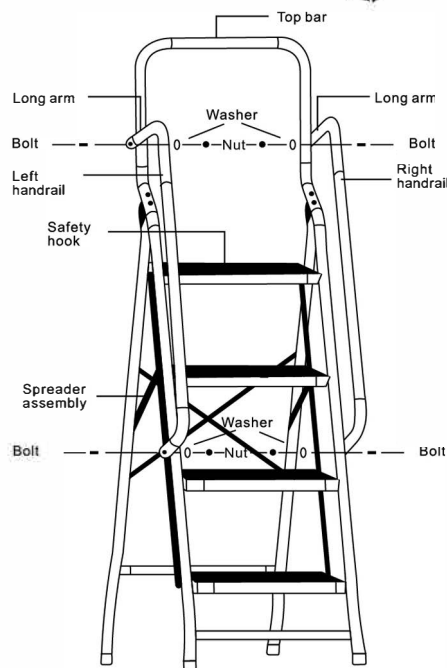

INSTALLATION STEPS:

1. Attach the top bar to the lower part of ladder body. See Figure 2
2. Attach the handrails by lining up the bottom hole in the handrail with the bottom hole in the frame of the ladder, insert the bolt through the handrail and frame, place the washer and nut on. Do not tighten. See Figure 3

Figure 2

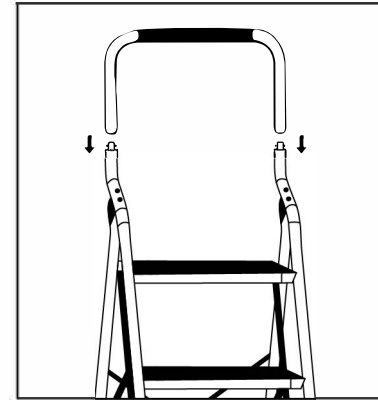
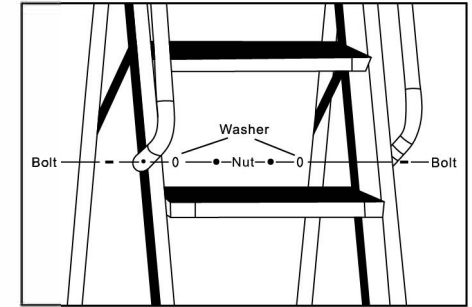

Figure 3



3. Line up the hole in the top of handrail with the hole in the top of the ladder frame, you may need to push and /or pull on the handrail to get the holes to line up. Insert the bolt through the handrail and frame, place the washer and nut on, then tighten. Finish tightening the bottom nuts and bolts. See Figure 4a & 4b.

Figure 4a

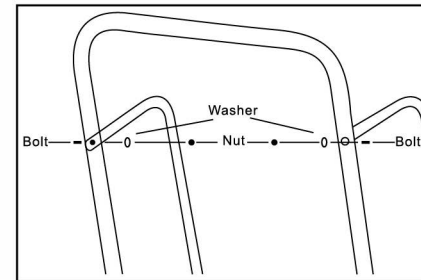
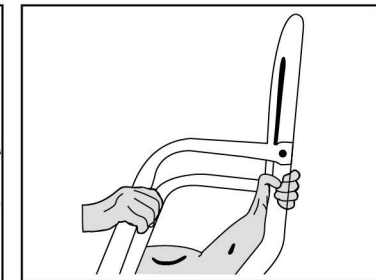

Figure 4b



INSTRUCTIONS FOR USE:

- Unfold the ladder by pushing down on the top step. The safety hook underneath the top step will automatically slide down and lock the spreader assembly. Ensure spreader assembly is secure before use.
- To fold the ladder, press the safety hook at the highest step and carefully pull up the back of the top step making sure not to pinch or injure your fingers. See Figure 5 for location of safety hook below.
- The Safety Lock must be in locked position prior to using ladder.

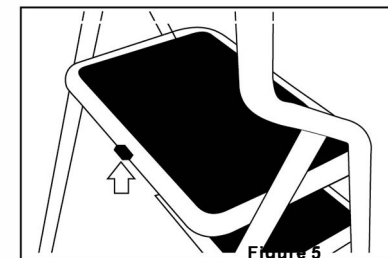

Figure 5