

# ALMA BEDSIDE TABLE

## ASSEMBLY GUIDE

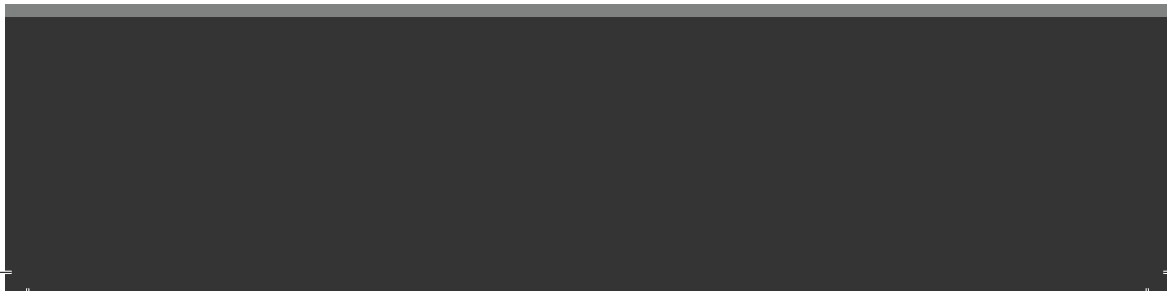

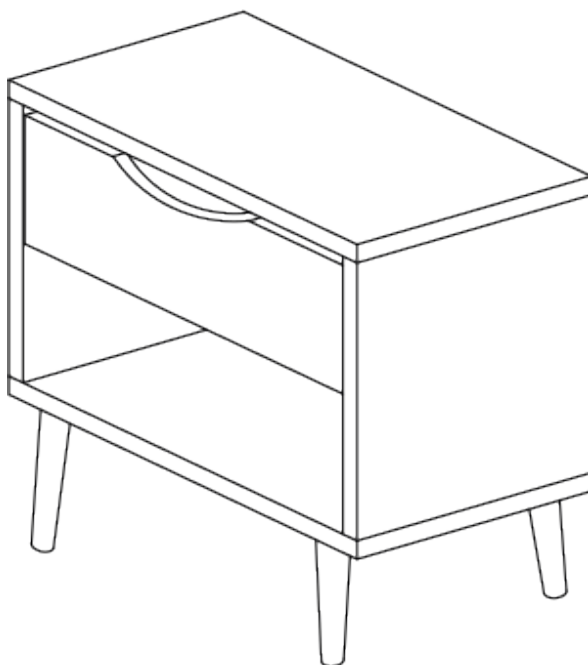

### **SAFETY AND CARE ADVICE**



### **NO POWER TOOLS**

#### **SAFETY AND CARE ADVICE**

- Check you have all the components and tools listed.
- Remove all fittings from the plastic bags and separate them into their groups.
- We do not recommend the use of power drills/drivers for inserting screws, as this could damage the unit. Only use hand screwdrivers and Allen keys.
- Keep children and animals away from the work area, small parts could cause choking if swallowed.
- Make sure you have enough space to layout the parts before starting.
- Assemble the item as close to its final position (in the same room) as possible.
- Do not overtighten the nuts to avoid causing damage to the threads.
- Only clean using a damp cloth and mild detergent, do not use bleach or abrasive cleaners.
- From time to time check that there are no loose screws on this unit
- This product should not be discarded with household waste. Take to your local authority waste disposal centre

## IMPORTANT INFORMATION



45 MINUTE  
BUILD



TWO  
PERSON



MAXIMUM  
CAPACITY 25Kg

PLEASE CHECK CAREFULLY AND MAKE SURE YOU HAVE ALL FITTINGS AND TOOLS LISTED BELOW BEFORE YOU START.

- ① -Top Board\*1
- ② -Bottom Board\*1
- ③ -Left Side Board\*1
- ④ -Right Side Board\*1
- ⑤ -Back Board\*1
- ⑥ -Drawer Front Piece\*1
- ⑦ -Drawer Back Piece\*1
- ⑧ -Drawer Side Piece\*2
- ⑨ -Drawer Bottom Piece\*1

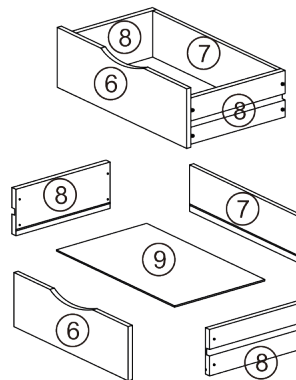
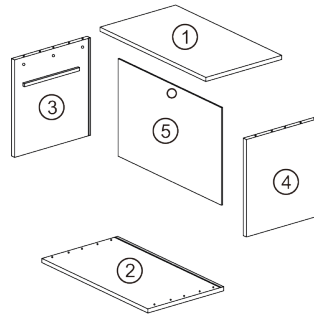

A	Cam Screw	*6
B	Cam Lock Nut	*6
C	Wooden Dowel	*8
D	Ø3.5x25mm Self Tapping Screw	*8
E	Ø7x50mm Long Screw	*6
F	Screw Driver	*1
G	Leg	*4
H	Feet pad	*4

**NOTE:** The quantities above are the correct amount to complete the assembly. In some cases more fittings may be supplied than are required.

## STEP 1

Put the pieces on the soft flat surface e.g. a carpet to avoid scratching. Make sure that you have all pieces and components ready to build the bedside table.

Insert Cam screw (A) and wooden dowel (C) into the corresponding hole at the top board (1), and insert wooden dowel (C) into corresponding hole of the bottom board (2)

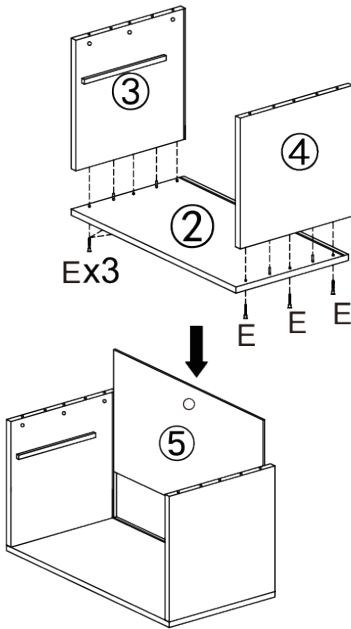
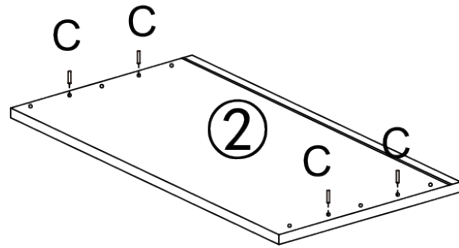
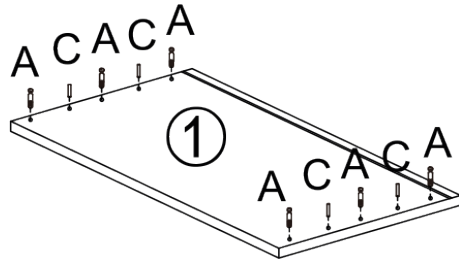

## STEP 2

Connect the side board (3), (4) with the bottom board (2) use the ling screws (E). Connect the back board (5) with the side board (3), (4) and the bottom board (2) together.

### STEP 3

Assemble the top board (1) with the side boards (3) (4) and then the back board (5). Tighten using cam lock nuts (B). Install the wooden leg (G) and stick on the waterproof feet pad (H).

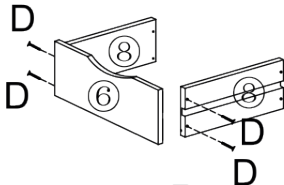
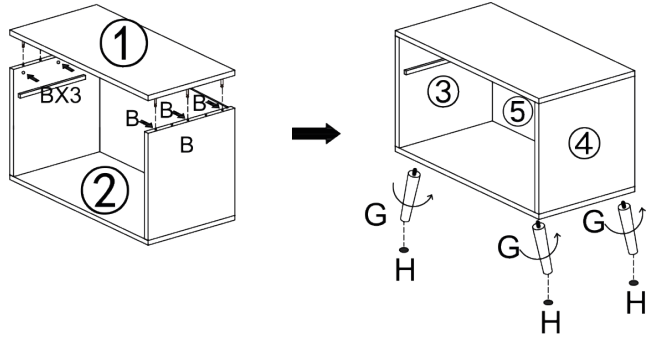

### STEP 4

Assemble the drawers, connect the drawer front piece (6), drawer side piece (7), (8) and bottom drawer piece (9), tighten with screws (D).

**ATTENTION:** Be careful not to overload drawers.

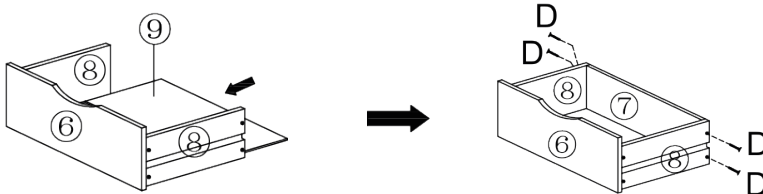

### STEP 5

Install the assembled drawers in the assembled cabinet.

Then use fastening clips to secure cabinet back with 16mm screws.

Assembly complete.

**ATTENTION:** The Anti Tipping Kit **MUST** be used to connect the cabinet to the wall to prevent tipping over.

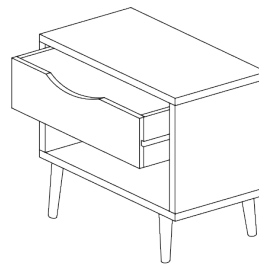

## WHAT THE GUARANTEE COVERS



**PRE-INSERTED FIXINGS**  
e.g. lose metal threads



**FAULTY JOINTS**  
e.g. legs bending



**EXTERNAL FIXING FAULTS**  
e.g. metal discs removing  
from table top



**STRUCTURAL INTEGRITY**  
e.g. the frame of the  
product