

Bed Frame Instructions

SKU: 6667090K-G/6667090K

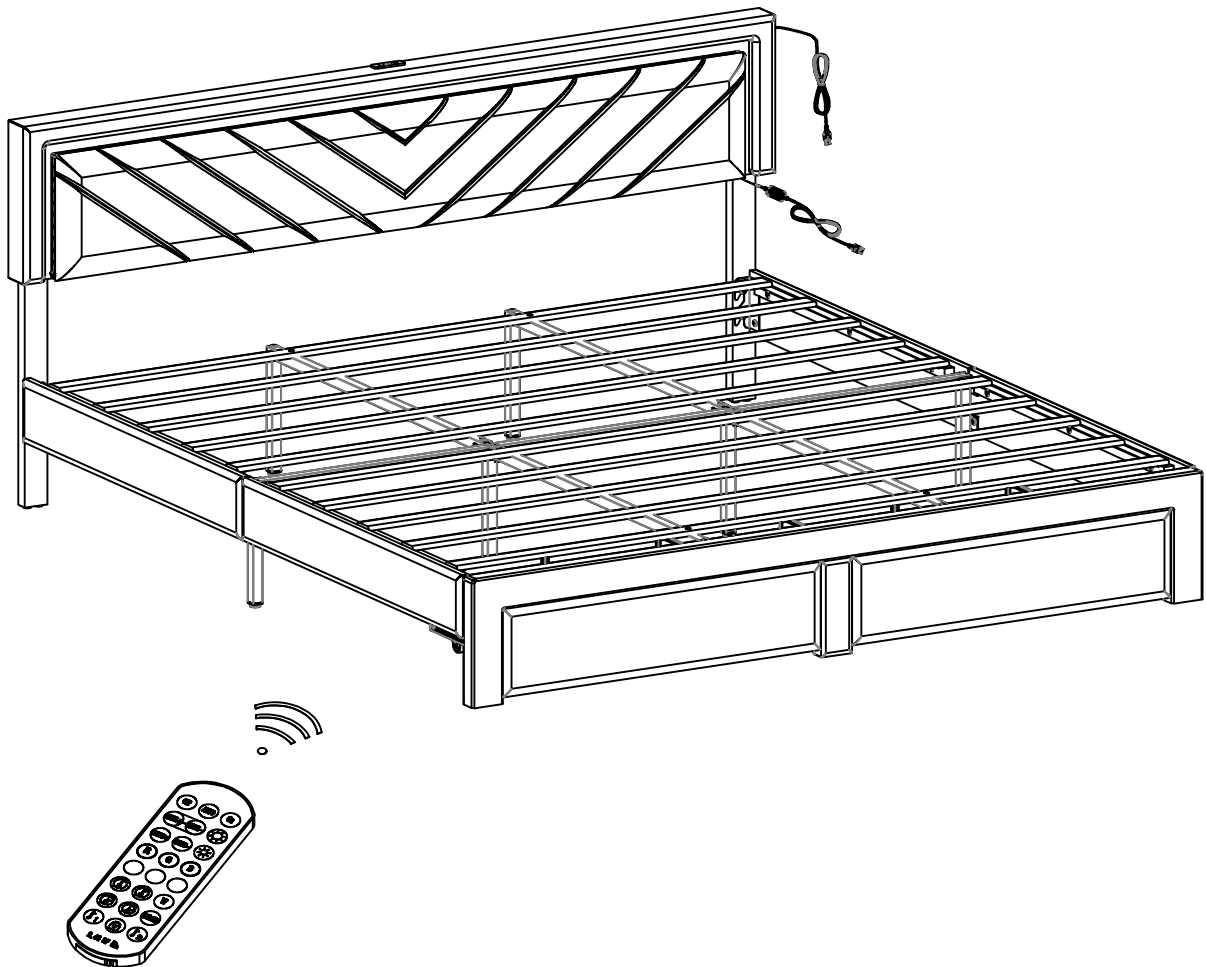

We recommend powering up the LED strip before installation to check if it works.
If you encounter after-sales problems, please contact us through the 2 ways below:

1. Our Email: **foraftersales@gmail.com**
 2. The 'Contact Seller' button in the detail page of your order in Amazon
- If you encounter assembly problems, please refer to the [assembly videos](#) on Amazon's product detail page.

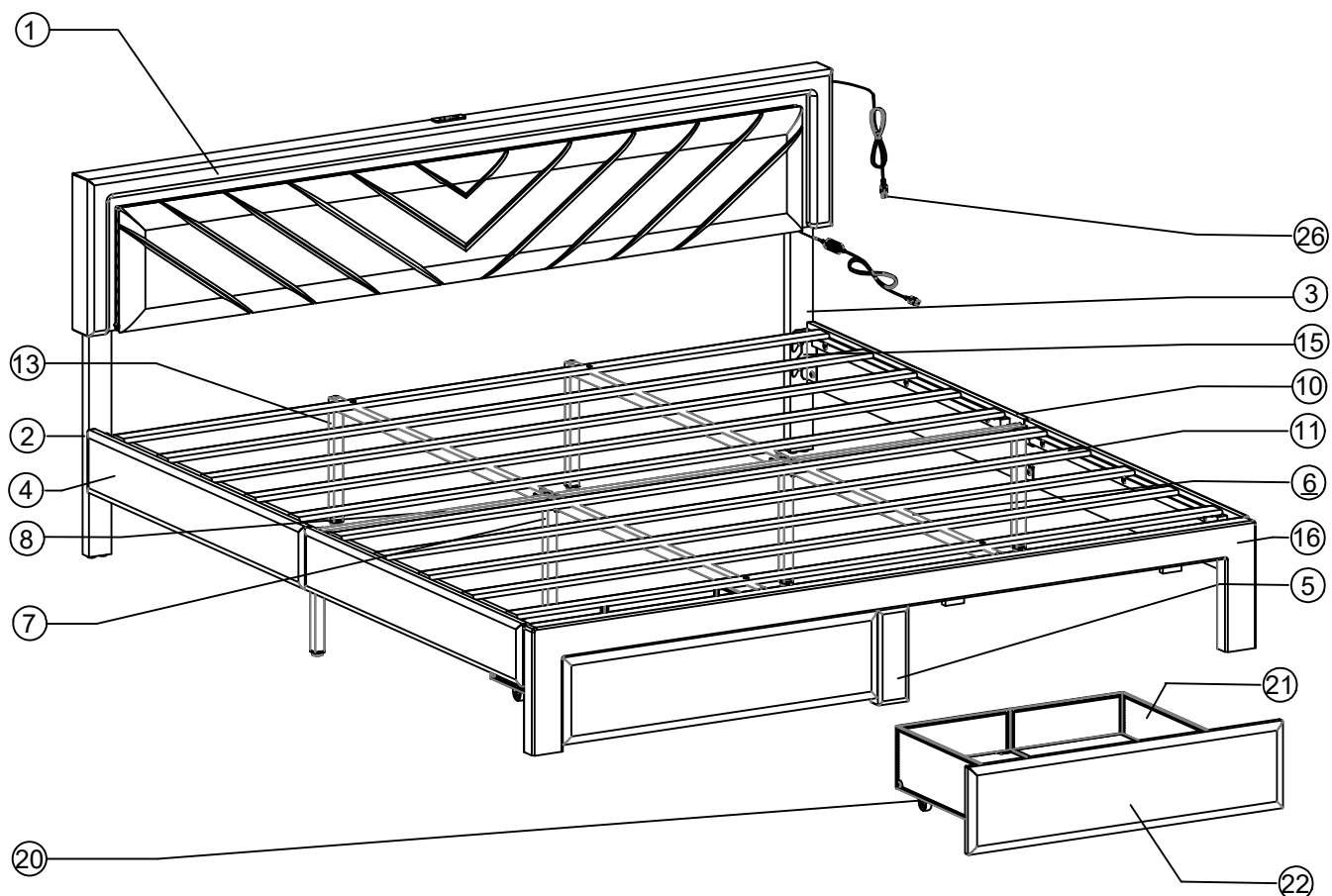

Hardware list



M8x15mm

(A) 16PCS

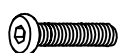

M8x20mm

(B) 14PCS



M8x35mm

(C) 10PCS



M8x45mm

(D) 8PCS



M8

(E) 6PCS



M8

(F) 1PC



M6x12mm

(G) 8PCS



M6x20mm

(H) 24PCS



M6

(I) 12PCS



M6x25mm

(J) 12PCS



M6x30mm

(K) 4PCS



M6

(L) 1PC



M6

(M) 16PCS



M6

(N) 1PC



Ø3x15

(O) 2PCS



Ø4x35

(P) 4PCS

Part list

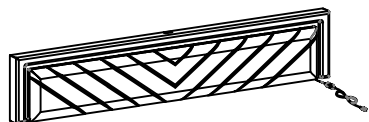

① 1PC



② 1PC

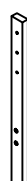

③ 1PC

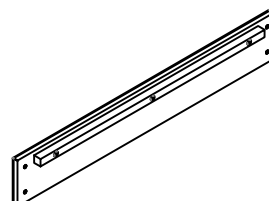

④ 2PCS

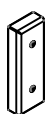

⑤ 1PC

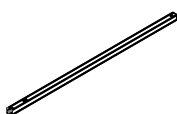

⑥ 4PCS



⑦ 2PC



⑧ 1PC



⑨ 1PC

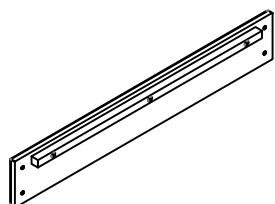

⑩ 2PCS

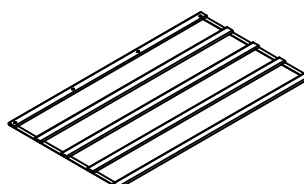

⑪ 2PCS



⑫ 1PC



⑬ 1PC



⑭ 2PCS



⑮ 2PCS

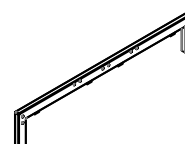

⑯ 1PC



⑰ 2PCS

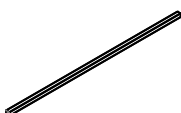

⑲ 2PCS



⑳ 8PCS

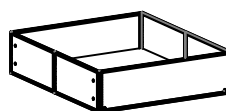

㉑ 2PCS

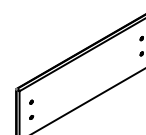

㉒ 2PCS



㉓ 4PCS

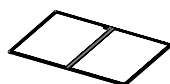

㉔ 2PCS



㉕ 4PCS



㉖ 1PC



㉘ 4PCS

Step:1

Operating Instructions

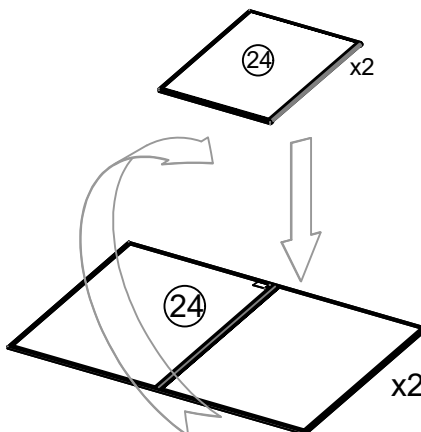
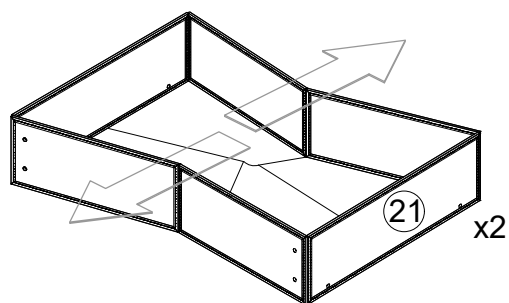

⊕ x 8PCS

⊕ x 24PCS

⊕ x 12PCS

⊕ x 12PCS

⊕ x 16PCS

Attach Part 19 to Part 25, using Screw J for installation.
Attach Part 23 to Part 25, using Screw J for installation.
Attach Part 20 to Part 25, using Screw H and M for installation.

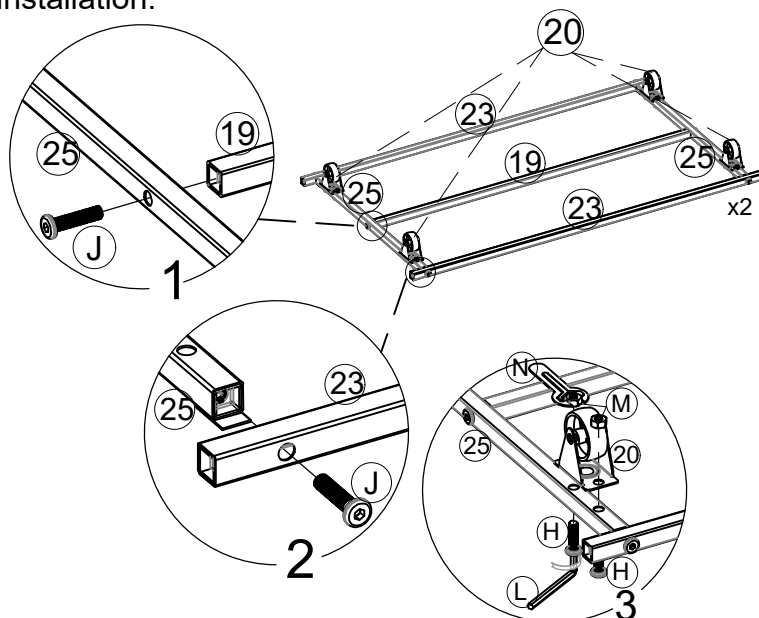

Attach Part 21 to Part 23, using Screw I and H for installation.

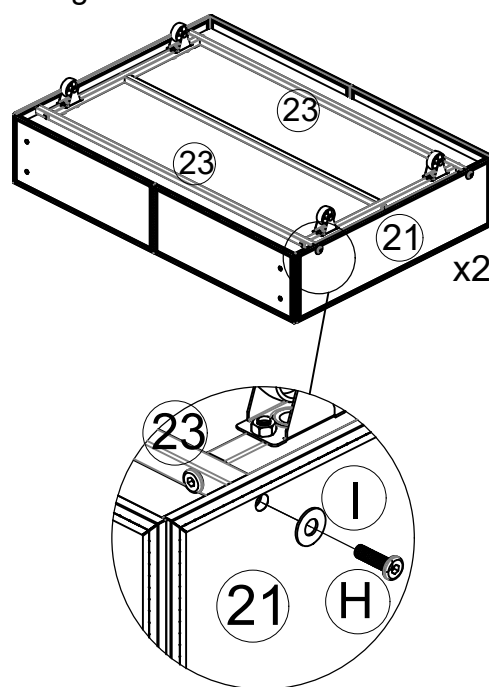

Attach Part 21 to Part 22, using Part 34, Screw G and I for installation.

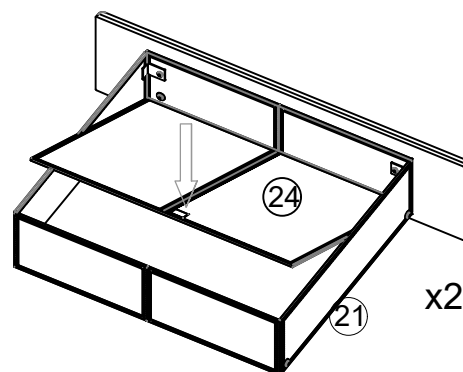
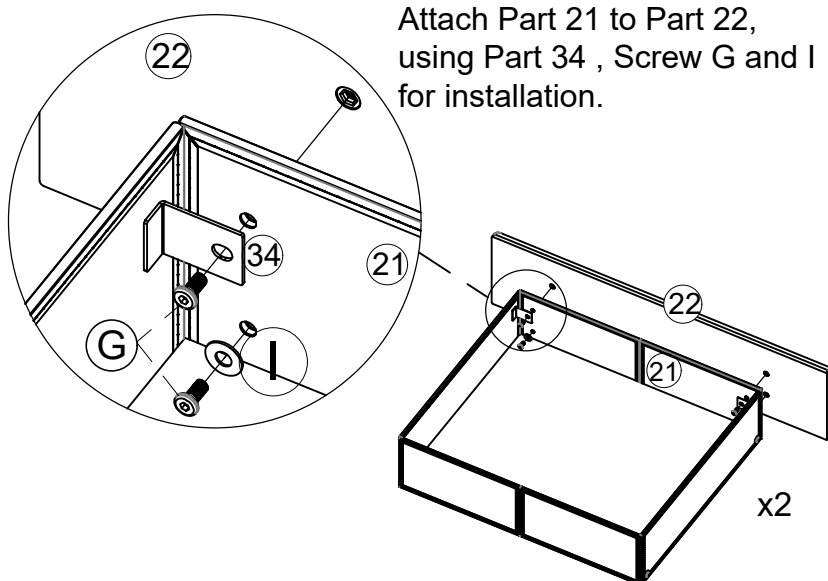

Step:2

Attach Part 15 and Part 14 to Part 4 and Part 10,
using Screw A for installation.



(A) x 8PCS

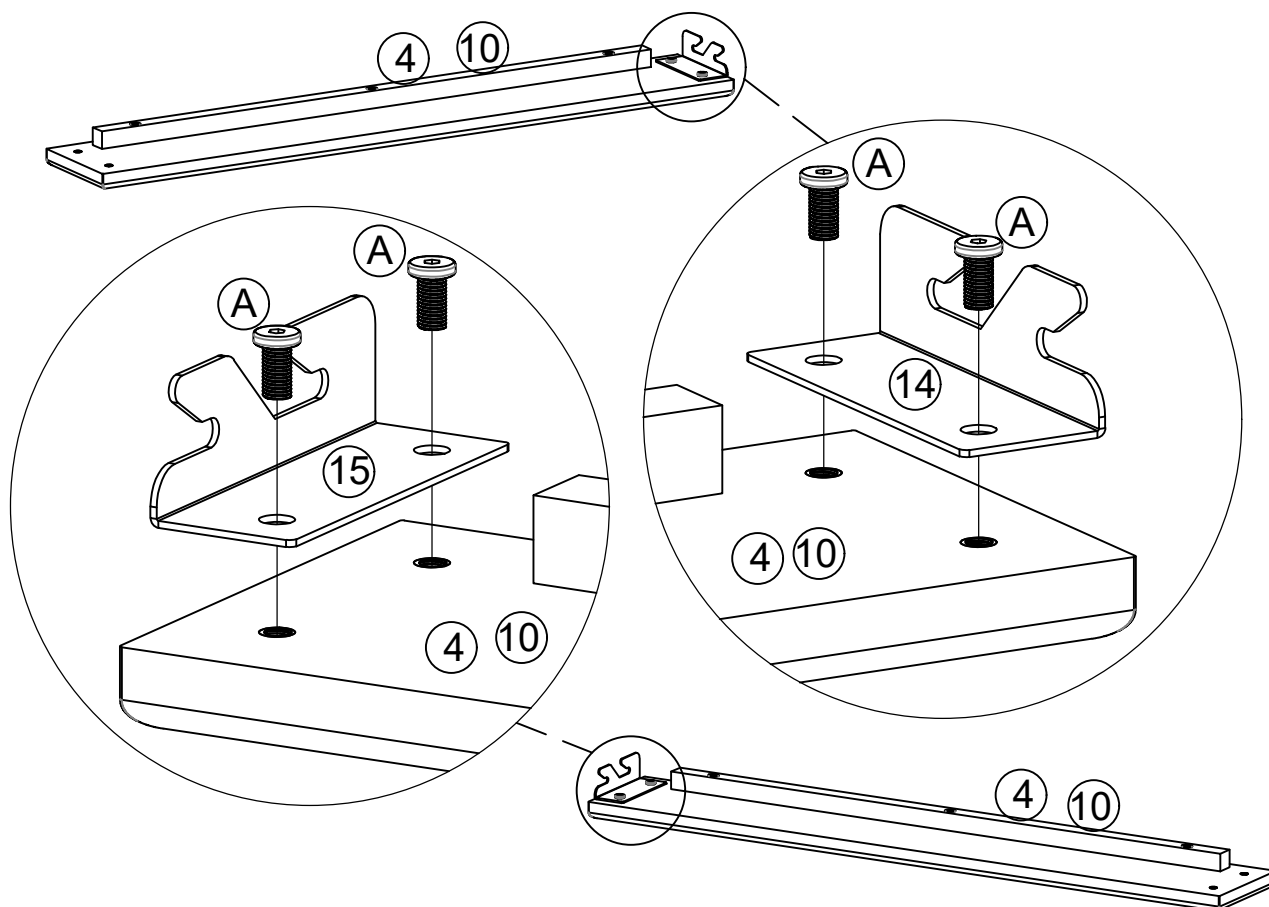

Step:3

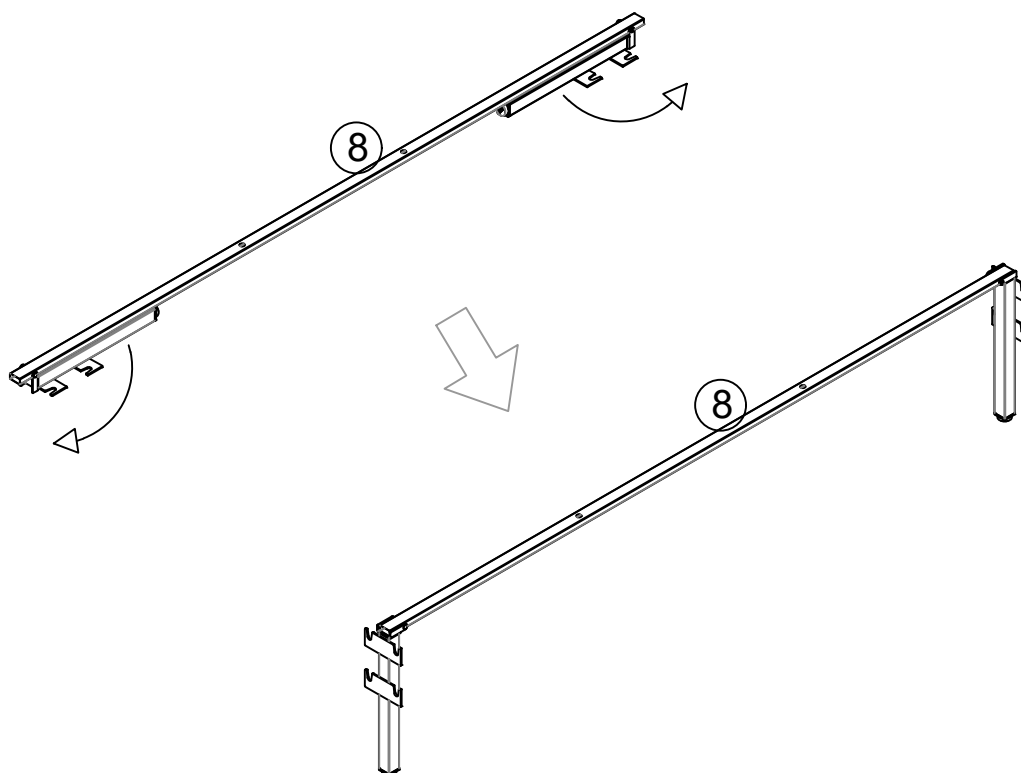

Step:4

⊙x 6PCS

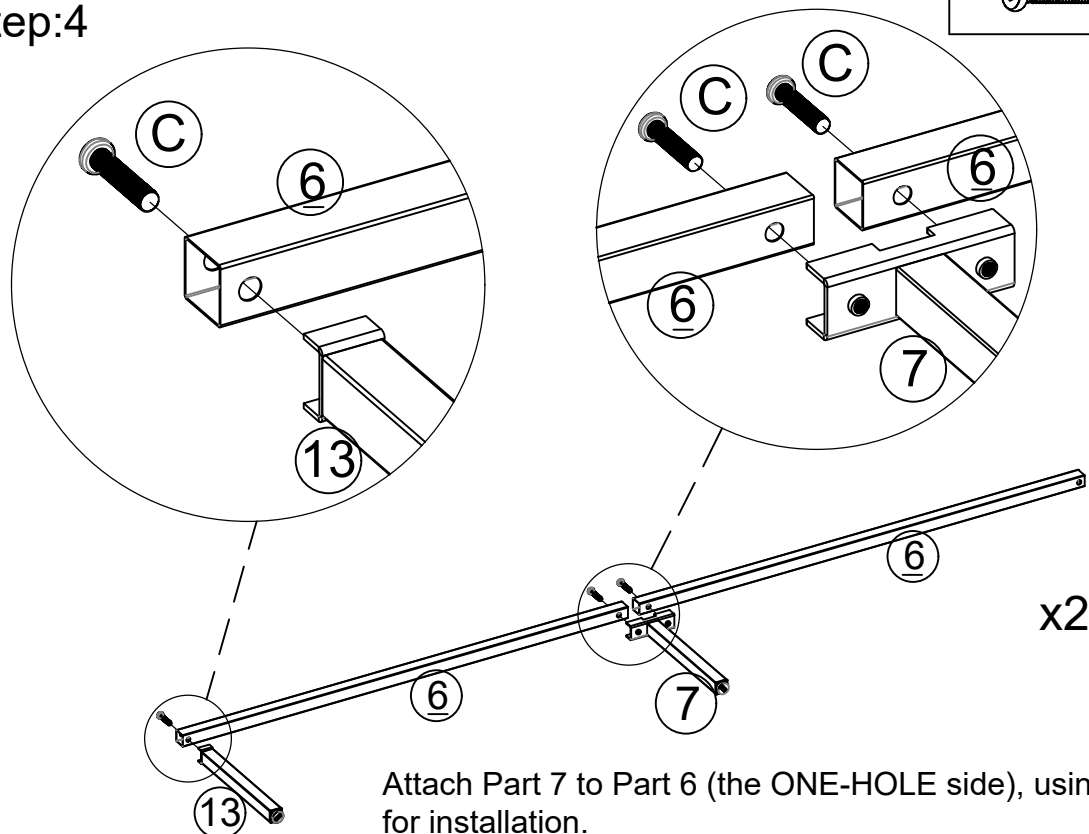

Attach Part 7 to Part 6 (the ONE-HOLE side), using Screw C for installation.

Attach Part 13 to Part 6 (through the outermost screw hole), using Screw C for installation.

Step:5

⊙x 6PCS

⊙x 2PCS

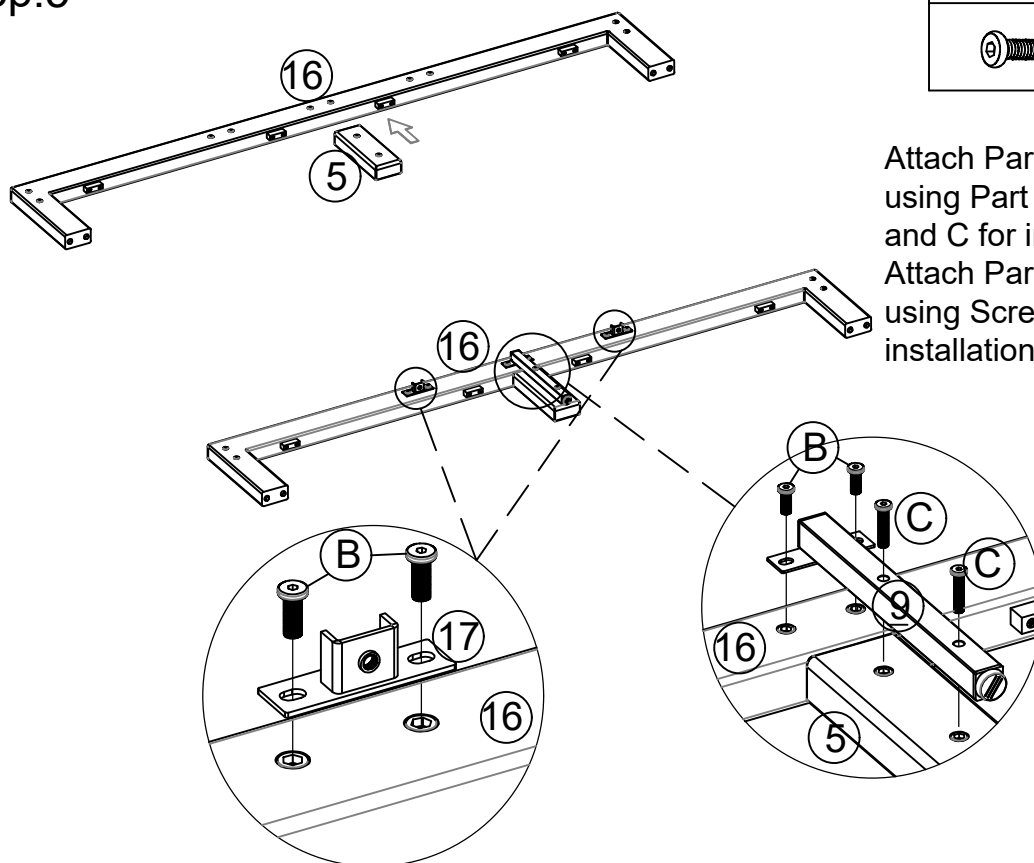

Attach Part 5 to Part 16, using Part 9, Screw B and C for installation.

Attach Part 17 to Part 16, using Screw B for installation.

Step:6

Attach Part 2 and Part 3 to Part 1, using Screw D and Washer E for installation.

 D x 6PCS

 E x 6PCS

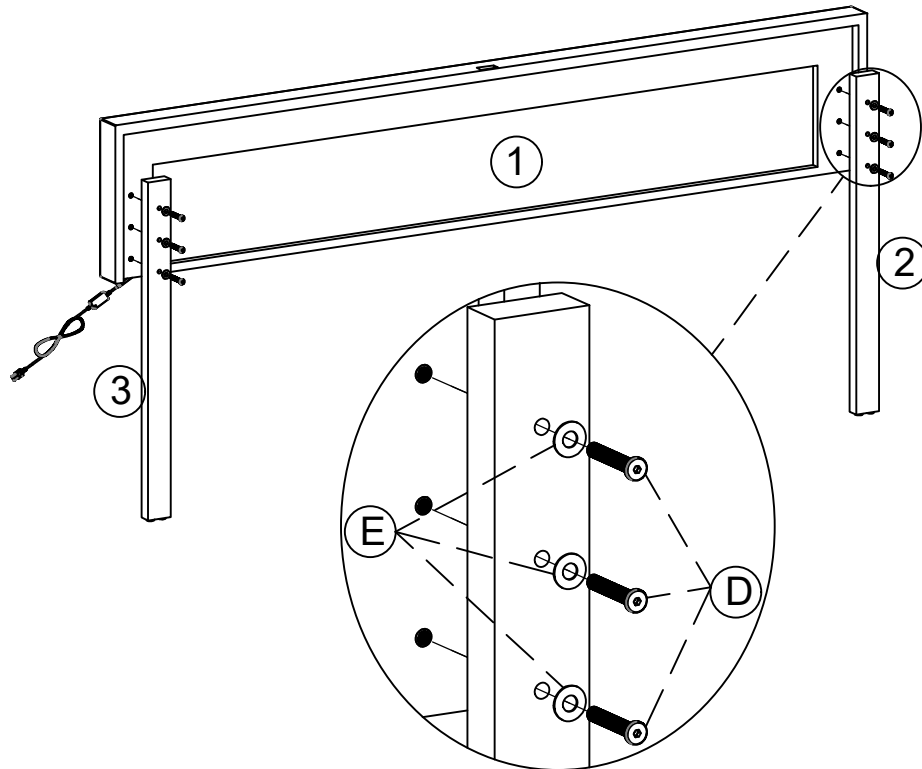

Step:7

 B x 4PCS

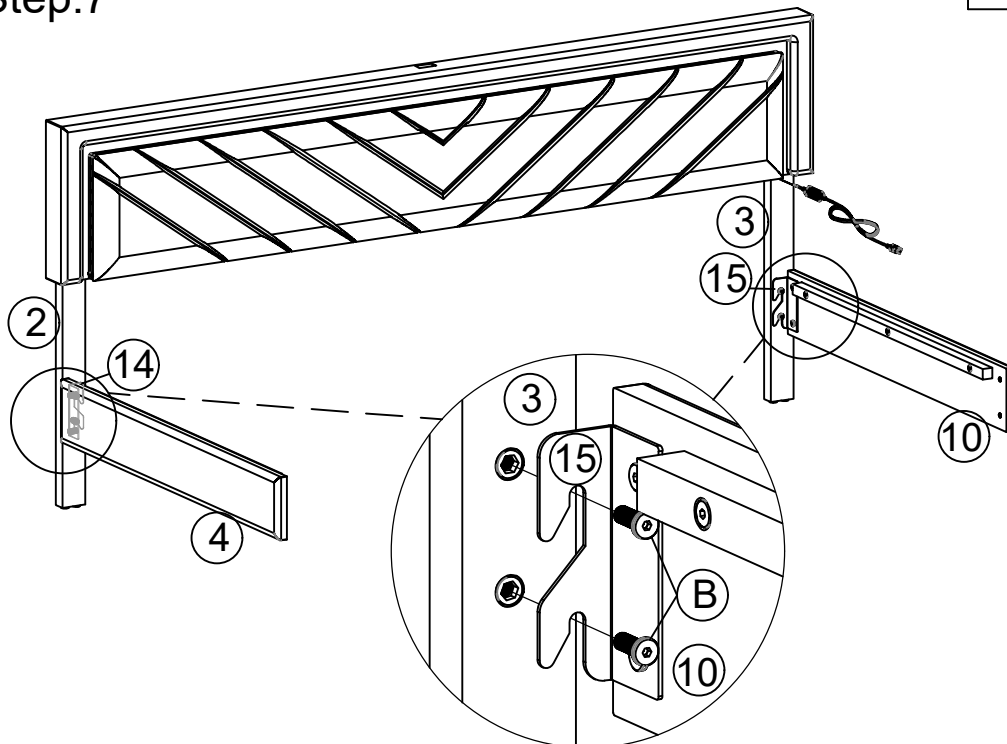

Attach Part 4 and Part 10 to Part 2 and Part 3, using Screw B, Part 15 and 14 for installation. Attach Part 4 and Part 10 to Part 2 and Part 3, using Screw B, Part 15 and 14 for installation.

Step:8



Ⓑ x 4PCS

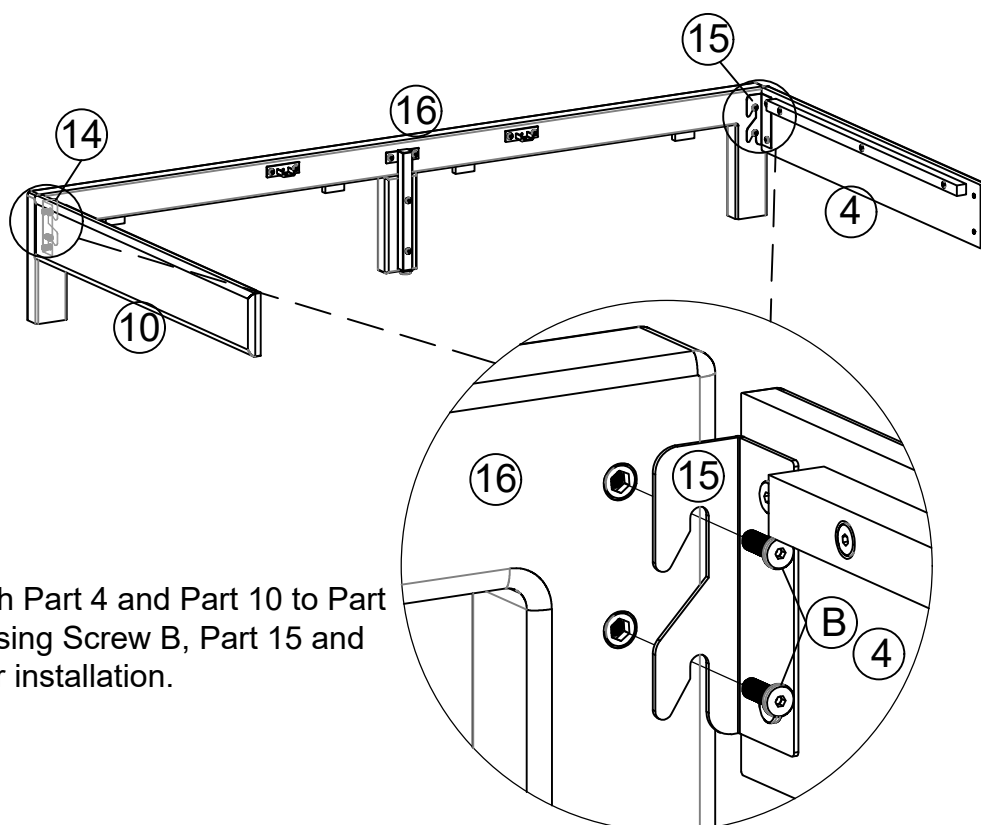

Attach Part 4 and Part 10 to Part 16, using Screw B, Part 15 and 14 for installation.

Step:9

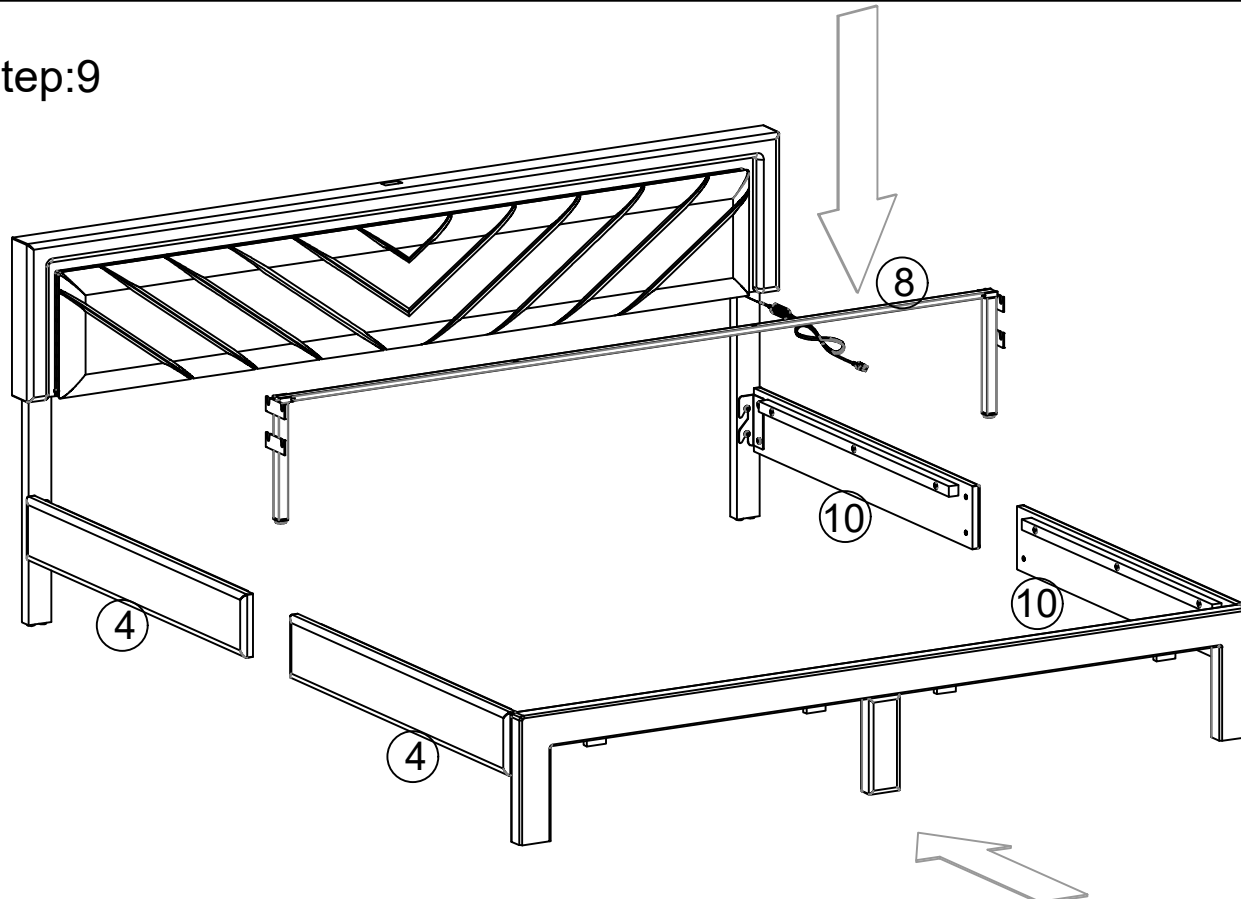

Step:10

Attach Part 8 to Part 4 and Part 10, using Screw A for installation.

 (A) x 8PCS

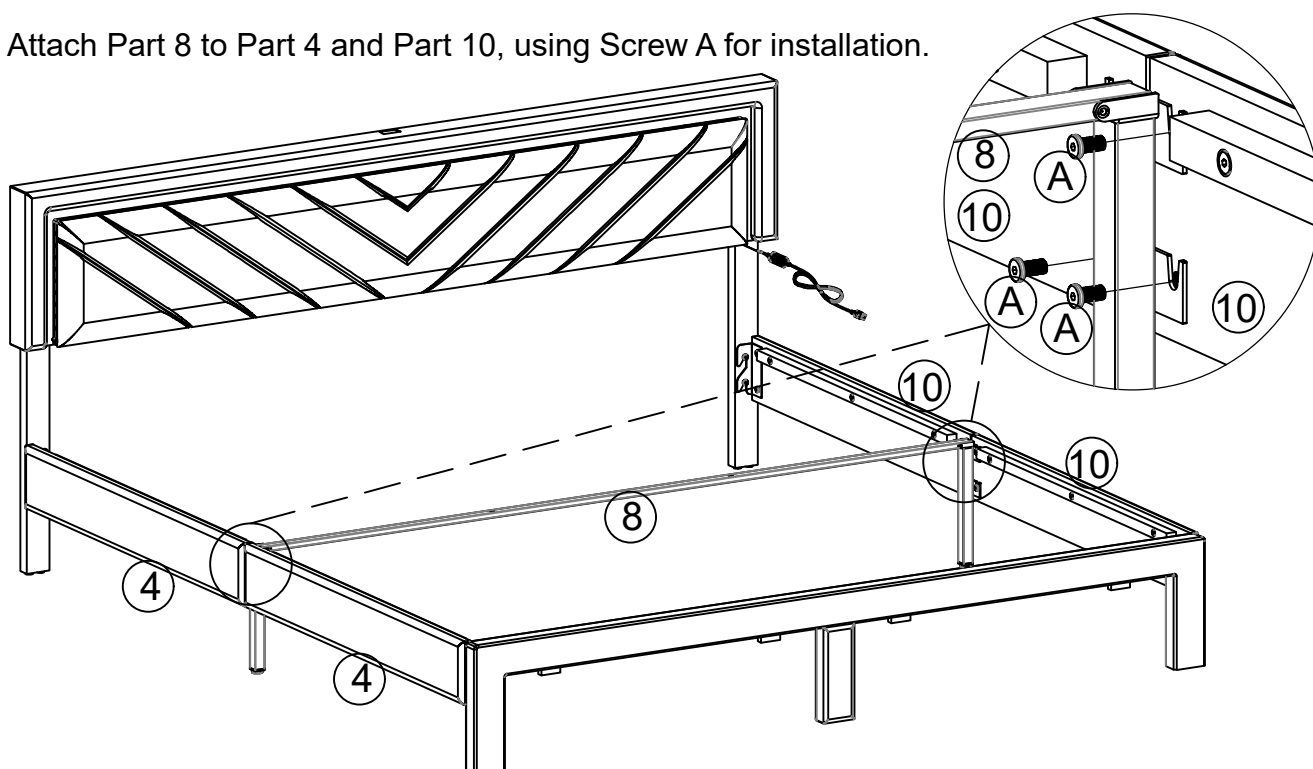

Step:11

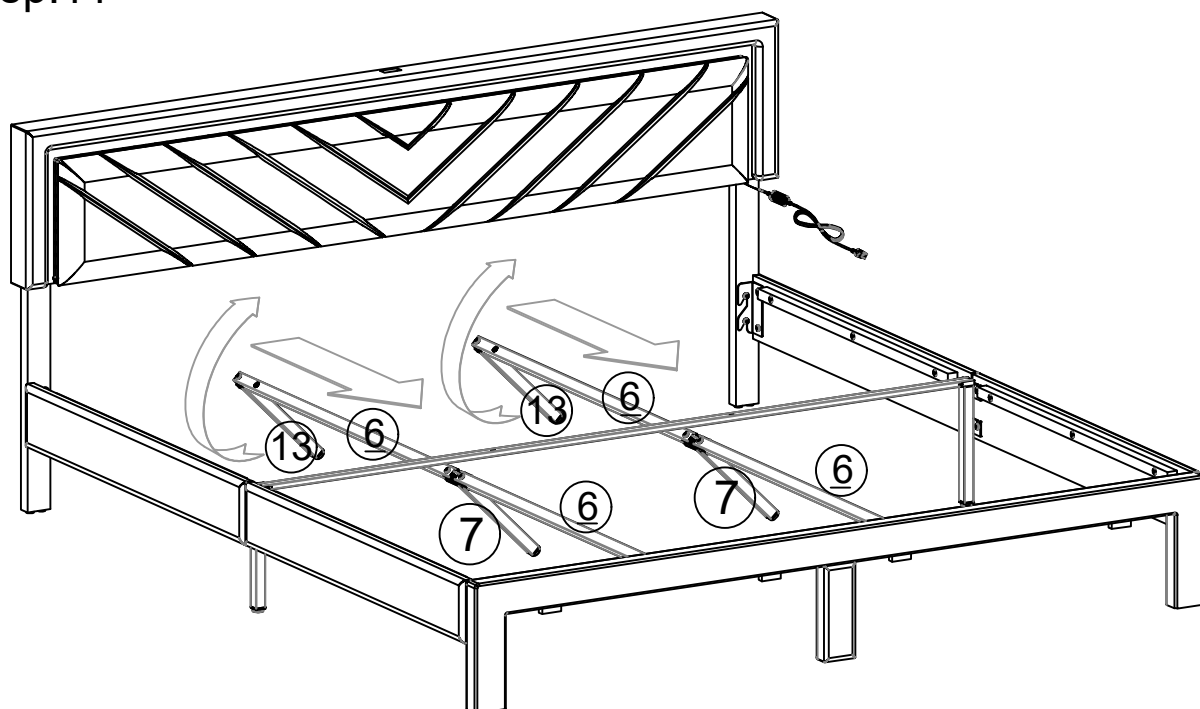

Step:12

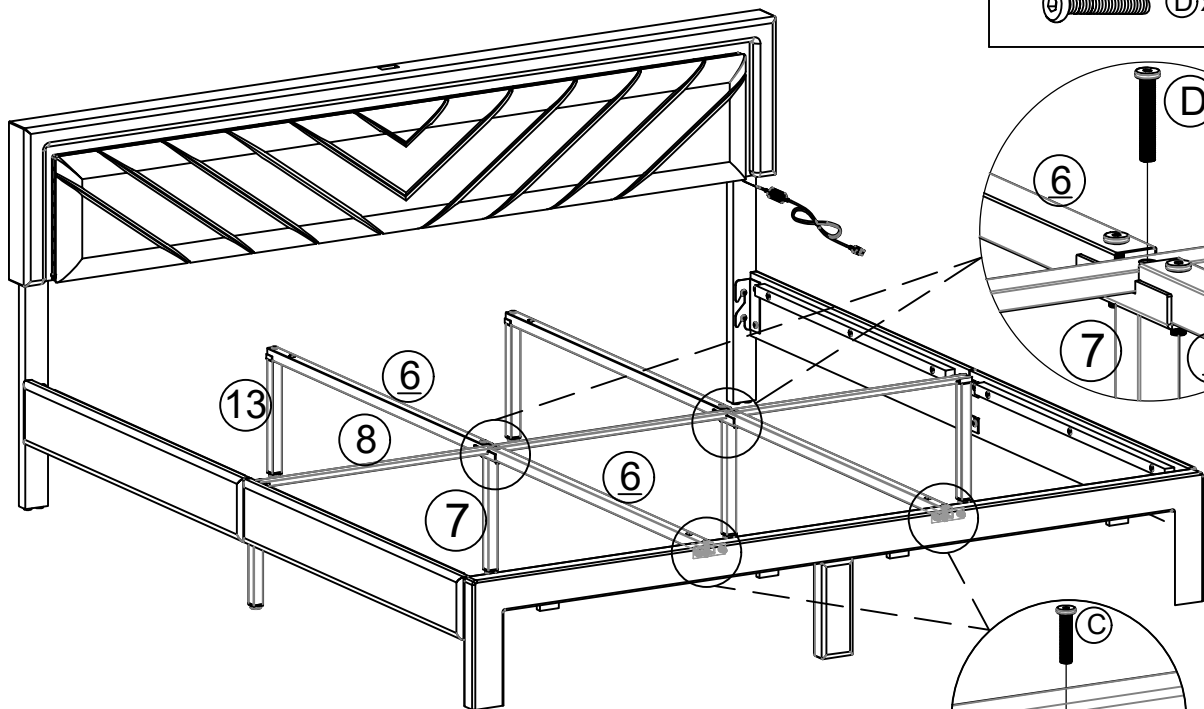

⊙ x 2PCS

⊙ x 2PCS

Attach the 2 middle bars to Part 8,
using Screw D and C for installation.

Step:13

Attach Part 11 to the bed frame,
using Screw K and P for installation.

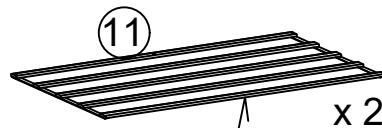

⊙ x 4PCS

⊙ x 4PCS

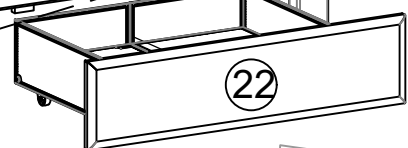
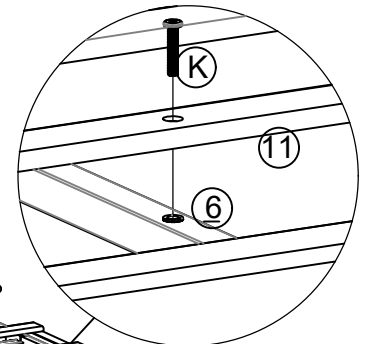
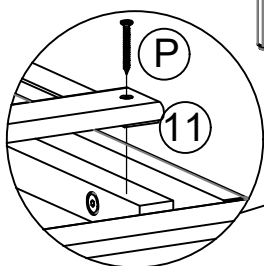

Step:14



⊙x 2PCS

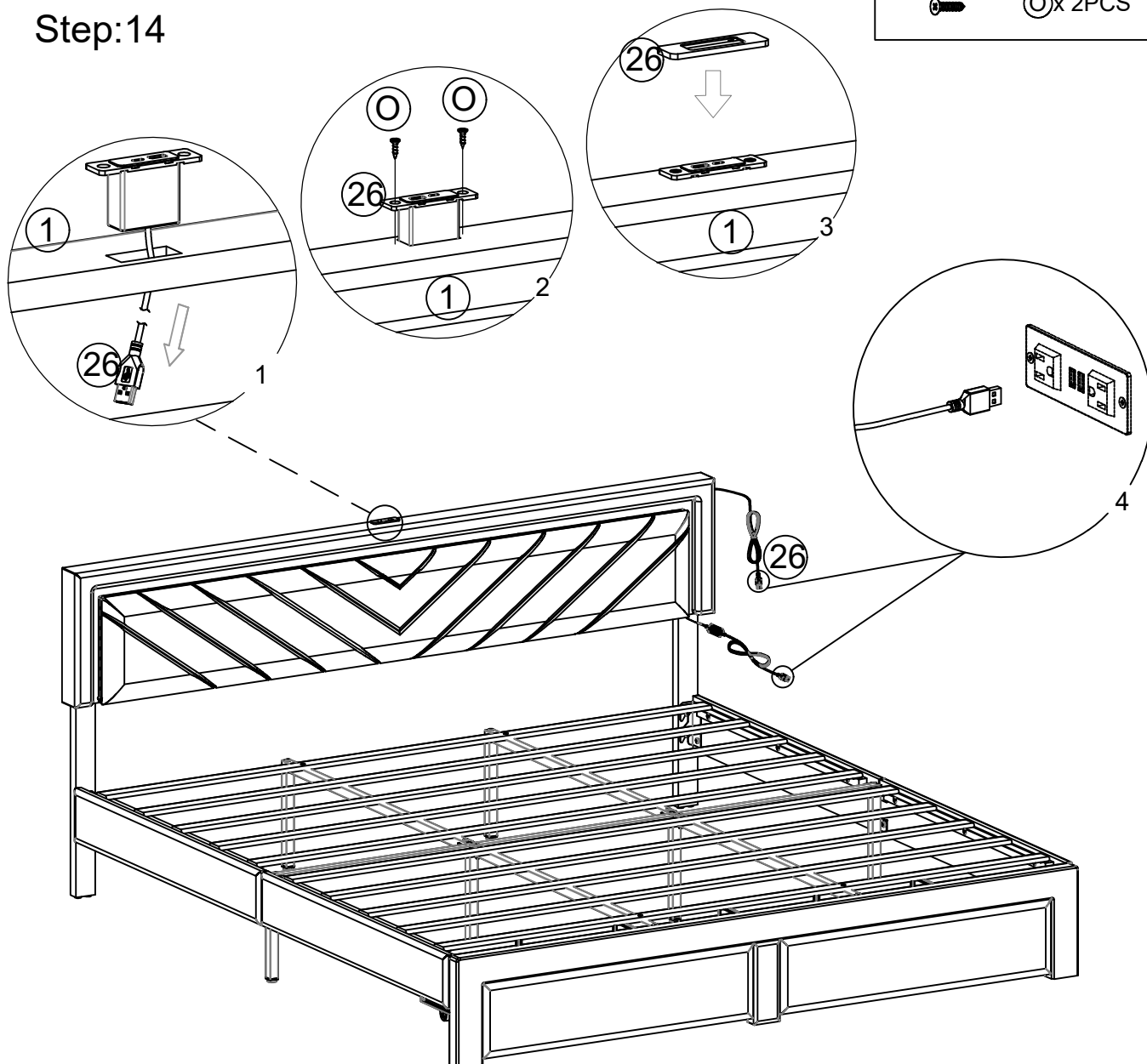

Pull out the plastic piece in the remote control, and then enjoy the led lights.

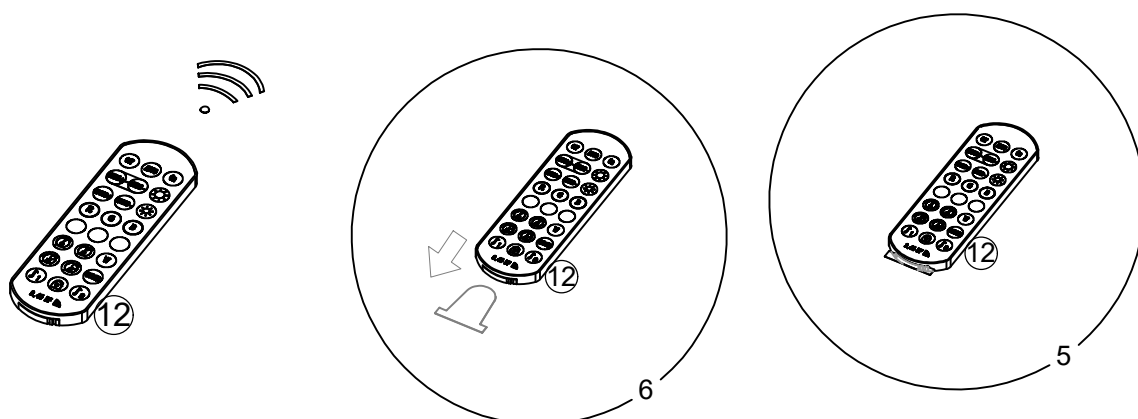

LotusLantern APP Manual

1. Software Overview

1.1 Overview

LotusLantern is a mobile APP to control LED strip by both IOS and Android phones.

The traditional control ways like infrared, 433MHz, 2.4GHz and others old wired ways will be replaced by mobile phone control way with convenient, powerful and scalable features.

Through this mobile APP , you can not only control the color, brightness and color temperature of the LED strips but also set up all kinds of fancy flash mode ; Also this APP can change the light of the LED strip according to the rhythm of the music. This APP can set and control several LED strips through Bluetooth and the operation is very simple, easy to learn and easy to use.

1.2 Features

- Adjust color LED strips with 60,000 colors to change color and brightness and adjust monochrome LED strips to change brightness and color temperature
- Play music or turn on a sound playback device, you can let the light change the color and brightness with the rhythm of music, the music rhythm beautiful
- Inside multiple setting mode for color change and control LED strips without mobile
- Long distance control with omni-directional antenna, and many-to-many group control mode
- Once the connection is successful, connect automatically next time

1.3 Performance

LotusLantern APP is easy for use as well as great compatible with all kinds of smart phones; After the actual test of hundreds of mobile phones verification, the compatibility is above 95% of mobile phones in the market. APP is small and convenient, it consumes less system resources, so the requirements of the mobile configuration are low. Control delay is small, the operation feels good, light control is smooth with people's visual sense.

2. Operating Environment

This APP program requires phones of system above Andriod 4.3 and iOS 8.0. Mobile phone configuration is not limited.

3. Instructions

Note: Android version and iOS version download and use the same method, here in the Android version as an example.

3.1 APP Download

Scan the QR code

iOS and Android systems can download the "LotusLantern" APP by scanning the QR code. Open the browser or other tools with "Scan QR code" function, scan the "LotusLantern" QR code as below:



3.2 App Operation

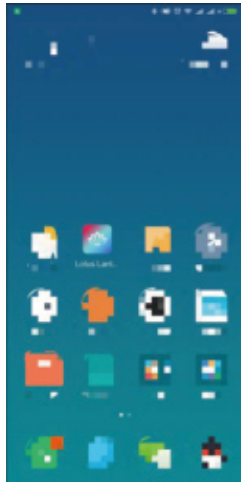

- (2) After entering the APP interface, if Bluetooth is not enabled, "an application wants to enable the Bluetooth function of this device." Click [Allow]

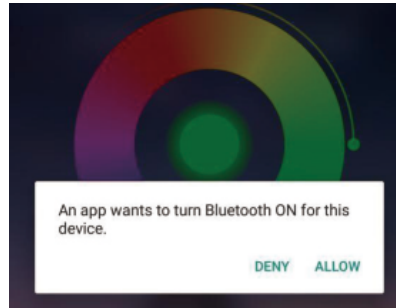

- (3) switch to color and brightness interface:

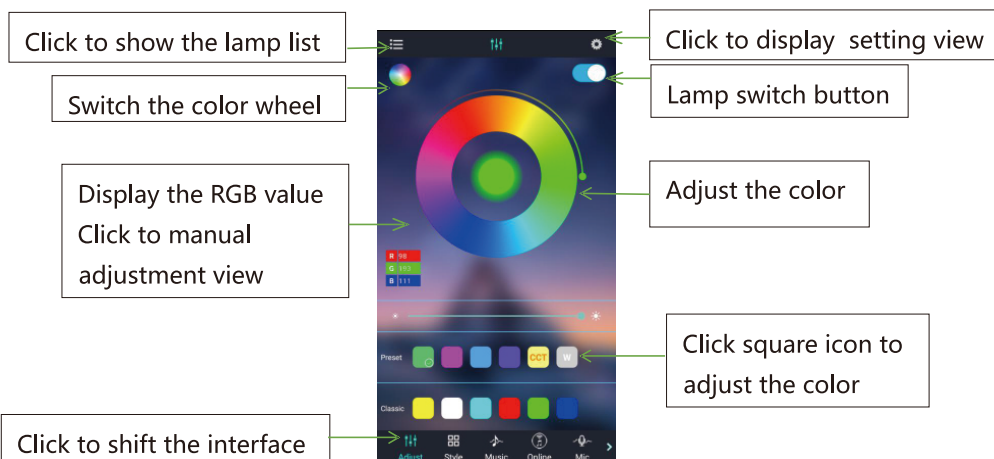

- (4) click to show the lamp list, view lamp list:

Bluetooth auto connect after search for devices

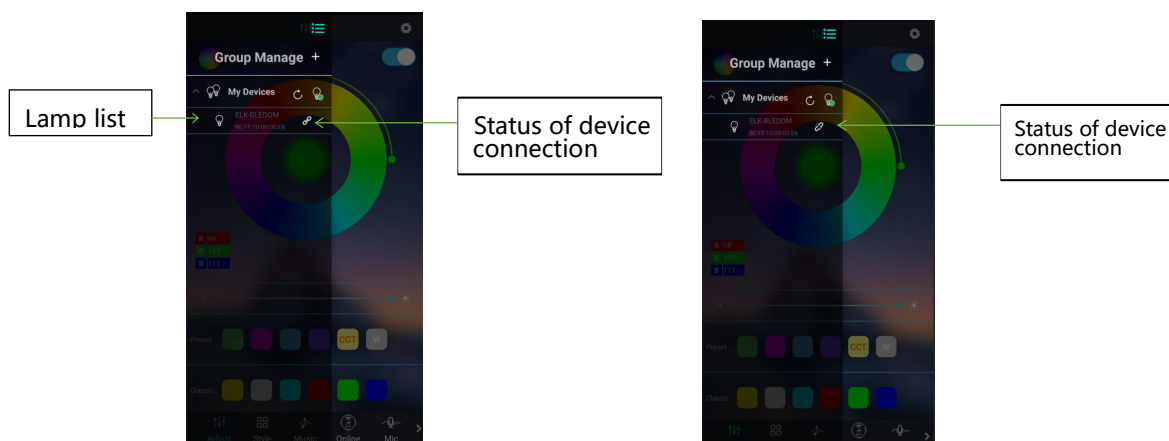

(5) Click to RGB manual adjustment view:

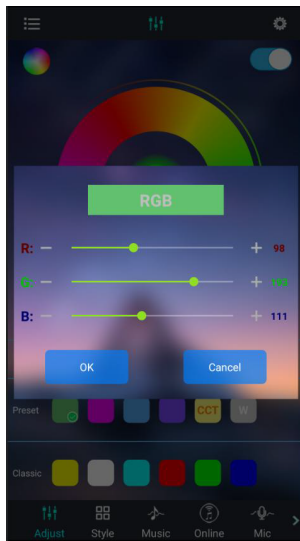

(6) switch to the mode interface:

Scroll the selection mode

Adjust seed

Adjust luminance

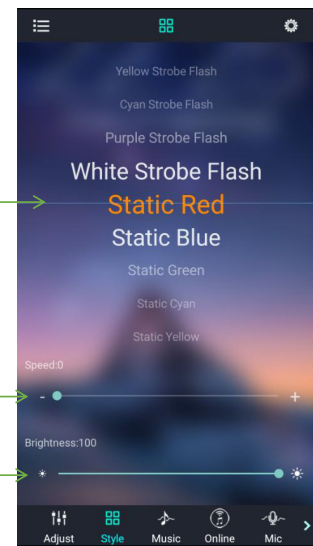

(7) switch to the music rhythm interface:

(8) Switch to the online music interface:

Previous song,
Pause/Play,
Next song

Play mode

Music List

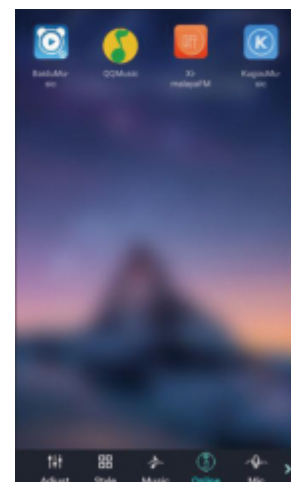
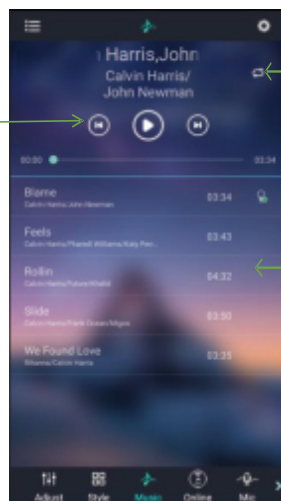

(9) Switch to the microphone rhythm interface:

Music rhythm through the
microphone on the product

Switch phone microphone
and external microphone

4-style rhythm

Change the sensitivity of
MIC to match the sound

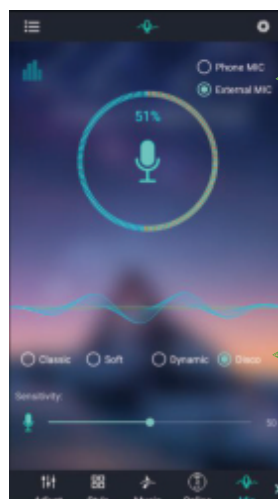

(10) Switch to the schedule interface:

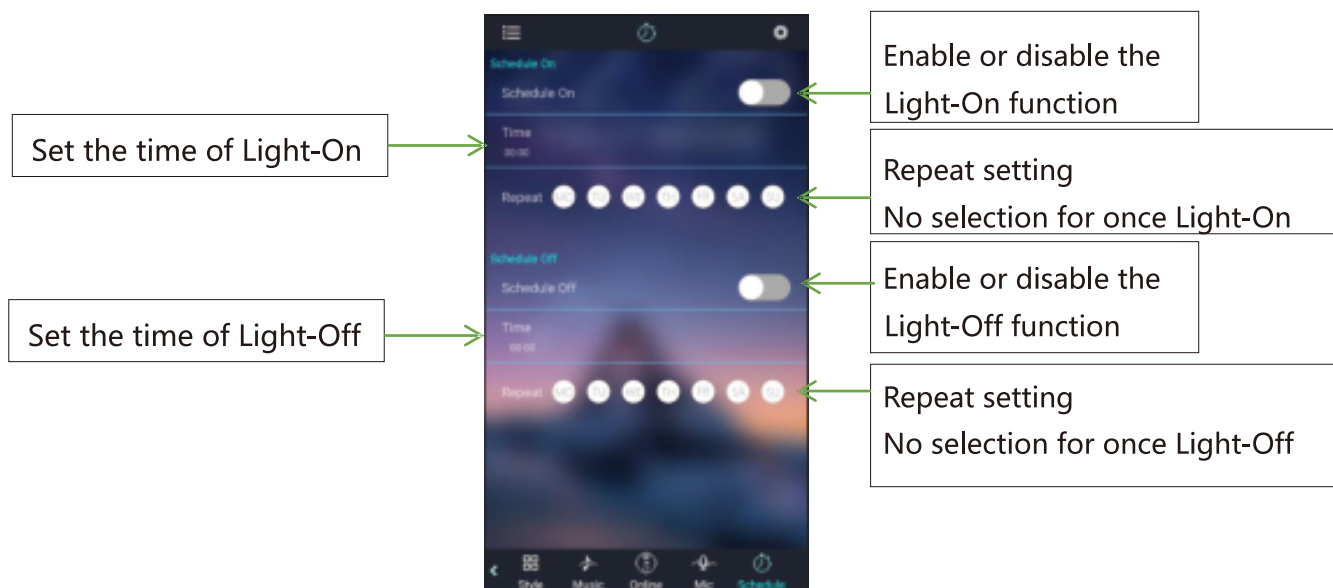

(11) Switch to the modify pin sequence interface:

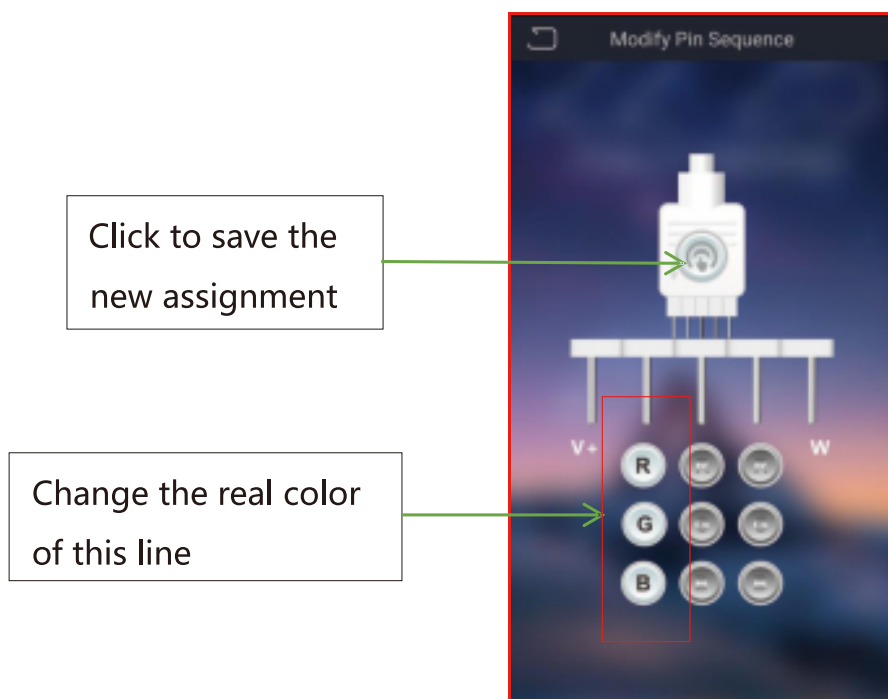

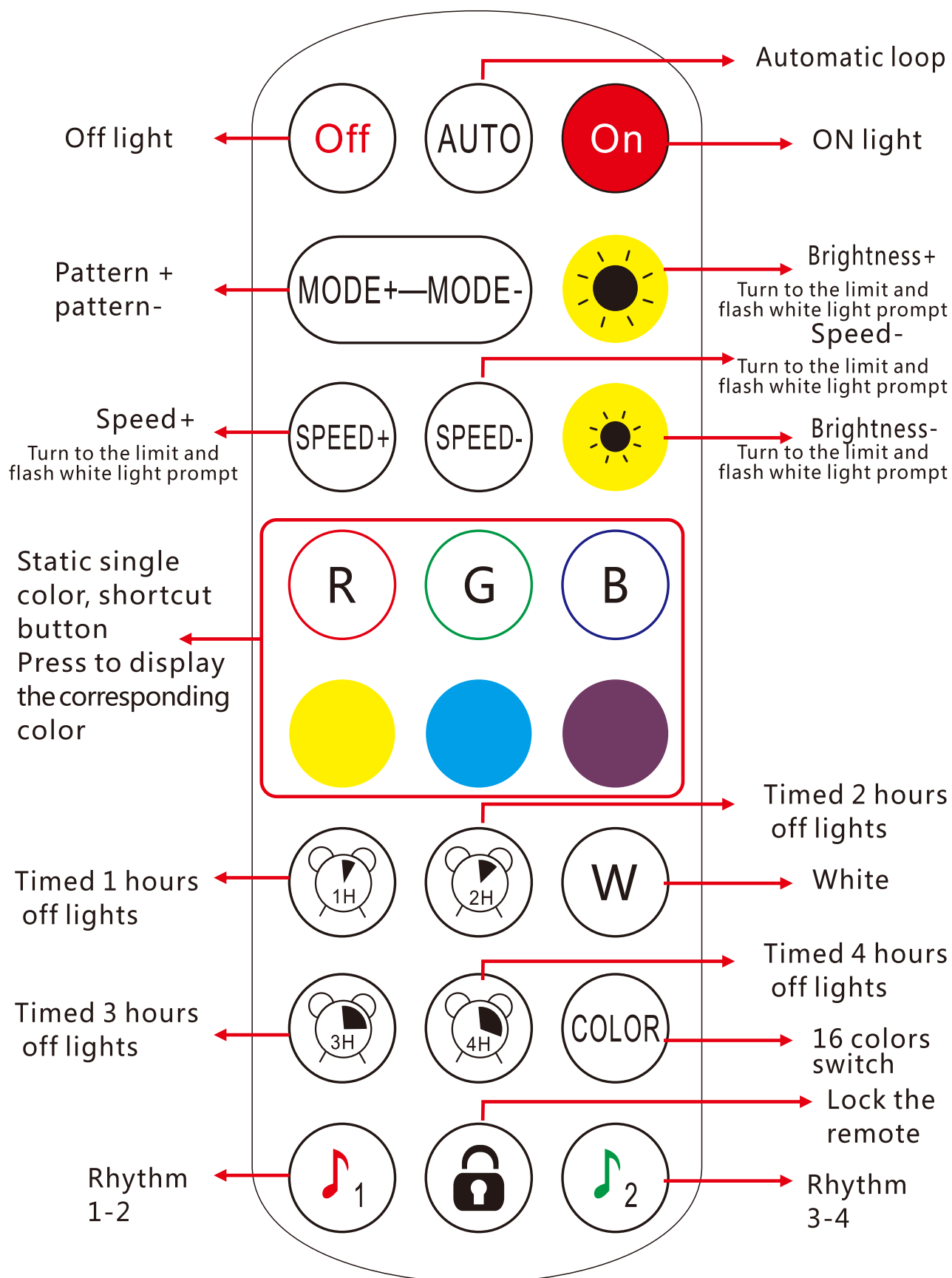

Rhythm 1-2: Single click to switch to 1-2 rhythm mode
 Rhythm 3-4: Click to cycle through the 3-4 rhythm mode
 Remote control lock: After pressing, the remote control is locked, pressing the switch is available, other keys are invalid. After pressing once, the unlock button can be used.
 After the remote control is locked, press the switch to unlock the remote control. 16/16